

DURACELL® High Power Inverter 1200 / 3000 User Guide

FR
SP

FRENCH AND SPANISH LANGUAGE MANUALS - Please go to www.DuracellPower.com to download printable manual.

MANUELS DE LANGUE FRANÇAISE ET ESPAGNOLE - Passez à www.DuracellPower.com pour télécharger le manuel imprimable.

MANUALES DE IDIOMAS ESPAÑOL E FRANCÉS - Por favor vaya a www.DuracellPower.com para descargar manual imprimible.

Features

1200 Watt Inverter

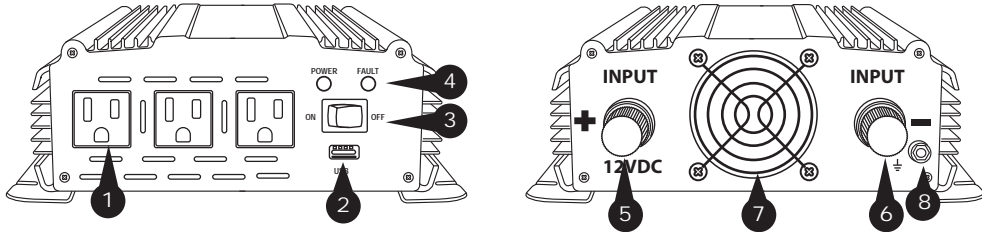

- | | |
|-----------------------------|--|
| 1. AC outlets (3 total) | 5. Positive DC input |
| 2. USB port | 6. Negative DC input |
| 3. Inverter On / Off switch | 7. Cooling vent - IMPORTANT - DO NOT COVER |
| 4. Power/Fault LED lights | 8. Ground connection |

3000 Watt Inverter

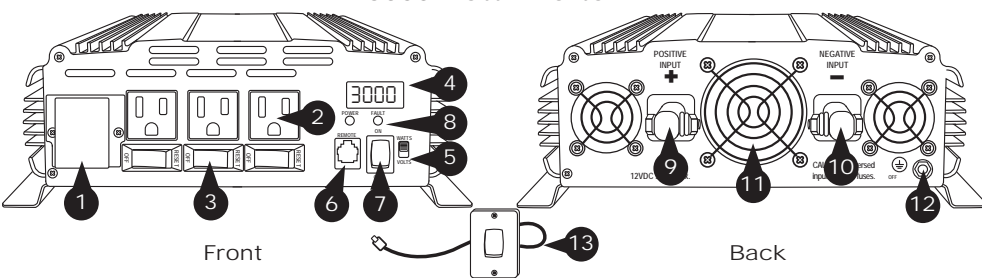

- | | |
|--|--|
| 1. AC output terminal | 8. Power/Fault LED lights |
| 2. AC outlets (3 total) | 9. Positive DC input |
| 3. AC outlet individual On / Off + circuit breaker | 10. Negative DC input |
| 4. LED digital display | 11. 3 Cooling vents - IMPORTANT - DO NOT COVER |
| 5. Digital display select (Watts / Volts) | 12. Ground connection |
| 6. Remote port | 13. Remote On / Off switch |
| 7. Inverter On/Off switch | |

Getting Started

SAVE THESE INSTRUCTIONS – this manual contains safety and operating instructions for the inverter. Misusing or incorrectly connecting the inverter may damage the equipment or create hazardous conditions for users. Read the following safety instructions and pay special attention to all Caution and Warning statements in the guide.

Warnings identify conditions that may result in personal injury or loss of life.

Cautions identify conditions or practices that may damage the unit or other equipment.

! IMPORTANT

Consult an electrician. Installations must meet local and national wiring codes.

Installation

Wire Selection

Use the thickest gauge and shortest length allowed by your configuration and budget. As a rule of thumb no more than 2% loss should be allowed. The chart below lists minimum specifications, please consult a wire gauge chart for longer installations.

Failure to follow these safety guidelines may cause personal injury and/or damage to the inverter. It may also void your product warranty.

Maximum cable length (ft.) [2% voltage drop]

	Wire Gauge AWG						
	8	6	4	2	1/0	2/0	4/0
100A (1200W)		2.9	4.6	7.2	11.5	14.5	23
250A (3000W)			1.8	2.8	4.6	5.8	9.2

! IMPORTANT

All connections must be clean and tight for optimal performance. Loose connections will result in higher resistance loss of power and increased heating. Do not cover or obstruct ventilation openings.

Install in a ventilated area, leave at least 6 inches of space in front and behind the inverter for ventilation and at least 2 inches around the top and sides for the cooling fins to dissipate heat.

Connecting the power cable to the inverter terminal - must be in this order

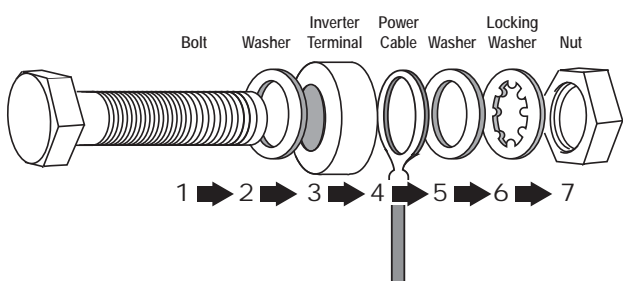

Grounding

The ground connection can be connected to earth or chassis ground depending on the installation:

- **Land:** Connect to earth ground
- **Vehicle:** Connect to vehicle chassis of the vehicle. If power equipment is used outside the vehicle an earth-stake should be used.

! WARNING

Loose connectors result in excessive voltage drop and may cause over heated wires and melted insulation, which can lead to electrical fires. Reverse polarity connections (positive to negative) will blow internal fuses in the inverter and may permanently damage the inverter.

Permanent Installation

See diagram below. Install a UL-listed fuse in-line with the red input cable, as close to the battery as possible. Ensure tight connections.

Fuse size
DRINV1200: ANL-200
DRINV3000: ANL-400

1. Connect the negative (black) terminal of inverter to the negative battery post.

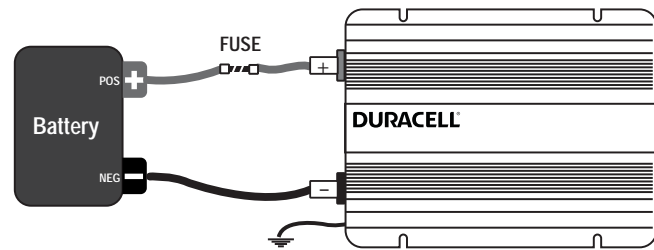

2. Connect the positive (red) terminal of inverter to the positive battery post.
3. Connect the ground terminal according to the GROUNDING section above.

Direct Connect AC Terminal (DRINV3000 model only)

! IMPORTANT

AC extension wire and socket are not included with this inverter. Each wire should be no thicker than 10AWG.

1. Remove the cover to access the terminals.
2. Expose no more than 1/2" of conductor from each wire and secure the rest through the strain relief.
3. AC wire colors:
 - Line/Hot – Black or Brown
 - Neutral – White or Blue
 - Ground – Green or Green/Yellow

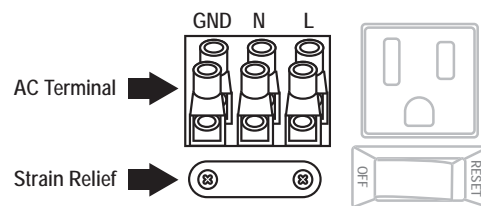

Using The Inverter

! IMPORTANT

The inverter draws current in the ON position, switch it OFF to prevent it from drawing power from the batteries. See "no-load power draw" section in the specification table.

Connecting your devices/appliances

1. Ensure that all connections are secure and DC power is available.
2. Connect AC devices.
3. Connect USB devices (1200 Watt Inverter Only)
4. Turn the inverter On/Off switch ON.

NOTE: Turn the inverter On/Off switch to OFF when done using the inverter to avoid discharging your battery.

! IMPORTANT

Your inverter is able to operate several devices at once, up to its maximum combined load. The 1200 Watt inverter can power a combined load of up to 1200 Watts of continuous power. The 3000 Watt can power a combined load of up to 3000 Watts of continuous power. If the total power draw of the connected devices, tools and/or appliances exceeds this maximum, the inverter will automatically shut down to avoid dangerous overload. The chart below shows an approximation of typical wattages for popular electrical items. Please consult the manual(s) of your device(s) to determine the exact wattage of your particular model.

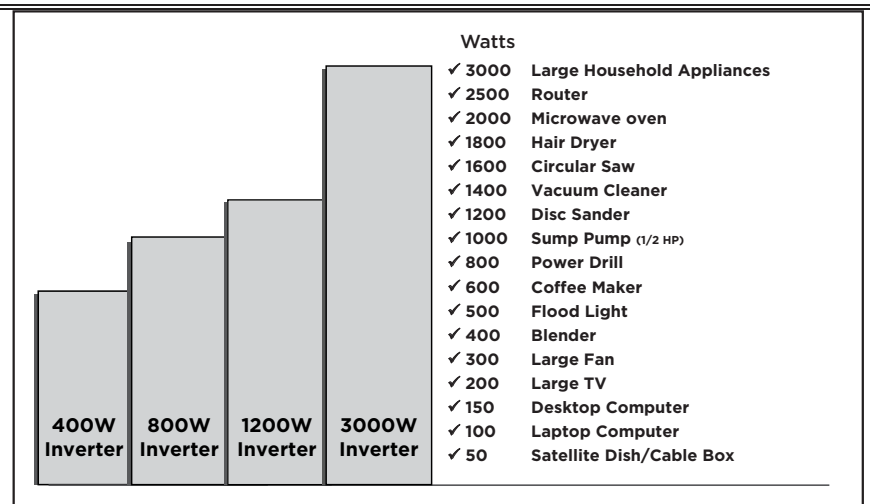

LED display (3000 Watt Inverter only)

Use the digital display select switch to show AC output power in Watts or battery voltage in Volts.

Remote On/Off switch (3000 Watt Inverter only)

In order to use the remote, the inverter On/Off switch must be in the OFF position. The inverter can then be turned ON or OFF with the remote switch.

Safety

Under Voltage

At 10.5 ±0.3V input an alarm sounds, at 10.0V the inverter shuts down and the FAULT LED turns on. This protects the battery from over discharge.

Over Voltage

If the input voltage is >15V, an alarm sounds, the inverter shuts down to protect itself and the FAULT LED will illuminate.

Over Load

When power output exceeds the rated continuous power for extended periods of time or the surge power for more than 20 seconds the inverter will shut down. After the excessive load is removed the inverter can be restored by turning it on and off.

Over Temperature

An alarm will sound and the FAULT LED will illuminate if the inverter overheats and will shut down if it does not cool down. Poor ventilation, over load or high room temperature can cause an overheating condition. The cooling fan is temperature controlled and turns on to prevent overheating during normal operation.

Short Circuit

When an output short circuit occurs, the inverter will beep, the FAULT LED will turn on and the inverter will shut down.

Specifications

	DRINV1200	DRINV3000
Continuous Rated Power	1200 Watts	3000 Watts (distributed between the 3 AC outlets - OR - full output wattage from the AC output terminal)
Peak Surge Power	2400 Watts	6000 Watts
Input Voltage (Nominal)	12 V	12 V
Output Voltage AC (Nominal)	115 V	115 V
Output Frequency (Nominal) 60 Hz	60 Hz	60 Hz
Output Waveform	Modified Sine Wave	Modified Sine Wave
Standby Current <0.80A <1.0A	<0.5A	<1.0A
Low Battery Voltage Alarm	10.5 VDC (+/-0.5VDC)	10.5 VDC (+/-0.5VDC)
Low Battery Voltage Shutdown	10.0 VDC (+/-0.5VDC)	10.0 VDC (+/-0.5VDC)
High Battery Voltage Shutdown	>15 VDC	16 VDC (+/-1.0VDC)
Efficiency	>85%	>83%
Dimension (L x W x H)	10.8" x 8.7" x 3.1" (275 x 220 x 78 mm)	16.5" x 10.2" x 3.6" (420 x 260 x 92 mm)
Weight	5.7 lb. (2.6 kg)	13.2 lb. (6.0 kg)
Operating Temperature	-5°C to 40°C	-5°C to 40°C
Operating Humidity	10 to 90% relative humidity	10 to 90% relative humidity

Troubleshooting

Problem	Cause and remedies
No Power	A bad battery's voltage can be below the inverter's low voltage limit.
No Power	Check fuses and circuit breakers if installed.
No Power	Loose cable connections can create high resistance and voltage drops, check all connections.
Inverter turns off quickly	Over load: check the wattage of devices connected to the inverter and make sure they do not exceed the rated continuous wattage.
Alarm and/or fault led activates	low voltage, over temperature or overload may be the cause. Follow the remedies listed above.

Recycling

Battery-Biz is committed to environmental responsibility and recommends that electronic devices be disposed of properly. Please contact your local city offices for information on recycling and disposal programs for e-waste.

For instructions on how to recycle this product visit <http://www.call2recycle.org>.

Contacting Customer Support

If you experience any problems or have any questions regarding your DURACELL® inverter, free technical support is available. Prior to calling, please review the technical support tips below.

Call from a phone where you have access to your mobile device

Be prepared to provide the following information:

- Name, address and telephone number
- Name of the DURACELL® product
- Make and model of your device
- Symptoms of the problem(s) and what led to them

Technical Support is available by telephone:

U.S. and Canada (800) 300-1857

Outside of the US/Canada: (805) 437-7765

Written inquires should be directed to:

Battery-Biz Inc.

DURACELL® Product Inquiry

1380 Flynn Road, Camarillo, CA 93012, USA

Warranty and Return Information

Three Year Limited Warranty

The DURACELL® inverter carries a limited warranty against defects in material and workmanship under normal use and service for three years from the original date of purchase. The manufacturer or distributor, at its option, shall repair or replace the defective unit covered by this warranty. Please retain the dated sales receipt as evidence of the date of purchase as it will be required for any warranty service. In order to keep the warranty in effect, the product must have been handled and used as described in the instructions accompanying this warranty. This warranty does not cover any damage due to accident, misuse, abuse or negligence.

Disclaimer Of Warranty

The limited warranty described herein is your sole remedy. To the extent permitted by law, the manufacturer and distributor disclaim all other implied or express warranties including all warranties of merchantability and/or fitness for any particular purpose.

Limitation Of Liability

Except to the extent of repairing or replacing this product as expressly stated in the limited warranty described herein, the manufacturer and distributor shall not be liable for any damages, whether direct, indirect, incidental, special, consequential, exemplary, or otherwise, including lost revenues, lost profits, loss of use of software, loss or recovery of data, rental of replacement equipment, downtime, damage to property, and third-party claims, arising out of any theory of recovery, including statutory, contract or tort. Notwithstanding the term of any limited or implied warranty, or in the event that any limited warranty fails of its essential purpose, in no event will the manufacturer's and distributors entire liability exceed the purchase price of this product. Some states and provinces do not allow the exclusion or limitation of incidental or consequential damages so the above limitations or exclusions may not apply to you. This limited warranty gives you specific legal rights. You may have other rights which vary from state to state and province to province.



WARNING

This product contains chemical(s) known to the State of California to cause cancer, birth defects, or other reproductive harm.