

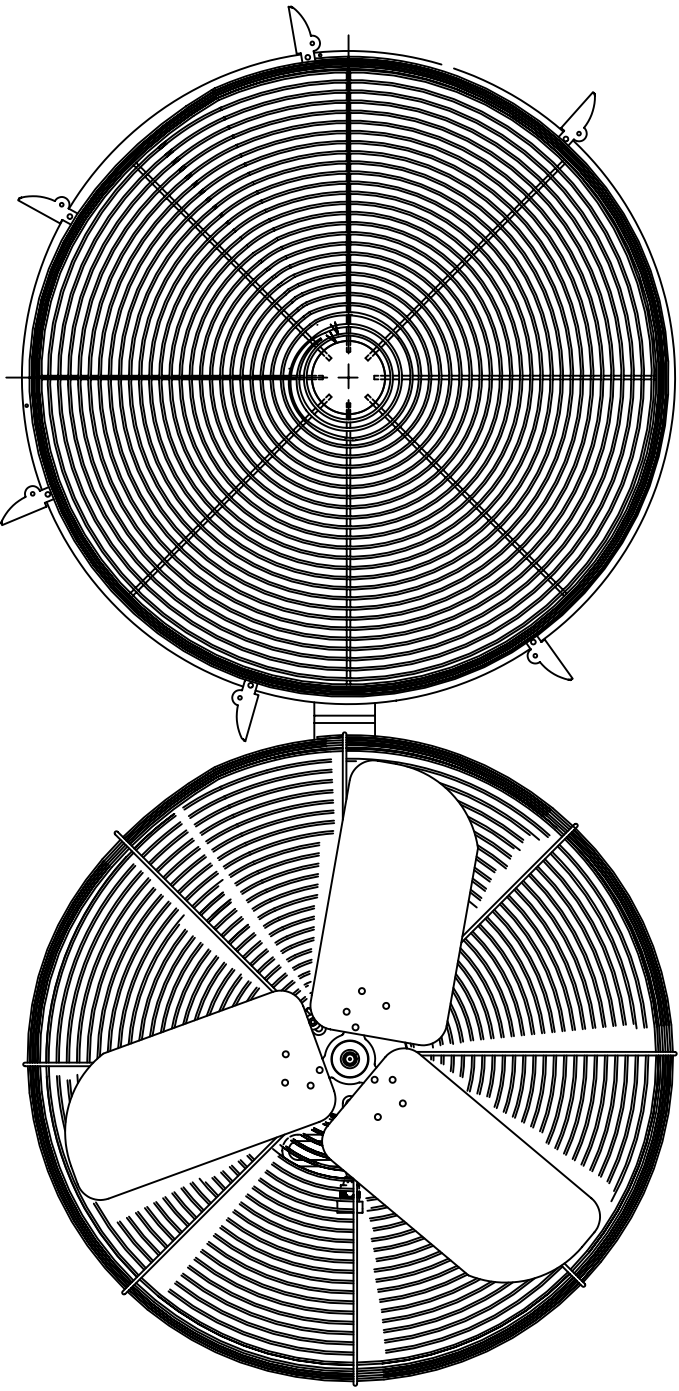

**TPI CORPORATION  
INDUSTRIAL FANS**

**SPECIFICATION SHEET  
HDHJR SERIES**

**EASY ACCESS HINGED GUARD**



**2-SPEED DROP DOWN SWITCH**

SJT VW-1 80° (MIN)  
18AWG/3C (UL), YELLOW MIN  
12" EXTERNAL LENGTH  
TRM-3 PLUG

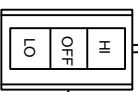

THREE POSITION ROCKER SWITCH  
WITH YELLOW JUNCTION BOX  
12" EXTERNAL LENGTH  
TRM-3M PLUG WITH CONNECTOR CLAMP

**GRILL LOCKING CLAMPS**

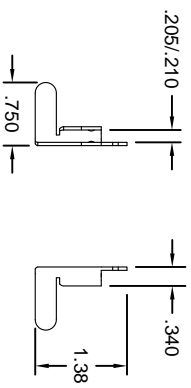

**CLAMP DETAIL**  
MATERIAL: .045 (18 GAUGE) PLATED STEEL

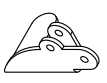

**OPTIONAL ACCESSORIES**

UPC 686334	MODEL	COLOR	OPTIONAL ACCESSORIES	SHIPPING WT (LBS)
796095	HDM-P	YELLOW	HEAVY DUTY PEDESTAL MOUNT	34
796101	HDM-W	YELLOW	HEAVY DUTY WALL MOUNT BRACKET	3
796118	HDM-I	YELLOW	HEAVY DUTY I-BEAM MOUNT BRACKET	9
796125	HDM-C	YELLOW	HEAVY DUTY CEILING MOUNT BRACKET	3
796187	ACM-P	GRAY	PEDESTAL MOUNT	34
796194	ACM-W	GRAY	WALL MOUNT	3
796200	ACM-I	GRAY	I-BEAM MOUNT	9
796217	ACM-C	GRAY	CEILING MOUNT	3
796224	ACM-S	GRAY	SUSPENSION MOUNT	2
874724	RS06-EC	YELLOW	6' EXTENSION CORD USED WITH DROP DOWN POWER SWITCH	1
874731	RS09-EC	YELLOW	9' EXTENSION CORD USED WITH DROP DOWN POWER SWITCH	1.5
874748	RS12-EC	YELLOW	12' EXTENSION CORD USED WITH DROP DOWN POWER SWITCH	2
874755	SCK-12	* * * * *	12" SAFETY CABLE WITH CLAMPS	.5
874762	R1-MOT	YELLOW	1/2HP MOTOR WITH REMOTE SWITCH	1
868181	ACM-PM	BLACK	POLE MOUNT	5
868136	ACM-WK	BLACK	OPTIONAL PEDESTAL WHEEL KIT	4

SUBMITTED BY: \_\_\_\_\_ DATE: \_\_\_\_\_  
 APPROVED BY: \_\_\_\_\_ DATE: \_\_\_\_\_





**TPI CORPORATION  
INDUSTRIAL FANS**

**HDHJR OPTIONAL ACCESSORIES**

**SPECIFICATION SHEET  
HDHJR SERIES**

**SCK-12**

WIRE ROPE MATERIAL: TYPE 304 STAINLESS STEEL  
CONSTRUCTION: 1 X 19 STRAND  
DIAMETER: 3/32"  
LENGTH: 300'  
BREAKING STRENGTH: 1,200LBS.

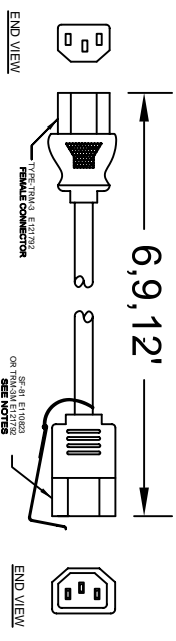

**RS EXTENSION CORD**

**CEILING MOUNT**

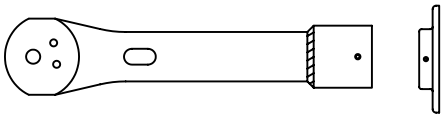

**POLE MOUNT**

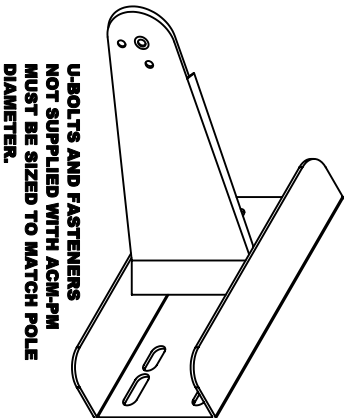

**U-BOLTS AND FASTENERS  
NOT SUPPLIED WITH ACM-FM  
MUST BE SIZED TO MATCH POLE  
DIAMETER.**

**WALL MOUNT**

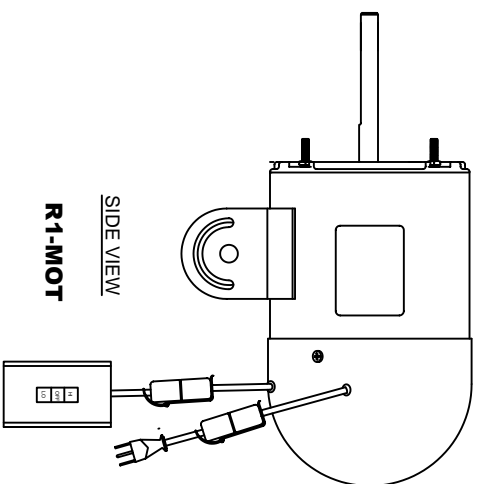
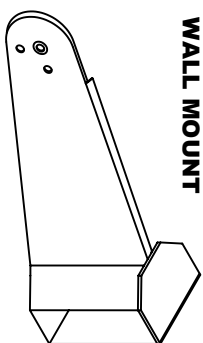

**PEDESTAL  
ADJ HEIGHT  
4 1/2 - 7FT**

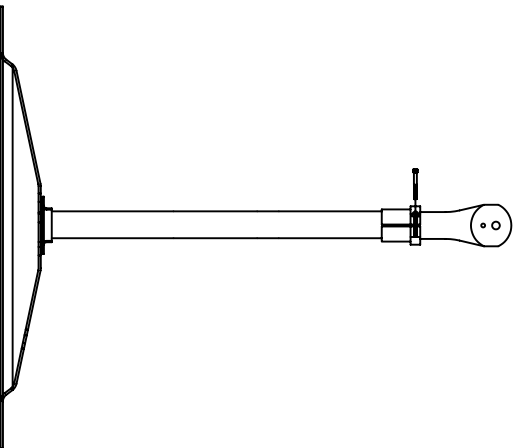

**SUSPENSION MOUNT**

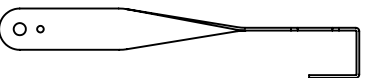

**I-BEAM MOUNT**

