



OWNER'S MANUAL

7-1/2" Electric Lawn Edger

Copyright All Rights Reserved.

Model ED70012S



This product has been engineered and manufactured to our high standard for dependability, ease of operation, and operator safety. Properly cared for, it will give you years of rugged, trouble-free performance.



WARNING: To reduce the risk of injury, the user must read and understand the owner's manual before using this product.

Thank you for your purchase.

DO NOT RETURN THIS PRODUCT TO THE STORE. OPERATING, ASSEMBLY, PARTS, SERVICE QUESTIONS? GO TO SCOTTSS.AMERICANLAWNMOWER.COM OR CALL 1-800-618-7474. BETWEEN 8 AM - 5 PM EST, MONDAY-FRIDAY FOR ASSISTANCE.

SAVE THIS MANUAL FOR FUTURE REFERENCE



IMPORTANT SAFETY WARNINGS



TO REDUCE RISK OF INJURY: Before any use be sure everyone using this product reads and understands all safety instructions and other information contained in this manual.

Save these instructions and review frequently prior to use and in instructing others.



WARNING: When using electric appliances, basic safety precautions should always be followed to reduce risk of fire, electric shock, and personal injury, including the following:

READ ALL INSTRUCTIONS

GENERAL SAFETY

Read the operator's manual carefully. Be thoroughly familiar with the controls and the proper use of the equipment. Know how to stop the lawn edger and disengage the controls quickly.

CHECK FOR DAMAGED PARTS - Before further use of the edger, a guard or other part that is damaged should be carefully checked to determine that it will operate properly and perform its intended function. Check for alignment of moving parts, binding of moving parts, breakage of parts, mounting and any other condition that may affect its operation. Any part that is damaged should be properly repaired or replaced. For assistance call our customer service help line at 1-800-618-7474.

AVOID DANGEROUS ENVIRONMENTS - Don't use this product in damp or wet locations. Do not operate this product in gaseous or explosive atmospheres. Motors in these products may spark, and the sparks might ignite fumes.

Do not allow children or untrained individuals to use the lawn edger.

Clear the work area before each use. Remove all objects such as rocks, broken glass, nails, wire, or string which can be thrown or become entangled in the edger blade.

USE SAFETY GLASSES - Wear safety glasses with side shields or goggles that are marked to comply with ANSI Z87.1 standard when operating this product.

DRESS PROPERLY- Don't wear loose clothing or jewelry and wear protective hair covering to contain long hair. They can be caught in moving parts. Use of rubber gloves and sturdy, nonskid footwear is recommended when working outdoors.

Do not operate the lawn edger when barefoot or wearing open sandals. Always wear safety footwear and pants or slacks that cover your legs.

Always operate the lawn edger from a position to the left of the handle when viewed from the rear.

KEEP CHILDREN AWAY - All visitors, children and pets should stay at least 50 ft. away from the work area.

STAY ALERT - Watch what you are doing and use common sense. Do not use the lawn edger when you are tired or under the influence of drugs, alcohol or medications.

LIGHTING - Only operate the lawn edger in daylight or good artificial light.

Keep firm footing and balance at all times. **DON'T OVERREACH.** Overreaching can result in loss of balance or exposure to the cutting blade. Keep all parts of your body away from any moving part.



DANGER: Rotating cutting blade.

Keep both hands on the handles when blade is rotating.

Keep hands and feet away from the cutting area.

Do not attempt to remove cut material or hold material to be cut when motor is running or when cutting blade is moving.

Make sure the unit is unplugged when clearing jammed material from the cutting blade.

Keep guards in place.

Keep the blade area clean. Replace dull blades as needed.

Before landscaping or trenching, check for buried electrical cables.



CAUTION: Cutting blade coasts after edger is turned off.

Unplug the lawn edger before making any adjustments or repairs. Wear protective equipment and observe all safety instructions. After the lawn edger is turned off, make sure the cutting blade has stopped before setting the unit down.

Inspect the lawn edger before each use for damage or loose fasteners. Make sure all fasteners are secure and replace any damaged parts before use.

Do not, under any circumstance, use an attachment or accessory on the product which was not provided with the product or identified as appropriate for use with this product in the operator's manual.

Do not operate this product in the rain.

GENERAL SAFETY

If the lawn edger vibrates abnormally, immediately stop the motor and check for the cause. Abnormal vibration is generally a warning of trouble.

Before cleaning, repairing, or inspecting, shut off the motor and make sure all moving parts have stopped. Service on the product must be performed by qualified individuals only. Service or maintenance performed by unqualified personnel could result in injury to the user or damage to the product.

WARNING: To avoid electric shock use only identical replacement parts when servicing a tool with double insulation. Use of unauthorized parts may create a risk of serious injury to the user or damage to the product.

POLARIZED PLUGS-To reduce the risk of electric shock, this product has a polarized plug (one blade is wider than the other) and will require the use of a polarized extension cord. The plug will fit into a polarized extension cord only one way. If the plug does not fit fully into the extension cord, reverse the plug. If it still does not fit, obtain a correct, polarized extension cord. A polarized extension cord will require the use of a polarized wall outlet. This plug will fit into the polarized wall outlet only one way. If the extension cord does not fit fully into the wall outlet, reverse the plug. If the plug still does not fit, contact a qualified electrician to install a proper wall outlet. Do not change the plug on the tool or the extension cord in any way.

Avoid body contact with grounded surfaces such as pipes, radiators, ranges, and refrigerators. There is an increased risk of electric shock if your body is grounded.

WARNING: To avoid electric shock do not use in wet or damp areas or expose to rain. Water entering a power tool will increase the risk of electric shock.

WARNING: Keep all connections dry and off the ground. Do not touch the plug with wet hands.

WARNING: Use outdoor extension cords marked SW-A, SOW-A, STW-A, STOW-A, SJW-A, SJTW-A, or SJTOWA. These cords are rated for outdoor use and reduce the risk of electric shock.

STORE IDLE UNIT INDOORS-When not in use, the edger should be stored indoors in a dry and high or locked up area out of reach of children.

Turn off lawn edger before unplugging.

Do not use the edger if the switch does not turn it on or off. Any tool that cannot be controlled with the switch is dangerous and must be repaired.

Do not use the edger if it has been left outdoors or dropped in water.

Do not leave the tool unattended when it is plugged in. Unplug from the power source when not in use, before servicing, changing accessories, and before storing the tool. Such preventative safety measures reduce the risk of starting the tool accidentally.

DON'T ABUSE CORD -Never carry this product by the cord or yank the cord to disconnect from the receptacle. Keep cord from heat, oil, and sharp edges. Keep the cord away from the cutting blade.

For household use only.

GROUND FAULT CIRCUIT INTERRUPTER (GFCI) protection should be provided on the circuit or outlet to be used for the edger. Receptacles are available having built-in GFCI protection and may be used.

Avoid Unintentional Starting -Don't carry plugged in edger with your finger on the switch. Be sure switch is off when plugging in.

Don't grasp the exposed cutting blade when picking up or holding the edger.

Don't Force Edger -It will do the job better and with less likelihood of a risk of injury at the rate for which it was designed.

Maintain Edger with Care -Keep sharp cutting edge clean for best performance and to reduce the risk of injury. Follow instructions for lubricating and changing accessories. Inspect edger cord periodically, and if damaged, have it repaired by a qualified individual.

Keep handles dry, clean, and free from oil and grease.

Do not use the edger for any job except that for which it is intended.

EXTENSION CORD. Make sure your extension cord is in good condition. When using an extension cord be sure it is heavy enough to carry the current your product will draw. An undersized extension cord will cause a drop in line voltage resulting in loss of power and overheating. The following table shows the correct size to use.

| Volts | Minimum Gage for Cord Sets | | | | |
|---------------|------------------------------|--------------------|--------------|-----------------|----|
| | Total Length of cord in Feet | | | | |
| 120V | 0-25 | 26-50 | 51-100 | 101-150 | |
| | (0-7.6m) | (7.6-15.2m) | (15.2-30.4m) | (30.4-45.7m) | |
| 240V | 0-50 | 51-100 | 101-200 | 201-300 | |
| | (0-15.2m) | (15.2-30.4m) | (30.4-60.9m) | (60.9-91.4m) | |
| Ampere Rating | | American wire Gage | | | |
| More Than | Not More Than | | | | |
| 0 | - 6 | 18 | 16 | 16 | 14 |
| 6 | - 10 | 18 | 16 | 14 | 12 |
| 10 | - 12 | 16 | 16 | 14 | 12 |
| 12 | - 16 | 14 | 12 | Not Recommended | |

It is possible to tie two extension cords together in a knot to prevent them from becoming disconnected during use. Make the knot as shown, then connect the plug end of the power cord into the receptacle end of the extension cord.



GENERAL SAFETY

Be aware of the extension cord while operating the edger. Be careful not to trip on the cord. Always keep the cord away from the cutting blade.



DOUBLE INSULATION – The lawn edger has double insulation. This means that all external metal parts are insulated from the electrical supply. This is achieved by introducing an insulation layer between electrical and mechanical parts. The double insulation guarantees you the greatest possible safety. No grounding means is provided on a double insulated appliance, nor should a means for grounding be added.



WARNING: To avoid electric shock use only identical replacement parts when servicing a tool with double insulation. Servicing a double insulated appliance requires extreme care and knowledge of the system and should be done only by a qualified technician.

Be sure all guards are properly and securely attached.



CAUTION: Replace dull or worn blade; do not attempt to sharpen. Failure to heed this warning could result in excessive vibration causing serious personal injury or property damage.

Use this edger for edging along sidewalks, driveways, and flower beds. Do not use for any other purpose.

Do not use the edger on or near graveled surfaces.

If the edger strikes any type of foreign object, stop the edger, disconnect from the power supply and inspect for damage. Repair or replace any damaged part before any further use of the edger.

Inspect the area you are edging for uneven sidewalks, holes in the terrain, and other hazardous conditions. Objects can break off and become dangerous projectiles. Always push the edger slowly over rough ground.

Never direct discharged material toward bystanders. Do not direct the discharge towards people or areas where property can be damaged. Keep children, pets and others away from the work area.

Do not attempt to remove cut material or hold material to be cut when the motor is running or while the cutting blade is moving. Always stop the edger and disconnect from the power supply before attempting to remove any obstruction caught or jammed in the blade or when making adjustments.

Always keep your right hand on the rear handle and your left hand on the auxiliary handle when the blade is rotating.

Never stand or have any part of your body in line with the path of the edger blade.

A coasting blade can cause injury while it continues to spin after the motor is stopped or trigger is released. Maintain proper control until the blade has completely stopped rotating.



WARNING: California Proposition 65 Warning:

This product contains chemicals known to the State of California to cause cancer, birth defects or other reproductive harm.



WARNING: Some dust and debris created by the use of this tool could contain chemicals known to the State of California to cause cancer and birth defects or other reproductive harm. Some examples of these chemicals are:

- chemicals in fertilizers
- compounds in insecticides, herbicides, and pesticides
- arsenic and chromium from chemically treated lumber

Your risk from exposure to these chemicals varies, depending on how often you do this type of work. To reduce your exposure, work in a well ventilated area and with approved safety equipment such as dust masks that are specially designed to filter out microscopic particles.



WARNING: Cancer and Reproductive Harm - www.P65Warnings.ca.gov.

CHILD SAFETY:

Tragic accidents can occur if the operator is not aware of the presence of children.

Keep children out of the work area and under the watchful care of a responsible adult.

Do not allow children to operate the edger.

Stay alert, and turn the edger off if a child or any other person enters the work area.

Look behind and downward for small children before and while moving backwards.

Use extreme care when approaching blind corners, doorways, shrubs, trees, or other objects that may obscure your view of a child who may run into the path of the edger.

PRODUCT SPECIFICATIONS

Model: ED70012S

Power supply voltage: 120V-60HZ
 Power consumption: 11 Amp
 Blade diameter: 7.7 inch (195 mm)
 3 cutting settings: 1 inch / 1.25 inch / 1.5 inch
 Speed: 4700 RPM
 Weight: 14 pounds

| # | Description | Qty |
|----|-------------------------|-----|
| 1 | Power Cord | 1 |
| 2 | Safety lock button | 1 |
| 3 | Trigger | 1 |
| 4 | Upper handle | 1 |
| 5 | Auxiliary handle | 1 |
| 6 | Wing nuts | 2 |
| 7 | Rear wheel | 2 |
| 8 | Base | 1 |
| 9 | Motor housing | 1 |
| 10 | Lock nut M10 | 1 |
| 11 | Spacer | 2 |
| 12 | Blade | 1 |
| 13 | ST4.2X30 screws | 3 |
| 14 | Blade guard | 1 |
| 15 | Front wheel | 1 |
| 16 | Depth adjustment knob | 1 |
| 17 | Curved head bolt(M6X50) | 2 |
| 18 | ST4.2X20 screws | 4 |

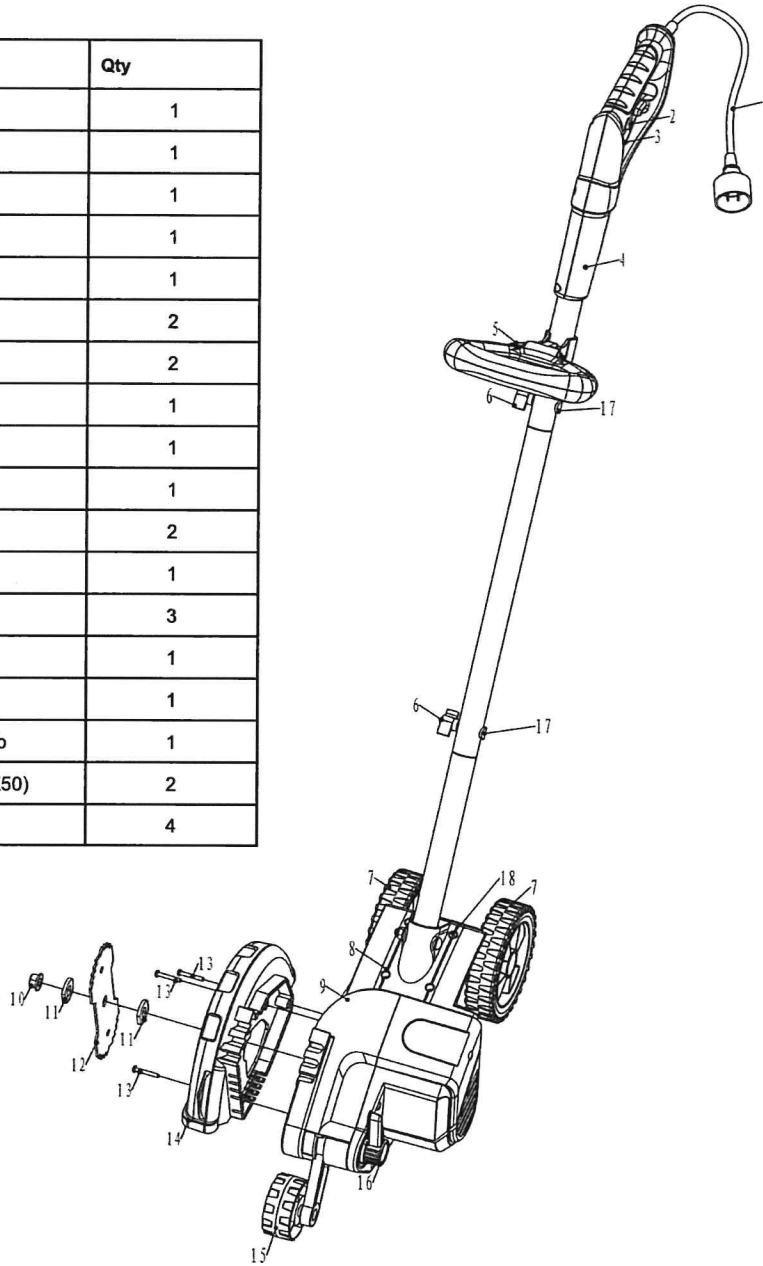

ASSEMBLY

UNPACKING

The edger must be assembled before use. When removed from the box, the handle sections are connected by an electrical cord and must be assembled.

Carefully remove everything from the box. Make sure that all items listed in the packing list are included.

Do not discard the packing material until you have carefully inspected and satisfactorily operated the edger

PACKING LIST

- 1 Edger
- 1 Auxiliary handle
- 2 Wingnuts and M6X50 curved head bolts for upper handle tube and lower handle tube
- 1 Knob and M6X45 bolt for auxiliary handle
- 4 ST4.2X20 Self-tapping screw
- 1 Manual

Assembling the Pole Handle

- Remove protective packing material from tube ends and discard.
- Assemble the top handle to the middle handle section with the label facing up.
- Slide upper handle tube down onto the middle handle tube so that the holes are aligned.
Ensure the power cable moves smoothly down into the middle handle tube while assembling.
- Fasten handle tubes together with curved head M6*50 bolt and wingnut as shown in illustration (b). Note that when you first insert the bolt it may be necessary to wiggle it carefully to get it past the jacketed wire inside the tube.
- Repeat this process to attach the middle handle tube to the lower handle tube. See illustration (c).



CAUTION: NEVER use a sharp object to move the jacketed wires out of the way.

WARNING: Failure to lock handle tubes as directed above could result in serious injury or death.

Assembling The Auxiliary Handle

- The edger must be assembled before use. When removed from the box, the auxiliary handle is disassembled.
- Position auxiliary handle into the bracket as shown in illustration (a), making sure the holes are aligned.
- Insert M6X45 bolt through the hex shaped recess in the bracket and secure with handle knob.
- Adjust handle to the desired angle, then fully tighten.

Assembling The Pole To The Edger Body

- Insert the male plug from the lower handle into the female plug on the body of edger as shown in illustration (d).
- Place the base at the bottom of the handle onto the body and secure with the (4) screws provided.

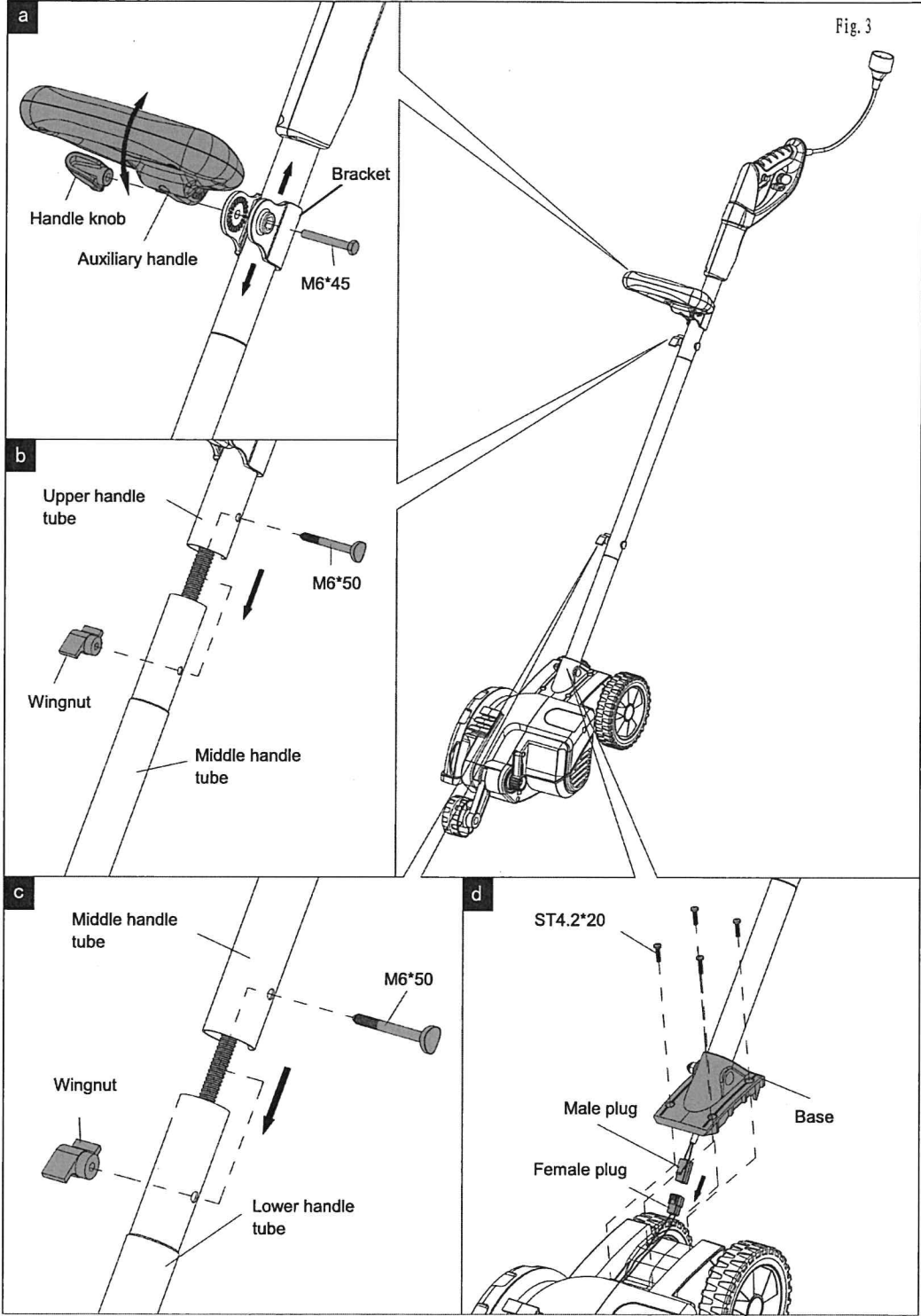

OPERATING

Before starting the edger, line up the tool so the blade cut line indicator is aligned with the edge of the paved surface. Both rear wheels should be on the paved surface when edging.

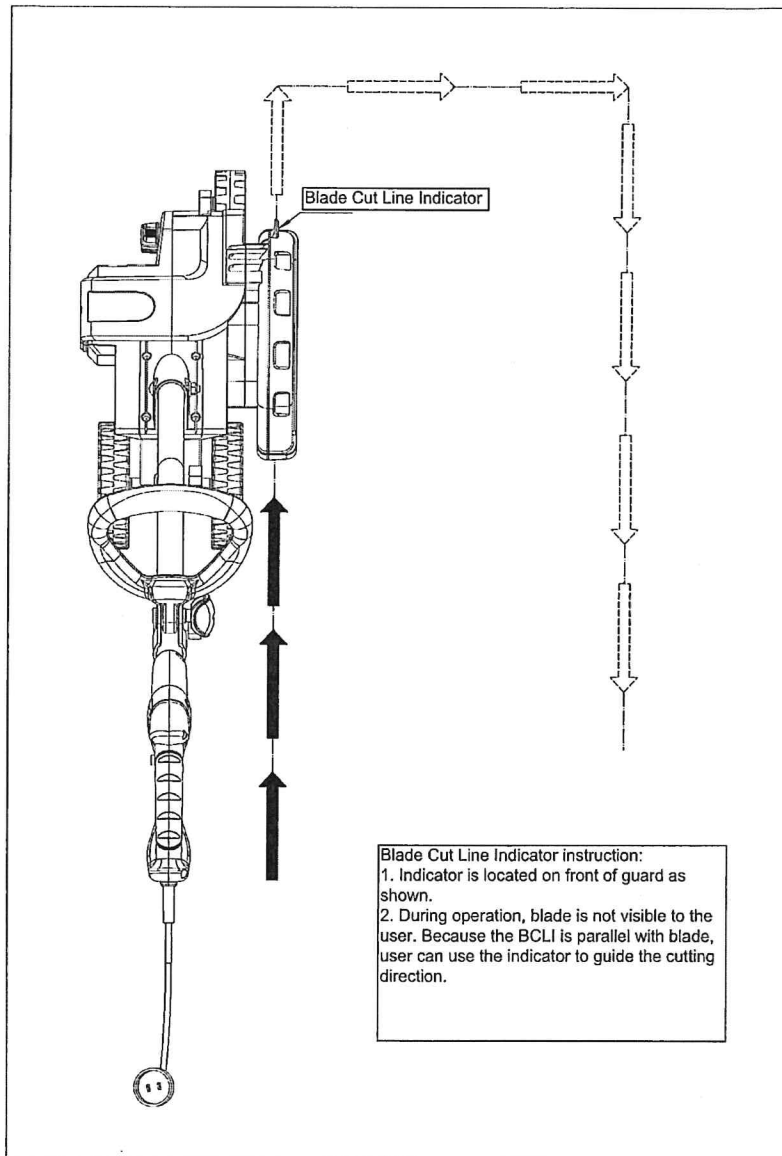

CUT DEPTH ADJUSTMENT

 **DANGER: UNPLUG TOOL! WAIT FOR BLADE TO COME TO COMPLETE STOP**

The front wheel can be adjusted to allow a deeper or shallower cut, and to increase the life of the blade. Change the cut depth from the shipping position to your desired depth by:

1. Wait for blade to come to complete stop!
2. UNPLUG TOOL!
3. Rotate the Depth Adjustment Lever.
4. Adjust wheel depth to one of three positions.

- NOTE: Recommend 1 in. depth for edging.**
5. Release Depth Adjustment Lever to lock position.

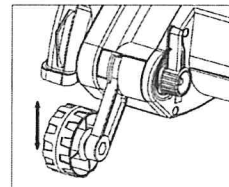

OPERATING

TO TURN THE EDGER ON

Your lawn edger is equipped with a safety lock off button to prevent accidental operation of the tool.

To start the lawn edger, depress the safety lock button (2) and pull the trigger (3) firmly.

Release the safety lock button when motor is engaged. Continue to pull the trigger to maintain power to the unit. To stop the lawn edger, release the trigger.

Ensure when starting the lawn edger that the blade is not in contact with any surface.

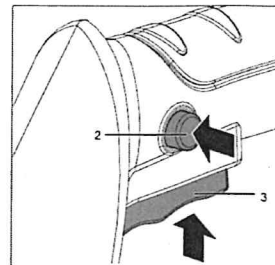

To avoid kickback of edger, tilt the handle down so the blade is above the ground surface. Slowly lift handle to lower the blade, finding the edge of the paved surface and start edging. Then move the tool forward slowly along edge of paved surface. During edging some sparks may be generated from hitting stones. This is normal. For electrical safety and to prevent clogging of the blade guard, do not attempt to edge when the grass or soil is wet or damp. If blade guard becomes clogged, release trigger, wait for blade to come to complete stop. **UNPLUG TOOL!** Remove clogged material with a stick. Do not attempt to unclog the blade guard by tapping the tool on the ground. This can damage the unit. Keep hands clear of blade when cleaning as the blade will wear to a sharp point during edging.

Cord routing

Always make sure that you route the cord away from the work area to prevent it from coming near the blade of the lawn edger. Lay your cable route before starting work.

Start your lawn edger at the point nearest to the electrical socket, and then move away while working. This will mean that the cord will be pulled through the area that has already been cut, thereby keeping it out of danger of being cut through by the blade.

Cord Restraint

Your lawn edger has a cord retainer to prevent the power cords from being disconnected.

It is recommended the cord retainer is used as follows: Approx. one (1) foot (300mm) from the end of the extension cord, form a tight loop in the extension cord, and feed the loop through the square hole beneath the handle.

Place the loop over the retainer hook in the handle to prevent the cord from pulling back through the square hole. Gently pull the cord to ensure it is firmly retained.

Changing the Blade

WARNING: Before performing any maintenance or adjustments ensure the power cord has been totally disconnected from the main power supply.

1. Lay edger on its side with the blade facing up.
2. Remove the lock nut, spacer and the blade. Ensure the shaft and inner spacer are free of any dirt, etc.
3. Install the new blade and spacer. Install the lock nut and tighten firmly.
4. After the blade is secure, rotate the blade by hand to ensure the blade is not making contact with any components of the edger.

Cleaning

CAUTION: Use only mild soap and a damp cloth to clean the lawn edger.

Never allow any liquid to get inside the lawn edger. Never immerse any part of the lawn edger into a liquid.

BLADE

DANGER: UNPLUG TOOL! WAIT FOR BLADE TO COME TO COMPLETE STOP

The blade, two spacers and hex head nut with conical washer should be attached to your edger in the order shown. Please check that the blade has been properly mounted before using your edger. When the blade wears to the small hole at each end of the blade it will give only 1/4 in. depth of cut and should be replaced.

Tip: To increase blade life, keep initial cutting depth at minimum and increase depth setting as blade wears.

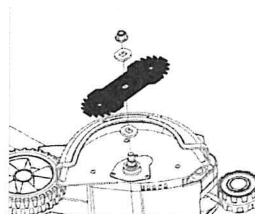

OPERATING

NOTE: The edger is a major appliance and should not be operated simultaneously with other major appliance on the same household circuit. For the first edging each season, it is best to move forward slowly because grass is thickest then. Subsequent edging will be completed more rapidly. If the tool slows down, back it up an inch or two until the blade comes up to normal speed. Do not attempt to edge when the grass or soil is wet or moist, for electrical safety and to prevent clogging of the blade chamber. If you must edge under conditions that cause the blade chamber to become clogged, release trigger, wait for blade to come to complete stop! UNPLUG TOOL! Open door and remove clogged material with a stick. To continue to operate the tool in a clogged condition will seriously overload the motor.

 **CAUTION:** Do not attempt to unclog the blade guard by dropping or tapping the tool on the ground. This can damage the unit. Keep hands clear of blade when cleaning as it will wear to a very sharp point during edging.

STORAGE

 **WARNING:** Be sure lawn edger is unplugged.

 **CAUTION:** Do not hang edger on switch trigger or power cord.

Note: Do not store the tool on or adjacent to fertilizers or chemicals. Such storage can cause rapid corrosion.

PREVENTING CORROSION

Fertilizers and other garden chemicals contain agents that greatly accelerate the corrosion of metals. If you use the tool in areas where fertilizers or chemicals have been used, the tool should be cleaned immediately afterwards. Wipe all exposed parts with a damp cloth. You may lubricate only metal parts with a light petroleum based oil. When cleaning, DO NOT immerse tool in water or squirt it with a hose.

| TROUBLESHOOTING | | |
|------------------------|----------------------------|---|
| Problem | Possible Cause | Possible Solution |
| Unit will not start | Cord not plugged in. | Plug tool into a working outlet. |
| | Circuit fuse is blown. | Replace circuit fuse. (If the product repeatedly causes the circuit fuse to blow, discontinue use immediately and have it serviced.) |
| | Circuit breaker is tripped | Reset circuit breaker. (If the product repeatedly causes the circuit breaker to trip, discontinue use immediately and have it serviced) |
| | Cord or switch is damaged | Have cord or switch replaced. |

PARTS AND SERVICE

For parts or service, please call 1-800-618-7474 or visit us online at scotts.americanlawnmower.com. Be sure to provide all relevant information when you call or visit.

REPAIR PARTS (KITS/ ITEMS)

The model number of this tool is found on a plate or label attached to the housing. Please record the serial number in the space provided below.

MODEL NUMBER ED70012S

SERIAL NUMBER _____

Always mention the model number when ordering kits/items for this tool.

| No. | Kit/ Item Number | Description |
|-----|------------------|---------------------|
| 1 | ED-BK | Blade & hardware |
| 2 | ED-HHK | Handle hardware kit |
| 3 | ED-WK | Wheels & hardware |

CALL US FIRST

Call us first with questions about operating or maintaining your Electric Lawn Edger at 1-800-618-7474 between 8:00 a.m. - 5:00 p.m. Eastern Standard Time, or get assistance on scotts.americanlawnmower.com.



OWNER'S MANUAL

ED70012S 7-1/2" Electric Lawn Edger

Copyright All Rights Reserved.

WARRANTY

Scotts Warranty policy

- **3 Year limited warranty** on all Scotts corded power tools from date of purchase when used for personal, household, or family use.

The Great States Corp. (GSC) warrants to the original owner that this Scotts product and service part is free from defects in materials and workmanship and agrees to repair or replace any defective product or part for the warranty period as stated above

- Warranty voided if used for commercial or industrial purposes or any other improper use as determined by GSC.
- Warranty does not include repairs necessary due to operator's abuse or negligence (including overloading the product beyond capacity or immersion in water), or the failure to assemble, operate, maintain or store the product according to the instructions in the owner's manual.
- This warranty does not cover
 - Wear items, including but not limited to - drive belts & gears, tines, cutting blades, mower blades, saw chains, mulching blades, blower fans, spool covers, trimmer line, blower and vacuum tubes, guide bars, high pressure hoses, wheels, handles, augers, worn bags, power cables, and other items subject to wear over time.
 - Wear on batteries, including but not limited to - drops, wear and breakage on charger, exposure to extreme temperature swings (hot or cold), battery left on charger too long, battery left uncharged for too long, and misuse or abuse of the battery.
- This warranty does not cover damage caused by cold, heat, rain, excessive humidity or other environmental extremes.
- This warranty does not cover normal deterioration of the exterior finish or normal wear and tear on the products including, but not limited to scratches, cracks, dents, or damage caused by outside chemicals.
- This warranty is not transferable and only applies to new products sold directly from an authorized retailer. This warranty does not apply to any product, new or used, purchased through unauthorized third-party channels. For information on authorized dealers, contact our customer support hotline at 1-800-618-7474 (Mon-Fri 8am-5pm Est)
- Any incidental, indirect or consequential loss, damage, or expense that may result from any defect or malfunction of the products is not covered by the warranty.
- The warranty does not include installation, assembly or normal adjustments explained in the operator's manual. The expense of delivering the product to the vendor and the expense of returning the product or replacement parts to the owner is not covered by the warranty.

Additional Warranty Limitations

Some states do not allow the exclusion or limitation on how long an implied warranty lasts, so the above limitation may not apply to you. Products sold damaged or incomplete, sold —as is, or sold as reconditioned are not covered under the warranty. Damage or liability caused by shipping, improper handling, improper assembly, incorrect voltage, improper wiring, improper maintenance, improper modification or the use of accessories and/or attachments not specifically recommended is not covered by this warranty.

Proof of purchase, original dated sales receipt, must accompany all warranty claims.

For claims go to scotts.americanlawnmower.com or call our customer support hotline from 8am-5pm EST, Mon-Fri at 1-800-618-7474



American Lawn Mower Company
The Great States Corporation
7444 Shadeland Station Way,
Indianapolis, IN 46256

In a continued commitment to improve quality, the Manufacturer reserves the right to make component changes or design changes when necessary.