

ironton[®]

3 -Tier Industrial Shelving Unit

Owner's Manual



Item# 73290

READ & SAVE THESE INSTRUCTIONS

Thank you very much for choosing an Ironton product!

For future reference, please complete the owner's record below:

Serial Number/Lot Date Code (if applicable): _____

Purchase Date: _____

Save the receipt, warranty, and this manual. It is important that you read the entire manual to become familiar with this product before you begin using it.

This product is designed for certain applications only. Northern Tool and Equipment is not responsible for issues arising from modification or improper use of this product such as an application for which it was not designed. We strongly recommend that this product not be modified and/or used for any application other than that for which it was designed.

For technical questions, please call **1-800-222-5381**.

Table of Contents

Intended Use	4
Packaging Contents	4
Technical Specifications	4
Important Safety Information	4
Specific Operation Warnings	6
Main Parts of Product	6
Assembly Instructions	7
Operating Instructions	11
Maintenance	11
Troubleshooting	11
Parts Diagram	12
Parts List	12
Replacement Parts	13
Limited Warranty	13

Intended Use

The Ironton 3-Tier Industrial Shelving Unit (77x72x24 in.) is a storage unit with a welded steel frame offering industrial-strength storage. Four mesh decks allow air circulation around stored items. The rack can stand individually, or for greater stability, be joined together using the common upright frame. The rack has an 8000-lb. total capacity.

Packaging Contents

- Uprights (2)
- Cross Beams (6)
- Beam Strap (9)
- Welded Wire Mesh (3)
- Lock Pin (12)
- M6 Allen Button Bolt (18)
- Pan Philip Self-Taping Screw (2)
- Plastic Dry Wall Anchor (2)
- Flat Washer M5 (2)

Technical Specifications

Property	Specification
Rack Dimensions	77 in x 24 in x 72 in.
Maximum Load Capacity per Shelf	2000 lb. evenly distributed
Upright Frame Dimensions	24 in x 72 in
Shelf Depth	24 in
Shelf Material	Wire Deck

Important Safety Information

⚠️WARNING

- Read and understand all instructions. Failure to follow all instructions may result in serious injury or property damage.
- The warnings, cautions, and instructions in this manual cannot cover all possible conditions or situations that could occur. Exercise common sense and caution when using this tool. Always be aware of the environment and ensure that the tool is used in a safe and responsible manner.
- Do not allow persons to operate or assemble the product until they have read this manual and have developed a thorough understanding of how it works.
- Do not modify this product in any way. Unauthorized modification may impair the function and/or safety and could affect the life of the product. There are specific applications for which the product was designed.
- Use the right tool for the job. DO NOT attempt to force small equipment to do the work of larger

industrial equipment. There are certain applications for which this equipment was designed. It will be a safer experience and do the job better at the capacity for which it was intended. DO NOT use this equipment for a purpose for which it was not intended.

- Industrial or commercial applications must follow OSHA requirements.

⚠WARNING

PROP 65

- This Package can expose you to chemicals including lead, which is known to the State of California to cause cancer. For more information, go to www.P65warnings.ca.gov.

⚠WARNING

WORK AREA SAFETY

- Inspect the work area before each use. Keep work area clean, dry, free of clutter, and well-lit. Cluttered, wet, or dark work areas can result in injury. Using the product in confined work areas may put you dangerously close to cutting tools and rotating parts.
- Keep children and bystanders away from the work area while operating the tool. Do not allow children to handle the product.

⚠WARNING

PERSONAL SAFETY

- Stay alert, watch what you are doing, and use common sense when operating the tool. Do not use the tool while you are tired or under the influence of drugs, alcohol, or medication. A moment of inattention while operating the tool may result in serious personal injury.
- Dress properly. Do not wear loose clothing, dangling objects, or jewelry. Keep your hair, clothing and gloves away from moving parts. Loose clothes, jewelry, or long hair can be caught in moving parts. Air vents on the tool often cover moving parts and should be avoided.
- Wear the proper personal protective equipment when necessary. Use ANSI Z87.1 compliant safety goggles (not safety glasses) with side shields, or when needed, a face shield. Use a dust mask in dusty work conditions. Also use non-skid safety shoes, hardhat, gloves, dust collection systems, and hearing protection when appropriate. This applies to all persons in the work area.
- Do not overreach. Keep proper footing and balance at all times.

⚠CAUTION

SHELVING RACK USE AND CARE

- Do not force the rack. Products are safer and do a better job when used in the manner for which they are designed. Plan your work and use the correct product for the job.
- Check for damaged parts before each use. Carefully check that the product will operate properly and perform its intended function. Replace damaged or worn parts immediately. Never operate the product with a damaged part.
- Store the product when it is not in use. Store it in a dry, secure place out of the reach of children. Inspect the tool for good working condition prior to storage and before re-use.
- Use only accessories that are recommended by the manufacturer for use with your product. Accessories that may be suitable for one product may create a risk of injury when used with another tool. Never use an accessory that has a lower operating speed or operating pressure than the tool itself.

Specific Operation Warnings

⚠WARNING

- Do not exceed 2000 lbs. per shelf; distribute weight evenly.
- Install on a level surface; secure to the wall for stability.
- Keep away from children; not a climbing structure.
- Follow assembly instructions; improper setup may cause failure.

Main Parts of Product

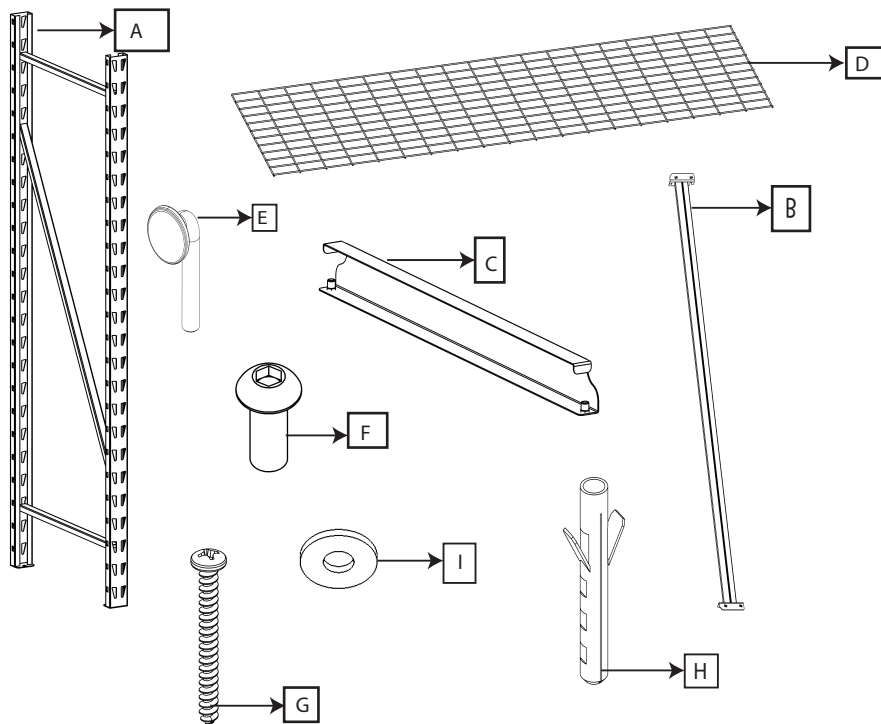

	DESCRIPTION	QUANTITY
A	Upright	2
B	Crossbeam	6
C	Beam strap	9
D	Welded wire mesh	3
E	Lock pin	12
F	M6 Allen button bolt	18
G	Pan Philip self-taping screw	2
H	Plastic Dry wall anchor	2
I	Flat washer m5	2

Assembly Instructions

⚠WARNING

- This shelving rack must be placed on a level surface. Failure to do so can result in unit failure, poor product performance, or a possible tipping safety hazard.

Figure 1

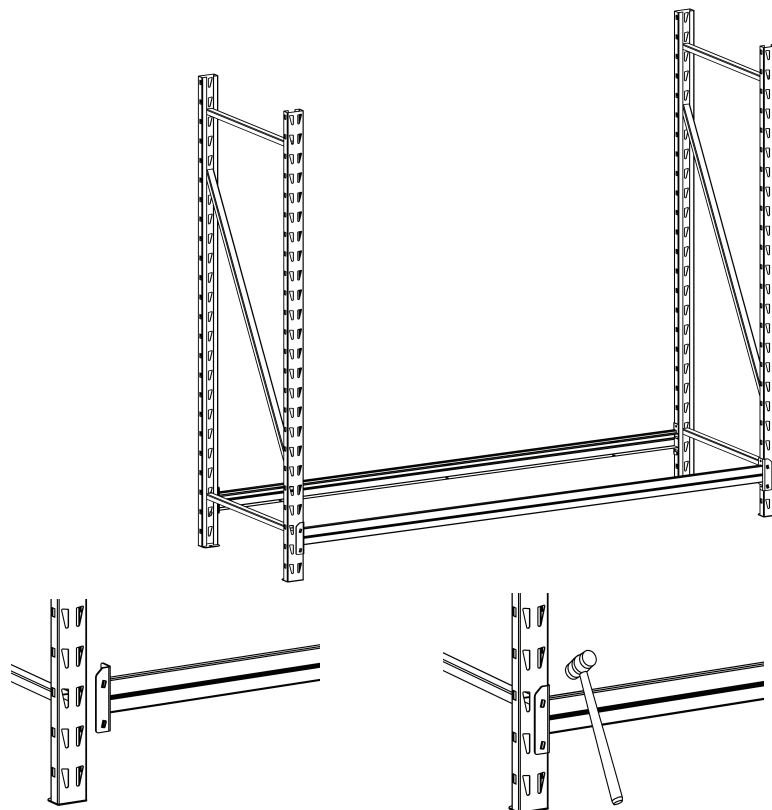

- ❖ Attach the beams to the uprights (see Figure 1), starting at the bottom shelf by using both end frames to establish the left and the right sides of the unit.

- ❖ After placing a cross beam in both upright slots, align Insert locking pins into the holes located on the mounting slot of each cross beam (see Fig. 2). Repeat for all Cross Beams, ensuring pins are properly fastened for stability.

Figure 2

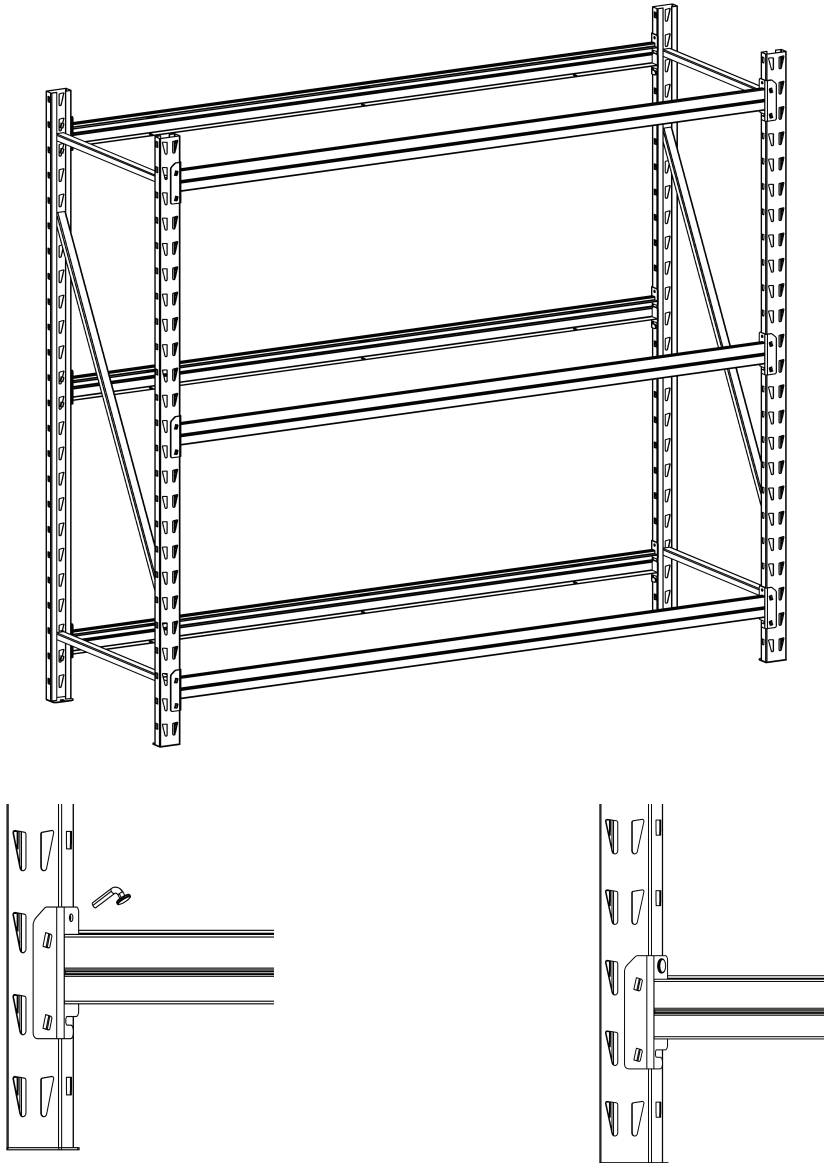

- ❖ Assemble each shelf sequentially from the bottom to the top, completing both the front and back sections.
- ❖ If the base beam tabs are bent due to mishandling, adjust them back to their original form.
- ❖ Ensure the completed rack has four levels evenly spaced for maximum stability. While beam heights can be adjusted, maintain even spacing to preserve unit stability.
- ❖ Use cross beams to support heavy loads. Align the obround holes on the cross beams with those on the inside bottom edge of the beams and secure them.

Figure 3

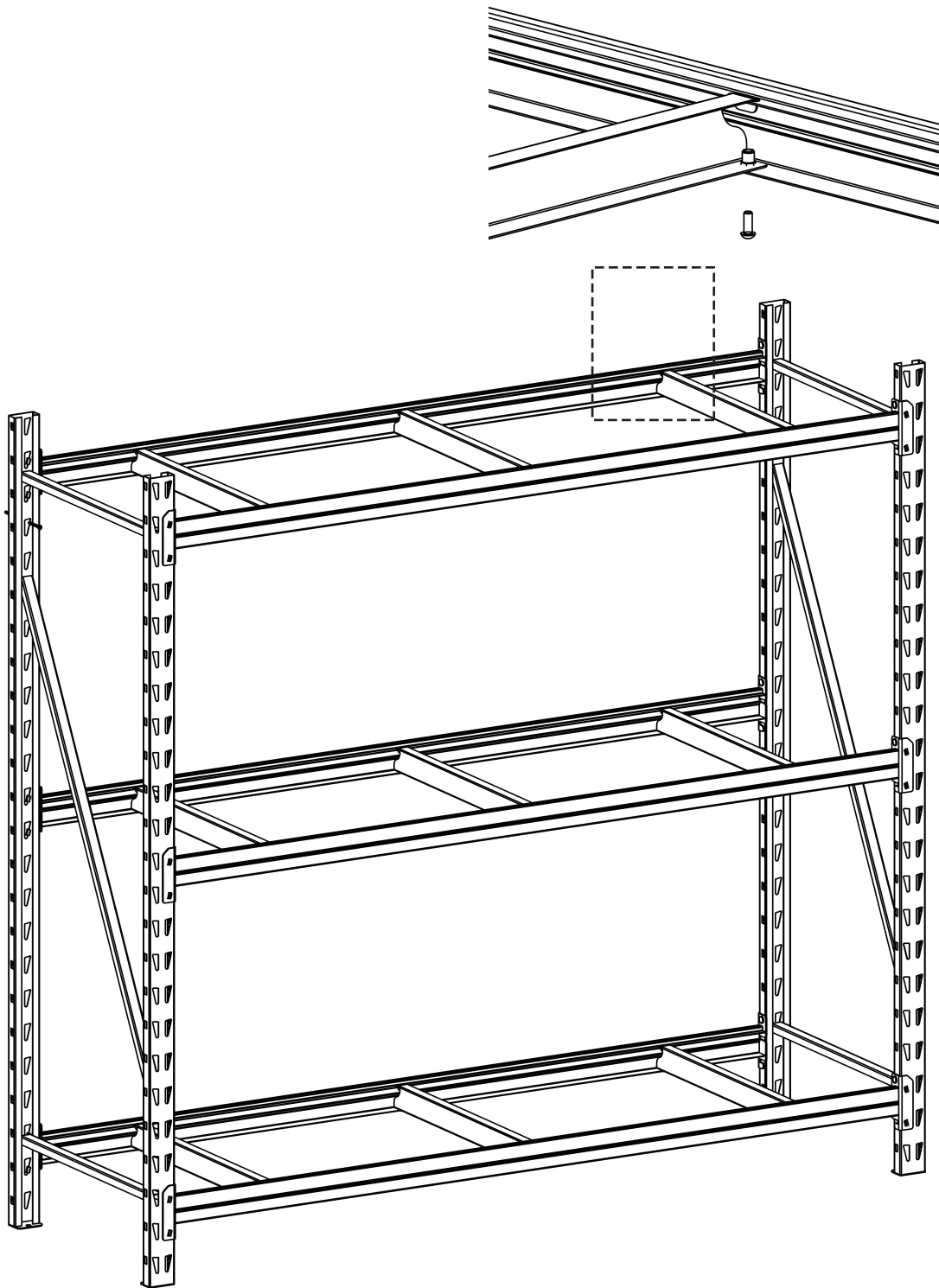

- ❖ Insert the beam strap pin into the cross beam with slight alignment Follow the same process to install the balance of the beam strap at respective locations and align Insert M6 Bolt.

- ❖ After all Beam straps and cross beams are in place, place a wire deck into each shelf (see Figure 4).

Figure 4

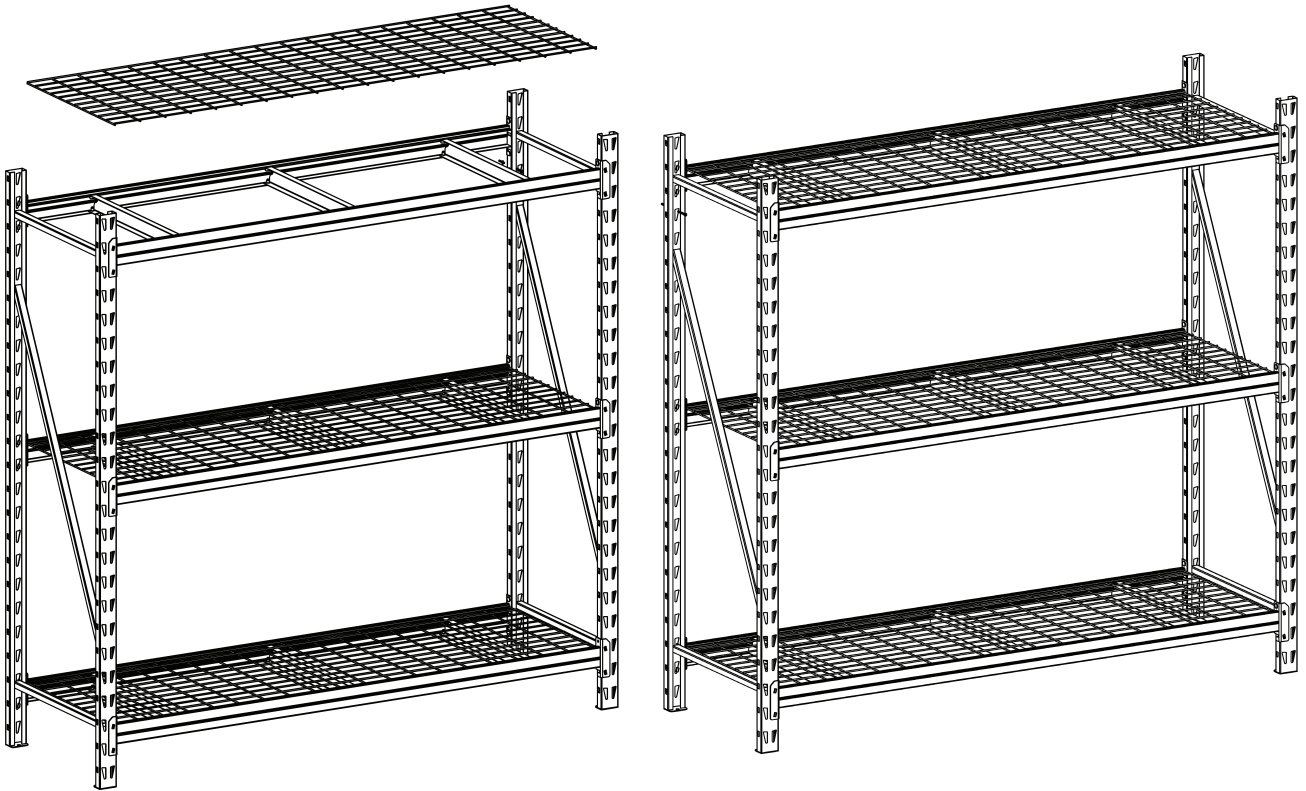

- ❖ Secure 2 rear uprights against the wall by mounting the wall anchoring fasteners as shown (Fig.5)

Figure 5

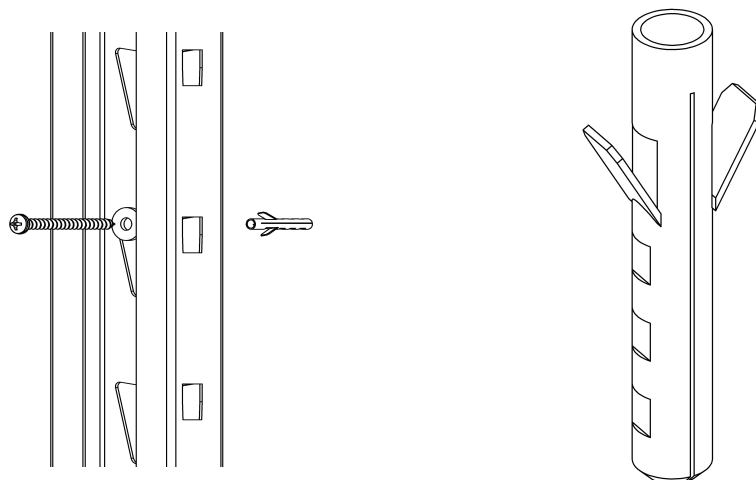

Operating Instructions

⚠️ WARNING

- Do not exceed the rated load capacity per shelf.
- For use on a hard, level surface.
- Do not climb or use the shelf as a ladder.
- To prevent the shelf from tipping, evenly distribute the weight on each shelf and keep the heaviest loads on the bottom shelf.

Maintenance

- To avoid rusting, keep the unit out of damp or wet environments.
- If shelves become damp, wipe with a cloth to avoid rusting. Be sure to dry the shelf joints.

Troubleshooting

Failure	Possible Cause	Corrective Action
The shelf is bent.	Shelf is overloaded.	Unload the shelf and reload, staying under 2000 lb. per shelf.
The shelf has a rusty surface.	The shelf has moisture creating rust.	Repaint the rusted surface.

Parts Diagram

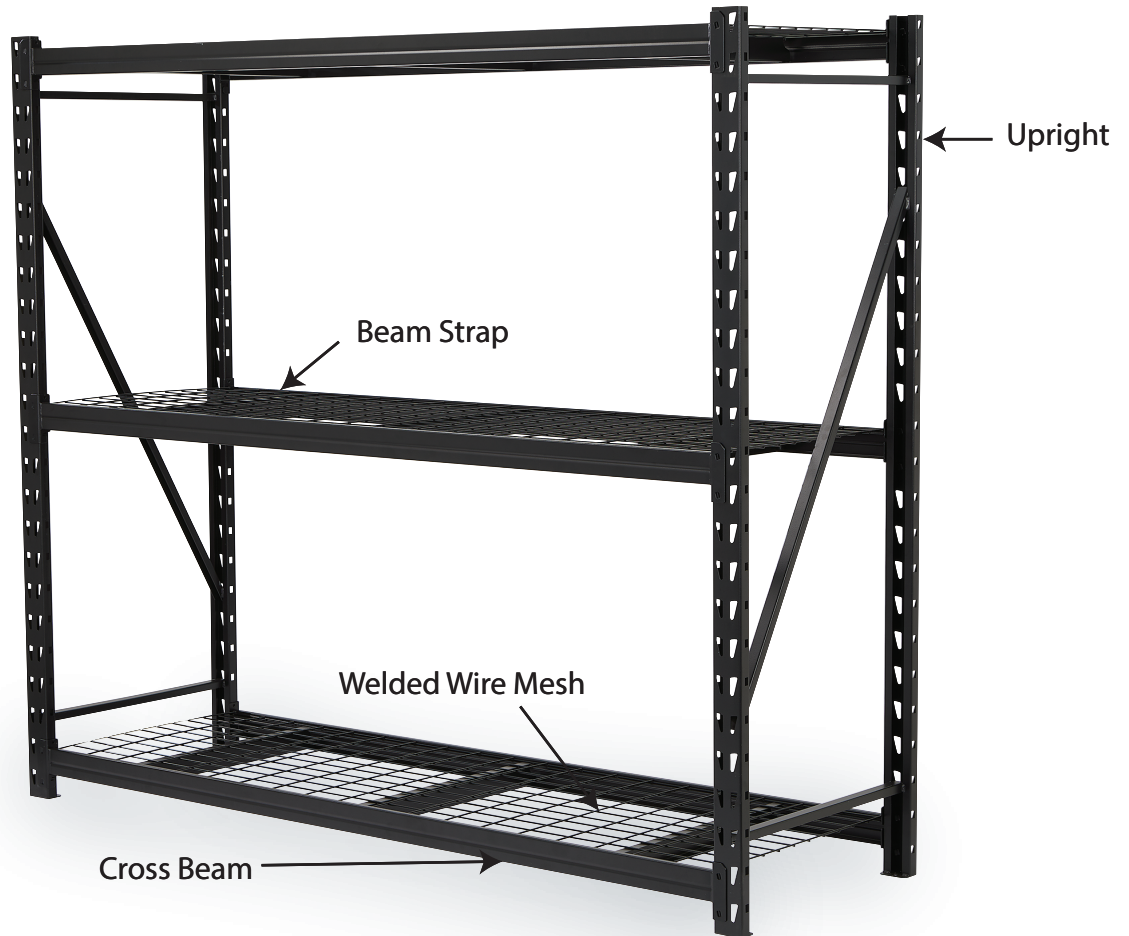

Parts List

DESCRIPTION	QUANTITY
Upright	2
Crossbeam	6
Beam strap	9
Welded wire mesh	3
Lock pin	12
M6 Allen button bolt	18
Pan Philip self-taping screw	2
Plastic Dry wall anchor	2
Flat washer M5	2

Replacement Parts

- For replacement parts and technical questions, please call Customer Service at **1-800-222-5381**.
- Not all product components are available for replacement. The illustrations provided are a convenient reference to the location and position of parts in the assembly sequence.
- When ordering parts, the following information will be required: item description, item model number, item serial number/item lot date code, and the replacement part reference number.
- The distributor reserves the right to make design changes and improvements to product lines and manuals without notice.

Limited Warranty

Northern Tool and Equipment Company, Inc. ("We" or "Us") warrants to the original purchaser only ("You" or "Your") that the Ironton product purchased will be free from material defects in both materials and workmanship, normal wear and tear excepted, for a period of one year from date of purchase. The foregoing warranty is valid only if the installation and use of the product is strictly in accordance with product instructions. There are no other warranties, express or implied, including the warranty of merchantability or fitness for a particular purpose. If the product does not comply with this limited warranty, Your sole and exclusive remedy is that We will, at our sole option and within a commercially reasonable time, either replace the product or product component without charge to You or refund the purchase price (less shipping). This limited warranty is not transferable.

Limitations on the Warranty

This limited warranty does not cover: (a) normal wear and tear; (b) damage through abuse, neglect, misuse, or as a result of any accident or in any other manner; (c) damage from misapplication, overloading, or improper installation; (d) improper maintenance and repair; and (e) product alteration in any manner by anyone other than Us, with the sole exception of alterations made pursuant to product instructions and in a workmanlike manner.

Obligations of Purchaser

You must retain Your product purchase receipt to verify date of purchase and that You are the original purchaser. To make a warranty claim, contact Us at 1-800-222-5381, identify the product by make and model number, and follow the claim instructions that will be provided. The product and the purchase receipt must be provided to Us in order to process Your warranty claim. Any returned product that is replaced or refunded by Us becomes our property. You will be responsible for return shipping costs or costs related to Your return visit to a retail store.

Remedy Limits

Product replacement or a refund of the purchase price is Your sole remedy under this limited warranty or any other warranty related to the product. We shall not be liable for: service or labor charges or damage to Your property incurred in removing or replacing the product; any damages, including, without limitation, damages to tangible personal property or personal injury, related to Your improper use, installation, or maintenance of the product or product component; or any indirect, incidental or consequential damages of any kind for any reason.

Assumption of Risk

You acknowledge and agree that any use of the product for any purpose other than the specified use(s) stated in the product instructions is at Your own risk.

Governing Law

This limited warranty gives You specific legal rights, and You also may have other rights which vary from state to state. Some states do not allow limitations or exclusions on implied warranties or incidental or consequential damages, so the above limitations may not apply to You. This limited warranty is governed by the laws of the State of Minnesota, without regard to rules pertaining to conflicts of law. The state courts located in Dakota County, Minnesota shall have exclusive jurisdiction for any disputes relating to this warranty.

ironton®

Distributed by:

Northern Tool & Equipment Company, Inc.

Burnsville, Minnesota 55306

www.northerntool.com

Made in India