

**Have product questions or need technical support?**

**Contact Us:**



Website: [www.poulanpro.com](http://www.poulanpro.com)



Toll free: 1-888-676-7909 Mon-Fri 8-4 CST



Email: [support@poulanpro-power.us](mailto:support@poulanpro-power.us)



**READ AND UNDERSTAND THE OPERATOR'S MANUAL AND ALL SAFETY WARNINGS BEFORE USE**

*Failure to operate the product correctly can result in damage to the product, personal property and cause serious injury or death.*

Manufactured under license from Husqvarna AB  
Poulan Pro® is a registered Trademark of Husqvarna AB  
Imported by Novus Performance Products  
W225N16708 Cedar Park Ct. Jackson, WI



Vol. 2025-02

## UNPACKING

- ▶ Carefully remove the snow thrower and all loose components from the carton.
- ▶ Verify all parts listed below are included. If any parts are missing, please contact our customer support team at 1-888-676-7909 for assistance.

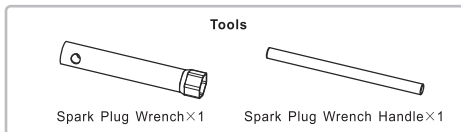
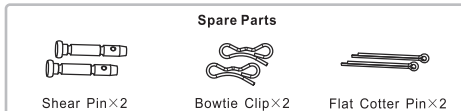
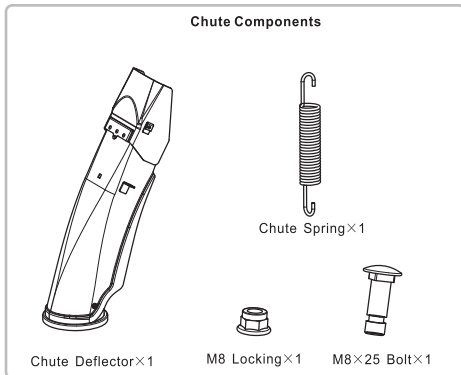
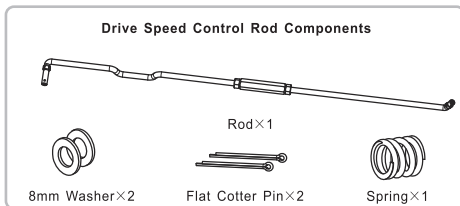
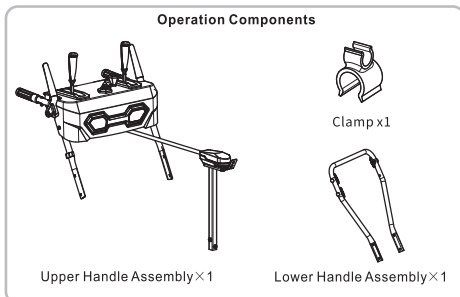
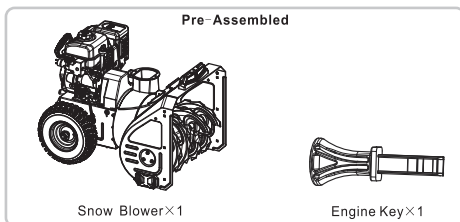

## ASSEMBLY

### Install the Lower Handle

1. Remove the 4 pre-installed flange bolts (A), lock washer (B), flat washer (C) from the frame case.
2. Using the hardware removed above install the lower handle (D) onto the frame case and tighten the bolts.

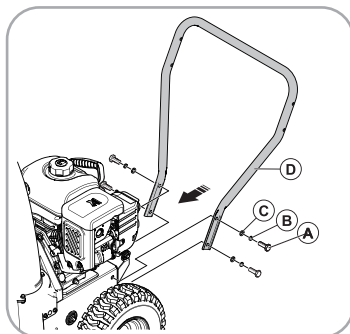

## Install the Upper Handle

1. Remove the pre-installed handle bolts (A), wave washers (B), handle knobs (C) from the upper handle (D).
2. With assistance, install the upper handle (D) onto the lower handle and secure in place using handle bolts (A) curved washers (B) and handle knobs (C).

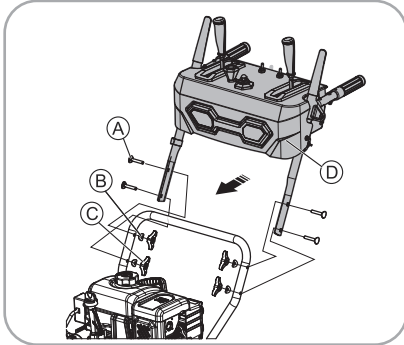

**Note:** Route the chute rotation cable (A) above the lower handle crossbar.

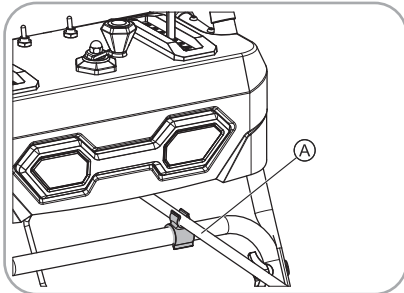

3. Insert the z-bend end of the auger and drive cables into the upper holes (C) of the left and right engagement levers (A).
4. Install the threaded part of the auger and drive cables into the cable holders (B) with one nut on the top and bottom of the plate. Adjust cable tension if necessary and lock the cables in place by tightening the M6 nut.

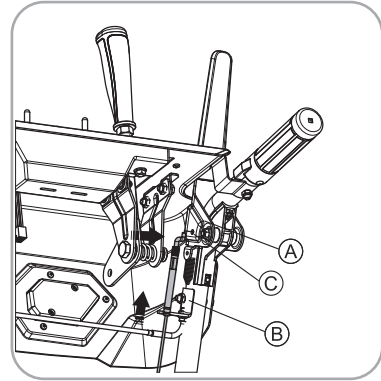

## Assembling the Chute

1. Remove the 2 pre-installed M8x35 flange bolts (B) from the chute rotation support bracket (A).
2. Using the removed bolts, fasten the support bracket onto the blower housing.

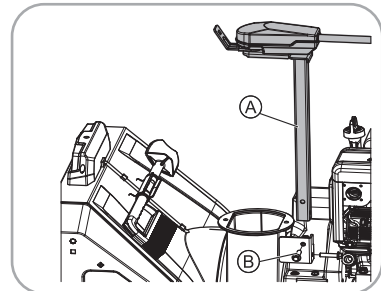

3. Install the deflector chute (A) by placing onto the auger housing discharge and securing to the chute rotation assembly with 1 x M8x25 bolt (B) and 1 x M8 flanged lock nut (C).

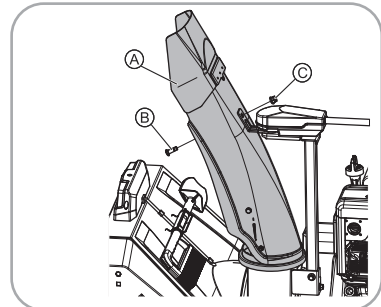

4. Insert barrel end of the chute deflector cable (A) into the hole located on the chute deflector.

5. Install the chute deflector cable with one nut (B) above and one below (C) the bracket. Adjust to remove slack in the cable when the deflector is in the full up position then tighten the nut.
6. Install one end of the deflector return spring (D) into the hole on the back of the deflector. Install the lower end of the return spring into the slot of the M8X25 deflector mounting bolt.

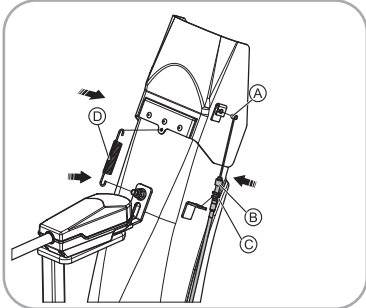

7. Install the chute rotation cable (A) into the cable clamp as shown.

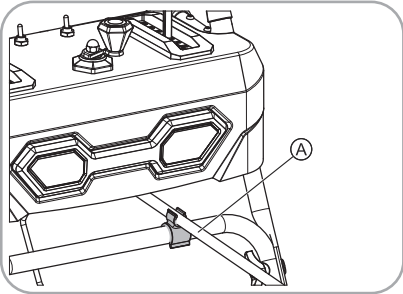

## Installing the Drive Speed Control Rod

1. Install the long-bent end of the drive speed control rod (A) to the shift lever and secure it with 1 x spring (B), 1 x M8 flat washer (C) and 1 x cotter pin (D). (Fig 1)
2. Pull up wards on the shift connecting plate (B) and install the short-bent end of the drive speed control rod (A). Attach the control rod (A) with 1 x M8 flat washer (C) and 1 x cotter pin (D). (Fig 2)

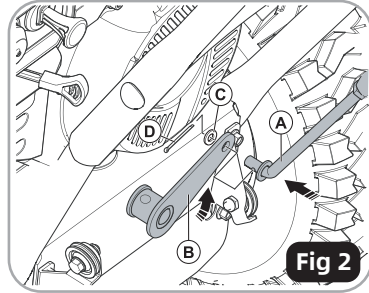
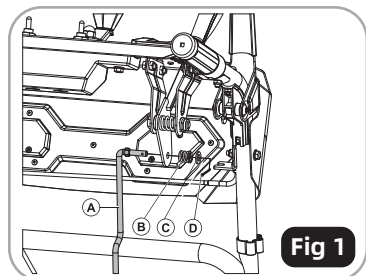

## Connect Wiring

1. Connect square heated handgrip plug (A) to engine plug (C). Connect oval LED lighting plugs (B & D).

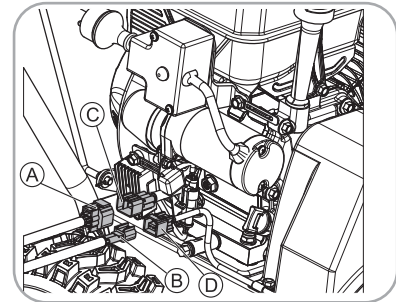

2. Use wire / cable retention clips (B) to fix the LED light and heating grip wires to the handles (A).

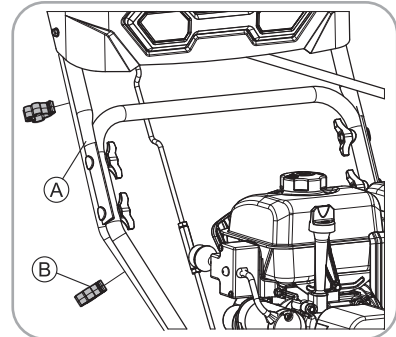

## Add Engine Oil

1. Place the snow blower on a flat level surface.
2. Remove oil fill cap/dipstick to add engine oil.
3. Using a funnel, add up to 20 fl. oz (600 ml) of oil and replace oil fill cap/dipstick.  
DO NOT OVERFILL.
4. Check the engine oil level and add as needed. Securely screw in the oil filler cap/dipstick.

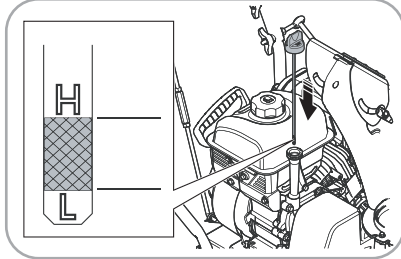

2. Slide the fuel switch lever fully to the right. "ON" position.

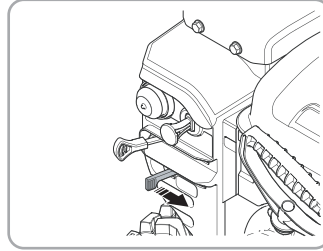

3. Slide the choke / throttle control lever to the left. "Choke" position.

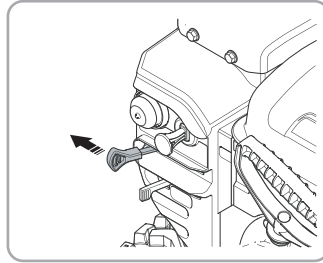

## Add Fuel

### **⚠ DANGER:**

*Gasoline vapors are highly flammable and extremely explosive.*

1. Remove the fuel tank cap.
2. Add fresh, clean unleaded fuel with a minimum of 87 octane and a maximum of 10% ethanol to the fuel tank leaving 1/4" of space from the top of the tank. DO NOT OVERFILL. Immediately wipe up any spilled fuel.
3. Reinstall the fuel tank cap turning clockwise until it stops.

4. Firmly push in the primer 3 times with your thumb, holding the primer in for a second before releasing it each time.

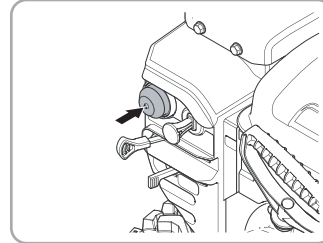

## Starting and Operating Procedures

This section of the quick start guide provides basic instructions on how to start and operate your new Snow Blower. This quick start guide is not a comprehensive guide, we recommend the operator's manual is read and understood before using your new equipment.

5. Pull the starter handle slowly until resistance felt, then pull rapidly.

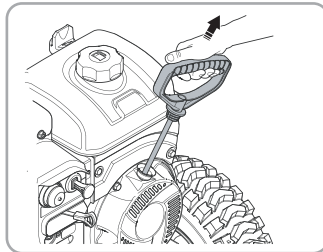

## Starting The Engine (Recoil / Pull Start)

1. Insert the engine key.

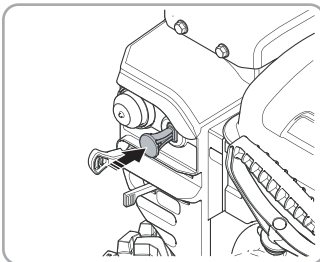

- Once the engine starts, slowly slide the choke/ throttle control lever to the right into the "Run" position.

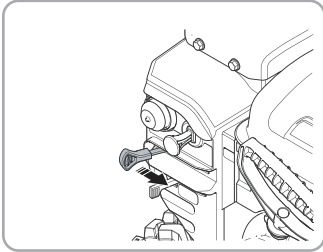

- Allow the engine to run for 30 - 40 seconds before starting to blow snow.

## Starting the Engine (Electric Start)

Follow Steps 1, 2, 3 and 4 listed under Recoil / Pull Start.

- Plug a 3-wire extension cord into the electric start adapter on the snow thrower. Plug the other end of the power cord into a convenient 120V outlet.

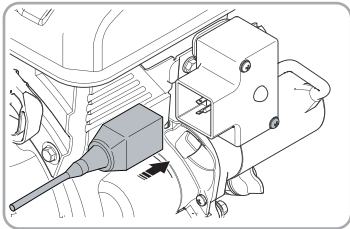

- Press and hold the start button on the control box for 5 seconds.

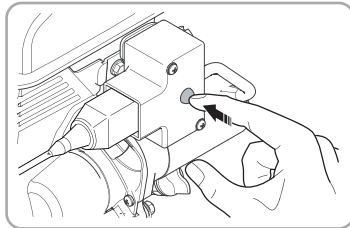

**Note:** If the engine does not start, wait 5 seconds, then push the start button again.

- Once the engine starts, slide the choke / throttle control lever to the right to the "Run" position.
- Remove the extension cord from the unit and unplug it from the outlet.
- Allow the engine to run for 30-40 seconds before starting to throw snow.

## Operating the Snow Blower

### Auger Engagement

- Squeeze the left-side auger engagement lever down to the handle to engage the auger and blow snow. (Fig 1)

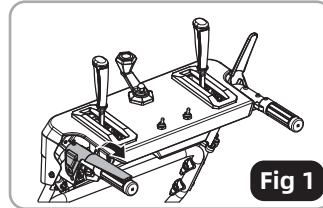

### Wheel Drive Engagement

- Move the drive speed control lever to the front to operate the product forward. Move the drive speed control lever to the back to operate the product rearward. (Fig 1)
- Squeeze the right-side drive engagement lever to the handle to engage the drive wheels. The product will move forward or reverse depending on the location of the drive speed control lever. (Fig 2)

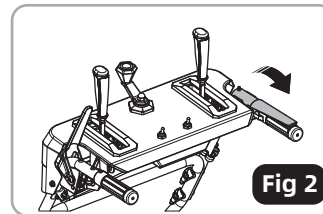
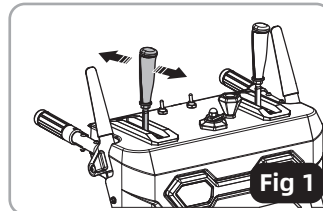

## Stopping the Snow Blower

- Release the right-side drive engagement lever to stop the drive wheels.
- Release the left-side auger engagement lever to disengage the auger and stop throwing snow.
- Slide the Choke / Throttle control lever fully to the right.
- Pull outward on the engine key to stop the engine.
- Slide the fuel switch lever fully to the left. "Closed" position.

