

Work bench with one drawer

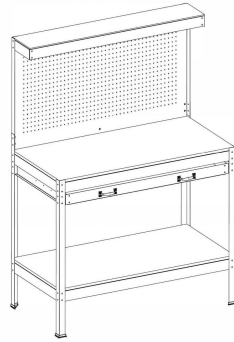

1

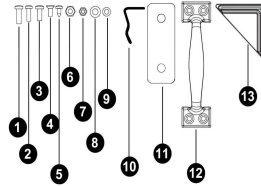

- 1) M6x14 mm (x4)
- 2) M4x12 mm (x10)
- 3) M6x10 mm (x6)
- 4) M4x10 mm (x8)
- 5) (x4)
- 6) M6 (x7)
- 7) M4 (x8)
- 8) M6 (x7)
- 9) M4 (x18)
- 10) (x12)
- 11) (x1)
- 12) (x2)
- 13) (x4)

2

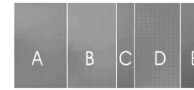

- A(x1)
- B(x1)
- C(x1)
- D(x1)
- E(x1)

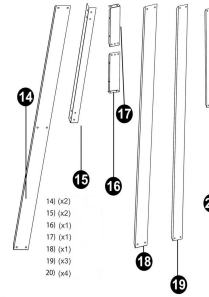

- 14) (x2)
- 15) (x2)
- 16) (x1)
- 17) (x1)
- 18) (x1)
- 19) (x3)
- 20) (x4)

3

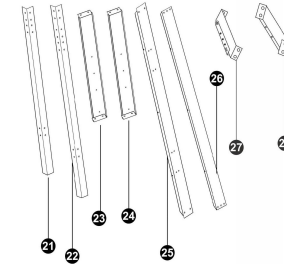

- 21) 900 mm (x2)
- 22) 996 mm (x2)
- 23) (x1)
- 24) (x1)
- 25) (x1)
- 26) (x1)
- 27) (x1)
- 28) (x1)

4

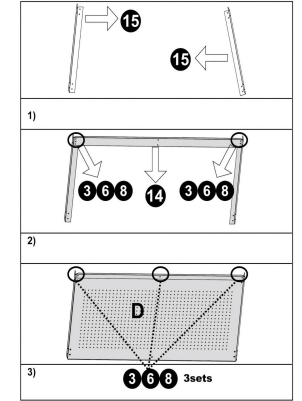

- 1) [Diagram showing panel D being attached to the top rail]
- 2) [Diagram showing panel D being attached to the side rails]
- 3) [Diagram showing panel D being attached to the bottom rail]

5

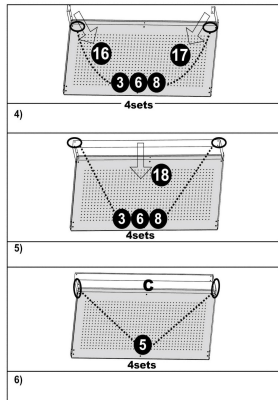

4) 4sets

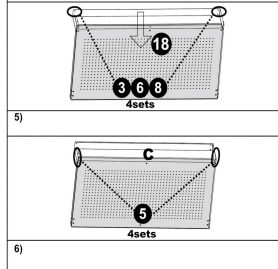

5) 4sets

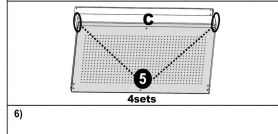

6) 4sets

6

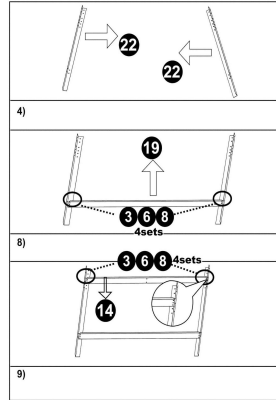

4) 4sets

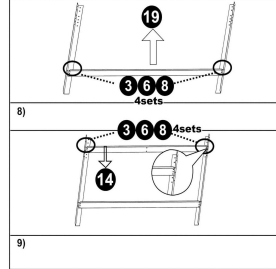

8) 4sets

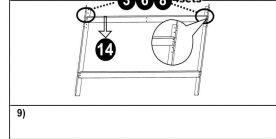

9) 4sets

7

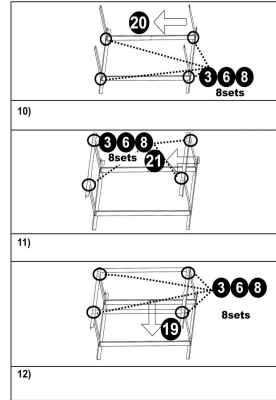

10) 8sets

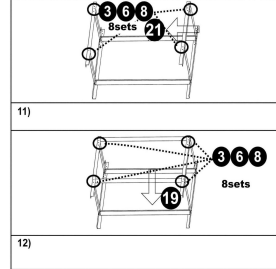

11) 8sets

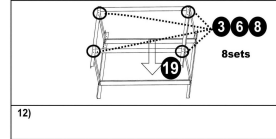

12) 8sets

8

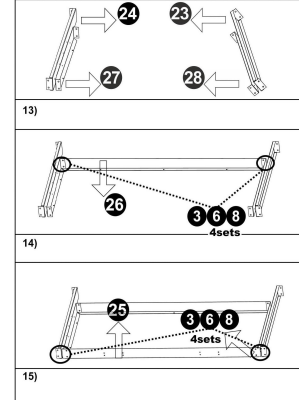

13) 4sets

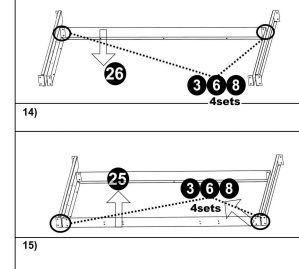

14) 4sets

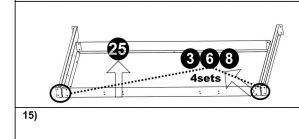

15) 4sets

9

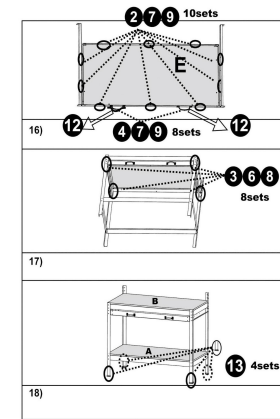

16) 10sets

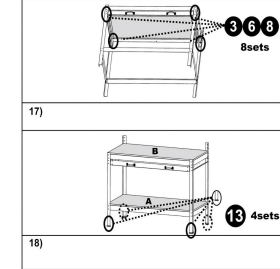

17) 8sets

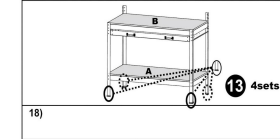

18) 4sets

10

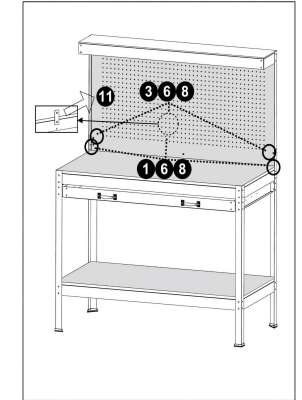

11) 4sets

11