

Solar Panel

User Guide

Model: SP100L

Contact Us:
www.bluettipower.com
service@bluettipower.com



User Guide

What is in the box

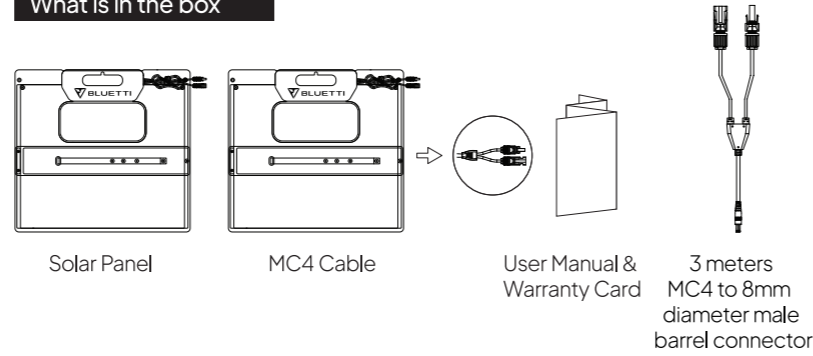

How to use

1 Unfold

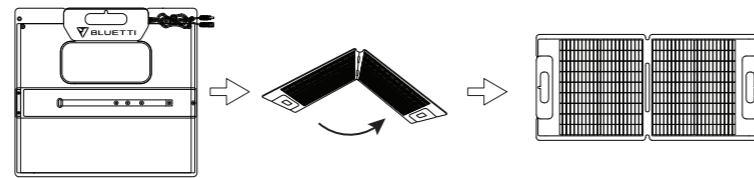

2 Adjust the kickstand

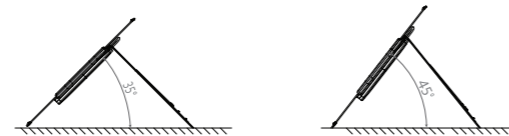

3 Connect to power station

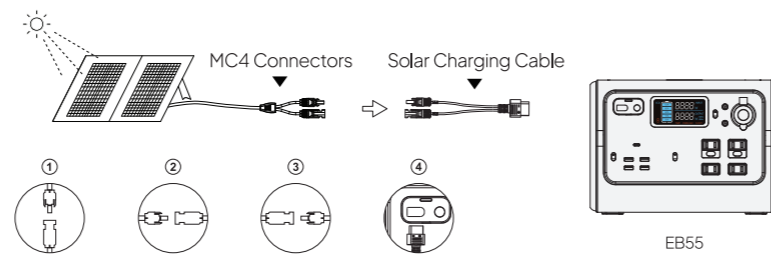

Note:

Use ONLY ONE SP100L solar panel with EB3A,EB55.

MC4 to 8mm diameter male barrel connector use only for AC50,EB70

Whether connected in series or parallel, make sure the total voltage of solar panels is under the power station's input voltage limit.

Attention

Regular inspection and maintenance are required to prolong the lifespan of solar panels.



No fall



No soak



No bend



No shading



No scratch

Warning:

Do not use solar panels in extreme weather conditions like thunderstorms, floods, typhoons, etc.

Always use solar panels within the specified temperature range (14-149°F/-10-65°C).

Technical details

SP100L		
Maximum Power(Pm)	100W*	
Open Circuit Voltage(voc)	24.62V	
Short Circuit Current(Isc)	5.13A	
Cell Efficiency	Up to 23.4%	
Solar Cell Lamination	ETFE	
Voltage at Max Power(Vmp)	20.52V	
Current at Max Power(Imp)	4.88A	
Operating Temperature	-10°C~+65°C	
Best Working Temperature	+25°C	
Folding Number	2	
General		
Weight	10.91lbs / 4.95Kg	
Dimensions	Unfolded	23.4*44.5in* / 595*1132mm
	Folded	23.4*22.2*2.2in / 595*564.5*55mm
Warranty		
12 Months		

User Guide

User Guide

* STC: Irradiation 1000W/m², cell temperature 25°C, atmospheric mass number AM 1.5, measurement tolerance ±3% (Pm).

Frequently asked questions

Is the solar panel waterproof?

No. The solar panel is IP67 water-resistant that provides protection against water splash. Please do not leave it in the rain or water for a long time.

What will affect the final conversion efficiency of solar panels?

The actual solar panel efficiency may be affected by several factors, like weather, sun intensity, shading, panel orientation, temperature, location, dust and dirt. For example, if you live in a place without much sunlight or your panels are covered by shade, you'll get a very low output or none at all.

Is the BLUETTI's solar panel compatible with the third party's power station?

Yes. Make sure BLUETTI solar panels' voltage is compatible with your power stations' voltage limit, while you're using the same connector. Please feel free to contact us for compatibility with other power stations.

US REP

Business Name: BLUETTI POWER INC
Business Address: 6185 S Valley View Blvd Ste D. Las Vegas NV 89118

