



Electric Wheelchair/ Scooter Carrier

Instructions for Part #10101194



GENERAL GUIDELINES & SAFETY

- It is the user's responsibility to read and follow all instructions.
- Keep these instructions with the product at all times and review before each use.
- It is the responsibility of this product's owner to furnish the instructions to any person that borrows or purchases the product.
- Inspect the product before use to ensure it is assembled properly and all parts are in safe working order and free of defects.
- Never modify this product in any way.
- All circumstances cannot be addressed in these instructions.
- Please use common sense and practice general safety measures when using this product.
- Parts and/or instructions are subject to change without notice.
- Never exceed the 350 lb. weight capacity; distribute load evenly.
- Never exceed the maximum trailer hitch tongue weight rating; please note that hauling weight may be limited by your vehicle's suspension.
- Some vehicles may require air shocks or heavier springs to stiffen up the suspension to sagging.
- Make sure the carrier is secured on the trailer hitch mount and all loads are secured on the carrier; tie-down straps are sold separately.
- Do not occupy the mobility aid while loading the carrier; do not stand on the carrier.
- Hitch adapters may affect the weight capacity of the carrier; if using a hitch adapter, always check its limitations before use.
- Always store the carrier in a safe place; improper use, storage, or installation of the carrier could result in death or serious injury.
- Not recommended for tow-behind trailers including 5th wheel trailers and camping trailers; do not install carrier on any kind of trailer.
- Periodically check nuts and bolts for tightness.
- Load and secure the wheelchair/scooter in the center of the carrier prior to transporting; do not allow it to tilt to one side.
- When lifting and lowering the carrier, the jack needs one minute interval before changing directions; failure to allow the carrier to rest between changing directions will damage the jack.

PARTS

Part	Description	Quantity
1	Tray	1
2	Folding Rod	1
3	M12 Lock Nut	4
4	M12 *65 Hex Bolts	1
5	Jack	1
6	M16 Bolt	1
7	16 Flat Washer	2
8	M16 Lock Nut	1
9	Support Bracket	1

Part	Description	Quantity
10	M12 *75 Hex Bolts	3
11	Receiving Bracket Assembly	1
12	M16 Anti-Vibration Bolt	1
13	16 Spring Washer	1
14	Cotter Pin	1
15	Emergency Manual Crank	1
16	Power Cable	1
17	Key for Switch	1

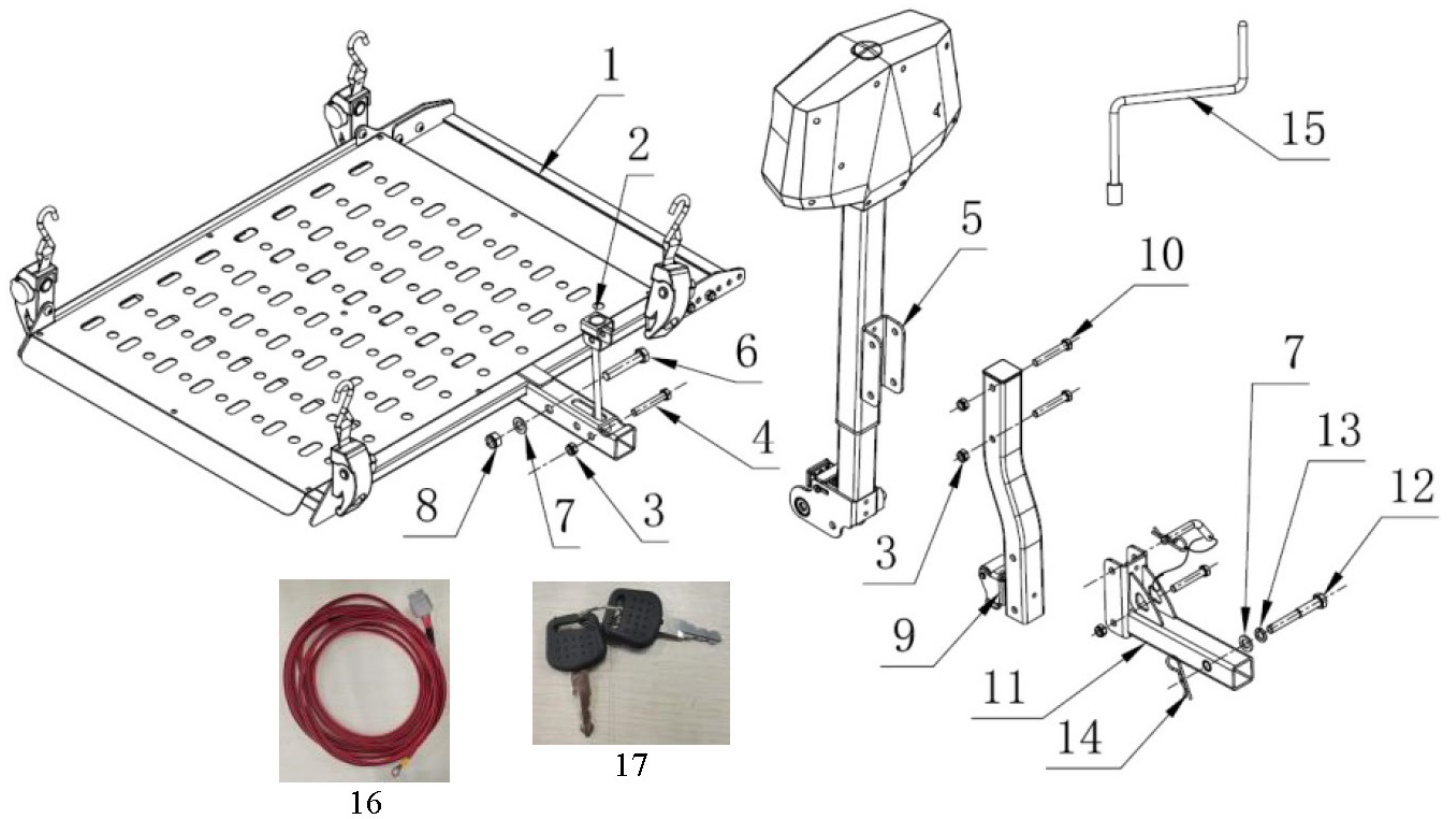

Recommended Tools for Assembly (Not Included)

- Adjustable Wrench
- 19mm Wrench
- 24mm Wrench

INSTRUCTIONS

STEP 1. Put the folding rod (2) into the square tube in the direction of the arrow, rotate it 90 degrees and align the hole position, and fix and tighten it with M12 * 65 outer hexagon bolt and M12 lock nut (3, 4).

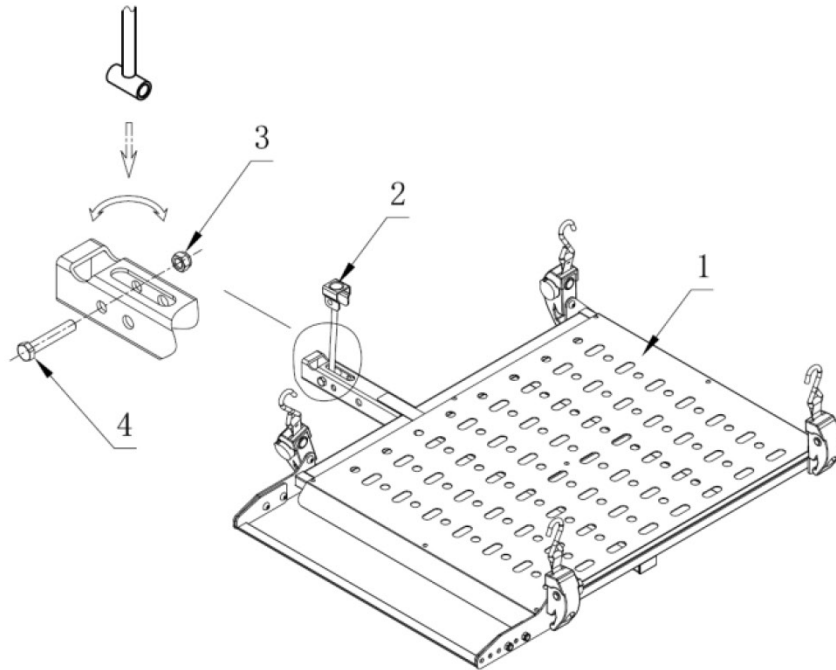

STEP 2. Remove the jack (5) from the box and connect the power.

Turn the handle (circled below) so that it points to the right, away from the vehicle.

IMPORTANT: Then press the **DOWN** switch to increase the height of jack by at least 6".

NOTE: If the jack (Part 5) appears to be stuck in the low position, disconnect the power. Use the **Emergency Manual Crank (Part 15)** to assist the jack into position. To do this, the jack must be held in the upright position while cranking counter-clockwise a half turn.

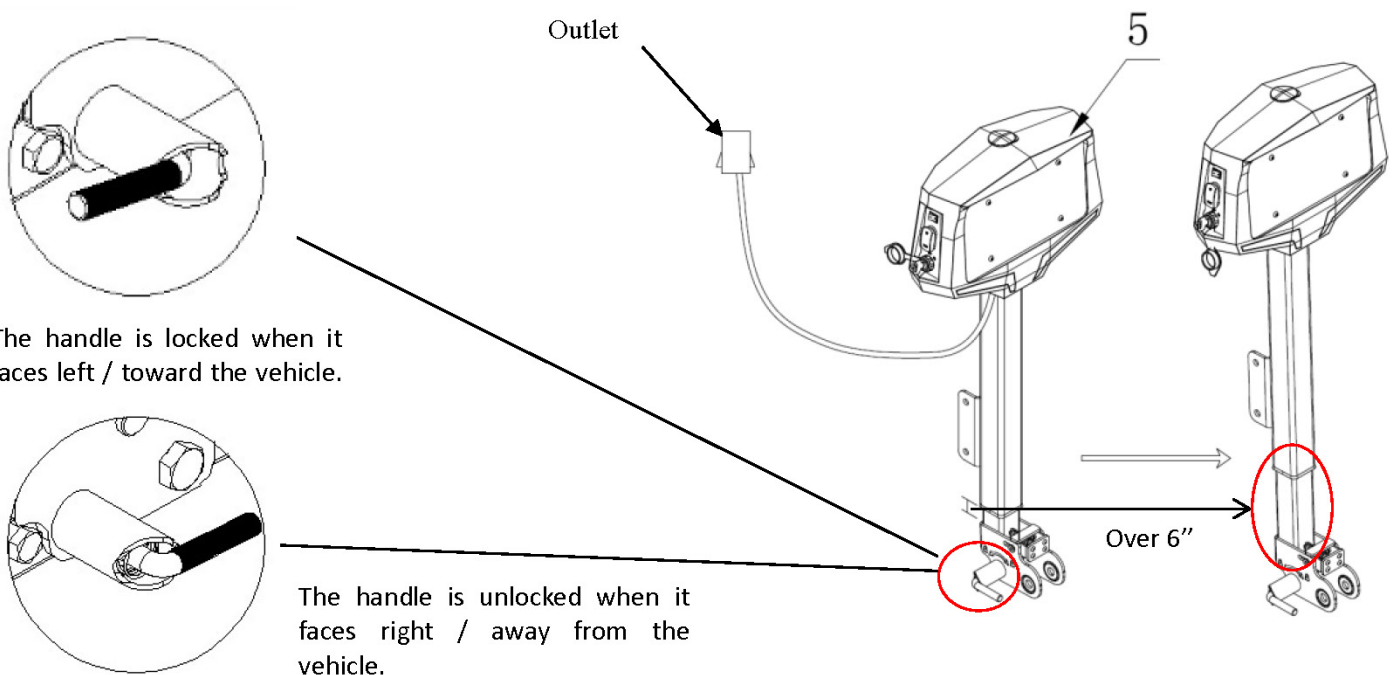

STEP 3. Connect the tray (1) to the jack (5) as shown in the diagram below. The tray has a square block which must be inserted directly into the opening in the jack tube. Align the holes with the jack tube with the holes on the tray and use a M16 Bolt (6), 16 flat washer (7) and M16 lock nut (8) to connect the components. Screw to 90% tightness. Turn the handle back to the left/toward the vehicle to lock it.

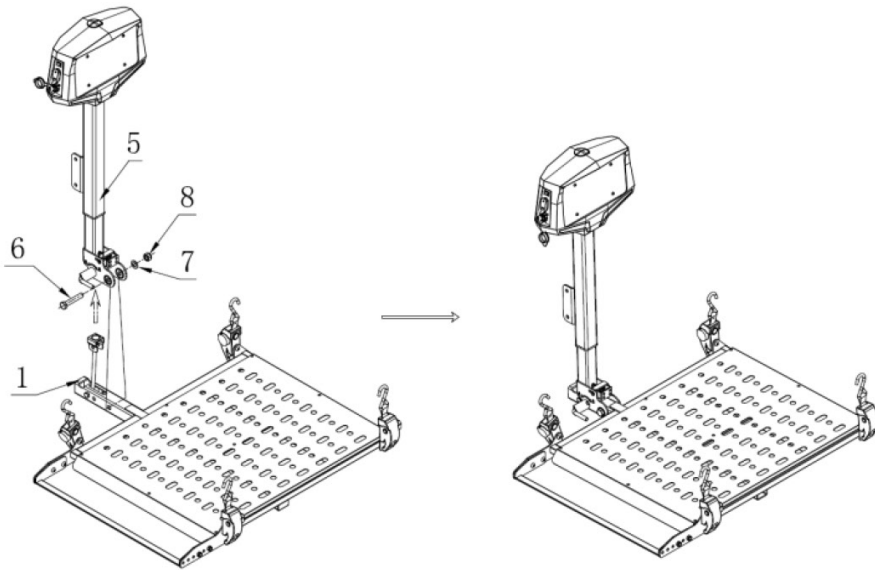

STEP 4. Install the Support Bracket (9) in the U-shaped bracket on the vehicle side of the jack (1). Align the holes on both components and secure them together with M12*75 outer hexagon bolts (10) and M12 locknuts (3), as shown below.

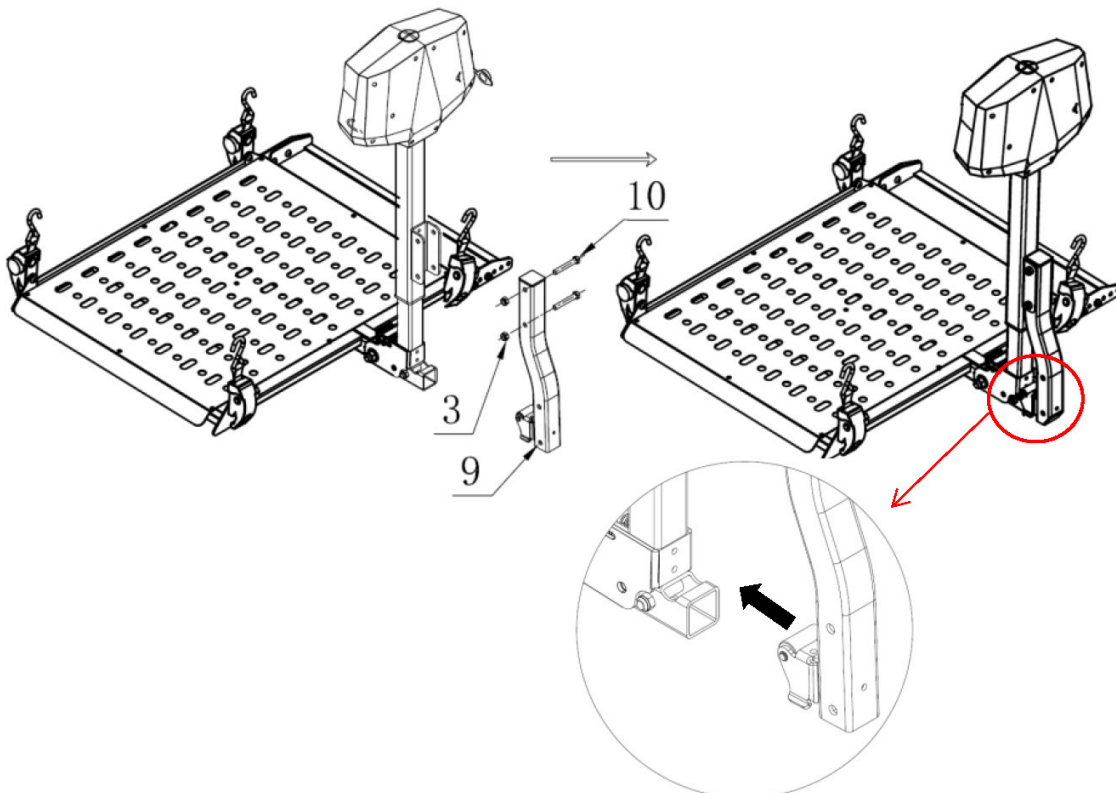

STEP 5. Align the U-Shaped groove on the Receiving Bracket Assembly (11) with the support bracket (9). Align the holes on both components and secure them together with M12*75 outer hexagon bolts (10) and M12 locknuts (3), as shown below.

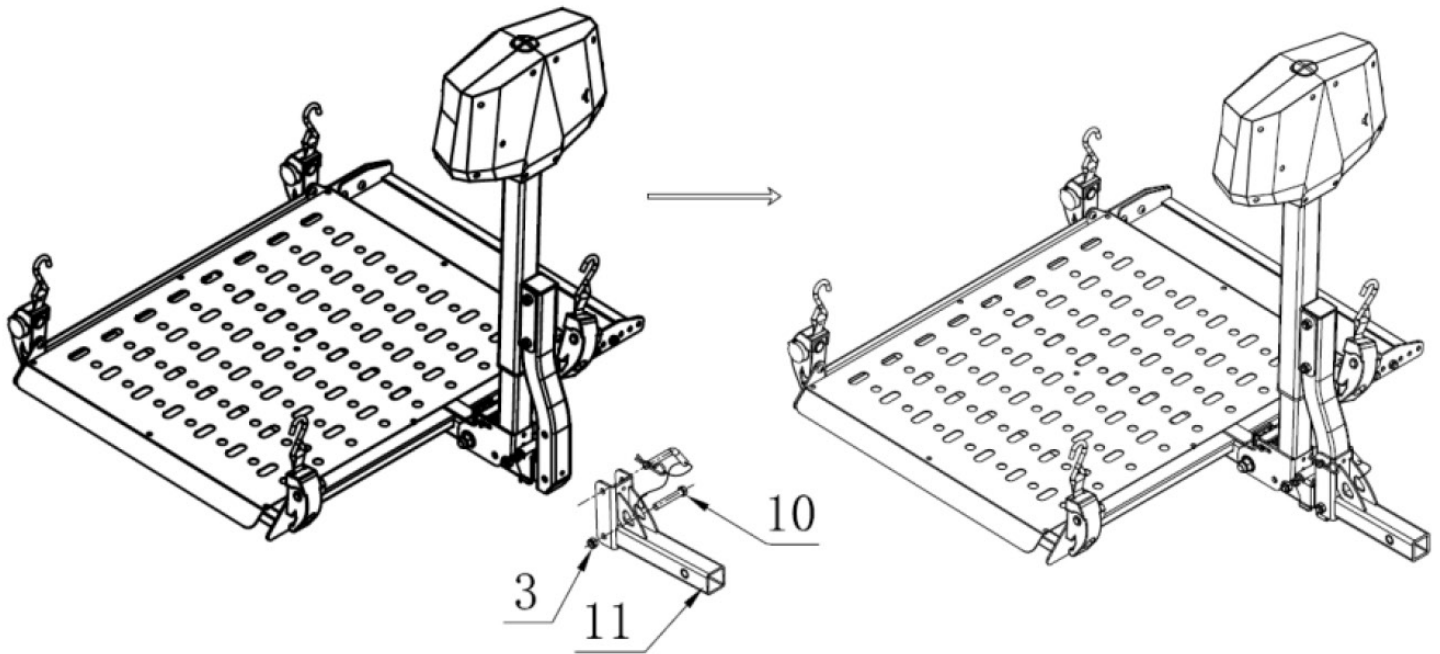

STEP 6. Insert the receiving bracket assembly (11) into your vehicle's 2" receiver. Align the holes on both components and secure them the M16 Anti-Vibration Bolt (12), 16 Spring Washer (13), and 16 Flat Washers (7). Fasten with a Cotter Pin (14).

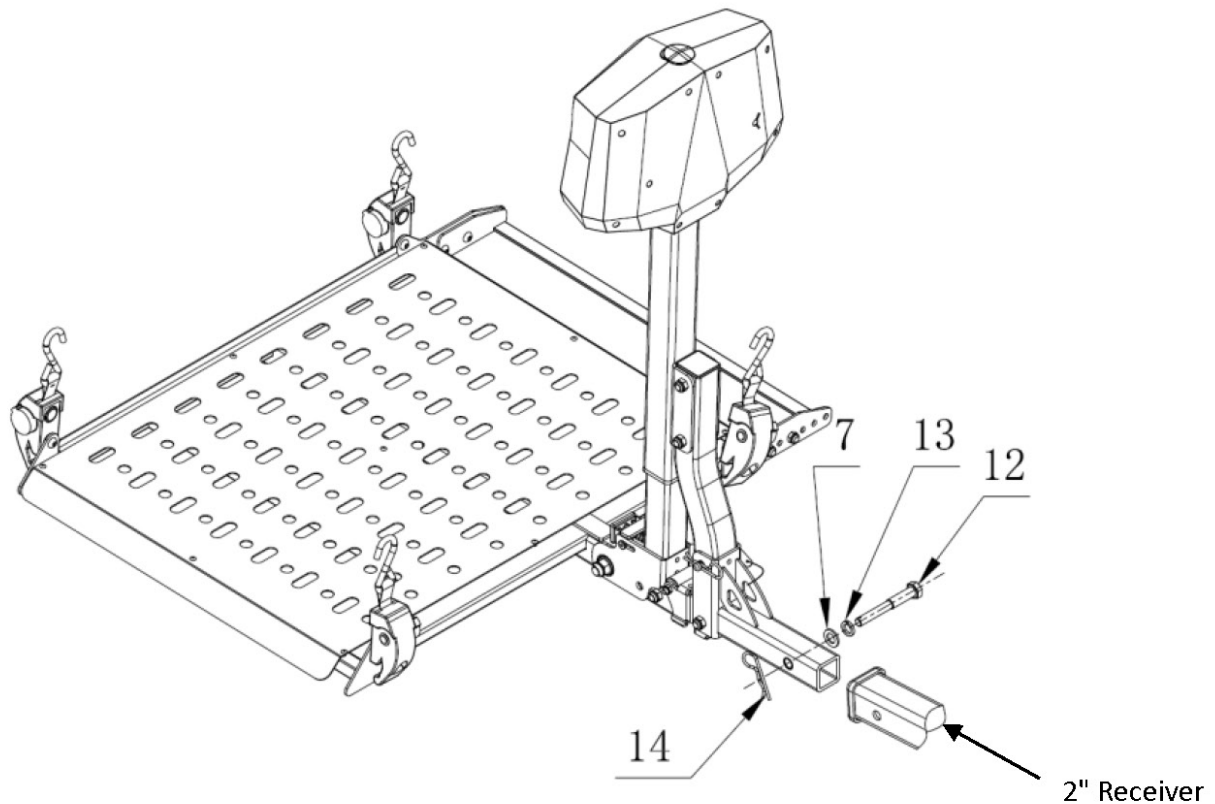

SINGLE-BEAM WIRING AND FUNCTIONAL INSTRUCTIONS

Place the single cable harness on the bottom of the car as shown in the figure below, and insert it with the carrier, as shown below.

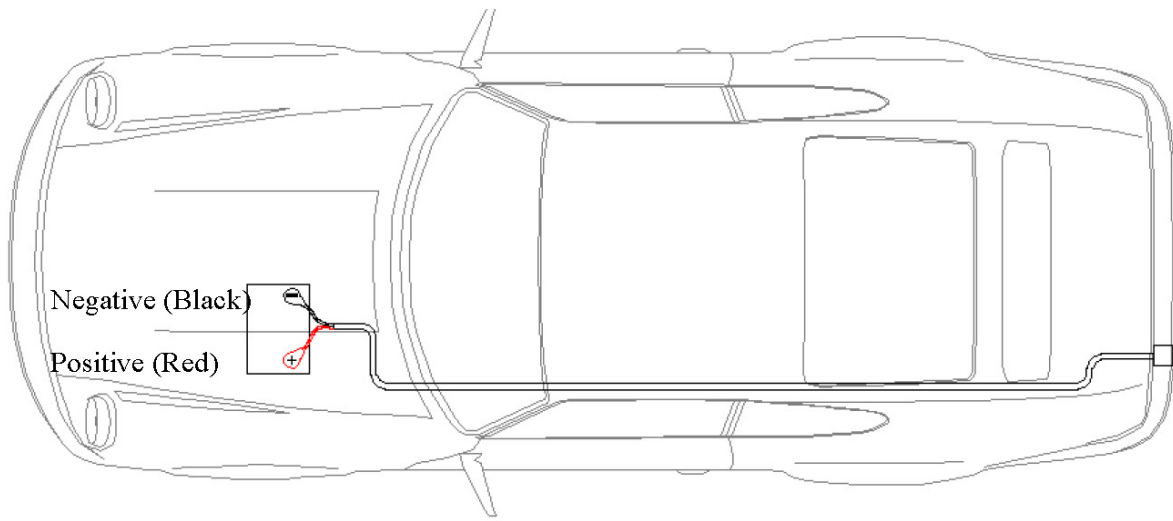

Power-on plug connector

Light Switch: Controls the product's light switch, which can be used to illuminate a license plate installed on the jack.

Up-Down Switch: Raises/Lowers Product

Power Switch: Allows the jack to raise or lower. It must be adjusted with a key. Insert a key and turn the switch as desired.

Vertical = Power Off, will not operate
Turned to the right = Power On, will operate

(Note: Close the waterproof cover after removing the key.)

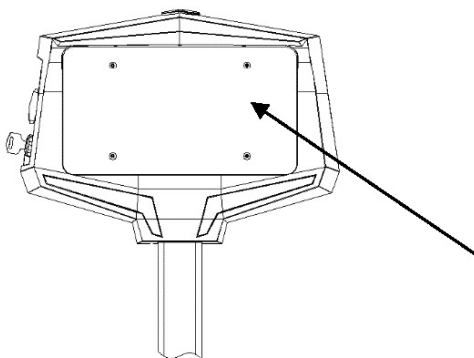
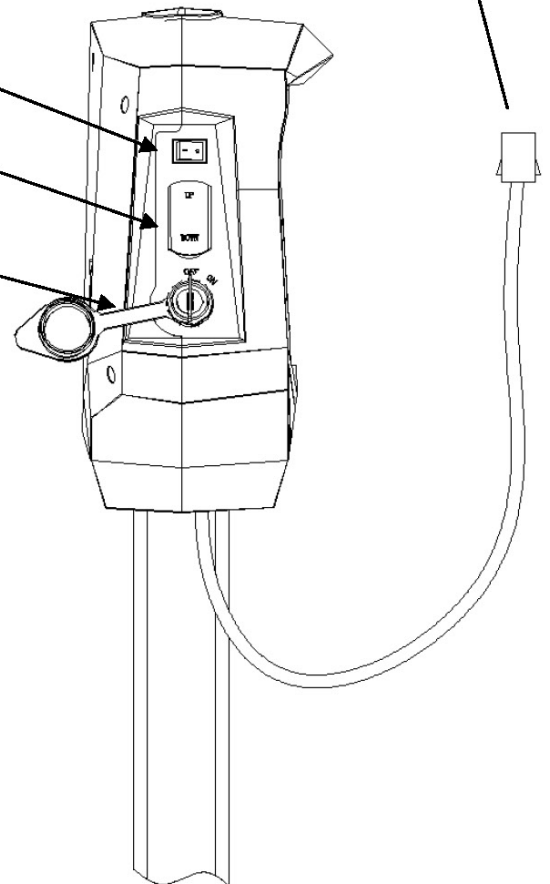

The jack has a place to install a license plate. Follow all local rules and regulations regarding displaying license plates.

OPERATION

1. How to control the descent

①

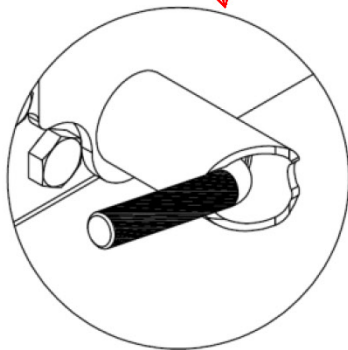
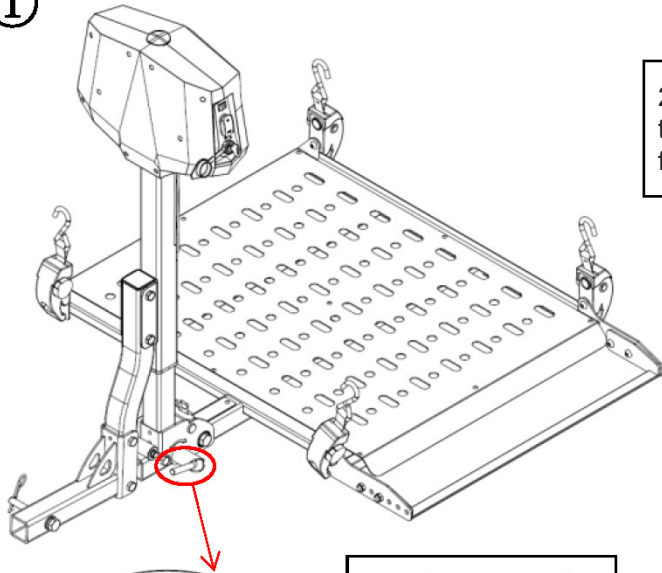

1. When using this carrier, the locking pull rod shall face the 2" receiver.

②

2. After the power is turned on, turn the key from off to on.

3. Press and hold the bottom of the button (with the word "down").

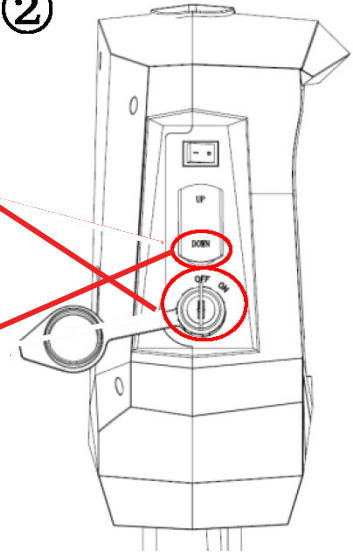

③

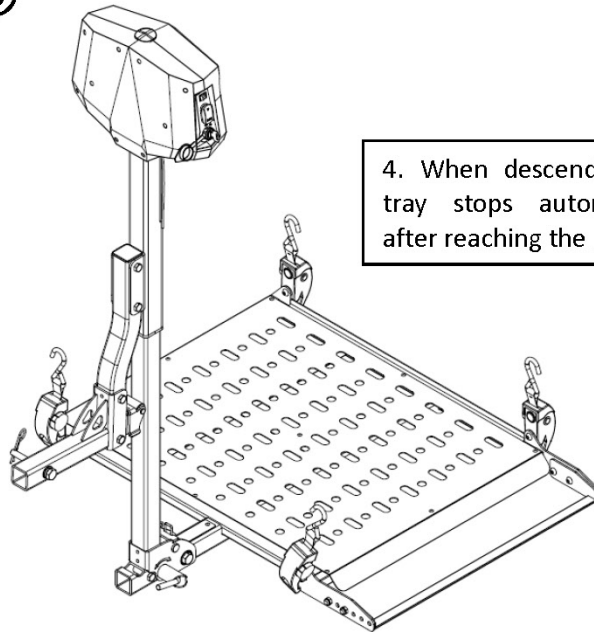

4. When descending, the tray stops automatically after reaching the ground.

2. How to control the rise

①

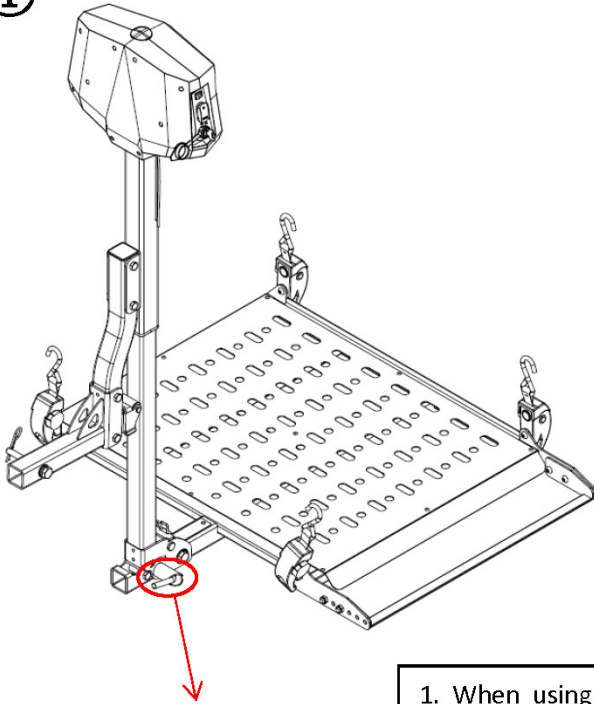

1. When using this carrier, the locking pull rod shall face the 2" receiver.

②

2. After the power is turned on, turn the key from off to on.

3. Press and hold the bottom of the button (with the word "up").

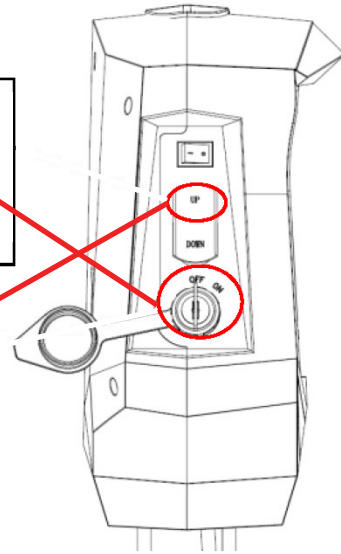

③

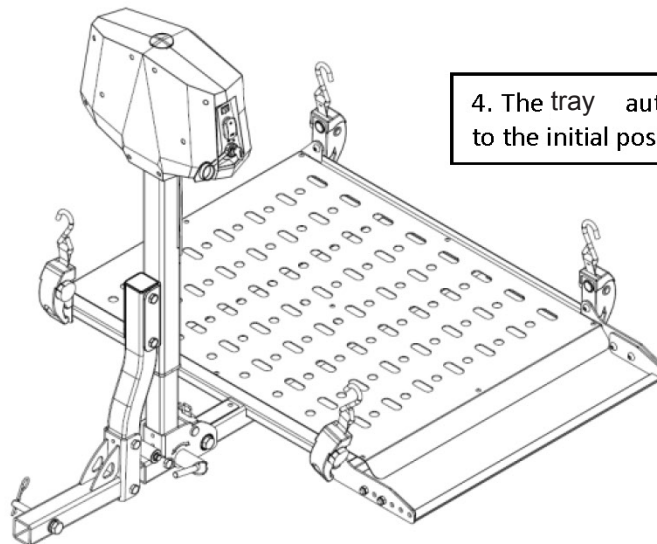

4. The tray automatically stops when it rises to the initial position.

3. How to control folding

①

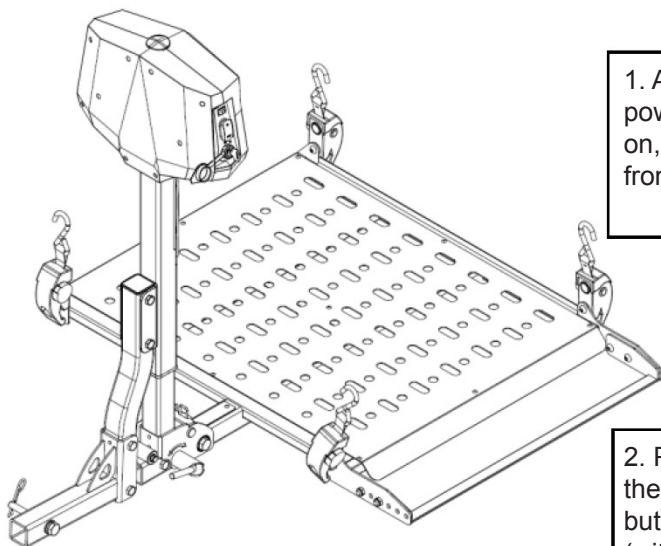

②

1. After the power is turned on, turn the key from off to on.

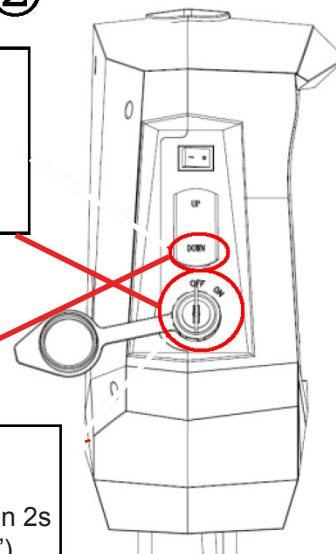

2. Press and hold the bottom of the button for more than 2s (with the word "up").

③

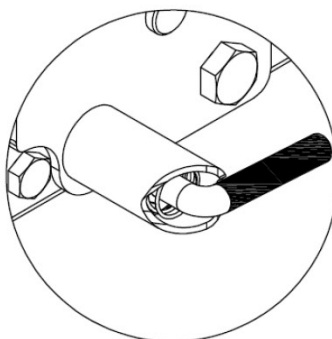
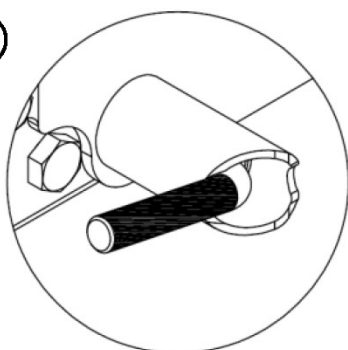

3. Before folding, the locking pull rod shall face the carrier plate.

④

4. Then press and hold the upper part of the button (word "up").

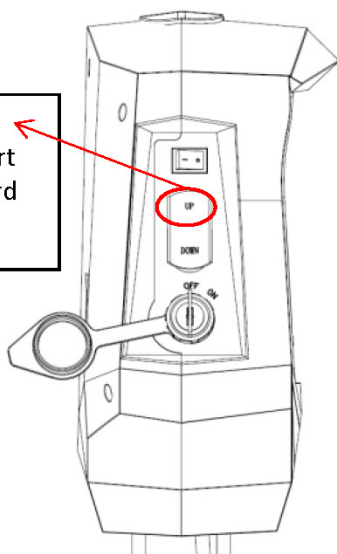

⑤

5. When it rises to the vertical state, it stops automatically.

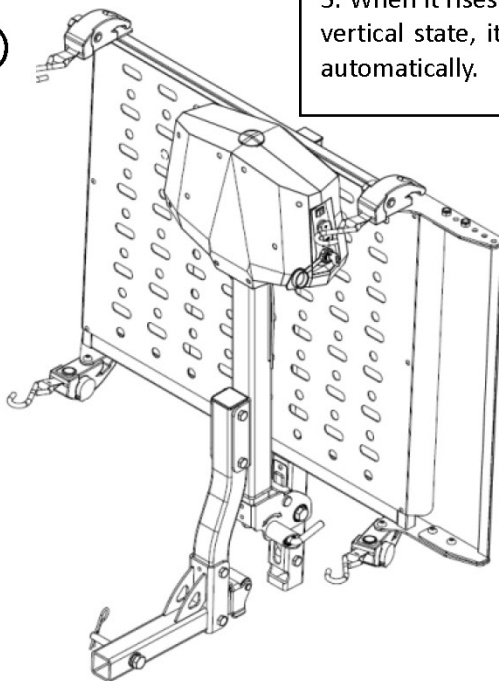

Operating instructions for insufficient voltage and opening trunk

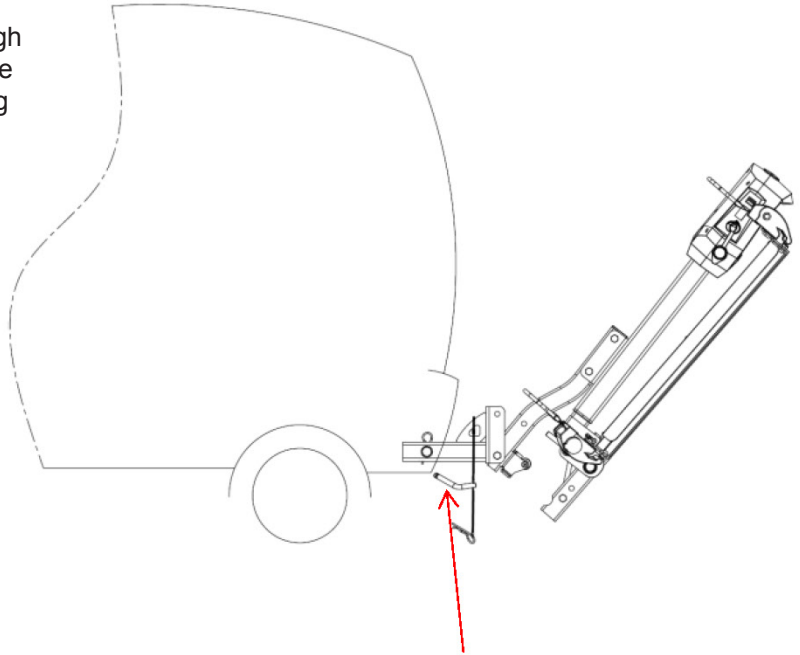
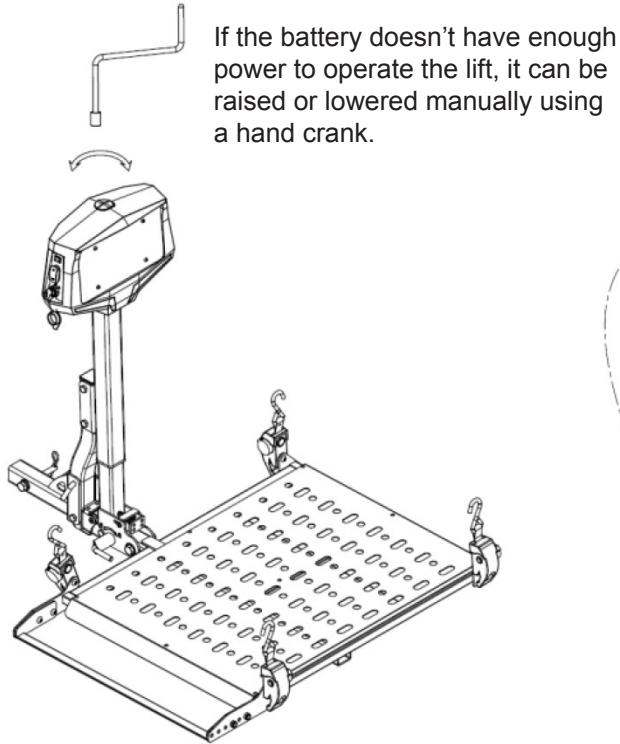

When the product is unloaded, the bent pin in the connector can be pulled out to tilt and open the trunk.

Operating instructions for product loading scooter

Follow the instructions as stated above to lower the carrier. Once in contact with the ground, place the electric scooter on the tray.

Note: Never ride an occupied scooter onto the carrier.

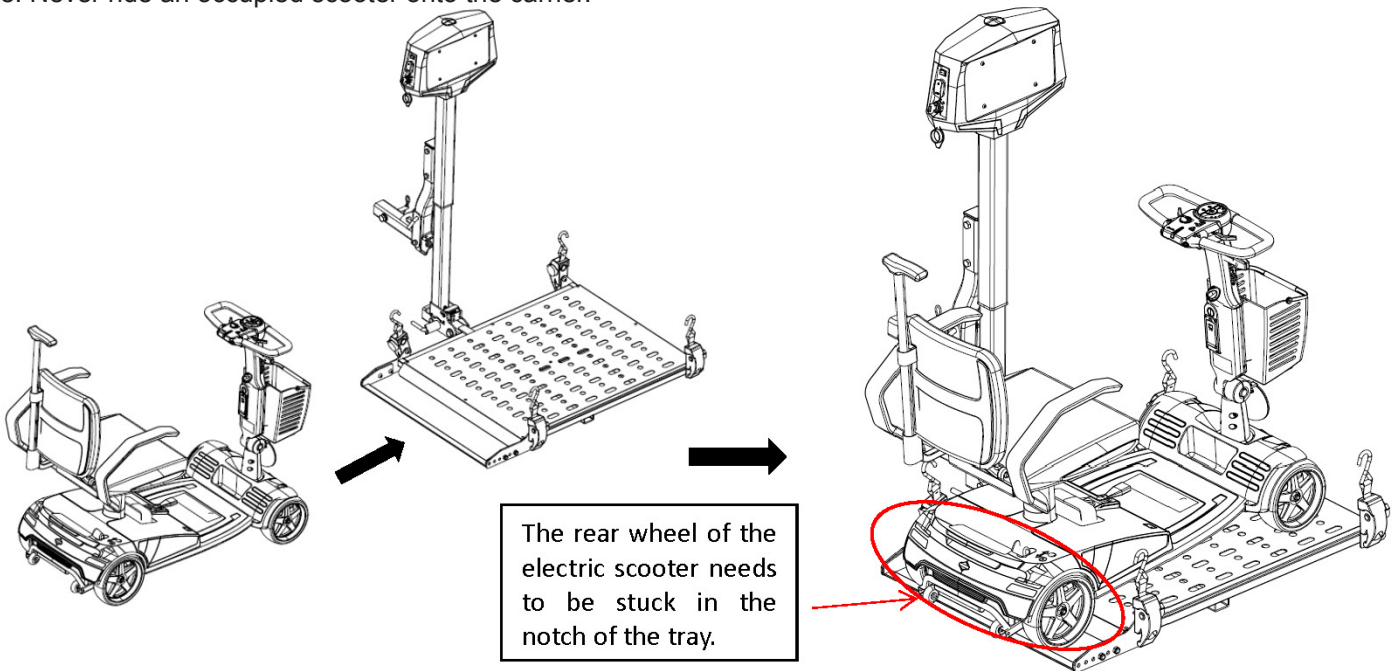

Step2: Raise the carrier to the automatic stop position according to the above method of controlling the lifting.

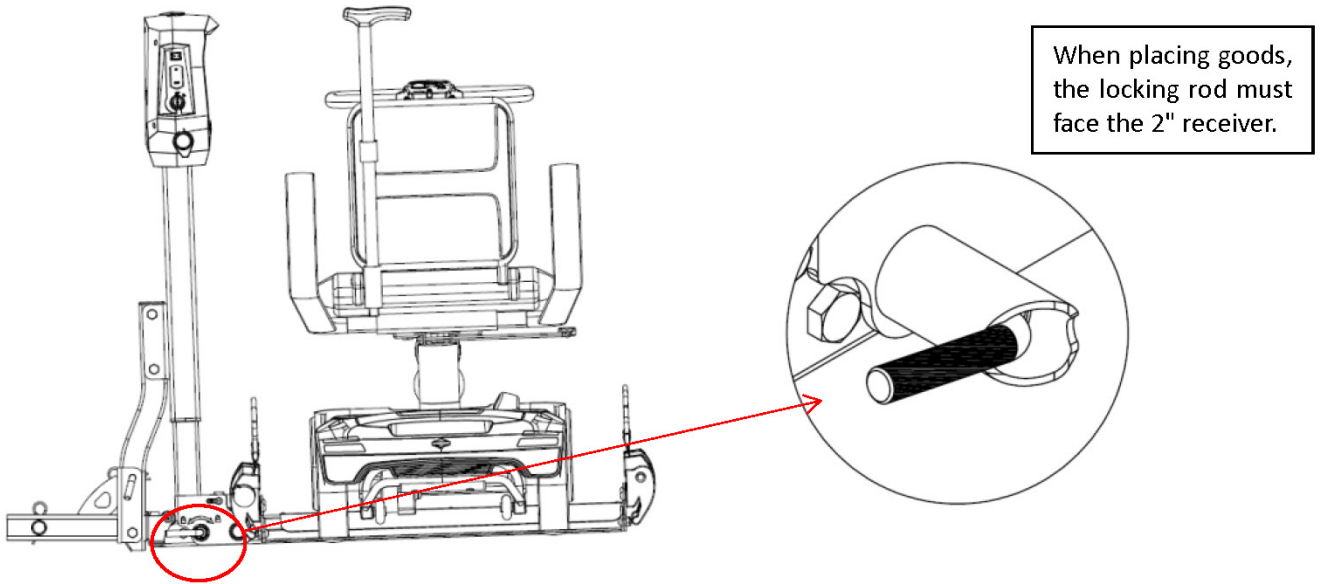

step3: The electric scooter on the tray with 4 tensioning belts

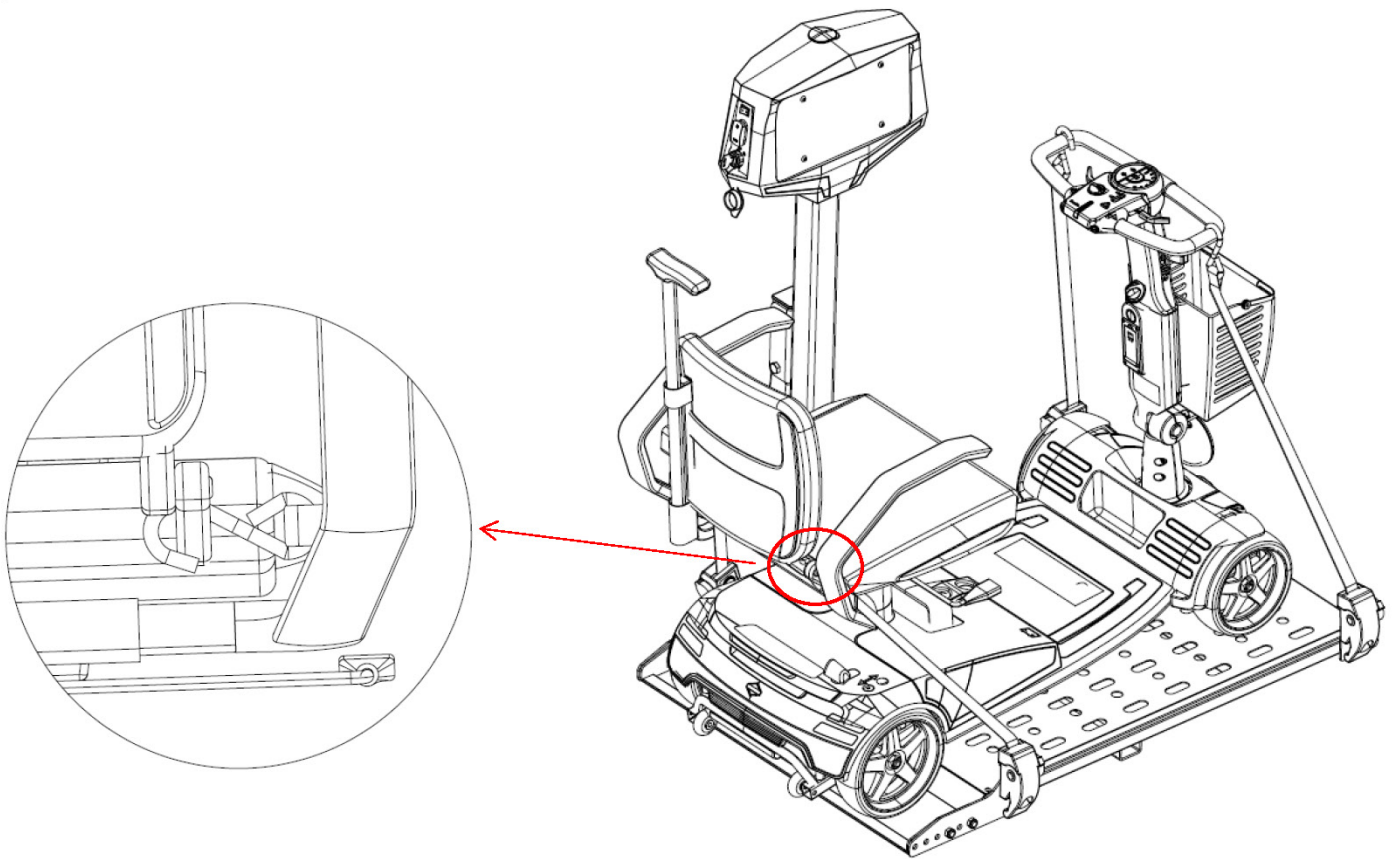

REAR-WHEEL SUPPORT ADJUSTMENT

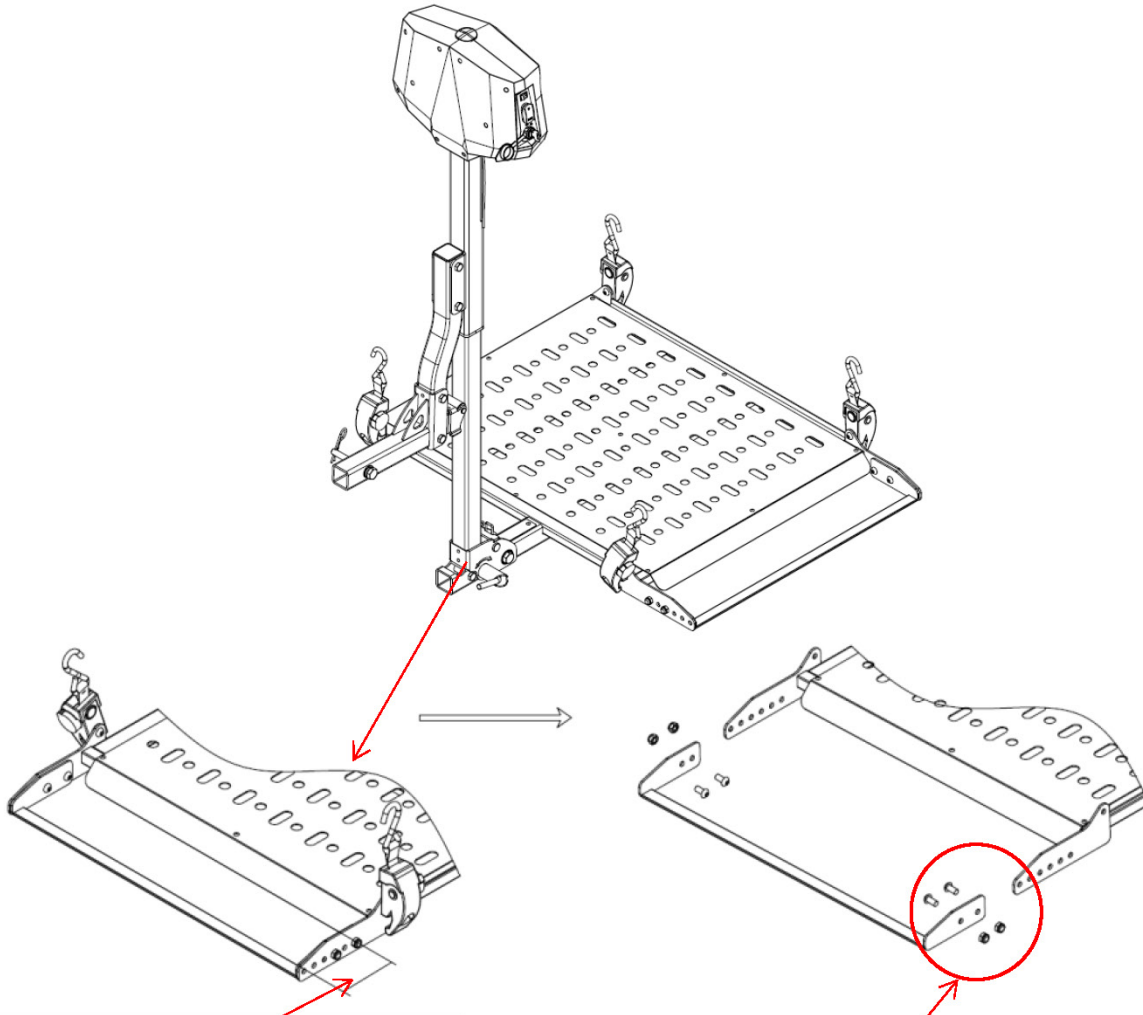

The wheel size of the electric scooter can be adjusted according to different sizes, which must be adjusted under no-load and the range from 3.9" to 6.9" (100mm to 176mm).

Loosen the bolts and nuts during adjustment.

PRODUCT WARRANTY & LIABILITY

GENERAL PRODUCT WARRANTY: Products purchased from the Authorized Dealer (original place of purchase) or Merchant ("Dealer") will be free of defects in material and workmanship at the time of receipt, and will meet the specifications stated at the place of purchase transaction or online at the Dealer's website, under normal use and service when correctly installed, operated and maintained. This product warranty is effective for the period of time stated below, unless otherwise stated in the product instructions or depicted in the product advertisement. All Authorized Dealer warranties are NON-TRANSFERABLE and cover only the original end purchaser. This limited warranty does not cover products purchased through non-authorized dealers. Non-authorized dealer receipts are not accepted for warranty verification.

*****WARRANTY CLAIMS MUST BE MADE DIRECTLY TO THE ORIGINAL PLACE OF PURCHASE.*****

WARRANTY PERIOD: This warranty remains in force for one year from the date of the product's accepted delivery. The Authorized Dealer offers a one year manufacturer's warranty for most products unless otherwise specified on the product advertisement.

WARRANTY SERVICE: The Authorized Dealer will replace any defective or malfunctioning part at no charge, including payment of the shipping costs of parts or replacement product to and from the manufacturer. The purchaser is responsible for labor charges. If the product does not meet specifications as depicted in the advertisement, the Authorized Dealer will refund the full purchase price of the product.

Questions regarding the warranty on a specific product and warranty claims should be directed to the Authorized Dealer with whom the purchase transaction was made.

WARRANTY LIMITATIONS: The above warranty does not apply to products that are repaired, modified or altered by any party other than the Authorized Dealer; are subjected to unusual physical stress or conditions (such as overloaded ramps or corrosion), natural disaster, governmental actions, wars, strikes, labor disputes, riots, theft, vandalism, terrorism or any reason beyond reasonable control; are damaged due to improper installation, misuse, abuse, accident or negligence in use, storage, transportation or handling, or tampering; or to products that are considered consumable items or items requiring repair or replacement due to normal wear and tear.

Product should be inspected prior to signing for delivery. Product damage incurred during shipping, unless noted on the Bill of Lading at the time of delivery, renders this warranty void.

LIMITED LIABILITY: In no event shall **THE AUTHORIZED DEALER** be liable to the purchaser or any third party for any indirect, incidental, consequential, special, exemplary or punitive damages arising out of the use of the product, including, without limitation, property damage, loss of value of the product or any third party products that are used in or with the product, or loss of use of the product or any third party products that are used in or with the product.