

KLUTCH™

3inch Battery Powered Disk Chipper Shredder Bare Tool Owner's Manual



⚠ WARNING: Read carefully and understand all ASSEMBLY AND OPERATION INSTRUCTIONS before operating. Failure to follow the safety rules and other basic safety precautions may result in serious personal injury.

Item # 6161948

READ & SAVE THESE INSTRUCTIONS

Thank you very much for choosing a KLUTCH® product!

For future reference, please complete the owner's record below:

Serial Number/Lot Date Code: _____

Purchase Date: _____

Save the receipt, warranty, and this manual. It is important that you read the entire manual to become familiar with this product before you begin using it.

3inch Battery Powered Disk Chipper Shredder Bare Tool designed for certain applications only. Northern Tool and Equipment is not responsible for issues arising from modification or improper use of this product such as an application for which it was not designed. We strongly recommend that this product not be modified and/or used for any application other than that for which it was designed.

For technical questions, please call 1-800-222-5381.

TECHNICAL SPECIFICATIONS

MODEL	6161948
WHEELBASE	28"(71.1cm)
CHIPPING CAPACITY	Ø3"(Ø7.6 cm) (side feed chute) Ø3/8"(Ø0.95 cm) (top-loading hopper)
CUTTERS	Double-edge chipper blades and quad hammer shredders
WHEELS & TIRES	ATV-locking 145/70-6 Ø13.5" (Ø34.9 cm) O.D.x5.25"(13.3 cm)
CHIPPER SHREDDER	Leaves, brush, garden compost
EXPULSION CHUTE	Adjustable

SAFETY CONVENTIONS



DANGER! This indicates a hazardous situation, which, if not avoided, will result in death or serious injury.



WARNING! This indicates a hazardous situation, which, if not avoided, could result in death or serious injury.



CAUTION! This indicates a hazardous situation, which, if not avoided, may cause minor or moderate injury.

ADDITIONAL INFORMATION AND POTENTIAL CHANGES

We reserve the right to discontinue, change, and improve our products at any time without notice or obligation to the purchaser. The descriptions and specifications contained in this manual were in effect at printing. Equipment described within this manual may be optional. Some illustrations may not be applicable to your machine.

IMPORTANT SAFETY INFORMATION



WARNING! Read and understand the complete User Manual before assembling or using this product. Failure to comprehend and comply with warnings, cautions and instructions for assembly and operation could result in serious injury or death.



WARNING! Do not permit children to operate this equipment at any time. Do not permit others that have not read and understood the complete User Manual to operate this equipment. Operation of power equipment can be dangerous. It is the sole responsibility of the operator to understand the assembly and safe operation of this product.



DANGER! INTENDED USE: Do not use this machine for any purpose other than chipping wood, for which it was designed. Any other use is unauthorized and may result in serious injury or death.



DANGER! PERSONAL PROTECTIVE EQUIPMENT: When operating this machine, it is essential that you wear safety gear including goggles or safety glasses, steel-toed shoes and tight-fitting gloves (no loose cuffs or draw strings). Always wear ear plugs or sound-deafening headphones to protect against hearing loss when operating this wood chipper.



CAUTION! Do not wear loose clothing or jewelry that can be caught by moving parts of the machine. Keep clothing and hair away from all moving parts of the machine.

GENERAL SAFETY INFORMATION

 **DANGER! GENERAL SAFETY:** Failure to follow warnings, cautions, assembly and operation instructions in the User Manual may result in serious injury or death.

 **DANGER! READ THE USER MANUAL BEFORE OPERATION**

- **Do not** permit children to operate this equipment at any time. Do not permit others that have not read and understood the complete User Manual to operate this equipment.
- Keep all people and pets a minimum of 12 feet (3.7m) away from the work area when operating this machine. Only the operator is to be near the machine during use.
- **Do not** operate the machine when under the influence of alcohol, drugs, or medication.
- **Do not** allow a person who is tired or otherwise impaired or not completely alert to operate this machine.



 **DANGER! WORK AREA**

- **Do not** operate the machine on icy, wet, muddy or otherwise slippery ground. **ONLY** operate your machine on level ground. **Operating on a slope could cause the machine to roll over, which could result in injury.**
- **Do not** operate the machine in an enclosed area. Exhaust fumes from the motor and battery contain carbon monoxide which can be harmful or deadly when inhaled.
- **Do not** move the machine over hilly or uneven terrain without a tow vehicle or adequate help.
- Use a tire chock or block on wheels to prevent movement of the machine while in operation.
- Operate the machine in daylight or under good artificial light.
- Keep the work area free of clutter. Remove chipped wood from around the machine frequently to avoid potential tripping.



 **DANGER!**

- **Make sure the operator knows how to stop and disengage the controls before operating.**
- **Do not place hands or feet inside the machine during operation. Serious injury or death could result.**
- **Do not** straddle or step over the machine during operation.
- **Do not** move the machine while the motor and battery are running
- **Never leave the equipment unattended while the motor and battery is running.** Shut off the motor and battery even if you are leaving the machine for a short period of time.
- Avoid contact with the motor during operation or after running to prevent burns.



 **WARNING! REPAIR AND MAINTENANCE**

- **Do not operate the machine when it is in poor mechanical condition or in need of repair.**

GENERAL SAFETY INFORMATION

Before each use, check that all nuts, bolts, and screws are tight.

- **Do not** alter the machine in any manner. Any alteration will void the warranty and could cause the machine to be unsafe to operate. Perform all recommended maintenance procedures before using the machine. Replace all damaged or worn parts immediately.
- **Do not** tamper with the motor and battery to run it at excessive speeds. The maximum motor and battery speed are preset by the manufacturer and is within safety limits.
- Remove the battery AC cable before performing any service or repair on the machine.



CAUTION! FIRE PREVENTION

- Do not smoke while operating this machine.
- Keep a Class B fire extinguisher on hand when operating this machine in dry areas as a precautionary measure against possible flying sparks.



CAUTION! IMPORTANT NOTE: This machine is equipped with an EV motor and lithium-ion battery and should not be used on or near any forest-covered, brush-covered, or grass-covered land. Please follow applicable local or state laws (if any). Inspect your motor and battery before each use to ensure the safety of the operator.



CAUTION! TOWING SAFETY

- Check all local and state regulations regarding towing, licensing, and lights before towing your machine.
- Check before towing to make sure that the machine is correctly and securely attached to the towing vehicle and that the safety chains are secured to the hitch or bumper of the vehicle with enough slack to allow turning. Always use a Class 1, 2" ball with this machine.
- **Do not** carry any cargo or wood on the machine.
- **Do not** allow anyone to sit or ride on the machine.
- Disconnect the machine from the towing vehicle before operating it.
- Use care when backing up with the machine in tow to avoid jack-knifing. Allow for added length of the machine when turning, parking, crossing intersections and in all driving situations.
- **Do not exceed 15mph (24km/h) when towing your machine.** Towing the machine at speeds higher than 15mph (24km/h) could result in loss of control, damage to the equipment, serious injury or death. Adjust towing speed for terrain and conditions. Be extra cautious when towing over rough terrain.



WARNING! PROPER MAINTENANCE AND STORAGE

- Keep machine, attachments, and accessories in safe working condition.
- Check motor and battery mounting bolts and other hardware before each use for proper tightness. **Never** operate your equipment in poor mechanical condition or when in need of repair. Be sure all safety guards and shields are in proper position. These safety devices are for your protection.
- Allow the motor and battery to cool before storing in any enclosure.
- If it is necessary for any reason to unclog the feed chute or discharge openings or to inspect or repair the equipment where a moving part can come in contact with your body or clothing, shut the machine off, allow all moving parts to come to a complete stop and

GENERAL SAFETY INFORMATION

allow the motor and battery to cool before attempting to unclog, inspect, or repair.

- Check the blade mounting screws before each use for proper tightness. Also visually inspect the blade for wear and damage. Replace the blade with parts that meet original equipment specifications.
- Blades should be checked for sharpness and the bolts attaching them to the flywheel for tightness before each operation.
- Replace the nylock nuts securing the blade every time you replace the blade.
- Check the gap between the blade and the wear plate every time you replace the blade.
- **Never** tamper with safety devices. Check their proper operation regularly.



CALIFORNIA PROPOSITION 65 WARNING: This machine is constructed with material which is known to the State of California to cause cancer and birth defects or other reproductive harm. Read more at <https://www.p65warnings.ca.gov/>.



WARNING! OPERATION

- **Never** place your hands, feet, or any part of your body in the chipper chute, discharge opening, or near or under any moving part while the motor and battery is running. Keep clear of the discharge opening at all times. If it becomes necessary to push material into the chipper chute, use a small diameter stick, **NOT YOUR HANDS**.
- Keep your face and body back from the chipper chute to avoid accidental bounce back of any material.
- If the cutting mechanism strikes a foreign object or if your machine should start making an unusual noise or vibration, immediately stop the motor and battery. After the machine has come to a complete stop proceed as follows:
 - Wait for all moving parts to come to a complete stop.
 - Inspect for any damage.
 - Repair or replace any damaged parts before restarting and operating the machine.
 - Exercise caution to avoid slipping or falling.
 - If the machine should start to vibrate abnormally, immediately stop the motor and battery, and wait for all moving parts to come to a complete stop and inspect for the cause. Vibration is generally a warning sign of trouble.
 - Stop the motor and battery when leaving the operating position, and when making any repairs, adjustments and inspections. **STAY CLEAR OF THE CHIP CHUTE AT ALL TIMES.**
- Take all possible precautions as recommended in this manual when leaving the machine unattended.
- Before cleaning, repairing, or inspecting, shut off the motor and battery and make certain the flywheel and all moving parts have come to a complete stop.
- Keep all guards and safety devices in place and operating properly. Do not operate the machine if all safety guards are not in place.
- **Do not** use the unit with the chipper hopper removed.
- **Do not** overload or attempt to chip material beyond 3 inches.
- Only use accessories approved for this machine by the manufacturer. Read, understand, and follow all instructions provided with the approved accessory.
- Only operate the equipment in good daylight. Do not operate this equipment at night or in dark areas where your vision may be impaired.



GENERAL SAFETY INFORMATION

- Use extreme caution when reversing or pulling the machine towards you. **NEVER** move the machine while it is running.
- **Do not** tamper with the motor and battery settings. Over-speeding the motor and battery is dangerous and will cause damage to the motor and battery and to the other moving parts of the machine.
- Start the motor and battery according to this User Manual's instructions. Keep hands and feet away from the inlet and discharge areas.
- **Do not** operate while under the use of alcohol, drugs, or medication. A clear mind is essential for safety.
- When feeding material into this equipment, be extremely careful that pieces of metal, rocks, or other foreign objects are not included. Personal injury or damage to the equipment could result.
- **Do not** allow an accumulation of processed material to build up in the discharge area as this will prevent proper discharge and can result in kick-back from the chipper chute.
- **Do not** allow any part of the motor and battery to become clogged with processed material, leaves, oil, grease or any other combustible material.



CHECK THE PACKING

Open and unpack all items, leave lots of working space, and inspect all parts.

.....

STEP 1: AXLE

Install the axle (45) with the hardware provided.

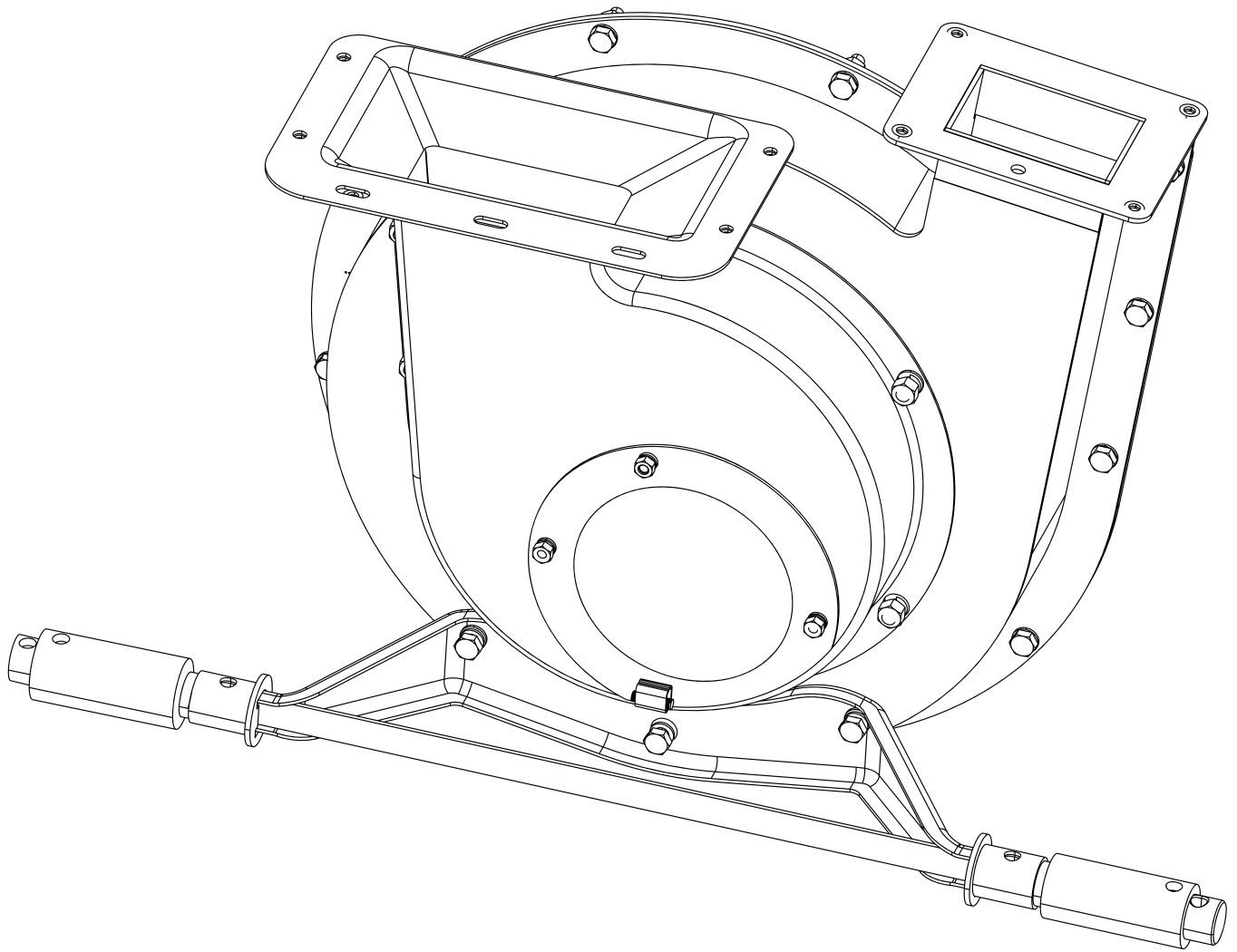

STEP 2: WHEELS

Install the wheels (44) using the hardware provided.



CAUTION! Use the locking pins in the axle to keep the wheels in place while chipping.

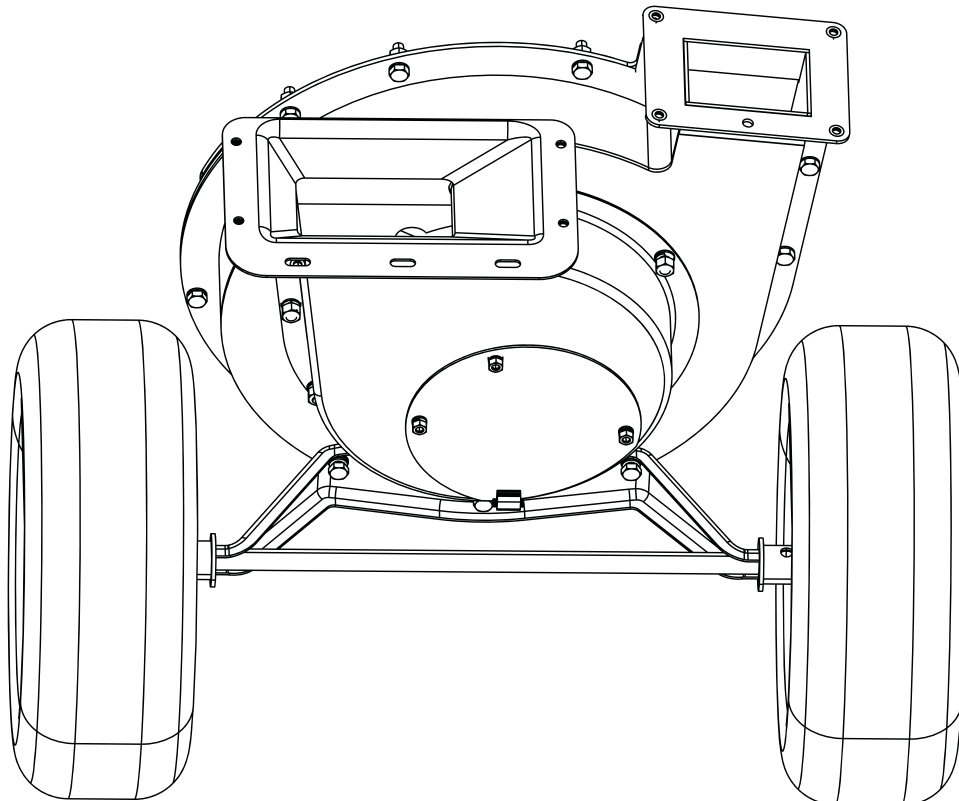
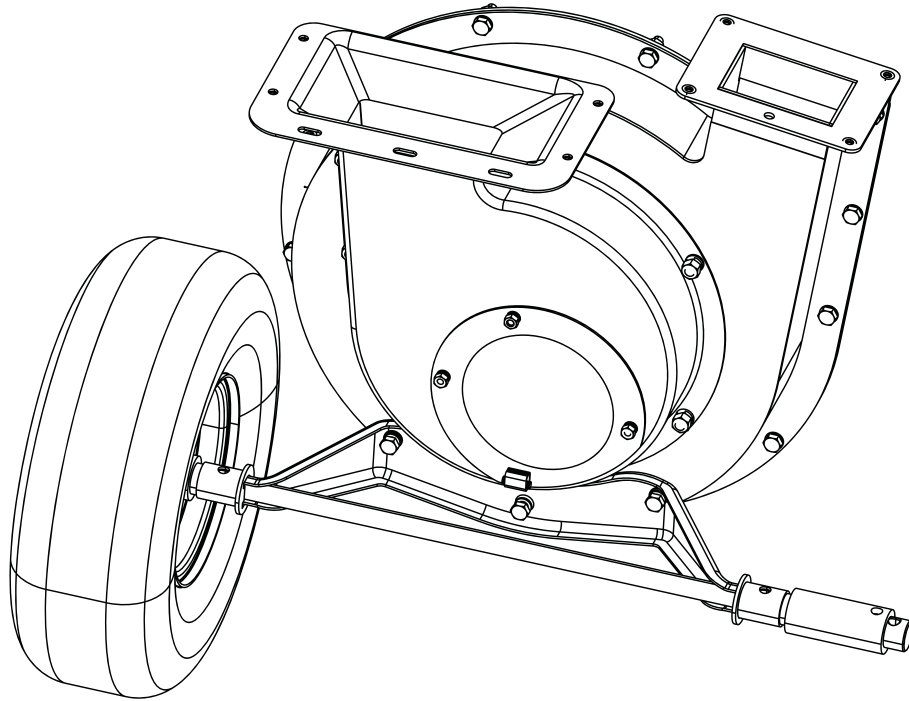

STEP 3: DROP STAND & TOW BAR

Install the drop stand (16) and tow bar (5) using the hardware provided.

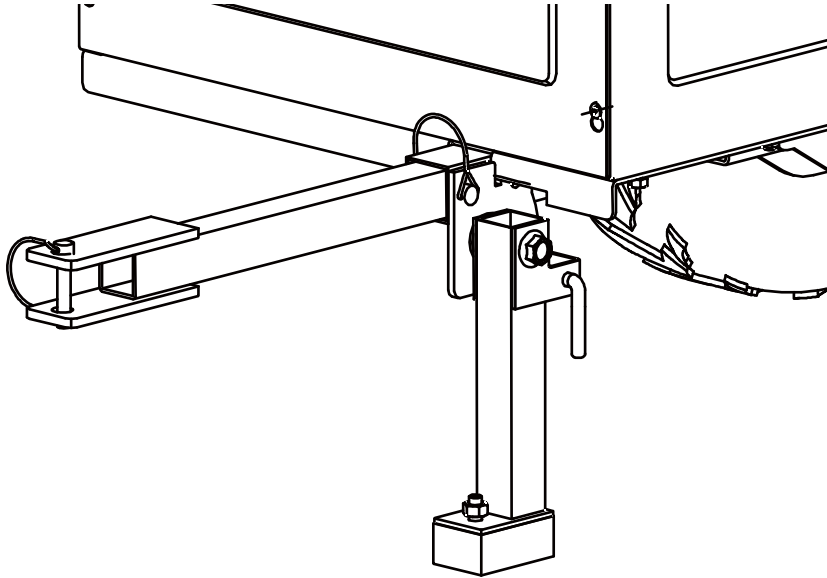

STEP 4: SIDE FEED CHUTE

Install the side feed chute (47) using the hardware provided.

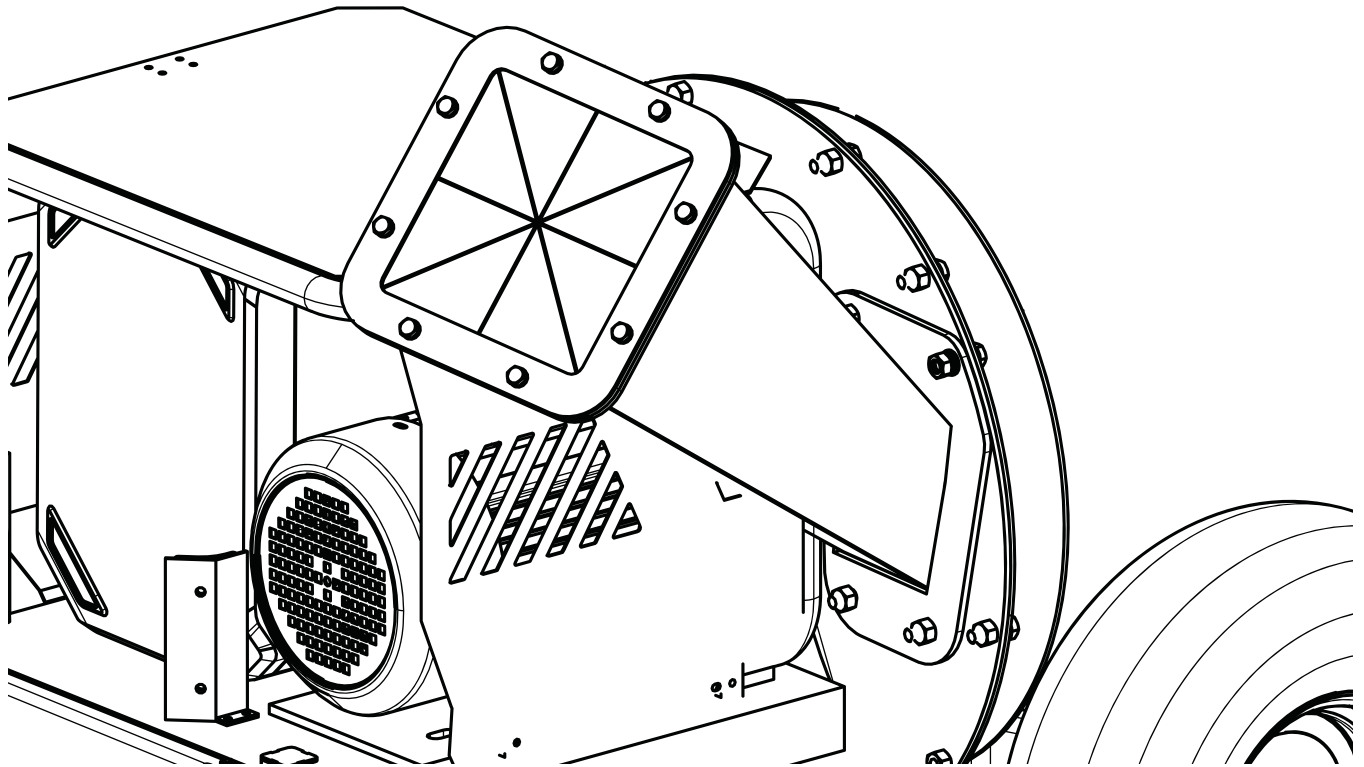

STEP 5: TOP-LOADING HOPPER HANDLE

Install the handle (42) to the top-loading hopper (39) using the hardware provided.

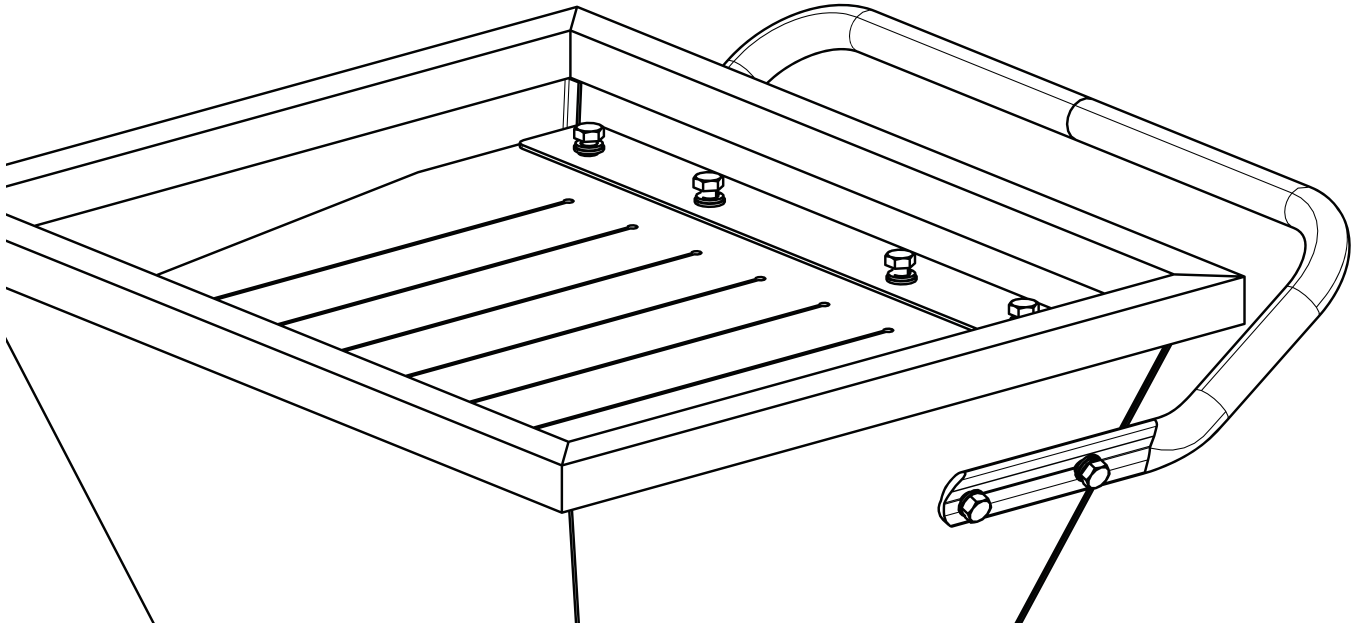

STEP 6: TOP-LOADING HOPPER

Mount the top-loading hopper (39) to the unit using the hardware provided.

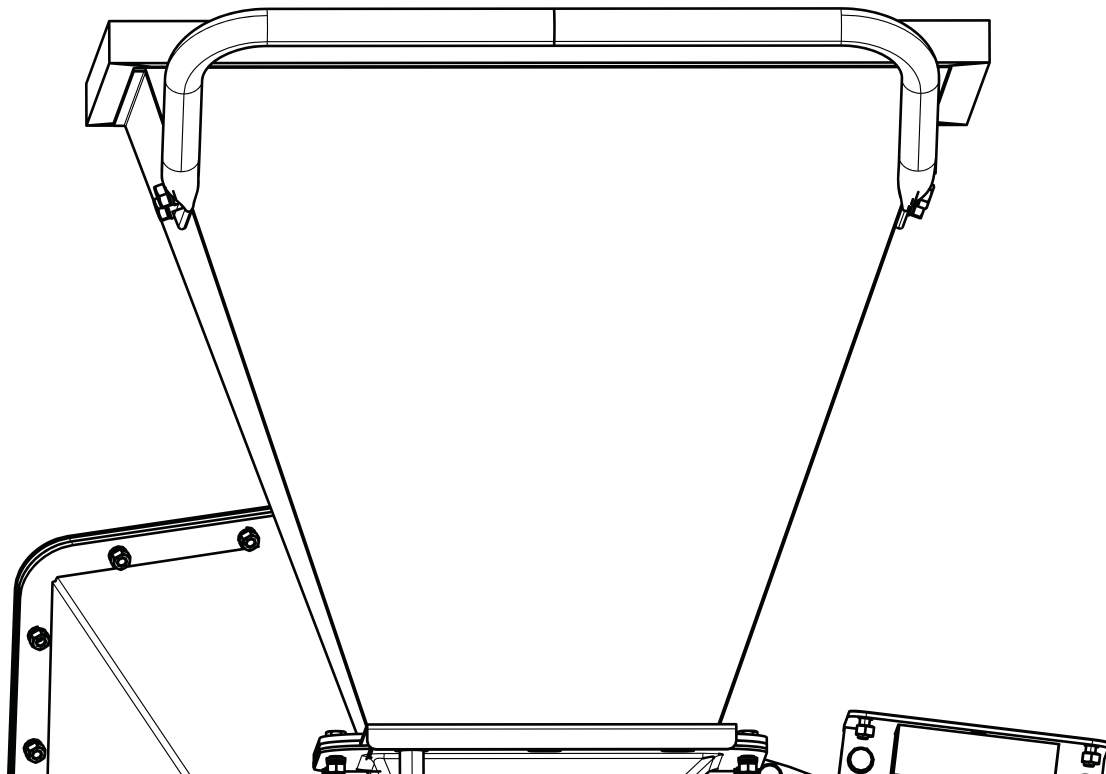

STEP 7: EXPULSION CHUTE

Install the expulsion chute (51, 52, 53) to the unit using the hardware provided.

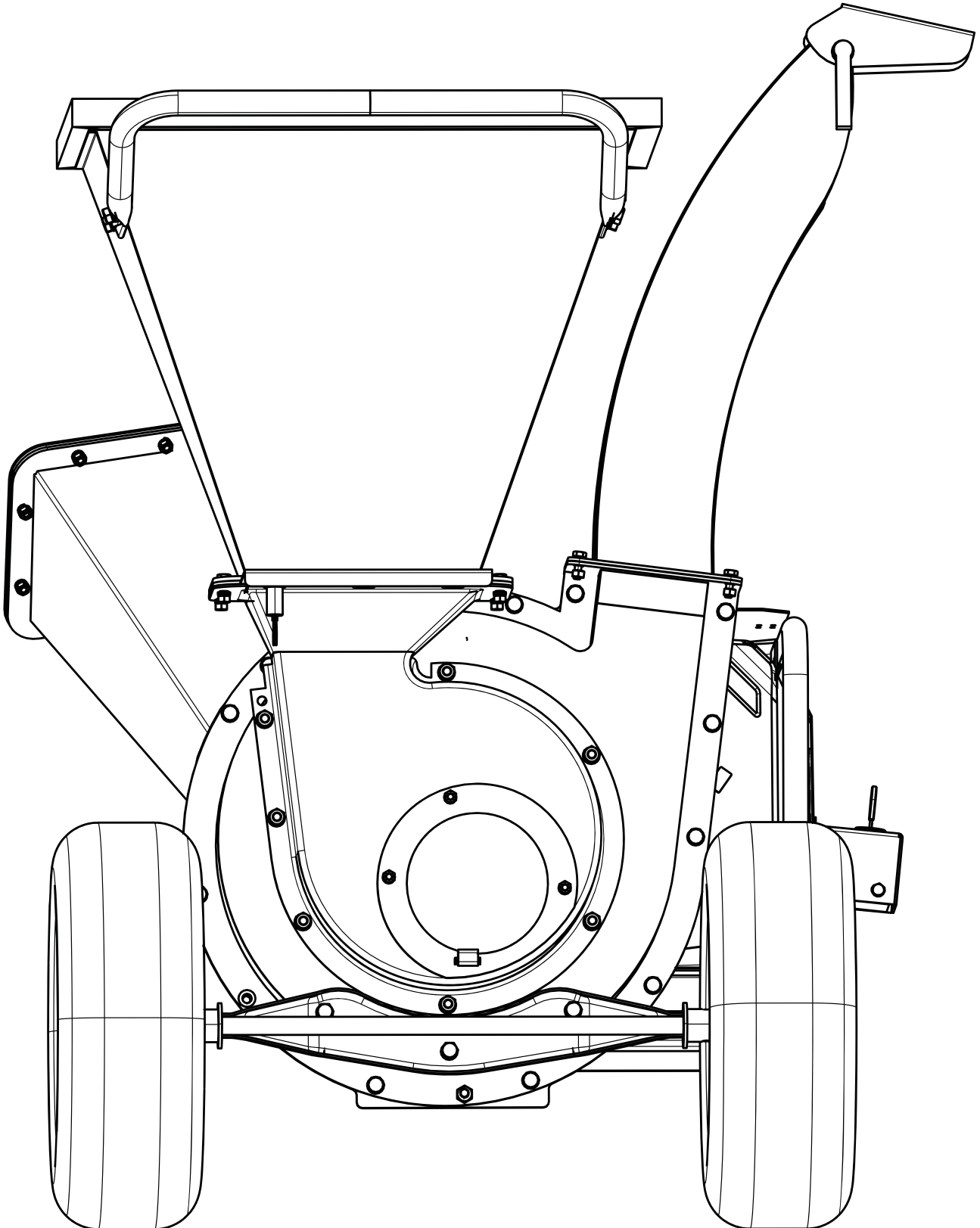

OPERATING INSTRUCTIONS



DANGER! Read and understand the complete User Manual before assembling or using this equipment! Failure to comprehend and comply with these warnings, cautions, and instructions for assembly and operation could result in serious injury or death.



DANGER! Do not permit children to operate this equipment at any time.



DANGER! Do not permit others that have not read and understood the complete User Manual to operate this equipment. Operation of the power equipment can be dangerous. It is the sole responsibility of the operator to understand the assembly and safe operation of this equipment.



WARNING! TOWING: Before towing, the safety chains must be secured to the hitch or bumper of the vehicle. Local regulations should be checked regarding licensing, lights, towing, etc. Turn the motor and battery off prior to towing. Do not exceed 15mph (24km/h) when towing this equipment. See also *Towing Safety in Section II • Safety in this User Manual.*

.....
Please refer to safety in this User Manual for an extensive list of warnings and precautions to follow prior to operating this equipment.
.....

STARTING THE MACHINE

1. Press the power button on the battery to turn on the power supply (FIG. 1).
2. Turn the switch key on the side of the battery and motor shroud (FIG. 2).

NOTE: Battery power level is shown on the battery, periodically check your battery power level.

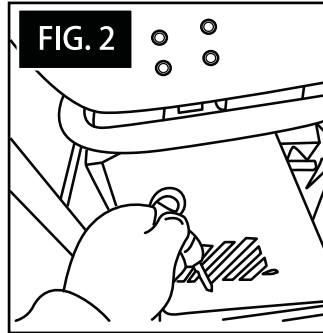
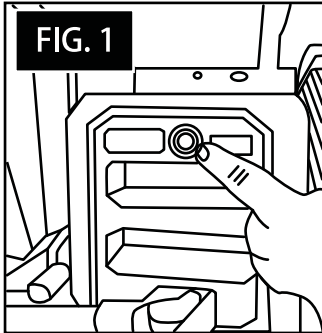

STOPPING THE MACHINE

1. Turn the switch key on the side of the battery and motor shroud to stop the motor (FIG. 4).
2. Press the power button on the battery to turn off the power supply (FIG. 5).

The machine will stop completely.

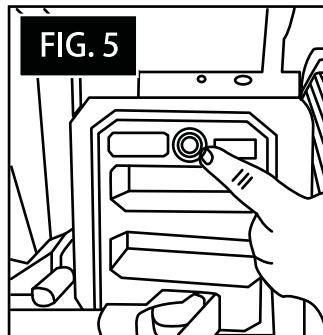
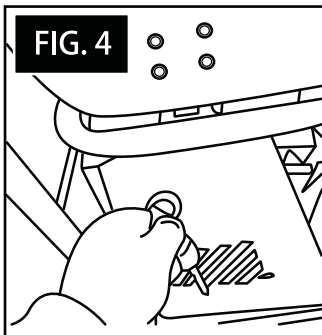

SCHEMATICS

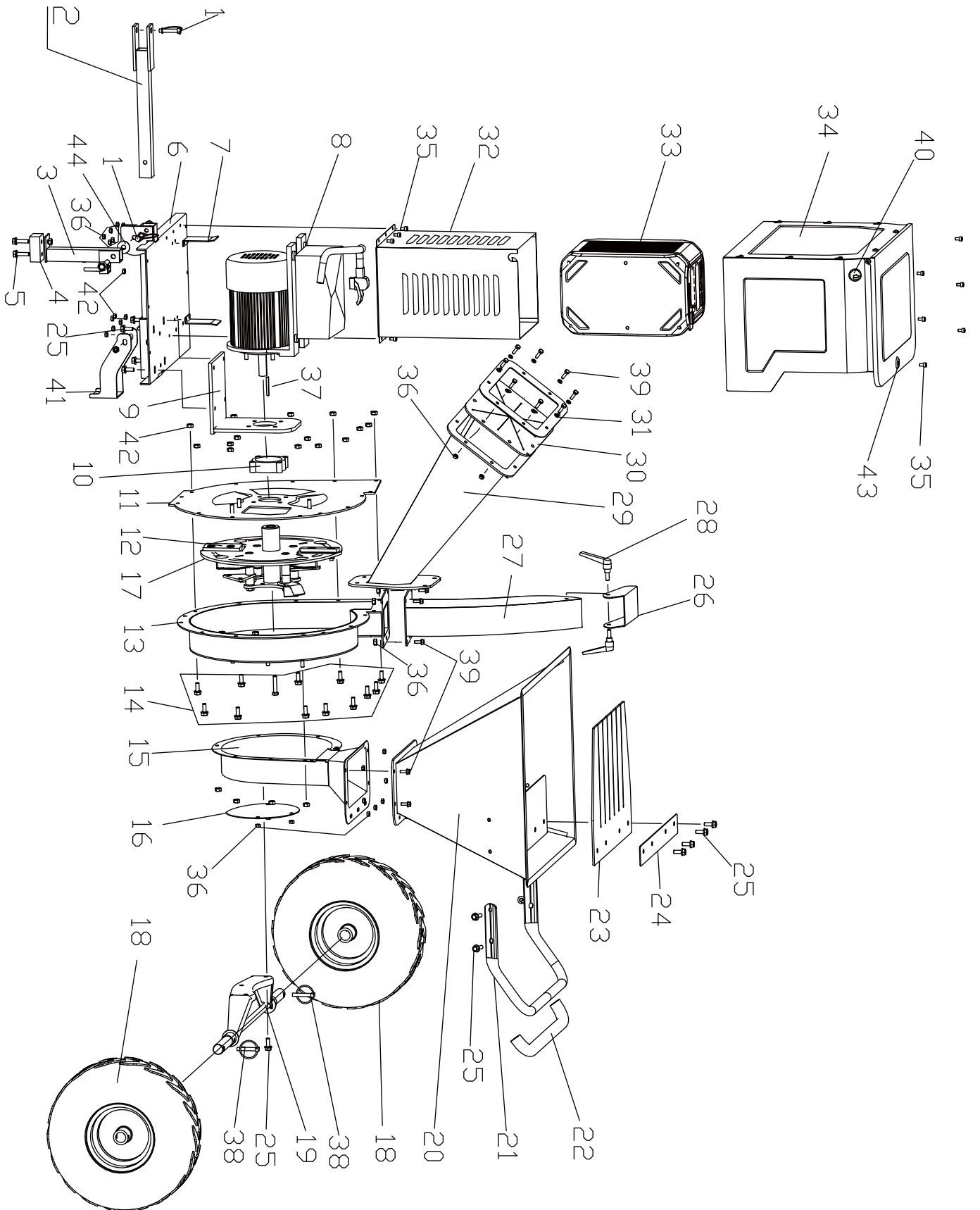

PARTS LIST

No.	Description	No.	Description
1	D-type latch 8x45	23	Splash Guard
2	Towbar	24	Pressure plate
3	Support feet	25	Hexagon bolts M8X25
4	Rubber feet	26	Discharge cover
5	Hexagon flange bolts M8X45	27	Discharge port components
6	Motor base assembly	28	Adjusting bolt M8X25
7	Battery fixing plate	29	Side feed port
8	Motor components	30	Splash Guard
9	Motor fixing plate	31	Pressure plate
10	Connection flange	32	Battery compartment
11	Crushing chamber fixing plate	33*	Battery
12	blade	34	Guard assembly
13	Large crushing room	35	Cylindrical head bolts M6X15
14	Hexagon flange bolts M8X30	36	Hexagonal nut M6
15	Small crushing room	37	Flat key 4.8x4.8x45
16	Cover	38	Round latch 8x45
17	Cutter assembly	39	Hexagon bolts M6X20
18	Tire 145/70-6	40	Electric door lock
19	Axle	41	U-shaped fixing plate
20	Large feed hopper	42	Hexagonal nut M8
21	Armrest	43	Cover lock
22	Handrail Tubing	44	Flat gasket 10x35

*Battery (33) sold separately.

REPLACEMENT PARTS

- For replacement parts and technical questions, please call Customer Service at 1-800-222-5381.
- Not all product components are available for replacement. The illustrations provided are a convenient reference to the location and position of parts in the assembly sequence.
- When ordering parts, the following information will be required: item description, item model number, item serial number/item lot date code, and the replacement part reference number.

The distributor reserves the rights to make design changes and improvements to product lines and manuals without notice.

LIMITED WARRANTY

Northern Tool and Equipment Company, Inc. ("We" or "Us") warrants to the original purchaser only ("You" or "Your") that the Klutch product purchased will be free from material defects in both materials and workmanship, normal wear and tear excepted, for a period of two years from date of purchase. The foregoing warranty is valid only if the installation and use of the product is strictly in accordance with product instructions. There are no other warranties, express or implied, including the warranty of merchantability or fitness for a particular purpose. If the product does not comply with this limited warranty, Your sole and exclusive remedy is that We will, at our sole option and within a commercially reasonable time, either replace the product or product component without charge to You or refund the purchase price (less shipping). This limited warranty is not transferable.

Limitations on the Warranty

This limited warranty does not cover: (a) normal wear and tear; (b) damage through abuse, neglect, misuse, or as a result of any accident or in any other manner; (c) damage from misapplication, overloading, or improper installation; (d) improper maintenance and repair; and (e) product alteration in any manner by anyone other than Us, with the sole exception of alterations made pursuant to product instructions and in a workmanlike manner.

LIMITED WARRANTY

Obligations of Purchaser

You must retain Your product purchase receipt to verify date of purchase and that You are the original purchaser. To make a warranty claim, contact Us at 1-800-222-5381, identify the product by make and model number, and follow the claim instructions that will be provided. The product and the purchase receipt must be provided to Us in order to process Your warranty claim. Any returned product that is replaced or refunded by Us becomes our property. You will be responsible for return shipping costs or costs related to Your return visit to a retail store.

Remedy Limits

Product replacement or a refund of the purchase price is Your sole remedy under this limited warranty or any other warranty related to the product. We shall not be liable for: service or labor charges or damage to Your property incurred in removing or replacing the product; any damages, including, without limitation, damages to tangible personal property or personal injury, related to Your improper use, installation, or maintenance of the product or product component; or any indirect, incidental or consequential damages of any kind for any reason.

Assumption of Risk

You acknowledge and agree that any use of the product for any purpose other than the specified use(s) stated in the product instructions is at Your own risk.

Governing Law

This limited warranty gives You specific legal rights, and You also may have other rights which vary from state to state. Some states do not allow limitations or exclusions on implied warranties or incidental or consequential damages, so the above limitations may not apply to You. This limited warranty is governed by the laws of the State of Minnesota, without regard to rules pertaining to conflicts of law. The state courts located in Dakota County, Minnesota shall have exclusive jurisdiction for any disputes relating to this warranty.

KLUTCH[®]

Distributed by:
Northern Tool & Equipment Company, Inc.
Burnsville, Minnesota 55306
www.northerntool.com

Made in China