

REAR TINE TILLER NV18DRTG QUICK START GUIDE



Jackson, Wisconsin
Website: www.novuspowerequipment.com
Email: Support@novuspowerequipment.com
Toll-Free Phone: 800-409-7802

2025 V01

2025 V01

UNPACKING

1. Remove banding and open the carton from top.
2. Remove the exterior sides of the carton by lifting upward and over the unit.
3. Remove all loose packed items and set aside. Do not discard packaging until you have confirmed the following components are present.

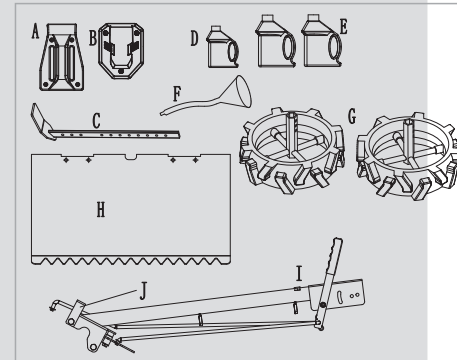

A	Control Cover Plate
B	Transmission Cover Plate
C	Drag Stake
D	Engine Oil Bottle
E	2 x Transmission Oil Bottles
F	Oil Funnel
G	2 x Wheels
H	Tine Shield
I	Lower Handle Tube
J	Transmission Cover Support Bracket

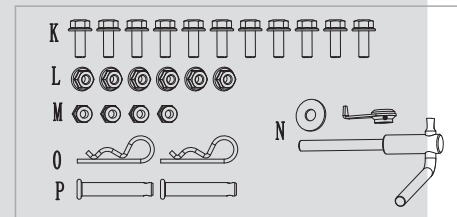

K	11x Hex Flange Bolt M6x16
L	6 x Hex Flange Nut M6
M	4 x Lock Nut M6
N	Handle Height Adjustment Bolt
O	2 x Cotter Pin
P	2 x Clevis Pin

Tools Kit Content: Tools Required

- 17 mm / 19 mm Wrench - Qty 2
- 13 mm / 16 mm Wrench - Qty 1
- 12 mm / 14 mm Wrench - Qty 1
- 8 mm / 10 mm Wrench - Qty 1



READ AND UNDERSTAND THE OPERATOR'S MANUAL AND ALL SAFETY WARNINGS BEFORE USE

Quick Start Guide Contents

- Unpacking / Package Contents
- Assembly Instructions
- Starting and Operating Procedures

If you require assistance during setup or operation of your new tiller, please contact our customer support team toll-free at (800) 409-7802 or email at support@novuspowerequipment.com

Please contact our customer support team at 1-800-409-7802 if any of the above loose parts are missing from the carton.

ASSEMBLY

Wheel Installation

Prior to the installation of the wheel & tire assemblies (1) identify the Right & Left side wheel. Note: Proper orientation is with the tread pattern forward facing “^” (see below). With assistance, lift the tiller unit upwards, install the wheel and tire assemblies onto the axle shaft. Align the hole closest to the wheel & tire assembly with the hole in the axle shaft and insert clevis pin (2), secure with cotter pin (3).

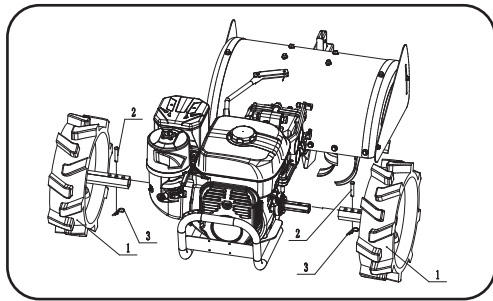

Attaching Lower Handle Tube

1. Set the upper handle assembly aside, carefully manage the cables to prevent pinching.
2. Remove the lower handle mounting hardware from transmission and set aside for use in installing the lower handle tube. (M12 Bolt, flat washer, lock washer and nut)

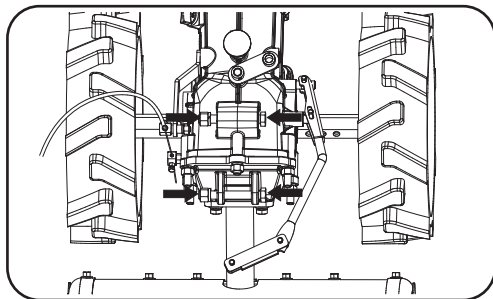

1

3. Using the two M12 bolts, nuts and washers (3,4,5) set aside above, install the lower handle tube (1) and cover support bracket (2). While setting the lower handle tube into place on the tiller gearbox it is important to install the wheel speed shift rod end (6) into the transmission shift lever linkage (7) and secure it into place with a cotter pin. Tighten bolts with 19mm wrench. Note: Make sure the cover support bracket (2) is installed perpendicular to the transmission prior to fully tightening the bolts.
4. Connect the tine shift arm (8) to the pivot bracket using the supplied clevis (9) and cotter pin (10).

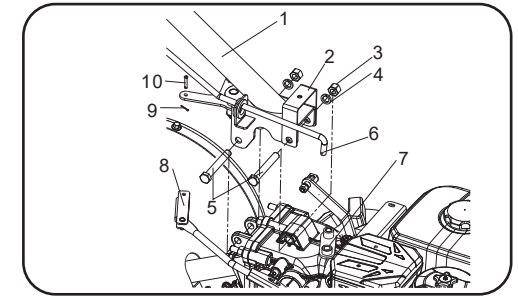

5. Remove the bolt and lock nut from upper handle tube and set aside.

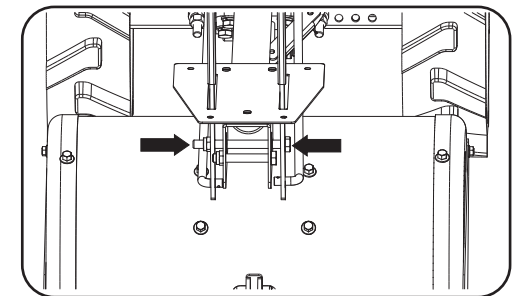

6. Install the upper handle using the bolt and locknut removed in step 5. Note: The On/Off switch - throttle control is on the top, the tine engagement bail is below the handle. Attention must be given to ensure the cables are not twisted or caught in the linkage.

7. Install the upper handle height adjustment bolt into the slotted hole of the upper handle tube. When tightening ensure the black locking nut tang is engaged in the hole of the upper handle tube. (as shown)

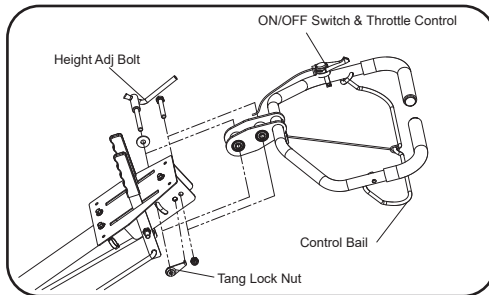

8. Route the cable and wires under the lower handle assembly and through the wire retention clips under the center of the handle tube. Note: It may require the removal of the cotter pins from the upper transmission shift linkage to properly run the cable and wires.

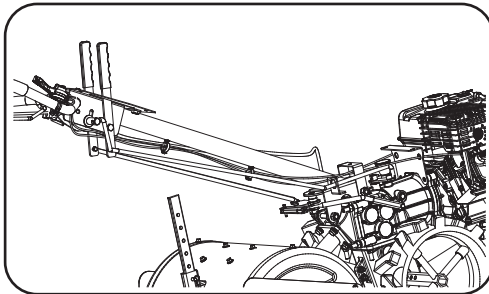

9. Verify the Yellow and Black ignition shut-off wires are connected at the engine (Left side) Wrap the ignition wires in place using the wire retention clip on the engine.

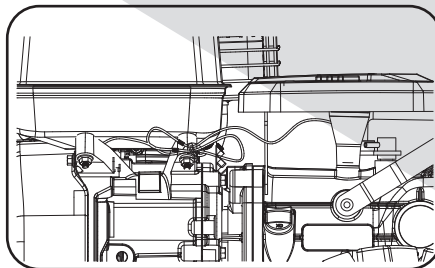
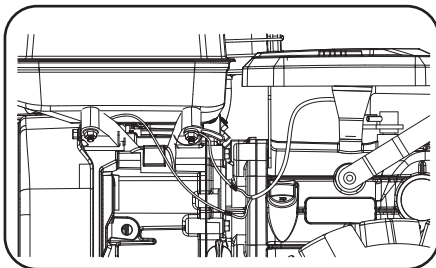

3 Install transmission and control panel cover plates.

1. Install the transmission cover plate (B) using 3 X Hex Flange Bolt (K) and 2 X Hex Flange Nuts (L).

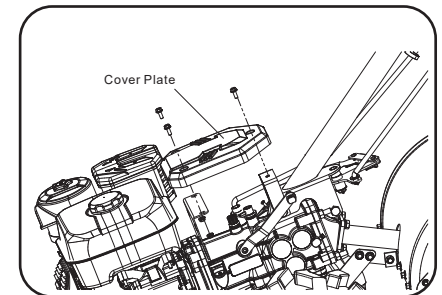

2. Install upper control cover plate (A) with 4 x Hex Flange Bolts (K) and 4 x Hex Flange Nuts (L).

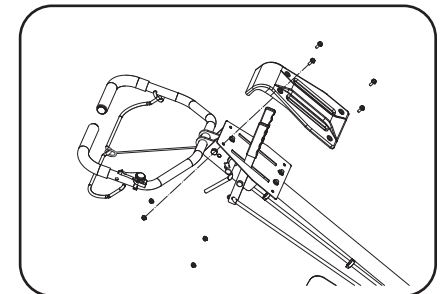

Install the Tine Shield

- Install the Tine Shield (H) using 4 X Hex Flang Bolts (K) and 4 X Lock Nuts (M).

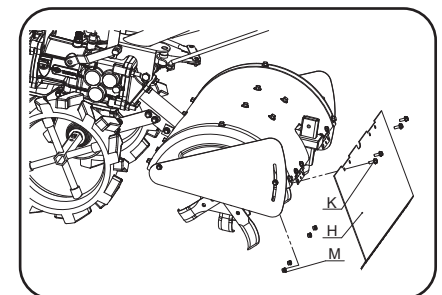

4

Install Drag Stake

Remove the drag stake clevis pin which is preinstalled in the drag stake pocket at the rear of the tiller. Insert the drag stake (C) with the foot facing back. Reinstall the clevis and cotter pin.

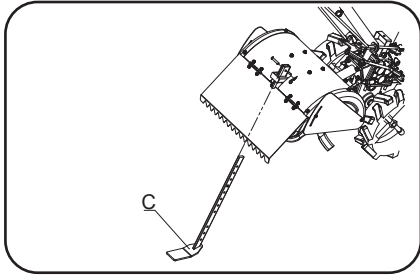

Add Engine Oil

1. Place the unit on a flat, level surface.
2. Remove the engine oil dipstick by turning counterclockwise
3. Using a funnel, add up to 20 fl. oz. (0.6 L) (D) of oil to the engine. The oil should be near the top thread of the filler neck.
4. Check the oil level using the dipstick. DO NOT screw in when checking.
5. When finished screw in the dipstick securely.

Add Transmission Oil

1. Place the unit on a flat, level surface.
2. Remove the transmission oil dipstick by turning counterclockwise.
3. Using a funnel (F), add 2.1qts (68oz) of SAE 10W-30 oil (E) at the transmission dipstick / oil pug location.
4. Check the oil level using the dipstick. Do Not screw the dipstick in when checking.
5. When finished screw in the dipstick securely.

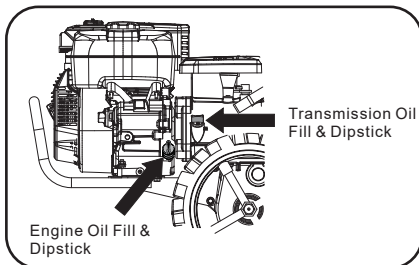

5

8

6

7

Starting and Operating Procedures

1. Remove the fuel cap and slowly add fresh, regular unleaded gasoline to the tank until it reaches the fuel level indicator of the fuel screen. DO NOT overfill.
2. Replace and tighten the fuel tank cap.
3. Immediately wipe up any spills.

Starting & Operation

Starting the Engine

1. Place the tiller on a flat, level surface.
2. Place both shift handles (Tine & Wheel drive) into a neutral position.
3. Turn engine ON / OFF switch to the "ON" position (located on right side upper handlebar).
4. Rotate the throttle lever forward until it stops in the high-speed position.
5. Slide the Choke lever on engine fully to the left (Full Choke position).
6. Slide Fuel Valve fully to the right (Open position).
7. Pull the starter handle slowly until resistance felt, then pull rapidly.
8. Once the engine starts slide the choke lever to the Off position.

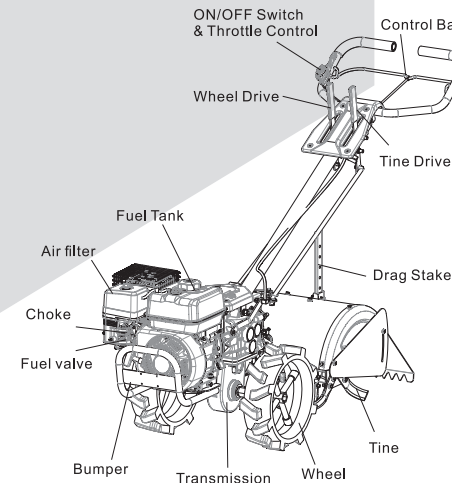
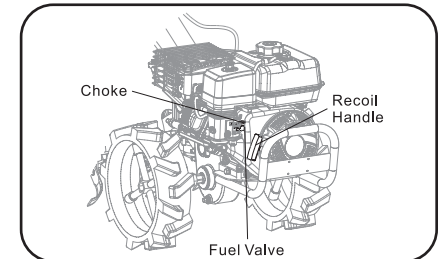
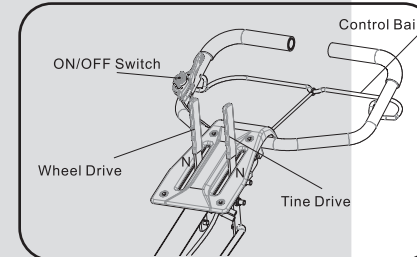

Operating the Tiller

1. Shift both the wheel drive and tine rotation levers into the desired gear.
2. Lift up on the control bail to engage. Release to stop.