

iron ton®

300' Garden Hose Reel Cart

Owner's Manual



! WARNING: Read carefully and understand all ASSEMBLY AND OPERATION INSTRUCTIONS before operating. Failure to follow the safety rules and other basic safety precautions may result in serious personal injury.

Item #6118085

READ & SAVE THESE INSTRUCTIONS

Thank you very much for choosing a **IRONTON** product!

For future reference, please complete the owner's record below:

Serial Number/Lot Date Code: _____

Purchase Date: _____

Save the receipt, warranty, and this manual. It is important that you read the entire manual to become familiar with this product before you begin using it.

This product is designed for certain applications only. Northern Tool & Equipment is not responsible for issues arising from modification or improper use of this product such as an application for which it was not designed. We strongly recommend that this product not be modified and/or used for any application other than that for which it was designed.

For technical questions, please call **1-800-222-5381**.

Table of Contents

Intended Use 4

Technical Specifications 4

Important Safety Information 4

Cution 6

Assembly Instructions 7

Diagram & Parts LIST 11

Intended Use

This Ironton Heavy-duty hose reel cart has a strong tubular steel frame, foam-padded handle and tires for easy maneuverability. Holds up to 300 feet of garden hose for easy reach to about anywhere in your yard.

Technical Specifications

Property	Specification
Capacity	300 feet of 5/8in. hose (not included)
Tires	10in. pneumatic
Construction	Tubular powder-coat steel frame

Important Safety Information

⚠️WARNING

- Read and understand all instructions. Failure to follow all instructions may result in serious injury or property damage.
- The warnings, cautions, and instructions discussed in this manual cannot cover all possible conditions or situations that could occur. It must be understood by the operator that common sense and caution are factors which cannot be built into this product, but must be supplied by the operator.
- Do not allow persons to operate or assemble the product until they have read this manual and have developed a thorough understanding of how it works.
- Do not modify this product in any way. Unauthorized modification may impair the function and/or safety and could affect the life of the product. There are specific applications for which the product was designed.
- Use the right tool for the job. DO NOT attempt to force small equipment to do the work of larger industrial equipment. There are certain applications for which this equipment was designed. It will be a safer experience and do the job better at the capacity for which it was intended. DO NOT use this equipment for a purpose for which it was not intended.

⚠️WARNING

- This product may contain chemicals known to the state of California to cause cancer, birth defects, or other reproductive harm.
- Some dust created by power sanding, sawing, grinding, drilling, and other construction activities contains chemicals known to the state of California to cause cancer, birth defects, or other reproductive harm. Some examples of these chemicals are:
 - - lead from lead-based paints,
 - - crystalline silica from bricks and cement and other masonry products, and

- arsenic and chromium from chemically treated lumber.

- Your risk from these exposures varies, depending on how often you do this type of work. To reduce your exposure to these chemicals: work in a well-ventilated area, and work with approved safety equipment, such as dust masks that are specially designed to filter out microscopic particles.
- Handling power cords on corded products may expose you to lead, a chemical known to the state of California to cause cancer and birth defects or other reproductive harm. Wash your hands after handling.

WORK AREA

- **Keep work area clean**, free of clutter and well lit. Cluttered and dark work areas can cause accidents.
- **Keep children and bystanders** away while operating a Hose Reel Cart and Hose, Distractions can cause you to lose control, so visitors should remain at a safe distance from the work area.
- **Be aware of all power lines, electrical circuits, water pipes and other mechanical hazards** in your work area, particularly those hazards below the work surface hidden from the operators view that may be unintentionally contacted and may cause personal harm or property damage.
- **Be alert of your surroundings.** Using a Hose Reel Cart and Hose in confined work areas may put you dangerously close to cutting tools and rotating parts.

PERSONAL SAFETY

- **Stay alert**, watch what you are doing and use common sense when using a Hose Reel Cart and Hose. Do not use a Hose Reel cart and Hose while you are tired or under the influence of drugs, alcohol or medication. A moment of inattention while operating a hose reel may result in serious personal injury.
- **Dress properly.** Do not wear loose clothing, dangling objects, or jewelry. Keep your hair, clothing and gloves away from moving parts. Loose clothes, jewelry or long hair can be caught in moving parts.

⚠ CAUTION

PRODUCT USE AND CARE

- **Do not modify the Hose Reel Cart in any way.** Unauthorized modification may impair the function and/or safety and could affect the life of the equipment. There are specific applications for which the Hose Reel Cart was design.
- **Always check of damaged or worn out parts before using the Hose Reel Cart.** Broken parts will affect operation. Replace or repair damaged or worn parts immediately.
- **Use the Hose Reel Cart on flat and level surfaces.** Pulling or pushing a load on a slanted or uneven surface can result in loss of control.
- **This Hose Reel Cart is not a toy.** Never allow children to play or ride on the Hose Reel Cart.
- **Store idle Hose Reel Cart.** When Hose Reel Cart is not in use, store it in a secure place out of the reach of children. Inspect it for good working condition prior to storage and before re-use.

ASSEMBLY (See Parts List And Hardware List in back of this manual)

ASSEMBLY INSTRUCTIONS

1. (SEE FIGURE 1) Place Frame (A1) into Frame (A2), and then attach two Support Brackets (K) on both sides Frame (A1 & A2), and fix them with two sets of Bolts (6), Flat Washers (12), and Lock Nuts (11).

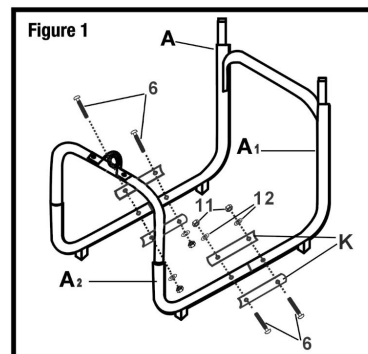

2. (SEE FIGURE 2) Stand assembled Frame (A) upright and slide each Axle (B) through both ends of Frame (A).

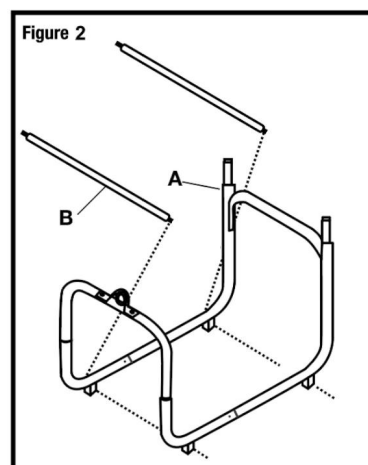

3. (SEE FIGURE 3) Slide Wheels (C) onto ends of each Axle (B), with the wheel valve stems facing outward. Fasten each wheel to axle using Flat Washers (10) and Lock Nuts (9). Do not over tighten.

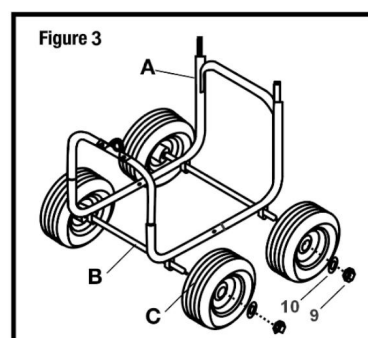

4. (SEE FIGURE 4) Insert the end of Crank Handle (E) through crank hub of Frame (A). Fasten Crank Hub to Frame (A) with carriage bolts (2) Flat Washers (12), and Lock Nuts (11).

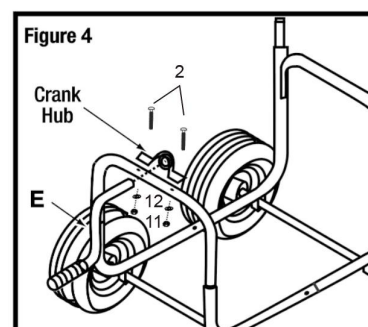

- (SEE FIGURE 5) Attach the first Hose Reel (D) to the Roller (I), on the end with the crank handle stem, using six Bolts (5). On the opposite end of the Roller (I), insert the Water Coupling (J) into the center hole of the reel and roller. Place the U Bracket (13) over the tubing of the Water Coupling (J). Use seven Bolts (5) to attach the U Bracket (13), Water Coupling (J), and Reel (D) to the Roller (I).

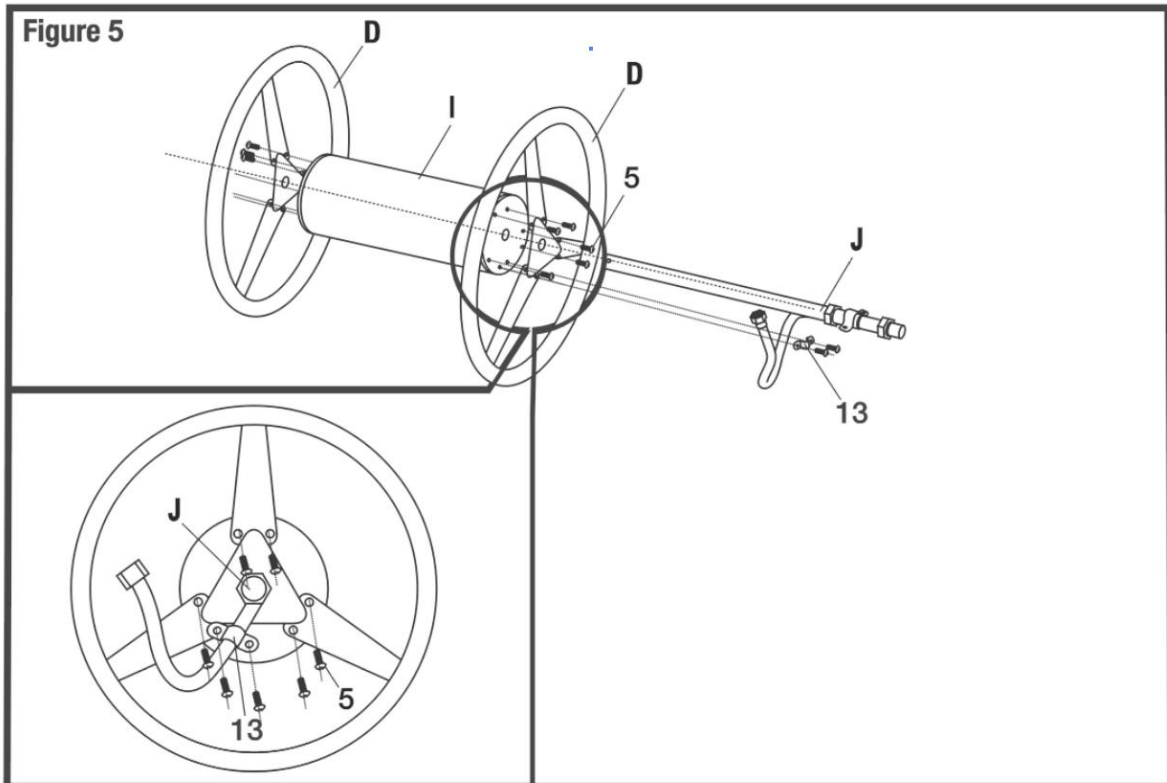

- (SEE FIGURE 6) Place Hose Reel (D) into assembled Frame (A). Insert end of crank stem from Hose Reel (D) onto Crank Handle (E). Align Crank Handle (E) mounting holes with crank stem mounting holes.

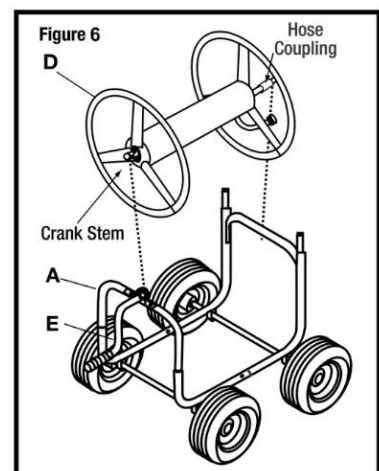

- (SEE FIGURE 7) Insert Bolt (3) through inside hole of crank stem and crank handle hole, Place Flat Washer (12) onto Bolt (3) fasten with Lock Nut (11). Insert Bolt (3) through outside hole of crank stem and crank handle hole and fasten with Lock Nut (11). Tighten all fasteners securely.

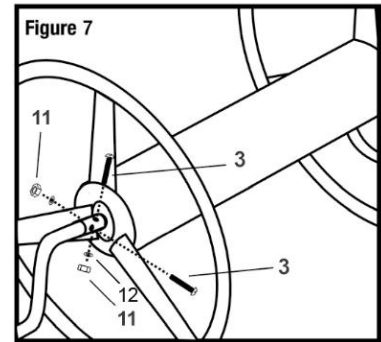

- (SEE FIGURE 8) Attach hose coupling end of Hose Reel (D) to Frame (A), using U-Bracket. Fasten U-Bracket to frame with carriage bolts (1), Flat washers (12), and Lock Nuts (11). Tighten securely.

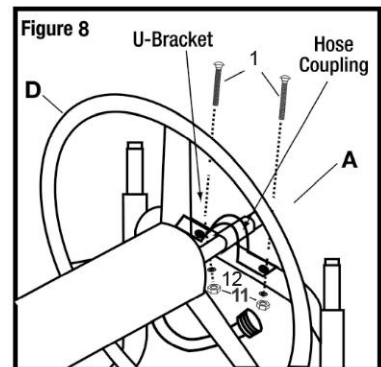

- (SEE FIGURE 9) Place handle (F) onto vertical posts of frame (A). Align mounting holes and slide Bolts (2) through mounting holes and place Flat Washer (12) onto Bolt (2). Fasten Handle (F) using Flat washers (12), and Lock Nut (11).

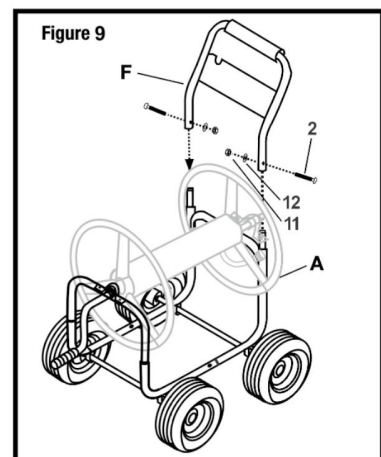

- (SEE FIGURE 10) Attach Accessories Basket (H) to handle (F). Place the Bolt (4) through mounting holes of Handle (F). Place Accessories Basket (H) mounting tabs onto Bolts (4) then place flat washer (8) onto both bolts. Fasten basket using hex nuts (7).

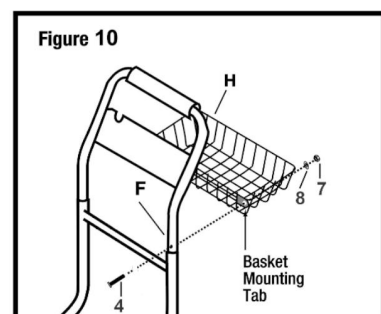

11. (SEE FIGURE 11) Place Rubber Washer (14) into the female end of Water Coupling (J) on Hose Reel (D) drum. Attach one end of Leader Hose (G) to Water Coupling (J) on Hose Reel (D) drum. Attach the other end of Leader Hose (G) to the water supply spigot. Attach garden hose to threaded garden hose connector and wind garden hose around Hose Reel (D).

NOTE: The hose reel will hold up to 300' of 5/8" garden hose.

(Garden Hose Not Included)

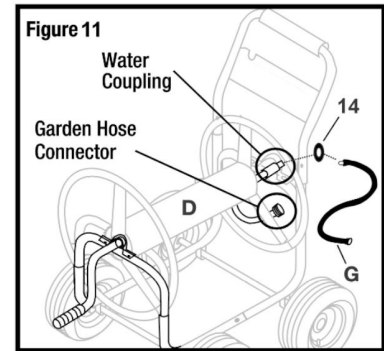

MAINTENANCE

Maintain your Hose Reel Cart. It is recommended that the general condition of the Hose Reel Cart be examined before it is used. Keep your Hose Reel Cart in good repair by adopting a program of conscientious repair and maintenance. Have necessary repairs made by qualified service personnel.

DIAGRAM & PARTS LIST

PARTS LIST		
PART#	DESCRIPTION	QUANTITY
A1	Frame	1
A2	Frame	1
B	Axles	2
C	Wheels	4
D	Hose Reel	2
E	Crank Handle	1
F	Handle	1
G	Leader Hose	1
H	Accessories Basket	1
I	Roller	1
J	Water Coupling	1
K	Support Brackets	4
L	Crank Hub	1

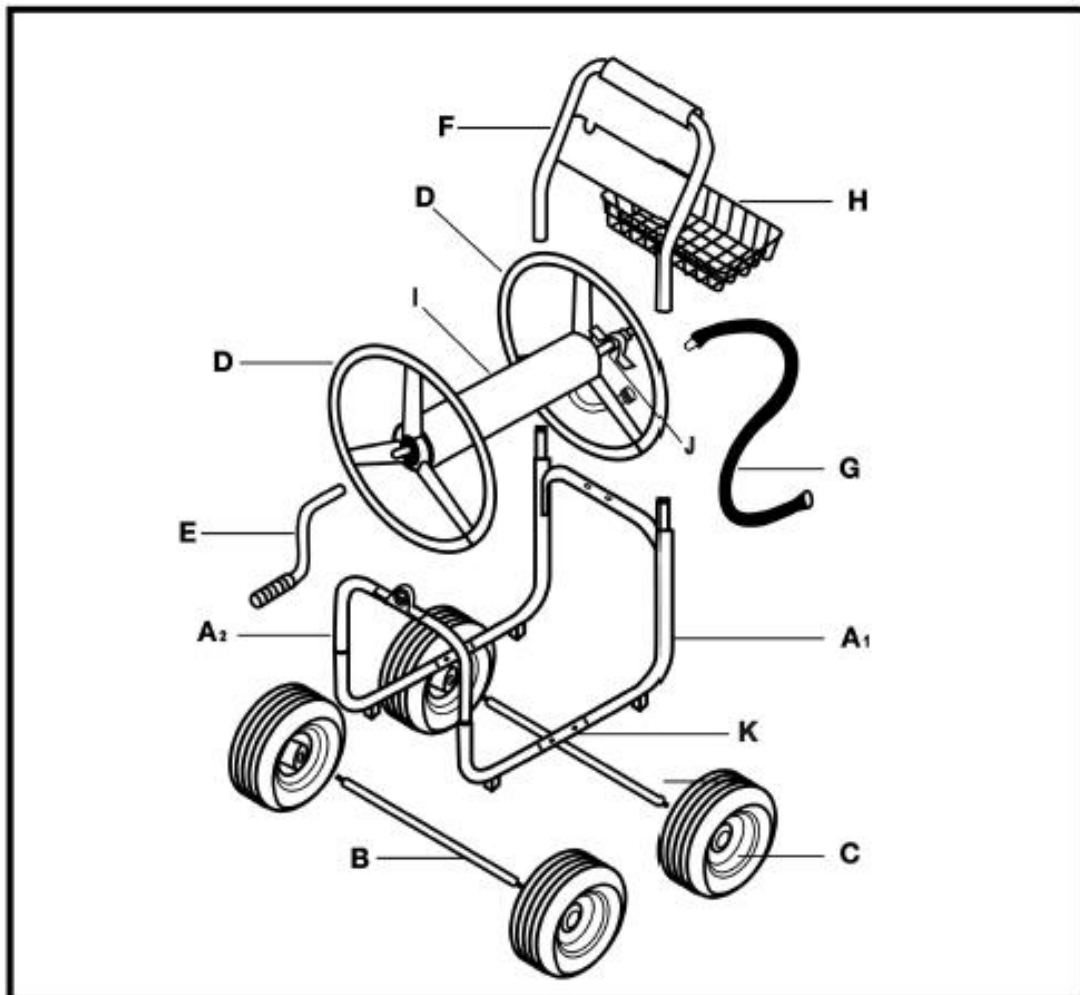

HARDWARE LIST		
PART#	DESCRIPTION	QUANTITY
1	Carriage Bolt, 6*35mm	2
2	Carriage Bolt, 6*42mm	4
3	Bolt, 6*30mm	2
4	Bolt, 8*45mm	2
5	Bolt, 5*15mm	13
6	Bolt, 6*45mm	4
7	Hex Nut, 8mm	2
8	Flat washer, 8mm	4
9	Lock Nut, 12mm	4
10	Flat washer, 12mm	4
11	Lock Nut, 6mm	10
12	Flat washer, 6mm	10
13	U Bracket	1
14	Rubber Washer (Includes 1-Spare Rubber Washer)	2

Carefully remove the contents from the package. If any parts are missing do not attempt to use the product until they have been obtained and correctly installed.

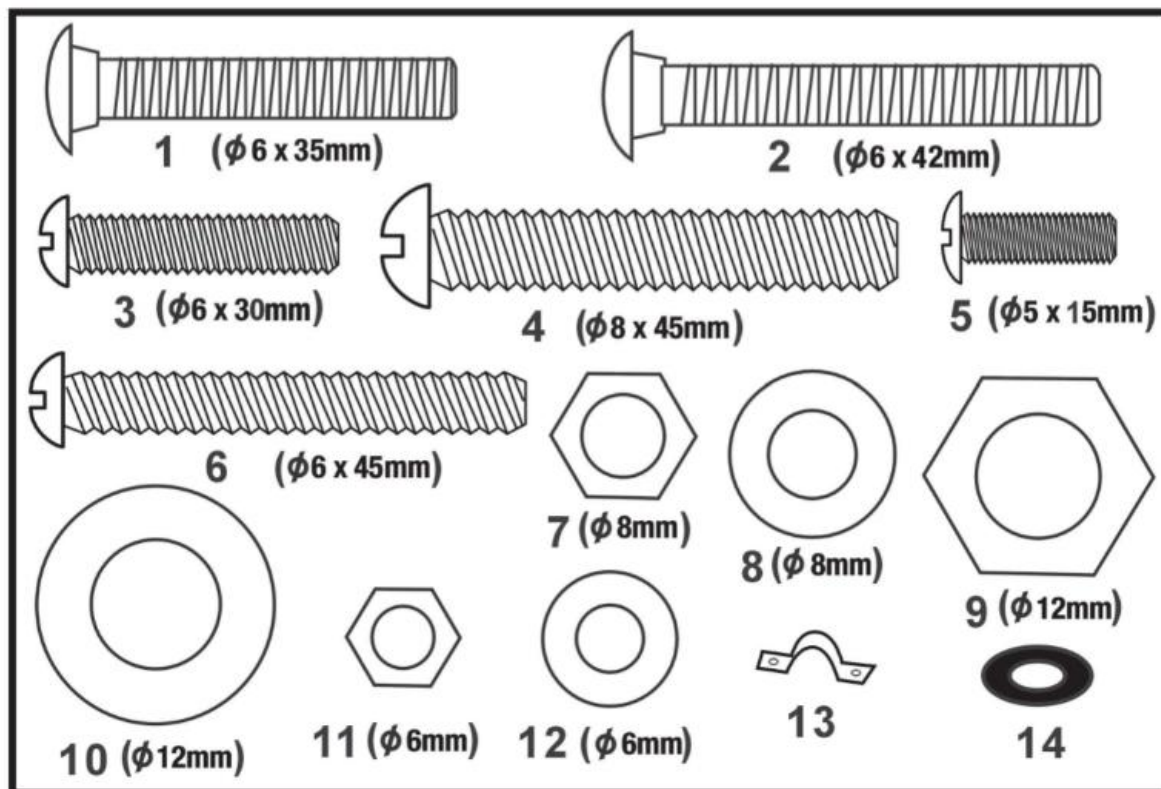

For replacement parts and technical question, please call 1-800-222-5381.

iron ton[®]

Distributed by:

Northern Tool & Equipment Company, Inc.

Burnsville, Minnesota 55306

www.northerntool.com

Made in Vietnam