

PROPER BLADE INSTALLATION

Following these steps will ensure the proper blade setup for your TrenchBadger Pro. Failure to follow these procedures could damage gearbox **and void warranty.**

STEP 1. Follow blade assembly diagram to install blade, washers and castle nut. Don't install cotter pin yet.

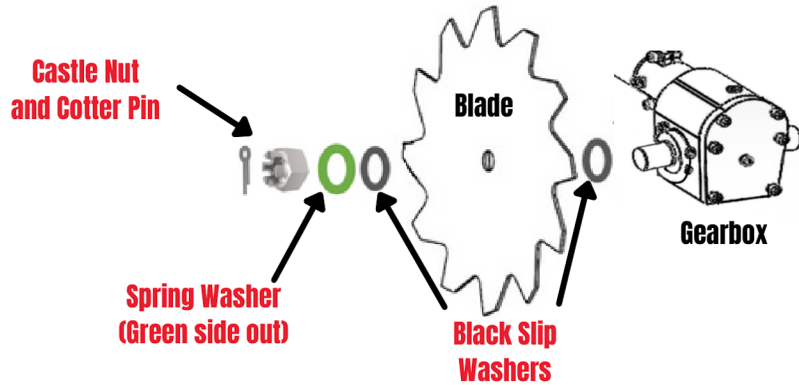

STEP 2. ONLY using your HAND, tighten castle nut until it stops.

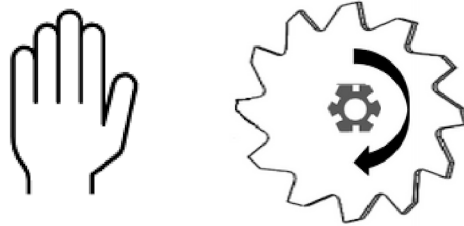

STEP 3. Rotate output shaft until arbor hole aligns between shoulder screws and insert Lock Pin.

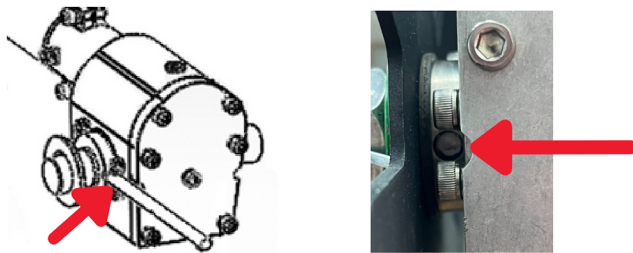

STEP 4. Using a torque wrench, torque Castle Nut to 18-20 ft-lbs, and align slot in Castle Nut with closest hole in Output Shaft.

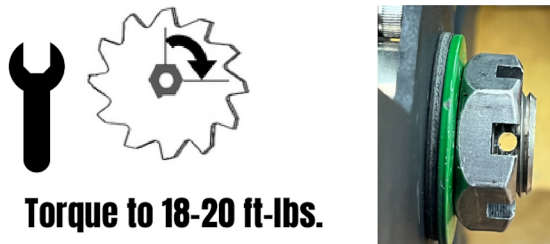

WARNING: Over-tightening Castle Nut will not allow blade to slip when hitting hard objects. This will damage gearbox and void the warranty.

STEP 5. Fully insert Cotter Pin through slot/hole. Split and bend one leg over Output Shaft and the other leg back toward blade.



www.trenchbadger.com



contact@trenchbadger.com



866-887-3624

HOW TO REPLACE A GEARBOX

Follow the "Proper Blade Installation" steps backwards to remove the blades from the unit. Once the blades are removed, follow these steps to replace your gearbox.

REMOVING OLD GEARBOX

STEP 1. Place unit on flat surface and remove the 3 bolts securing the gearbox to the pole.

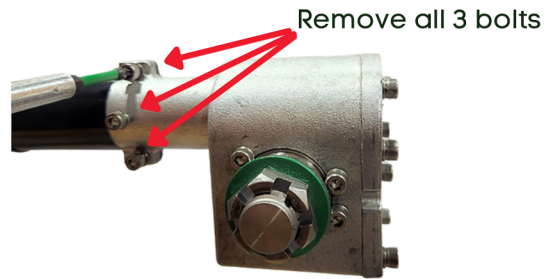

STEP 2. Hold the pole with one hand and pull gearbox away from the pole with the other hand.

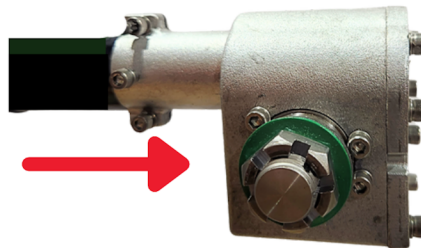

INSTALLING NEW GEARBOX

STEP 3. Install new Gearbox and make sure driveshaft is fully inserted into the gearbox (you may need to slightly rotate gearbox to align driveshaft with gearbox)

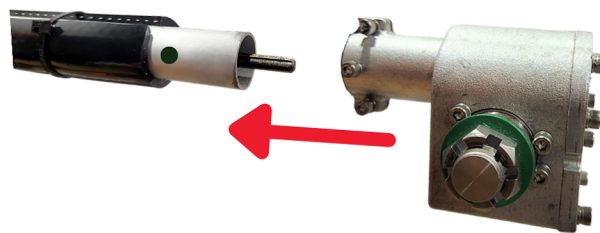

STEP 4. Remove middle bolt in the gearbox and confirm the hole is aligned with hole in the pole.

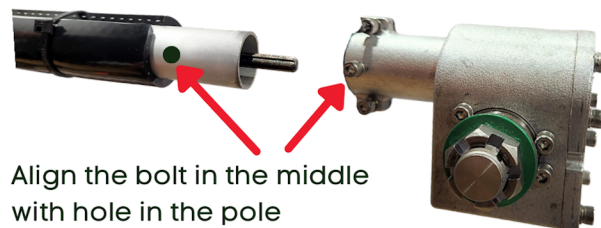

STEP 4. Re-insert middle bolt and make sure it goes through hole in the pole (tighten slightly). Tighten the other 2 bolts to 80in-lbs to make sure the gearbox doesn't rotate.

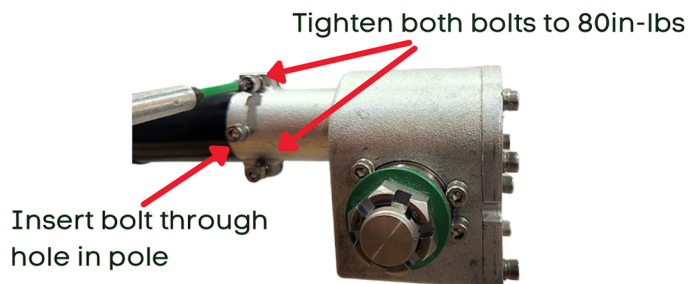

www.trenchbadger.com



contact@trenchbadger.com



866-887-3624