

PERFORMANCE CURVES

GX120

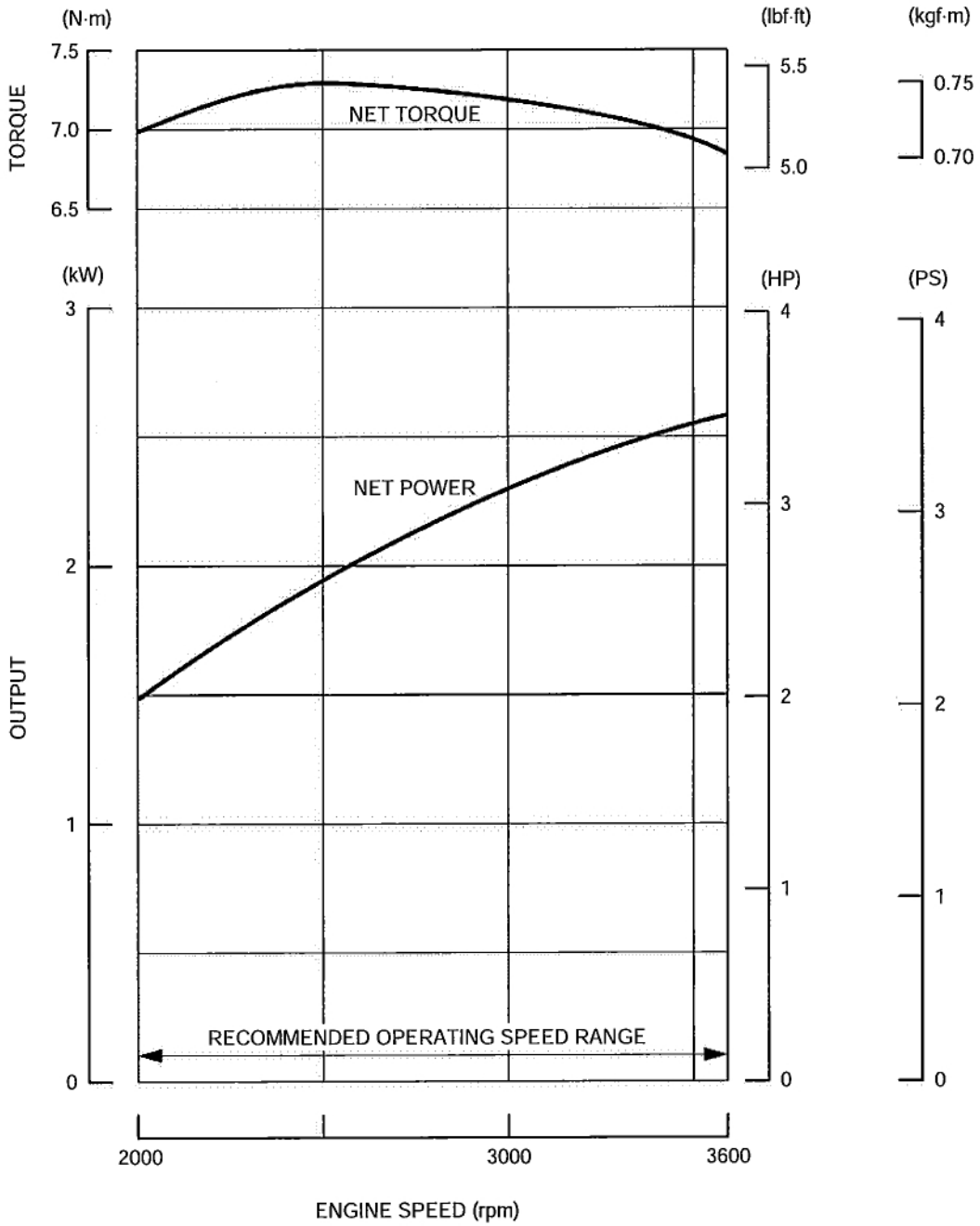

DIMENSIONAL DRAWINGS

*: P.T.O. type.

GX120 (WITHOUT REDUCTION)

Unit: mm (in)

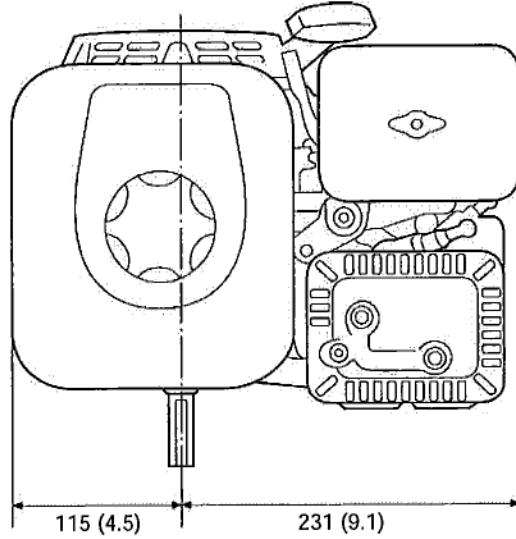

Dual/dual silent: 160 (6.3)
 Cyclone: 166 (6.5)
 Oil bath: 157 (6.2)
 Semi dry: 156 (6.1)

Dual/dual silent: 317 (12.5)
 Cyclone/Oil bath: 330 (13.0)
 Semi dry: 314 (12.4)

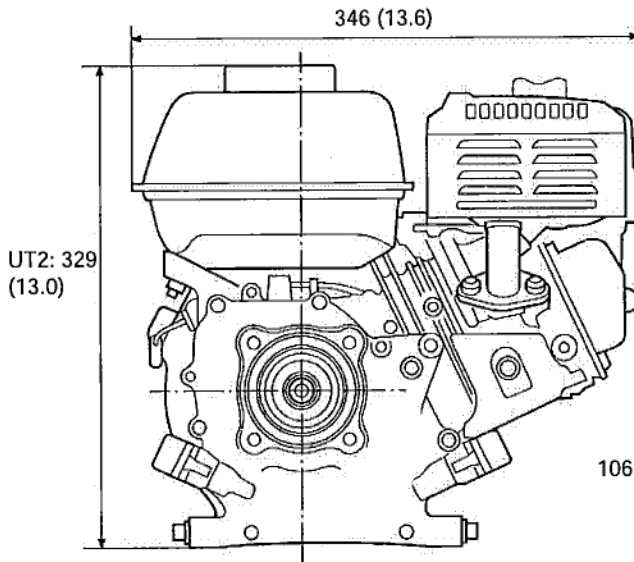

Standard: 91 (3.6)
 Silent: 104 (4.1)

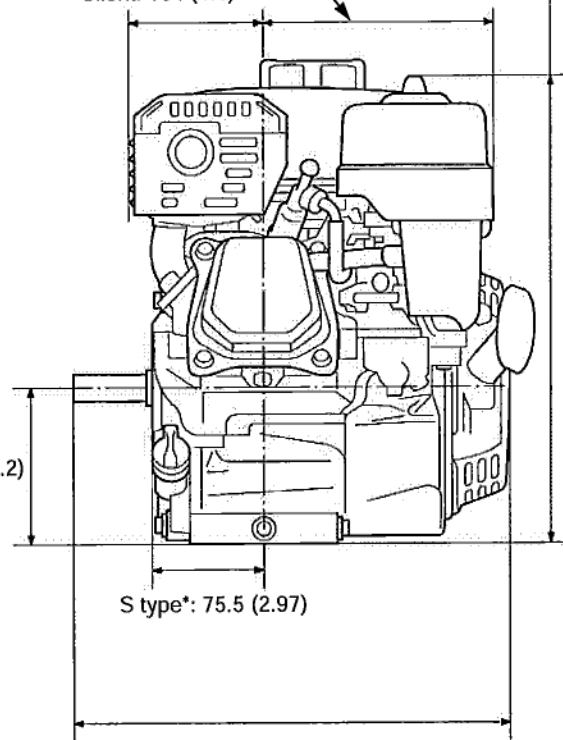

S type*: 75.5 (2.97)

Q type*: 305.5 (12.03)
 S type*: 297 (11.7)
 T type*: 305.5 (12.03)
 V type*: 315.5 (12.42)

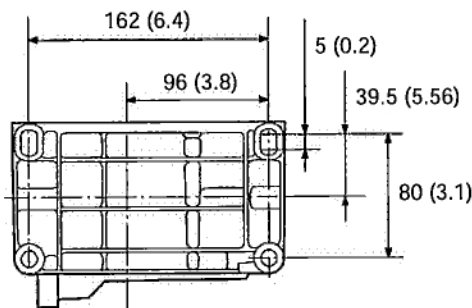

SPECIFICATIONS

GX120UT2

GX120 (WITH REDUCTION)

Unit: mm (in)

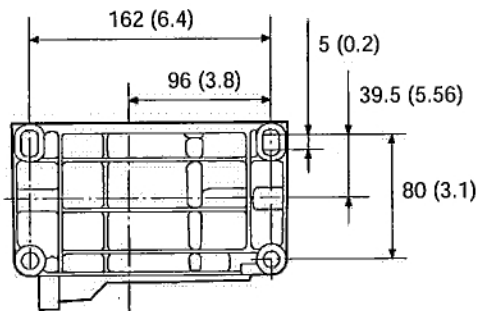
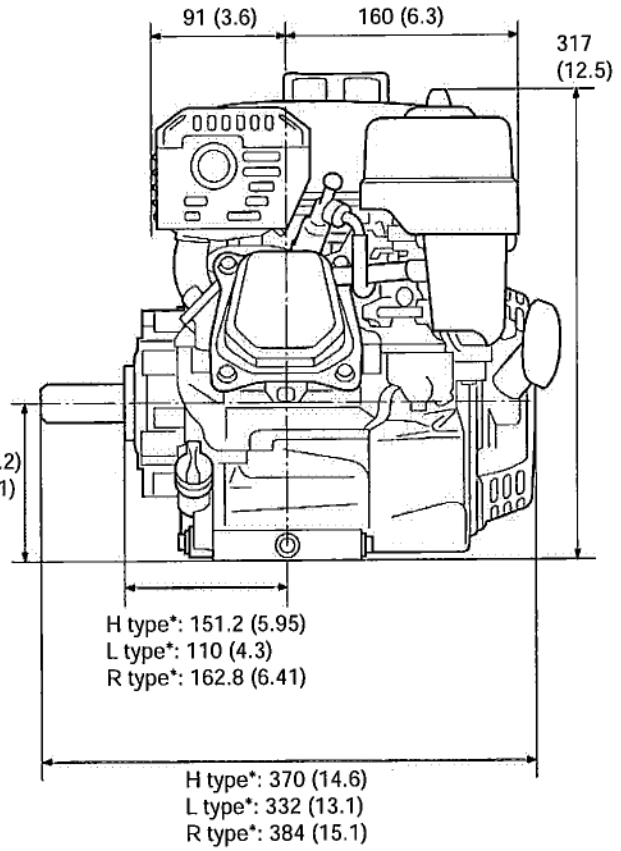
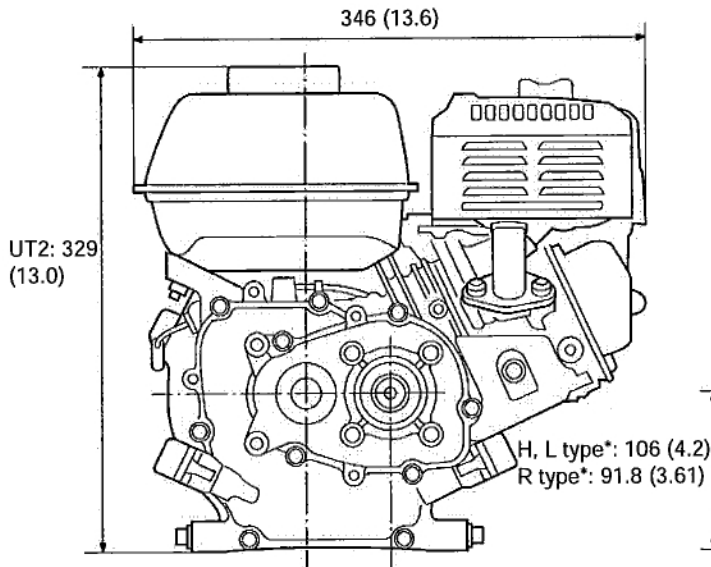
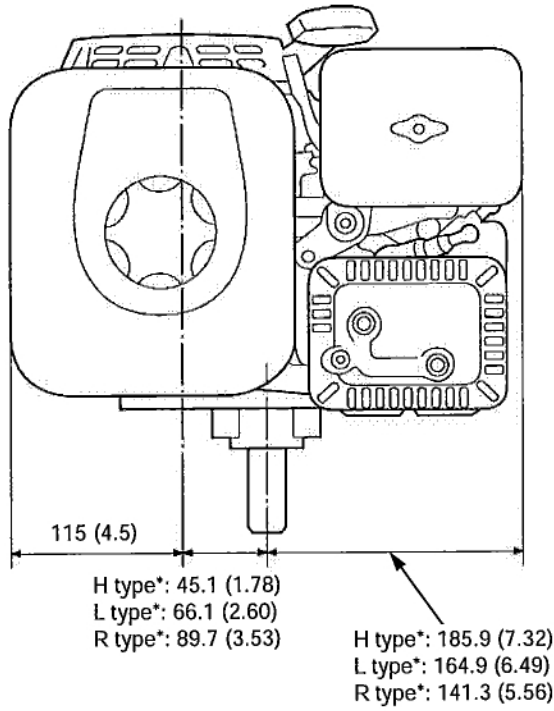

DIMENSIONAL DRAWINGS

GX120RT2 (RAMMER TYPE)

Unit: mm (in)

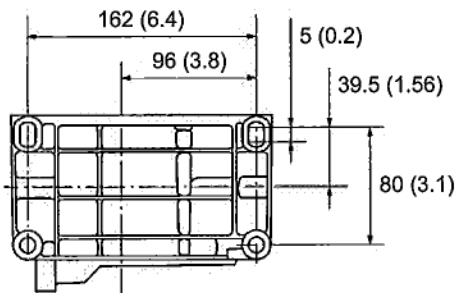
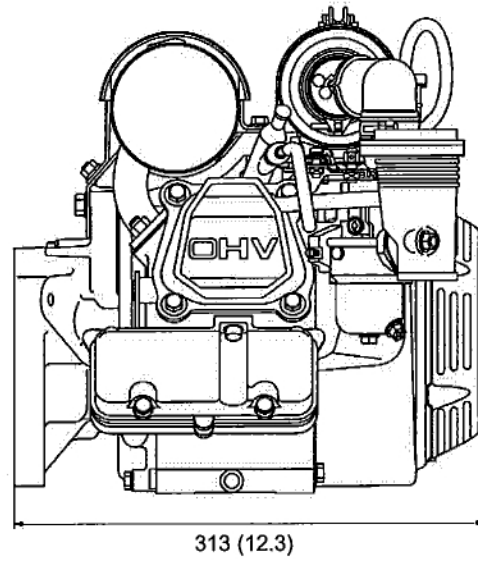
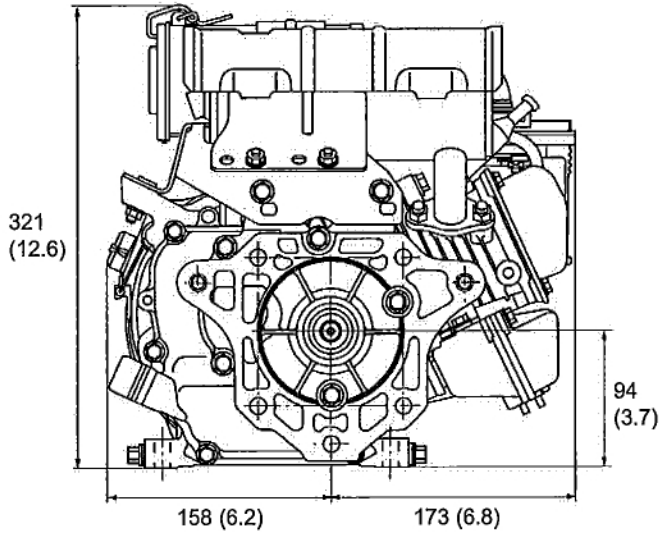
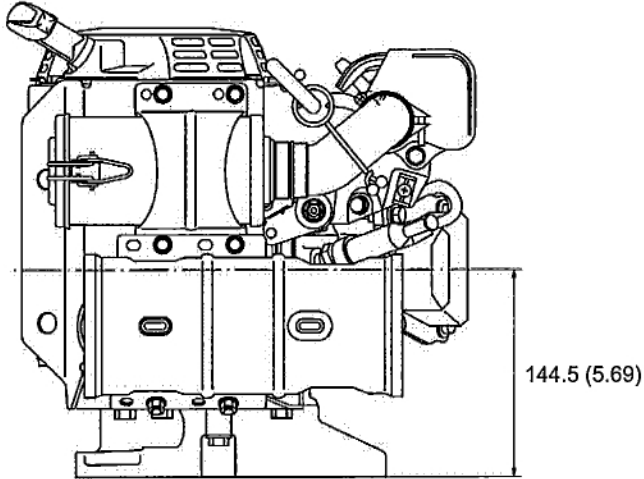

P.T.O. DIMENSIONAL DRAWINGS

*: P.T.O. type.

GX120RT2 (RAMMER TYPE)

Unit: mm (in)

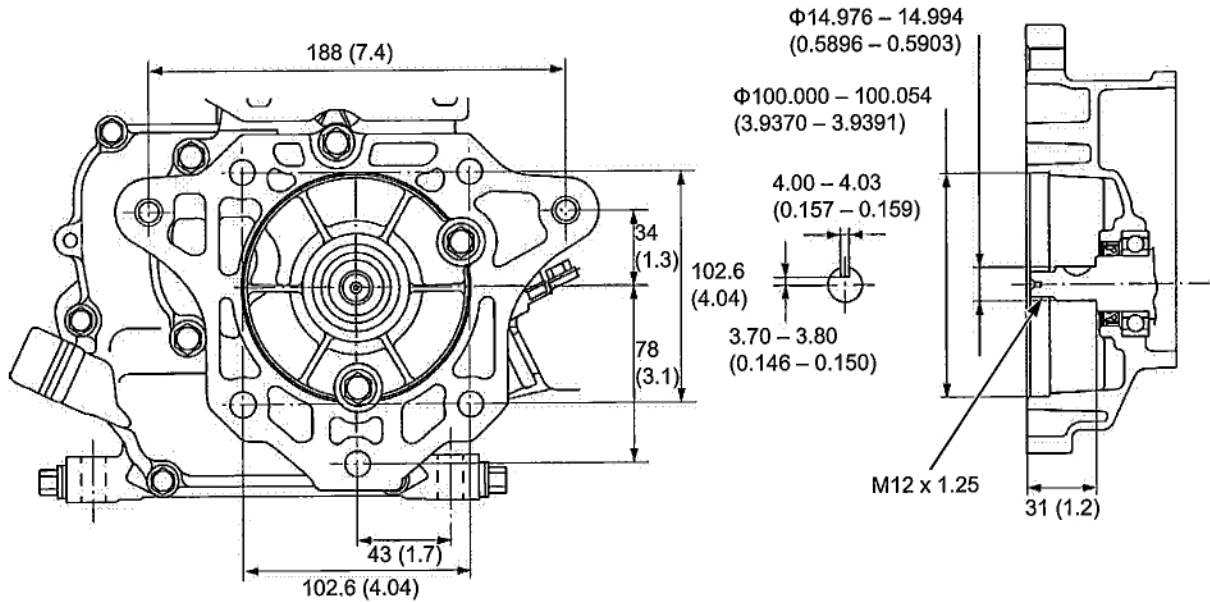

WITHOUT REDUCTION

Unit: mm (in)

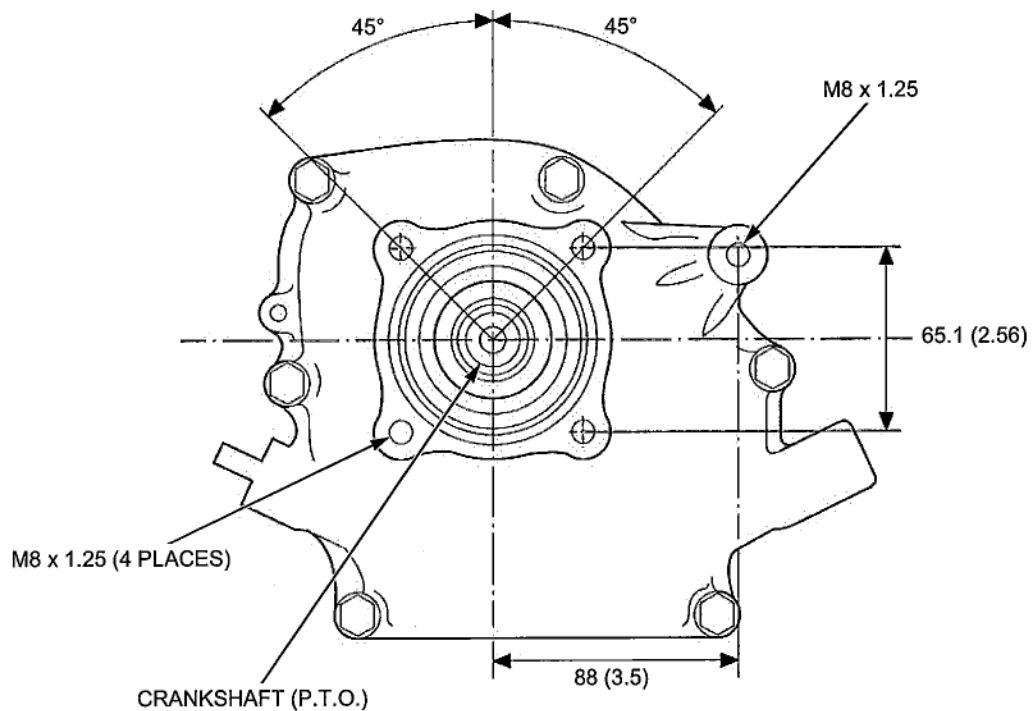

SPECIFICATIONS

GX120UT2

S type*

Unit: mm (in)

T type*

Unit: mm (in)

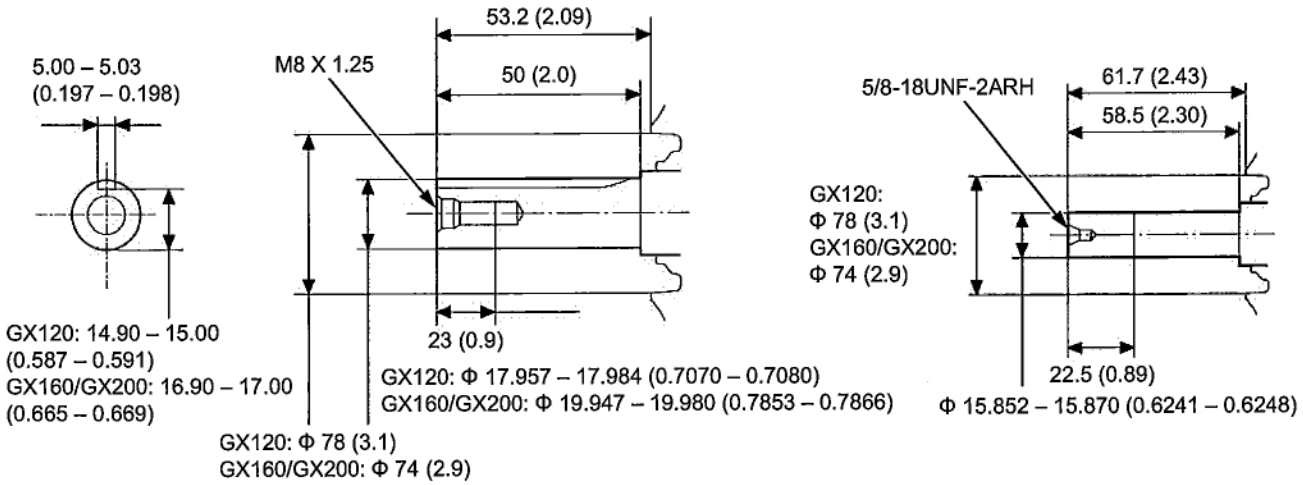

Q type*

Unit: mm (in)

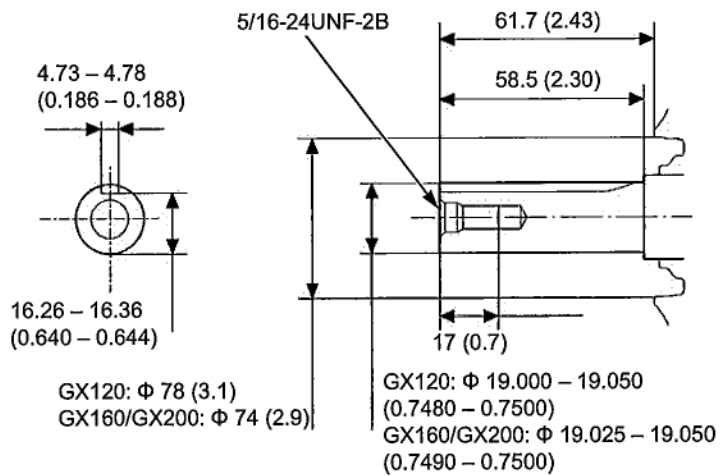

WITH REDUCTION

H type*

Unit: mm (in)

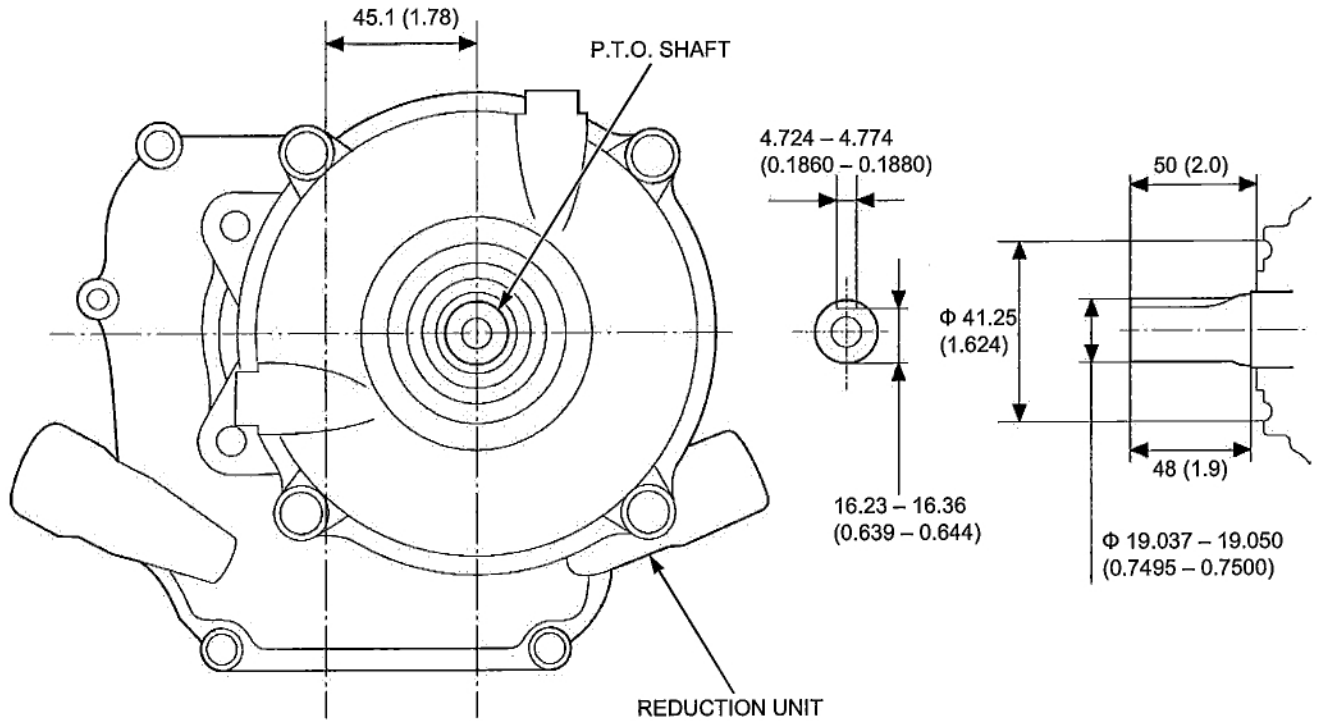

L type*

Unit: mm (in)

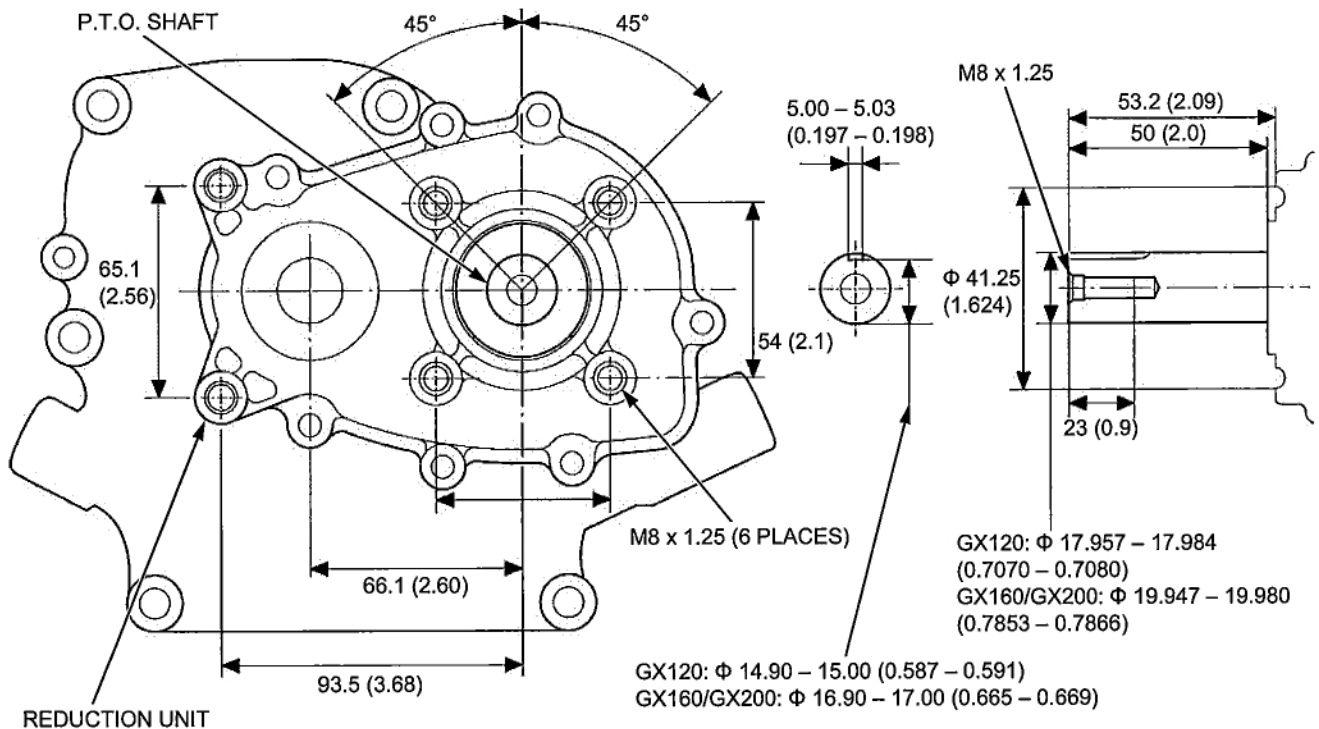

SPECIFICATIONS

GX120UT2

R type*

Unit: mm (in)

