

BANNON

175-Lb. Drywall and Panel Hoist

Owner's Manual



! **WARNING:** Read carefully and understand all ASSEMBLY AND OPERATION INSTRUCTIONS before operating. Failure to follow the safety rules and other basic safety precautions may result in serious personal injury.

Item #57502

READ & SAVE THESE INSTRUCTIONS

Thank you very much for choosing a Bannon™ product!

For future reference, please complete the owner's record below:

Serial Number/Lot Date Code: _____

Purchase Date: _____

Save the receipt, warranty, and this manual. It is important that you read the entire manual to become familiar with this product before you begin using it.

This drywall and panel hoist is designed for certain applications only. Northern Tool and Equipment is not responsible for issues arising from modification or improper use of this product such as an application for which it was not designed. We strongly recommend that this product not be modified and/or used for any application other than that for which it was designed.

For technical questions, please call **1-800-222-5381**.

Table of Contents

Intended Use.....4

Packaging Contents.....4

Technical Specifications4

Important Safety Information4

Specific Operation Warnings6

Main Parts of Panel Lifter7

Assembly Instructions.....8

Before Each Use.....11

Operating Instructions.....11

After Each Use.....19

Maintenance19

Troubleshooting.....20

Parts Diagram.....21

Parts List.....21

Replacement Parts22

Limited Warranty23

Intended Use

The Bannon 175-Lb. Drywall and Panel Hoist can lift plasterboard in every position: horizontal (ceiling installation), angled (sloping ceiling installation), and vertical (wall installation). It's the only panel and drywall hoist that can be operated manually and automatically with power drill assistance. Its rack and pinion system allows you to lift plasterboards with less effort than others panel and drywall hoists. It has an innovative braking system with handles (main brake and safety brake) to lower the panel quickly with control.

Packaging Contents

- Arm (2)
- Support base for power drill (1)
- 1^{3/4}" screw (2)
- Arm pipe (2)
- Wooden platform (1)
- 2^{1/4}" screw (6)
- Top rack (1)
- Side foot (2)
- 2^{5/8}" screw (1)
- Main body (1)
- Middle foot (1)
- 3^{1/8}" screw (2)
- Integrated extension (1)
- Balance bar with 2 wheels (1)
- Nut (11)

Technical Specifications

Property	Specification
Maximum loading weight	175 lb.
Maximum board dimensions	4' x 14'
Minimum board dimensions	0.49' x 1.97'
Maximum height with extension part	14'
Maximum height without extension part	11.48'
Minimum height	5.28'
Maximum vertical lifting height with 8.2 Ft height board	20.51'
Board loading height (without extension)	2.76'
Minimum width in moving/storage position	24 ^{3/4} "
Total gross weight	117 lb.

Important Safety Information

⚠WARNING

- Read and understand all instructions. Failure to follow all instructions may result in serious injury or property damage.
- The warnings, cautions, and instructions in this manual cannot cover all possible conditions or situations that could occur. Exercise common sense and caution when using this tool. Always be aware of the environment and ensure that the tool is used in a safe and responsible manner.
- Do not allow persons to operate or assemble the product until they have read this manual and have developed a thorough understanding of how it works.
- Do not modify this product in any way. Unauthorized modification may impair the function and/or

safety and could affect the life of the product. There are specific applications for which the product was designed.

- Use the right tool for the job. DO NOT attempt to force small equipment to do the work of larger industrial equipment. There are certain applications for which this equipment was designed. This product will be safer and do a better job at the capacity for which it was intended. DO NOT use this equipment for a purpose for which it was not intended.
- Industrial or commercial applications must follow OSHA requirements.

⚠WARNING

WORK AREA SAFETY

- Inspect the work area before each use. Keep work area clean, dry, free of clutter, and well-lit. Cluttered, wet, or dark work areas can result in injury. Using the product in confined work areas may put you dangerously close to cutting tools and rotating parts.
- Do not use the product where there is a risk of causing a fire or an explosion; e.g., in the presence of flammable liquids, gases, or dust. The product can create sparks, which may ignite the flammable liquids, gases, or dust.
- Do not allow the product to come into contact with an electrical source. The tool is not insulated and contact will cause electrical shock.
- Keep children and bystanders away from the work area while operating the tool. Do not allow children to handle the product.
- Be aware of all power lines, electrical circuits, water pipes, and other mechanical hazards in your work area. Some of these hazards may be hidden from your view and may cause personal injury and/or property damage if contacted.

⚠WARNING

PERSONAL SAFETY

- Stay alert, watch what you are doing, and use common sense when operating the tool. Do not use the tool while you are tired or under the influence of drugs, alcohol, or medication. A moment of inattention while operating the tool may result in serious personal injury.
- Dress properly. Do not wear loose clothing, dangling objects, or jewelry. Keep your hair, clothing and gloves away from moving parts. Loose clothes, jewelry, or long hair can be caught in moving parts. Air vents on the tool often cover moving parts and should be avoided.
- Wear the proper personal protective equipment when necessary. Use ANSI Z87.1 compliant safety goggles (not safety glasses) with side shields, or when needed, a face shield. Use a dust mask in dusty work conditions. Also use non-skid safety shoes, hardhat, gloves, dust collection systems, and hearing protection when appropriate. This applies to all persons in the work area.
- Do not overreach. Keep proper footing and balance at all times.
- Remove keys or wrenches before connecting the tool to an air supply, power supply, or turning on the tool. A wrench or key that is left attached to a rotating part of the tool may cause personal injury.

- Secure the work with clamps or a vise instead of your hand when practical. This safety precaution allows for proper tool operation using both hands.

⚠CAUTION

HOIST USE AND CARE

- Do not force the hoist. Products are safer and do a better job when used in the manner for which they are designed. Plan your work, and use the correct product for the job.
- Check for damaged parts before each use. Carefully check that the product will operate properly and perform its intended function. Replace damaged or worn parts immediately. Never operate the product with a damaged part.
- Do not use a product with a malfunctioning switch. Any power tool that cannot be controlled with the power switch is dangerous and must be repaired by an authorized service representative before using.
- Disconnect the power/air supply from the product and place the switch in the locked or off position before making any adjustments, changing accessories, or storing the tool. Such preventive safety measures reduce the risk of starting the tool accidentally.
- Store the product when it is not in use. Store it in a dry, secure place out of the reach of children. Inspect the tool for good working condition prior to storage and before re-use.
- Use only accessories that are recommended by the manufacturer for use with your product. Accessories that may be suitable for one product may create a risk of injury when used with another tool. Never use an accessory that has a lower operating speed or operating pressure than the tool itself.
- Keep guards in place and in working order. Never operate the product without the guards in place.

Specific Operation Warnings

⚠WARNING

- To avoid injury, slide bar lock must be fully engaged if winch assembly is extended.
- Wear ANSI Z87.1 compliant safety goggles, hard hat, heavy duty gloves, and steel toed boots during setup and use.
- Do not exceed the rated load capacity.
- Do not use to transport people or pets.
- Secure load before raising or lowering load.
- Only use the hoist to raise and lower one panel at a time.
- Never load a drywall panel or operate the hoist if the lock pins are not engaged at one of the three positions.
- Use ONLY for lifting a drywall panel.
- To avoid serious injury, watch for overhead obstructions when raising panel.

- Be sure the winch components are clean and dry before operation.
- Inspect the tool for wear or damage. Pay special attention to any wear or damage to the wire rope.
- Carefully inspect the hoist before operating.
- Do not grease or oil the rack, pinion, or the gear.
- The top rack must be in low position while changing the feet position.
- Do not use the hoist as a working platform. Use a stepladder or a working platform to screw the board onto the ceiling.
- Do not obstruct the wheels while operating. It may cause the device to malfunction.
- Do not put your hand through the steering wheel while the top rack is lowering. It may cause hand or finger injuries.
- Do not remove the hoist's safety labels.
- Do not modify the hoist.
- Use the hoist on a firm and stable surface which can support the weight of the tool and plasterboard.
- Lock the 2-wheel brakes while lifting a board.
- In order to avoid collision with the top rack during its descent, use the main brake to regulate the speed. In case of a main brake default, release immediately the safety brake lever in order to stop the descent right away.

Main Parts of Panel Lifter

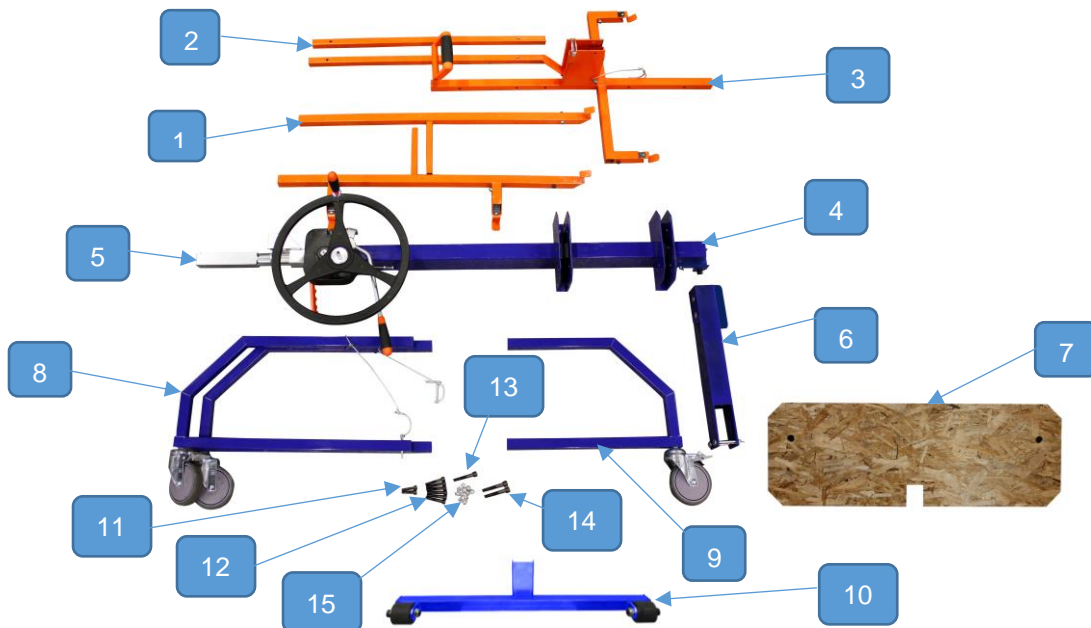

Reference	Subassembly
1	Arm
2	Arm pipe
3	Top rack
4	Main body

Reference	Subassembly
5	Integrated extension
6	Support base for power drill
7	Wooden platform
8	Side foot
9	Middle foot
10	Balance bar with wheels
11	1 ^{3/4} " screw
12	2 ^{1/4} " screw
13	2 ^{5/8} " screw
14	3 ^{1/8} " screw
15	Nut

Assembly Instructions

1. Attach the balance bar with wheels (10) to the main body (4) with the two 3^{1/8}" screws (14) and nuts (15). Use a 1/2" flat wrench and a 1/4" hex wrench.

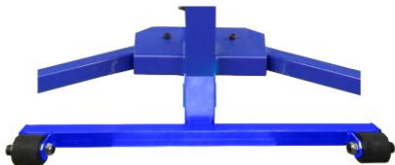

2. Attach the side (8) and middle feet (9) to the main body (4) with the six 2^{1/4}" screws (12) and nuts (15). Use a 1/2" flat wrench and a 1/4" hex wrench.

Position the side feet with the brake (8) on the same side as the security and main brake levers. The middle foot (9) is the shortest foot. The middle foot nuts have to be firmly tightened because the foot doesn't rotate like the side feet (8).



3. Open the 2 side feet (8) and insert the removable pin in the base frame hole following the selected configuration :

- HORIZONTAL CEILING SETTING AND SLOPING CEILING :

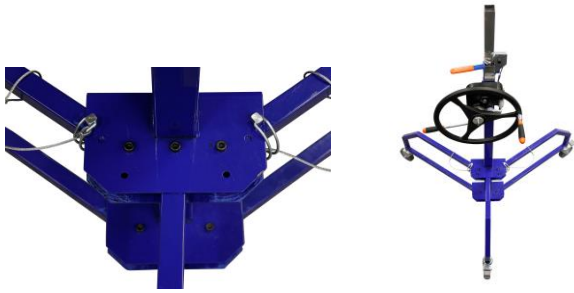

- VERTICAL SETTING :

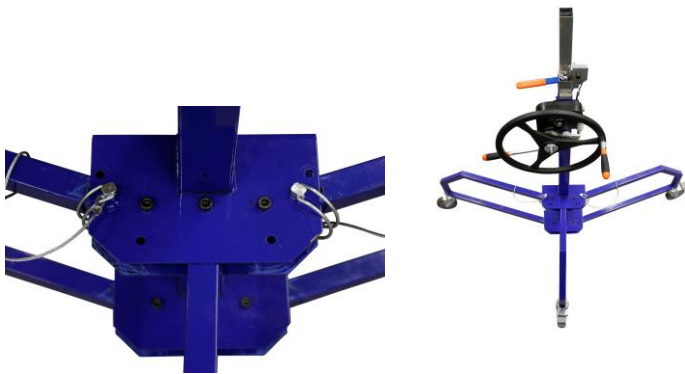

- STORAGE/MOVING POSITION :

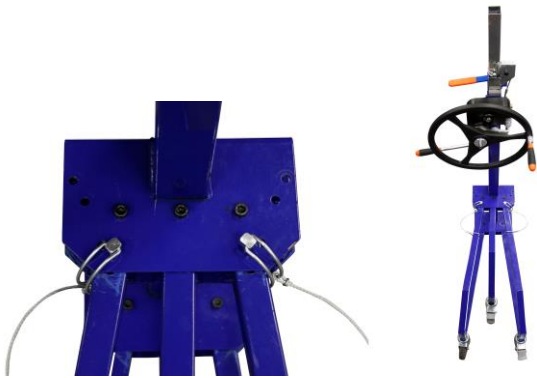

The top rack (3) must be in low position while changing the feet position.

4. Insert the 3.28 Ft extension (5) in the frame and lock it in the selected hole with the removable pin. The extension has 3 different height positions: 11.48 Ft – 13.12 Ft and 14.76 Ft.



5. Insert the top rack (3) in the extension base and attach it with the 2^{5/8}" screw (13) and nut (15).



6. Assemble the arms (1) with the two 1^{3/4}" screws (11) and nuts (15), using a 1/2" flat wrench and a 1/4" hex wrench. Be sure the arm marks match: R with R and L with L.
7. Insert the arms (1) in the top rack (3) according to the position selected. When you are in front of the steering wheel, put the R arm on your right and the L arm on your left. The retractable pins must be locked in the corresponding holes.
8. Attach the power drill support base (6) to the main body (4) with the two provided screws and tighten the wing nuts to lock the support base.

Before Each Use

⚠WARNING

- Make sure all the parts are securely assembled.
- Make sure all the nuts are well tightened and the removable pins are in position.
- Remove the dust from the gear as well as the rack and pinion.
- Make sure the retractable pins are well-locked in the appropriate holes.
- Before each use, check all operations.
- Make sure the cable is in good condition. Do not hesitate to change it as soon as the tiniest imperfection is visible: crushing, pinching, and wire breaking.
- Make sure the main brake is in good condition and well-adjusted. Once the board is lifted at the required height, it has to stay in position when the safety brake is unlocked. If the top rack goes down, tighten the main brake by turning the knurled nut clockwise direction.

Operating Instructions

⚠WARNING

- To avoid injury, slide bar lock must be fully engaged if winch assembly is extended.
- Wear ANSI Z87.1 compliant safety goggles, hard hat, heavy duty gloves, and steel toed boots during setup and use.
- Do not exceed the rated load capacity.
- Only use the hoist to raise and lower one panel at a time.
- Never load a drywall panel or operate the hoist if the lock pins are not engaged at one of the three positions.
- Use ONLY for lifting a drywall panel.
- To avoid serious injury, watch for overhead obstructions when raising panel.
- Do not grease or oil the rack, pinion, or the gear.
- The top rack must be in low position while changing the feet position.
- Do not use the hoist as a working platform. Use a stepladder or a working platform to screw the board onto the ceiling.

- Do not obstruct the wheels while operating. It may cause the device to malfunction.
- Do not put your hand through the steering wheel while the top rack is lowering. It may cause hand or finger injuries.
- Do not remove the hoist's safety labels.
- Do not modify the hoist.
- Use the hoist on a firm and stable surface which can support the weight of the tool and plasterboard.
- Lock the 2-wheel brakes while lifting a board.
- In order to avoid collision with the top rack during its descent, use the main brake to regulate the speed. In case of a main brake default, release immediately the safety brake lever in order to stop the descent right away.

1. Lift the latch to unlock the top rack and tilt it completely.



2. Insert the arms in the tube according to the selected setting-the retractable pin must be locked in the hole.



3. Block the 2 wheel brakes, and then load the board.



4. Pull the handle to position the board on the chosen configuration.



5. Unlock the 2 wheel brakes and turn the steering wheel while pushing the main brake lever to lift the board.



6. Once the board touches the ceiling, position the board perfectly and lock the wheel brakes while screwing the board.



Once the board is lifted to the required height, it has to stay in position when the safety brake is unlocked. If the board goes down, tighten the main brake by turning the knurled nut clockwise. If the board is heavier than a standard board (more than 55.12 lb.), turn the knurled nut clockwise to increase the spring power.

If the board still goes down even with the knurled nut at its tightest, change the brake lining.

7. Push the brake lever while lifting the safety brake latch, to lower the top rack. If you have to lower the top rack loaded, pay attention to control the descent by pushing slightly on the main brake lever. In case of a main brake default, release immediately the safety brake lever in order to stop the descent right away.



LOADING CONFIGURATIONS

HORIZONTAL CEILING AND SLOPING CEILING SETTING

1. Open the feet as much as possible and insert each removable pin in the 3rd hole of the base frame.

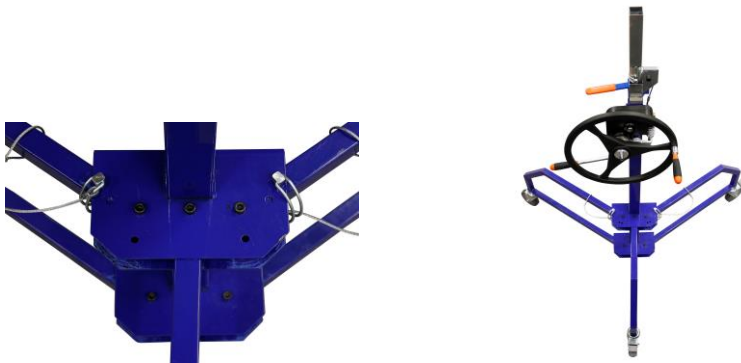

2. Insert the arms in the horizontal tubes. The retractable pin must be locked in the selected hole.



3. **A. CEILING SETTING:** Once the board is loaded, pull the top rack handle to put the board in horizontal position. Position the panel hoist with the steering wheel in front of the wall to lift the board along the wall.



- B. HORIZONTAL SLOPING CEILING:** Once the board is loaded, pull out the removable pin to unlock the top rack, and then pull the handle to angle the board. Insert the removable pin in the sloping ceiling position hole (45° position). The top rack position is adjusted according to the ceiling angle while the board is touching the ceiling.



4. Turn the steering wheel while pushing the main brake lever to lift the board up to the ceiling.

VERTICAL LIFTING AND VERTICAL SLOPING CEILING SETTING

1. Insert the arms in the vertical tubes; the retractable pin must be locked in the selected hole according to the board dimensions.
 - 1st hole for vertical sloping ceiling
 - 2nd hole (with vertical position marking) for vertical lifting



2. VERTICAL SLOPING CEILING: Once the board is loaded, pull out the removable pin to unlock the top rack, then pull the handle to angle the board and insert the removable pin in the sloping ceiling position hole (45° position). The top rack position is adjusted according to the ceiling angle while the board is touching the ceiling.



VERTICAL LIFTING: Once the board is loaded, position the hoist along the vertical wall. Pull out the removable pins from the 2 lateral feet and open them up to the 2nd hole of the frame base. Insert the removable pins to lock the feet. Pull out the removable pin from the top rack in order to angle the board completely on vertical position, while pushing the hoist along the wall with help of the top rack handle. Lock the 2 wheel brakes.



3. **Turn** the steering wheel while pushing the main brake lever to lift the board.



Automatic Use Assisted by Power Drill

1. You must use the power drill support base for safety reasons. Set up the hoist according to the selected setting configuration
2. Insert the hex bit in the power drill chuck.



3. Adjust the power drill support base according to the power drill dimensions.



4. Insert the hex bit attached to the power drill, in the hex hole located in the middle of the steering wheel. Turn the power drill to block it against the power drill support base. Set the power drill on "maximum torque - low speed", rotating in a clockwise direction.



POWER DRILL MINI 14.4 VOLT - 3 Ah

5. Pull the power drill trigger to lift the board.
6. To lower the top rack, remove the power drill first, and then push the main brake lever while lifting up the safety brake latch.

After Each Use

After each use, the hoist should be stored in a dry, secure place, out of the reach of children.

Maintenance

Maintain the product by adopting a program of conscientious repair and maintenance in accordance with the following recommended procedures. It is recommended that the general condition of any tool be examined before it is used. Keep your tool in good repair. Keep handles dry, clean, and free from oil and grease. The following chart is based on a normal operation schedule.

Maintenance Interval	Maintenance Point
Daily before operating	<p>Make sure all the parts are perfectly well assembled.</p> <p>Make sure all the nuts are well tightened and the removable pins are in position.</p> <p>Remove the dust from the gear, as well as the rack and pinion.</p> <p>Make sure the retractable pins are well-locked in their holes.</p> <p>Before each use, do an overall check.</p> <p>Make sure the cable is in good condition. Do not hesitate to change it as soon as the tiniest imperfection is visible (e.g., crushing, pinching, or a broken wire).</p> <p>Make sure the main brake is in good condition and well-adjusted. Once the board lifted at the required height, it has to stay in position when the safety brake is unlocked. If the top rack goes down, tighten the main brake by turning the knurled nut clockwise.</p>

Troubleshooting

Use the table below to troubleshoot problems before contacting service personnel or your local dealer. If the problem continues after troubleshooting, call your local dealer for assistance.

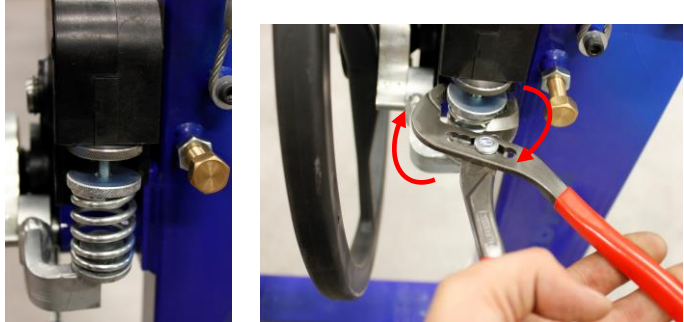
Failure	Possible Cause	Corrective Action
The top rack goes down instead of staying in position while the safety brake is unlocked.	The main brake is not securely tightened.	<p>Tighten the main brake by turning the knurled nut clockwise.</p> 

Parts Diagram

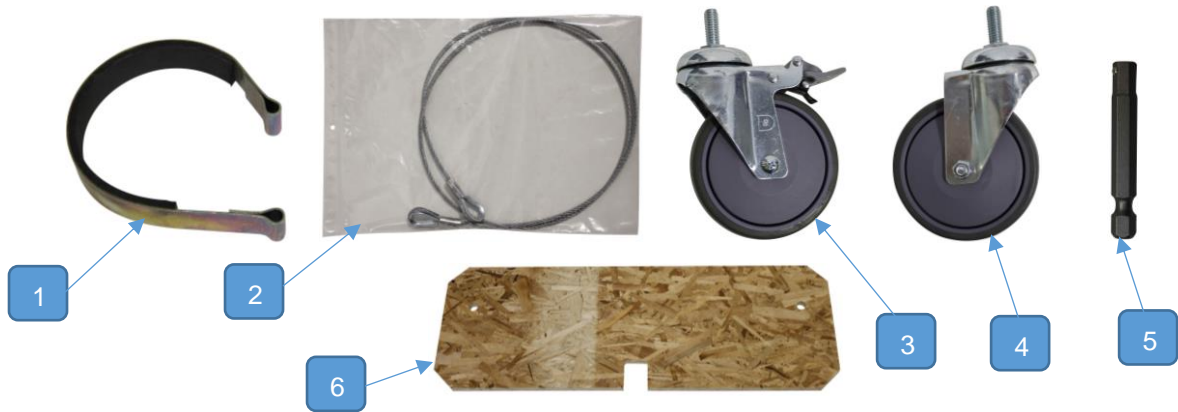

Parts List

Reference	Part Number	Part Description	Quantity
1	1	Brake lining	1
2	2	Metallic cable	1
3	3	Wheel with brake	1
4	4	Wheel without brake	1
5	5	Hex bit for using with power drill	1
6	6	Wooden platform	1

Replacement Parts

- For replacement parts and technical questions, please call Customer Service at **1-800-222-5381**.
- Not all product components are available for replacement. The illustrations provided are a convenient reference to the location and position of parts in the assembly sequence.
- When ordering parts, the following information will be required: item description, item model number, item serial number/item lot date code, and the replacement part reference number.
- The distributor reserves the rights to make design changes and improvements to product lines and manuals without notice.

Limited Warranty

Northern Tool and Equipment Company, Inc. ("We" or "Us") warrants to the original purchaser only ("You" or "Your") that the Bannon product purchased will be free from material defects in both materials and workmanship, normal wear and tear excepted, for a period of **one year** from date of purchase. The foregoing warranty is valid only if the installation and use of the product is strictly in accordance with product instructions. There are no other warranties, express or implied, including the warranty of merchantability or fitness for a particular purpose. If the product does not comply with this limited warranty, Your sole and exclusive remedy is that We will, at our sole option and within a commercially reasonable time, either replace the product or product component without charge to You or refund the purchase price (less shipping). This limited warranty is not transferable.

Limitations on the Warranty

This limited warranty does not cover: (a) normal wear and tear; (b) damage through abuse, neglect, misuse, or as a result of any accident or in any other manner; (c) damage from misapplication, overloading, or improper installation; (d) improper maintenance and repair; and (e) product alteration in any manner by anyone other than Us, with the sole exception of alterations made pursuant to product instructions and in a workmanlike manner.

Obligations of Purchaser

You must retain Your product purchase receipt to verify date of purchase and that You are the original purchaser. To make a warranty claim, contact Us at 1-800-222-5381, identify the product by make and model number, and follow the claim instructions that will be provided. The product and the purchase receipt must be provided to Us in order to process Your warranty claim. Any returned product that is replaced or refunded by Us becomes our property. You will be responsible for return shipping costs or costs related to Your return visit to a retail store.

Remedy Limits

Product replacement or a refund of the purchase price is Your sole remedy under this limited warranty or any other warranty related to the product. We shall not be liable for: service or labor charges or damage to Your property incurred in removing or replacing the product; any damages, including, without limitation, damages to tangible personal property or personal injury, related to Your improper use, installation, or maintenance of the product or product component; or any indirect, incidental or consequential damages of any kind for any reason.

Assumption of Risk

You acknowledge and agree that any use of the product for any purpose other than the specified use(s) stated in the product instructions is at Your own risk.

Governing Law

This limited warranty gives You specific legal rights, and You also may have other rights which vary from state to state. Some states do not allow limitations or exclusions on implied warranties or incidental or consequential damages, so the above limitations may not apply to You. This limited warranty is governed by the laws of the State of Minnesota, without regard to rules pertaining to conflicts of law. The state courts located in Dakota County, Minnesota shall have exclusive jurisdiction for any disputes relating to this warranty.

BANNON

Distributed by:

Northern Tool & Equipment Company, Inc.

Burnsville, Minnesota 55306

www.northerntool.com

Made in Taiwan