



Vestil Manufacturing Co.
2999 North Wayne Street, P.O. Box 507, Angola, IN 46703
Telephone: (260) 665-7586 -or- Toll Free (800) 348-0868
Fax: (260) 665-1339
Web: www.vestil.com e-mail: info@vestil.com

DCHT
DRUM & HAND TRUCK



Receiving Instructions

After delivery, remove the packaging from the product. Inspect the product closely to determine whether it sustained damage during transport. If damage is discovered, record a complete description of it on the bill of lading. If the product is undamaged, discard the packaging.

NOTE: The end-user is solely responsible for confirming that product design, use, and maintenance comply with laws, regulations, codes, and mandatory standards applied where the product is used.

Technical Service & Replacement Parts

For answers to questions not addressed in these instructions and to order replacement parts, labels, and accessories, call our Technical Service and Parts Department at (260) 665-7586. The Department can also be contacted online at https://www.vestil.com/page-parts-request.php.

Electronic Copies of Instruction Manuals

Additional copies of this instruction manual may be downloaded from https://www.vestil.com/page-manuals.php.

Table of Contents
Product Description..... 2
Signal Words..... 2
Safety Instructions..... 2 - 3
Operating the Hand Truck..... 3 - 4
Record of Satisfactory Condition..... 4
Inspecting & Maintaining the Hand Truck..... 4
Swapping Nose Plate for Drum Forks..... 5
Exploded View and Bill of Materials..... 6
Labeling Diagram..... 7
Troubleshooting..... 7
Limited Warranty..... 8

PRODUCT DESCRIPTION

The DCHT series hand trucks are engineered for transporting and handling drums in industrial settings. Key features include:

- **Capacity:** 500 lbs (DCHT-1) or 750 lbs (DCHT-1-FF).
- **Versatility:** Operates as a drum truck, hand truck, or drum cradle.
- **Design:** Extra-long handles for leverage, interchangeable steel nose plate and drum tines, large 16" x 4" wheels for rough terrain, and a built-in bung nut wrench.
- **Dimensions:** Approximately 28-15/16" W x 26-3/4" L x 59-13/16" H (DCHT-1) or 28-7/8" W x 26-3/4" L x 59-7/8" H (DCHT-1-FF).
- **Drum Cradle Height:** 11-5/8" when horizontal.
- The standard nose plate (40-514-047) can be unfastened from the truck and replaced with drum forks (09-514-107). See "Swapping nose plate for drum forks" on p. 5.

SIGNAL WORDS

This manual uses SIGNAL WORDS to indicate the likelihood that a particular action will cause personal injuries or property damage. Signal words also specify the level of seriousness of injury if the product is misused in the ways described. The following signal words are used in this manual.



DANGER

Identifies a hazardous situation which, if not avoided, **WILL** result in **DEATH** or **SERIOUS INJURY**. Use of this signal word is limited to the most extreme situations.



WARNING

Identifies a hazardous situation which, if not avoided, **COULD** result in **DEATH** or **SERIOUS INJURY**.



CAUTION

Indicates a hazardous situation which, if not avoided, **COULD** result in **MINOR** or **MODERATE** injury.



NOTICE

Identifies practices likely to result in product/property damage, such as operation that might damage the product.

SAFETY INSTRUCTIONS

Vestil strives to identify all foreseeable hazards associated with the use of its products. Material handling is dangerous and no manual can address every conceivable risk. Ultimately, the most effective way to prevent injury is to apply sound judgment whenever using this device.

▲ WARNING

Risks that could result in death or serious personal injury.

- *Read and understand the entire manual before assembling, installing, using or servicing the product.* Read the manual to refresh your understanding of proper use and maintenance procedures.
- **DO NOT** attempt to resolve any problem(s) with the product unless you are both authorized to do so and certain that it will be safe to use afterwards.
- **DO NOT** modify the product in any way **UNLESS** you first obtain written approval from Vestil. Unapproved modifications automatically void the LIMITED WARRANTY on p. 8 and might make the product unsafe to use.
- Improper use can cause the hand truck to tip over, leading to serious injury or death.
 - Always center the drum on the nose plate.
 - Secure the drum to the truck, e.g. using ratchet straps.
 - Do not exceed the rated capacity (DCHT-1 = 500 lb.; DCHT-1-FF = 750 lb.).
- Using the hand truck on uneven or slippery surfaces can cause loss of control:
 - Use only on flat, dry, and stable surfaces.
 - Avoid inclines, stairs, or rough terrain beyond the capability of the 16" x 4" wheels.

[Continues on following page]

⚠ WARNING

[Continued from prior page]

- **Drum Damage Hazard:** Improper handling can damage the drum or cause spillage, potentially exposing users to hazardous materials.
 - Ensure the drum is securely fastened before moving.
 - When using as a cradle, position the drum to prevent rolling or tipping.
 - For drums containing hazardous materials, follow all applicable safety regulations and wear appropriate personal protective equipment (PPE).
- **Bung Nut Wrench Hazard:** Improper use of the built-in bung nut wrench can cause the drum to tip or spill.
 - Ensure the drum is stable and secure before using the wrench.
 - Control the drum during opening to prevent sudden movements.
- **Pinch Point Hazard:** Moving parts can pinch or crush fingers or hands.
 - Keep hands and feet clear of the nose plate, wheels, and drum tines during loading and unloading.
 - Wear gloves when handling the hand truck.
- **Lifting Hazard:** Improper lifting techniques can cause back or muscle injuries.
 - Use proper lifting techniques: bend at the knees, not the waist.
 - Seek assistance for heavy or awkward loads.
- See Label 1153 in the [LABELING DIAGRAM](#) on p. 7.
- Inspect the product according to the instructions in [INSPECTINGS & MAINTAINING THE HAND TRUCK](#) on p. 4. DO NOT use the product unless it is in [SATISFACTORY CONDITION](#). See p. 4.
- DO NOT use this device UNLESS all product labels are readable and undamaged. See [LABELING DIAGRAM](#) on p. 7.

NOTICE

Proper use, maintenance, and storage are essential for this product to function properly.

- Always use this product in accordance with the instructions in this manual and consistent with any training relevant to machines, devices, etc. used in conjunction with this product.
- Keep the product clean & dry. Lubricate moving parts.

OPERATING THE HAND TRUCK

A. Using as a Hand Truck

1. **Position the Hand Truck:** Place the hand truck next to the drum, aligning the nose plate with the drum's base.
2. **Load the Drum:** Tilt the drum forward slightly and slide the nose plate underneath it. For steel drums, ensure the drum rests against the frame. For plastic drums, use appropriate attachments if provided.
3. **Secure the Drum:** Use straps or clamps (if available) to secure the drum to the frame.
4. **Tilt and Balance:** Tilt the hand truck back until the drum's weight is balanced over the wheels, using the extra-long handles for leverage.
5. **Transport:** Push or pull the hand truck to the desired location, keeping the load stable and avoiding sudden movements. NOTE: DO NOT transport drums over sloped surfaces (up or down)
6. **Unload:** Gently lower the hand truck to set the drum on the ground; then slide the nose plate out from under the drum.

B. Using as a Drum Cradle

1. **Load the Drum:** Load a drum onto the nose plate as described in steps 1 & 2 in *Using as a Hand Truck* (above).
2. **Attach Spigots:** If you need to attach a spigot to the drum to facilitate emptying its contents, install the drum spigot. A drum bung wrench is included with the truck and can be used to remove the bung plug.

3. **Put the Truck into Horizontal Position:** Carefully lay the hand truck horizontally on a flat, stable surface. NOTE: Enlist the help of a coworker if you are not confident that you can safely perform this operation by yourself.
4. **Open the Spigot/Drum Bung:** Open the spigot or drum bung (if not equipped with a spigot) as necessary to empty drum contents.
5. **Pour Contents:** Tilt the drum as needed to pour out contents, controlling the flow to prevent spillage.
6. **Remove the Drum:** Once the drum is either empty or you have dispensed the desired volume from the drum, carefully stand the hand truck upright. Transport the drum to the unloading site. Then, Slide the nose plate out from under the drum.

RECORD OF SATISFACTORY CONDITION (THE "RECORD")

Before putting the hand truck into service, inspect and document its condition to establish a baseline for future inspections. Use the checklist below:

Component	Condition	Notes
Frame	No bends, cracks, or damage	
Wheels	Rotate freely, no flat spots or damage	
Nose Plate	Securely attached, no damage	
Drum Tines	Secure, no damage	
Handles	Secure, no loose parts	
Straps/Clamps (if applicable)	In good condition, functional	
Bung Nut Wrench	Present and functional	
Overall Condition	Clean, no debris or obstructions	

Take photos of the unit that clearly capture all features of the hand truck. Take close range photos of wheel hubs and retaining hardware, the wheel axle weldment (40-514-053), the nose plate and its fasteners, the drum tines, and both handle grips (07-025-005).

INSPECTING AND MAINTAINING THE HAND TRUCK

Compare inspection results to the [RECORD](#). Do not continue to use the product unless every component is in [satisfactory condition](#). Cosmetic changes, like damaged paint/powder coat do not constitute changes from satisfactory condition. However, touchup paint should be applied to all affected areas as soon as damage occurs. Contact the [Technical Service and Replacement Parts](#) department to order replacement parts. Contact information is provided on the cover page of this manual.

- **Pre-Use Inspection:** Before beginning to use the hand truck at the beginning of each day of use, check it for damage or significant wear, including bent frame elements, loose fasteners (bolts and nuts), or worn or otherwise damaged wheels. Ensure all components are in satisfactory condition.
- **Periodic Maintenance:** At least once per month
 - Lubricate wheels and moving parts periodically to ensure smooth operation.
 - Tighten any loose bolts or fasteners.
 - Replace damaged or worn components immediately.
- **Storage:** Store the hand truck in a dry, clean area to prevent corrosion or damage.
- **Do Not Use if Damaged:** Discontinue use if the hand truck is no longer in satisfactory condition and cannot be restored to satisfactory condition. For instance if a component (wheel, nose plate, drum tine, etc.) is damaged, repair the damaged component if possible, or replace it with a manufacturer-approved replacement part. If the truck is generally in such condition that it cannot be operated safely and cannot be restored to satisfactory condition, permanently remove the truck from service.

SWAPPING NOSE PLATE FOR DRUM FORKS

The steel nose plate of DCHT series hand trucks can be swapped for two drum forks to accommodate different drum types. This procedure involves removing four 3/8-16 x 1 ½ bolts and their washers and lock nuts to detach the nose plate and using the same hardware to attach the drum forks.

Tools Required:

- 9/16" wrench or socket
- 9/16" ratchet wrench (optional)
- Work gloves (recommended)

Safety Notes:

- Wear gloves to protect hands from sharp edges or pinching during the swap.
- Do not use damaged bolts, lock nuts, or drum forks; contact Vestil for replacements.
- Ensure the hand truck is stable during the procedure to prevent tipping.

Steps:

1. Prepare the Hand Truck:

- Place the hand truck on a flat, stable surface.
- Ensure the hand truck is unloaded i.e. free of drums or materials.

2. Remove the Nose Plate:

- Locate the four 3/8-16 x 1 ½ bolts securing the nose plate to the hand truck frame. See arrows in diagram.
- Using a 9/16" wrench or socket, hold the lock nut on one side while turning the bolt counterclockwise with another wrench or ratchet.
- Remove all four bolts and lock nuts, keeping them in a safe place for reuse.
- Carefully lift the nose plate off the frame and set it aside.

3. Install the Drum Forks:

- Position the two drum forks on the frame, aligning the mounting holes of each fork with the holes where the nose plate was attached.
- Insert the 3/8-16 x 1 ½ bolts through the mounting holes of the drum forks and frame.
- Secure each bolt with a lock nut, hand-tightening initially to ensure proper alignment.

4. Tighten the Hardware:

- Using the 9/16" wrench or socket, tighten each bolt while holding the lock nut, ensuring all four bolts are securely fastened.
- Verify that the drum forks are firmly attached and do not move when pressure is applied.

5. Inspect the Installation:

- Check that all bolts and lock nuts are tight and that the drum forks are properly aligned.
- Ensure no components are damaged during the swap.

6. Store the Nose Plate:

- Store the removed nose plate in a dry, clean area to prevent corrosion or damage.

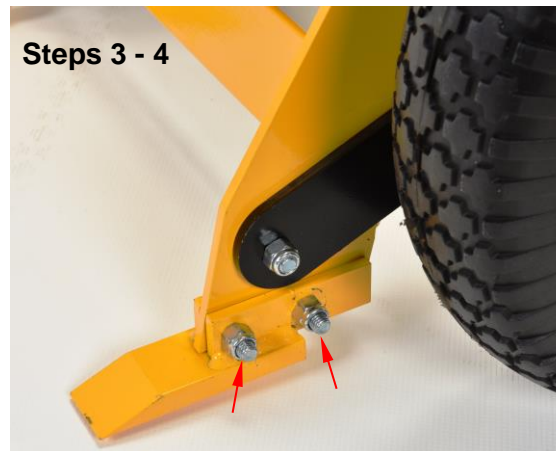
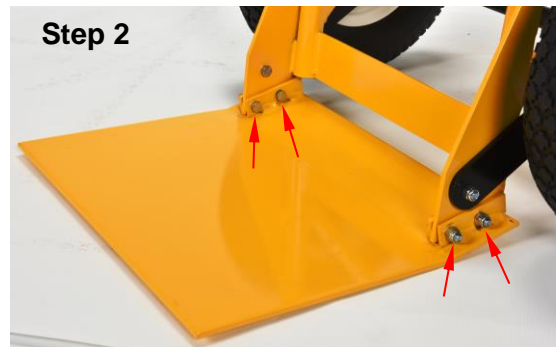

EXPLODED VIEW AND BILL OF MATERIALS DCHT-1 & DCHT-1-FF (40-006-035)

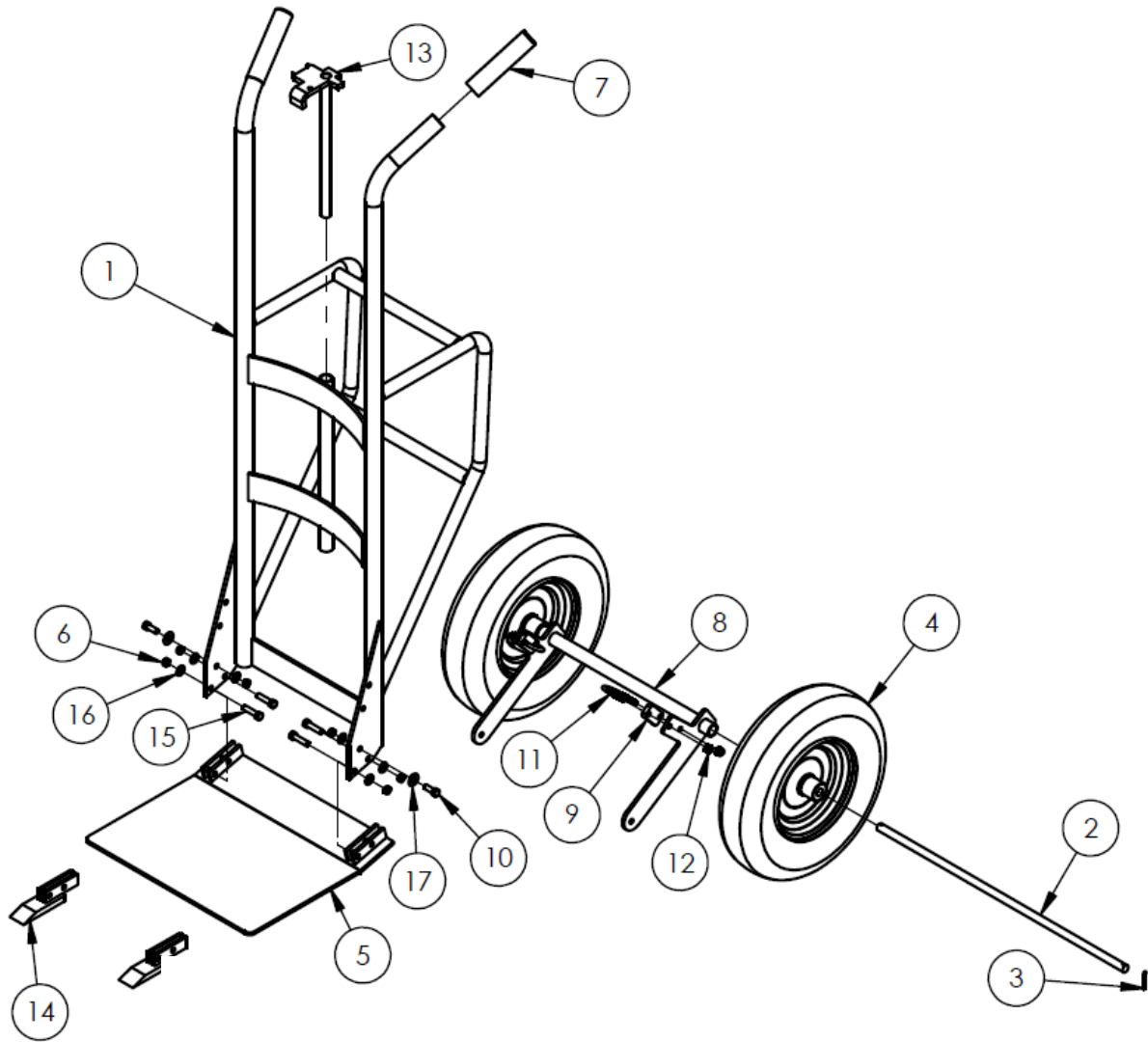

ITEM NO.	PART NO.	DESCRIPTION	QTY.
1	09-514-173	WELDMENT, FRAME, SUB ASSEMBLY	1
2	40-113-003	SPACER, WHEEL ROD	1
3	65078	EXTENDED PRONG COTTER PIN, ZINC FINISH, 1/8" X 1 1/2"	2
4	16-132-126 16-132-246	PNEUMATIC TIRE, 4" X 16" (DCHT-1) FOAM FILLED WHEEL, 4" X 16" (DCHT-1-FF)	2
5	40-514-047	WELDMENT, FRAME, NOSE PLATE	1
6	37026	JAM NYLOCK INSERT LOCK NUT, 3/8-16 UNC, Z PLATED	6
7	07-025-005	HANDLE, BLACK RUBBER, 6"	2
8	40-514-053	WELDMENT, FRAME, AXLE	1
9	40-113-005	SPACER, AXLE	2
10	11105	HEX BOLT, GRADE A, ZINC PLATED, 3/8-16 X 1	2
11	42012	5/16-18 U-BOLT FOR 3/4" PIPE	2
12	37021	NYLON INSERT LOCK NUT, GRADE 2, ZINC FINISH, 5/16"-18	4
13	09-516-067	WELDMENT, DRUM GRIPPER	1
14	09-514-107	WELDMENT, FOOT, DRUM SUPPORT	2
15	11109	HEX BOLT, GRADE A, ZINC FINISH, 3/8-16 X 1 1/2	4
16	33082	WASHER, 3/8" ZINC PTD SAE FLAT WASHER	6
17	76065	FLAT WASHER, NYLON, GRADE 6/6, 1/2" X 1" OD	2

LABELING DIAGRAM

Label content and locations are subject to change so your product might not be labeled exactly as shown. Compare this diagram to the [RECORD](#). If differences exist between the diagram and the *RECORD*, contact [TECHNICAL SERVICE](#). Replace all labels that are damaged, missing, or not easily readable (e.g. faded). To order replacement labels, contact the technical service and parts department online at <https://www.vestil.com/page-parts-request.php>. Alternatively, you may request replacement parts and/or service by calling (260) 665-7586 and asking the operator to connect you to the Parts Department.

⚠ WARNING	⚠ ADVERTENCIA	⚠ AVERTISSEMENT
Do not operate or move with unstable loads DO NOT LOAD beyond rated capacity DISTRIBUTE LOAD EVENLY DO NOT sit or ride	No use o mueva con cargas inestables No cargue más de la capacidad tasada DISTRIBUYA LA CARGA A NIVEL NO SE SIENTE o vaya en el carro	Ne pas utiliser avec une charge instable NE PAS CHARGER au-delà du débit nominale DISTRIBUER la charge régulièrement NE PAS VOUS ASSEoir OU VOUS PROMENER sur le charriot

658

MODEL / MODELO / MODÈLE _____
 WEIGHT / PESO / MASS _____
 CAPACITY / CAPACIDAD / CAPACITÉ _____
 SERIAL / SERIE / SÉRIE _____

UNITS: 2.2 lb. = 1kg 1" (or 1in.) = 2.54cm 1153

1153



TROUBLESHOOTING

Contact Vestil's [TECHNICAL SERVICE](#) department to discuss issues not addressed in this section.

Issue	Possible Cause	Solution
Hand truck tips during use	Load not centered or secured	Ensure drum is centered and secured with straps/clamps
Wheels do not roll smoothly	Debris or lack of lubrication	Clean wheels and lubricate as needed
Drum slips during transport	Inadequate securing	Check and tighten straps/clamps
Difficulty tilting drum in cradle	Improper positioning	Reposition drum to ensure it is centered and stable



LIMITED WARRANTY

Vestil Manufacturing Company (“Vestil”) warrants this product to be free of defects in material and workmanship during the warranty period. Our warranty obligation is to provide a replacement for a defective, original part covered by the warranty after we receive a proper request from the Warrantee (you) for warranty service.

Who may request service?

Only a warrantee may request service. You are a warrantee if you purchased the product from Vestil or from an authorized distributor AND Vestil has been fully paid.

Definition of “original part”?

An original part is a part used to make the product as shipped to the Warrantee.

What is a “proper request”?

A request for warranty service is proper if Vestil receives: 1) a photocopy of the Customer Invoice that displays the shipping date; AND 2) a written request for warranty service including your name and phone number. Send requests by one of the following methods:

<u>US Mail</u>	<u>Fax</u>	<u>Email</u>
Vestil Manufacturing Company	(260) 665-1339	info@vestil.com
2999 North Wayne Street, PO Box 507	<u>Phone</u>	Enter “Warranty service request”
Angola, IN 46703	(260) 665-7586	in subject field.

In the written request, list the parts believed to be defective and include the address where replacements should be delivered. After Vestil receives your request for warranty service, an authorized representative will contact you to determine whether your claim is covered by the warranty. Before providing warranty service, Vestil will require you to send the entire product, or just the defective part (or parts), to its facility in Angola, IN.

What is covered under the warranty?

The warranty covers defects in the following original, dynamic parts: motors, hydraulic pumps, motor controllers, and cylinders. It also covers defects in original parts that wear under normal usage conditions (“wearing parts”), such as bearings, hoses, wheels, seals, brushes, and batteries.

How long is the warranty period?

The warranty period for original dynamic components is 90 days. For wearing parts, the warranty period is 90 days. Both warranty periods begin on the date Vestil ships the product to the Warrantee. If the product was purchased from an authorized distributor, the periods begin when the distributor ships the product. Vestil may, at its sole discretion, extend a warranty period for products shipped from authorized distributors by up to 30 days to account for shipping time.

If a defective part is covered by the warranty, what will Vestil do to correct the problem?

Vestil will provide an appropriate replacement for any *covered* part. An authorized representative of Vestil will contact you to discuss your claim.

What is not covered by the warranty?

The Warrantee (you) are responsible for paying labor costs and freight costs to return the product to Vestil for warranty service.

Events that automatically void this Limited Warranty.

- Misuse;
- Negligent assembly, installation, operation or repair;
- Installation/use in corrosive environments;
- Inadequate or improper maintenance;
- Damage sustained during shipping;
- Collisions or other accidents that damage the product;
- Unauthorized modifications: Do not modify the product IN ANY WAY without first receiving written authorization from Vestil.

Do any other warranties apply to the product?

Vestil Manufacturing Co. makes no other express warranties. All implied warranties are disclaimed to the extent allowed by law. Any implied warranty not disclaimed is limited in scope to the terms of this Limited Warranty. Vestil makes no warranty or representation that this product complies with any state or local design, performance, or safety code or standard. Noncompliance with any such code or standard is not a defect in material or workmanship.