

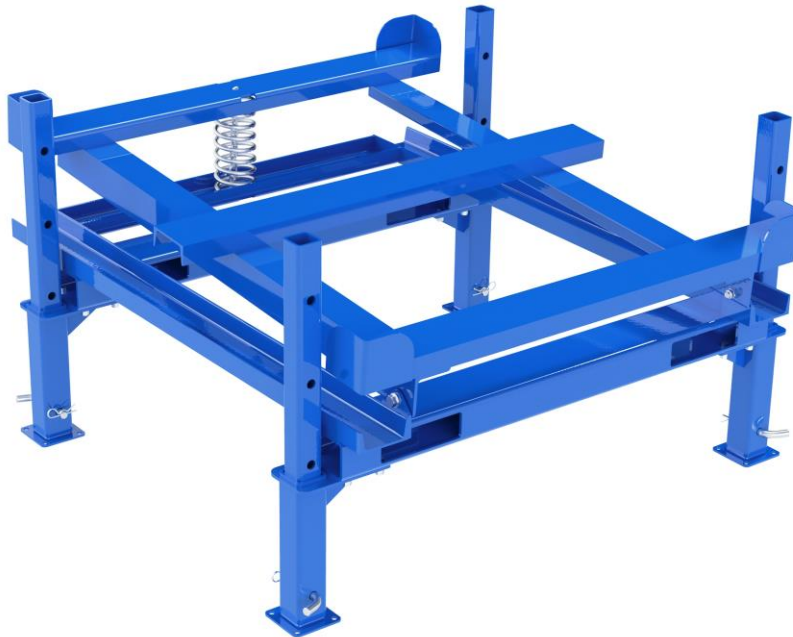

**Vestil Manufacturing Company**  
 2999 North Wayne Street, P.O. Box 507, Angola, IN 46703  
 Telephone: (260) 665-7586 -or- Toll Free (800) 348-0868  
 Fax: (260) 665-1339  
 Web: [www.vestil.com](http://www.vestil.com) e-mail: [info@vestil.com](mailto:info@vestil.com)

# IBC-TLT-FPL



**Receiving Instructions**

After delivery, remove the packaging from the product. Inspect the product closely to determine whether it sustained damage during transport. If damage is discovered, record a complete description of it on the bill of lading. If the product is undamaged, discard the packaging.

**NOTE:** The end-user is solely responsible for confirming that product design, use, and maintenance comply with laws, regulations, codes, and mandatory standards applied where the product is used.

**Technical Service & Replacement Parts**

For answers to questions not addressed in these instructions and to order replacement parts, labels, and accessories, call our Technical Service and Parts Department at (260) 665-7586. The department can also be contacted online at <https://www.vestil.com/page-parts-request.php>.

**Electronic copies of Instruction Manuals**

Additional copies of this instruction manual may be downloaded from <https://www.vestil.com/page-manuals.php>.

<b>Table of Contents</b>		<b>Page</b>
Signal Words.....		2
Safety Instructions.....		2
Assembling the Container Stand.....		2 - 3
Using the Container Stand.....		4
Exploded View and Bill of Materials.....		4
Specifications.....		5
Record of Satisfactory Condition.....		6
Inspecting & Maintaining the Stand.....		6
Labeling Diagram.....		7

## SIGNAL WORDS

SIGNAL WORDS appear in this manual to draw the reader’s attention to important safety-related messages.



**Identifies a hazardous situation which, if not avoided, WILL result in DEATH or SERIOUS INJURY. Use of this signal word is limited to the most extreme situations.**



**Identifies a hazardous situation which, if not avoided, COULD result in DEATH or SERIOUS INJURY.**



**Indicates a hazardous situation which, if not avoided, COULD result in MINOR or MODERATE injury.**



**Identifies practices likely to result in product/property damage, such as operation that might damage the product.**

## SAFETY INSTRUCTIONS

Vestil strives to identify all foreseeable hazards associated with the use of its products. However, material handling is dangerous and no manual can address every conceivable risk. Ultimately, the most effective way to prevent injury is to apply sound judgment whenever using this device.

### ⚠️ WARNING

Improper or careless use of this product could result in death or serious personal injuries.

- Read and understand the entire manual before assembling, installing, using or servicing the product. Read the manual to refresh your understanding of proper use and maintenance procedures.
- DO NOT attempt to resolve any problem(s) with the product unless you are both authorized to do so and certain that it will be safe to use afterwards.
- DO NOT modify the product in any way UNLESS you first obtain written approval from Vestil. Unapproved modifications automatically void the LIMITED WARRANTY on p. 7 and might make the product unsafe to use.
- DO NOT exceed the capacity: 4,400 pounds (2000kg). Capacity information is provided in on-product labeling. See SPECIFICATIONS on p. 5; Label 1153 in the LABELING DIAGRAM on p. 6.
- Inspect the product according to the instructions in INSPECTING & MAINTAINING THE STAND. DO NOT use the product unless it is in satisfactory condition.
- DO NOT move the stand (via lift truck) until the IBC has been removed from the stand.
- DO NOT use the stand UNLESS all labels are readable & undamaged. See LABELING DIAGRAM.

## ASSEMBLING THE CONTAINER STAND

Numbers in parentheses () refer to part numbers in the bill of materials of the Exploded View on p. 4. At least 2 people should work together to assemble this product. Additionally, you will need either a 9/16" or adjustable crescent wrench, or a 9/16" socket and socket wrench to assemble the product.

- 1) Begin the assembly process by inserting the forks of your lift truck into the fork channels and lifting the main body to an ergonomically comfortable height above the ground. Notice that there are sets of 4 bolt holes at both ends of the frame tubes (circled).

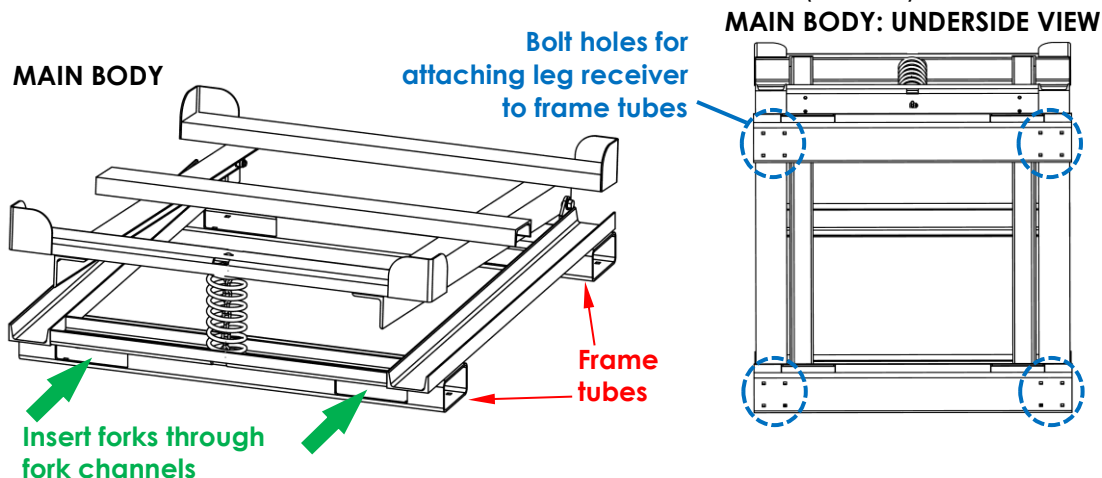

- 2) Attach a **leg receiver (16-514-345)** to each end of the frame tubes with 3/8"-16 x 1" carriage bolts (21355) and **3/8"-16 lock nuts (37024)**. Insert bolts through the frame tubes; then through the bolt holes in the leg receivers. Secure each bolt with a lock nut. Wrench-tighten each connection.

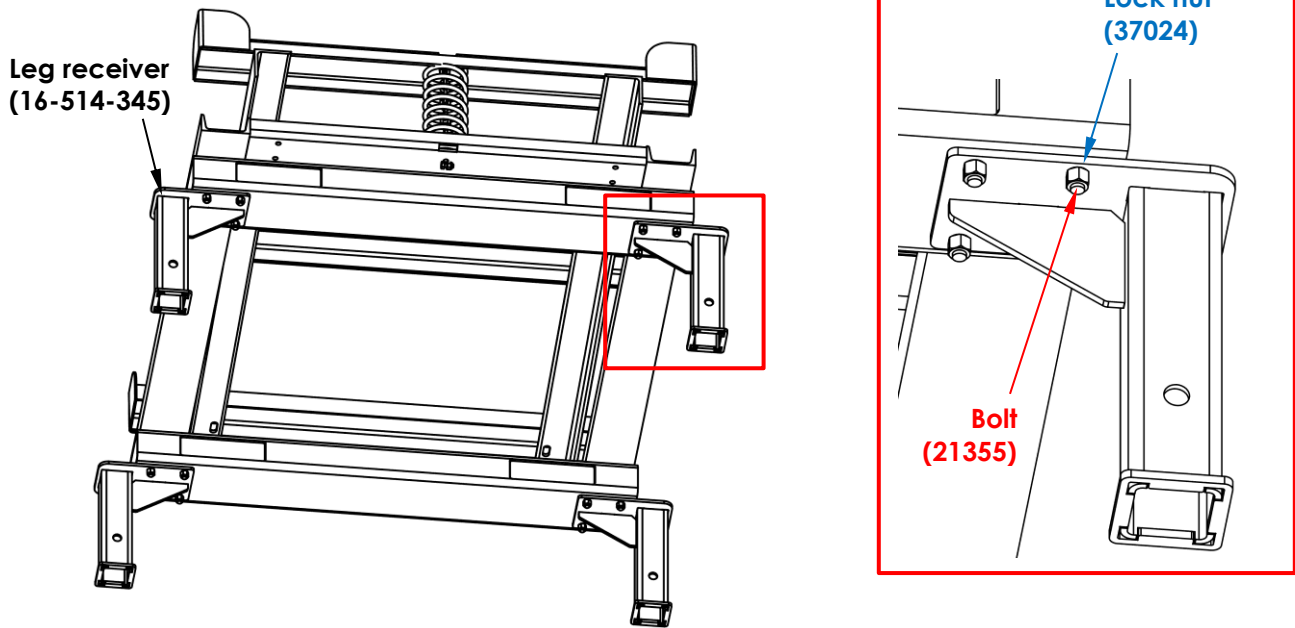

- 3) If necessary, elevate the forks of the lift truck so that the bottoms of the leg receivers are about 38 inches above the ground. Install each **leg (16-514-346)** into the leg receivers: insert the top of a leg into the bottom of a leg receiver. Align the selected holes in the legs with the pin holes in the leg receivers. Insert a **leg pin (99-112-030)** through the aligned pin holes; then insert a **hitch pin clip (45286)** through the hole at the end of each leg pin. Legs are adjustable in 6 in. increments. See *USING THE CONTAINER STAND* on p. 4.

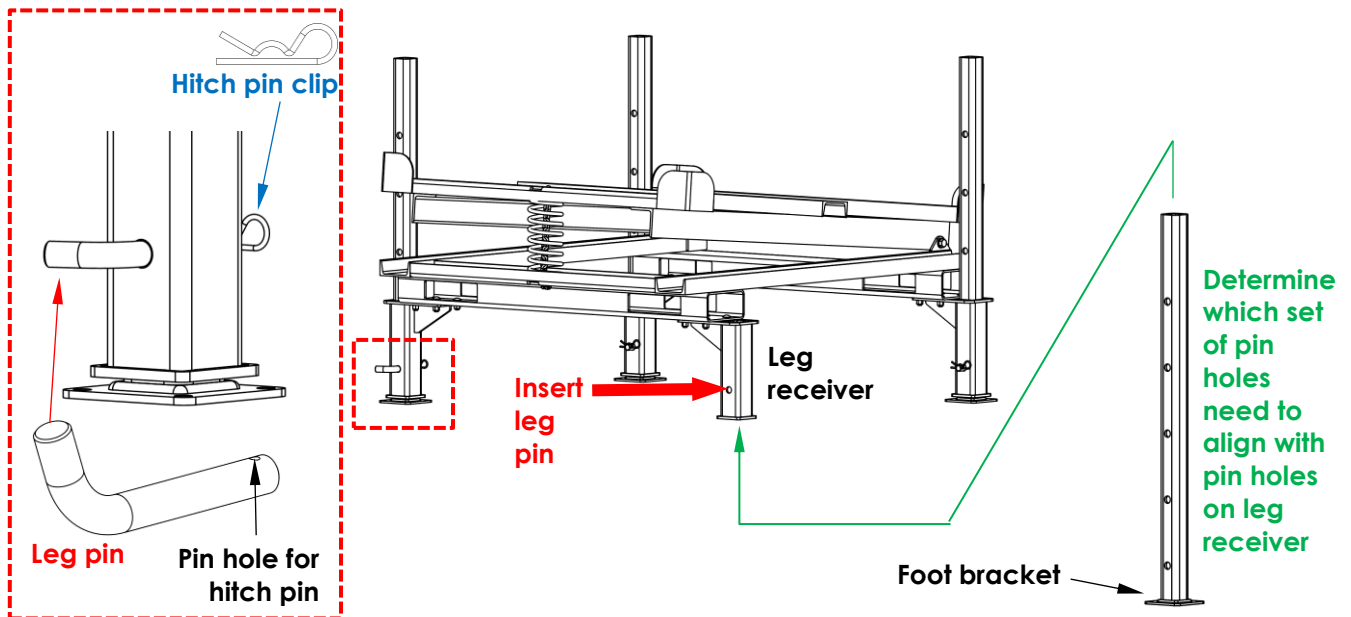

- 4) Carefully set the container holder on its feet in the location where it will be used. The use location should be even, level and able to support the combined weight of the container holder and a full capacity load. Refer to your **Specifications** document; add the MAX CAPACITY figure and the APPROX WEIGHT figure to determine the combined weight.

## USING THE CONTAINER STAND

The stand is designed to support 275 gallon and 300 gallon intermediate bulk containers (ICB's). Before setting an IBC on the stand, anchor all 4 legs to the ground with 3/8" x 4" long anchor bolts. Install anchor bolts in all four **anchor bolt holes** of each **foot bracket** (16 bolts required).

Legs are adjustable in 6" increments (15.2cm). To adjust the height of the stand, first make sure that it is unloaded. If necessary, remove the IBC from the stand. Then, remove **hitch pin clips** and **leg pins**. Raise the stand to the desired height with your lift truck. Align pin holes in the legs with the pin holes in the leg receivers and reinstall the leg pins and hitch clips.

Place an IBC on the stand with the **drain (butterfly valve)** opposite the spring as shown in the diagrams to the right. The spring elevates the back side of the container support as the weight of the container decreases. Elevating the back side of the IBC causes its contents to flow towards the drain.

The stand can be transported via forklift. However, it should not be transport the stand while it is loaded. Remove the IBC from the stand. Remove all anchor bolts. Insert the forks into the (2) for pockets in the frame. Tilt the forklift mast toward the cab and slowly and carefully drive the stand to the offloading location.

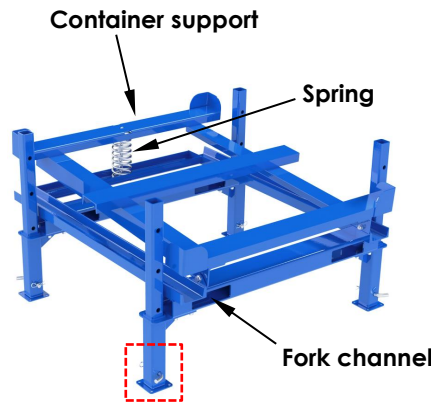
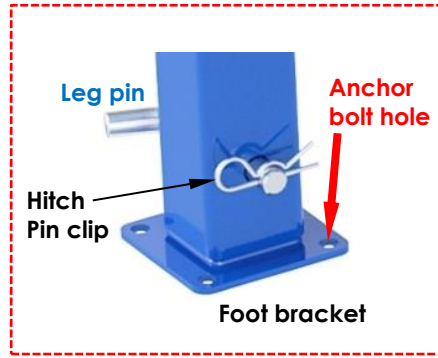

## IBC-TLT-FPL EXPLODED VIEW AND BILL OF MATERIALS

16-006-504

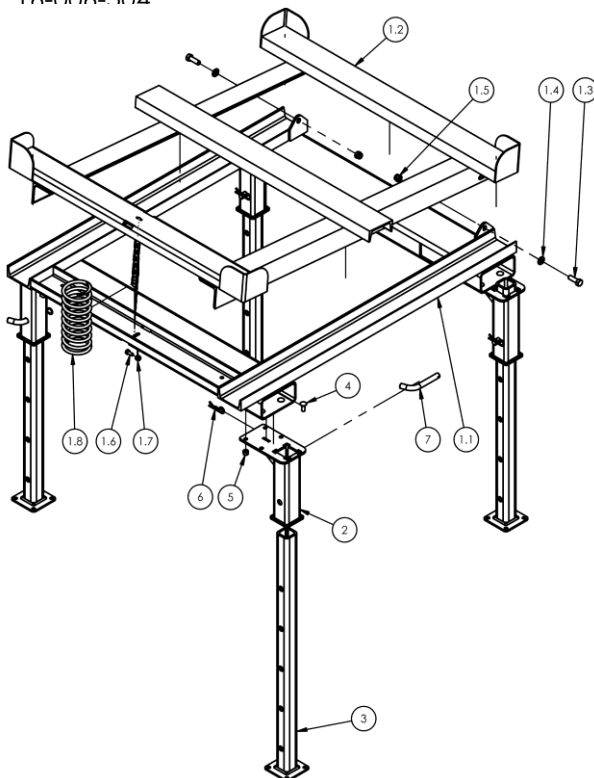

ITEM NO.	PART NO.	DESCRIPTION	QTY.
1	16-001-503	FINAL ASSEMBLY W/O SHIPPING	1
1.1	16-514-344	WELDMENT, FRAME SUB-ASSEMBLY	1
1.2	16-514-277	WELDMENT, UPPER FRAME	1
1.3	11209	1/2-13 X 1 1/2" LG HHCS - ASTM A307 GRADE A, ZINC PLATED	2
1.4	33011	FLAT WASHER, USS, PLAIN FINISH, Ø1/2"	2
1.5	37030	1/2"-13 NYLON INSERT LOCK NUT, GRADE 2	2
1.6	11053	Ø 5/16 - 18 x 3/4 LG HHCS #2 Z-PLATED, GRADE A	1
1.7	37021	NYLON INSERT LOCK NUT, GRADE 2, ZINC FINISH, 5/16"-18	1
1.8	16-146-005	SPRING, TILTING SPRING	1
2	16-514-345	WELDMENT, SUB-ASSEMBLY	4
3	16-514-346	WELDMENT, FRAME	4
4	21355	Ø3/8"-16 x 1" Zinc Finish Grade A Round Head Carriage Bolt	16
5	37024	NYLON INSERT LOCK NUT, GRADE 2, ZINC FINISH, 3/8"-16	16
6	45286	#11 HITCH PIN CLIP, Ø1/8" X 2 5/8 LG	4
7	99-112-030	PIN, LEG	4

# SPECIFICATIONS

Documents that provide specifications for IBC-TLT-series intermediate bulk container stands are available online to anyone who visits Vestil's website. Specifications include dimensions, net weight, and capacity information. To access the appropriate specifications document, navigate to the IBC-TLT webpage at <https://www.vesfil.com/product.php?FID=1638>. Scroll the page to the entry for the stand product you purchased. Click the button in the "PDF" column that looks like a pencil inside a blue box. A PDF file will open. This file is the specifications document. Print a copy of the document and keep it with your copy of this manual. The following is an exemplar specification document, in this case, for model IBC-TLT-FPL.

**ADJUSTABLE IBC TILT STAND W/ FORK POCKETS - IBC-TLT-FPL** APPROX WEIGHT: 319.59 lbs.  
DOES NOT INCLUDE WEIGHT OF POWER OR PACKAGING!!!  
 \*\*\* ANY ADDITIONS, DELETIONS, OR OMISSIONS MUST BE CORRECTED ON THIS DRAWING AS THIS DRAWING WILL BE CONSIDERED ALL INCLUSIVE \*\*\*  
 ALL GRAPHICS PROVIDED ARE FOR REFERENCE ONLY. IF CERTAIN DIMENSIONS ARE CRITICAL PLEASE VERIFY THOSE DIMENSIONS WITH YOUR SALESPERSON

**STANDARD FEATURES**  
 MODEL NUMBER IS: IBC-TLT-FPL  
 MAX CAPACITY IS: 4,400 LBS  
 OVERALL WIDTH IS: 48"  
 USABLE WIDTH IS: 40 1/2"  
 OVERALL LENGTH IS: 48 1/2"  
 USABLE LENGTH IS: 47 3/4"  
 HEIGHT ADJUSTMENT IN: 6" INCREMENTS  
 2" HIGH X 7" WIDE FORK POCKETS ON 27" CENTERS  
 TOUGH BAKED IN POWDER COATED BLUE FINISH

**SPECIAL FEATURES**  
 NONE

**APPROVAL**  
 I, THE UNDERSIGNED, AGREE THAT THE PRODUCT AS REPRESENTED SATISFIES DESIGN AND DIMENSION REQUIREMENTS. I ALSO ACKNOWLEDGE MY DUTY TO CONFIRM PRODUCT AND INSTALLATION COMPLIANCE WITH ALL APPLICABLE FEDERAL, STATE AND LOCAL REGULATIONS AND STANDARDS.  
**UNITS REQUIRING APPROVAL DRAWINGS OR MODIFIED ARE NON-RETURNABLE**  
 As drawn     As marked

Signed: \_\_\_\_\_ Date: \_\_\_\_\_  
 Printed Name: \_\_\_\_\_  
 LEAD TIME WILL START UPON RECEIPT OF SIGNED APPROVAL DRAWING

DISTRIBUTOR'S NAME: <b>VESTIL MANUFACTURING</b>		P.O.# X
DRAWN BY: JGP	DATE: 8/4/2020	W.O.# X
REFERENCE: X	SCALE: 1:20	SALES: X
QUOTED LEAD TIME: X	QUOTE # X	FILE NAME: 16-007-504

DIMENSION TOLERANCE ± 1/4"  
 FEET MUST BE ANCHORED TO GROUND.

## RECORD OF SATISFACTORY CONDITION (THE "RECORD")

After the unit is installed, make a detailed record of its condition. Include observations about all features: pivot points, welds, the container support subassembly, spring, legs, leg receivers, pins and anchor bolts. Thoroughly photograph the unit from multiple angles so that all features are clearly imaged. Photograph all labels applied to the stand. Describe where each label is located. Collect all photographs and writings in a single file. This file is a record of the stand in satisfactory condition. Compare the results of each inspection to this *RECORD* to determine whether the unit is in satisfactory condition. Do not use the stand unless it is in satisfactory condition.

## INSPECTING AND MAINTAINING THE STAND

Compare inspection results to your [RECORD](#). Do not continue to use the product unless every component is in [SATISFACTORY CONDITION](#). Cosmetic changes, like damaged paint/powder coat do not constitute changes from satisfactory condition. However, touchup paint should be applied to all affected areas as soon as damage occurs. Contact the [TECHNICAL SERVICE & PARTS DEPARTMENT](#) to order replacement parts. Contact information is provided on the cover page of this manual.

Inspect the following at least once per month:

1. Surfaces – Check all surfaces of the stand for dirt or other matter, especially fluids. Clean the surfaces of the stand with a mild soap and water solution and air dry.
2. Hardware, fasteners – Examine hardware & fasteners (anchor bolts and sleeves, bolts, nuts, pins, & clips). Replace damaged/worn hardware. Any time a lock nut is removed, it must be replaced with a new lock nut.
3. Spring – Check the spring for cracks and other damage. Remove debris.
4. Labels – Replace labels that are damaged, missing, or not easily readable from a reasonable distance. See [LABELING DIAGRAM](#).
5. Frame (all parts of the stand not listed in parts 1-4 above) – Examine the legs, leg receivers, and all other frame elements for wear, breaks, corrosion/rust, metal fatigue, and other forms of damage (e.g. impact damage). Examine the whole structure for rusting or metal erosion, rot, thinned regions. In particular, examine pivot points, legs and anchor brackets. If rusting is purely superficial, remove the rust/corrosion. Clean the affected area and apply touchup paint. If rusting, rot, or thinning has weakened the material, contact [TECHNICAL SERVICE](#) for advice.

## LABELING DIAGRAM

Label content and locations are subject to change so your product might not be labeled exactly as shown. Replace labels that are damaged, missing, or not easily readable (e.g. faded). To order replacement labels, contact the technical service and parts department online at <https://www.vestil.com/page-parts-request.php> or by calling (260) 665-7586 and asking the operator to connect you to the Parts Department.

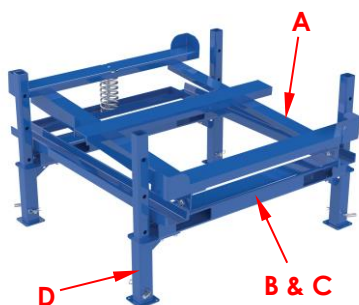

**A:** Label 208 (apply to both sides)



**B:** Label 1153

MODEL / MODELO / MODÈLE _____
WEIGHT / PESO / MASS _____
CAPACITY / CAPACIDAD / CAPACITÉ _____
SERIAL / SERIE / SÉRIE _____
UNITS: 2.2 lb. = 1kg      1' (or 1m.) = 2.54m
<b>1153</b>

**D:** Label 1107 (on leg receivers)

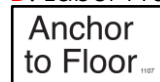

**C:** Label 1049

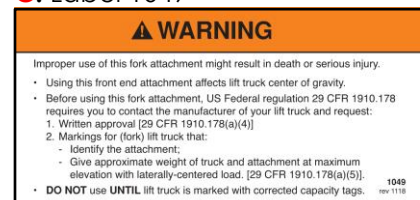



## LIMITED WARRANTY

Vestil Manufacturing Company ("Vestil") warrants this product to be free of defects in material and workmanship during the warranty period. Our warranty obligation is to provide a replacement for a defective, original part covered by the warranty after we receive a proper request from the Warrantee (you) for warranty service.

### Who may request service?

Only a warrantee may request service. You are a warrantee if you purchased the product from Vestil or from an authorized distributor AND Vestil has been fully paid.

### Definition of "original part"?

An original part is a part used to make the product as shipped to the Warrantee.

### What is a "proper request"?

A request for warranty service is proper if Vestil receives: 1) a photocopy of the Customer Invoice that displays the shipping date; AND 2) a written request for warranty service including your name and phone number. Send requests by one of the following methods:

US Mail	Fax	Email
Vestil Manufacturing Co. 2999 North Wayne Street, PO Box 507 Angola, IN 46703	(260) 665-1339 <u>Phone</u> (260) 665-7586	<a href="mailto:info@vestil.com">info@vestil.com</a> Enter "Warranty service request" in subject field.

In the written request, list the parts believed to be defective and include the address where replacements should be delivered. After Vestil receives your request for warranty service, an authorized representative will contact you to determine whether your claim is covered by the warranty. Before providing warranty service, Vestil will require you to send the entire product, or just the defective part (or parts), to its facility in Angola, IN.

### What is covered under the warranty?

The warranty covers defects in the following original, dynamic parts: motors, hydraulic pumps, motor controllers, and cylinders. It also covers defects in original parts that wear under normal usage conditions ("wearing parts"), such as bearings, hoses, wheels, seals, brushes, and batteries.

### How long is the warranty period?

The warranty period for original dynamic components is 90 days. For wearing parts, the warranty period is 90 days. Both warranty periods begin on the date Vestil ships the product to the Warrantee. If the product was purchased from an authorized distributor, the periods begin when the distributor ships the product. Vestil may, at its sole discretion, extend a warranty period for products shipped from authorized distributors by up to 30 days to account for shipping time.

### If a defective part is covered by the warranty, what will Vestil do to correct the problem?

Vestil will provide an appropriate replacement for any covered part. An authorized representative of Vestil will contact you to discuss your claim.

### What is not covered by the warranty?

The Warrantee (you) are responsible for paying labor costs and freight costs to return the product to Vestil for warranty service.

### Events that automatically void this Limited Warranty.

- Misuse;
- Negligent assembly, installation, operation or repair;
- Installation/use in corrosive environments;
- Inadequate or improper maintenance;
- Damage sustained during shipping;
- Collisions or other accidents that damage the product;
- Unauthorized modifications: Do not modify the product IN ANY WAY without first receiving written authorization from Vestil.

### Do any other warranties apply to the product?

Vestil Manufacturing Co. makes no other express warranties. All implied warranties are disclaimed to the extent allowed by law. Any implied warranty not disclaimed is limited in scope to the terms of this Limited Warranty. Vestil makes no warranty or representation that this product complies with any state or local design, performance, or safety code or standard. Noncompliance with any such code or standard is not a defect in material or workmanship.