



## Pallet Puller

Owner's Manual



**WARNING:** Read carefully and understand all ASSEMBLY AND OPERATION INSTRUCTIONS before operating. Failure to follow the safety rules and other basic safety precautions may result in serious personal injury.

Item #52413 & #52414

**SAVE THESE INSTRUCTIONS**

Thank you very much for choosing a Strongway™ product!

For future reference, please complete the owner's record below:

Serial Number/Lot Date Code: \_\_\_\_\_

Purchase Date: \_\_\_\_\_

Save the receipt, warranty, and this manual. It is important that you read the entire manual to become familiar with this product before you begin using it.

This Pallet Puller is designed for certain applications only. Northern Tool and Equipment is not responsible for issues arising from modification or improper use of this product such as an application for which it was not designed. We strongly recommend that this product not be modified and/or used for any application other than that for which it was designed.

For technical questions, please call **1-800-222-5381**.

**Table of Contents**

**Intended Use.....4**

**Technical Specifications .....4**

**Important Safety Information .....4**

**Specific Operation Warnings .....4**

**Operating Instructions.....4**

**Maintenance .....5**

**Parts Diagram .....6**

**Parts List .....7**

**Replacement Parts .....7**

**Limited Warranty .....8**

## Intended Use

The Strongway Pallet Puller is used to slide heavy crates and pull loaded pallets. It has a 5 inch maximum jaw opening and fit for 1 ½ inch space pallets.

## Technical Specifications

Item#	#52413 Specification	#52414 Specification
Pulling Capacity (lbs)	5,000	2,000
Jaw Opening (in)	5 (max.)	5 (max.)
Compatible With	1 1/2 inch space pallet	1 1/2 inch space pallet

## Important Safety Information

### ⚠WARNING

- Read and understand all instructions. Failure to follow all instructions may result in serious injury or property damage.
- The warnings, cautions, and instructions in this manual cannot cover all possible conditions or situations that could occur. Exercise common sense and caution when using this tool. Always be aware of the environment and ensure that the tool is used in a safe and responsible manner.

## Specific Operation Warnings

### ⚠WARNING

- Material handling is inherently dangerous. Improper use might result in death or serious personal injury.
- ONLY use the tool to PULL pallets. DO NOT use it as a lifting device.
- DO NOT exceed the maximum rated load.
- DO NOT use to pull top-heavy or unstable loads.
- DO NOT use to pull broken or damaged pallets.
- Pull ONLY 1 pallet at a time.

## Operating Instructions

The operating instructions in this manual only *supplement* the operation rules applied at your workplace. Safe use of this device is the operator's responsibility.

1. Engage the stringer (not the deck boards) of a pallet or skid with the jaws of the puller.
2. Attach the shackle to a fork truck and slowly drive the truck in reverse. As force is applied, the jaws tightly grip the stringer.
3. When the pallet is in position to be directly engaged by the forks of your lift truck, reverse direction momentarily; then uncouple the puller from the fork truck. Open the jaws of the puller to release the pallet.

## Maintenance

Maintain the pallet puller by adopting a program of conscientious repair and maintenance in accordance with the following recommended procedures. It is recommended that the general condition of any tool be examined before it is used. Keep your pallet puller in good repair. Keep handles dry, clean, and free from oil and grease. Regular inspections and maintenance are necessary to keep the puller in satisfactory operating condition.

### Inspections

DO NOT use the pallet puller if it fails any part of the inspection described below.

Inspect the pallet puller before it is used for the first time. Thereafter, inspect the unit regularly, e.g., at least once per week. Inspect the following:

1. Jaw arms and link arms: Examine the arms for twisting, bending, and warping regions. Pay particular attention to pivot points.
2. Pins: Check all pivot pins and the shackle pins for straightness. Each pin should be able to rotate freely.
3. Shackle or chain: Inspect for cracks, elongations, and deformations.
4. Grippers: Confirm soundness of welds to the jaw arms.
5. All components: Check for excessive wear.

### Maintenance

1. Clean the pallet puller periodically to preserve the paint.
2. Lubricate all of the pivot points.

# Parts Diagram

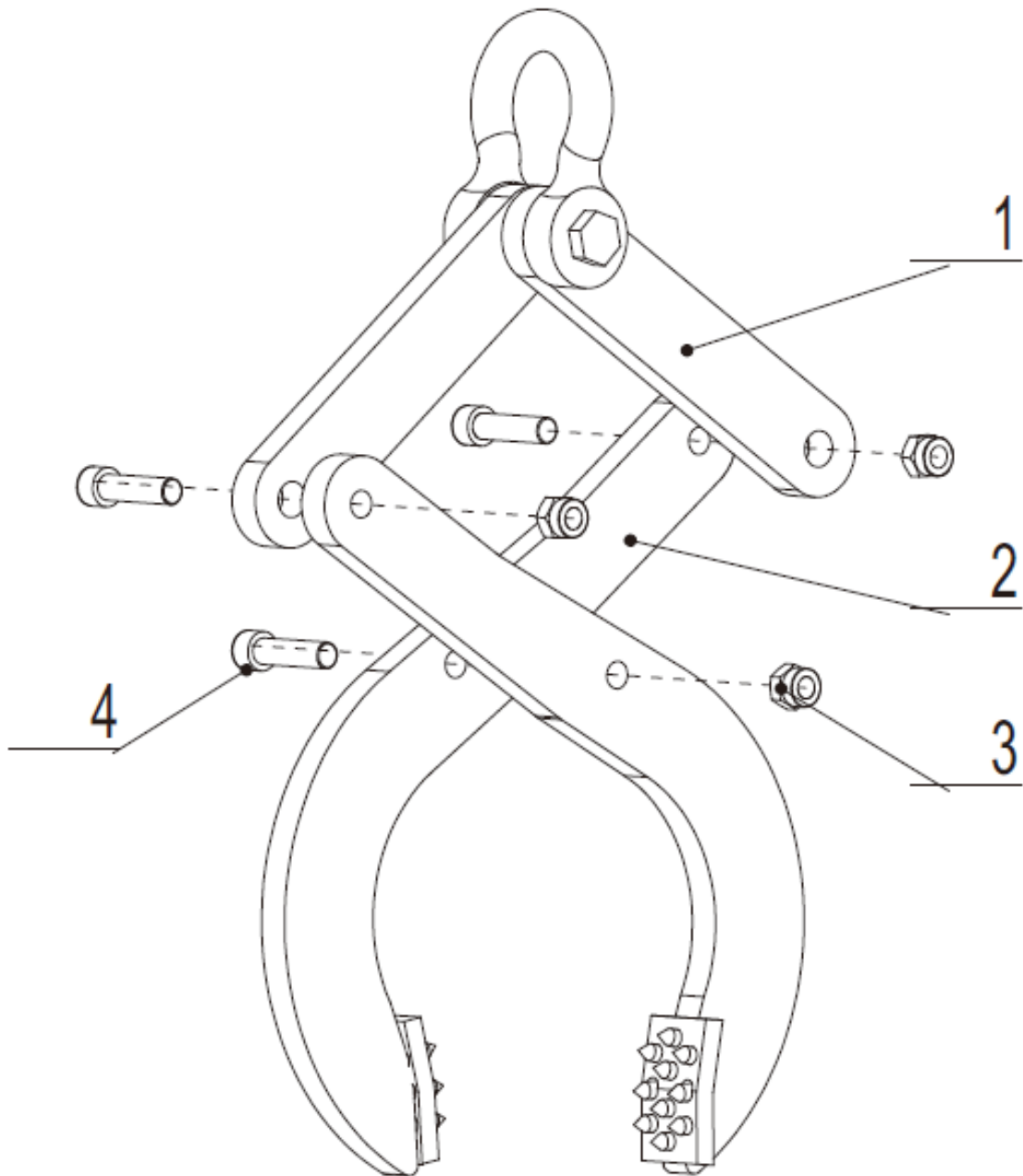

## Parts List

Part Number	Part Description	Quantity
1	Straight Seaming Part	1
2	Crank Seaming Part	2
3	V Nut	3
4	Hex Cap Screw	3

## Replacement Parts

- For replacement parts and technical questions, please call Customer Service at **1-800-222-5381**.
- Not all product components are available for replacement. The illustrations provided are a convenient reference to the location and position of parts in the assembly sequence.
- When ordering parts, the following information will be required: item description, item model number, item serial number/item lot date code, and the replacement part reference number.
- The distributor reserves the rights to make design changes and or improvements to product lines and manuals without notice.

## Limited Warranty

Northern Tool and Equipment Company, Inc. ("We" or "Us") warrants to the original purchaser only ("You" or "Your") that the Strongway product purchased will be free from material defects in both materials and workmanship, normal wear and tear excepted, for a period of one year from date of purchase. The foregoing warranty is valid only if the installation and use of the product is strictly in accordance with product instructions. There are no other warranties, express or implied, including the warranty of merchantability or fitness for a particular purpose. If the product does not comply with this limited warranty, Your sole and exclusive remedy is that We will, at our sole option and within a commercially reasonable time, either replace the product or product component without charge to You or refund the purchase price (less shipping). This limited warranty is not transferable.

### Limitations on the Warranty

This limited warranty does not cover: (a) normal wear and tear; (b) damage through abuse, neglect, misuse, or as a result of any accident or in any other manner; (c) damage from misapplication, overloading, or improper installation; (d) improper maintenance and repair; and (e) product alteration in any manner by anyone other than Us, with the sole exception of alterations made pursuant to product instructions and in a workmanlike manner.

### Obligations of Purchaser

You must retain Your product purchase receipt to verify date of purchase and that You are the original purchaser. To make a warranty claim, contact Us at 1-800-222-5381, identify the product by make and model number, and follow the claim instructions that will be provided. The product and the purchase receipt must be provided to Us in order to process Your warranty claim. Any returned product that is replaced or refunded by Us becomes our property. You will be responsible for return shipping costs or costs related to Your return visit to a retail store.

### Remedy Limits

Product replacement or a refund of the purchase price is Your sole remedy under this limited warranty or any other warranty related to the product. We shall not be liable for: service or labor charges or damage to Your property incurred in removing or replacing the product; any damages, including, without limitation, damages to tangible personal property or personal injury, related to Your improper use, installation, or maintenance of the product or product component; or any indirect, incidental or consequential damages of any kind for any reason.

### Assumption of Risk

You acknowledge and agree that any use of the product for any purpose other than the specified use(s) stated in the product instructions is at Your own risk.

### Governing Law

This limited warranty gives You specific legal rights, and You also may have other rights which vary from state to state. Some states do not allow limitations or exclusions on implied warranties or incidental or consequential damages, so the above limitations may not apply to You. This limited warranty is governed by the laws of the State of Minnesota, without regard to rules pertaining to conflicts of law. The state courts located in Dakota County, Minnesota shall have exclusive jurisdiction for any disputes relating to this warranty.



Distributed by:

Northern Tool & Equipment Company, Inc.

Burnsville, Minnesota 55306

[www.northerntool.com](http://www.northerntool.com)

Made in China