

Safety Ladder Gate

Part #: 10798

GUARDIAN
FALL PROTECTION
PERFORMANCE SAFETY GEAR

Compliant with all OSHA 1910 and OSHA 1926 Subpart M regulations.

Safety Ladder Gates are suitable for the following application:



Safety Ladder Gate may only be used in combination with a compatible ladder in Fall Prevention applications. Fall Prevention Systems are placed around the leading edges of any and all fall hazards to prevent a worker from going over an edge. Installation requirements for Safety Ladder Gate must be adhered to. Personal Fall Arrest, Work Positioning, Rescue, and any other systems must NEVER be connected to Fall Prevention Systems.

Materials: powder-coated aluminum.

Not repairable by the manufacturer.

Components:

4 Allen Screws (4mm or 5/32")
2 Brackets
1 Safety Ladder Gate

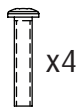

x4

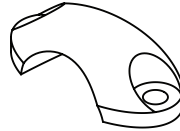

x2



Shown installed on Safe-T Ladder (#10800)



Always adhere to ladder slope requirements (4/1, vertical/horizontal).

Top rung step of ladder must be in line with landing platform.

Top of Safety Ladder Gate MUST be 42" (+/- 3") above walking surface.

Ladder MUST be secured to landing platform to use Safety Ladder Gate.

Only use ladder on stable and level surfaces.

One hand must always grasp a ladder rung during climbing.

NEVER carry loads that may cause loss of balance.

MAXIMUM 1 user per ladder at any time.

UPC Code: 672421107981.

Carton Dimensions: 20"L x 20"W x 12"H.

Carton Weight: 45 lbs.

Carton Quantity: 5.