



30" COMMERCIAL PEDESTAL FAN

Owner's Manual



⚠ WARNING: Read carefully and understand all ASSEMBLY AND OPERATION INSTRUCTIONS before operating. Failure to follow the safety rules and other basic safety precautions may result in serious personal injury.

Item # 49939

Thank you very much for choosing a Strongway product!

For future reference, please complete the owner's record below:

Serial Number/Lot Date Code: _____

Purchase Date: _____

Save the receipt, warranty, and this manual. It is important that you read the entire manual to become familiar with this product before you begin using it.

This **fan** is designed for certain applications only. The distributor cannot be responsible for issues arising from modification or use of this product in an application for which it was not designed. We strongly recommend that this product not be modified and/or used for any application other than that for which it was designed. If you have questions about a particular modification or application, **DO NOT** use the product until you have first contacted the distributor to determine if the product can or should be modified or used in such an application.

For technical questions, please call **1-800-222-5381**.

Table of Contents

Intended Use	4
Technical Specifications	4
General Safety Rules	Error! Bookmark not defined.
Important Safety Considerations	5
Specific Operation Warnings	7
Safety Labels	7
Assembly	7
Before Each Use	8
Operating Instructions	8
After Each Use	8
Maintenance	8
Parts Diagram	9
Parts List	9
Troubleshooting	10
Replacement Parts	10
Limited Warranty	10

Intended Use

High velocity cooling, ventilation, and circulation of commercial environments.

Technical Specifications

Property	Specification
Voltage	120V~ / 60Hz
Watts	220 W
Amps	2.1 A

⚠ WARNING

- Read and understand all instructions. Failure to follow all instructions may result in serious injury.
- The warnings, cautions, and instructions in this manual cannot cover all possible conditions or situations that could occur. Exercise common sense and caution when using this tool. Always be aware of the environment and ensure that the tool is used in a safe and responsible manner.
- DO NOT allow persons to operate or assemble this product until they have read this manual and have developed a thorough understanding of how the product works.

SAVE THESE INSTRUCTIONS

Important Safety Considerations

FAN USE AND CARE

- **Do not modify the fan in any way.** Unauthorized modification may impair the function and/or safety and could affect the life of the equipment. There are specific applications for which the fan was designed.
- **Always check of damaged or worn out parts before using the fan.** Broken parts will affect the fan operation. Replace or repair damaged or worn parts immediately.
- **Store idle fan.** When fan is not in use, store it in a secure place out of the reach of children. Inspect it for good working condition prior to storage and before re-use.

CAUTION: Read and follow all instructions before operating fan. Do not use fan if any part are damaged and missing.



WARNING:

- To reduce the risk of fire or electrical shock, do not expose fan to water or rain.
- To reduce the risk of fire or electrical shock, do not use this fan with any solid-state speed control device.
- Automatically operated device — to reduce risk of injury, disconnect from power supply before servicing.
- If the power supply cord is damaged, contact your local service centre or a qualified electrician to install an appropriate replacement cord to prevent any injury or damage.
- The appliance should not be used in locations where special conditions prevail such as the presence of a corrosive or explosive atmosphere (dust, vapor, gas).
- This appliance is not intended for use by persons (including children) with reduced physical, sensory or mental capabilities or lack of experience and knowledge, unless they have been given supervision or instruction concerning use of the appliance by a person responsible for their safety
- Children should be supervised to ensure that they do not want to play with the appliance.

WARNING

PERSONAL SAFETY

- Never insert fingers or any other objects into grill guard when fan is in operation.
- Disconnect the fan from its power source when moving from one location to another.
- Disconnect the fan from its power source when removing guards for cleaning.
- Be sure fan is placed on a secure, level surface.
- Does not use fan in windows. Rain and moisture may create electrical hazard.
- Close supervision is necessary when this fan is used near children, the elderly and pets.
- Do not place the fan near an open flame, cooking or heating appliance, or hot surface.
- This fan should NOT be operated outside.
 - **CAUTION:** Do not alter fan's assembly.



WARNING: Be sure that both front and rear grille screws are completely tightened before operation.

⚠ CAUTION

FAN USE AND CARE

- Check for damaged parts before each use. Carefully check that the tool will operate properly and perform its intended function. Replace damaged or worn parts immediately. Never operate the tool with a damaged part.
- Do not use a tool with a malfunctioning switch. Any power tool that cannot be controlled with the power switch is dangerous and must be repaired by an authorized service representative before using.
- Unplug the power cord from the outlet.. Such preventive safety measures reduce the risk of starting the fan accidentally.
- Store the fan when it is not in use. Store it in a dry, secure place out of the reach of children. Inspect the tool for good working condition prior to storage and before re-use.
- Use only accessories that are recommended by the manufacturer for use with your fan..
- Keep guards in place and in working order. Never operate the fan without the guards in place.
- Do not leave the tool running unattended.
- Inspect the fan for damage or excessive wear before each use. If you find damage do not use the fan.

Specific Operation Warnings

⚠ WARNING

- Be sure that both front and rear grille screws are completely tightened before operation

Safety Labels

⚠ WARNING

• Do not use extension cords with this product ! • To reduce the risk of electric shock, do not expose to water or rain. • To reduce the risk of fire or electric shock, do not use the product with any solid-state speed control device. • Automatically operated device - To reduce the risk of injury, disconnect from power supply before servicing.

SUITABLE FOR COMMERCIAL OR INDUSTRIAL USE ONLY

Assembly

- **COLUMN / BASE ASSEMBLY INSTRUCTIONS:**
 1. Attach COUPLING to the BASE with the 4 screws as shown on the Diagram and Parts list below.
 2. Loosen set knob on coupling and extend inner tube to desired height.
 3. Slide COVER RING down the OUTER TUBE to rest on top of the BASE.
CAUTION: The set knob must be fully tightened before assembling the fan head to the inner tube.
- **MOTOR / COLUMN ASSEMBLY INSTRUCTIONS:**
 1. Set the MOTOR FLANGE in the hole of top of the INNER TUBE. Insert the PIVOT BOLT, WASHER into the INNER TUBE, then firmly fasten the NUT to lock in place.
 2. Insert the POSITION KNOB, locking the motor to the INNER TUBE.
- **GRILLE / MOTOR ASSEMBLY INSTRUCTIONS:**

1. Unscrew the set screws from the MOTOR.
2. Set the REAR GUARD in its proper position. Please make sure the REAR GUARD fits securely against the motor housing.
3. Attach the REAR GUARD by inserting and tightening the screws to the motor (through the eyelets on the guard).
4. Insert the BLADE on the motor shaft until it reaches a stopping point and the SET SCREW is in line with the flat groove on the SHAFT.
NOTE: Be sure the set screw of the blade is facing the motor of the fan.
5. Securely tighten the BLADE set screw.
CAUTION: Do not alter angle of blade.
6. Center the FRONT GUARD by aligning the logo on the logo plate so it is horizontal and parallel with the floor.
7. Combine the FRONT GUARD with REAR GUARD by fastening screws.
8. Completely tighten GRILLE SCREW on FRONT GUARD and into REAR GUARD.

Before Each Use

- Place fan on flat, stable surface.

Operating Instructions

1. Plug fan into grounded power outlet.
 2. Direct fan to area of desired air flow. Select speed for cooling.
- **TO ADJUST AIRFLOW UPWARD OR DOWNWARD:**
 - Loosen the POSITION KNOB first, then loosen the NUT of the PIVOT BOLT. Tilt fan head to the desired angle then firmly tighten the POSITION KNOB, then tighten the NUT of the PIVOT BOLT.
 - **SPEED CONTROL:** Set switch to LOW, or HIGH speeds or OFF respectively.

NOTE: It is normal for the motor to feel warm to touch after continuous operation. This fan features a thermostat that will automatically shut off should it overheat for any reason. If this happens, immediately unplug the fan from the outlet. Wait approximately 15 minutes before plugging back in.

After Each Use

Be sure fan speed control is in OFF position

Maintenance

Maintain your fan. It is recommended that the general condition of any fan be examined before it is used. Keep your fan in good repair by adopting a program of conscientious repair and maintenance. Have necessary repairs made by qualified service personnel.

Lubrication. Apply a small amount of lubricant oil into bearing room of the shaft (#7) by the hole of the motor (#8). If fan is used continuously, this should be done every three months. If fan does not run continuously, lubrication should take place once every six months.

CLEANING:

⚠ WARNING: UNPLUG FROM ELECTRICAL SUPPLY BEFORE CLEANING.

1. Use a soft, damp cloth (water only) for cleaning, then wipe with dry cloth.
2. Don't use cleaners that harm paints or plastics; i.e., bleach or ammonia.
3. Do not bend blades

Parts Diagram

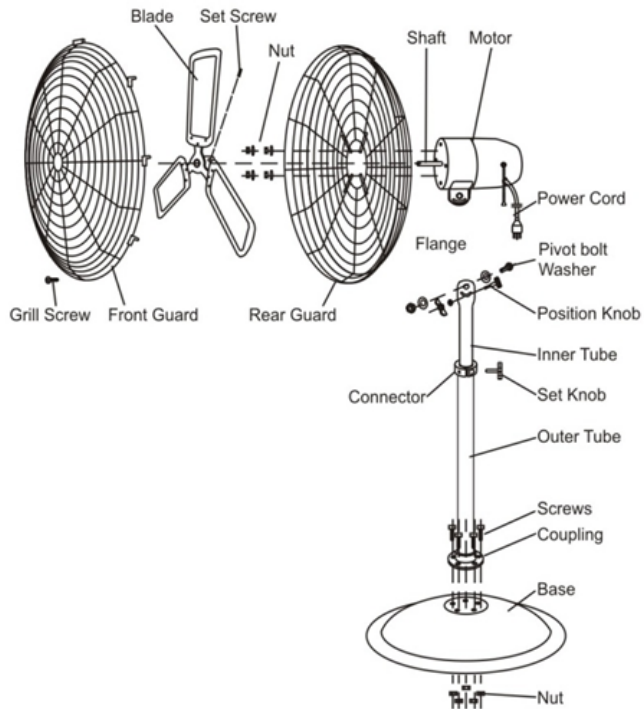

Parts List

Part#	Description	Qty.	Part#	Description	Qty.
1	SCREWS	6	12	POWER CORD	1
2	COUPLING (ATTACHED TO OUTER TUBE)	1	13	FLANGE (ATTACHED TO MOTOR)	1
3	OUTER TUBE	1	14	MOTOR	1
4	BASE	1	15	SHAFT	1
5	NUT (TO ATTACH BASE TO OUTER TUBE)	6	16	REAR GUARD	1
6	SET KNOB (TO CONNECTOR)	1	17	NUT (TO ATTACH REAR GUARD TO MOTOR)	4
7	INNER TUBE	1	18	BLADE	1
8	POSITION KNOB	1	19	SET SCREW	1
9	PIVOT BOLT	1	20	FRONT GUARD	1
10	WASHER	1	21	GRILL SCREW	1
11	NUT	1			

Troubleshooting

Surges in electrical power or excessive heat may cause the fan to turn off.
Wait approximately 15 minutes for the fan to resume operation

Replacement Parts

- For replacement parts and technical questions, please call Customer Service at **1-800-222-5381**.
- Not all product components are available for replacement. The illustrations provided are a convenient reference to the location and position of parts in the assembly sequence.
- When ordering parts, the following will be required: Model Number, Serial Number/Lot Date Code, and Description.
- The distributor reserves the rights to make design changes and or improvements to product lines and manuals without notice.

Limited Warranty

Limited 1-year warranty: this Strongway fan is warranted to the original purchaser (for indoor use) under the following terms:

Strongway will repair or replace the unit at its option and return it, freight prepaid at no charge for 12 months from the date of original purchase. For the balance of the warranty period, Strongway will repair or replace the unit at a predetermined charge. This warranty does not apply to damage from shipping, mishandling, accident misuse, alternation improper power voltage, improper installation, exposure to extremes of heat and humidity, industrial use, outdoor, use failure due to hardware not supplied by Iron-ton. If defective within the limitation of this warranty, please notify Strongway in writing to receive shipping instruction for repair or replacement (at our option) of your fan at no cost to you except shipment to and from our service station. The removal and reinstallation of the fan is your responsibility. In returning the fan for service, make sure the fan is properly packaged to avoid in-transit damage (which is not covered by this warranty). It is suggested that the original carton and inserts be used, send it along with a service request card and proof of purchase to Strongway.

Strongway is not responsible for damages of any kind including incidental and consequential damages, so the above exclusion and limitation may not apply to you. This warranty gives you specific legal rights and you may also have other rights, depending on where you reside.



Distributed by
Northern Tool and Equipment Company, Inc.
Burnsville, Minnesota 55306
NorthernTool.com

Made in **China**