



VICE MOUNTED BEAD ROLLER

Owner's Manual



! **WARNING:** Read carefully and understand all ASSEMBLY AND OPERATION INSTRUCTIONS before operating. Failure to follow the safety rules and other basic safety precautions may result in serious personal injury.

Item #49709

SAVE THESE INSTRUCTIONS

Thank you very much for choosing a Klutch product!

For future reference, please complete the owner's record below:

Serial Number/Lot Date Code: _____

Purchase Date: _____

Save the receipt, warranty, and this manual. It is important that you read the entire manual to become familiar with this product before you begin using it.

This bead roller is designed for certain applications only. Northern Tool and Equipment cannot be responsible for issues arising from modification or use of this product in an application for which it was not designed. We strongly recommend that this product not be modified and/or used for any application other than that for which it was designed.

For technical questions, please call **1-800-222-5381**.

Table of Contents

Intended Use.....4

Technical Specifications4

Important Safety Considerations4

Specific Operation Warnings6

Assembly6

Before Each Use.....6

Operating Instructions.....7

After Each Use.....7

Maintenance7

Parts Diagram8

Parts List9

Replacement Parts9

Limited Warranty10

Intended Use

This hand operated bead roller forms sheet metal up to 18 gauge thickness mild steel (or equivalent) and ensures minimum deflection of the workpiece. Six sets of provided standard rollers allow large and small turning, burning, wiring, crimping, and ogee bead.

Technical Specifications

Property	Specification
Capacity	1.2mm / 18 GA.
Throat depth	457mm / 18"
Packing	73x27x14 cm
Weight	24/26kg

Important Safety Considerations

⚠ WARNING

- Read and understand all instructions. Failure to follow all instructions may result in serious injury.
- The warnings, cautions, and instructions in this manual cannot cover all possible conditions or situations that could occur. Exercise common sense and caution when using this tool. Always be aware of the environment and ensure that the tool is used in a safe and responsible manner.
- DO NOT allow persons to operate or assemble this product until they have read this manual and have developed a thorough understanding of how the product works.
- DO NOT modify the product in any way. Unauthorized modification may impair the function and/or safety and could affect the life of the product. There are specific applications for which the product was designed.
- Use the right tool for the job. DO NOT attempt to force a small equipment to do the work of larger industrial equipment. There are certain applications for which this equipment was designed. It will do the job better and more safely at the capacity for which it was intended. DO NOT use this equipment for a purpose for which it was not intended.
- Industrial or commercial applications must follow OSHA requirements.

⚠ WARNING

- This product may contain chemicals known to the State of California to cause cancer, birth defects or other reproductive harm.

⚠ WARNING

WORK AREA SAFETY

- Inspect the work area before each use. Keep work area clean, dry, free of clutter, and well-lit. Cluttered, wet, or dark work areas can result in injury. Using the tool in confined work areas may put you dangerously close to other cutting tools and rotating parts.
- Do not use the roller when there is a risk of causing a fire or an explosion; e.g., in the presence of flammable liquids, gases, or dust. The tool can create sparks, which may ignite the dust or fumes.
- Do not allow the roller to come into contact with an electrical source. Contact will cause a shock.
- Keep children and bystanders away from the work area while operating the roller. Do not allow children to handle the roller.
- Be aware of all power lines, electrical circuits, water pipes, and other mechanical hazards in your work area. Some of these hazards may be below the work surface hidden from your view and may cause personal harm or property damage if unintentionally contacted.

PERSONAL SAFETY

- Stay alert, watch what you are doing, and use common sense when operating the roller. Do not use the roller while you are tired or under the influence of drugs, alcohol, or medication. A moment of inattention while operating the roller may result in serious personal injury.
- Dress properly. Do not wear loose clothing, dangling objects, or jewelry. Keep your hair, clothing and gloves away from moving parts. Loose clothes, jewelry, or long hair can get caught.
- Use ANSI-approved safety goggles or safety glasses with side shields, or when needed, a face shield. Use a dust mask in dusty work conditions. Also use non-skid safety shoes, hardhat, gloves, dust collection systems, and hearing protection when appropriate. This applies to all persons in the work area.
- Do not overreach. Keep proper footing and balance at all times.

⚠ CAUTION

BEAD ROLLER USE AND CARE

- Do not force the roller. Tools do a better and safer job when used in the manner for which they are designed. Plan your work, and use the correct tool for the job.
- Check for damaged parts before each use. Carefully check that the roller will operate properly and perform its intended function. Replace damaged or worn parts immediately. Never operate the tool with a damaged part.
- Store the roller when it is not in use. Store it in a dry, secure place out of the reach of children. Inspect the roller for good working condition prior to storage and before re-use.
- Use only accessories that are recommended by the manufacturer. Accessories that may be suitable for one tool may create a risk of injury when used with another tool.
- Inspect the roller and accessories for damage or excessive wear before each use. If you find damage do not use the roller.

Specific Operation Warnings

⚠ WARNING

- Never use highly flammable solvents to clean.

Assembly

IMPORTANT: The bead roller and dies are coated at the factory with a protectant. To ensure proper fit and operation, remove the coating before first use. The coating is easily removed with a mild solvent, such as mineral spirits, and a soft cloth.

⚠ WARNING

Never use highly flammable solvents to avoid possible fire hazard.

⚠ CAUTION

Avoid getting cleaning solution on paint or any of the rubber or plastic parts. Solvents may deteriorate these finishes. Use soap and water on paint, plastic or rubber components.

After cleaning, cover all exposed surfaces with a light coating of oil.

- The bead roller should be installed on a level surface such as a bench, with proper lighting.
- Be sure to provide clearance for crank arm rotation.
- The area around roller should be clear of scraps, oil or dirt.
- Apply a suitable non-skid material to floor.

Before Each Use

- Carefully clean all rust protected surfaces with a mild solvent or kerosene and a soft rag. Do not use lacquer thinner, paint thinner, or gasoline. These will damage painted surfaces.
- Coat all machined surfaces with a light coat of oil to inhibit rust.
- Carefully move the machine to a well-lighted area on a solid, level work bench, and secure to the bench with lag screws or bolts.
- Machine location must allow access to all sides.
- Check the condition of the roller and that its free of scraps or other debris and clean enough for the next operation.
- Check that the rollers, especially the gears and crank handle, are not worn or damaged.
- Rotate the handle and check whether the gears have good, firm contact with each other.
- Verify that the roller is securely mounted to the workbench or surface.

Operating Instructions

1. Select the die set required for the next operation.
2. Place die set and retaining nuts onto the driving and driven shafts. Tighten the retaining nuts with a wrench (not provided).
3. Adjust the position of the upper die according to thickness of the workpiece by using the screw (5) on the top of the vertical bracket

After Each Use

- Clear away any scraps or debris to setup for the next operation.
- The machine must be lubricated every day of service with a few drops of oil.
- Every thirty days of operation grease the gears
- Lightly oil the rolls when not in use to prevent rust.

Maintenance

Maintain your roller. It is recommended that the general condition of any tool be examined before it is used. Keep your tool in good repair by adopting a program of conscientious repair and maintenance in accordance with the recommended procedures found in this manual.

Keep handles dry, clean, and free from oil and grease.

LUBRICATION

1. All exposed iron surfaces should be coated with light oil to prevent rusting.
2. Grease the gears monthly with a multi-purpose or bearing grease.

Parts Diagram

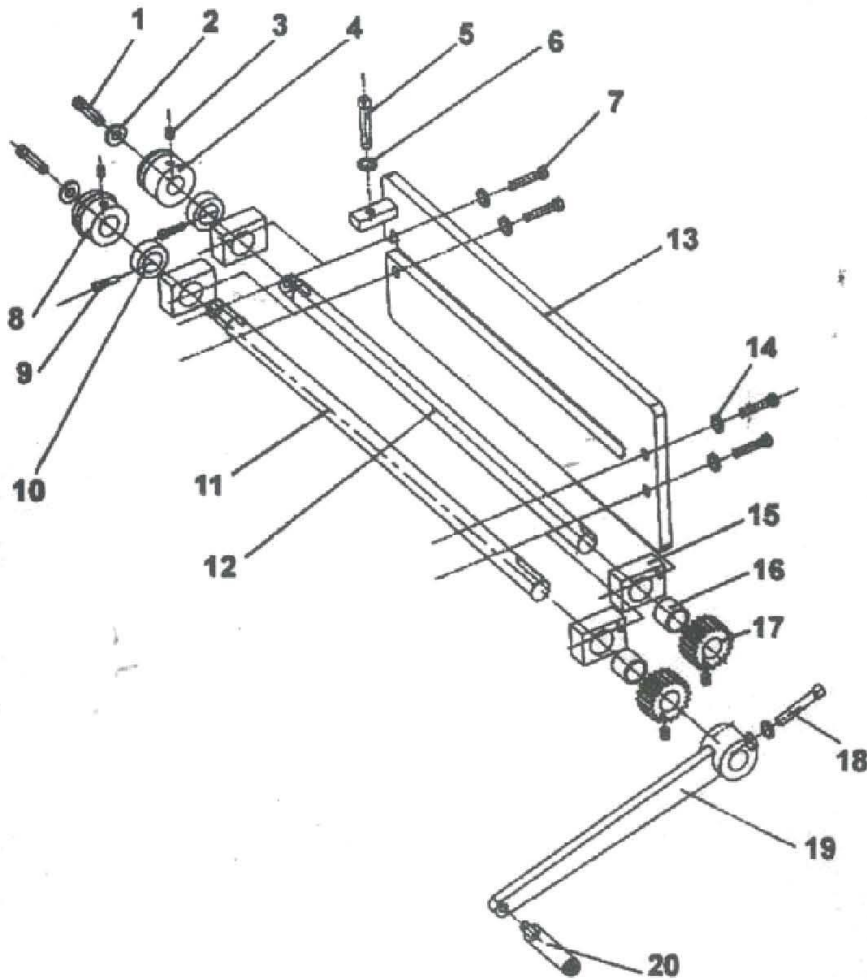

Note: This manual is only for your reference. Owing to the continuous improvement of the machine, changes may be made at any time without obligation on notice.

Parts List

Part	Description	Qty.	Part	Description	Qty.
1	Head screw M10	2	12	Driven shaft	1
2	Washer	2	13	Vertical bracket	1
3	Hex screw	4	14	Washer	4
4	Concave wheel	1	15	Supporting block	4
5	Screw	1	16	Copper bushing	2
6	Washer	2	17	Gear	2
7	Head screw M12	4	18	Square screw	1
8	Cam	1	19	Handle	1
9	Hex screw m6	2	20	Handle lever	1
10	Bushing	2	21	Roller die set	5
11	Main spindle	1			

Replacement Parts

- For replacement parts and technical questions, please call Customer Service at **1-800-222-5381**.
- Not all product components are available for replacement. The illustrations provided are a convenient reference to the location and position of parts in the assembly sequence.
- When ordering parts, the following will be required: model number, serial number/lot date code, and description.
- The distributor reserves the rights to make design changes and improvements to product lines and manuals without notice.

Limited Warranty

Northern Tool and Equipment Company, Inc. ("We" or "Us") warrants to the original purchaser only ("You" or "Your") that the Klutch product purchased will be free from material defects in both materials and workmanship, normal wear and tear excepted, for a period of **one year** from date of purchase. The foregoing warranty is valid only if the installation and use of the product is strictly in accordance with product instructions. There are no other warranties, express or implied, including the warranty of merchantability or fitness for a particular purpose. If the product does not comply with this limited warranty, Your sole and exclusive remedy is that We will, at our sole option and within a commercially reasonable time, either replace the product or product component without charge to You or refund the purchase price (less shipping). This limited warranty is not transferable.

Limitations on the Warranty

This limited warranty does not cover: (a) normal wear and tear; (b) damage through abuse, neglect, misuse, or as a result of any accident or in any other manner; (c) damage from misapplication, overloading, or improper installation; (d) improper maintenance and repair; and (e) product alteration in any manner by anyone other than Us, with the sole exception of alterations made pursuant to product instructions and in a workmanlike manner.

Obligations of Purchaser

You must retain Your product purchase receipt to verify date of purchase and that You are the original purchaser. To make a warranty claim, contact Us at 1-800-222-5381, identify the product by make and model number, and follow the claim instructions that will be provided. The product and the purchase receipt must be provided to Us in order to process Your warranty claim. Any returned product that is replaced or refunded by Us becomes our property. You will be responsible for return shipping costs or costs related to Your return visit to a retail store.

Remedy Limits

Product replacement or a refund of the purchase price is Your sole remedy under this limited warranty or any other warranty related to the product. We shall not be liable for: service or labor charges or damage to Your property incurred in removing or replacing the product; any damages, including, without limitation, damages to tangible personal property or personal injury, related to Your improper use, installation, or maintenance of the product or product component; or any indirect, incidental or consequential damages of any kind for any reason.

Assumption of Risk

You acknowledge and agree that any use of the product for any purpose other than the specified use(s) stated in the product instructions is at Your own risk.

Governing Law

This limited warranty gives You specific legal rights, and You also may have other rights which vary from state to state. Some states do not allow limitations or exclusions on implied warranties or incidental or consequential damages, so the above limitations may not apply to You. This limited warranty is governed by the laws of the State of Minnesota, without regard to rules pertaining to conflicts of law. The state courts located in Dakota County, Minnesota shall have exclusive jurisdiction for any disputes relating to this warranty.



Distributed by

Northern Tool and Equipment Company, Inc.

Burnsville, Minnesota 55306

NorthernTool.com

Made in China