



Vestil Manufacturing Company

2999 North Wayne Street, P.O. Box 507, Angola, IN 46703

Telephone: (260) 665-7586 -or- Toll Free (800) 348-0868

Fax: (260) 665-1339

Web: www.vestil.com e-mail: info@vestil.com

SBM-ML Series Economy Spreader Beams with Magnetic Lifters

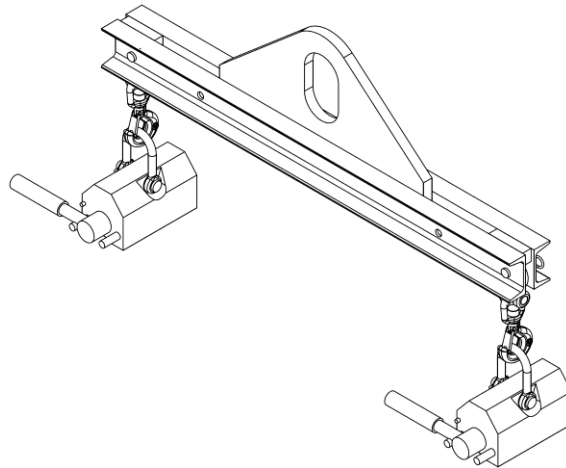

Receiving Instructions

After delivery, remove the packaging from the product. Inspect the product closely to determine whether it sustained damage during transport. If damage is discovered, record a complete description of it on the bill of lading. If the product is undamaged, discard the packaging.

NOTE: The end-user is solely responsible for confirming that product design, use, and maintenance comply with laws, regulations, codes, and mandatory standards applied where the product is used.

Technical Service & Replacement Parts

For answers to questions not addressed in these instructions and to order replacement parts, labels, and accessories, call our Technical Service and Parts Department at (260) 665-7586. The department can also be contacted online at <https://www.vestil.com/page-parts-request.php>.





Electronic copies of Instruction Manuals

Additional copies of this instruction manual may be downloaded from <https://www.vestil.com/page-manuals.php>.

Table of Contents		Page
Signal Words.....		2
Safety Instructions.....		2-3
National Standards.....		3
Record of Satisfactory Condition.....		3
Load Tests.....		3
Specifications.....		3
SBM-10-#-ML Exploded View, Bill of Materials, & Specifications.....		4
SBM-20-#-ML Exploded View, Bill of Materials, & Specifications.....		5
Using the Lifter.....		6
Inspections & Maintenance.....		7
Labeling Diagram.....		8
Limited Warranty.....		9

SIGNAL WORDS

This manual uses SIGNAL WORDS to indicate the likelihood of personal injuries, as well as the probable seriousness of those injuries, if the product is misused in the ways described. Other signal words call attention to uses of the product likely to cause property damage. The following are signal words used in this manual and their definitions.

 DANGER	Identifies a hazardous situation which, if not avoided, WILL result in DEATH or SERIOUS INJURY . Use of this signal word is limited to the most extreme situations.
 WARNING	Identifies a hazardous situation which, if not avoided, COULD result in DEATH or SERIOUS INJURY .
 CAUTION	Indicates a hazardous situation which, if not avoided, COULD result in MINOR or MODERATE injury.
 NOTICE	Identifies practices likely to result in product/property damage, such as operation that might damage the product.

SAFETY INSTRUCTIONS

Vestil strives to identify all hazards associated with the use of our products. However, material handling is dangerous and no manual can address every risk. The most effective way to avoid injury is for the end-user to exercise sound judgment whenever using this product.

WARNING

Improper or careless operation might result in serious personal injuries or death.

- **Read the entire manual before assembling, installing, using, or servicing the spreader beam or magnetic lifters.** A copy of this manual must be available at all times to persons who assemble, install, use, or service the beam or lifters. Read the manual whenever necessary to refresh your understanding of use and maintenance procedures.
- This lifting device must only be used by designated persons and lifting device inspectors. Maintenance and test personnel should only use this device when necessary to perform their duties.
- DO NOT use this lifter if it is damaged, malfunctioning, or missing parts.
- DO NOT modify the product without first obtaining written approval from Vestil. Unapproved modifications automatically void the [LIMITED WARRANTY](#) on p. 9 and might make the product unsafe to use.
- Only attach the lifter to a properly functioning safety hook, i.e. a hook with a spring latch.
- DO NOT remove or obscure any label. Confirm the placement and legibility of all labels as shown in the [LABELING DIAGRAM](#) on p. 8. DO NOT use this device UNLESS all labeling is readable and undamaged.
- Inspect the lifter before each use. See [INSPECTIONS AND MAINTENANCE](#) on p. 7.
- Review safety messages in the manuals for your crane, trolley, hoist, rigging, and all other devices used in conjunction with this spreader beam.
- Tighten the shackle pins before each use. See "Hook with Shackle" in Exploded Views on [p. 4 & 5](#).
- Make sure your travel path is clear before picking up a load.
- DO NOT use this lifter to move a load item if the item does not balance when it is elevated. The beam should be horizontal/level when the load is elevated.
- DO NOT lift more than 1 item at a time.
- DO NOT lift people. This device must only be used to lift materials.
- Center the hoist above the load item before connecting it to a load. Centering minimizes load swing as the load lifts off of the ground. DO NOT side load the hoist/lifter.
- DO NOT sit, or ride, on the load item or the lifter.
- DO NOT exceed the rated load/capacity of your lifter. Capacity figures are provided in [SPECIFICATIONS](#) tables on [p. 4 & 5](#), as well as on product labeling. See [LABELING DIAGRAM](#) on p. 8.
- Carefully eliminate slack in the hoist line before raising the load. Lift and lower loads slowly and steadily. Avoid jolting the loads.
- Slowly raise the loaded lifter a few inches above the ground to determine whether the load is stable.
- DO NOT lift a load higher than necessary. See [USING THE LIFTER](#) on p. 6. Keep the suspended load as close to the ground as possible while moving it and avoid obstructions.
- Avoid contact with the load item while it is suspended. DO NOT get in front of or behind a suspended load. Avoid putting your feet and other parts of your body beneath the load item. NEVER lift material over yourself or other people.

⚠ WARNING

Continued from page 2.

- Watch the load carefully while lifting and moving it. The load could swing or spin while elevated.
- DO NOT leave a suspended load unattended.
- DO NOT pull, drag, or slide loads with the lifter.
- Apply a 3:1 safety factor when using this magnetic spreader beam lifter to move loads.
- Make sure the surface of the load item is clean and smooth. Remove dust, oil, and other surface debris/contaminants. Grind off burrs and other surface projections.
- DO NOT turn on the magnets unless the magnetic lifters are in contact with a load item. Magnets can be damaged if activated when not in contact with a load item.

NATIONAL STANDARDS

The spreader beam and each of the magnetic lifters are "Below-the-Hook Lifting Devices" (BTH lifter). [ASME standard B30.20](#) (the "Standard") applies to BTH lifters. Acquire a copy of the latest version of the Standard before putting the beam and magnetic lifters into service. Follow all use and maintenance/care instructions provided in the Standard as well as all other provisions for owners and users. If content in this manual conflicts with any recommendations or mandatory provisions in the Standard, apply the provisions from the Standard. Vestil encourages you to immediately contact [TECHNICAL SERVICE](#) and report these conflicts. See [TECHNICAL SERVICE AND REPLACEMENT PARTS](#) section of the cover page.

RECORD OF SATISFACTORY CONDITION

Record the condition of the lifter before putting it into service. Measure the length and width of the hook shackles and magnetic lifter shackles. Measure the throat opening of all 4 shackles (2 hook shackles; 2 magnetic lifter shackles) and both hooks (2). Measure the length and width of the lifting bale. Record your measurements. Thoroughly photograph the unit from multiple angles. Include close range photos of all labeling, the lifting shackles and shackle pins, the hooks, the magnetic lifters and their shackles and shackle pins, the lifting beam, fasteners (pins, bolts, nuts, etc.), the lifting bale, and welds. Collate all photographs and writings into a single file. Mark the file appropriately to identify it. This file is a record of the lifter in satisfactory condition. Compare the results of all inspections to this record to determine whether the unit is in satisfactory condition. If the lifter is not in satisfactory condition, repair it before returning it to service. Purely cosmetic changes, like damaged paint/powdercoat, do not constitute changes from satisfactory condition. However, touchup paint should be applied to all affected areas as soon as cosmetic damage occurs to prevent rusting and corrosion. If left unaddressed, rusting/corrosion will alter the lifter from satisfactory condition and could make it unsafe to use.

LOAD TESTS

After creating a [RECORD OF SATISFACTORY CONDITION](#) and before using the lifter for the first time, a qualified person should conduct a load test. The test load should be 125% of the rated load of the lifter. Raise the lifter until the load is totally suspended. Return the load to the ground and unload the lifter, i.e. deactivate the magnets. Perform a [Monthly Inspection](#) as described in [INSPECTIONS AND MAINTENANCE](#) (below). The lifter must undergo load testing immediately after it is repaired, modified, or altered.

SPECIFICATIONS

Dimensions, net weight, and capacity information for each model is provided in the "Specifications" sections on [pages 4 & 5](#). However, minor changes in product design might alter particular specifications, such as dimensions or net weight. To provide instant access to up-to-date information, specifications documents for SBM-series spreader beams are available online to anyone who visits the Vestil website. Acquire the appropriate specifications document by opening this webpage: <https://www.vestil.com/product.php?FID=571>. Click the "Specifications" tab. Scroll the page to the entry for the specific model you purchased. Click the button in the "PDF" column that looks like a pencil inside a blue-bordered box. A PDF file will open. This file is the specifications document. Print a copy of the document as soon as your product is delivered and keep it with your copy of this manual. If you encounter difficulties while trying to obtain a copy of the specifications document, contact [Technical Service](#). Contact information is provided on the cover page of this manual. NOTE: Some models might be discontinued between revisions of this manual.

EXPLODED VIEW & BILL OF MATERIALS: SBM-10-#-ML SERIES LIFTERS

08-006-445

Item	Part no.	Description	Qty.
1	08-514-142	Weldment, spreader beam	1
	08-514-146	SBM-10-3-ML	1
	08-514-150	SBM-10-4-ML	1
	08-514-154	SBM-10-6-ML	1
	08-514-158	SBM-10-8-ML	1
	08-514-162	SBM-10-10-ML	1
2	49-001-026	ML-6, magnetic lifter, permanent	2
3	08-645-006	Subassembly, hook with shackle, 1 ton	2
4	28-112-040	Clevis pin, 1/2" x 2"	2
5	45286	#11 hitch pin clip, 1/8"x2 5/8"	2

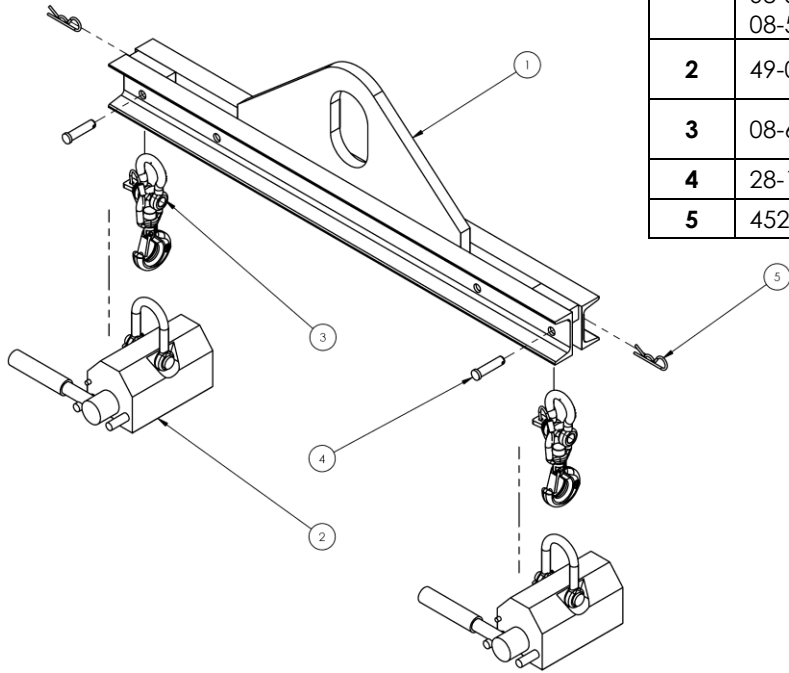

SPECIFICATIONS

08-007-445

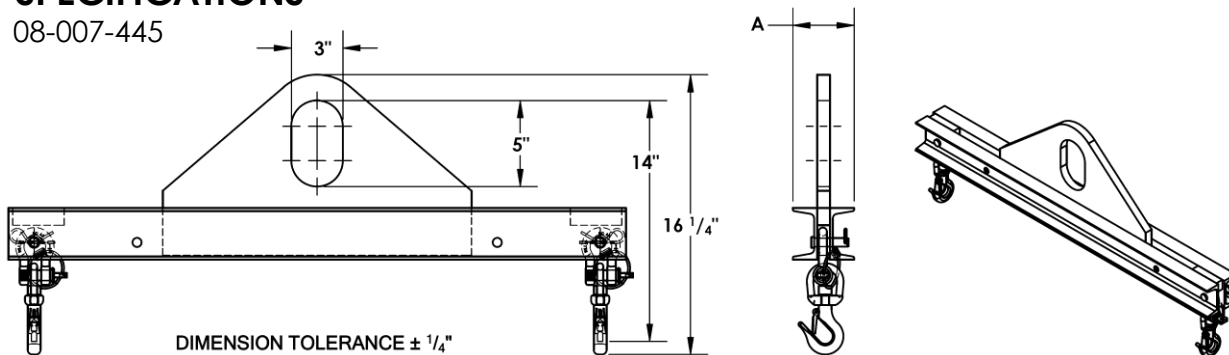

DIMENSION TOLERANCE ± 1/4"

Model	A	Minimum spread	Maximum spread	Capacity	Net weight
SBM-10-3-ML	3 ⁹ / ₁₆ "	21"	33"	1,000 lb.	56 lb.
	9.0cm	53.3 cm	83.8 cm	454.5 kg	25.5 kg
SBM-10-4-ML	3 ⁹ / ₁₆ "	33"	45"	1,000 lb.	64 lb.
	9.0cm	83.8 cm	114.3 cm	454.5 kg	29.1 kg
SBM-10-6	3 ⁹ / ₁₆ "	45"	69"	1,000 lb.	82 lb.
	9.0cm	114.3 cm	175.3 cm	454.5 kg	37.3 kg
SBM-10-8	3 ⁹ / ₁₆ "	69"	93"	1,000 lb.	98 lb.
	9.0cm	175.3 cm	236.2 cm	454.5 kg	44.5 kg
SBM-10-10	3 ¹⁵ / ₁₆ "	93"	117"	1,000 lb.	140 lb.
	10.0cm	236.2 cm	297.2 cm	454.5 kg	63.6 kg
SBM-10-12	3 ¹⁵ / ₁₆ "	117"	141"	1,000 lb.	162 lb.
	10.0cm	297.2 cm	358.1 cm	454.5 kg	73.6 kg

EXPLODED VIEW & BILL OF MATERIALS: SBM-20-#-ML SERIES LIFTERS

08-006-451

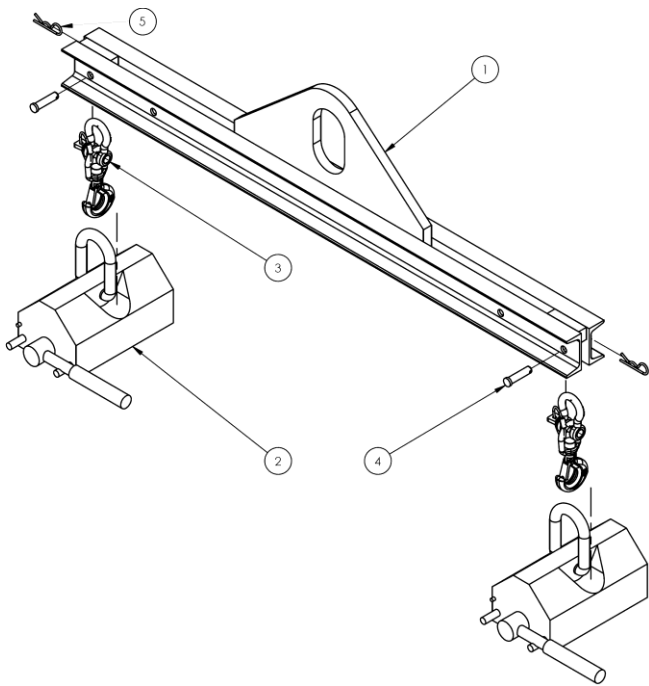

Item	Part no.	Description	Qty.
1	08-514-143	Weldment, spreader beam	1
	08-514-147	SBM-20-3-ML	1
	08-514-151	SBM-20-4-ML	1
	08-514-155	SBM-20-6-ML	1
	08-514-159	SBM-20-8-ML	1
	08-514-159	SBM-20-10-ML	1
	08-514-163	SBM-20-12-ML	1
2	49-001-016	ML-12, magnetic lifter, permanent	2
3	08-645-004	Subassembly, hook with shackle, 0.5 ton	2
4	28-112-040	Clevis pin, 1/2"x2"	2
5	45286	#11 hitch pin clip, 1/8"x2 ⁵ / ₈ "	2

SPECIFICATIONS

08-007-451

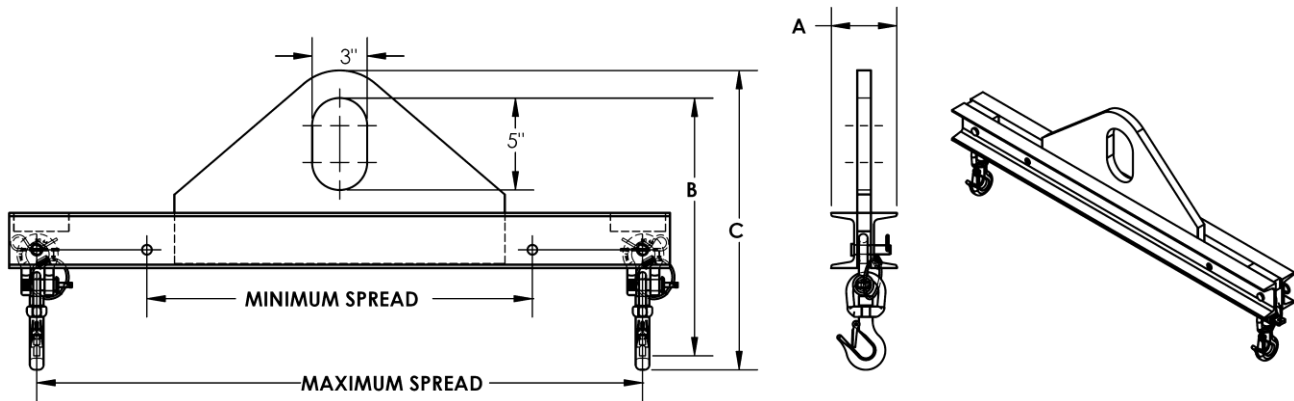

Model	A	B	C	Minimum spread	Maximum spread	Capacity	Net weight
SBM-20-3	3 ⁹ / ₁₆ "	14"	16 ¹ / ₄ "	21"	33"	2,000 lb.	56 lb.
	9.0cm	35.6 cm	41.3 cm	53.3 cm	83.8 cm	909.1 kg	25.5 kg
SBM-20-4	3 ⁹ / ₁₆ "	14"	16 ¹ / ₄ "	33"	45"	2,000 lb.	64 lb.
	9.0cm	35.6 cm	41.3 cm	83.8 cm	114.3 cm	909.1 kg	29.1 kg
SBM-20-6	3 ¹⁵ / ₁₆ "	14"	16 ¹ / ₄ "	45"	69"	2,000 lb.	97 lb.
	10.0cm	35.6 cm	41.3 cm	114.3 cm	175.3 cm	909.1 kg	44.1 kg
SBM-20-8	3 ¹⁵ / ₁₆ "	14"	16 ¹ / ₄ "	69"	93"	2,000 lb.	118 lb.
	10.0cm	35.6 cm	41.3 cm	175.3 cm	236.2 cm	909.1 kg	53.6 kg
SBM-20-10	4 ¹ / ₄ "	15"	17 ¹ / ₄ "	93"	117"	2,000 lb.	170 lb.
	10.8cm	38.1 cm	43.8 cm	236.2 cm	297.2 cm	909.1 kg	77.3 kg
SBM-20-12	4 ¹ / ₄ "	15"	17 ¹ / ₄ "	117"	141"	2,000 lb.	197 lb.
	10.8cm	38.1 cm	43.8 cm	297.2 cm	358.1 cm	909.1 kg	89.5 kg

USING THE LIFTER

⚠ WARNING

The capacity of the hoist, crane, and rigging should equal or exceed the capacity of the spreader beam. **DO NOT** exceed the capacity of the spreader beam, crane, rigging, or the hoist, whichever is **smallest**.

Select a load that is appropriate for your lifter. Then, load the lifter by applying the following steps:

1. Make sure that both magnetic lifters are turned off. To turn off a magnet, turn the handle as far to the right (clockwise) as possible.
2. Tighten the shackle pins of both hook shackles.
3. Attach a hoist hook to the bale of the spreader beam. Make sure that the hoist is centered above the bale. The hoist chain/rope should be vertical once the hoist hook is connected to the bale.
4. Move the beam into position above the load item. Center the bale/crane hook above the load's center of gravity.
5. Lower the spreader beam until the magnetic lifters rest on top of the load item. Magnets should be aligned with the long axis of the load item. The entire bottom surface of each magnetic lifter should be in contact with the surface of the load item.
6. Adjust the positions of the load hooks, if necessary. To change the position of a hook, first remove the hitch clip from the clevis pin; then remove the clevis pin. Select the appropriate location of the hook. Move the hook and shackle to the necessary location. The interior space of the shackle should align with the pin hole in the beam. Reinstall the clevis pin. Secure the clevis pin with its hitch clip. Generally, the hooks should be attached in the same locations on either side of the bale.
7. Activate the magnets. Turn the handle of each magnetic lifter to the ON position.
8. Perform a **test lift**. Raise the load just a few inches above the ground. The load and beam should balance, i.e. be horizontally level. If one end of the load is lower than the other, the center of gravity of the load is not directly below the lifting bale as it should be. Return the load to the ground. Turn off the magnets by turning the handles of the magnetic lifters to the OFF positions. Reposition the beam appropriately to balance the load. Keep the magnetic lifters in line with the long axis of the load item and move the beam towards the end of the item that was lower than the other. Reapply the magnets and perform another test lift. When balanced, the spreader beam and load item are horizontal.

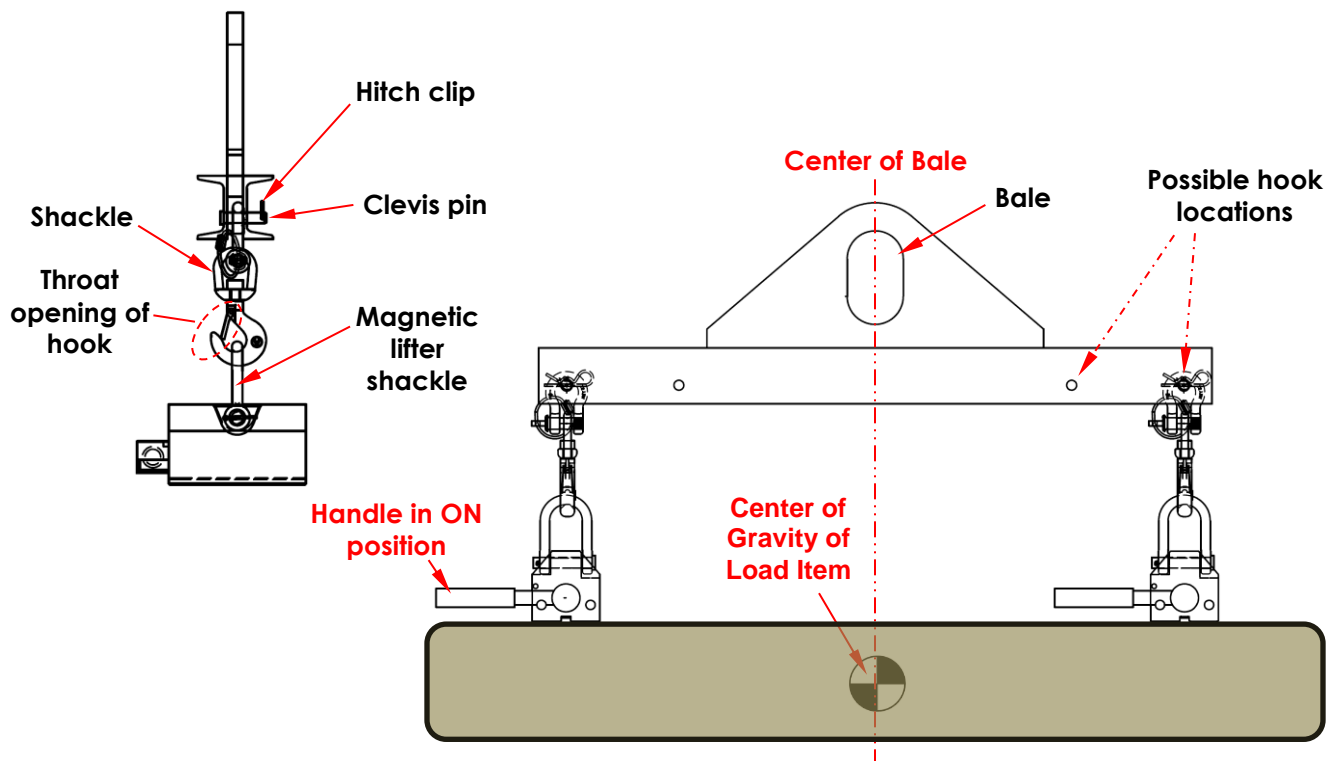

INSPECTIONS & MAINTENANCE

Inspection procedures are included in the most current revision of ASME B30.20. As stated above in the [NATIONAL STANDARDS](#) section, Vestil recommends that you acquire a copy of the most recent revision of this standard. Apply all use and maintenance/care instructions in the standard. Vestil also recommends that you contact your local occupational safety and health authority to determine if any laws, regulations, codes, ordinances, etc. apply inspection requirements to below-the-hook (BTH) lifters. Inquire specifically about mechanical spreader beams and magnetic BTH devices.

Inspections and repairs should only be performed by qualified persons. Compare the results of each inspection to the [RECORD OF SATISFACTORY CONDITION](#). Do not use the lifter unless all parts are in satisfactory condition. Replace parts that are not in satisfactory condition before using the lifter again. **DON'T GUESS! If you have any questions about the condition of your lifter, contact the [TECHNICAL SERVICE](#) department.** The phone number is provided on the cover page of this manual. Never make temporary repairs of damaged or missing parts. Only use manufacturer-approved replacement parts. Deformities, cracks, and severe wear of the lifting arm or main body requires immediate replacement of the entire unit.

Every lift

The operator of this lifter must inspect the lifter every lift. Look for dirt or other surface debris. Clean the surfaces.

Monthly Inspections

At least once per month a qualified person must perform the following inspections. Written reports should be prepared for every monthly inspection including inspections following [LOAD TESTS](#).

1. **Spreader beam assembly:** Examine each pin hole for elongations and the surrounding metal for cracks, and severe rusting and corrosion. Pin holes should be smooth and circular; the frame should be square and rigid and should lack cracks, warps, regions weakened by severe rusting or corrosion, etc.
2. **Pins:** inspect all clevis pins & shackle pins. Confirm all pins are straight and without cracks, warps, etc.
3. **Hooks and shackles (hardware):** examine each hook and shackle for damage including significant wear, warping, cracks, or deformation. Measure the throat opening of each hook. Compare it to the measurements in the [Record](#). The throat opening of each hook should not be 15 percent or more in excess of normal throat opening or be twisted more than 10° from the plane of the unbent hook.
4. **Labeling:** Labels should be readable and located as shown in the [LABELING DIAGRAM](#). If a label(s) is unreadable or missing, contact Vestil to order a replacement.
5. **Welds:** Confirm that all welds are intact.

LABELING DIAGRAM

The beam and magnetic lifters should be labeled as shown in the diagrams below. However, label content and location are subject to change and this diagram might present a prior labeling regime. Thoroughly photograph the beam and both lifters when you first receive them as discussed in the [RECORD OF SATISFACTORY CONDITION](#) section on p. 3. Make sure that your [RECORD](#) includes a photograph of each label. Replace all labels that are, or later become, damaged, missing, or not easily readable (e.g. faded).

To order replacement labels, contact the [TECHNICAL SERVICE AND REPLACEMENT PARTS DEPARTMENT](#) online at <https://www.vestil.com/page-parts-request.php>. Alternatively, you may request replacement parts and/or service by calling (260) 665-7586 and asking the operator to connect you to the Parts Department.

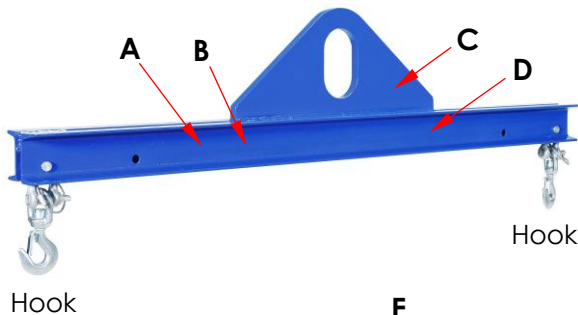

[One magnetic lifter attached to each hook]

A: Label 675

⚠ WARNING	⚠ ADVERTENCIA
<ul style="list-style-type: none"> • DO NOT exceed rated capacity • DO NOT use if damaged, malfunctioning, or missing parts • DO NOT lift people OR lift loads over people • DO NOT raise load higher than necessary • DO NOT leave a suspended load unattended • DO NOT use lifter unless you read and understand the owner's manual • DO NOT alter OR modify lifter • DO NOT remove OR obscure any label • STAY CLEAR of suspended loads • Secure load before using this device 	<ul style="list-style-type: none"> • NO exceda la capacidad tasada • NO USE is las partes estan dañadas, no funcionan correctamente o faltan partes. • NO eleve al personal o eleve cargas sobre el personal • NO eleve la carga mas alto de lo necesario • NO deje desatendida una carga que este suspendida • NO use el elevador a no ser que haya leído y entendido las instrucciones del manual del propietario • NO altere o modifique el elevador • NO quite u oscurezca ninguna etiqueta • MANTENGASE alejado de las cargas suspendidas • Asegure la carga antes de usar este dispositivo.

B: Label 202



C: Label 1016

⚠ WARNING
Improper use might result in serious personal injuries: <ol style="list-style-type: none"> 1. DO NOT side load! Bales designed only for straight line pulls. 2. Bale pins/bolts must be in place before attaching load.
⚠ ADVERTENCIA
El uso indebido podría causar lesiones personales graves: <ol style="list-style-type: none"> 1. NO voltear de lado, pacas diseñado solamente para poner en línea recta. 2. Los pin de las pacas / pernos deben estar en su lugar antes de colocar la carga.

D: Label 1000

Model No. _____	Serial No. _____
No. Modelo _____	No. Serie _____
Capacity _____ lbs.	Lifter Weight _____ lbs.
Capacidad _____ kgs.	Peso del Elevador _____ kgs.
BHT-1 Design Category: B	BHT-1 Service Category: 1
BHT-1 Categoría de Diseño B	BHT-1 Categoría de Servicio: 1
Read Owners Manual for product safety warnings Lea Manual de Proprietarios para advertencias de seguridad de producto	
1000	

E: Label 1068

⚠ WARNING	⚠ ADVERTENCIA
STRONG MAGNETIC FIELD: <ul style="list-style-type: none"> • Persons with medical implants (e.g. pacemakers) should remain at least 12 in. (30cm) away from magnet • Avoid pinch hazard. Magnetic field attracts metallic objects 	CAMPO DE MAGNETICO ALTO: <ul style="list-style-type: none"> • Personas con implantes medicos (e.g. marcapasos) deben permanecer alejadas por los menos 30 cm del iman • Evitar riesgo de pellizco. El campo magnetico atrae objetos metalicos



LIMITED WARRANTY

Vestil Manufacturing Company("Vestil") warrants this product to be free of defects in material and workmanship during the warranty period. Our warranty obligation is to provide a replacement for a defective, original part covered by the warranty after we receive a proper request from the Warrantee (you) for warranty service.

Who may request service?

Only a warrantee may request service. You are a warrantee if you purchased the product from Vestil or from an authorized distributor AND Vestil has been fully paid.

Definition of "original part"?

An original part is a part used to make the product as shipped to the Warrantee.

What is a "proper request"?

A request for warranty service is proper if Vestil receives: 1) a photocopy of the Customer Invoice that displays the shipping date; AND 2) a written request for warranty service including your name and phone number. Send requests by one of the following methods:

<u>US Mail</u>	<u>Fax</u>	<u>Email</u>
Vestil Manufacturing Company	(260) 665-1339	info@vestil.com
2999 North Wayne Street, PO Box 507	<u>Phone</u>	Enter "Warranty service request"
Angola, IN 46703	(260) 665-7586	in subject field.

In the written request, list the parts believed to be defective and include the address where replacements should be delivered. After Vestil receives your request for warranty service, an authorized representative will contact you to determine whether your claim is covered by the warranty. Before providing warranty service, Vestil will require you to send the entire product, or just the defective part (or parts), to its facility in Angola, IN.

What is covered under the warranty?

The warranty covers defects in the following original, dynamic parts: motors, hydraulic pumps, motor controllers, and cylinders. It also covers defects in original parts that wear under normal usage conditions ("wearing parts"), such as bearings, hoses, wheels, seals, brushes, and batteries.

How long is the warranty period?

The warranty period for original dynamic components is 90 days. For wearing parts, the warranty period is 90 days. Both warranty periods begin on the date Vestil ships the product to the Warrantee. If the product was purchased from an authorized distributor, the periods begin when the distributor ships the product. Vestil may, at its sole discretion, extend a warranty period for products shipped from authorized distributors by up to 30 days to account for shipping time.

If a defective part is covered by the warranty, what will Vestil do to correct the problem?

Vestil will provide an appropriate replacement for any *covered* part. An authorized representative of Vestil will contact you to discuss your claim.

What is not covered by the warranty?

The Warrantee (you) is responsible for paying labor costs and freight costs to return the product to Vestil for warranty service.

Events that automatically void this Limited Warranty.

- Misuse;
- Negligent assembly, installation, operation or repair;
- Installation/use in corrosive environments;
- Inadequate or improper maintenance;
- Damage sustained during shipping;
- Collisions or other accidents that damage the product;
- Unauthorized modifications: Do not modify the product IN ANY WAY without first receiving written authorization from Vestil.

Do any other warranties apply to the product?

Vestil Manufacturing Company makes no other express warranties. All implied warranties are disclaimed to the extent allowed by law. Any implied warranty not disclaimed is limited in scope to the terms of this Limited Warranty. Vestil makes no warranty or representation that this product complies with any state or local design, performance, or safety code or standard. Noncompliance with any such code or standard is not a defect in material or workmanship.