

# Topsider Toolbox Mounting Instructions

Please read these instructions and warnings before installation.

## **⚠ DANGER**

Do not use this toolbox for the storage or transportation of flammables, explosives, hazardous waste or materials such as gasoline, solvents, gun powder, dynamite, propane tanks, acetylene tanks or cutting torches. This toolbox is only intended and safe for use in storing and transporting small tools and equipment.

## **⚠ WARNING**

- If the proper mounting brackets are not used, the toolbox could drop off the vehicle while it is moving and cause personal injury and/or property damage.
- For all top of bed rail installations, the truck toolbox must be mounted with the ends attached to the included support legs. Mounting the toolbox without the support legs with significantly reduce the capacity and life of the toolbox and damage your vehicle. The legs are not required if mounting onto a flatbed or other structural surface of the body that supports the entire underside of the toolbox. In this case, at least six 5/16-inch bolts are needed to secure the box to the structural surface or flatbed.
- Prior to any welding or drilling holes in a vehicle frame, check for location of fuel tanks, fuel lines, brake lines or electrical wires.
- If welding is to be done on a vehicle frame in the mounting of this toolbox, disconnect the cables from the battery to prevent shorting of electrical components on the vehicle.
- Always wear protective eye wear when drilling, welding or checking the underside of a vehicle

This truck toolbox may be mounted on various truck types and chassis styles which may require alternative ways to attach the product to the vehicle. Use the included hardware mounting kit to properly mount your truck toolbox (see images below) in a top of bed rail installation; failure to use the mounting kit may void your warranty. Additional fabrication may be necessary to

complete this installation. Buyers Products Co. recommends contacting a qualified and trained truck equipment dealer for installation. Install fasteners with integrated nylock OR add threadlocker adhesive and follow manufacturer instructions with its application. After mounting the toolbox, apply silicone sealant all around each fastener to prevent leaks. Touch-up drilled holes in the truck frame, brackets, and toolbox with aerosol paint to prevent rust.

The legs are not required if mounting onto a flatbed or other structural surface of the body that supports the entire underside of the toolbox. In this case, at least six 5/16-inch bolts are needed to secure the box to the structural surface or flatbed. On the bottom surface, Place at least one bolt as near to each corner as is practical for your installation. If you do not secure all four corners, your box will twist under loading during use which can damage your tools, toolbox, and/or vehicle. It is a best practice to install 2 more bolts on the bottom surface, near the center of the box, one each to the back and front of the toolbox. In this way the six bolts are spread out two on the front end, two in the middle, and two on the back end. Follow guidance above for sealant and threadlocker application. See figure 5 for a diagram of the six bolt locations.

## **Figure 1: Installation Overview**

A final latch adjustment after installation of your toolbox on the truck will ensure the latches are fine-tuned to your box configuration. Review the information below or scan the QR Code to watch our YouTube tutorial on adjusting our most popular latches.



**This step-by-step instructional video details how to adjust and tighten our most popular truck toolbox latches.**

Fig. 1

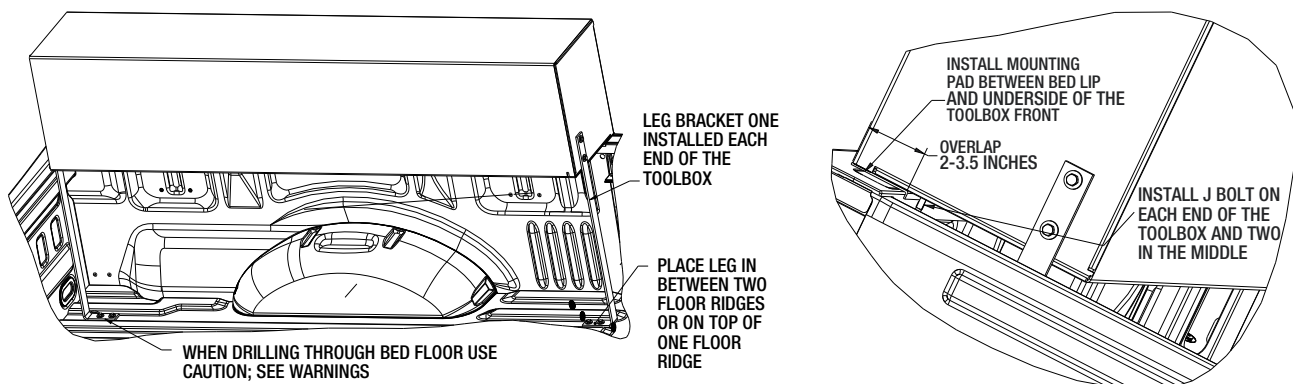

## Installation:

### Tools Required:

- (2) 1/2" Open or Boxed End Wrench
- Ratchet Wrench with 1/2" Deep Well Socket
- Electric Drill
- 1/2" and 3/8" Drill Bits
- Carpenters Square
- Utility Knife or Scissors
- Tape
- 9/16" Open or Boxed End Wrench

1. Park the vehicle on a level surface.
2. Place the mounting pad in position on the top of the truck bed lip as shown in Figure 1. You may want to tape the pad to the lip to keep it from moving during installation.
3. Place the toolbox bottom up on something soft like a drop cloth so you don't dent or scratch the top of your box. Trace 4 lines on the bottom of the box as shown in figure 3, one 2 inches in from each end, and another pair centered, 12 inches apart.
4. Place the toolbox in position on top of the truck bed and support the rear of the box so the box can sit safely by itself. Follow overlap instructions from Figure 1. Support the box with scrap lumber or similar material. Level the box so it is horizontal when viewed from the rear. The mounting of the support legs needs to be directly to the truck floor and not on top of any bed liner or floor mat. Please move these items before proceeding, and they can be replaced at the end.
5. To mark the drill holes for the support legs, Place one support leg as close to the rear corner of the box as possible and use a square to get proper vertical alignment. The closer the legs are mounted to the rear of the box, the more stable the box will be. The foot of each of the support legs must be squarely mounted on or between the floor ridges. Make sure the bolt won't interfere with the structure of the toolbox (end stiffener or shock mounts) when installed.
6. Mark both leg foot holes on the floor of the truck bed and both leg top holes on the end of the toolbox. Repeat the leg placement and marking process at the other end of the toolbox.
7. Before removing the box from the lip, trace a line on the bottom of the toolbox along the edge of the bed lip. This line will be used to position the mounting holes for the "J" bolts in the right spot for your truck. Check where the 4 lines you drew in step 3 intersect the bed lip line that you traced in the previous step. If the location lines up with a feature on the inner wall of the bed that will not allow a "J" Bolt to hook on the bed rail, adjust the position of the line until it clears.
8. Remove the toolbox from the rail and place it upside down again on the soft surface you used in step 3. Find each of the 4 intersections on the bottom of the box and then Offset 1/2 inch into the truck bed for the drill holes for the "J" Bolts. Mark these 4 locations.
9. Drill the necessary 3/8" diameter holes into the sides and bottom of the toolbox as well as the truck bed floor.

10. Fasten the legs to the toolbox and install the box into the truck bed. Ensure the slots on the underside of the toolbox lip are seated over the top of the mounting pad on the bed lip. Fasten the leg feet to the floor and install the "J" bolts as shown in Figure 2.

Fig. 2

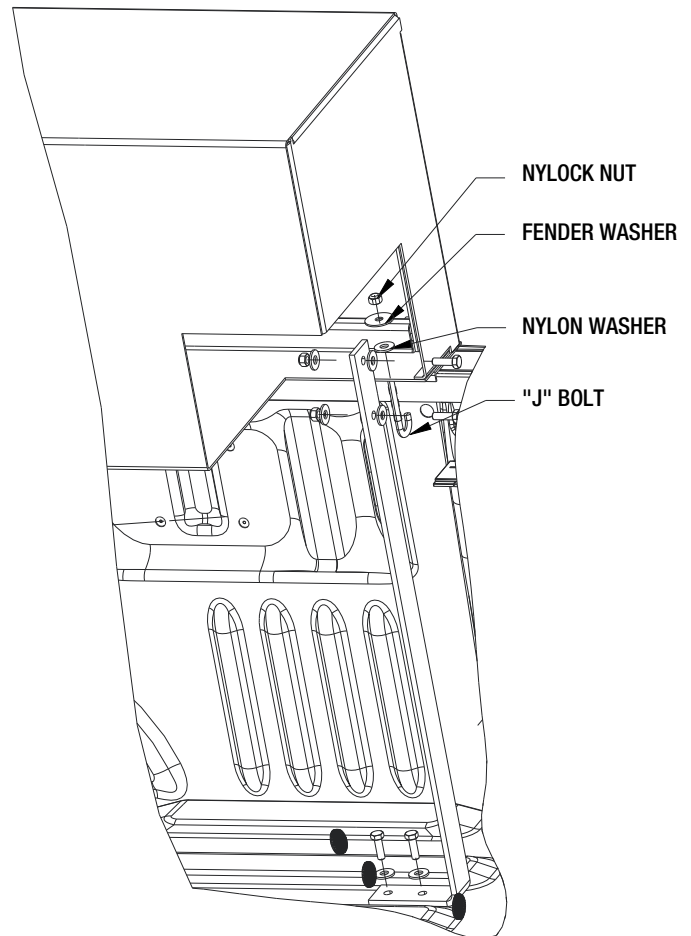

## Maintenance & Adjustment of Truck Toolbox

1. Inspect Latch hardware monthly to ensure proper performance
  - Paddle Latch** - locate the striker post on the top panel of the toolbox. Loosen the adjustment nut, slide to the proper position moving the striker further into the box to tighten the latch. Retighten nut to secure the striker.
  - T-Handle** - Adjust cam arm on backside of latch by loosening the two nuts on the shank. To tighten, loosen the near nut first, slide the cam up to that nut and then tighten the far nut onto the cam.
  - T-Handle with Roller** - Compress the cam arm by hand (moving it towards you) and adjust the single nut to desired position (moving the nut towards you to tighten the latch). The cam arm will lock around nut when re-seated.
2. Check all mounting hardware monthly. The fasteners are subjected to vibration and can loosen over time.
3. Lubricate the truck toolbox hinge twice per year.
4. Inspect gaskets for damage, wear or tears twice per year. Replace if necessary.

Fig. 3

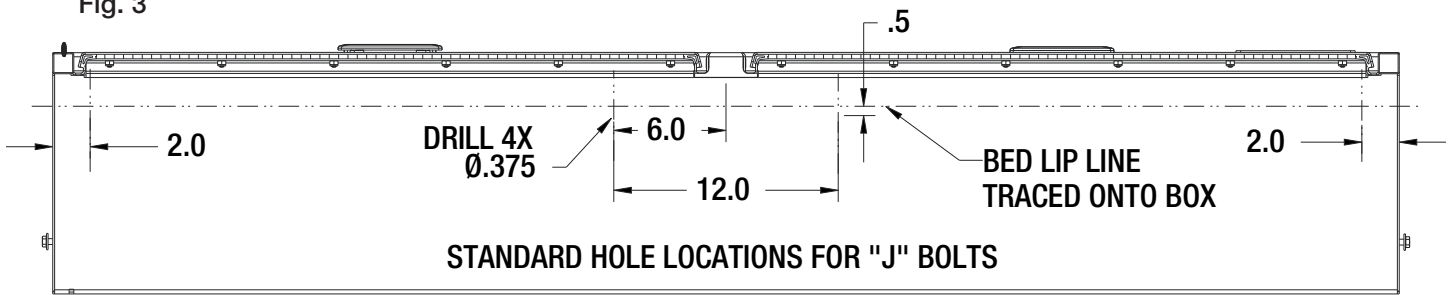

If location lines up with a feature on the inner wall of the bed that will not allow a "J" bolt to hook onto the bed rail, adjust the position of the line until it clears. Drill the hole in that modified location instead.

Fig. 4

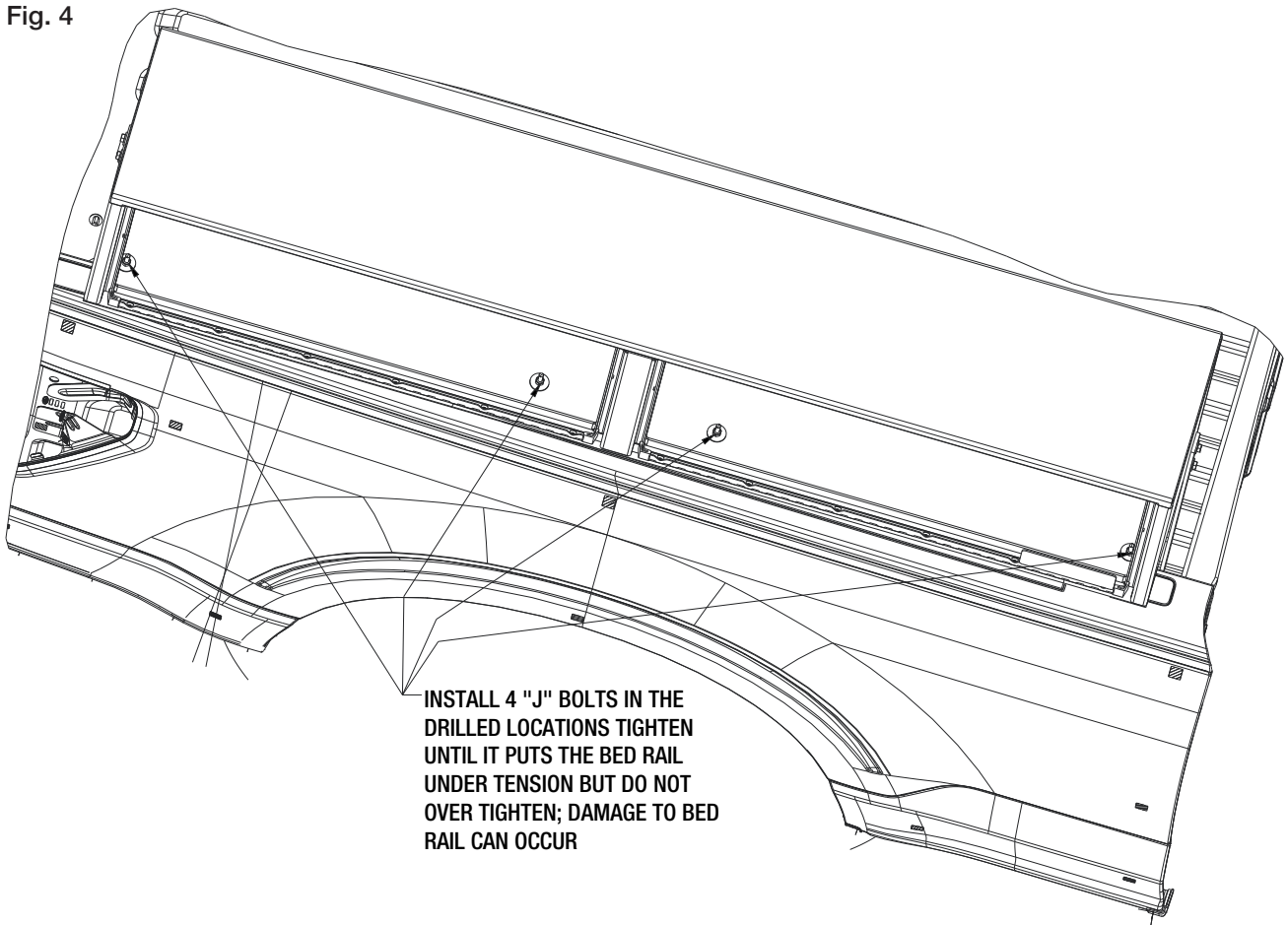
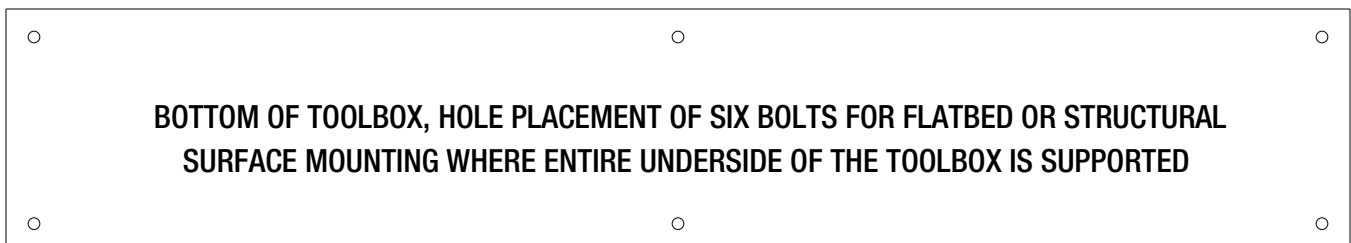

Fig. 5 - This layout below is NOT for top of bed rail installation



## Steel Topsider Shelves

PART NO.	HEIGHT	DEPTH	WIDTH	WT.
<b>BLACK POWDER COATED OPTIONAL SHELF</b>				
1702940TRAY	2.25/4	10.75	35	11
1702950TRAY	2.25/4	10.75	43	14
1702960TRAY	2.25/4	10.75	47	15
1702980TRAY	2.25/4	13.75	35	12
1702990TRAY	2.25/4	13.75	43	14
1703000TRAY	2.25/4	13.75	44	15
1703020TRAY	2.25/4	13.75	77	16
<b>WHITE POWDER COATED OPTIONAL SHELF</b>				
1702840TRAY	2.25/4	10.75	35	11
1702850TRAY	2.25/4	10.75	43	14
1702860TRAY	2.25/4	10.75	47	15
1702880TRAY	2.25/4	13.75	35	12
1702890TRAY	2.25/4	13.75	43	14
1702895TRAY	2.25/4	13.75	44	15
1702920TRAY	2.25/4	13.75	77	16

## Topsider Mounting Hardware Kits

PART NO.	DESCRIPTION	WT.
3005318	Black Mounting Kit	8
3004604	White Mounting Kit	8

## Universal Accessories

PART NO.	DESCRIPTION
1701062	Universal Heavy-Duty Truck Tool Box & Shelf Liner
DM1212B	Universal Heavy-Duty Interlocking Shelf Liner & Floor Tile

## Gas Shocks

PART NO.	EXTENDED LENGTH	COMPRESSED LENGTH	STROKE	ROD DIAMETER	CYLINDER DIAMETER	BALL SOCKET DIAMETER	FORCE RATING (LBS.)	WT.
3045502	17"	10"	7"	6mm	15mm	10mm	20	0.42
3045504	12"	8"	4"	6mm	15mm	10mm	25	0.27
3045506	12"	8"	4"	6mm	15mm	10mm	30	0.43
3045508	12"	8"	4"	6mm	15mm	10mm	40	0.27
3045512	12"	8"	4"	6mm	15mm	10mm	60	0.27
3045514	12"	8"	4"	6mm	15mm	10mm	80	0.42
3040770	17.10"	10.80"	6.30"	8mm	18mm	10mm	97	0.56
3023460	19.63"	11.63"	8"	9.98mm	21.59mm	10mm	250	0.85
3028786	13.93"	8.5"	5.5"	8mm	18mm	10mm	35	0.51
3008745	10mm Ball Stud (Sold Separately except for 3028786)							0.03
FNE031018034	Nylock Nut for Ball Stud (Sold Separately except for 3023460)							0.01

## Common Latches

PART NO.	INFO	DESCRIPTION
L8816	Locking	T-Handle Latch, Stainless
	88CH545	Replacement Cylinder
	CH545	Replacement Key
	L881XGO	Replacement Gasket
L3890RLS	Locking	Paddle Latch, Stainless
	CH545	Replacement Key
	L881XGO	Replacement Gasket
LL9000	Locking	Die Cast T-handle
	88CH545	Replacement Cylinder
	CH545	Replacement Key
	3036319	Replacement Gasket LL9000
LL90003	Locking	3-Point Die Cast T-handle
	88CH545	Replacement Cylinder
	CH545	Replacement Key
	3036319	Replacement Gasket LL9000
	3024136	7.60" individual rod for use in 3-Point Latch for 18" enclosure
	3024137	10.60" individual rod for use in 3-Point Latch for 24" enclosure
	3024138	13.60" individual rod for use in 3-Point Latch for 30" enclosure
	3024139	16.60" individual rod for use in 3-Point Latch for 36" enclosure
	3030564	22.60" individual rod for use in 3-Point Latch for 48" enclosure
	3031368	28.60" individual rod for use in 3-Point Latch for 60" enclosure

### WARRANTY

Buyers Products Co. warrants all truck/trailer hardware manufactured or distributed by it, to be free from defects in material and workmanship for a period of one year from date of shipment. Parts must be properly installed and used under normal conditions. Any product which has been altered, including modification, misuse, accident or lack of maintenance will not be considered under warranty. Normal wear is excluded. The sole responsibility of Buyers Products Co. under this warranty is limited to repairing or replacing any part or parts which are returned, prepaid, and are found to be defective by Buyers Products Co. Authorization from Buyers Products Co. must be obtained before returning any part. No charges for transportation or labor performed on Buyers' products will be allowed under this warranty.