



# 1000-LB. MOTORCYCLE LIFT TABLE

## OWNER'S MANUAL



### **WARNING:**

Read carefully and understand all **ASSEMBLY AND OPERATION INSTRUCTIONS** before operating. Failure to follow the safety rules and other basic safety precautions may result in serious personal injury.

**Item# 46205**

Thank you very much for choosing a Strongway product! For future reference, please complete the owner's record below:

Model: \_\_\_\_\_ Purchase Date: \_\_\_\_\_

Save the receipt, warranty and these instructions. It is important that you read the entire manual to become familiar with this product before you begin using it.

This machine is designed for certain applications only. The distributor cannot be responsible for issues arising from modification. We strongly recommend this machine not be modified and/or used for any application other than that for which it was designed. If you have any questions relative to a particular application, DO NOT use the machine until you have first contacted the distributor to determine if it can or should be performed on the product.

For technical questions please call **1-800-222-5381**.

## INTENDED USE

This Motorcycle Lift Table elevates motorcycles, ATVs, riding mowers or snowmobiles to make repairs and maintenance easier and more comfortable. A great accessory lift for motorcycle builds or bikes requiring long term storage. Adjust the height by rotating the screw manually.

## TECHNICAL SPECIFICATIONS

Description	Specifications
Maximum Capacity	1,000 lbs
Minimum Lift Height without adapters	3.94 inch
Maximum Lift Height without adapters	13.38 inch
Minimum Lift height with adapters	6.69 inch
Maximum Lift Height with adapters	17.72 inch
Product Dimensions	20.86 x 7.08 x 6.69 inch
Product weight	35.2 lbs

Safe Operating Temperature is between 40°F – 105°F (4°C - 41°C)

## GENERAL SAFETY RULES



**WARNING:** Read and understand all instructions. Failure to follow all instructions listed below may result in serious injury.



**CAUTION:** Do not allow persons to operate or assemble this lift table until they have read this manual and have developed a thorough understanding of how the lift table works.



**WARNING:** The warnings, cautions, and instructions discussed in this instruction manual cannot cover all possible conditions or situations that could occur. It must be understood by the operator that common sense and caution are factors which cannot be built into this product, but must be supplied by the operator.

## SAVE THESE INSTRUCTIONS

## LIFT TABLE USE AND CARE

- **Do not modify the lift table in any way.** Unauthorized modification may impair the function and/or safety and could affect the life of the equipment. There are specific applications for which the **lift table** was designed.
- **Always check of damaged or worn out parts before using the lift table.** Broken parts will affect the **lift table** operation. Replace or repair damaged or worn parts immediately.
- **Store idle lift table.** When **lift table** is not in use, store it in a secure place out of the reach of children. Inspect it for good working condition prior to storage and before re-use.
- **Not for use by children** or people with reduced mental capacity.
- **Do not use under the influence of drugs or alcohol.**
- **Ensure children and other bystanders** are kept at a safe distance when using table.

## INSPECTION

- Inspect the table carefully before each use. Ensure the table is not damaged, excessively worn, or missing parts.
- Do not use the table unless it is properly lubricated.
- Using a table that is not in good clean working condition or properly lubricated may cause serious injury.
- Inspect the work area before each use. Make sure it is free and clear of any potential hazards.



**WARNING:** The warnings, cautions, and instructions discussed in this instruction manual cannot cover all possible conditions or situations that could occur. It must be understood by the operator that common sense and caution are factors that cannot be built into this product, but must be supplied by the operator.

# SAFETY MARKINGS



## **WARNING:**

- Study, understand, and follow all instructions before operating this device.
- Do not exceed rated capacity.
- Use only on hard, level surfaces.
- Center load on lift platform or if saddles are used, load saddles equally.
- If saddles are used, use as a matched pair only.
- Lift only those areas of the motorcycle specified by its manufacturer.
- Use of this product is limited to lifting, lowering, and storing in the lowered position, loads consisting of a motorcycle whose lift points are compatible with the lift platform. Incompatibility is evident when the loaded vehicle wobbles, appears unstable, and/or does not securely engage the lift platform.
- Never work on, around or under a load that is not stable and secure.
- Keep operator's and bystander's head, hands, and feet away from lift when raising and lowering.
- No alterations shall be made to this product.
- Only attachments and/or adapters supplied by the manufacturer shall be used.
- Do not use lift for any use other than the manufacturer specified usage.
- Failure to heed these markings may result in personal injury and/or property damage.

## ASSEMBLY

1. Familiarize yourself with the lift.
2. Insert the lift handle onto the handle socket.
3. Mount the saddle brackets onto the platform, then tighten the locking screw on each saddle.

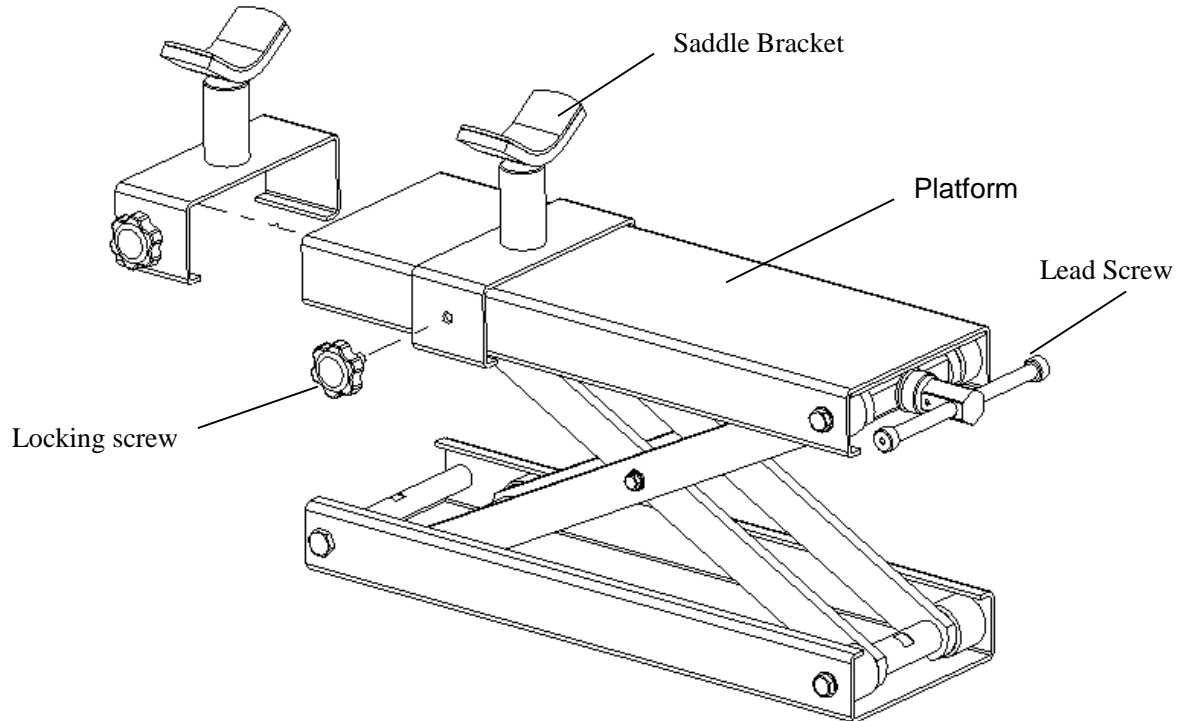

4. Make sure the saddle is correctly positioned. To prevent damage to the lift, do not move the lift while the handle is attached to the socket..
5. Secure the handle in place inside onto handle socket. Without any weight on the lift. Cycle the lift up and down several times to insure the lift is operating properly.

## BEFORE USE

1. Before using this product, read the owner's manual completely and familiarize yourself thoroughly with the product and the hazards associated with its improper use.
2. Check that the lift operates smoothly before putting into service.
3. Inspect before each use. Do not use if bent, broken or cracked components are noted.

# OPERATION

## RAISING THE LIFT

1. Position the lift near desired lift point.
2. Rotate the lead screw handle to adjust and raise the lift.
  - To prevent damage to the lift, do not move the lift while the handle is attached to the socket.
3. With-out any weight on the lift. Cycle the lift up and down several times to insure the lift is operating properly.
4. Before raising double check and verify the saddles are centered and also has full contact with the lifting point.
5. Grasp the handle firmly with both hands. Securely hold on to the lift handle so your hands do not slip.
6. To raise load, turn handle clockwise.
7. After lifting, support the load by appropriate means before working under any load.

**CAUTION:** NEVER WIRE, CLAMP OR OTHERWISE DISABLE THE LIFT CONTROL TO FUCTION BY ANY MEANS OTHER THAN BY USING THE OPERATOR'S HAND. USE THE HANDLE PROVIDED WITH THIS PRODUCT OR AN AUTHORIZED REPLACEMENGT HANDLE TO ENSURE PROPER RELEASE OPERATION

## LOWERING THE LIFT

1. Insert the lift handle onto the handle socket.
  - To prevent damage to the lift, do not move the lift while the handle is attached to the socket.
2. Grasp the handle firmly with both hands. Securely hold on to the lift handle so your hands do not slip and ensure the release valve does not rapidly lower.
3. Raise load high enough to allow clearance for the support stands to be removed, then carefully remove support stands.
4. Secure the handle in place on the handle socket.
5. To lower load, turn handle counter-clockwise.
6. After removing lift from under the load, lower the saddle completely.



**WARNING:** USE EXTREME CAUTION WHEN LOWERING THE LIFT. FAILURE TO HEAD THESE WARNINGS COULD CAUSE SERIOUS INJURY OR DEATH.

# MAINTENANCE INSTRUCTIONS

**Maintain your lift table.** It is recommended that the general condition of any **lift table** be examined before it is used. Keep your **lift table** in good repair by adopting a program of conscientious repair and maintenance. Have necessary repairs made by qualified service personnel.

If you use and maintain your equipment properly, it will give you many years of service. Follow the maintenance instructions carefully to keep your equipment in good working condition. Never perform any maintenance on the equipment while it is under a load.

Visual inspection shall be made before each use of the lift by checking for abnormal conditions, such as cracked welds, and damaged or missing parts.

Because of the potential hazard associated with the lift, no alterations shall be made to the products.

## **Inspection**

You should inspect the product for damage, wear, broken or missing parts (e.g.: pins) and that all components function before each use. Follow lubrication and storage instructions for optimum product performance.

## **Binding**

If the product binds while under a load, use equipment with equal or a larger load capacity to lower the load safely to the ground. After un-binding; clean, lubricate and test that equipment is working properly. Rusty components, dirt, or worn parts can be causes of binding Clean and lubricate the equipment as indicated in the lubrication section. Test the equipment by lifting without a load. If the binding continues contact Customer Service.

## **Cleaning**

If the moving parts of the equipment are obstructed, use cleaning solvent or another good degreaser to clean the equipment. Remove any existing rust, with a penetrating lubricant.

## **Lubrication**

This equipment will not operate safely without proper lubrication. Using the equipment without proper lubrication will result in poor performance and damage to the equipment. Some parts in this equipment are not self-lubricating inspect the equipment before use and lubricate when necessary. After cleaning, lubricate the equipment using light penetrating oil, lubricating spray.

-Use a good lubricant on all moving parts.

-For light duty use lubrication once a month.

-For heavy and constant use lubrication recommended every week.

-NEVER USE SANDPAPER OR ABRASIVE MATERIAL ON THESE SURFACES!

## **Rust Prevention:**

-Check threads and pivot point's assemblies daily for any signs of rust or corrosion.

-Without a load lift the equipment as high as it goes and look under and behind the lifting points. If signs of rust are visible clean as needed.

## **Grease Fittings**

-Some models contain grease fittings the will regularly need to be greased and lubricated.

## **Storing the Lift**

1. Lower the Lifting Saddle in the full down position.
2. Store in a dry location, recommended indoors.
3. Store the handle with care.

**Note:** *If the lift is stored outdoors, be sure to lubricate all parts before and after use to ensure the lift stays in good working condition.*

# ASSEMBLY DIAGRAM

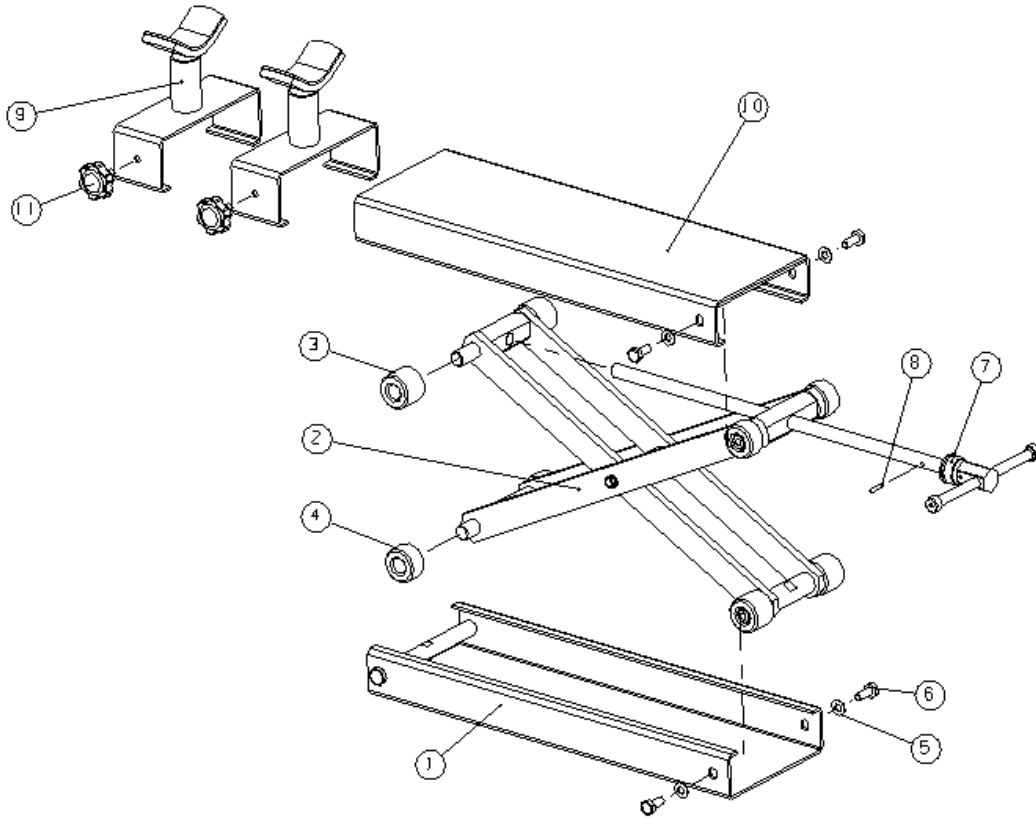

## PARTS LIST

Index #	Description	Part No.	Qty.
1	Bottom Platform	TRE4101-001	1
2	Lifting Part	TRE4101-002	1
3	Pulley	TRE4101-003	4
4	Pulley	TRE4101-004	4
5	Washer	TRE4101-005	4
6	Screw	TRE4101-006	4
7	Lead Screw	TRE4101-007	1
8	Elastic Pin	TRE4101-008	1
9	Support Part	TRE4101-009	2
10	Top Platform	TRE4101-010	1
11	Locking Screw	TRE4101-011	2

Safe Operating Temperature is between 40°F – 105°F (4°C - 41°C)

## REPLACEMENT PARTS

For replacement parts Customer Service at **1-800-222-5381**. Not all equipment components are available for replacement; illustrations provided are a convenient reference of location and position in the assembly sequence. When ordering parts the following will be required: Model Number, Serial Number and Description.

**The distributor reserves the rights to make design changes and or improvements to product lines and manuals without notice.**

For replacement parts and technical questions, please call 1-800-222-5381.

## **Limited Warranty**

### **Limited Warranty**

Northern Tool and Equipment Company, Inc. ("We" or "Us") warrants to the original purchaser only ("You" or "Your") that the Strongway product purchased will be free from material defects in both materials and workmanship, normal wear and tear excepted, for a period of one year from date of purchase. The foregoing warranty is valid only if the installation and use of the product is strictly in accordance with product instructions. There are no other warranties, express or implied, including the warranty of merchantability or fitness for a particular purpose. If the product does not comply with this limited warranty, Your sole and exclusive remedy is that We will, at our sole option and within a commercially reasonable time, either replace the product without charge to You or refund the purchase price (less shipping). This limited warranty is not transferable.

### **Limitations on the Warranty**

This limited warranty does not cover: (a) normal wear and tear; (b) damage through abuse, neglect, misuse, or as a result of any accident or in any other manner; (c) damage from misapplication, overloading, or improper installation; (d) improper maintenance and repair; and (e) product alteration in any manner by anyone other than Us, with the sole exception of alterations made pursuant to product instructions and in a workmanlike manner.

### **Obligations of Purchaser**

You must retain Your product purchase receipt to verify date of purchase and that You are the original purchaser. To make a warranty claim, contact Us at 1-800-222-5381, identify the product by make and model number, and follow the claim instructions that will be provided. The product and the purchase receipt must be provided to Us in order to process Your warranty claim. Any returned product that is replaced or refunded by Us becomes our property. You will be responsible for return shipping costs or costs related to Your return visit to a retail store.

### **Remedy Limits**

Product replacement or a refund of the purchase price is Your sole remedy under this limited warranty or any other warranty related to the product. We shall not be liable for: service or labor charges or damage to Your trailer incurred in removing or replacing the product; any damages, including, without limitation, damages to tangible personal property or personal injury, related to Your improper use, installation, or maintenance of the product; or any indirect, incidental or consequential damages of any kind for any reason.

### **Assumption of Risk**

You acknowledge and agree that any use of the product for any purpose other than the specified use(s) stated in the product instructions is at Your own risk.

### **Governing Law**

This limited warranty gives You specific legal rights, and You also may have other rights, which vary from state to state. Some states do not allow limitations or exclusions on implied warranties or incidental or consequential damages, so the above limitations may not apply to You. This limited warranty is governed by the laws of the State of Minnesota, without regard to rules pertaining to conflicts of law. The state courts located in Dakota County, Minnesota shall have exclusive jurisdiction for any disputes relating to this warranty.



Distributed by  
Northern Tool + Equipment Co., Inc.  
Burnsville, Minnesota 55306  
NorthernTool.com  
Made in China