



# 15GAL STEEL OIL DRAIN WITH 110V PUMP

## OWNER'S MANUAL



### **WARNING:**

Read carefully and understand all **ASSEMBLY AND OPERATION INSTRUCTIONS** before operating. Failure to follow the safety rules and other basic safety precautions may result in serious personal injury.

**Item # 42735**

Thank you very much for choosing a Roughneck product! For future reference, please complete the owner's record below:

Model: \_\_\_\_\_ Purchase Date: \_\_\_\_\_

Save the receipt, warranty and these instructions. It is important that you read the entire manual to become familiar with this product before you begin using it.

This product is designed for certain applications only. The manufacturer cannot be responsible for issues arising from modification. We strongly recommend this product not be modified and/or used for any application other than that for which it was designed. If you have any questions relative to a particular application, DO NOT use the product until you have first contacted us to determine if it can or should be performed on the product.

For technical questions, please call **1-800-222-5381**

## Intended Use

Works great for low-profile applications.

## TECHNICAL SPECIFICATIONS

Item	Description
<b>Capacity:</b>	15 gallons
<b>Dimensions:</b>	48.03in.L x 24.80in.W x 7.857in.H
<b>Includes:</b>	3in. front swivel caster, 5in. rear wheel and T-bar handle
<b>Additional Features:</b>	Expanded metal cover helps reduce oil splash
	Built-in 110V pump for fast oil draining
	8ft. drain hose

## GENERAL SAFETY RULES



**WARNING:** Read and understand all instructions. Failure to follow all instructions listed below may result in serious injury.



**CAUTION:** Do not allow persons to operate or assemble this low-profile steel oil drain until they have read this manual and have developed a thorough understanding of how the low-profile steel oil drain works.





**WARNING:** The warnings, cautions, and instructions discussed in this instruction manual cannot cover all possible conditions or situations that could occur. It must be understood by the operator that common sense and caution are factors which cannot be built into this product, but must be supplied by the operator.

## SAVE THESE INSTRUCTIONS

## WORK AREA

- **Keep work area clean**, free of clutter and well lit. Cluttered and dark work areas can cause accidents.
- **Keep children and bystanders** away while operating a low-profile steel oil drain. Distractions can cause you to lose control, so visitors should remain at a safe distance from the work area.
- **Be alert of your surroundings.** Using a low-profile steel oil drain in confined work areas may put you dangerously close to cutting tools and rotating parts.

## PERSONAL SAFETY

- **Stay alert**, watch what you are doing and use common sense when using a low-profile steel oil drain. Do not use a low-profile steel oil drain while you are tired or under the influence of drugs, alcohol or medication. A moment of inattention while operating the low-profile steel oil drain may result in serious personal injury.
- **Dress properly.** Do not wear loose clothing, dangling objects, or jewelry. Keep your hair, clothing and gloves away from moving parts. Loose clothes, jewelry or long hair can be caught in moving parts.
- **Use safety apparel and equipment.** Use safety goggles or safety glasses with side shields which comply with current national standards, or when needed, a face shield. Use a dust mask if working in dusty work conditions. This applies to all persons in the work area. Also use non-skid safety shoes, hardhat, gloves, dust collection systems, and hearing protection when appropriate.
  - Make sure the Oil Drain is used only on a dry, oil/grease free, flat, level, ground surface capable of supporting the weight of the unit and contents.
  - Do not work under the vehicle without proper support devices.
  - Prior to using the Oil Drain Dolly, make sure to read and understand all warnings, safety precautions, and instructions as outlined in the vehicle manufacturers and the support device's instruction manuals.
  - Do not allow anyone in the vehicle while using the Oil Drain. Keep all bystanders a safe distance away from the vehicle.
  - Avoid burns. Allow the engine oil to completely cool before draining the oil into the Oil Drain
  - Do not leave the Oil Drain unattended when operating or draining the oil.
-  Never use the Oil Drain near open flames or heat sources.
- Make sure to remove the Oil Drain and all other tools and equipment before lowering the vehicle to the floor surface.
-  Follow guidelines for engine oil disposal. Used engine oil should be removed from the vehicle and properly disposed of or recycled. Many states require recycling. Contact your local solid/liquid waste authority for information on recycling and/or disposal.
- Oil contains hazardous chemicals which may be harmful to the environment and hazardous to your health.
- Do not use oil drain in wet or damp conditions. It could result in electrical shock.
- If extension cords are used, use heavy duty extension cord not longer than 25'.

## LOW-PROFILE STEEL OIL DRAIN USE AND CARE

- **Do not modify the LOW-PROFILE steel oil drain in any way.** Unauthorized modification may impair the function and/or safety and could affect the life of the equipment. There are specific applications for which the low-profile steel oil drain was designed.
- **Always check for damaged or worn out parts before using the LOW-PROFILE steel oil drain.** Broken parts will affect the low-profile steel oil drain operation. Replace or repair damaged or worn parts immediately.
- **Do not exceed the LOW-PROFILE steel oil drain load capacity.**
- **Distribute the load evenly.** Uneven loads may cause the low-profile steel oil drain to tip, resulting in personal injury to the operator or others.
- **Use the LOW-PROFILE steel oil drain on flat and level surfaces** capable of supporting the low-profile steel oil drain and its maximum load. Pulling or pushing a load on a slanted or uneven surface can result in loss of control.
- **Store idle LOW-PROFILE steel oil drain.** When low-profile steel oil drain is not in use, store it in a secure place out of the reach of children. Inspect it for good working condition prior to storage and before re-use.
- **Do not DRAIN gasoline, caustic, or flammable products.**

## WARNINGS FOR ELECTRIC PUMP

1. If the plug on the pump is damaged, replace by a qualified service technician.
2. To prevent serious injury from accidental operation: Disconnect the Pump from its 110 Volt connection before performing any inspection, maintenance, or cleaning procedures.
3. To prevent serious injury from pump failure: Do not use damaged equipment. If abnormal noise or vibration occurs, have the problem corrected before further use.
4. Never smoke near the Pump or use the Pump near an open flame. Fire could result.
5. Designate a work area that is clean and well-lit. The work area must not allow access by children or pets to prevent distraction or injury.
6. Route the cord along a safe route to reach the work area without creating a tripping hazard or exposing the cables to possible damage. The cord must reach the work area with enough extra length to allow free movement while working.
7. There must not be hazardous objects, such as utility lines or foreign objects, nearby that will present a hazard while working.

## ASSEMBLY

### See parts diagram for reference during assembly

1. Attach the Wheel (#26) together with Bearing (#24) to the wheel axle under the back of the Reservoir (#19) , secure with Bolt (#23), Washers (#15), Retaining rings (#25) and Lock Nut (#27). Be sure the wheel can spin freely.
2. Attach the Caster (#12) to the bracket at the front of the Reservoir (#19); secure with Washer (#15) , Spring Washer (#14) and Nut (#13).
3. Connect one end of Short Hose (#10) to Hose Fitting (#11) under the Reservoir(#19), and another end to Hose Fitting (#28) under the Pump (#9); secure them with Hose Clamps (#6).
4. Connect Long Hose (#3) to Hose Fitting (#7) on top of the Pump (#9), Secure with Hose Clamps (#6).
5. Attach the Handle Seater (#22) on the top front of the Reservoir (#19), secure with Bolt (#20),

- Spring Washer(#21) and Washer(#17); Attach the handle onto the Handle Seater (#22), secure with Bolt (#18), Washer(#17) and Lock Nut (#16).
6. Connect the Pressing Plate (#31) to the Reservoir (#19) with Screw (#30) and Filter (#32).
  7. Put the Filter Screen (#2) onto the Reservoir (#19).

## OPERATION



**WARNING: Follow all safety precautions outlined in this manual and the vehicle manual.**

1. Move the Oil Drain under the vehicle, making sure the Opening of Reservoir is positioned directly below the oil drain plug of the engine.
2. Remove the oil drain plug of the engine, and allow the old oil to completely drain from the engine into the Reservoir.
3. Once the old engine oil is completely drained, replace the oil drain plug of the engine and refill, if needed.
4. When emptying the old oil from the Reservoir of the Oil Drain, make sure to follow guidelines for engine oil disposal. If necessary, contact your local solid/liquid waste authority for information on recycling and/or disposal.
5. Move the oil drain to where the old oil will be temporary stored (e.g., a tank). Connect the cord to a 110 Volt circuit. For new pump or pump that has not been used for a long time, fill with a little oil from inlet and outlet of the pump before use; this action keeps the rotors of the pump lubricated.
6. Put the Long Hose (#3) into the tank, and switch on the electric pump until old oil in the drain is emptied out.

## MAINTENANCE

- **Maintain your low-profile steel oil drain.** It is recommended that the general condition of any low-profile steel oil drain be examined before it is used. Keep your low-profile steel oil drain in good repair by adopting a program of conscientious repair and maintenance. If any abnormal vibrations or noise occurs, have the problem corrected before further use. Have necessary repairs made by qualified service personnel. Before each use, inspect the general condition of the Oil Drain. Check for broken or bent parts, loose or missing parts, and any condition that may affect the proper operation of the product. If a problem occurs, have the problem corrected before further use. **Do not use damaged equipment.**
- When cleaning, use a clean cloth with detergent or mild solvent. Then, store the Oil Drain in a safe and dry location.

# DIAGRAM & PARTS LIST

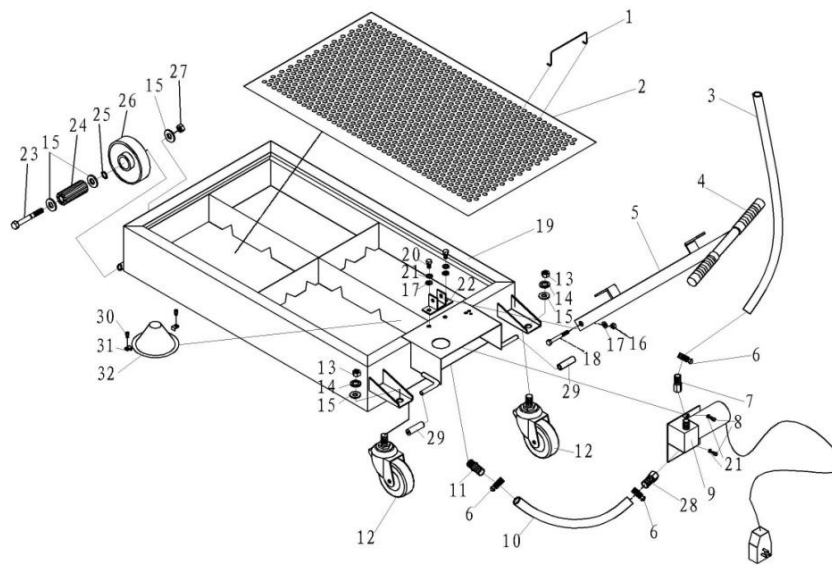

Ref #	Description	Qty	Ref #	Description	Qty
1	Handle	1	17	Washer	3
2	Filter Board	1	18	Bolt	1
3	Long Hose	1	19	Reservoir	1
4	Handle Grip	2	20	Bolt	2
5	Handle Ass'y	1	21	Spring Washer	4
6	Hose Clamp	3	22	Handle Seater	1
7	Connector I	1	23	Bolt	2
8	Screw	2	24	Bearing	2
9	Pump	1	25	Retaining Ring	2
10	Short Hose	1	26	Wheel	2
11	Connector II	1	27	Locking Nut	2
12	Caster	2	28	Connector III	1
13	Nut	2	29	Cover	2
14	Spring Washer	2	30	Screw	2
15	Washer	8	31	Pressing Plate	2
16	Locking Nut	1	32	Filter	1

For replacement parts and/or technical questions, please call **1-800-222-5381**.

**WARRANTY:** One-year Limited Parts Warranty



Distributed by  
 Northern Tool + Equipment Co., Inc.  
 Burnsville, Minnesota 55306-6936  
 Made in China