



### Vestil Manufacturing Company

2999 North Wayne Street, P.O. Box 507, Angola, IN 46703  
Telephone: (260) 665-7586 -or- Toll Free (800) 348-0868  
Fax: (260) 665-1339  
Web: [www.vestil.com](http://www.vestil.com) e-mail: [info@vestil.com](mailto:info@vestil.com)

# BOL-FD-2W-36-YL Fold-Down Bollard



### Receiving Instructions

After delivery, remove the packaging from the product. Inspect the product closely to determine whether it sustained damage during transport. If damage is discovered, record a complete description of it on the bill of lading. If the product is undamaged, discard the packaging.

**NOTE:** The end-user is solely responsible for confirming that product design, use, and maintenance comply with laws, regulations, codes, and mandatory standards applied where the product is used.

### Technical Service & Replacement Parts

For answers to questions not addressed in these instructions and to order replacement parts, labels, and accessories, call our Technical Service and Parts Department at (260) 665-7586. The department can also be contacted online at <https://www.vestil.com/page-parts-request.php>.

### Electronic copies of Instruction Manuals

Additional copies of this instruction manual may be downloaded from <https://www.vestil.com/page-manuals.php>.

Table of Contents	Page
<a href="#">Signal Words</a> .....	2
<a href="#">Safety Instructions</a> .....	2
<a href="#">Specifications</a> .....	3
<a href="#">Exploded View and Bill of Materials</a> .....	4
<a href="#">Installing the Bollard</a> .....	4
<a href="#">Assembling the Bollard</a> .....	5
<a href="#">Record of Satisfactory Condition</a> .....	6
<a href="#">Inspecting and Maintaining the Bollard</a> .....	6
<a href="#">Labeling Diagram</a> .....	6
<a href="#">Limited Warranty</a> .....	7

## SIGNAL WORDS

SIGNAL WORDS appear in this manual to draw the reader's attention to important safety-related messages. The following are signal words used in this manual and their definitions.

<b>⚠ DANGER</b>	<b>Identifies a hazardous situation which, if not avoided, <u>WILL</u> result in DEATH or SERIOUS INJURY. Use of this signal word is limited to the most extreme situations.</b>
<b>⚠ WARNING</b>	<b>Identifies a hazardous situation which, if not avoided, <u>COULD</u> result in DEATH or SERIOUS INJURY.</b>
<b>⚠ CAUTION</b>	<b>Indicates a hazardous situation which, if not avoided, <u>COULD</u> result in MINOR or MODERATE injury.</b>
<b>NOTICE</b>	<b>Identifies practices likely to result in product/property damage, such as operation that might damage the product.</b>

## SAFETY INSTRUCTIONS

Vestil strives to identify foreseeable hazards associated with the use of its products, but no manual can address every conceivable risk. Minimize the likelihood of injury by observing the hazards identified below and by inspecting and maintaining the product as instructed in [INSPECTING & MAINTAINING THE BOLLARD](#) on p. 6.

### ⚠ WARNING

Risks of serious personal injuries or death.

- **Read and understand the entire manual before assembling, using, inspecting, or servicing the baler.**
- Read and understand the entire manual before installing, using, or servicing the product.
- Read the manual whenever necessary to refresh your understanding of proper use and maintenance procedures.
- DO NOT attempt to resolve any problem(s) with the product unless you are both authorized to do so and certain that it will be safe to use afterwards.
- DO NOT modify the product in any way UNLESS you first obtain written approval from Vestil. Unauthorized modifications automatically void the [LIMITED WARRANTY](#) on p. 7 and might make the product unsafe to use.
- Inspect the product as instructed in the [INSPECTING AND MAINTAINING THE BOLLARD](#) section on p. 6. DO NOT use this product unless it is in [SATISFACTORY CONDITION](#). If your bollard requires repairs or replacement parts, DO NOT use the product until it is fully restored to [SATISFACTORY CONDITION](#). See [RECORD OF SATISFACTORY CONDITION](#) on p. 6.
- DO NOT use the product if it is not securely anchored to the ground/surface. The bollard should not wobble. Relocate the bollard if it cannot be securely anchored to the ground/surface.
- Replace the bollard immediately after it sustains damage. NOTE: Damaged sustained as a result of the bollard's intended/designed use is not covered by the warranty.
- DO NOT use this device UNLESS all labels are clearly visible and undamaged. Replace damaged labels as soon as damage occurs. See [LABELING DIAGRAM](#) on p. 6.

### NOTICE

Proper use, maintenance, and storage are essential for this product to function properly.

- Always use this product in accordance with the instructions in this manual and consistent with any training relevant to machines, devices, etc. used in conjunction with this product.
- Keep the product clean & dry. Lubricate moving parts.

# SPECIFICATIONS

Specifications documents for BOL-FD-2W-36-YL fold-down bollards are available online to anyone who visits Vestil's website. Specifications include attributes such as dimensions and net weight information. To access the applicable specifications document, navigate to this webpage: <https://www.vestil.com/product.php?FID=1781>. Scroll the page to the "Product Specifications Table". Click the button in the "PDFs" column that looks like a pencil inside a box. A PDF file will open. This file is the specifications document. Print a copy of the document and keep it with your copy of this manual. The following is an exemplar specifications document.

## 2 WAY FOLD DOWN STEEL BOLLARD - BOL-FD-2W-36-YL

\*\*\* ANY ADDITIONS, DELETIONS, OR OMISSIONS MUST BE CORRECTED ON THIS DRAWING AS THIS DRAWING WILL BE CONSIDERED ALL INCLUSIVE \*\*\*  
ALL GRAPHICS PROVIDED ARE FOR REFERENCE ONLY. IF CERTAIN DIMENSIONS ARE CRITICAL PLEASE VERIFY THOSE DIMENSIONS WITH YOUR SALESPERSON

APPROX WEIGHT: 26.27 lbs.  
DOES NOT INCLUDE WEIGHT OF POWER OR PACKAGING!!!

### STANDARD FEATURES

- MODEL NUMBER IS BOL-FD-2W-36-YL
- OVERALL WIDTH IS 8"
- BOLLARD WIDTH IS 4 3/8"
- OVERALL LENGTH IS 12"
- OVERALL LENGTH LOWERED IS 40 9/16"
- USABLE LENGTH IS 12"
- OVERALL HEIGHT IS 36"
- OVERALL HEIGHT LOWERED IS 3"
- USABLE HEIGHT LOWERED IS 2 7/16"
- STEEL CONSTRUCTION
- DURABLE BAKED-IN POWDER COATED YELLOW FINISH

### SPECIAL FEATURES

NONE

DIMENSION TOLERANCE ± 1/4"

APPROVAL	I, THE UNDERSIGNED, AGREE THAT THE PRODUCT AS REPRESENTED SATISFIES DESIGN AND DIMENSION REQUIREMENTS. I ALSO ACKNOWLEDGE MY DUTY TO CONFIRM PRODUCT AND INSTALLATION COMPLIANCE WITH ALL APPLICABLE FEDERAL, STATE AND LOCAL REGULATIONS AND STANDARDS.	
	UNITS REQUIRING APPROVAL DRAWINGS OR MODIFIED ARE NON-RETURNABLE	
	[ ] As drawn	[ ] As marked
	Signed: _____ Date: _____	
Printed Name: _____		
LEAD TIME WILL START UPON RECEIPT OF SIGNED APPROVAL DRAWING		
DISTRIBUTOR'S NAME:	P.O.# X	
VESTIL MANUFACTURING		W.O.# X
DRAWN BY: TJH	DATE: 02/06/24	SALES: X
REFERENCE: X	SCALE: 1:12	FILE NAME:
QUOTED LEAD TIME: X	QUOTE # X	23-007-905

**NOTE:** If your model is not included on the webpage, or if you cannot access and/or print the document, contact the [TECHNICAL SERVICE DEPT.](#) Contact information is provided on the front page of this manual.

## EXPLODED VIEW AND BILL OF MATERIALS: BOL-FD-2W-36-YL 23-006-905

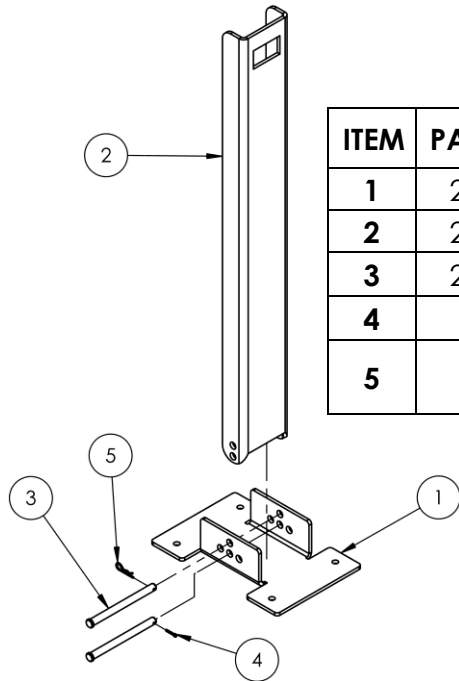

ITEM	PART NUMBER	DESCRIPTION	QTY.
1	23-016-275	BRACKET, FLOOR MOUNT, FORMED	1
2	23-024-531	GUARD, BOLLARD, LEG, FORMED	1
3	23-112-024	PIN, CLEVIS, 1/2 x 6"	2
4	65073	COTTER PIN, ZINC FINISH, Ø1/8 X 5/8"	1
5	45281	0.093 X 1 5/8 HAIRPIN COTTER, 1/4 - 1/2 SHAFT	1

### INSTALLING THE BOLLARD

There are 4 bolt holes in the mounting bracket of your bollard for receiving 3/8" anchor bolts. Your building engineer should determine the necessary length of the anchor bolts used to attach the bollard to the selected concrete surface.

To install the bollard:

- 1) Begin by setting the **mounting bracket** in position at the installation site.
- 2) Mark the concrete with the locations of all 4 **bolt holes**. See arrows (↓) in diagram.
- 3) Drill holes where the surface is marked using a properly sized masonry drill bit. Drill to the depth specified in the installation instructions for your anchoring hardware. Install anchors in the drilled holes as instructed.
- 4) Set the bollard in place, i.e. align bolt holes in the mounting plate with the holes you just drilled into the concrete.
- 5) Install anchor bolts through the bolt holes in the mounting plate.

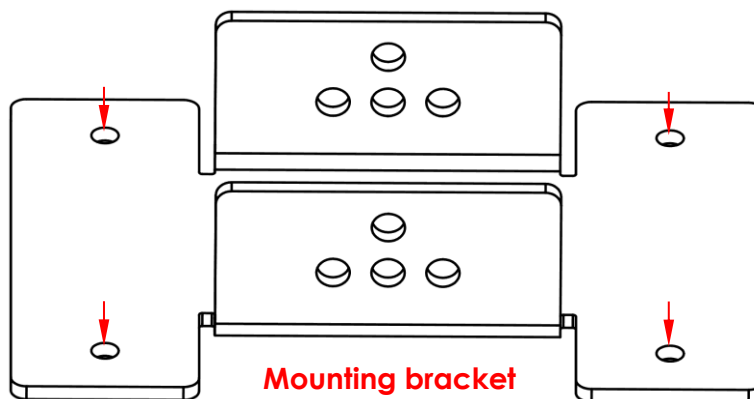

**Install 3/8" anchor bolts of appropriate length through bolt holes (arrows) in mounting bracket**

## ASSEMBLING THE BOLLARD

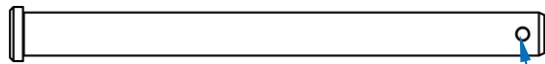

Clevis pin

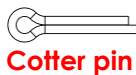

Cotter pin



Hitch pin

Small hole for either cotter pin or hitch pin

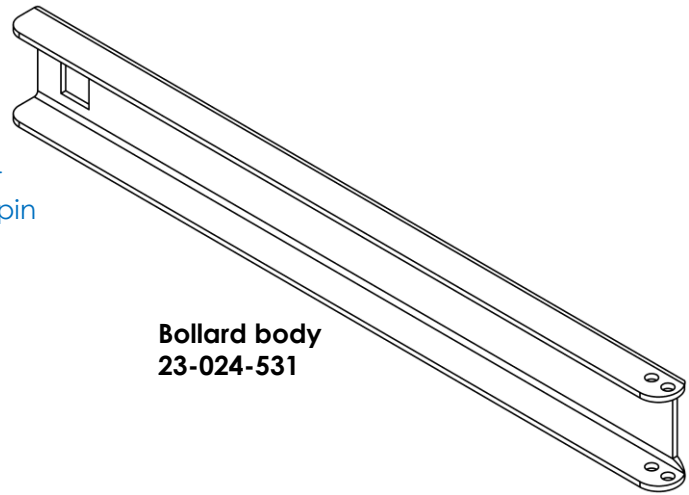

Bollard body  
23-024-531

Once the mounting plate is anchored to the floor/surface, the bollard body can be attached to it.

1) Align the middle pair of bolt holes in the mounting bracket with the lowest pair of bolt holes in the bollard body.

2) Insert a 1.2" x 6" **clevis pin** (23-112-024) through the aligned pin holes.

3) Insert a **cotter pin** (65073) through the small hole in the end of the **clevis pin**. Bend the arms of the cotter pin in opposite directions around the clevis pin.

4) The bollard can be pinned in any of 3 positions: upright (deployed) or laid flat in either direction. Simply insert the remaining **clevis pin** (23-112-024) through the appropriate pin holes to pin the bollard in the desired configuration. In the diagrams below, the second clevis pin is installed through the upper pins holes which deploys the bollard (upright). Install the **hitch pin** (45281) through the small pin hole at the end of the clevis pin.

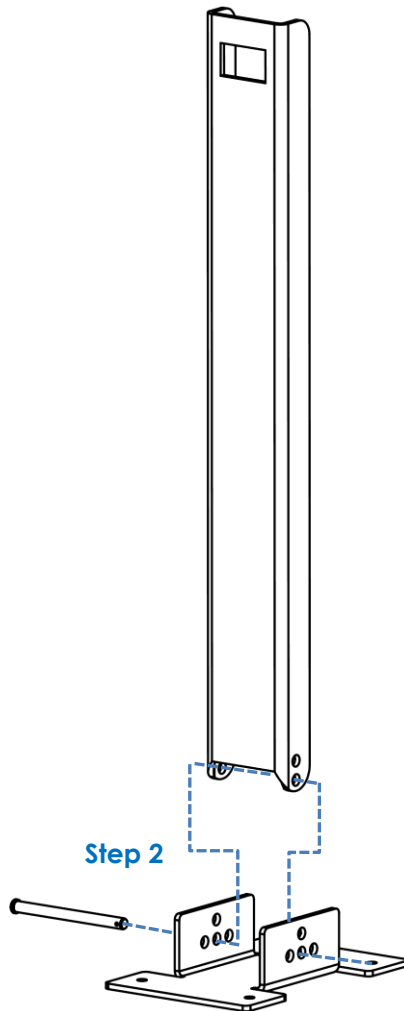

Step 2

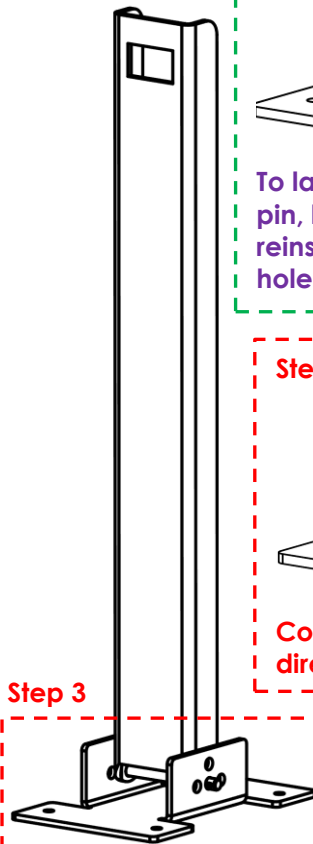

Step 3

Step 4: Install second clevis pin & hitch pin.

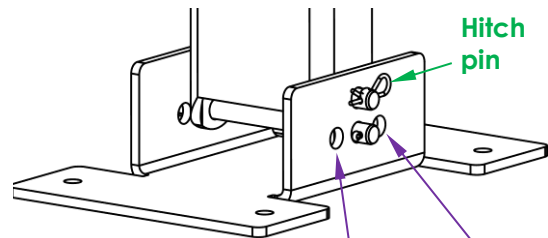

To lay bollard flat, remove second clevis pin, lower bollard in either direction, and reinstall second clevis pin through aligned holes + hitch pin.

Step 3

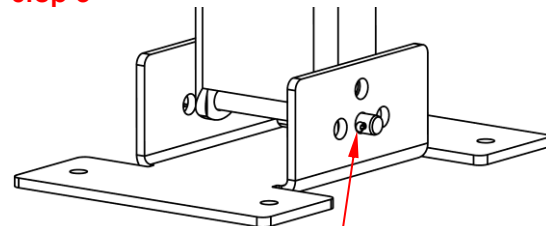

Cotter pin: Bend arms in opposite directions around end of clevis pin.

## RECORD OF SATISFACTORY CONDITION (the "RECORD")

After installing the bollard, make a record of its appearance. Describe in writing the condition of the bollard, anchoring hardware and the anchoring surface around the bollard, pins and pinholes (if applicable), as well as the location of each label, tag, decal, etc. Take photographs of all elements: mounting plate, bollard body, pins, and label(s). Collect your photos and writings in a file. **This file is a record of the unit in satisfactory condition.**

## INSPECTING AND MAINTAINING THE BOLLARD

Compare your observations to your [RECORD](#) to determine whether the bollard is in satisfactory condition. Remove the bollard from service unless every component is in satisfactory condition. Cosmetic changes, like recently damaged paint/powder coat, are not changes from satisfactory condition. However, touchup paint must be applied to all affected areas as soon as damage occurs. Exposed metal rusts and rust could compromise the integrity of the metal. Contact [TECHNICAL SERVICE](#) to order replacement parts. Contact information appears on the cover page of this instruction manual.

At least once per month:

1. Check the surface of the product for dirt or other matter. **Clean the bollard** with a mild soap and water solution.
2. Examine **anchoring hardware**. Replace damaged, worn, or corroded hardware. Confirm that the bollard is solidly anchored to the ground surface (concrete). Replace all anchoring hardware that is not able to be solidly attached to the ground. If the bollard wobbles, tighten loose anchor bolts. Install the bollard in another location if wobble cannot be eliminated in the current location by applying the [INSTALLING THE BOLLARD](#) instructions on p. 4.
3. Check all labeling. Replace labels that are damaged or not easily readable. See [LABELING DIAGRAM](#) (below).
4. Examine the whole structure for significant rusting, metal erosion, rot, etc. If rusting is purely superficial, remove the rust/corrosion with a steel bristle brush or steel wool. Clean the affected area and apply touchup paint. Contact the [TECHNICAL SERVICE](#) department to discuss any questions you have regarding the condition of your bollard.

## LABELING DIAGRAM

Label content and location are subject to change so your product might not be labeled exactly as shown. Compare the diagram below with your [RECORD](#). If you have any questions about how your bollard is labeled, contact the [TECHNICAL SERVICE](#) department. Replace all labels that are damaged, missing, or not easily readable (e.g. faded). To order replacement labels, contact the technical service and parts department online at <https://www.vestil.com/page-parts-request.php>. Alternatively, request replacement parts and/or service by calling (260) 665-7586 and asking the operator to connect you to the [TECHNICAL SERVICE](#) department.

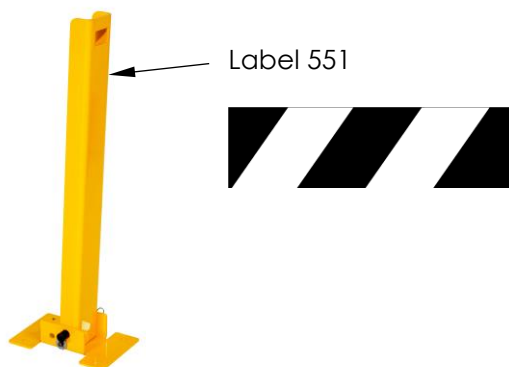



## LIMITED WARRANTY

Vestil Manufacturing Company ("Vestil") warrants this product to be free of defects in material and workmanship during the warranty period. Our warranty obligation is to provide a replacement for a defective, original part covered by the warranty after we receive a proper request from the Warrantee (you) for warranty service.

### Who may request service?

Only a warrantee may request service. You are a warrantee if you purchased the product from Vestil or from an authorized distributor AND Vestil has been fully paid.

### Definition of "original part"?

An original part is a part used to make the product as shipped to the Warrantee.

### What is a "proper request"?

A request for warranty service is proper if Vestil receives: 1) a photocopy of the [Customer Invoice](#) that displays the shipping date; AND 2) a [written request](#) for warranty service including your name and phone number. Send requests by one of the following methods:

<a href="#">US Mail</a>	<a href="#">Fax</a>	<a href="#">Email</a>
Vestil Manufacturing Company	(260) 665-1339	<a href="mailto:info@vestil.com">info@vestil.com</a>
2999 North Wayne Street, PO Box 507	<a href="#">Phone</a>	Enter "Warranty service request"
Angola, IN 46703	(260) 665-7586	in subject field.

In the written request, list the parts believed to be defective and include the address where replacements should be delivered. After Vestil receives your request for warranty service, an authorized representative will contact you to determine whether your claim is covered by the warranty. Before providing warranty service, Vestil will require you to send the entire product, or just the defective part (or parts), to its facility in Angola, IN.

### What is covered under the warranty?

The warranty covers defects in the following original, dynamic parts: motors, hydraulic pumps, motor controllers, and cylinders. It also covers defects in original parts that wear under normal usage conditions ("wearing parts"), such as bearings, hoses, wheels, seals, brushes, and batteries.

### How long is the warranty period?

The warranty period for original dynamic components is 90 days. For wearing parts, the warranty period is 90 days. Both warranty periods begin on the date Vestil ships the product to the Warrantee. If the product was purchased from an authorized distributor, the periods begin when the distributor ships the product. Vestil may, at its sole discretion, extend a warranty period for products shipped from authorized distributors by up to 30 days to account for shipping time.

### If a defective part is covered by the warranty, what will Vestil do to correct the problem?

Vestil will provide an appropriate replacement for any covered part. An authorized representative of Vestil will contact you to discuss your claim.

### What is not covered by the warranty?

The Warrantee (you) are responsible for paying labor costs and freight costs to return the product to Vestil for warranty service.

### Events that automatically void this Limited Warranty.

- Misuse;
- Negligent assembly, installation, operation or repair;
- Installation/use in corrosive environments;
- Inadequate or improper maintenance;
- Damage sustained during shipping;
- Collisions or other accidents that damage the product;
- Unauthorized modifications: Do not modify the product IN ANY WAY without first receiving written authorization from Vestil.

### Do any other warranties apply to the product?

Vestil Manufacturing Co. makes no other express warranties. All implied warranties are disclaimed to the extent allowed by law. Any implied warranty not disclaimed is limited in scope to the terms of this Limited Warranty. Vestil makes no warranty or representation that this product complies with any state or local design, performance, or safety code or standard. Noncompliance with any such code or standard is not a defect in material or workmanship.