

TOOL CART (TC310)

ASSEMBLY INSTRUCTIONS

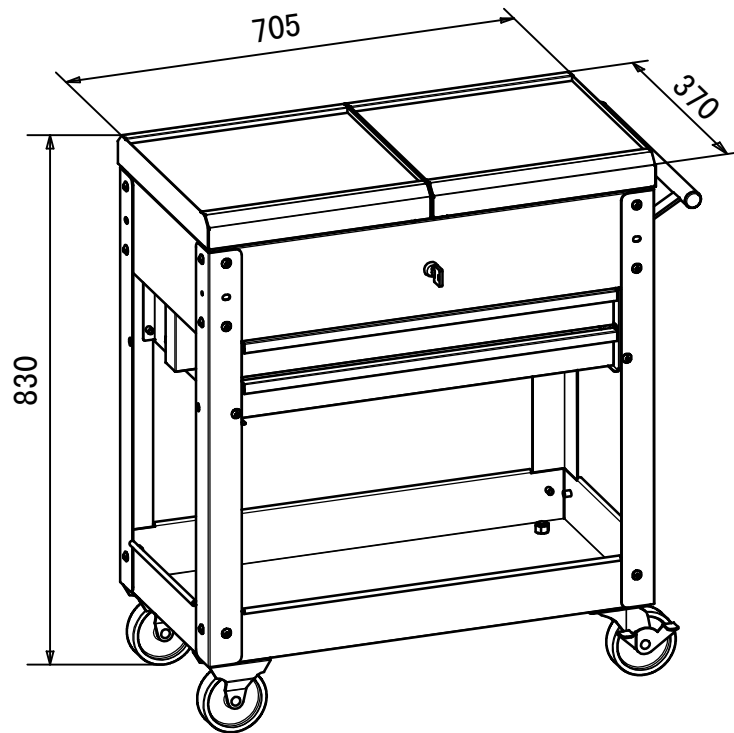

PARTS LIST

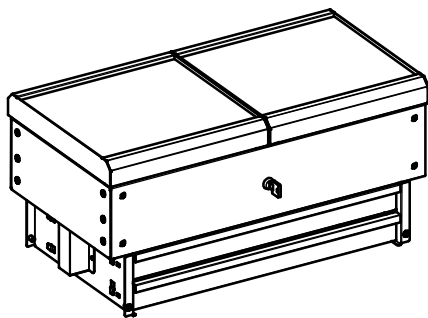

A) UPPER TRAY WITH 2 RUBBER LINERS
1PC

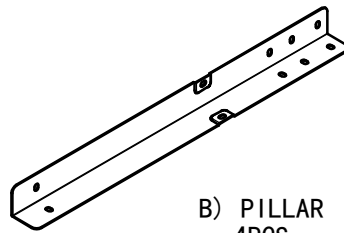

B) PILLAR
4PCS

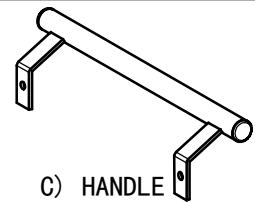

C) HANDLE
1PC

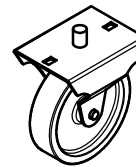

E) RIGID CASTER
2PCS

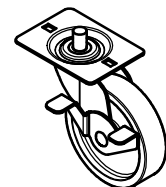

F) SWIVEL CASTER
2PCS

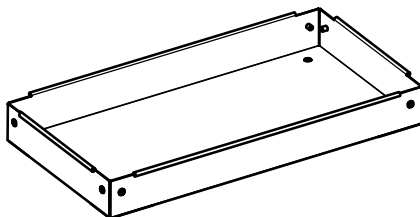

D) BOTTOM TRAY
1PC



G) BOLT M6X12
(30+2) PCS



H) NUT M12
4PCS

ATTENTION:

1. Before open the drawer, you may first open the sliding tops. And the inverse step is necessary when locking the drawer.
2. Only one drawer can be pull out at one time, or the cart may tip. Before pull out one drawer, make sure the other one has been pushed fully in.
3. Don't put heavy load on the drawer when it's open. The cart may tip.
4. Each drawer load is 8kg, upper tray load is 40kg, bottom tray load is 40kg, total load is 100kg. Never exceed the load capacity or the product may be damaged.

1

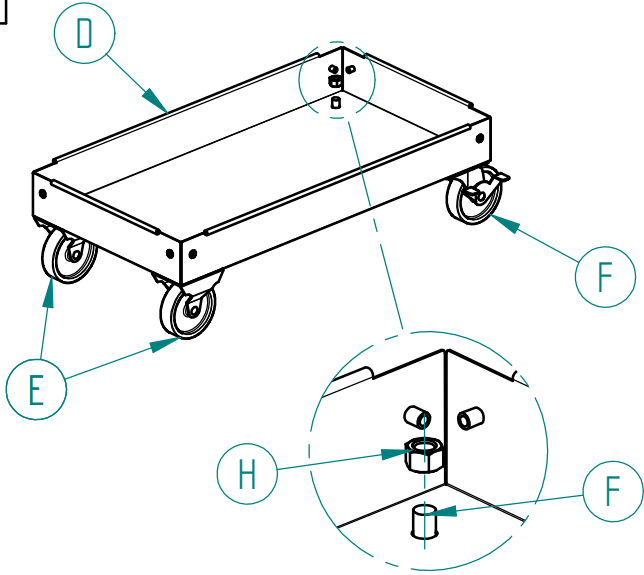

Note: Always put the same casters on one side.

2

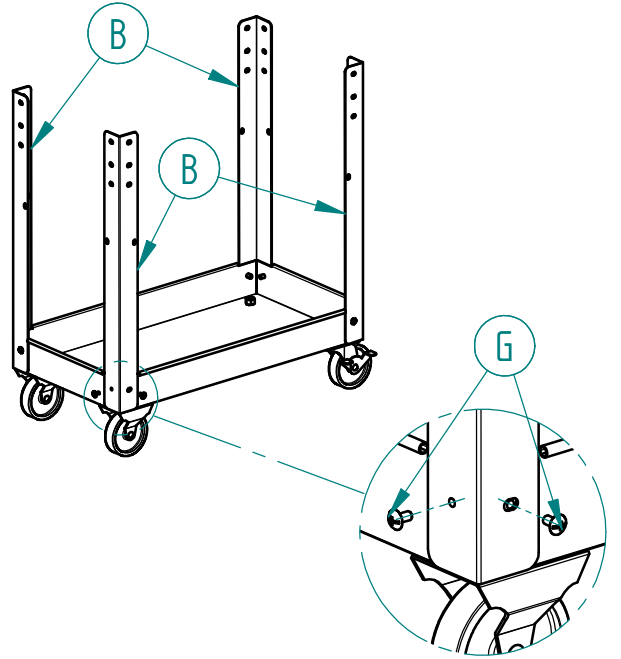

3

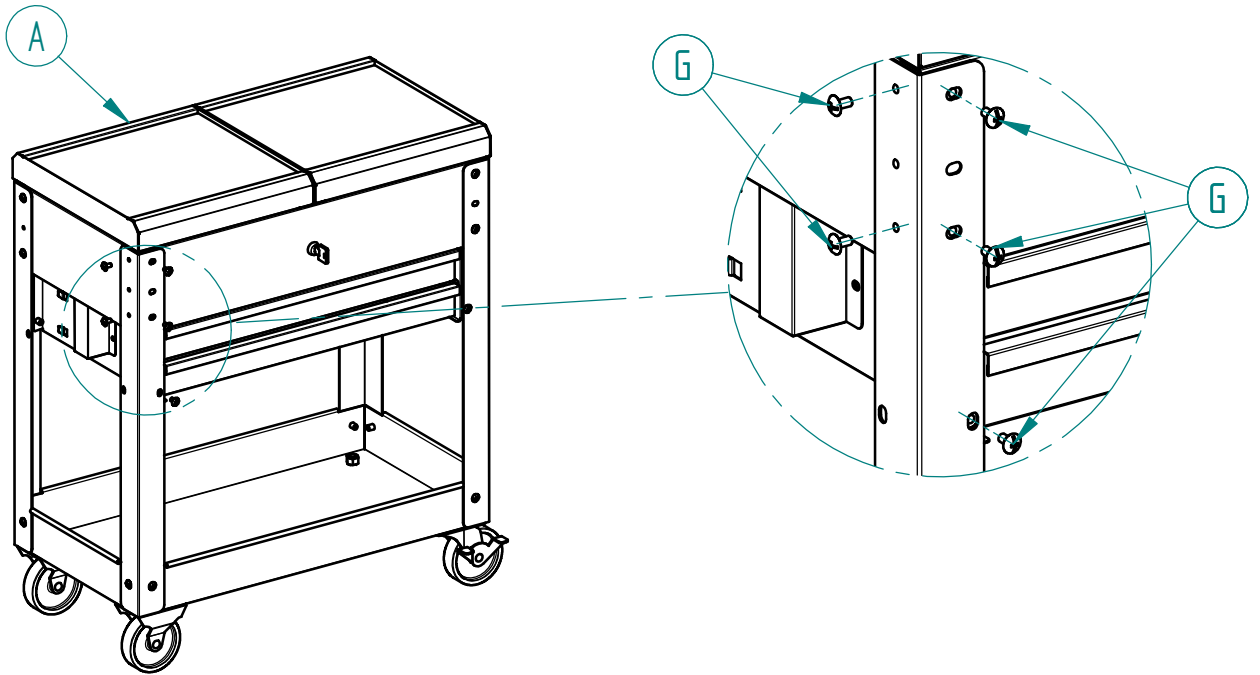

4

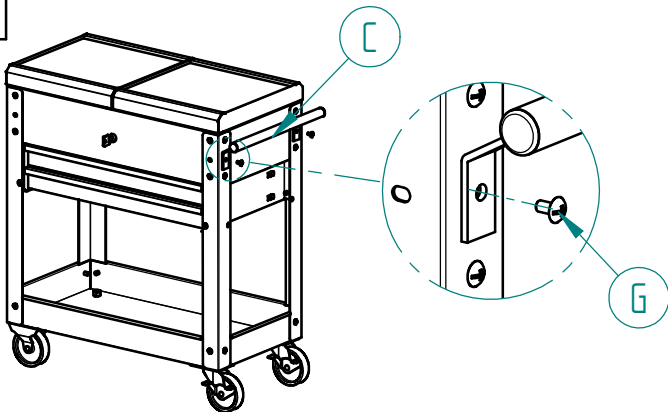

Handle can be attached on each side.

5

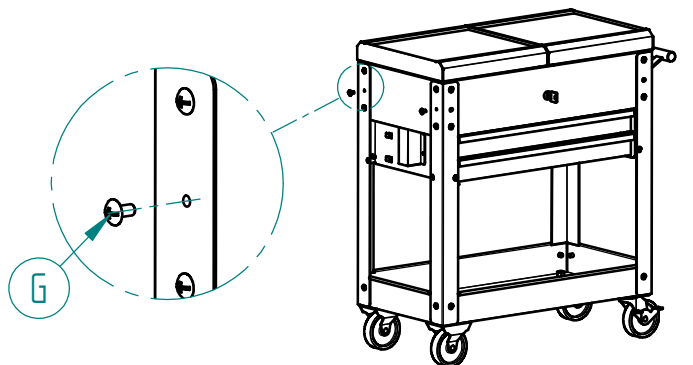

Here 2pcs screw are spare parts for you.