

Owner's Manual



The **NOMAD**[™] Economy Welding Table

Part No. TS3020

Contents:

- » Parts List
- » Assembly Instructions
- » Adjustments
- » Maintenance
- » Safety
- » Warranty



Specifications:

Part No.	Tabletop Size	Table Height Range	Slots in Tabletop	Table Positions	Load Capacity	Weight
TS3020	30" W x 20" L (760 x 510 mm)	26" ~ 32" (660 ~ 810 mm)	1.1" (28 mm)	Horizontal, 30°, Folded	350 lbs. (160 kg)	43 lbs. (20 kg)

Parts List

Part No. TS3020
NOMAD™ Economy Welding Table

Item	Qty	Item	Qty		
A	Steel Table Top (30" x 20")	1	M2	Caster Mounting Bracket	2
B	Table Leg Assembly	1	N	Guide Rail, 30"	1
C	Table Leg with Tool Shelf	1	O	Guide Rail, 20"	1
C1	Eccentric Leveling Foot	1	P	Lock Lever	4
U	Pull Handle	1	T	Crossbar	1
V	Compress Spring	2	Q1	Pan Head Screw 6mm x 40mm	6
D	Joint	2	Q2	Hex Head Bolt 8mm x 20mm	4
E	Height Adjustment Post	2	Q3	Hex Head Bolt 8mm x 40mm	2
F	Angle Adjustment Plate	2	Q4	Hex Head Bolt 8mm x 50mm	4
G	Locking Handle	2	Q5	Hex Head Bolt 8mm x 55mm	2
H	Locating Washer	2	R1	Lock Nut 6mm	6
I	Square Nut Holder	2	R2	Lock Nut 8mm	8
J	Square Nut M8	2	R3	Hex Nut 8mm	6
K	Locating Pin	2	S1	Washer 6mm	10
L	Plastic Knob	2	S2	Washer 8mm	14
M1	Caster	2			

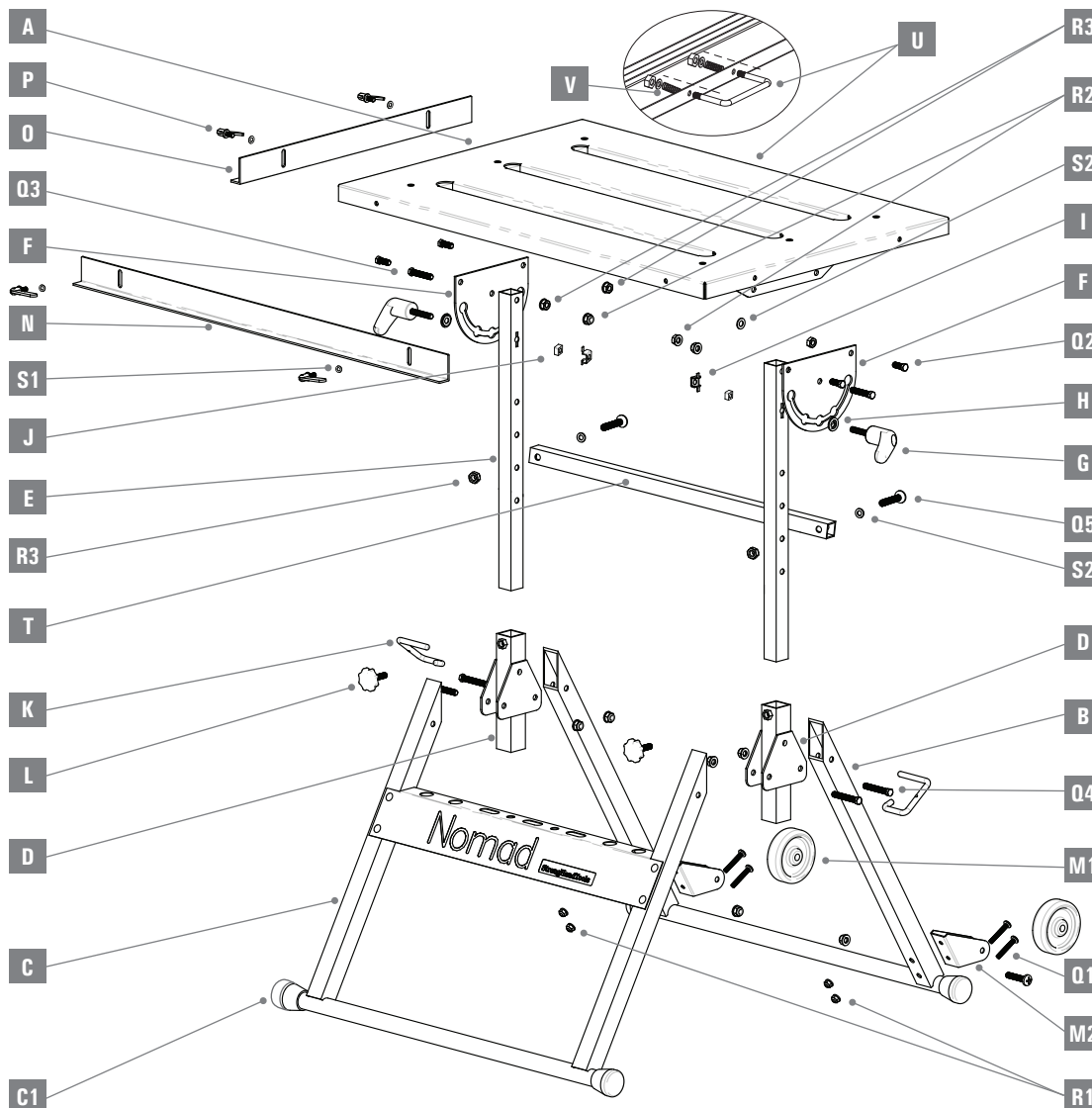

Assembly Instructions

Part No. TS3020
NOMAD™ Economy Welding Table

» Tools required for assembly : wrenches, phillips screwdriver and pliers.

Setting up the Leg Assembly (Fig. 1-6)

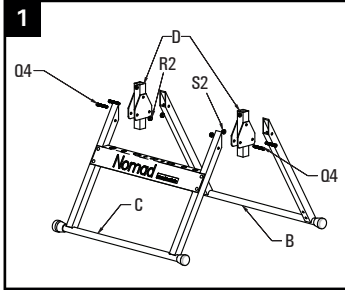

1. Place the Leg Assembly (**B & C**) onto the Joint (**D**) and fasten with the 8mm x 50mm Hex Head Bolts (**Q4**). Do not over-tighten and make sure the leg assembly is free to pivot.

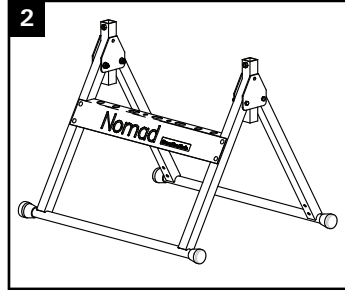

2. Slightly open the Table Legs.

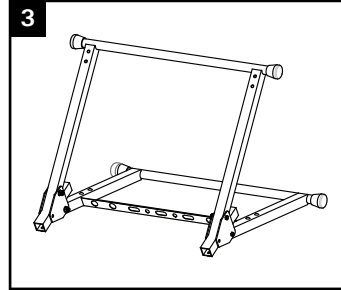

3. Position the Leg Assembly on its side to attach the Casters.

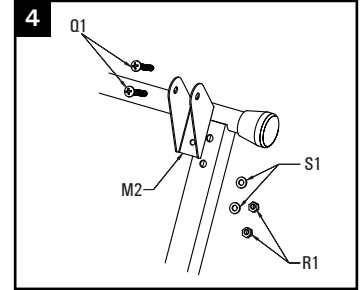

4. Mount the Casters Brackets (**M2**) on Table Leg Assembly (**B**) using two 6mm x 40mm Pan Head Screws (**Q1**), and two 6mm Lock Nuts (**R1**). Repeat on the other side.

Setting up the Leg Assembly (Fig. 1-6)

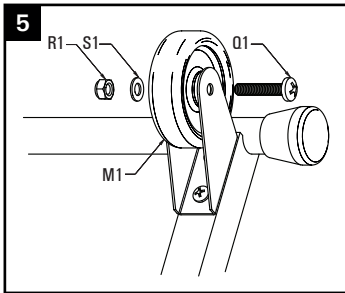

5. Attach the Casters (**M1**) onto the brackets using the 6mm x 40mm Pan Head Screws (**Q1**), and one 6mm Lock Nut (**R1**) and one 6mm Washer (**S1**).

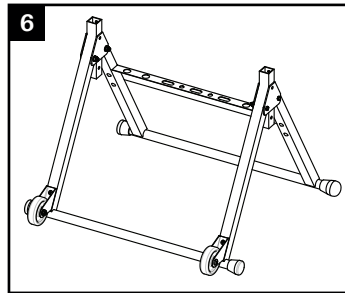

6. Make sure wheels can spin freely and repeat on other side. Position the leg assembly right side up to attach the Height Adjustment Posts.

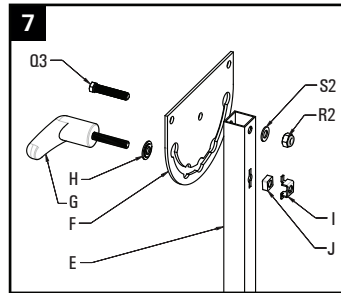

7. Attach Angle Adjustment Plate (**F**) to the Height Adjustment Post (**E**) using one 8mm x 40mm Hex Head Bolt (**Q3**), one 8mm Washer (**S2**) and one 8mm Lock Nut (**R2**).

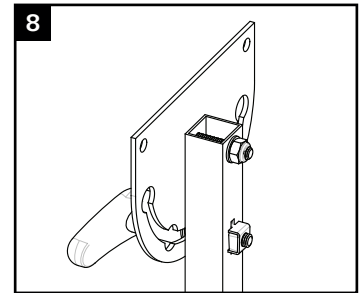

8. Attach Locking Handle (**G**) to Angle Adjustment Plate (**F**) using one Locating Washer (**H**), one 8mm Square Nut (**J**) and one Square Nut Holder (**I**).

Height Adjustment Post (Fig. 7-11)

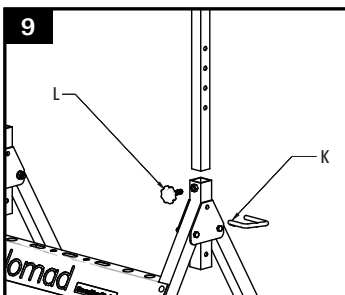

9. Insert the Height Adjustment Post through the Joint (**D**) and secure with Locking Pin (**K**) and the Plastic Knob (**L**).

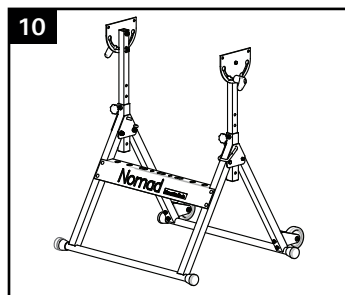

10. Repeat on the other side and tighten all screws. Make sure both height posts are at the same height.

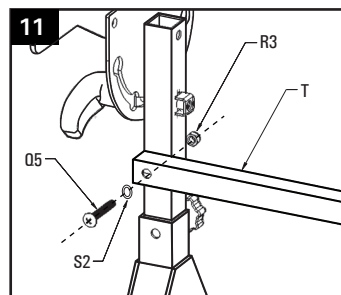

11. Install Crossbar (**T**) using one 8mm x 55mm Hex Head Bolt (**Q5**), 8mm Washer (**S2**) and 8mm Hex Nut (**R3**). Repeat on the other side and tighten bolts.

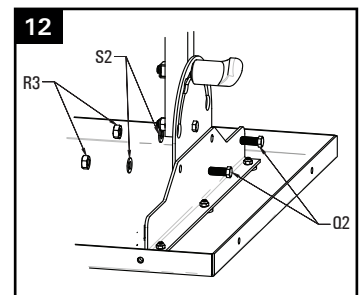

12. Place Table Top upside down. Install Angle Adjustment Plates using two 8mm x 20mm Hex Head Bolts (**Q2**) and 8mm Hex Nuts (**R3**). Tighten screws.

Installing Tabletop

Instructions and Adjustments

Part No. TS3020
NOMAD™ Economy Welding Table

» Tools required for assembly : wrenches, phillips screwdriver and pliers.

Installing Tabletop and Steel Guide Rails (Fig. 12-15)

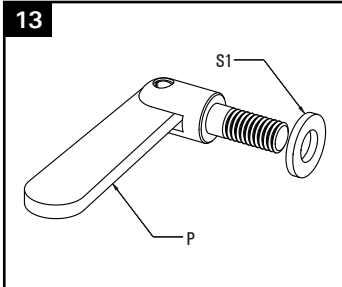

13. Carefully turn entire Table Top assembly right side up. Place the 6mm Washer (**S1**) on the threaded stud of the Lock Lever (**P**). Repeat on all four Lock Levers.

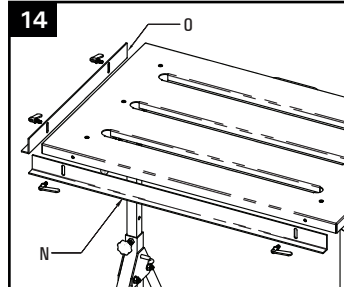

14. Attach the Guide Rails (**N & O**) to the table using the Lock Levers (**P**).

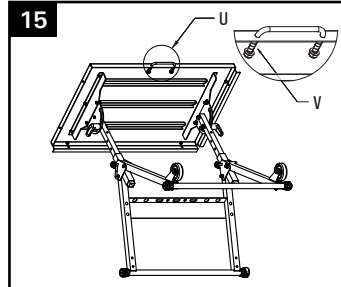

15. Insert the Pull Handle (**U**) into the holes located on the 30" side of the tabletop. Fasten to the tabletop using the Springs (**V**), 8mm Washers (**S2**) and 8mm Lock Nuts (**R2**), and tighten.

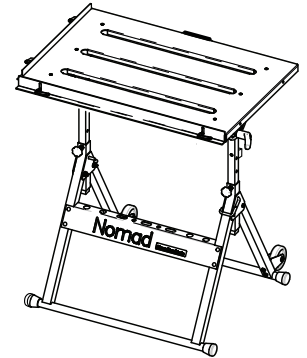

The Nomad Economy Welding Table now is fully assembled.

Storing and Adjusting the Nomad Economy Welding Table

Moving the Table

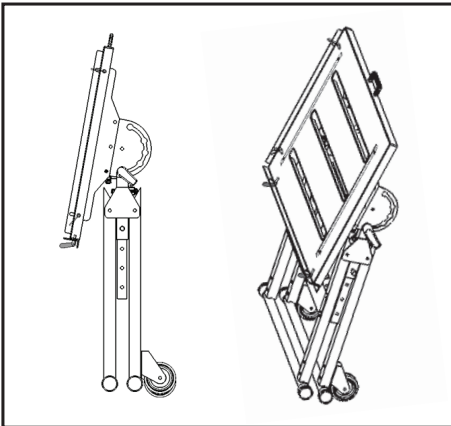

Loosen Locking Handle. Fold tabletop down to completely vertical position. Push legs in to closed position. Lean the table back on the two casters, and use the pull handle to move the table.

Adjusting the Table Height

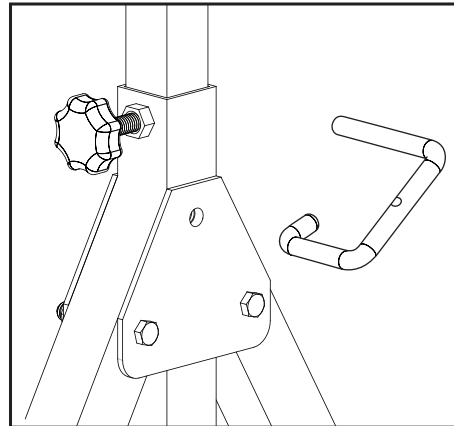

Loosen Plastic Knobs (**L**). Remove Locating Pins (**K**). Grasp tabletop and lift (evenly) to desired height. Re-insert Locating Pins and tighten Plastic Knobs.

Stabilizing the Table

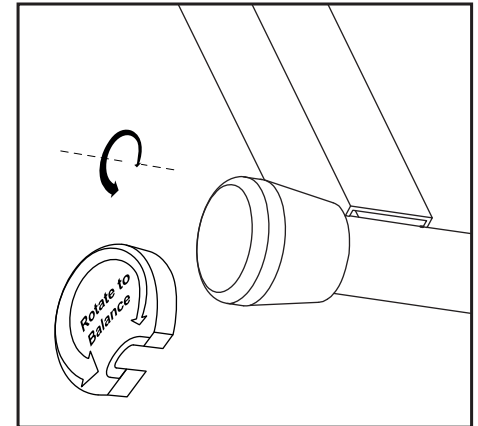

Adjust cam operated Eccentric Leveling Foot (**C1**) for stabilizing the table on uneven surfaces! Turn the wheel clockwise to elevate, and counterclockwise to lower the table.

Maintenance

Keep the table clean for optimal performance. Wipe away dust and debris from the tabletop and legs.

Safety

ALWAYS wear safety goggles, gloves, and other appropriate safety items for protection. Use the table only for its intended purpose. NEVER stand on the table. Do not drop the table, throw it, or otherwise misuse the table.

Limited 1 Year Warranty

Each STRONG HAND TOOL® product is warranted to be free from defects in material and workmanship. Return to place of purchase for a replacement if warranty applies.

StrongHandTools
Better Tools. Better Price.

Nomad Extended Table Assembly Instructions

Part No. 37898-2456

» Tools required for assembly : wrenches, phillips screwdriver and pliers.

Installing Connector Plate for Extended Table Assembly

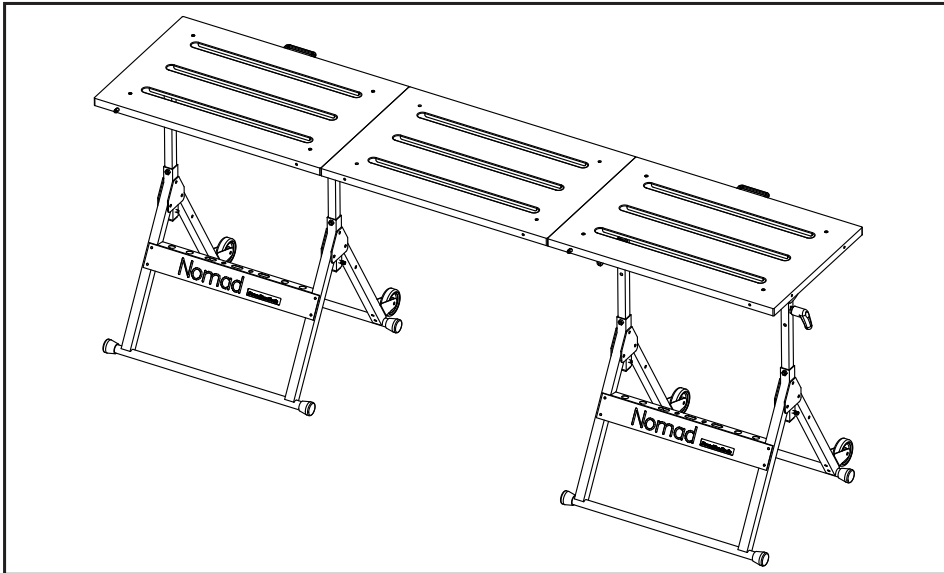

Join two standard Nomad Welding Tables (Part No. TS3020) with one Nomad Connector Plate (Part No. TSL30) to create a 90" L x 20" D Welding Table to work on large projects, or multiple projects.

Hold the Nomad Connector Plate against the 20" side of one fully assembled Nomad Table. Align mounting holes on the Nomad Table and Connector Plate. Fasten the Connector Plate to the Table using two of each: 6 mm screws, spring lock washers, and plain washers. [place spring lock washer on the screw first, then plain washer] Fasten the other side of the Connector Plate to the second fully assembled Nomad Table using the remaining 6 mm screws, spring lock washers and plain washers.

Nomad 6 pc. Clamping Kit

The Nomad 6 pc. Clamping Kit included with the Extended Nomad Table Assembly contains essential tools for setting-up, postioning, locating, and clamping stock before tack welding.

MagSpring Clamps x 2

The Spring-loaded Clamp with quick-set magnetic V-Pad!

Quick and Easy to Use! Squeeze to open, Set in place, Turn T-Handle to tighten.

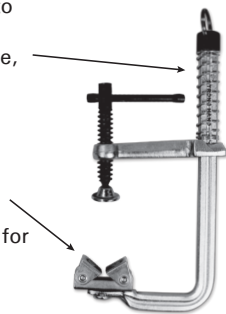

The Adjustable Magnetic V-Pad instantly adjusts for different shapes: round, flat, and angled steel.

Multi-Angle Magnets

Hold stock at accurate multiple angles while soldering brazing, and welding at: 30°, 45°, 60°, 90°.



Center hole makes it easy to handle and remove magnets.



Adj. Magnetic V-Pads x 2

Light Duty and Tight Spot Holding!

Hold and position round, flat, square, and angled stock in light duty substructure applications.

V-Pads contain strong rare earth disc magnets. Hold tabs, or small metal pieces or plates. Use as a rest for round stock.

Ideal for use in tight spots, or for holding at add angles.

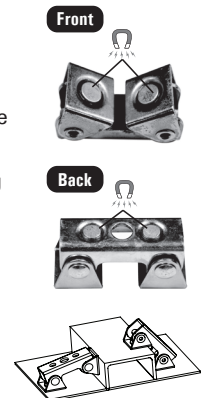

StrongHandTools®
Better Tools. Better Price.