

# **ULTRA-TOW™**

## **Motorcycle Trailer Rail Kit OWNER'S MANUAL**



### **WARNING:**

Read carefully and understand all **ASSEMBLY AND OPERATION INSTRUCTIONS** before operating. Failure to follow the safety rules and other basic safety precautions may result in serious personal injury.

**Item# 365405**

Thank you very much for choosing an Ultra-Tow™ product. For future reference, please complete the owner's record below:

Model: \_\_\_\_\_ Purchase Date: \_\_\_\_\_

Save the receipt, warranty and these instructions. It is important that you read the entire manual to become familiar with this product before you begin using it.

This product is designed for certain applications only. The distributor cannot be responsible for issues arising from modification. We strongly recommend this product not be modified and/or used for any application other than that for which it was designed. If you have any questions relative to a particular application, DO NOT use this product until you have first contacted the distributor to determine if it can or should be performed on the product.

For technical questions please call **1-800-222-5381**.

## INTENDED USE

The motorcycle rail system offers superior stability for transporting motorcycles on trailers. This unit can be mounted to any existing trailer bed, converting it to a motorcycle trailer. Works great with enclosed and flatbed trailers (snowmobile or utility trailers). This unit can be removed when not in use allowing your trailer to be multi-purpose.

## TECHNICAL SPECIFICATIONS

|  |   |
|--|---|
| TIRE SIZES – Front:                    | Up to 5in. (12.7cm) wide                            |
| TIRE SIZES – Rear:                     | Up to 8in. (20cm) wide                              |
| Rail Specification:                    | 96in. (244cm) long<br>1.1875in. square steel tubing |
| Mounts for securing to trailer bed     | 4 locations   |
| Tie-down rings for securing motorcycle | 4   |
| Finish                                 | Powder coat   |

## GENERAL SAFETY RULES



**WARNING:** Read and understand all instructions. Failure to follow all instructions listed below may result in serious injury.



**CAUTION:** Do not allow persons to operate or assemble this motorcycle rail kit until they have read this manual and have developed a thorough understanding of how the motorcycle rail kit works.



**WARNING:** The warnings, cautions, and instructions discussed in this instruction manual cannot cover all possible conditions or situations that could occur. It must be understood by the operator that common sense and caution are factors which cannot be built into this product, but must be supplied by the operator.

## SAVE THESE INSTRUCTIONS

## WORK AREA (During assembly and use)

- **Keep work area clean**, free of clutter and well lit. Cluttered and dark work areas can cause accidents.
- **Keep children and bystanders** away while assembling or installing the motorcycle rail kit. Distractions can cause you to lose control, so visitors should remain at a safe distance from the work area.
- **Be aware of all power lines, electrical circuits**, water pipes and other mechanical hazards in your work area, particularly those hazards below the work surface hidden from the operator's view that may be unintentionally contacted and may cause personal harm or property damage.
- **Be alert of your surroundings**. Assembling or installing the motorcycle rail kit in confined work areas may put you in a dangerous situation.

## PERSONAL SAFETY

- **Stay alert**, watch what you are doing and use common sense when using the motorcycle rail kit. Do not use the motorcycle rail kit while you are tired or under the influence of drugs, alcohol or medication. A moment of inattention while operating the motorcycle rail kit may result in serious personal injury.
- **Dress properly**. Do not wear loose clothing, dangling objects, or jewelry. Keep your hair, clothing and gloves away from moving parts. Loose clothes, jewelry or long hair can be caught in moving parts.
- **Use safety apparel and equipment**. Use safety goggles or safety glasses with side shields which comply with current national standards, or when needed, a face shield. Use a dust mask in dusty work conditions. This applies to all persons in the work area. Also use non-skid safety shoes, hardhat, gloves, dust collection systems, and hearing protection when appropriate.
- **NEVER** tie-down handlebars if they are rubber mounted or not firmly attached to the front end.
- **NEVER** use rear bag guards to tie-down the motorcycle. They can be pulled off of the bike.
- **NEVER** use a cover on your motorcycle when towing it on an open trailer. Grit and tiny movements of the cover can "scratch" the paint right off of your motorcycle.
- **ALWAYS** use high quality tie-down straps when securing your motorcycle. The price to repair your bike will be far greater than the money saved buying economy straps.
- **NEVER** transport motorcycles with this unit unless all 4 mounting points are secured to the trailer bed with proper fasteners and hardware that can support the weight of your motorcycle.
- **NEVER** transport motorcycles that have low tires.
- **NEVER** fasten motorcycle rail kit to a trailer that has a tire distance less than 48" wide.

## MOTORCYCLE RAIL KIT USE AND CARE

1. **Do not modify the motorcycle rail kit in any way**. Unauthorized modification may impair the function and/or safety and could affect the life of the equipment. There are specific applications for which the motorcycle rail kit was designed.
2. **Always check for damaged or worn out parts before using the motorcycle rail kit**. Broken parts will affect the motorcycle rail kit operation. Replace or repair damaged or worn parts immediately.
3. **Do not exceed trailer load capacity**. Always check your trailer mfg. specifications for load and weight limits before hauling with this product.
4. **Distribute the load evenly**. Uneven loads may cause the motorcycle to tip, resulting in personal injury to the operator or others.

5. **Use the motorcycle rail kit on flat and level surfaces** capable of supporting the motorcycle rail kit. Pulling or pushing a load on slanted or uneven surfaces can result in loss of control.
6. **Storing motorcycle rail kit.** When the motorcycle rail kit is not in use, store it in a secure place out of the reach of children. Inspect it for good working condition prior to storage and before re-use.
7. **Always** - Make sure to position the rail kit and motorcycle to ensure that there is enough tongue weight on the trailer.
8. **Always** - Make sure when mounting rail kit to a tilt bed trailer, to position the rail kit so the trailer bed does not tilt before the rear wheel of the motorcycle has come onto the trailer bed.
9. **Always** - Make sure all loading channels and or locking pins are secured before road travel.
10. **Notice** - When transporting one bike on a double trailer set up, reposition one of the rail kits to the center of the trailer bed.
11. **Always** - Make sure to secure the motorcycle using at least 4 ratcheting tie-down straps of proper size and capacity. Note this rail kit is equipped with 4 tie-down lugs.

## ASSEMBLY

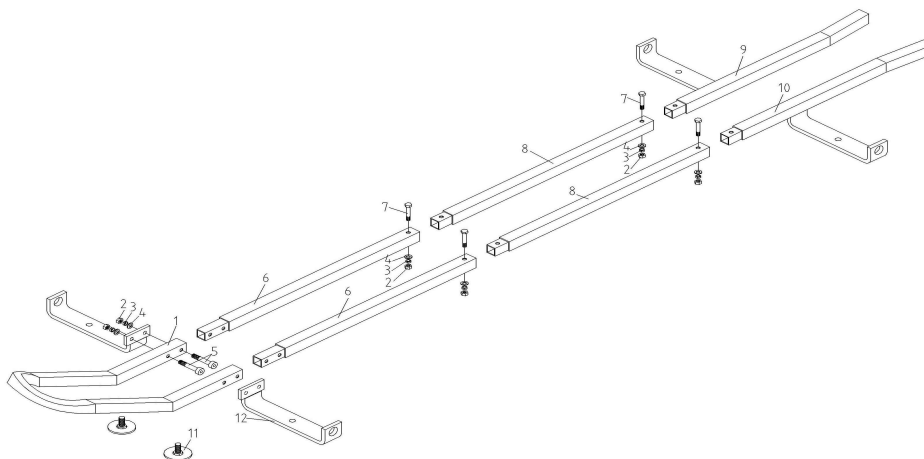

1. Place the Chock Head (1), Front Rails (6), Middle Rails (8), Right Rear Rail (9), Left Rear Rail (10) and Tie-down Lugs (12) on a clean hard flat surface.
- SEE DRAWING ABOVE FOR STEPS 2 to 5:
2. Insert Front Rails (6) into the Chock Head (1), align the holes on Front Rails (6), Chock Head (1) and Tie-down Lugs (12) and secure them with Nuts (2), Lock Washers (3), Washers (4) and Bolts (5).
  3. Insert Middle Rails (8) into Front Rails (6) and secure them with Nuts (2), Lock Washers (3), Washers (4) and Bolts (7).
  4. Insert Right Rear Rail (9) and Left Rear Rail (10) into Middle Rails (8) and secure them with Nuts (2), Lock Washers (3), Washers (4) and Bolts (7).
  5. Screw Adjusting Stands (11) under Chock Head (1) up or down, making sure Adjusting Stands (11) and Tie-down Lugs (12) are at the same level.

## OPERATION

### Mounting Procedure

1. Measure where you want to place the unit when mounted on trailer or pickup bed from the front portion where the Motorcycle front tire will be located. Make sure the unit will be mounted in the center of the trailer bed.
2. Use the unit as a template to mark and drill holes through the Trailer or pickup bed. Secure the unit with proper bolts with large flat washers on both ends and lock nuts. (mounting bolts, washers and nuts are not included). If possible, try to add a cross member (steel bar or sheet) under the trailer or pickup bed where holes are to be drilled.

### Step By Step Motorcycle Tie-down Procedure

1. Use 4 high quality ratchet straps (not included). Attach to the tie-down hooks into the tie-down Lugs (12). Place back straps in a position where they can be reached from the seat of the motorcycle.
2. If you are loading two motorcycles and the handlebars or accessories appear to conflict, try reversing one of the bikes position on the trailer.
3. Push the motorcycle slowly onto the trailer. Insure that the bike is straight in the rail and wheel chock. Then, while sitting on the bike attach the rear tie-down straps and tighten until the bike is firmly in place. Get off the bike and attach the front tie-down straps so that the bike is securely in place. When you are finished the bike should be completely upright and straight. Test tie-downs by shaking or moving the bike. This should only cause the trailer to move and very little bike movement.

## MAINTENANCE

- **Maintain your motorcycle rail kit.** It is recommended that the general condition of any motorcycle rail kit be examined before it is used. Keep your motorcycle rail kit in good repair by adopting a program of conscientious repair and maintenance. If any abnormal vibrations or noise occurs, have the problem corrected before further use. Have necessary repairs made by qualified service personnel.

# DIAGRAM & PARTS LIST

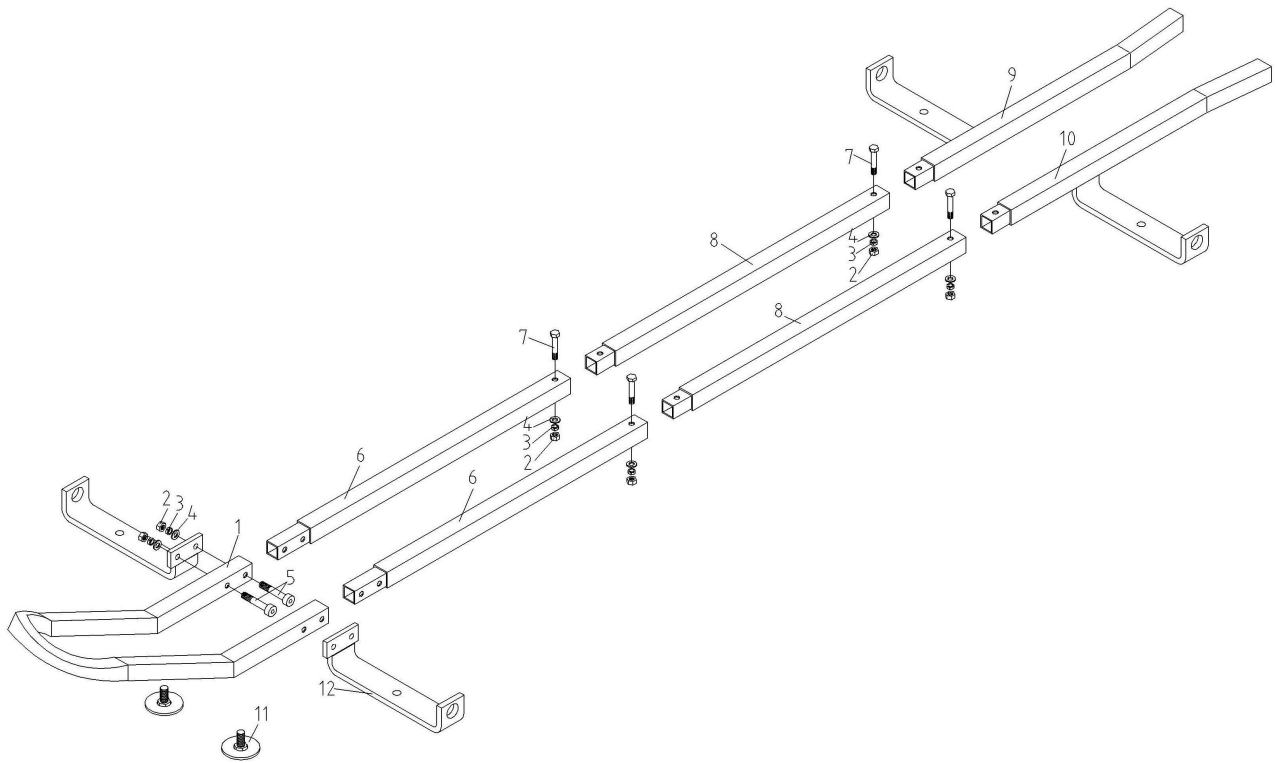

## PARTS LISTING:

| No. | Description   | Qty | No. | Description                     | Qty |
|-----|---------------|-----|-----|---------------------------------|-----|
| 1   | Chock Head    | 1   | 7   | Bolt                            | 4   |
| 2   | Nut           | 8   | 8   | Middle Rail                     | 2   |
| 3   | Spring Washer | 8   | 9   | Right Rear Rail w/ Tie Down Lug | 1   |
| 4   | Washer        | 8   | 10  | Left Rear Rail w/ Tie Down Lug  | 1   |
| 5   | Bolt          | 4   | 11  | Adjusting Stand                 | 1   |
| 6   | Front Rail    | 2   | 12  | Tie Down Lugs                   | 2   |

For replacement parts and technical questions, please call **1-800-222-5381**.

## WARRANTY

One-year limited warranty

**ULTRA-TOW™**

Distributed by  
Northern Tool + Equipment Co., Inc.  
Burnsville, Minnesota 55306-6936  
Made in CHINA