

# **ULTRA-TOW™**

## **SPARE TIRE CARRIER**

### **OWNER'S MANUAL**

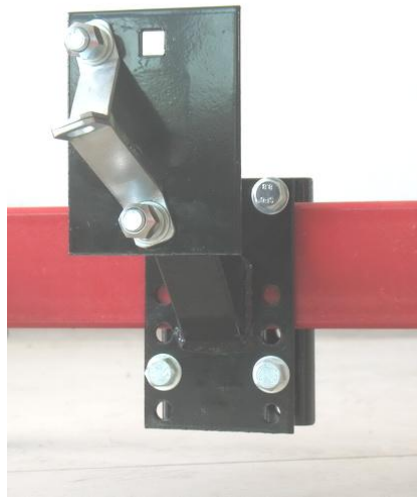

#### **WARNING:**

Read carefully and understand all **ASSEMBLY AND OPERATION INSTRUCTIONS** before operating. Failure to follow the safety rules and other basic safety precautions may result in serious personal injury.

**Item# 365371**

Thank you very much for choosing an ULTRA-TOW™ Product! For future reference, please complete the owner's record below:

Model: \_\_\_\_\_ Purchase Date: \_\_\_\_\_

Save the receipt, warranty and these instructions. It is important that you read the entire manual to become familiar with this product before you begin using it.

This product is designed for certain applications only. The manufacturer cannot be responsible for issues arising from modification. We strongly recommend this product not be modified and/or used for any application other than that for which it was designed. If you have any questions relative to a particular application, DO NOT use this product until you have first contacted the manufacturer to determine if it can or should be performed on the product.

For technical questions please call **1-800-222-5381**.

## INTENDED USE

The ULTRA-TOW Spare Tire Carrier fits most trailer tongues up to 3in. wide and 4in. high and will accept both 4- and 5-lug wheels with 4in. and 4.5in. bolt patterns. Easily mounts spare tire up and away from the trailer.

## TECHNICAL SPECIFICATIONS

**Construction:** Heavy-duty welded steel

**Overall Dimensions:** 13in.L x 4in.W x 6 1/4in.H (33 x 10 x 16cm)

**Pre-drilled holes:** 7/16in. (11mm)

**Maximum Weight Capacity:** 100 lbs. (45kg)

## GENERAL SAFETY RULES



**WARNING:** Read and understand all instructions. Failure to follow all instructions listed below may result in serious injury.



**CAUTION:** Do not allow persons to operate or assemble this Spare Tire Carrier until they have read this manual and have developed a thorough understanding of how the spare tire carrier works.



**WARNING:** The warnings, cautions, and instructions discussed in this instruction manual cannot cover all possible conditions or situations that could occur. It must be understood by the operator that common sense and caution are factors which cannot be built into this product, but must be supplied by the operator.

# SAVE THESE INSTRUCTIONS

## WORK AREA

- **Keep work area clean**, free of clutter and well lit. Cluttered and dark work areas can cause accidents.
- **Keep children and bystanders** away while mounting the spare tire carrier.

## PERSONAL SAFETY

- **Use safety apparel and equipment.** Use safety goggles or safety glasses with side shields which comply with current national standards.
- **Read and understand all instructions** and safety precautions as outlined in all manufacturers' manuals for the TRAILER you are using. Make sure to mount the Spare Tire Carrier to the manufacturer's recommended mounting positions.
- **Examine the Spare Tire Carrier for structural cracks**, bends, damage and any other condition that may affect the safe operation of the product. Do not use if damaged in any way.
- **It is the trailer owner's responsibility** to make sure the usage of this product meets all local motor vehicle laws and regulations. Do not obscure markers, taillights, running lights or license plate.
- Make certain bracket or tire does not interfere with the trailer's normal movement or blocks the driver's view.

## SPARE TIRE CARRIER USE AND CARE

- **Do not modify the spare tire carrier in any way.** Unauthorized modification may impair the function and/or safety and could affect the life of the equipment. There are specific applications for which the spare tire carrier was designed.
- **Always check for damaged or worn-out parts before using the spare tire carrier.** Broken parts will affect the spare tire carriers operation. Replace or repair damaged or worn parts immediately.
- **Do not exceed the spare tire carrier load capacity.**
- **Mount the spare tire carrier to balance evenly.** Uneven mounting may cause personal injury to the operator.

## PRE-ASSEMBLY

1. Secure the unloaded trailer with wheel chocks (blocks) on a hard, flat surface capable of supporting the weight of the trailer, Spare Tire Carrier, and required tools.
2. Raise the trailer tongue and secure it with two supports, one on each side of the trailer tongue.
3. Position the Mounting Bracket (part# 2) in a predetermined position against the side of the trailer tongue.

**Note:** The spare tire should be located to the side of the trailer tongue.

**Note:** The angled Tire Mounting Plate should be positioned upward (above) the Trailer Tongue Plate (plate that attaches to trailer tongue).

## ASSEMBLY

### STEP 1: (SEE PHOTO #1)

Attach the Mounting Bars (part #1) to the Mounting Bracket (part #2). Set the Mounting Bars (part #1) (containing 6 holes) flat against the trailer tongue so that the edges of the Mounting Bars (part #1) curve out away from the trailer tongue. Insert 4 hex bolts (part #3) through the Mounting Bars (part #1) as close to the trailer tongue as possible. Slide on Lock washers (part #8) and thread on Nuts (part #6). SEE PHOTO BELOW

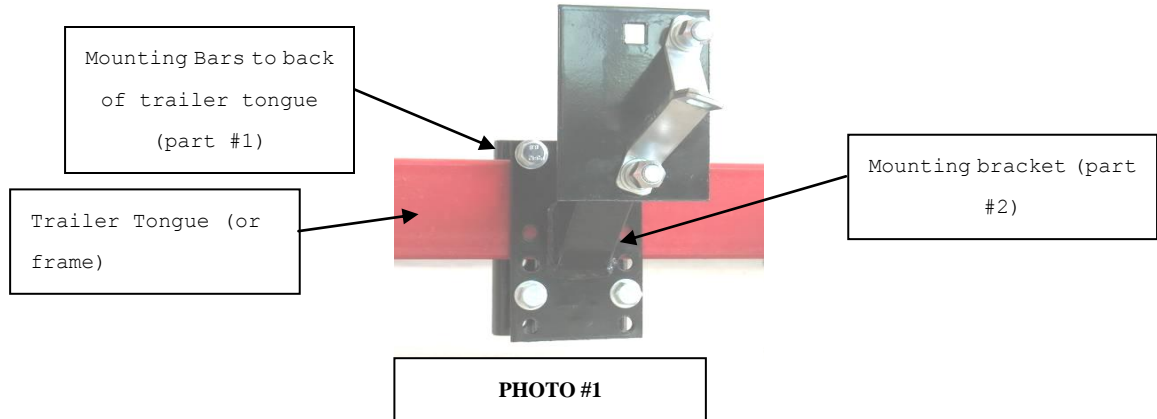

### STEP 2:

Mount the tire on the Tire Mounting Bracket with the valve facing outward so that the tire air pressure can be checked at any time.

**Note:** Make certain the tire is centered on the Tire Carrier when mounted, and refer to 5-lug or 4-lug mounting hole in Figure 2 below.

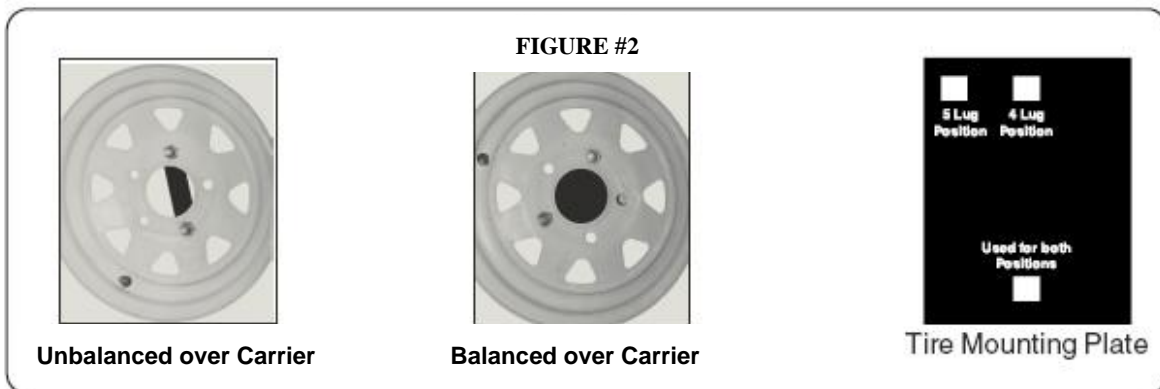

NEXT, insert carriage bolts (part #4) through back of the Tire Mounting Plate and through the Wheel lug holes. Secure using mounting nuts (part# 5)

STEP 3: (OPTIONAL) Attach ANTI-THEFT locking tabs (part #9) by using threaded end and screw onto threads of the Round Head Bolts (part #4). Align two large holes in tabs to allow a padlock (not included) to be used. See PHOTOS below for final assembly.

Anti-Theft tabs on 4-lug wheel



Threaded side of anti-theft locking tabs

Anti-Theft tabs on 5-lug wheel



## MAINTENANCE

- **Maintain your spare tire carrier.** It is recommended that the general condition of the spare tire carrier be examined before it is used. Check all nuts and bolts to make sure they are tight on a regular maintenance schedule. It is a good idea to use anti-seize on all bolts before tightening the nuts. If you hear any abnormal vibrations or noise, have the problem corrected before further use. Have necessary repairs made by qualified service personnel.

## SECURITY

- **Anti-Theft Locking Tabs for security.** After the tire is mounted on the carrier, the locking tabs can be threaded onto each bolt, then aligned to lock together for security. The threaded locking tabs can be positioned on either side of the lug nuts, depending on your particular application. Once threaded and locked into position, they become a very effective method to secure your spare tire.

• **DIAGRAM & PARTS LIST**

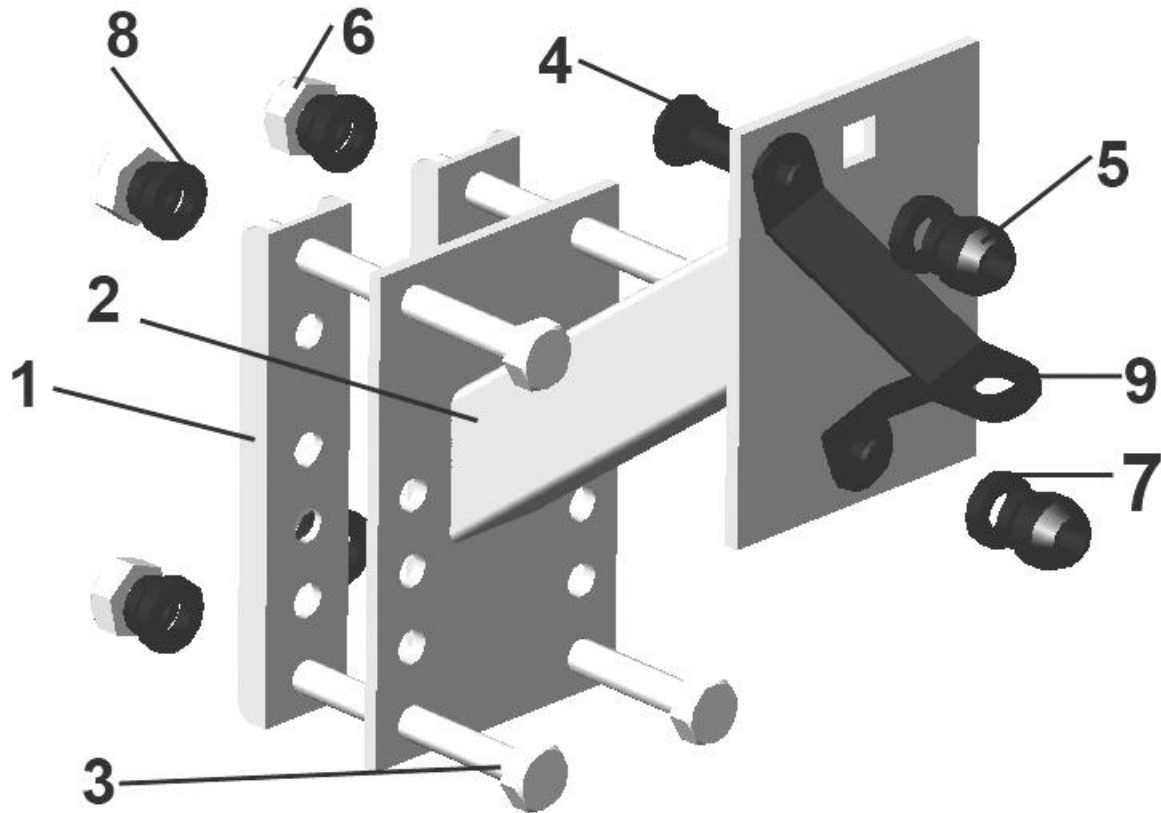

**Parts List**

Part #	Description	Quantity	Part #	Description	Quantity
1	Mounting Bar	2	6	Nut	4
2	Mounting Bracket	1	7	Spring and Flat Washer	2
3	Hex Bolt	4	8	Spring and Flat Washer	4
4	Carriage Bolt	2	9	Threaded Locking Tab	2
5	Nut	2			

For replacement parts and technical questions, please call **1-800-222-5381**.

**WARRANTY**

**One-year limited warranty**



Distributed by  
 Northern Tool + Equipment Co., Inc.  
 Burnsville, Minnesota 55306-6936  
 Made in China