

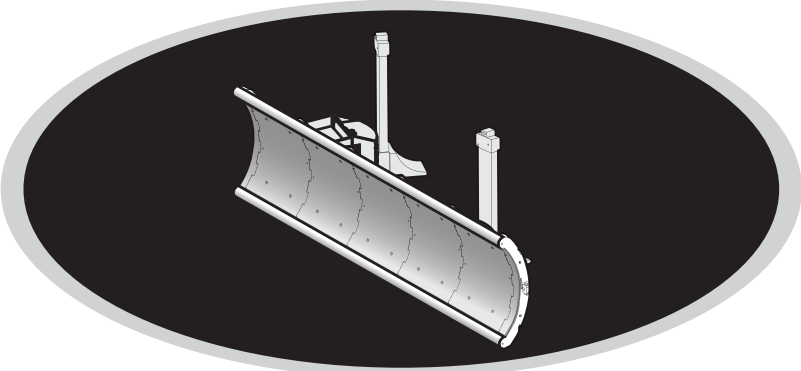

# ASSEMBLY INSTRUCTIONS

- Congratulations on the purchase of your Nordic Auto Plow - a truly unique solution (patent pending) to driveway snow removal.
- Properly assembled and used, the Nordic Auto Plow makes time consuming, back breaking manual snow removal a thing of the past!
- The Nordic Auto Plow was specifically designed and engineered for removal of snow in YOUR driveway. It is NOT to be used commercially, or for any type of street snow removal.
- See warranty and legal disclaimer (attached).
- Please read through the entire assembly sequence before beginning, it will help facilitate assembly. Estimated time for assembly: 30 minutes.
- Follow the assembly instructions carefully so your finished Nordic Auto Plow will be up to the snowiest task.
- Visit nordicautoplow.com for assembly videos and viewing the Nordic Auto Plow in action.
- Attachment of the Nordic Auto Plow to your vehicle is quick and safe, and storage is a snap.
- Be sure to keep these instructions on file for future reference and use if necessary.



Nordic Auto Plow LLC  
 771 W. North Ave.  
 West Chicago IL 60185  
 Phone for customer service: 888-662-PLOW (7569)  
 E-mail: support@nordicautoplow.com  
 Website: nordicautoplow.com  
 866-941-6577 (Fax)

## PARTS:

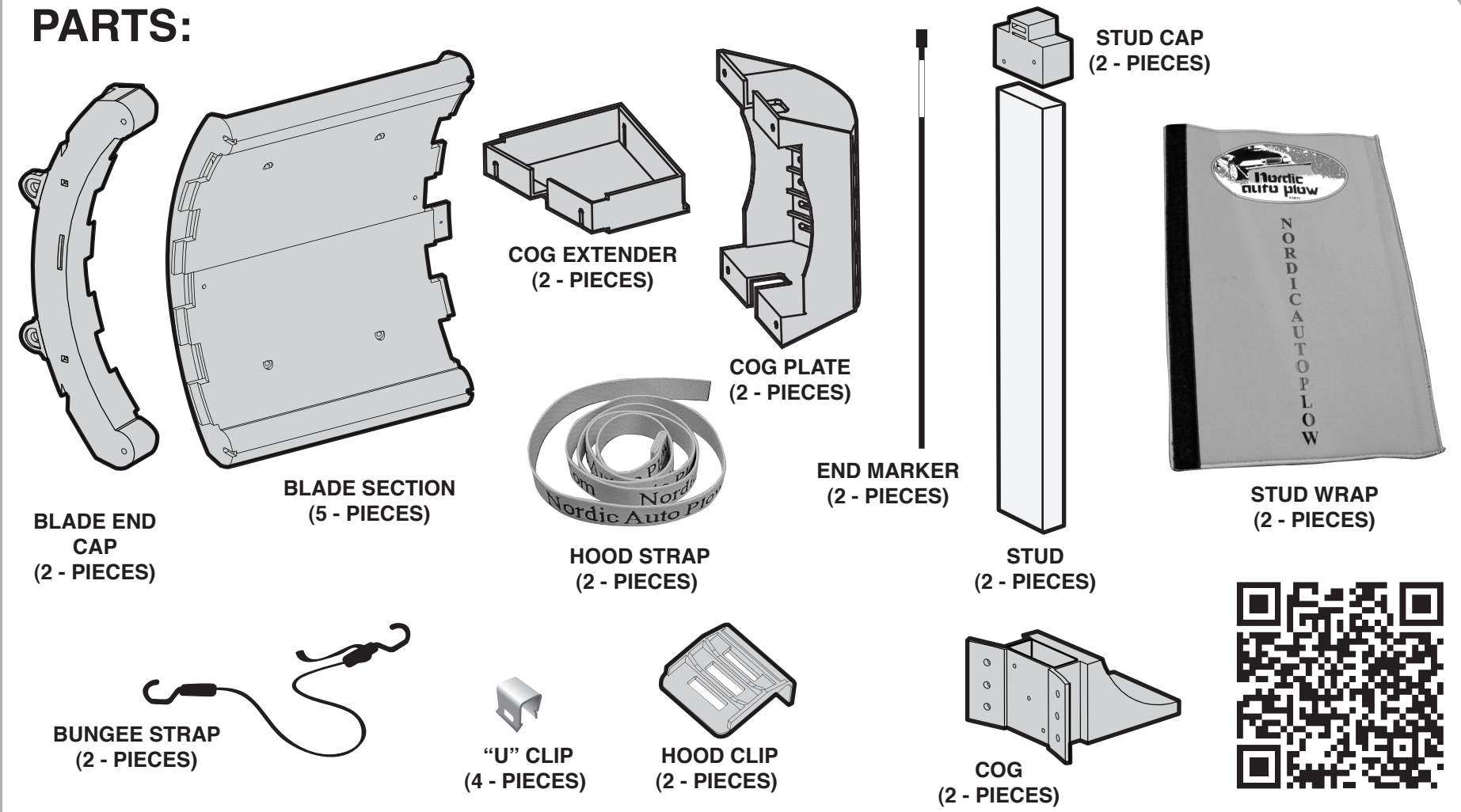

## HARDWARE:

NOTE: HARDWARE FOR TRUCK ADAPTER KITS IS INCLUDED IN A SEPARATE BAG (SHOWN IN THE TRUCK ADAPTER SECTION).

 1/4-20 x 1" PHILLIPS TRUSS HEAD BOLTS (12 - PIECES)	 1/4-20 x 1-1/2" PHILLIPS TRUSS HEAD BOLTS (8 - PIECES)	 1/4-20 x 3" PHILLIPS TRUSS HEAD BOLTS (4 - PIECES)	 1/4-20 x 1" ELEVATOR BOLTS (8 - PIECES)	 1/4 - 20 KEPS NUTS (32 - PIECES)	 #10 - 24 X 3/4" PHILLIPS PAN HEAD SCREWS (4 - PIECES)
 1/4" WASHERS (40 - PIECES)	 #8 x 3/4" PHILLIPS FLAT HEAD SHEET METAL SCREWS (14 - PIECES)				
USED IN STEP(S):	USED IN STEP(S):	USED IN STEP(S):	USED IN STEP(S):	USED IN STEP(S):	USED IN STEP(S):
2 8	12	4	10	2 4 8 10 12	6 7

## REQUIRED TOOLS:

7/16" (11mm.) WRENCH - #2 PHILLIPS HEAD SCREWDRIVER



**1**

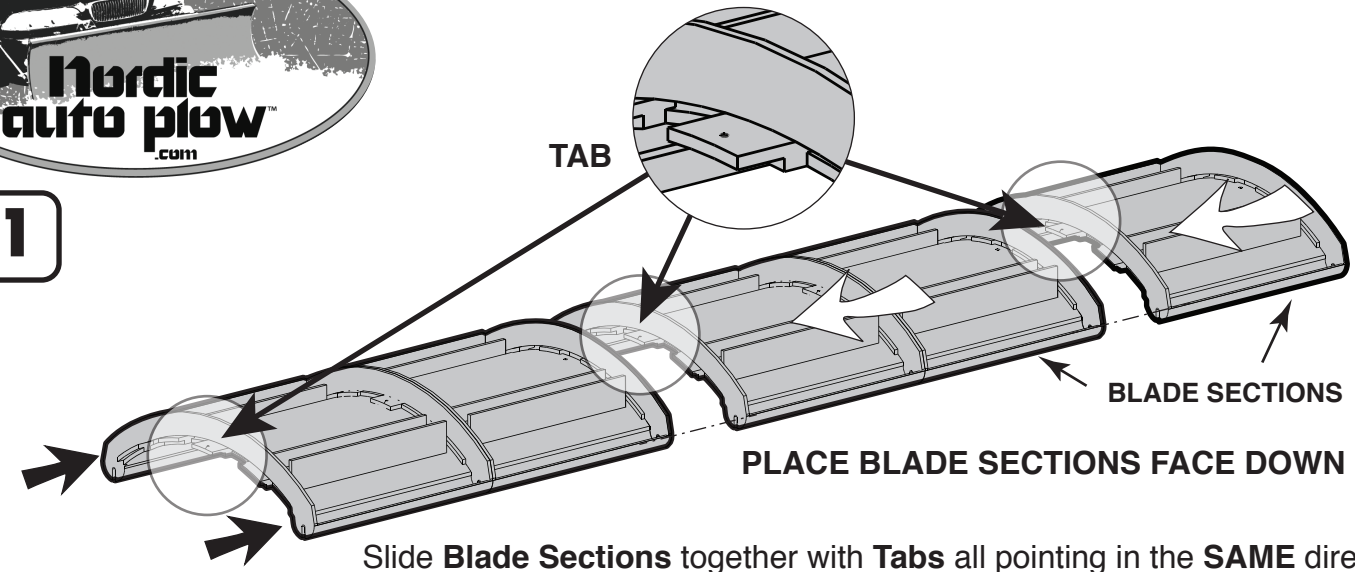

**2**

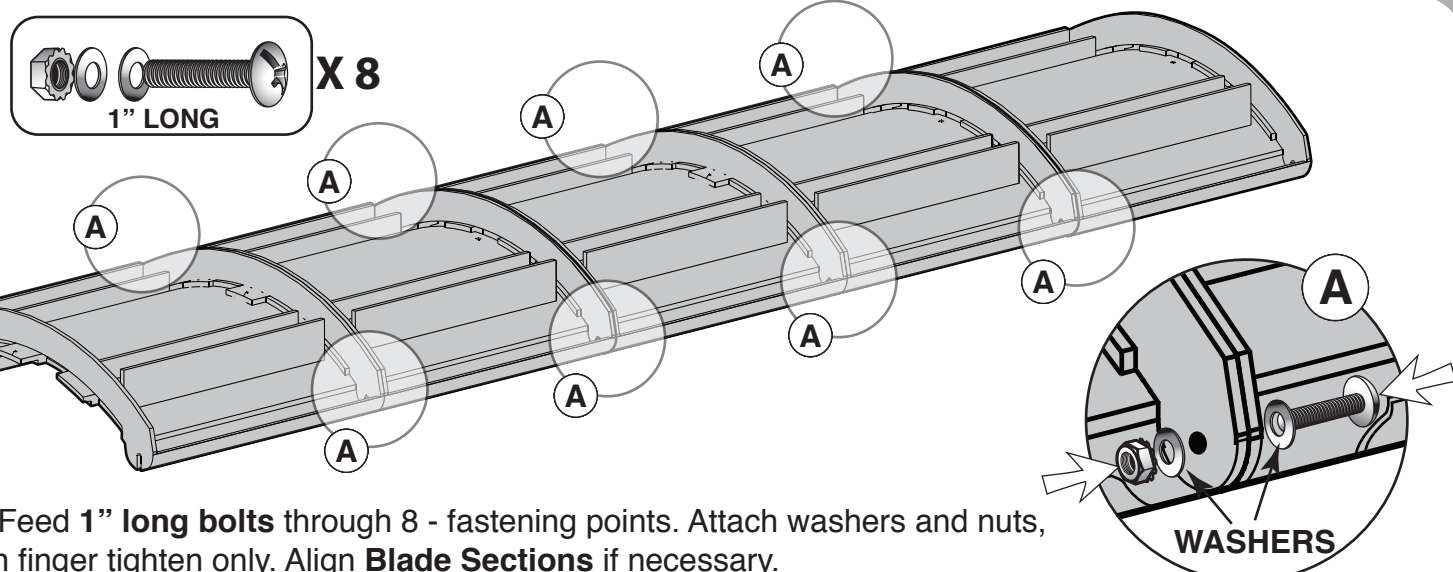

**3**

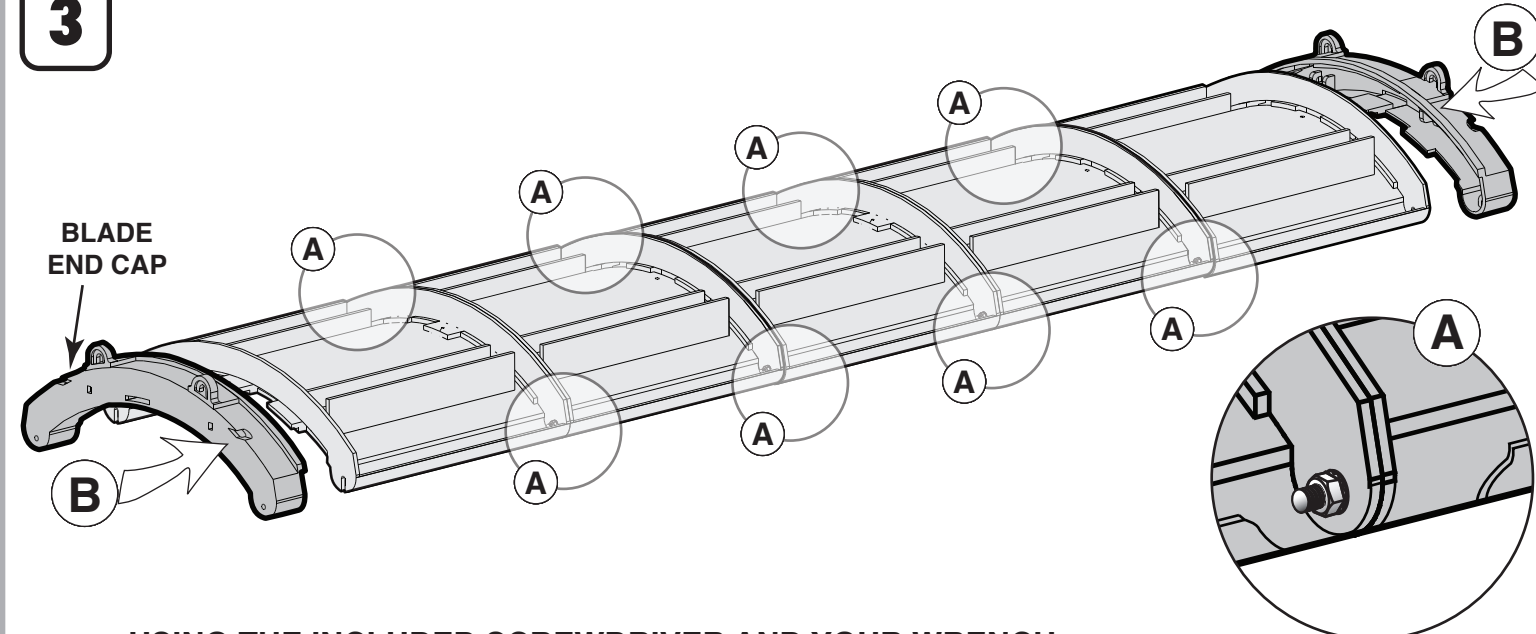

**4**

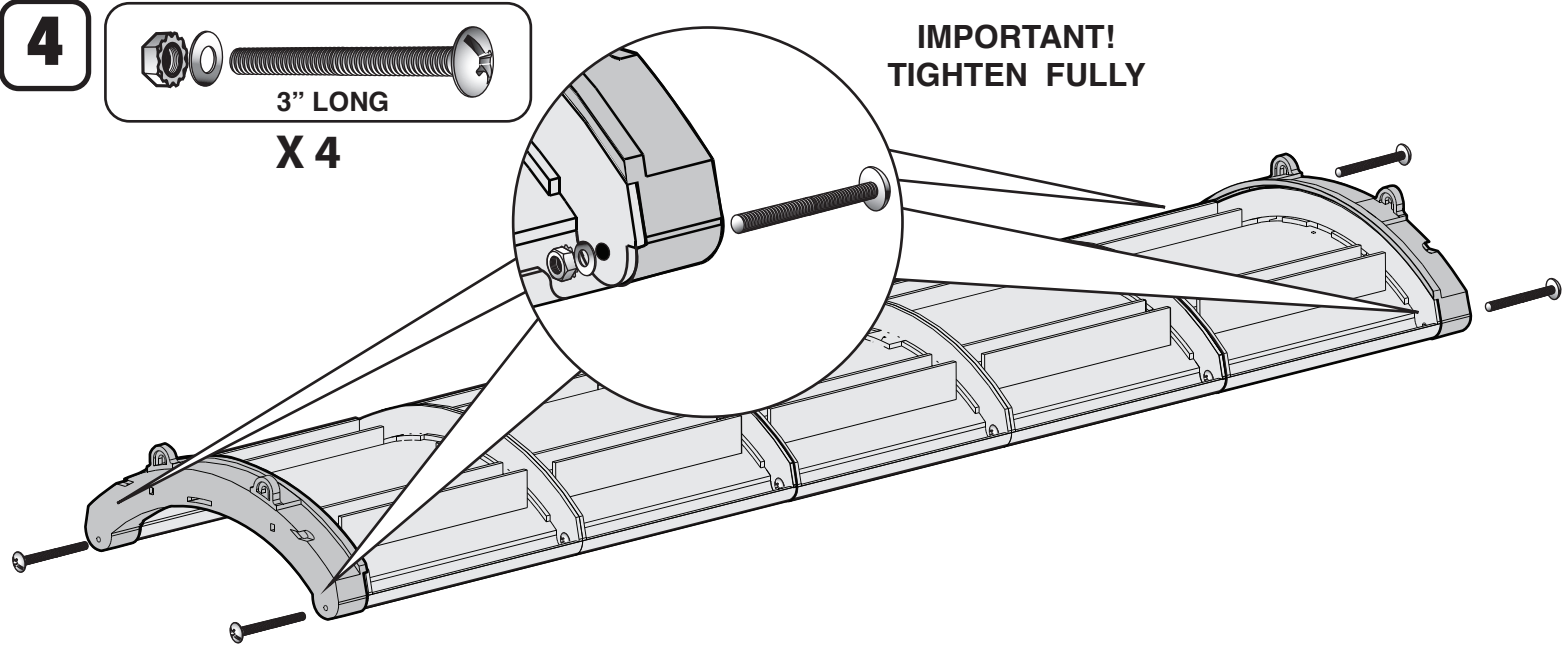

**USING THE INCLUDED SCREWDRIVER AND YOUR WRENCH:**  
**A** - Tighten fully all 1" long bolts and nuts at 8 - fastening points (A).  
**B** - Slide an End Cap over each end of the Blade .

Feed 3" long bolts through (2) holes in each End Cap and Blade Section. Attach washers and nuts, **tighten fully**.

**5**

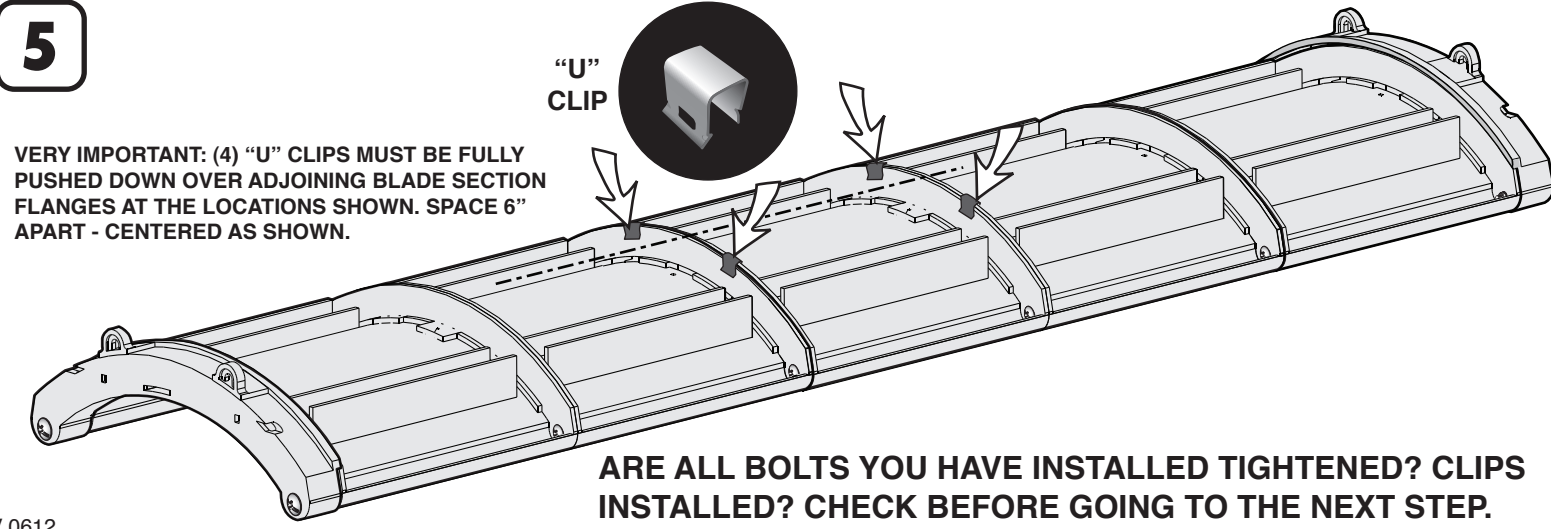

**ARE ALL BOLTS YOU HAVE INSTALLED TIGHTENED? CLIPS INSTALLED? CHECK BEFORE GOING TO THE NEXT STEP.**

**6**

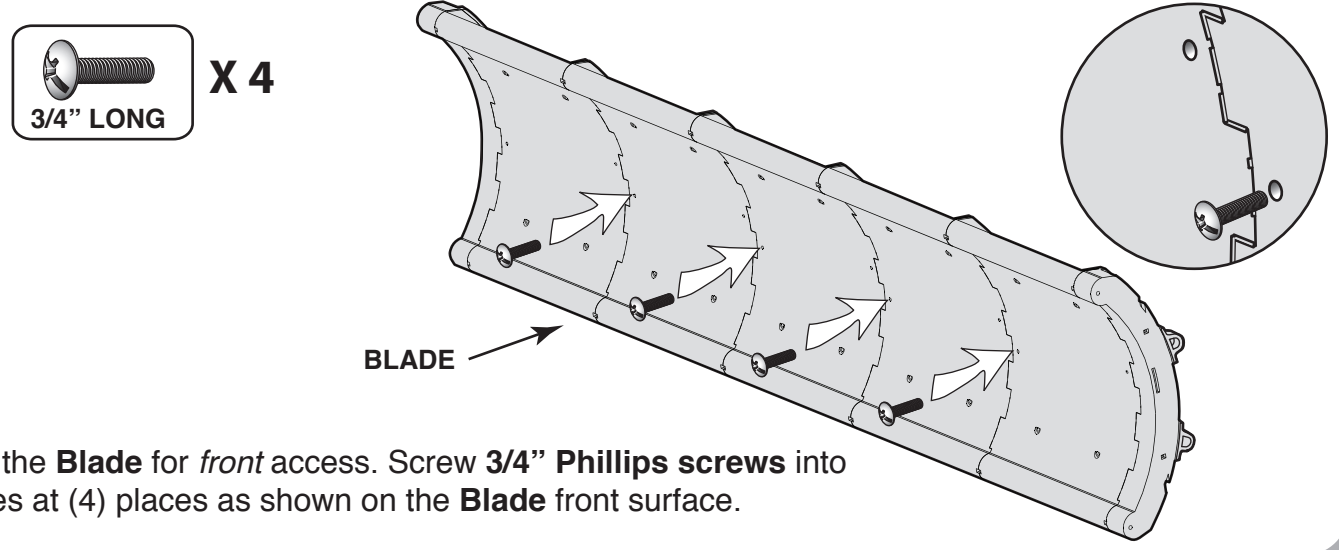

Position the **Blade** for front access. Screw 3/4" Phillips screws into pilot holes at (4) places as shown on the **Blade** front surface.