

**IF YOU ARE EXPERIENCING TROUBLE WITH THIS PRODUCT,
OR MISSING PARTS, PLEASE CALL 800-954-3310 FOR ASSISTANCE
DO NOT RETURN TO STORE**

FASTPIPE *RAPIDAIR*

Modular Aluminum Compressed Air Piping

INSTALLATION INSTRUCTIONS

PLANNING/LAYOUT

Before beginning the installation, create a plan as to the location of the air compressor and where you are going to mount the compressed air outlets. On the plan locate outlets, tees and elbows.

AIR COMPRESSOR

Use a flexible jumper hose from the air compressor to the filter regulator unit to reduce vibration to the FastPipe System.

FILTER REGULATOR

A filter regulator unit is recommended to keep contaminants out of the air system and to allow for pressure adjustment.

PRESSURE RATINGS

The FastPipe system has a maximum working pressure of 190 psi and a temperature range from 0 to 140 deg F.

ASSEMBLY OF THREADED COMPONENTS

Apply pipe sealant/paste to all NPT pipe threaded connections during assembly.

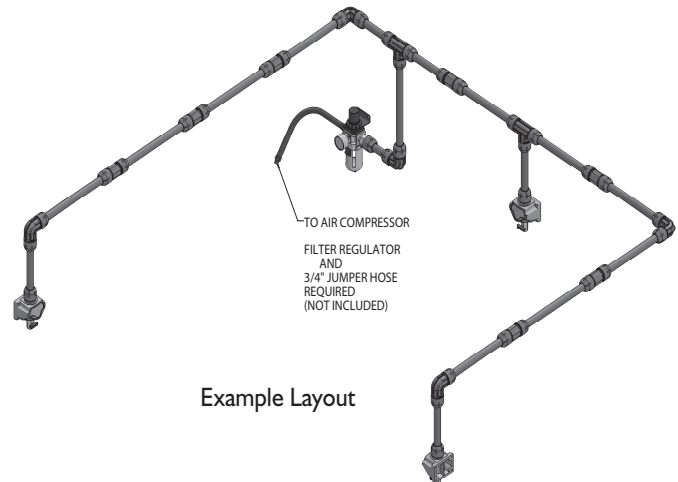

Example Layout

DO NOT USE TEFLON TAPE

FLAT SURFACE INSTALLATION

- Use pipe clips to secure pipe to any flat surface with mounting screw
- Ceiling or wall mount
- Clip has 5/16" thru hole and hex bore for a 5/16" hex nut
- Hex nut serves as a backer for screws
- In horizontal installations, mount clip pivot tab up

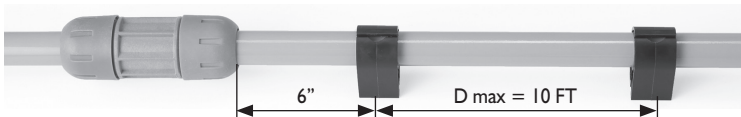

- Hangers or mounting clips should be no more than 10 ft apart and one must be at least 6" from a fitting
- Do not over tighten cantilever type tube supports, pipe must be allowed to expand and contract slightly in length
- For continuous lengths over 200 ft and change in temperature variations of 80 deg F Consult the factory for expansion joint guidelines.



HANGING INSTALLATION



- Beam Clamp
- 5/16" threaded rod
- Pipe Clip



- Beam Clamp
- 3/8" threaded rod
- Loop hanger

FASTPIPE INSTALLATION STEPS



- 1) CUT PIPE TO LENGTH with tubing cutter (cut must be square) (DO NOT USE HACKSAW)

STEP 1

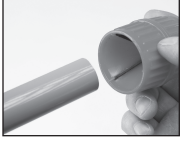

- 2) DEBURR the end of the pipe outside and inside (a smooth edge allows easy fitting assembly and no damage to the fitting o-ring)

STEP 2



- 3) MARK END OF PIPE for the proper insertion depth
1" Fitting: 2-3/4 inches
1-1/2" Fitting: 4 inches

STEP 3

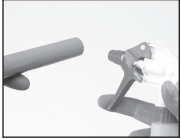

- 4) WET END OF PIPE with a very diluted soapy water DO NOT USE ANY OIL OR GREASE LUBRICANT

STEP 4



- 5) LOOSEN FITTING CONE NUT PARTIALLY LOOK INSIDE EACH FITTING FOR INNER PARTS (inner parts, o-ring, stainless steel bite ring)

STEP 5

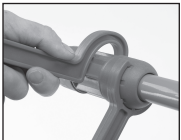

- 6) INSERT PIPE into fitting until pipe bottoms out HAND TIGHTEN fitting FULLY TIGHTEN fitting with FASTPIPE spanner wrenches

STEP 6

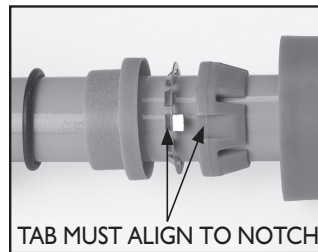

Front of block is ported
1/2" NPT Female
(x2)

SADDLE DROP INSTALLATION



STEP 1

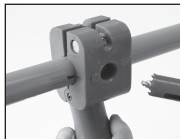

STEP 2



STEP 3



STEP 4

- 1) Position saddle drop opposite the side of the pipe that needs the hole
Tighten securely and mark the pipe by the raised locating mark on the fitting
Mark the pipe both horizontally and vertically along the fitting edge
- 2) Drill thru one side of pipe with the drill bit, using the hole in the fitting as a locator
- 3) Insert the saddle drop gasket into the molded cavity
- 4) Position the saddle drop over the drilled hole with aligning marks, tighten securely
- 5) Attach the necessary drop pipe or threaded adapter

WARNINGS

- * Compressed air is DANGEROUS if not used properly
- Always use EYE PROTECTION when using compressed air
- DO NOT POINT compressed air at your body or any person
- Pressurize system SLOWLY
- TURN OFF air compressor when not in use
- CHECK local building codes before installation
- CA PROP 65: This product contains chemicals known to the state of California to cause cancer and birth defects or other reproductive harm
- ALWAYS RELIEVE the system pressure when installing or performing maintenance
- Systems must have a SAFETY RELIEF valve installed at the compressed air source to prevent over pressurization
- When using FastPipe in direct sunlight, cover or paint the polymer fittings to protect from UV exposure (Pipe needs no covering and can be exposed)



FASTPIPE INSTALLATION GUIDELINES

- use pipe sealant/paste on all pipe threaded connections (not fitting cone nuts) **DO NOT USE TEFLON TAPE**
- **CHECK** that all fittings are fully tightened before pressurizing the system for the first time
- for initial installation, pressurize system slowly to 50psi and check for leaks, then pressurize slowly to **MAX 190psi**
- take extra precaution with **END CAP INSTALLATION**, double check these fittings are tightened fully
- **FASTPIPE** can be bent to conform around minor obstacles to a maximum of 15 degrees. **DO NOT OVERBEND**
- **USE JUMPER HOSE** at the air compressor to absorb vibration
- **ONLY** FastPipe outlets are designed for the direct pulling force of air hoses, for other fastPipe fittings attached to hoses, always secure hose with a **STRAIN RELIEF**, attached to the building structure
- After the first 48-96 hours of operation, check all the joints. then make sure all the cone nuts are tight as these may have loosened due to settling of the component
- Always use a filter unit to keep contaminants out of the FastPipe system

SADDLE DROP INSTALLATION TIPS

- system must be de-pressurized before installing, wear eye protection
- the drop can be used in any position on the pipe
- avoid putting the hole at the bottom of the pipe to prevent condensate or debris to enter the drop pipe
- to prevent chips from entering the pipe interior, stop drilling occasionally and blow out chips, grease the end of the drilling tool
- allen wrench for tightening is 6mm size