

# ***Linear Actuator User Information***

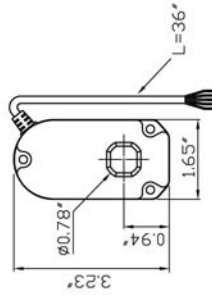
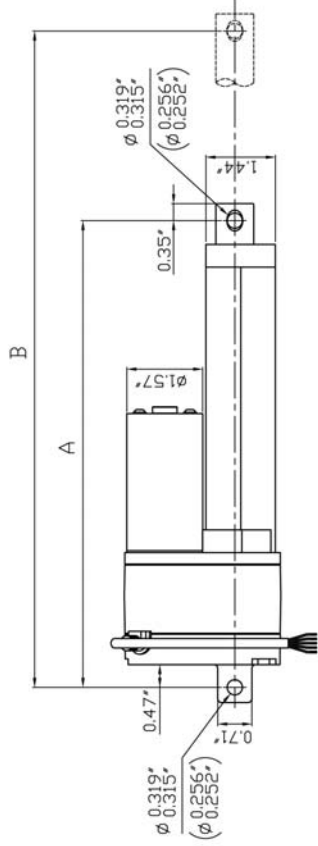
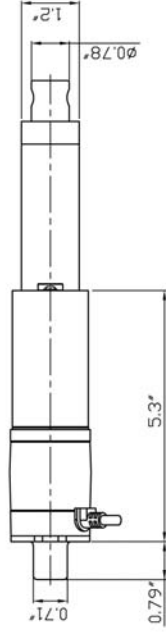
**Models:**

**LACT2P - LACT12P**



# Dimensional Information

Stroke	2"	4"	6"	8"	10"	12"
Retracted Length (A±0.12")	7.7"	9.7"	11.7"	13.7"	15.7"	17.7"
Extended Length (B±0.12")	9.6"	13.6"	17.6"	21.6"	25.6"	29.6"



## Wiring Information

When installing linear actuator with the optional controller, plug actuator connectors into controller module. Then follow instructions provided with the controller unit to complete setup.

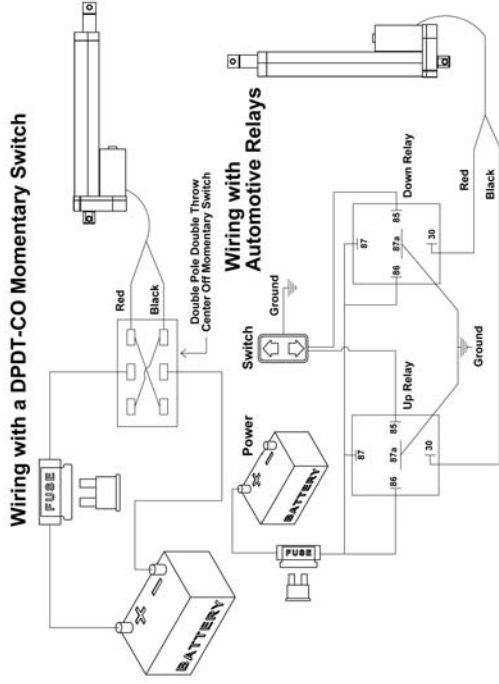


When installing linear actuator without a controller, remove connector from Red & Black lead, then wire according to Figure A.

White, Blue, and Yellow wires will not be used.

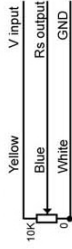


Figure A



## Potentiometer Wiring and Output Information

Stroke(mm)	Value of POT Resistance(Ω)
50	0.3-9.3K
100	0.3-9.7K
150	0.3-8.6K
200	0.3-9.6K
250	0.3-9.3K
300	0.3-9.3K
Remark:tolerance:±0.3K	





concentric™  
INTERNATIONAL

**512 Tuttle Street  
Des Moines, Iowa 50309  
515-283-3900**