

# GREASE JOINT REJUVENATOR® MASTER KIT #7863

Grease Joint Rejuvenator Professional Model #7862

Auxiliary 5" Flexible Hose #7884-7

Grease Joint Rejuvenator Pocket Model #7864

Extra Heavy Duty Grease Coupler #7902

## INSTRUCTIONS

The **Grease Joint Rejuvenator®** allows a clogged grease fitting or joint to take on grease by injecting light penetrating oil into the grease joint via the grease fitting, thus breaking up and removing any dirt, rust or debris. The purpose of this tool is to free up the joint and fitting, enabling them to be greased.

**SET UP:** First remove the piston from the tool body and fill with non-aerosol, penetrating oil. Once the tool body has been filled, reinsert the piston, gently working it into the bore of the body. Be sure to clean the piston and O-Ring before inserting, as dirt makes the tool less effective. NOTE: A spare O-Ring is located near the head of piston shaft and serves as a marker to show when the tool body is empty. To get the best use out of this tool, bleed all the air out of it. When the piston is inserted into the tool body, air may get trapped inside. Any air left in the tool reduces the hydraulic pressure causing the tool to be less effective. (If the piston bounces back when tapped, it has air in it!)

**REMOVE THE AIR:** After filling the tool body with light oil, put the piston back and turn the tool upside down to allow the air bubble to float to the top. Place a rag over the end of the tool and tap on the piston lightly with your hand until the air bubble burps out. You are now ready to use the tool. When bleeding, be sure and keep your face and eyes away from expelling air and fluid. (WEAR SAFETY GLASSES!)

**USING THE TOOL:** Once the tool has been bled of air, you are ready to unclog a stuck fitting or joint. If using the Professional Model, push the Grease Coupler over the grease fitting and tap the piston head with a light hammer. It may take several taps, but the piston eventually moves down into the tool body. This is the indication that the joint is being opened. Once the piston has pushed all the oil out, remove the tool and grease the joint. (Note: some joints are more stubborn than others. Several attempts with the Grease Joint Rejuvenator may be necessary.) If using the Pocket model, gently place the open end over the grease fitting and hold the tool down firmly. (The O-ring inside the end of the tool creates a seal and keeps the oil from leaking out.)

**PRECAUTIONS:** Be sure NOT to hit the tool too hard as you can snap off a grease fitting or damage the tool. If you find a stubborn fitting, try loosening the grease fitting one or two turns to expel any trapped air and increase the cleaning pressure. When the Grease Fitting Coupler on the end of the Professional Model is new, it may be difficult to remove from a fitting. Unscrew the head a quarter turn to loosen the jaws holding the fitting. The jaws can be turned around for extra life. (Note: The jaws are a wearable item and are not warranted.)

**WHAT ARE THE DIFFERENCES BETWEEN POCKET AND PROFESSIONAL MODEL?** Professional Model is ideal for large farm and constructions equipments. The 5" flex hose can be attached to it for accessing hard to reach fittings. The pocket model is smaller and handy for small equipments (e.g. lawn mowers). It has almost 2 ½ time more pressure than the Professional Model to push out dirt and grease, but holds 1/3 amount of oil as the Professional Model. With both tools, you will be able to unclog any joint every time!

7863 MASTER KIT GJR Instructions-ENG-v02

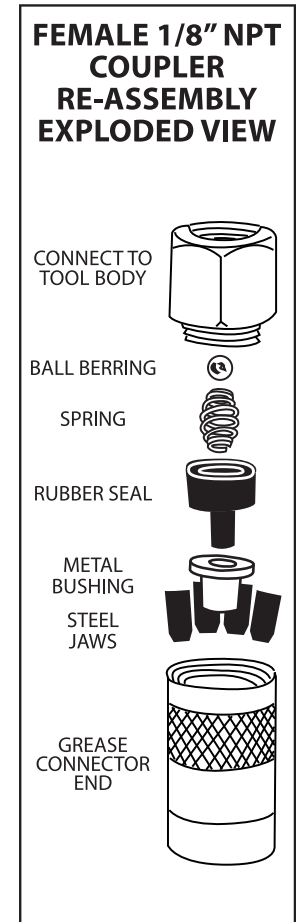
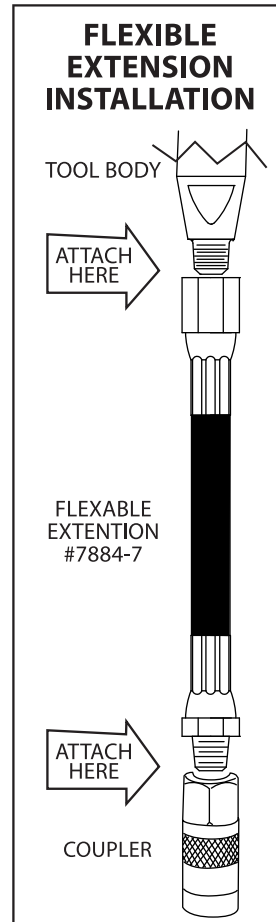
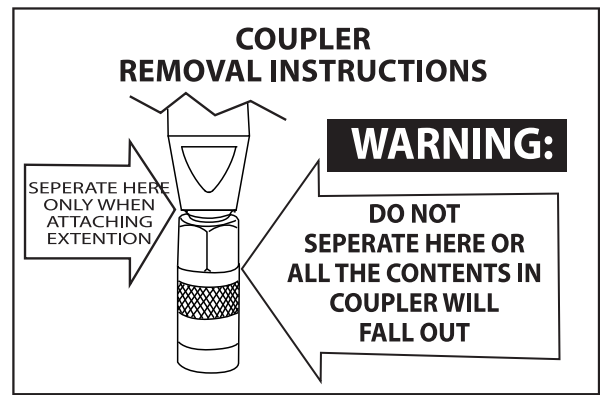

**INSTALL AUXILIARY FLEX HOSE #7884-7:** Some applications may require the use of the **auxiliary hose** to make a bend. To install the flex hose, remove the female grease fitting coupler from the **Professional Model #7862**. Use sealant tape and install the flex hose into the tool body, then install the grease coupler on the end of the hose. This gives you flexibility when trying to access tight places. The use of the hose should only be temporary. The **Grease Joint Rejuvenator®** works best without the hose. (Auxiliary hose can only be used with the **Professional Model**.)

**CLEANING:** Keep unit dry and oiled. If unit rusts, use a light steel wool and oil as soon as possible.

**LIMITED WARRANTY:** Workmanship and material. Any defect in the material or workmanship is repaired or replaced within 24 working hours upon receiving it by the manufacturer. The warranty does not cover use and abuse claims.

**FOR A WARRANTY CLAIM, RETURN THE ITEM TO:**  
**Warranty Repair, Innovative Products of America, 1674 Kirkwood Pike, Kirkwood, PA 17536.**  
717-529-4000 ph / 717-529-0118 fax