



66 Northfield Rd.
Scarborough, Ontario M1G 2H4
Tel: (905) 947-8011

Client **SCEPTER CANADA INC.**
Project **DURAMAX Instruction Updated Sheet** Fonts: **OUTLINES**
Date **August 14, 2024 (08/24)**
Docket
Scale **100%**
Program **Illustrator CC**

IMPORTANT: PLEASE READ!
THESE COLOURS ARE FOR REFERENCE ONLY AND SHOULD BE MATCHED TO THE APPROPRIATE PMS COLOUR CHIPS. SOME ADJUSTMENT MAY HAVE TO BE MADE TO COLOURS AT FILM STAGE TO ENSURE COLOUR ACCURACY.



• **DIELINES ARE FOR POSITION ONLY**
• **NO TRAPPING HAS BEEN APPLIED TO THIS DOCUMENT**

Comart Studios has made every effort to ensure that this digital art file has been accurately completed. You are advised to proof this material carefully before signing disk release below.

Client Approval:

Date:

ENGLISH UPDATED INSTRUCTIONS SHEET

August 14, 2024 (08/24)

8.5"



FLO 'N GO® DURAMAX®

HOSE REPLACEMENT FOR **UPGRADED** VERSION DURAMAX®

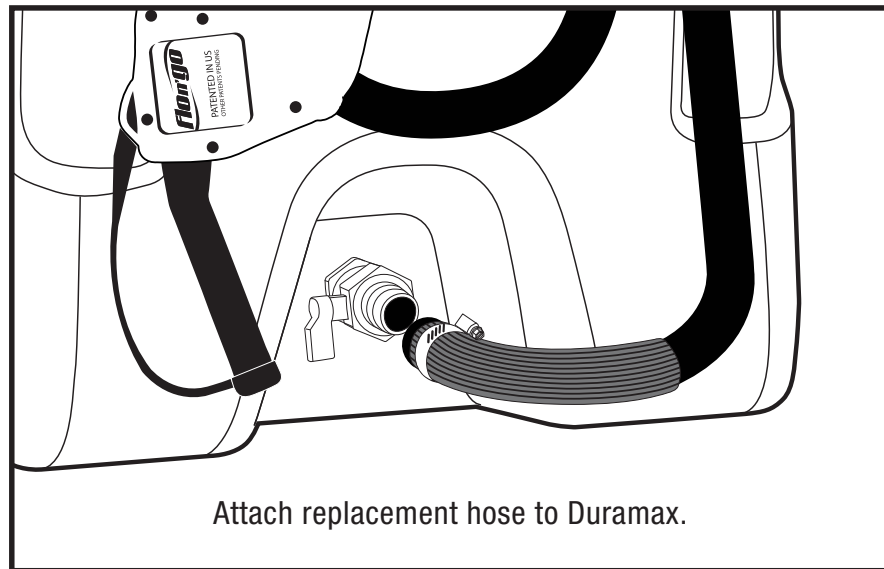

Attach replacement hose to Duramax.

HOSE REPLACEMENT FOR **ORIGINAL** VERSION DURAMAX®

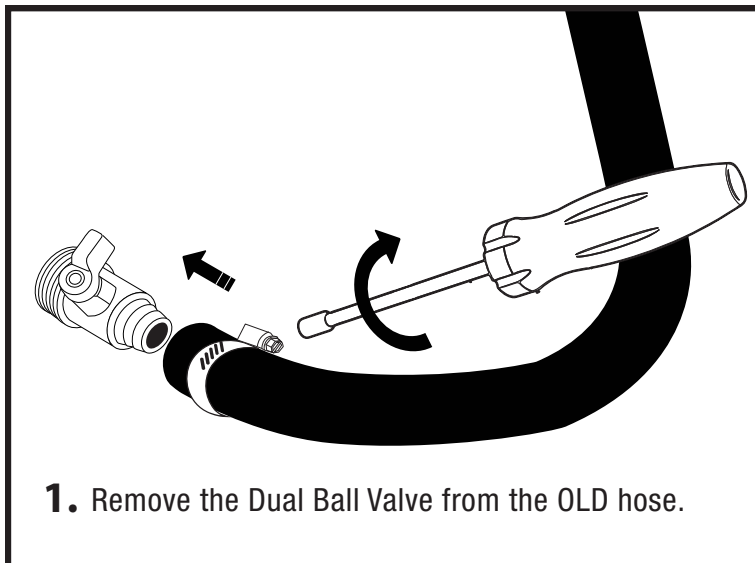

1. Remove the Dual Ball Valve from the OLD hose.

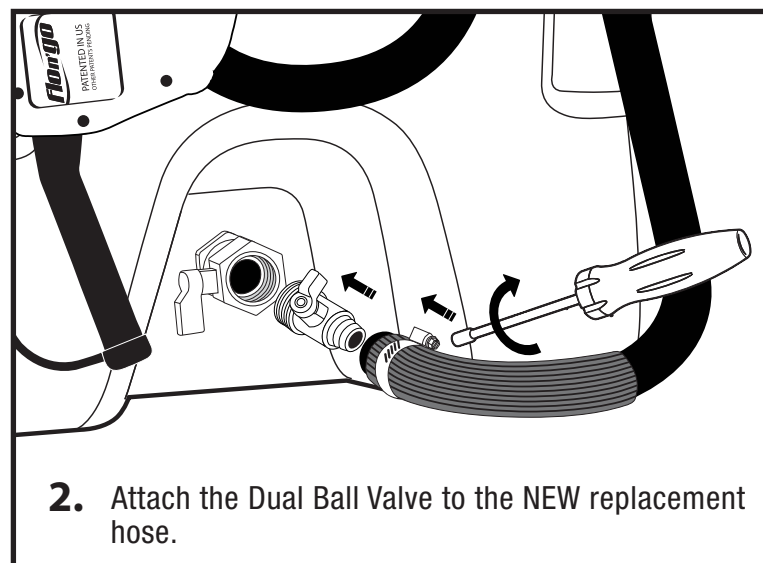

2. Attach the Dual Ball Valve to the NEW replacement hose.

If you have lost or need to replace your ball valve (Part# 6934), please contact
Scepter Customer Service at: 1-800-387-6018



Miami, OK USA | Scarborough, ON Canada
1-800-387-6018 www.scepter.com

08/24

11"