



# 1200-LB. CAPACITY DUMP CART

## OWNER'S MANUAL



### **WARNING:**

Read carefully and understand all **ASSEMBLY AND OPERATION INSTRUCTIONS** before operating. Failure to follow the safety rules and other basic safety precautions may result in serious personal injury.

**Item# 23317**

Thank you very much for choosing a NORTHERN INDUSTRIAL TOOLS product! For future reference, please complete the owner's record below:

Model: \_\_\_\_\_ Purchase Date: \_\_\_\_\_

Save the receipt, warranty and these instructions. It is important that you read the entire manual to become familiar with this product before you begin using it.

This machine is designed for certain applications only. The distributor cannot be responsible for issues arising from modification. We strongly recommend this machine not be modified and/or used for any application other than that for which it was designed. If you have any questions relative to a particular application, DO NOT use the machine until you have first contacted the distributor to determine if it can or should be performed on the product.

For technical questions please call **1-800-222-5381**.

## INTENDED USE

This utility dump cart has a rugged steel construction and is designed to carry a wide range of materials. The dump cart will easily haul up to 1200 lbs. of tools, firewood, animal feed, trash, landscaping materials, cement or anything else that needs to be moved. Easy-to-use removable tailgate makes loading and unloading fast and convenient. Never exceed the rated load capacity of 1200 lbs. when operating the utility dump cart.

## TECHNICAL SPECIFICATIONS

Item	Description
Capacity	1200 lbs. (17 cubic feet)
Tires	16in. x 5in. W
Construction	Steel
Dimensions	81in.L x 33.19in. W x 38.31in.H

## GENERAL SAFETY RULES



**WARNING:** Read and understand all instructions. Failure to follow all instructions listed below may result in serious injury.



**CAUTION:** Do not allow persons to operate or assemble this dump cart until they have read this manual and have developed a thorough understanding of how the dump cart works.



**WARNING:** The warnings, cautions, and instructions discussed in this instruction manual cannot cover all possible conditions or situations that could occur. It must be understood by the operator that common sense and caution are factors which cannot be built into this product, but must be supplied by the operator.

## SAVE THESE INSTRUCTIONS

## DUMP CART USE AND CARE

- **Do not modify the dump cart in any way.** Unauthorized modification may impair the function and/or safety and could affect the life of the equipment. There are specific applications for which the dump cart was designed.
- **Always check of damaged or worn out parts before using the dump cart.** Broken parts will affect the dump cart operation. Replace or repair damaged or worn parts immediately.
- **Store idle dump cart.** When dump cart is not in use, store it in a secure place out of the reach of children. Inspect it for good working condition prior to storage and before reuse.
- Do not at any time carry passengers sit or stand on the cart.
- Do not exceed equipment maximum load capacity of 1200 lbs.
- Avoid large holes and ditches when transporting loads.
- Be careful when operating on steep grades; the cart may tip over.
- Always operate at reduced speed in rough terrain.
- Do not operate close to creeks, ditches and public highways.
- To avoid personal injury and/or equipment damage, DO NOT EXCEED 10 MPH.
- Always use caution when loading and unloading the cart.
- Only tow with recommended vehicles (Lawn/Garden Tractors and ATVs).
- Always secure and lock dump cart to the vehicle hitch before operating.

## UTILITY DUMP CART COMPONENT PARTS AND ASSEMBLY

Take all parts out of the shipping crate and inspect components to ensure there are no missing pieces before starting to assemble the utility dump cart follow steps 1 through 9.

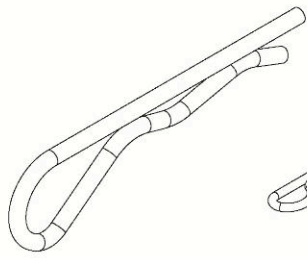

Hinge Pin  
8pcs

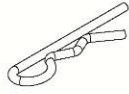

R Pin Ø3  
4pcs



Flat Washer Ø20  
4pcs



Hex Bolt M8x40  
4pcs



Screw M8x16  
8pcs



Screw M6x16  
4pcs



Nylon Lock  
Nut M8  
12pcs



Nylon Lock  
Nut M6  
4pcs

**NOTE:** You may have extra nuts and bolts when finished.

## TOOLS REQUIRED

- Pliers
- Screwdriver
- 10mm & 13mm Wrench

## ASSEMBLY

### STEP 1: Attach Bottom Panels and Support Tubes

1. Put the left bottom panel and right bottom panel together.
2. Attach the support tubes to the panels using four sets of M8x40 screws and M8 nylon lock nuts.

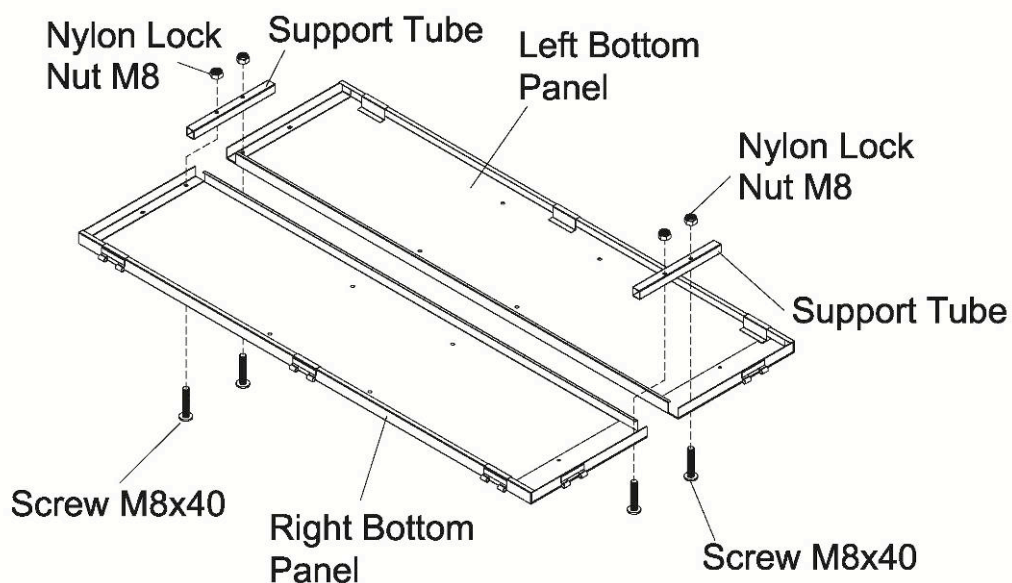

## STEP 2: Attach Tongue Support

1. Attach the tongue support to the bottom panel using four sets of M6x16 screws and M6 nylon lock nuts.

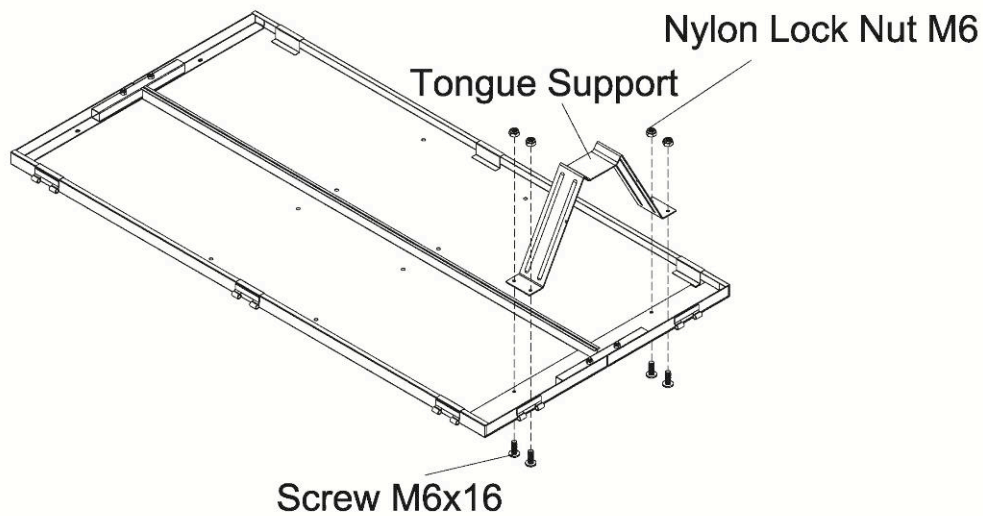

## STEP 3: Attach the Wheel Axle Support

1. Put together the two wheel axle support stand, attached them to the bottom panel using eight sets of the M8x16 Screws and M8 nylon lock nuts. Loosely tighten the nuts.

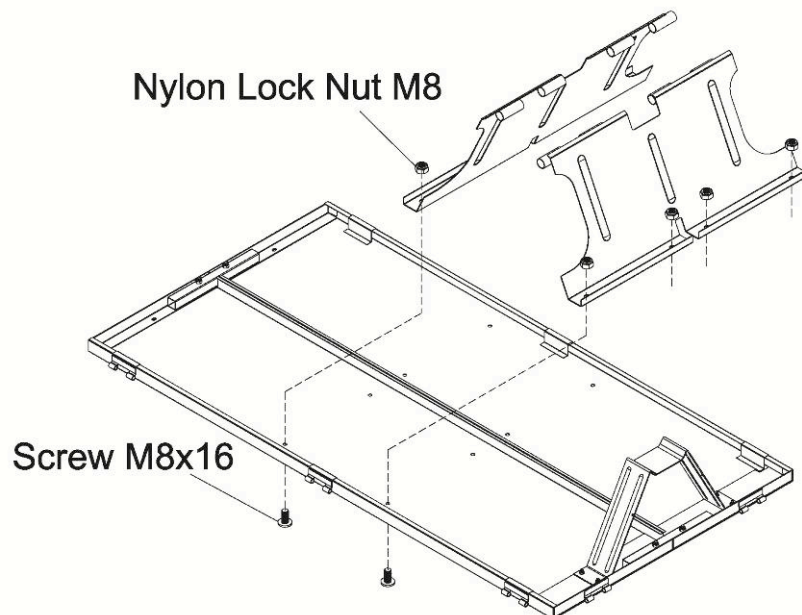

## STEP 4: Attach Wheel Axle

1. Center the hitch tongue assembly in the wheel axle support.
2. Insert the axle through the hole and slide it through both the axle support and the hitch tongue assembly.
3. Tighten all hardware in step 3.

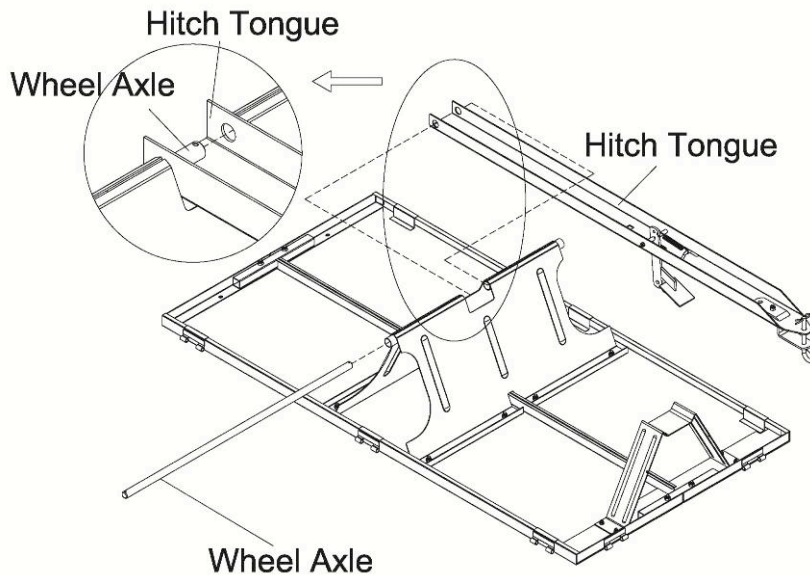

## STEP 5: Attach the Wheels

1. Put an  $\text{Ø}20$  flat washer on the axle; slide the wheel over the end, followed by the second  $\text{Ø}20$  flat washers and secure with  $\text{Ø}3$  R Pin.
2. Repeat the process for the other side of the axle.

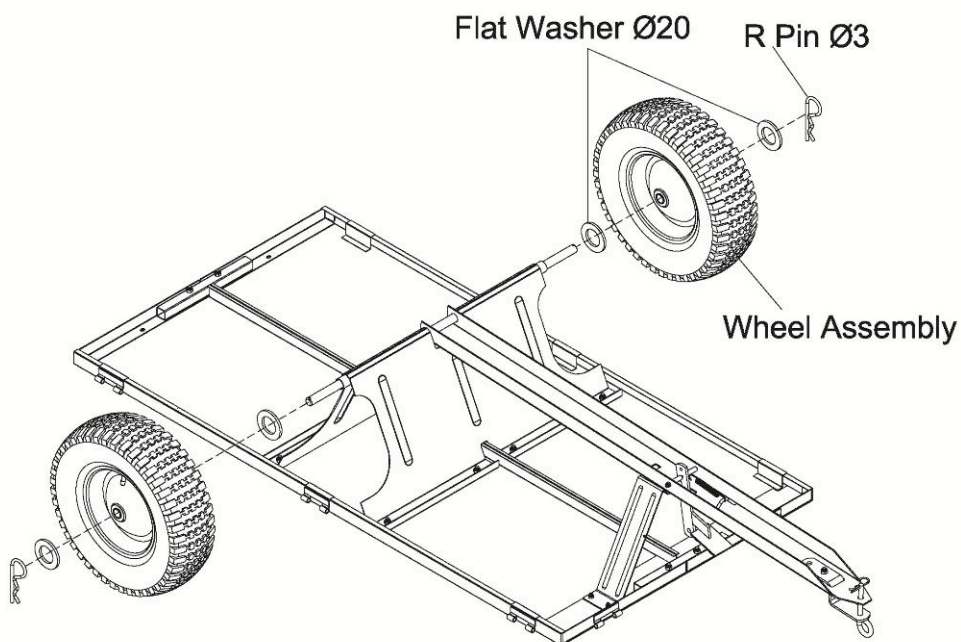

## STEP 6: Attach Side Panel

1. Attach the left and right side panel assemblies to the bottom panel using the four hinge pins.

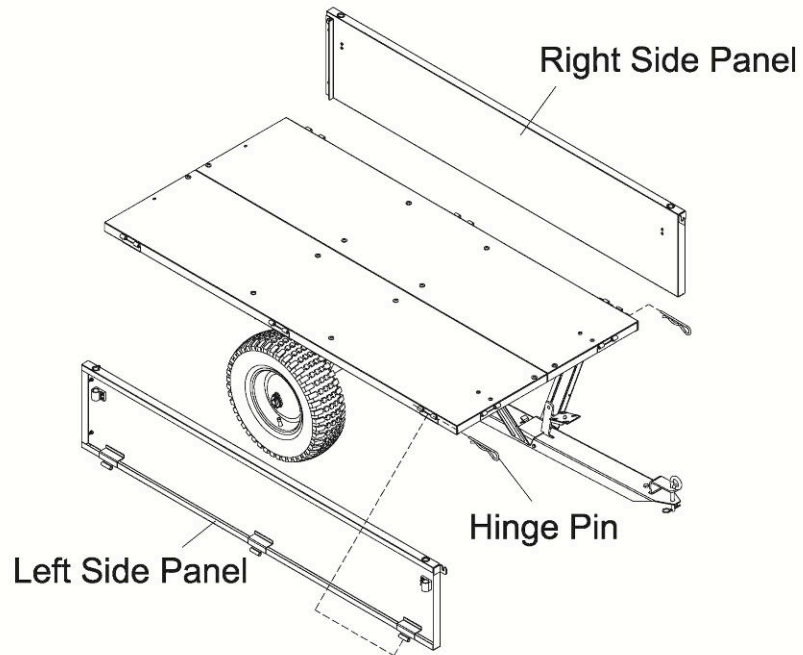

## STEP 7: Attach the Front Panel

1. Attach the front panel to the bottom panel and secure using the two hinge pins.
2. Lock the left and right side panel assemblies in place using the handle.

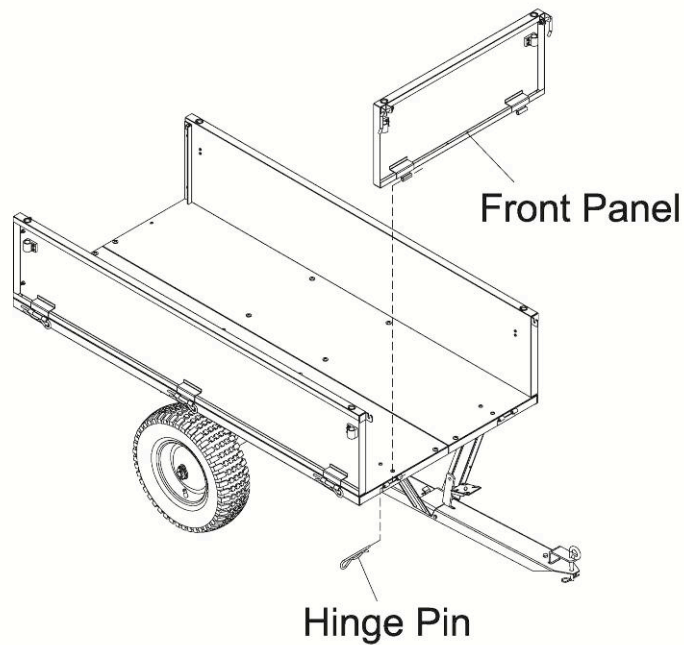

## STEP 8: Attach Rear Panel

1. Slide the rear panel through the slots on the back side panels.

### Rear Panel

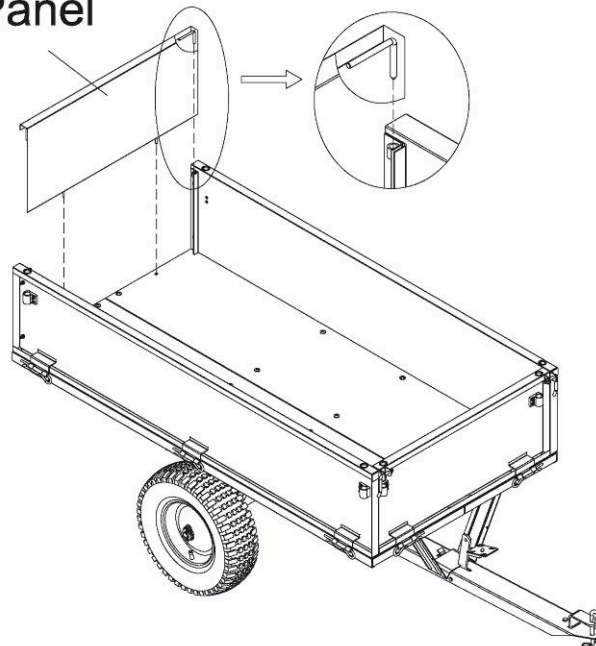

**NOTE:** The rear panel pins must go through the holes on the side panels to lock the panel in place.

## STEP 9: Attach Side Rails and Front Rail

1. Insert the side rails into the two holes on the side panels.
2. Secure the front rail using the two Ø3 R pins.

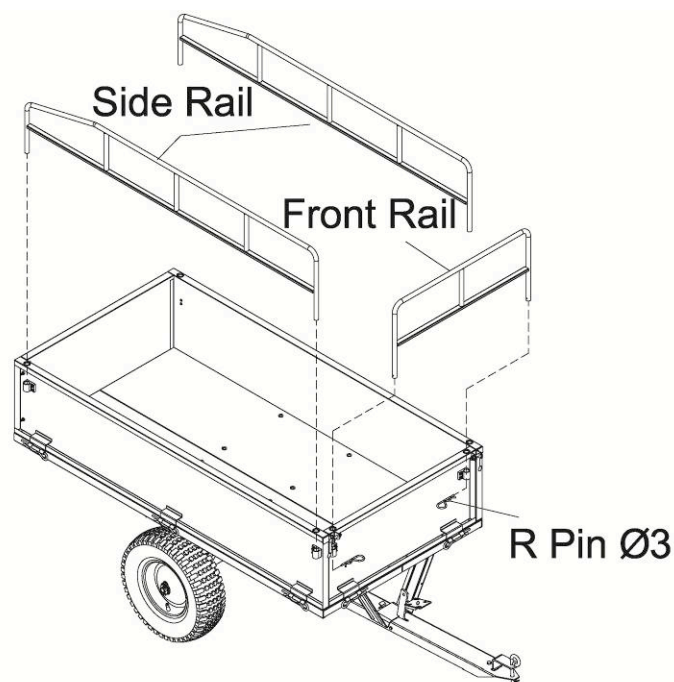

## OPERATION



**WARNING:** Before using the utility dump cart, review the instructions below and safety information. Failure to follow these instructions may result in property damage or injury to the operator or bystanders.

### USING YOUR UTILITY DUMP CART

1. **DO NOT** exceed rated capacity of 1200 lbs. (544.8kg).
2. **ALWAYS** secure and lock the utility cart to the vehicle hitch before operating.
3. **ONLY** use approved vehicles when towing the dump cart (Lawn/Garden Tractors and ATVs)
4. **NEVER** tow the utility dump cart with box raised.
5. **DO NOT** over fill the utility dump cart. Overflow loads can cause the cart and towing vehicle to lose traction and skid out of control.
6. **ONLY** fill the dump cart to a comfortable dumping load. Extremely heavy loads will be difficult to operate and dump.
7. **ALWAYS** use the dump cart for its intended purpose.
8. **ALWAYS** make sure that the tow vehicle and the combined weight of the operator **MUST BE** greater than the load of the cart weight for proper control.
9. **DO NOT** use cart on public highways or roads.
10. **NEVER** exceed 10 MPH when towing the dump cart.
11. **DO NOT** make sharp turns that may cause the Lawn/Garden Tractor or ATV tires to rub against the utility dump cart.
12. **ALWAYS** slow down before turning.
13. **ALWAYS** use caution when backing the utility cart. To prevent the cart from jackknifing, always back up in a straight line.

### MAINTENANCE

- **Maintain your dump cart.** It is recommended that the general condition of any dump cart be examined before it is used. Keep your dump cart in good repair by adopting a program of conscientious repair and maintenance. Have necessary repairs made by qualified service personnel.
- After each use clean material out of the cart box.
- Rinse/dry inside and outside of the dump cart after each use.
- Before operating make sure the tires have the **RECOMMENDED TIRE PRESSURE OF 25 PSI.**
- Regularly grease the axle and the wheel bearing area or when needed.
- Periodically check all fasteners for tightness.
- Annually clean and lightly lubricate parts.
- Use a glossy enamel spray paint to touch up scratched or worn painted metal surfaces.
- Never exceed load capacity rating of 1200 lbs. (544.8kg); doing so will damage the utility dump cart.

### STORAGE

- Never allow material to remain in the utility dump cart for extended periods of time.
- Before storing make sure the cart is clean and dry.
- Store indoors or protected area during severe weather and winter months.
- When storing outside, always keep the tongue a little higher than the back of the cart to allow moisture to easily run out the back; this ensures that moisture will not accumulate in the box.

# DIAGRAM & PARTS LIST

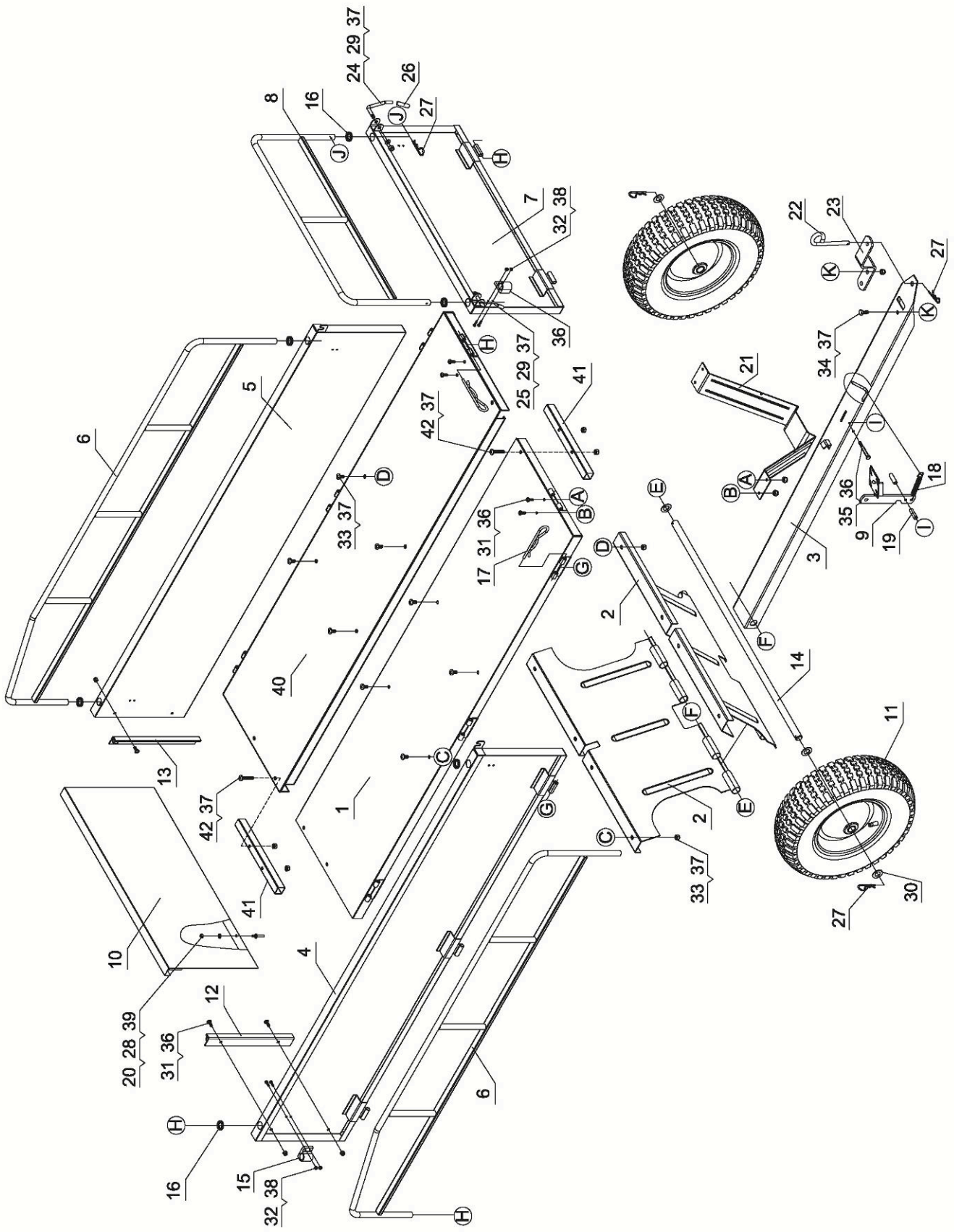

<b>Part#</b>	<b>Description</b>	<b>Qty.</b>	<b>Part#</b>	<b>Description</b>	<b>Qty</b>
1	Left Bottom Panel	1	22	Hitch Pin	1
2	Wheel Axle Support	2	23	Hitch Pin Bracket	1
3	Hitch Tongue	1	24	Handle A	1
4	Left Side Panel	1	25	Handle B	1
5	Right Side Panel	1	26	Handle Sleeve	2
6	Side Rail	2	27	R Pin Ø3	5
7	Front Panel	1	28	Flat Washer Ø6	2
8	Front Rail	1	29	Flat Washer Ø8	2
9	Release Pedal	1	30	Flat Washer Ø20	4
10	Rear Panel	1	31	Screw M6x16	8
11	Wheel Assembly	2	32	Screw M4x16	12
12	Left Card Slot of Rear Panel	1	33	Screw M8X16	8
13	Right Card Slot of Rear Panel	1	34	Hex Bolt M8x20	1
14	Wheel Axle	1	35	Hex Bolt M6x95	1
15	Rail Clamp	6	36	Nylon Lock Nut M6	9
16	Protection Ring	6	37	Nylon Lock Nut M8	15
17	Hinge Pin	8	38	Nylon Lock Nut M4	12
18	Latch Spring	1	39	Hex Nut M6	2
19	Spacer	2	40	Right Bottom Panel	1
20	Pin	2	41	Support Tube	2
21	Tongue Support	1	42	Screw M8X40	4

For replacement parts and technical questions, please call **1-800-222-5381**.

# WARRANTY

One-year limited warranty



Distributed by  
Northern Tool + Equipment Co., Inc.  
Burnsville, Minnesota 55306-6936  
[NorthernTool.com](http://NorthernTool.com)  
Made in China