

# Electric Hoist Frame

## Owner's Manual

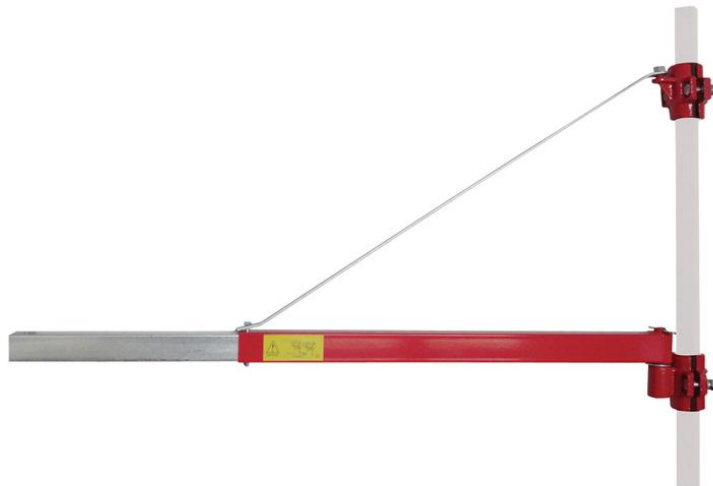

**⚠ WARNING:** Read carefully and understand all ASSEMBLY AND OPERATION INSTRUCTIONS before operating. Failure to follow the safety rules and other basic safety precautions may result in serious personal injury.

**Item # 19236**

Thank you very much for choosing product!

For future reference, please complete the owner's record below:

Serial Number/LotDate Code: \_\_\_\_\_

Purchase Date: \_\_\_\_\_

Save the receipt, warranty, and this manual. It is important that you read the entire manual to become familiar with this product before you begin using it.

This **electrichoist frame** is designed for certain applications only. The distributor cannot be responsible for issues arising from modification or use of this product in an application for which it was not designed. We strongly recommend that this product not be modified and/or used for any application other than that for which it was designed. If you have questions about a particular modification or application, DO NOT use the product until you have first contacted the distributor to determine if the product can or should be modified or used in such an application.

For technical questions, please call **1-800-222-5381**.

## Table of Contents

Intended Use.....	4
Technical Specifications.....	4
Important Safety Considerations.....	5
Assembly.....	7
Before Each Use.....	7
Operating Instructions.....	8
After Each Use.....	8
Maintenance.....	8
Parts Diagram.....	9
Parts List.....	9
Replacement Parts.....	10
Limited Warranty.....	10

## Intended Use

Electric Hoist Frame adds versatility to your electric hoist while increasing productivity. Frame mounts to a steel post (not included) and allows electric hoist applications in the shop, warehouse or garage. Conveniently swings out of the way when not in use. Includes all mounting hardware.

## Technical Specifications

- Hoist frame extension tube is 1 3/4in. square

Property	Specification
Capacity (lbs.)	1320
Arm Length (in.)	43 5/8 (extended)
Extension Width (in.)	1 3/4 (square)
Mounting Hardware Included	YES

## **⚠ WARNING**

- Read and understand all instructions. Failure to follow all instructions may result in serious injury.
- The warnings, cautions, and instructions in this manual cannot cover all possible conditions or situations that could occur. Exercise common sense and caution when using this tool. Always be aware of the environment and ensure that the tool is used in a safe and responsible manner.
- DO NOT allow persons to operate or assemble this product until they have read this manual and have developed a thorough understanding of how the product works.

**SAVE THESE INSTRUCTIONS**

## Important Safety Considerations

- **DO NOT** modify the product in any way. Unauthorized modification may impair the function and/or safety and could affect the life of the product. There are specific applications for which the product was designed.
- **Use the right tool for the job.DO NOT** attempt to force a small equipment to do the work of larger industrial equipment. There are certain applications for which this equipment was designed. It will do the job better and more safely at the capacity for which it was intended. **DO NOT** use this equipment for a purpose for which it was not intended.
- **Industrial or commercial applications must follow OSHA requirements.**

## **⚠ WARNING**

### **WORK AREA SAFETY**

- Inspect the work area before each use. Keep work area clean, dry, free of clutter, and well lit. Cluttered, wet, or dark work areas can result in injury. Using the tool in confined work areas may put you dangerously close to other cutting tools and rotating parts.
- Do not use the tool where there is a risk of causing a fire or an explosion; e.g., in the presence of flammable liquids, gases, or dust. The tool can create sparks, which may ignite the dust or fumes.
- Do not allow the tool to come into contact with an electrical source. The tool is not insulated and contact will cause electrical shock.
- Keep children and bystanders away from the work area while operating the tool. Do not allow children to handle the tool.
- Be aware of all power lines, electrical circuits, water pipes, and other mechanical hazards in your work area. Some of these hazards may be below the work surface hidden from your view and may cause personal harm or property damage if unintentionally contacted.

### **PERSONAL SAFETY**

- Stay alert, watch what you are doing, and use common sense when operating the tool. Do not use the tool while you are tired or under the influence of drugs, alcohol, or medication. A moment of inattention while operating the tool may result in serious personal injury.
- Dress properly. Do not wear loose clothing, dangling objects, or jewelry. Keep your hair, clothing and gloves away from moving parts. Loose clothes, jewelry, or long hair can be caught in moving parts. Air vents on the tool often cover moving parts and should be avoided.
- Use safety apparel and equipment. Use ANSI-approved safety goggles or safety glasses with side shields, or when needed, a face shield. Use a dust mask in dusty work conditions. Also use non-skid safety shoes, hardhat, gloves, dust collection systems, and hearing protection when appropriate. This applies to all persons in the work area.
- Do not overreach. Keep proper footing and balance at all times.
- Remove adjusting keys or wrenches before connecting the tool to the air supply or turning on the tool. A wrench or key that is left attached to a rotating part of the tool may cause personal injury.
- Secure the work with clamps or a vise instead of your hand when practical. This safety precaution allows for proper tool operation using both hands.

## **⚠ CAUTION**

### **TOOL USE AND CARE**

- Do not force the tool. Tools do a better and safer job when used in the manner for which they are designed. Plan your work, and use the correct tool for the job.
- Check for damaged parts before each use. Carefully check that the tool will operate properly and perform its intended function. Replace damaged or worn parts immediately. Never operate the tool with a damaged part.
- Do not use a tool with a malfunctioning switch. Any power tool that cannot be controlled with the power switch is dangerous and must be repaired by an authorized service representative before using.
- Disconnect the air supply from the tool and place the switch in the locked or off position before making any adjustments, changing accessories, or storing the tool. Such preventive safety measures reduce the risk of starting the tool accidentally.
- Store the tool when it is not in use. Store it in a dry, secure place out of the reach of children. Inspect the tool for good working condition prior to storage and before re-use.
- Use only accessories that are recommended by the manufacturer for use with your tool. Accessories that may be suitable for one tool may create a risk of injury when used with another tool. Never use an accessory that has a lower operating speed or operating pressure than the tool itself.
- Keep guards in place and in working order. Never operate the tool without the guards in place.
- Do not leave the tool running unattended.
- Inspect the tool, hose, and accessories for damage or excessive wear before each use. If you find damage do not use the tool.

## **Assembly**

- According to the operation height, firstly install the lower supporting seat (3) on the vertical supporting steel pipe with an outside diameter of 48mm and a wall thickness of more than 3mm, then connect the clamp block (1) and the lower supporting seat (3) with M12×55 bolts (18), M12 nuts (15), □12 spring washer (16) and flat washer (17) and fix them together. (The tightening force of the bolt should be more than 65N.m).
- Fix the upper supporting seat (2) and the clamp block (1) on the supporting steel pipe in the same way. Pay attention that the two supporting seats must be in the same direction and the vertical distance between their connecting bolts is 485mm.
- Overlap the hole on the end of the supporting rack post (4) into the rotation shaft of the upper supporting seat (2) and screw up M14 locking nut (19).
- Insert the rotation shaft of the external rack pipe (5) into the hole of the lower supporting seat (3), insert the flat washer (8) in the middle and fix with the split pin (14). Then insert the internal rack pipe (7) into the external rack pipe (5) (the side with the hole faces outwards), and insert the round stop block (6), connect the supporting rack post (4) and the internal and external rack pipes (7) and (5) with M10×70 bolt (13), M10 nut (10), Ø10 spring washer (11) and flat washer (12) and fix them together. (The bolt must pass through the round stop block.)

## **Before Each Use**

Before operation, carefully check all the structural parts and make sure that the supporting steel pipe must be firm, all the structural parts of the rack must not be damaged or have cracks and the fastener must not loosen.

## Operating Instructions

- Before operation, carefully check all the structural parts and make sure that the supporting steel pipe must be firm, all the structural parts of the rack must not be damaged or have cracks and the fastener must not loosen.
- The supporting steel pipe must be vertical so as to make the rack turn smoothly toward the right. The axis of the rack pipe must be in the horizontal position so as to make the steel cable wind neatly.
- Within the distance range of 745mm away from the rotation shaft of the rack, the maximum sling weight is 600kg. This moment fix the hoist on the external rack pipe with the fixing ring 1 (large size). (The internal rack pipe must not be drawn out.)(See Figure B)
- When it slings the weight of 300kg of below, the distance can be lengthened to 1100mm. This moment fix the hoist on the internal rack pipe with the fixing ring 2 (small size). (Pay attention that 10×70 bolt must pass through the round stop block on dismounting and the spacing pin(9) must be installed).(See Figure C)
- The weight to sling must not exceed the max. load rating valve.
- When it slings a weight, no person is permitted to stand under the rack.
- Caution: The fixing ring 1 (large size) and the fixing ring 2 (small size) are the parts for installing electric hoist but not the accessories of the rack. Be sure to take notes to distinguish them on installation.

## After Each Use

- Periodically check the supporting steel pipe so as to make sure there are no phenomena of rocking and bending, etc.
- Often check every structural part of the rack so as to make sure there are no conditions of damaging and cracking etc.

## Maintenance

Maintain your tool. It is recommended that the general condition of any tool be examined before it is used. Keep your tool in good repair by adopting a program of conscientious repair and maintenance in accordance with the recommended procedures found in this manual.

- Periodically check the supporting steel pipe so as to make sure there are no phenomena of rocking and bending, etc.
- Often check every structural part of the rack so as to make sure there are no conditions of damaging and cracking etc.
- Before using the rack, you must check every fixed position so as to make sure it can't loosen.
- If there is any abnormal situation, you must immediately stop using it and overhaul or replace it.
- You must be ready to pay attention to the rigidity and verticality of  $\varnothing 48$  steel pipe.
- It is strictly forbidden to use two electric hoists to sling or support a weight simultaneously.

## Parts Diagram

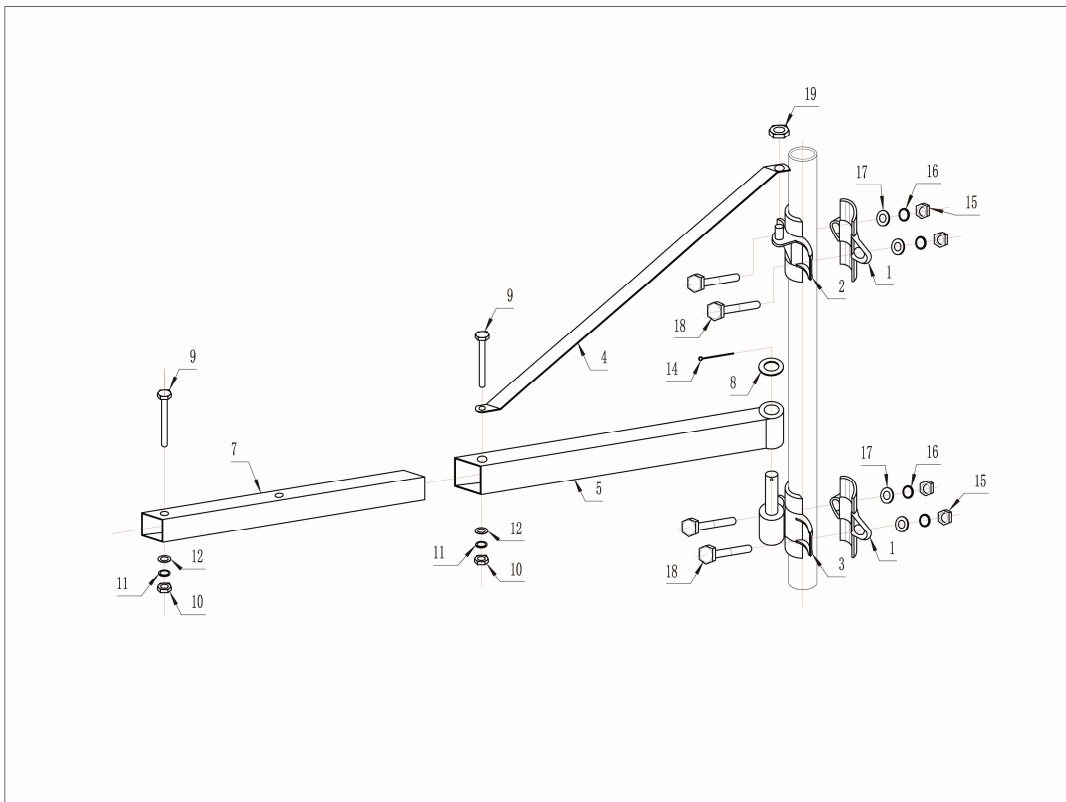

## Parts List

Part No.	Description	Quantity
1	Clamp Block	2
2	Upper Supporting Seat	1
3	Lower Supporting Seat	1
4	Supporting Rack Post	1
5	External Rack Pipe	1
7	Internal Rack Pipe	1
8	Flat Washer	1
9	M10×70 Bolt	2
10	M10 Nut	2
11	∅10 Spring Washer	2
12	∅10 Flat Washer	2
14	Open Pin	1
15	M12 Nut	4
16	∅12 Spring Washer	4
17	∅12 Flat Washer	4
18	M12×55 Bolt	4
19	M14 Locking Nut	1

## **Replacement Parts**

- For replacement parts and technical questions, please call Customer Service at **1-800-222-5381**.
- Not all product components are available for replacement. The illustrations provided are a convenient reference to the location and position of parts in the assembly sequence.
- When ordering parts, the following will be required: Model Number, Serial Number/Lot Date Code, and Description.
- The distributor reserves the rights to make design changes and or improvements to product lines and manuals without notice.

## **Limited Warranty**

One-Year Limited Warranty

Distributed by  
Northern Tool and Equipment Company, Inc.  
Burnsville, Minnesota 55306  
NorthernTool.com

Made in China