



### PROCESS



Air Plasma Cutting

**5/3/1**  
**INDUSTRIAL**  
**WARRANTY**



### MILD STEEL CUTTING CAPACITY\* (Thickness to scale.)

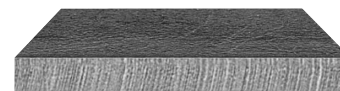

**Quality** 3/16 in (4.2 mm)

### Maximum Quality Cutting Capacity

Good-quality cut achieved at lower speeds.

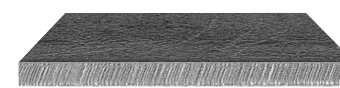

**Rated** 1/8 in (3.2 mm)

### Rated Cutting Capacity

10 inches per minute (minimum speed at which an operator achieves a smooth, steady cut using a hand-held torch).

\* Same ratings for stainless and aluminum.

### Comes Complete With:

- ICE-12C 20 ft (6.1 m) hand-held torch
- Heavy-duty work clamp with 20 ft (6.1 m) cable
- 10 ft (3 m) power cord with 115 VAC plug
- Extra consumables (2 tips, 2 electrodes)

### Applications

- Sheet metal
- Auto body repair
- Plumbing
- HVAC
- Home hobby

### FEATURES

### BENEFITS

<b>Unique non-stick drag shield</b>	Allows drag cutting without a standoff.
<b>Portable for all your applications</b>	With a built-in piston-driven air compressor the AirForce 250A comes complete — ready to cut, right out of the box. The complete unit weighs 50 lbs, offering the operator a high level of portability and convenience.
<b>Wide range line voltage capacity</b>	The AirForce 250A provides excellent cutting capability from 98 to 132 volts (115 V ±15%). This makes it easy to cut even when your primary power drops or when extension cords are used.
<b>In-Rush Current Control Circuit</b>	Patented In-Rush Current Control Circuit protects the unit in case of wrong voltage hook-up or voltage overload.
<b>Duty cycle to meet the challenge</b>	The AirForce 250A's 35% duty cycle is tested at 40° Celsius (104° Fahrenheit) to give you the cutting power whenever you need it. Duty cycle of a machine tends to increase as the temperature decreases. Hobart rates its product in high temperature conditions to ensure the performance you expect, even in hot environments.
<b>Heavy-duty industrial compressor</b>	Hobart's robust, built-in piston-driven compressor provides long life and superior airflow.
<b>ICE-12C torch</b>	The rugged ICE-12C torch, with patented trigger safety guard, is ergonomically built and includes drag tips for convenient cutting on all metals.
<b>Constant Pilot Arc Control</b>	The patented Constant Pilot Arc Control helps the operator minimize tip burnout by eliminating the need to restart the arc at the beginning of each new cut.
<b>Diagnostic lights for quick trouble-shooting</b>	Simple informative LED lights for end-user convenience regarding unit readiness, duty cycle, parts-in-place, and input voltage indication.
<b>Hobart's 5/3/1 Warranty</b>	No other manufacturer offers a better warranty than Hobart does. Power source is warranted for <b>three years</b> , parts and labor. Original rectifier parts have a <b>five-year</b> warranty and the ICE torches have a <b>one-year</b> parts and labor warranty.

### SPECIFICATIONS (SUBJECT TO CHANGE WITHOUT NOTICE.)



Rated Output	Max. Open-Circuit Voltage	Amps Input at Rated Output, 60 Hz, Single-Phase			Dimensions	Net Weight with torch	Ship Weight
		120 V	KVA	KW			
12 Amps at 110 VDC, 35% Duty Cycle	325 VDC	20	2.4	2.0	H: 13-1/2 in (343 mm) W: 8-1/2 in (216 mm) D: 16 in (406 mm)	50 lb (22.6 kg)	55 lb (24.9 kg)



**Hobart Welders** An Illinois Tool Works Company

U.S. Distributor Sales Phone 920-735-4576 FAX 800-637-2315  
 Hobart Retail Sales Phone 800-332-3281 FAX 937-332-4161  
 Canadian Sales Phone 888-489-9353 FAX 519-421-0480  
 International Sales Phone 920-735-4509 FAX 920-735-4125

Web Site [www.HobartWelders.com](http://www.HobartWelders.com)



## CUTTING PERFORMANCE

To determine the maximum rated cutting thickness of mild steel, follow the line from the 10 IPM (inches per minute) point on the cutting chart. The point at which this line intersects the cutting curve determines the maximum recommended production cutting thickness of the unit.

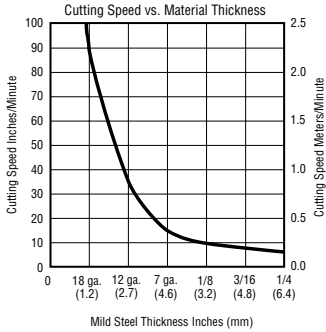

*Note: The rating is based on 10 IPM because this is the minimum speed at which the operator achieves a smooth, steady cut when using a hand-held torch.*

## TORCH CONSUMABLES (Order from Hobart Service Parts.)

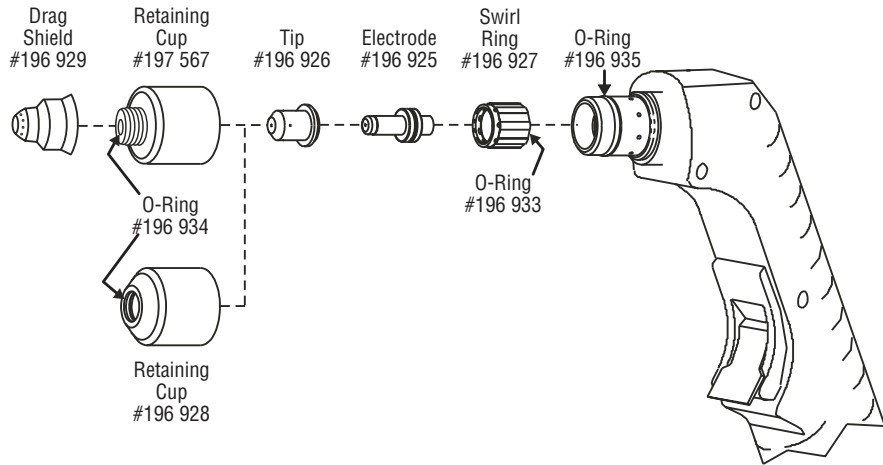

## ACCESSORIES

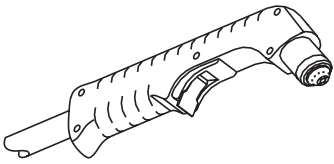

**Replacement Torch #195 172**  
20 ft (6.1 m) ICE-12C hand-held torch.

**Standoff Roller Guide #194 883**  
Helps maintain recommended standoff distance to maximize cutting performance and improve life.



**Plasma Circle-Cutting Guide #195 981**  
Cut straight lines or circles up to 12 in diameter with ease.



**Suction/Magnetic Pivot Base #195 979**  
Add this to your cutting guide for convenient attachment to all flat surfaces. The extended arm accommodates holes up to 30 in diameter.

## ORDERING INFORMATION AND SYSTEM CHECKLIST

Power Source	Stock No.	Description	Qty.	Price
<b>AirForce 250A</b>	<b>#500 437</b>	Single-phase, 115 VAC, 60 Hz		
UPC: #715959232814; Shipping Weight: 55 lb; Carton Dimensions: 13 x 22 x 16 in; Pallet Qty: 6				
<i>Note: Shipping via UPS not recommended.</i>				
<b>Accessories</b>				
Replacement Torch	<b>#196 923</b>	ICE-12C hand-held torch		
Standoff Roller Guide	<b>#194 883</b>			
Plasma Circle-Cutting Guide	<b>#195 981</b>			
Suction/Magnetic Pivot Base	<b>#195 979</b>			

Date:

Total Quoted Price:

# HOBART

W E L D E R S

## DISTRIBUTED BY: