



M1579011A.1

ITEM NUMBER: 1579011

SERIAL NUMBER: _____

Owner's Manual

Instructions for Assembly, Testing, Operation, Servicing, and Storage

Water recovery system: Outdoor pressure washer accessory used to filter and remove oil sheen from water.

⚠ WARNING

READ and UNDERSTAND the Owner's Manual completely before using this water recovery system. Assemble, test, and use only in accordance with the Owner's Manual instructions.

READ and FOLLOW warning label instructions.

WEAR personal protective gear when using, cleaning, and servicing the water recovery system.

ALWAYS connect to properly GFCI grounded receptacle.

DO NOT drink filtered water.

DO NOT REUSE filtered water.

ALWAYS keep a fire extinguisher rated "ABC" nearby.

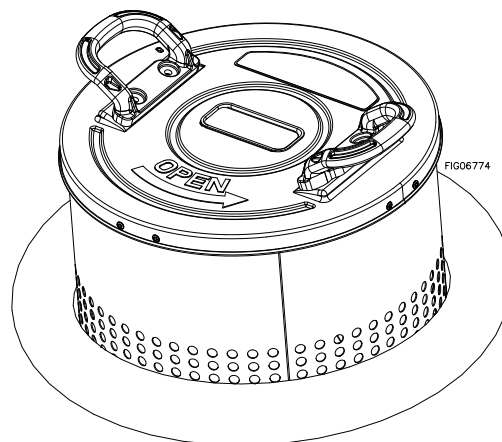

Any Questions, Comments, Problems, or Parts Orders
Call NorthStar Product Support 1-800-270-0810

Hazard Signal Word Definitions





	<p>This is the safety alert symbol. It is used to alert you to potential personal injury hazards. Obey all safety messages that follow this symbol to avoid possible injury or death.</p>
	<p>DANGER (red) indicates an imminently hazardous situation which, if not avoided, will result in death or serious injury.</p>
	<p>WARNING (orange) indicates a potentially hazardous situation which, if not avoided, could result in death or serious injury.</p>
	<p>CAUTION (yellow) indicates a potentially hazardous situation which, if not avoided, may result in minor or moderate injury.</p>
	<p>CAUTION (yellow) used without the safety alert symbol indicates a potentially hazardous situation which, if not avoided, may result in property damage.</p>

fig01453

Table of Contents

Intended Use	4
Summary of Important Safety Information	5
Warning Label Locations	6
Unpacking	7
Assembly	
Step One: Install pump (not included)	8
Step Two: Install handles to lid	9
Step Three: Install lid and lock into place	10
Machine Components	11
Operation	
Preparing the Water Recovery System	12
Using the Water Recovery System	13
Troubleshooting	14
Specifications	15
Exploded View	16
Limited Warranty	17
California Proposition 65 Information	18

Intended Use

The water recovery system is intended for use in separating oil and debris from water.

About Your Water Recovery System

This water recovery system is designed for use with a 7-inch submersible utility pump (not included). It is designed to remove particulates and oil sheen from water.

The technical specifications for your water recovery system are provided in the Specifications section of this manual.

Follow all safety precautions presented throughout this manual.

Any Questions, Comments, Problems, or Parts Orders
Call NorthStar Product Support 1-800-270-0810

Summary of Important Safety Information

⚠ WARNING

Read and understand **this owner's manual** completely before using the water recovery system.

Improper use of the water recovery system could result in injury for the operator or nearby persons/animals. This unit must be plugged into a proper GFCI outlet.

LISTED BELOW is a summary of safety information of particular importance. See individual sections of this owner's manual for more details.

----- **BEFORE OPERATION** -----

- **READ MANUAL.** Do not allow anyone to operate the water recovery system who has not read the Owner's Manual or has not been instructed on the safe use of the water recovery system.
- **REVIEW SAFETY RULES.** Before starting this water recovery system, review the instructions for safe operation.

----- **DURING ASSEMBLY** -----

- **DO NOT MODIFY** the water recovery system design.

----- **DURING OPERATION** -----

- **INSPECT and PREPARE** water recovery system before each use as directed in this manual.
- **DO NOT RUN** the water recovery system while unattended.
- **SEE** the Troubleshooting section of this manual before attempting any repairs. Wear personal protective equipment and follow safety instructions.
- **TURN OFF** the water recovery system before transporting.
- **DO NOT drink** filtered water.
- **DO NOT REUSE** filtered water.

Warning Label Location

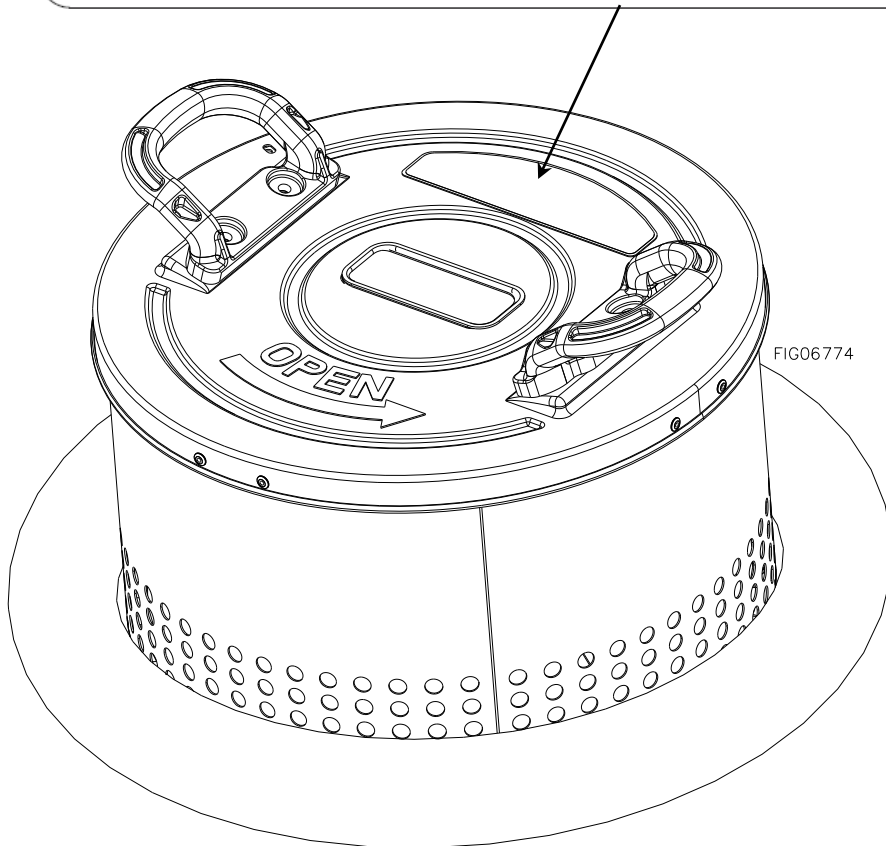
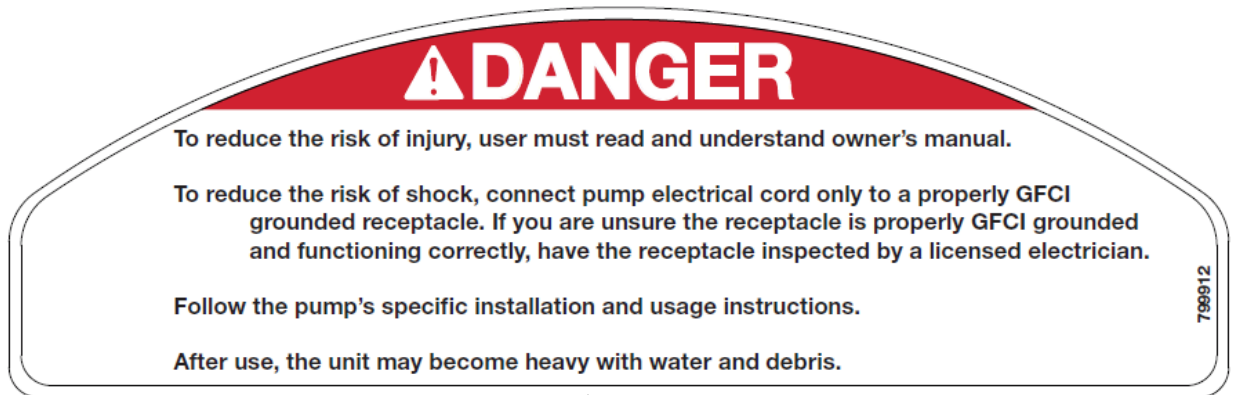

Part#	Description
799912	Warning Label

Always make sure safety labels are in place and in good condition. If a safety label is missing or not legible, order new labels or unsafe operation could result.
To order replacement safety labels, call NorthStar Product Support at 1-800-270-0810.

Unpacking

Closely inspect all contents in the shipping carton.

- If you have missing or damaged components, please contact NorthStar Product Support at 1-800-270-0810.

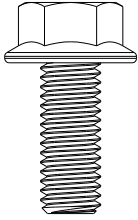

M8 x 20mm Bolt
82717
(Qty 4)

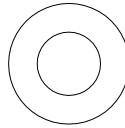

M8 Flat washer
82718
(Qty 4)

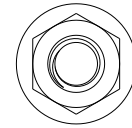

M8 Serrated flange nut
82719
(Qty 4)

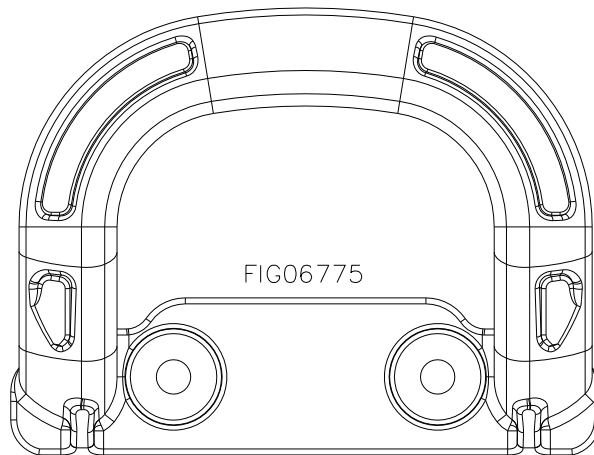

Handle
798525
(Qty 2)

Assembly

Step 1 – Install pump (not included)

- Insert 7" submersible utility pump into the center of the water recovery system base.

Tools Needed

- None

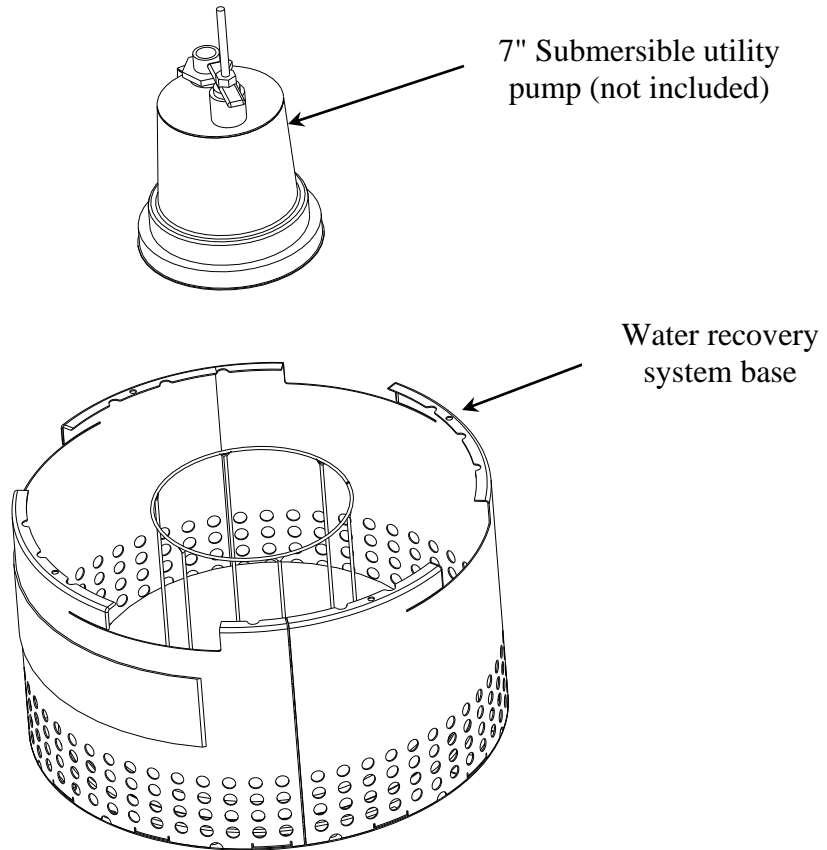

FIG06777

Assembly

Step 2 – Install handles to lid

- Install (2) handles to lid using (4) M8 x 20mm bolts, (4) M8 flat washers, and (4) M8 nyloc nuts. Handle with lanyard attached should be on the side with the pin hole.

Tools Needed

- 1/2" wrench

Fasteners Needed from Owner's Manual Bag

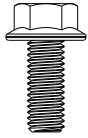

M8 x 20mm Bolt
82717
(Qty 4)

M8 Flat washer
82718
(Qty 4)

M8 Serrated flange nut
82719
(Qty 4)

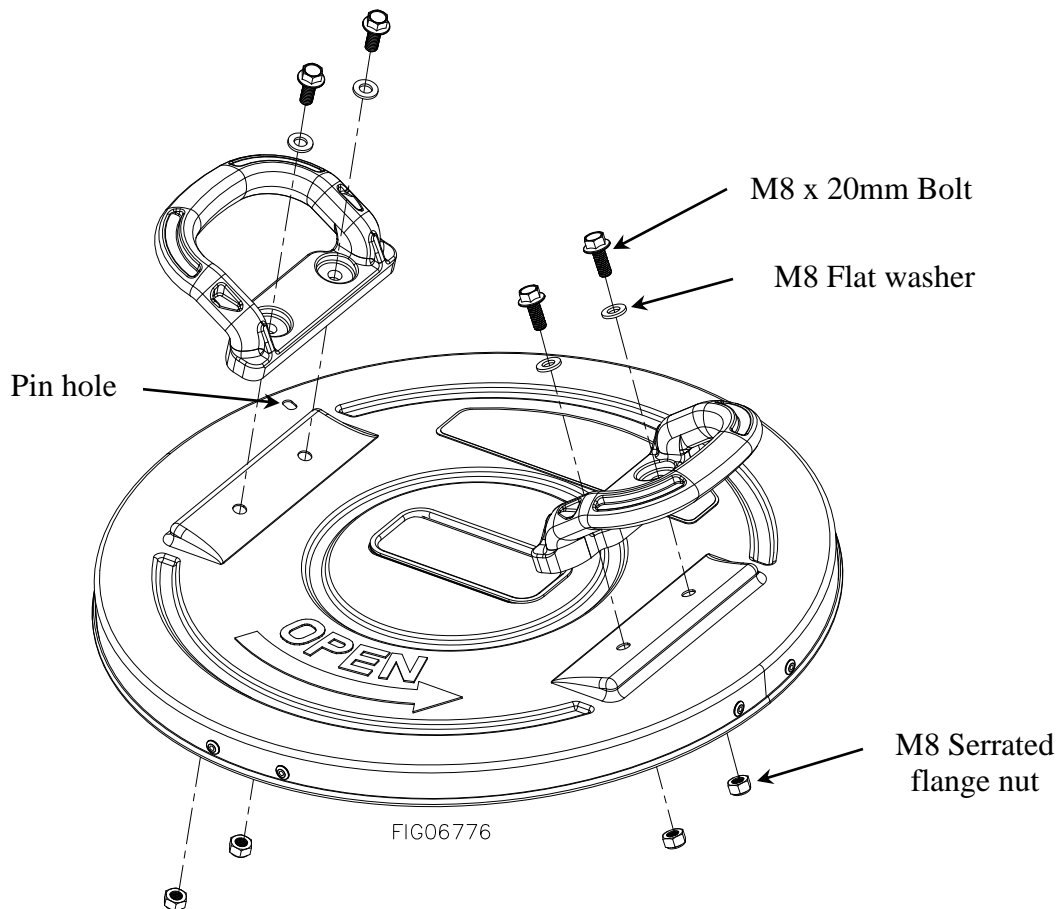

Assembly

Step 3 – Install lid and lock into place

- Line up the base cutouts with lid flanges and route the pump wire through the center of the lid. Set the lid onto the base.
- Turn the lid clockwise to lock.
- Secure the lid by inserting the pin through the lid.

Tools Needed

- None

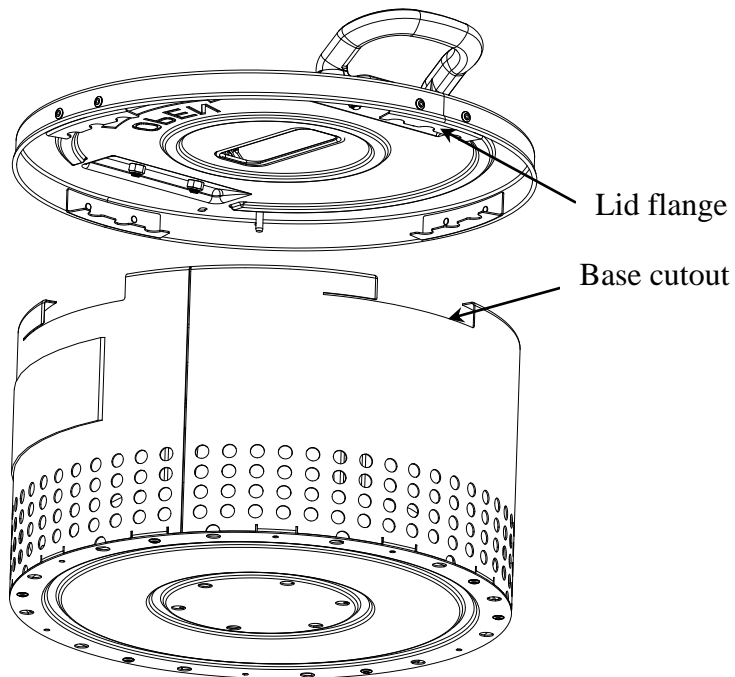

FIG06778

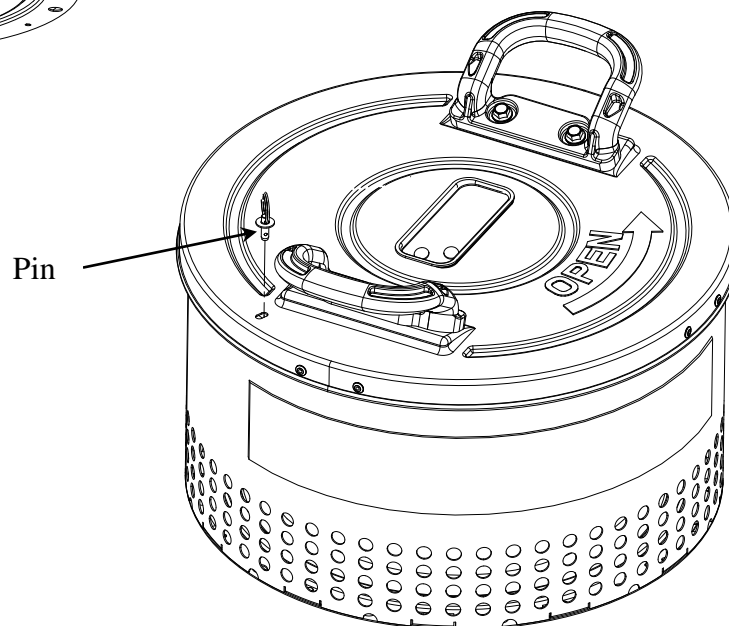
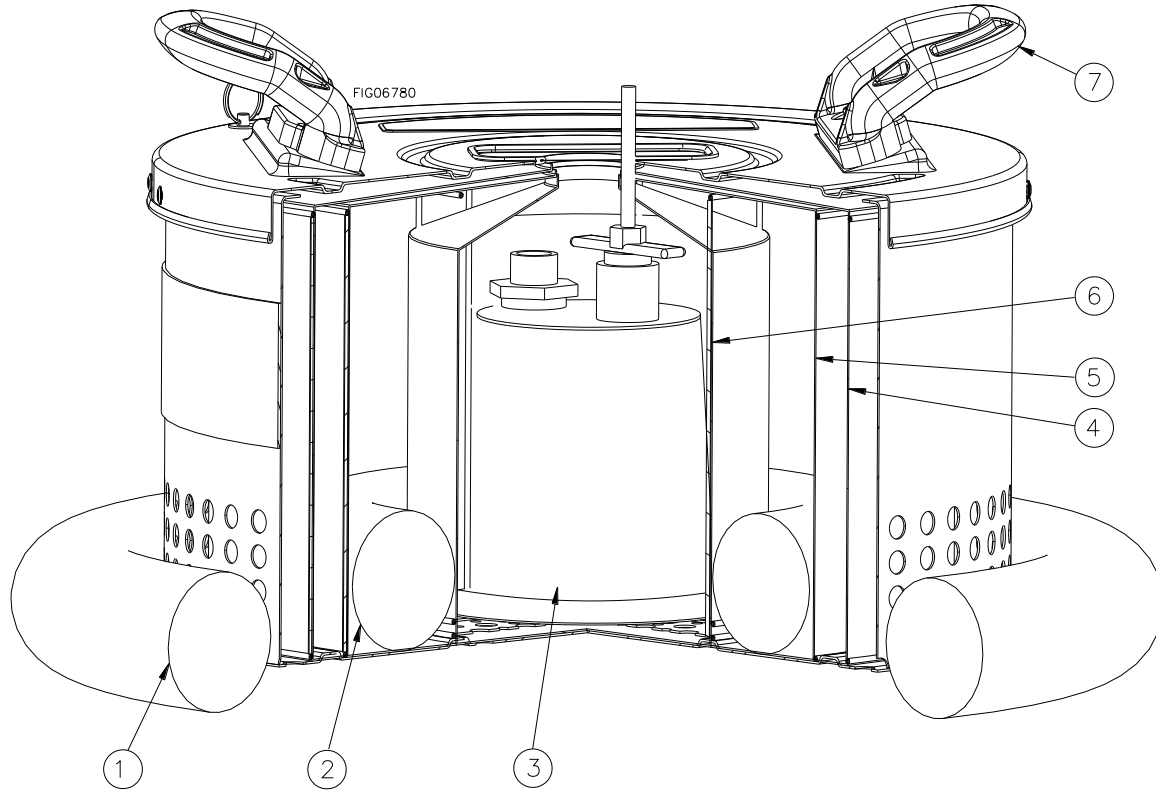

FIG06779

Machine Components



1. **Outer oil-only absorbent sock.** Removes oil sheen.
2. **Inner oil-only absorbent sock.** Removes oil sheen.
3. **Submersible utility pump (not included).** Water recovery system is designed to fit a 7" submersible utility pump.
4. **800-Micron outer filter bag.** Removes debris from water before it reaches the pump.
5. **200-Micron middle filter bag.** Removes debris from water before it reaches the pump.
6. **100-Micron inner filter bag.** Removes debris from water before it reaches the pump.
7. **Handles.** Heavy-duty handle for transporting the water recovery system.

Operation – Preparing the Water Recovery System

If the water recovery system has been used previously, it must be prepared BEFORE EACH SUBSEQUENT USE.

⚠ WARNING

- Read instructions below carefully for inspecting and preparing the water recovery system.
- Damaged or clogged equipment could result in leaks or poor performance.

Important safety rules:

- **Power off.** Make sure all power is OFF before cleaning, inspecting, or servicing.
- **Replacement parts.** If a part needs replacement, only use parts that meet the manufacturer's specifications. Replacement parts that do not meet specifications may result in a safety hazard or poor operation.

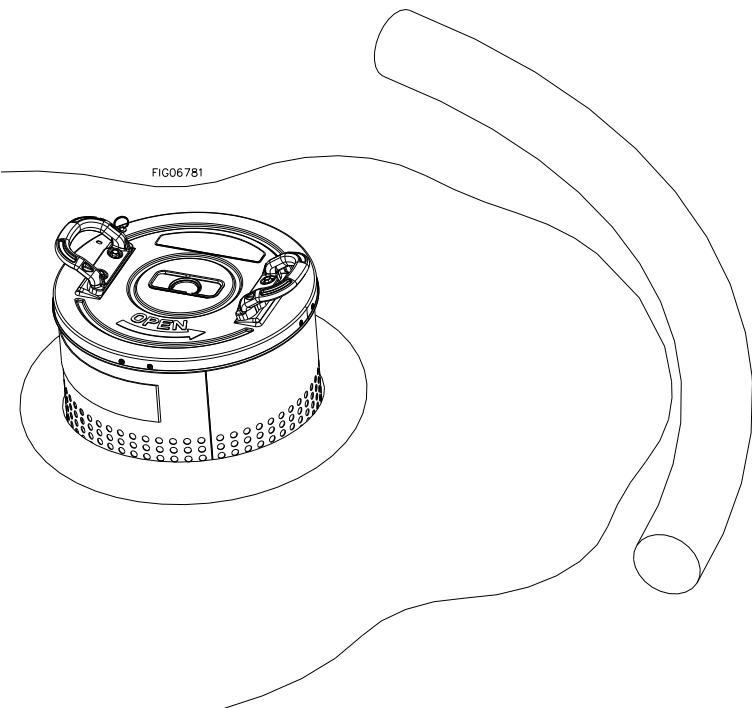
1. Inspect & repair	<p>Inspect and test the water recovery system thoroughly:</p> <ol style="list-style-type: none"> a) Inspect filter bags for holes. Replace any bags with holes. b) Inspect socks for full saturation. Replace socks that are fully saturated. c) Inspect pump, hose, and fittings for any damage. See pump manual for any pump related issues. Replace any hose or fittings that are damaged or leaking. <p><i>IMPORTANT: After any repair work has been done, ALWAYS test for leaks with water one final time before using.</i></p>
2. Prep work area	<p>Dry sweep the area to remove large debris before washing.</p> <p>Place the water recovery system in a dammed off area. Arrange water barriers to minimize the possibility of accidental runoff into storm drains.</p> <div style="text-align: center; margin-top: 20px;">  <p style="font-size: small; margin-top: 5px;">FIG06781</p> </div>
3. Run hose to tank	<p>Run hose from the water recovery system to a recovery tank (hose and tank are not included).</p>

Operation – Using the Water Recovery System

⚠ WARNING

- ALWAYS wear personal protective equipment.
- Long pants and sleeves, chemical-resistant gloves, and eye protection are strongly recommended.

1. Review safety information	Review the safety information in the owner’s manual and on the product warning label
2. Wear personal protective equipment	Wear personal protective equipment. Long pants and sleeves, chemical-resistant gloves, and eye protection are strongly recommended.
3. Turn on power	Plug pump into a GFCI outlet. To comply with the national electric code, the water recovery system should only be connected to a receptacle that is protected by a ground fault circuit interrupter (GFCI). <i>Note: The pump will start automatically when plugged in. Make sure the unit and hose are in place before plugging in.</i>
4. Leaving unattended	If the water recovery system must be left unattended at any time, disconnect power.
5. Discontinue use if clogged or inoperative	If the water recovery system becomes clogged or inoperative during use, discontinue use immediately. - DO NOT attempt to service while chemicals are in the water recovery system and power is connected. - Review the troubleshooting section before attempting to service.

Clean the water recovery system and decontaminate after use.

When you are finished using the water recovery system, it is important to clean and decontaminate yourself and the water recovery system.

⚠ WARNING

- Clean-up procedures must be followed after each use.
- Improper equipment clean-up and disposal of chemicals can result in dangerous chemical exposure to humans and the environment, as well as equipment damage.

1. Rinse filter bags	Filter bags should be rinsed after every use. PPE should be used while handling. Replace filter bags if a clog cannot be removed or if there are any holes. <i>Note: It is recommended to keep a supply of replacement filters on hand.</i>
2. Dispose of captured water	Properly dispose of captured water per local codes. Use the same guidelines for disposing of fully saturated socks.
3. Storage	Rinse the water recovery system thoroughly before storing.

Troubleshooting

⚠ WARNING

Before troubleshooting or attempting to service, read the following safety rules.

Before attempting to service the water recovery system:

1. Personal protective equipment	Wear personal protective equipment (PPE) while servicing. Long pants and sleeves, chemical-resistant gloves, and eye protection are strongly recommended.
2. Review troubleshooting table	Review the troubleshooting table below for the type of problem you are experiencing. However, DO NOT attempt to repair until the steps listed below are followed.
3. Disconnect power	Disconnect power to the water recovery system. DO NOT attempt any repairs while the system is still connected to power.
5. Perform repairs	Follow the directions provided in the troubleshooting table to repair the water recovery system.

PROBLEM	CAUSE	SOLUTION
Oil no longer being absorbed	Socks are fully saturated	Replace socks
Debris no longer being filtered	Hole in filter bag	Replace filter bags
Slow water recovery rate	Clogged filter(s)	Clean or replace filter bags
Pump will not turn on	See pump manual	See pump manual

Specifications

Maximum Recovery Rate	10.0 GPM (37.9 liters/min.)
Mesh Sizes	800 Micron 200 Micron 100 Micron
Overall Dimensions	18" x 18" x 12" (45.7cm x 45.7cm x 30.5cm)
Dry Weight*	22 lbs. (9.98kg)
<i>*does not include pump</i>	
Recommended Pump Specifications:	
Maximum pump diameter	7"
Maximum pump height	9"
Water recovery depth	As shallow as possible to maximize recovered water
Component Materials	
Housing.....	Stainless steel
Handles.....	Polypropylene
Filter bags.....	Nylon
Socks.....	Fibrous glass wool

The manufacturer reserves the right to make improvements in design and/or changes in specifications at any time without incurring any obligation to install them on units previously sold.

Any Questions, Comments, Problems or Parts Orders
Call NorthStar Product Support 1-800-270-0810

Exploded View

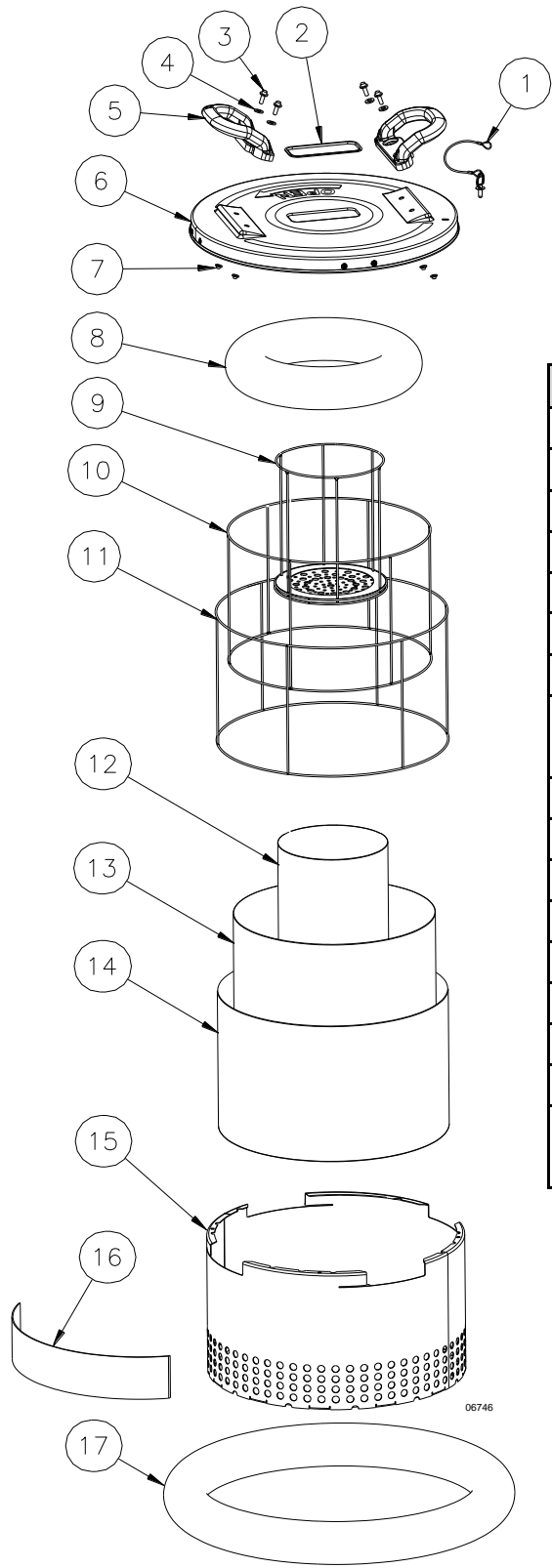

Ref #	Part #	Description	Qty
1	799428	Locking pin & lanyard	1
2	799405	Rubber trim	1
3	82717	M8 x 20mm Bolt	4
4	82718	M8 Flat washer	4
5	798525	Handle	2
6	800289	Lid, includes trim and decal	1
7	82719	M8 Serrated flange nut	4
8	79559	Oil-only sock, 36" – sold in packages of 10pcs	1
9	799698	Pump cage	1
10	799523	Inner cage	1
11	799522	Outer cage	1
12	1579012	100 Micron bag	1
13	1579013	200 Micron bag	1
14	1579014	800 Micron bag	1
15	800098	Outer shell & base	1
16	800525	NorthStar decal	1
17	79560	Oil-only sock, 75" – sold in packages of 10pcs	1

Limited Warranty

Dear Valued Customer:

The NorthStar Product you just purchased is built with the finest material and craftsmanship. Use this product properly and enjoy the benefits from its high performance. By purchasing a NorthStar product, you show a desire for quality and durability. Like all mechanical equipment this unit requires a due amount of care. Treat this unit like the high-quality piece of machinery it is. Neglect and improper handling may impair its performance. Please thoroughly read the instructions and understand the operation before using your product.

Limited Warranty

NorthStar shall warranty any piece of equipment manufactured, or parts of equipment manufactured, to be free from defects in material or workmanship for a period of 1 year for noncommercial/nonrental use and a period of 90 days for commercial/rental use from the date of purchase by user.

NorthStar shall warranty any wear item, including, but not limited to, valves, seals, pump diaphragms, hoses, and filter elements to be free from defects in material or workmanship for a period of 90 days from the date of purchase by user. This warranty applies to the original purchaser of the equipment and is non-transferable. Verification of purchase is the responsibility of the buyer. Parts will be replaced or repaired at no charge, except when the equipment has failed due to lack of proper maintenance. Any misuse, abuse, alteration or improper installation or operations will void warranty. Determining whether a part is to be replaced or repaired is the sole decision of NorthStar.

NOTE: Some services performed by parties other than NorthStar may void warranty.

This warranty covers parts only. It will not provide for replacement of complete products due to defective parts.

Components not manufactured by NorthStar are guaranteed by their manufacturer and can be serviced at factory-authorized locations near you. Any costs incurred due to replacement or repair of items outside of a NorthStar approved facility is the responsibility of the buyer and not covered under warranty. NorthStar can supply you with the service center location in your area.

This warranty specifically excludes the following; failure of parts due to damage caused by accident, fire, flood, windstorm, acts of God, applications not approved by NorthStar in writing, corrosion caused by chemicals, use of replacement parts which do not conform to manufacturer's specifications, and damage caused by vandalism. Additional exclusions: loss of running time, inconvenience, loss of income, or loss of use, including any implied warranty of merchantability of fitness for a specific use.

Warranty does not cover items subject to normal wear such as oil socks, filters, or any part subject to direct physical contact by the public. This warranty does not cover any personal injury or damage to surrounding property caused by failure of any part.

This warranty is in lieu of any other warranty expressed or implied and NorthStar assumes no other responsibility or liability outside that expressed within this warranty.

Please fill in the following information and have it on hand when you call in on a warranty claim.

Customer Number: _____

Date of Purchase: _____

NorthStar Serial Number: _____

Item Number: _____

⚠️WARNING: This product can expose you to chemicals including glass wool fibers (inhalable and biopersistent, which is known to the State of California to cause cancer.

For more information go to www.P65Warnings.ca.gov.



Manufactured by
Northern Tool & Equipment Company, Inc.
Burnsville, Minnesota 55306
www.northerntool.com
Made in China