



Service Jacks

Operating Instructions & Parts Manual

Model Number	Capacity
HW93657	4 Ton
HW93667 (Air/Manual)	4 Ton
HW93660	10 Ton
HW93662 (Air/Manual)	10 Ton



**Made in the
U.S.A.**

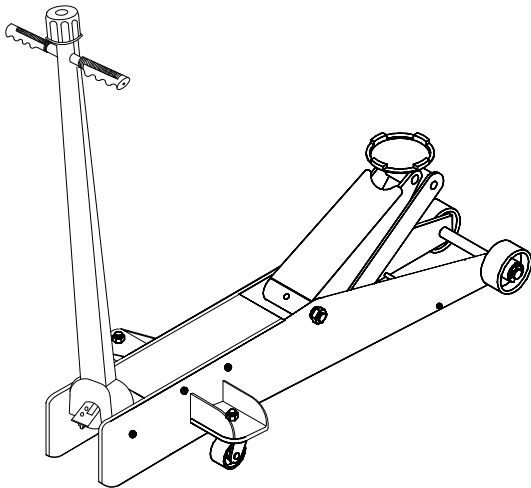

Model No. HW93657 & HW93660

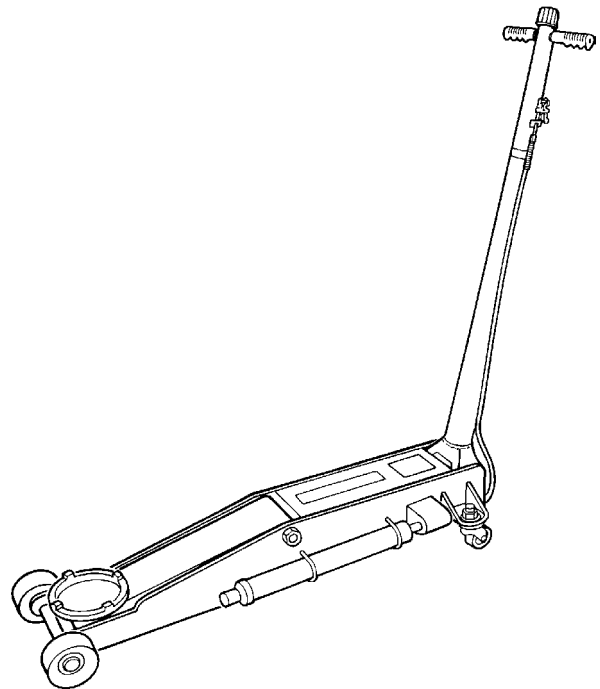

Model No. HW93667 & HW93662



This is the safety alert symbol. It is used to alert you to potential personal injury hazards. Obey all safety messages that follow this symbol to avoid possible injury or death.

SFA Companies
10939 N. Pomona Ave. Kansas City, MO 64153
816-891-6390 customerservices@heinwerner-automotive.com

Read this manual and follow all the Safety Rules and Operating Instructions before using this product.

SAFETY and GENERAL INFORMATION

Save these instructions. For your safety *read, understand, and follow* the information provided with and on this jack. The owner and operator of this equipment shall have an understanding of this jack and safe operating procedures before attempting to use. The owner and operator shall be aware that use and repair of this product may require special skills and knowledge. Instructions and safety information shall be conveyed in the operator's native language before use of this jack is authorized. If any doubt exists as to the safe and proper use of this jack, remove from service immediately.

Inspect before each use. Do not use if broken, bent, cracked, or damaged parts (including labels) are noted. Any jack that appears damaged in any way, operates abnormally or is missing parts, shall be removed from service immediately and the manufacturer notified. If you suspect that the jack was subjected to a shock load (a load dropped suddenly, unexpectedly upon it), immediately discontinue use until the jack has been checked by a factory authorized service center (contact distributor or manufacturer for list of Authorized Service Centers). It is recommended that an annual inspection be done by qualified personnel. Replace worn or damaged parts with Hein-Werner Authorized Replacement Parts only. Labels and owner's manuals are available from manufacturer.

PRODUCT DESCRIPTION

Hein-Werner Hydraulic Service Jacks are designed to lift, not support, rated capacity loads consisting of one end of a vehicle. Immediately after lifting, the load must be supported by a pair of appropriately rated jack stands.



Never use hydraulic jack as a stand alone device. After lifting, immediately support the lifted load with a pair of appropriately rated jack stands.

SPECIFICATIONS

Model	Capacity	Min. Height	Max. Height	Chassis Length	Wheel to Wheel Width	Min. Air Pressure for Rated Load	Gross Weight
HW93657	4 Ton	5 1/4"	26"	48 1/4"	12"	N/A	222 lb.
HW93667						140 psi	237 lb.
HW93660	10 Ton	5 7/8"		53 3/8"	17"	N/A	420 lb.
HW93662						140 psi	430 lb.

WARNING

- **Study, understand, and follow** all printed materials provided with/on this product before use.
- **Do not** exceed rated capacity.
- **This is a lifting device only!**
- **Immediately** after lifting, support the load with **a pair** of appropriately rated jack stands.
- Use only on hard, level surfaces capable of supporting rated capacity loads.
- On air actuated unit, never wire, clamp or otherwise disable the lift control valve to function by other than operator's hand.
- Do not use adapters or accessories that are not provided initially.
- Lift only on areas of the vehicle as specified by the vehicle manufacturer.
- Do not move or dolly loads with this device.
- No alterations shall be made to this product.
- Failure to heed these markings may result in personal injury and/or property damage.

WARNING

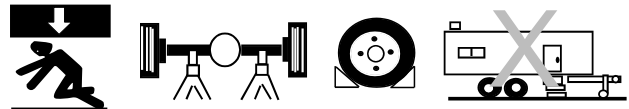

To avoid **crushing and related injuries**:

- **Never** work on, under or around a load supported only by hydraulic jack.
- **Always** use adequately rated jack stands.
- Chock each unlifted tire in both directions.
- **Do not** use this device to lift, level, lower, support nor move a house, mobile home, travel trailer, camper or any building structure.
- **Be alert** and **sober** when using this product. Do not operate under the influence of drugs or alcohol.

ADVERTENCIA

- Leer, comprender, y seguir las instrucciones antes de utilizar el aparato.
- El manual de instrucciones y la información de seguridad deben estar comunicado en lengua del operador antes del uso.
- No seguir estas indicaciones puede causar daños personales o materiales.

ASSEMBLY

Equipment needed

1. Needle nose locking pliers
2. Snap-ring pliers (Model HW93657 & HW93667 only)
3. 15 /16" wrench (Model HW93660 & HW93662 only)
4. Hammer
5. Tape measure
6. All necessary hardware is included and is assembled loosely onto the jack

Instructions

1. For HW93657 and HW93667: (see figure 1) Remove the retaining rings and the handle pin from the jack base that connects through the handle fork.
For HW93660 and HW93662: (see figure 2) Remove the 5/16-18 bolts and the handle pin from the jack base that connects through the handle fork.
2. Remove the #6-32 screw and nut from the universal receptacle.
3. Pull the universal assembly out a minimum of 1-3/4".
4. Clamp the needle nose locking pliers onto the rod so that the universal assembly will not retract back into the handle.
5. Slide the universal assembly into the handle socket so that it extends out the other side.
6. Push the pivot pin that was removed in step 1 back through the handle and handle socket (may have to gently tap the pin with a hammer).
7. For HW93660 & HW93662, align the pivot pin with the holes on the side plates that the pivot pin was removed from and tighten the 5/16"-18 bolts into the pivot pin until secure.
8. Connect the universal assembly to the universal receptacle rod using the #6-32 screw and nut (finger tighten only).
9. Remove the needle nose locking pliers.
10. Jack is now operational and ready for use.

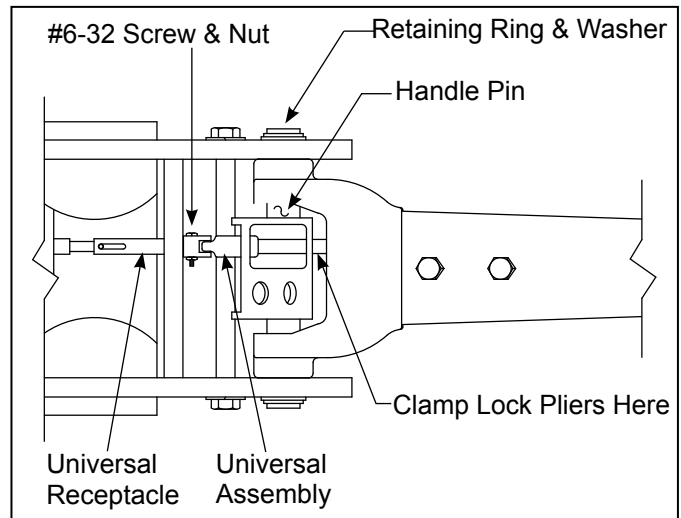

Figure 1- Assembly Illustration for HW93657 & HW93667

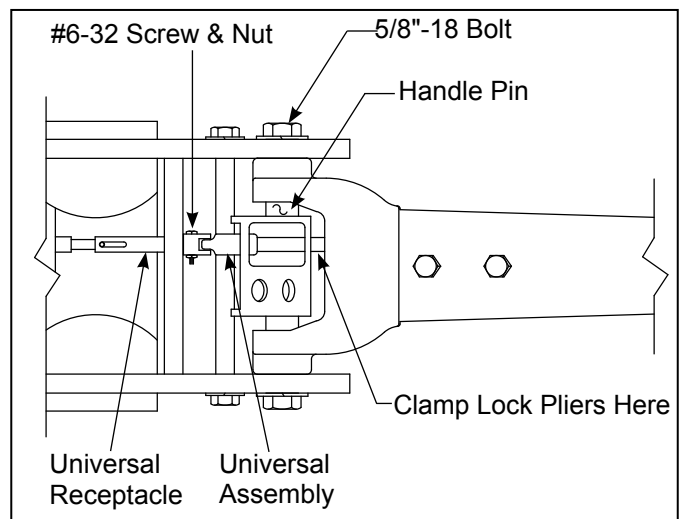

Figure 2- Assembly Illustration for HW93660 & HW93662

PREPARATION (REFER TO FIGURES 3 & 4)

Before Use

1. Verify that the product and application are compatible, if in doubt call Hein-Werner technical service.
2. Before use, read the operator's manual completely and familiarize yourself thoroughly with the product, its components and recognize the potential hazards associated with its use.
3. To familiarize yourself with the basic operation of these jacks, locate and turn the release valve knob:
 - a. Clockwise until firm resistance is felt to further turning. This is the '**CLOSED**' release valve position used to **raise** the load.
 - b. Counter-clockwise, but no more than 1/2 full turn from the closed position. This is the '**OPEN**' release valve position used to lower the load. The more you turn the release valve knob Counter-clockwise, the **faster** the load descends.
4. With saddle fully lowered, locate and remove cover plate, then remove air vent screw. Pump the operating handle through 6 to 8 full strokes. Check the oil level. Ensure the oil level is within ~3/16" from the inner cylinder as viewed from the air vent screw hole.
5. Reinstall the air vent screw.
6. Check to ensure that the jack rolls freely. Raise and lower the unloaded saddle throughout the lift range before putting into service to ensure the pump and release valve operate smoothly.
7. Replace worn or damaged parts and assemblies with Hein-Werner Replacement Parts only. Lubricate as instructed in Maintenance Section.

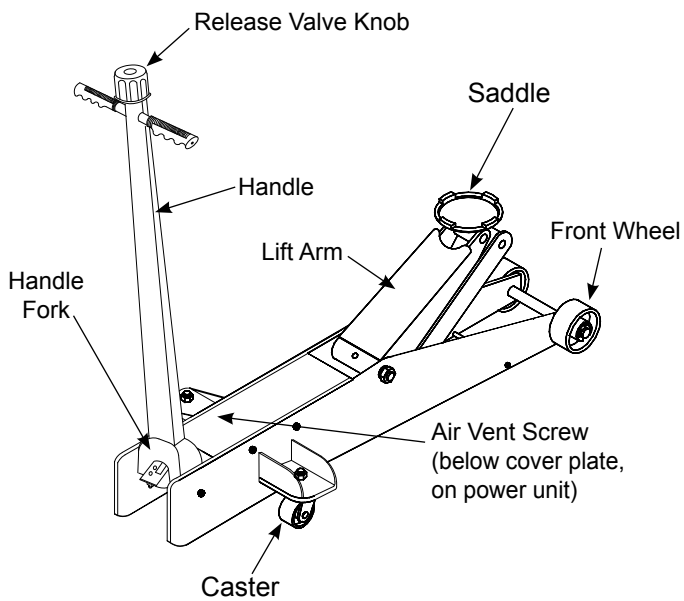

Figure 3 - Model HW93657 & HW93660 Nomenclature

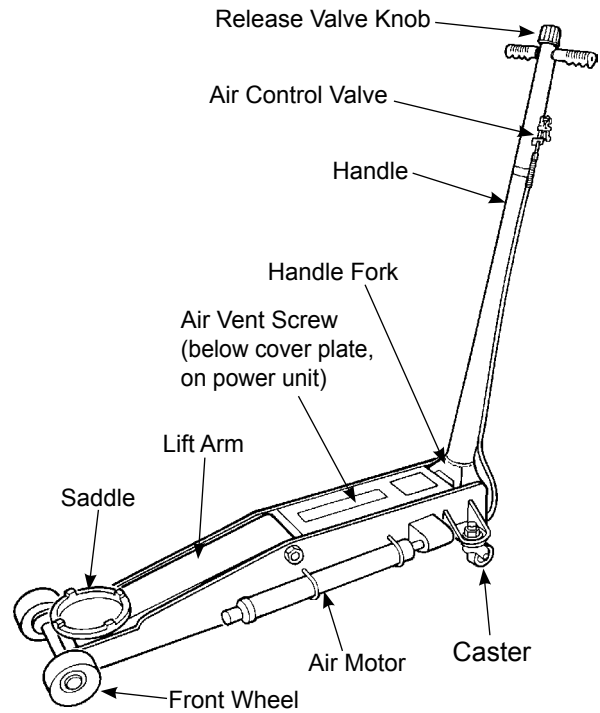

Figure 4 - Model HW93667 & HW93662 Nomenclature

OPERATION

Lifting



Only attachments and/or adapters supplied by the manufacturer shall be used. Lift only on areas of the vehicle as specified by the vehicle manufacturer.

1. Follow the vehicle manufacturer's recommended guidelines for lifting. Engage the emergency brake and chock each unlifted wheel in both directions to prevent inadvertent vehicle movement.
2. Locate and close the release valve by turning the release valve knob clockwise until firm resistance is felt.
3. Refer to the vehicle manufacturer owner's manual to locate approved lifting points on the vehicle. Center jack saddle under lift point.
4. Verify lift point then use handle pump to contact lift point. To lift, pump handle or squeeze air control valve (model HW93667 & HW93662) until load reaches desired height.
5. Transfer the load **immediately** to appropriately rated jack stands.



NEVER use hydraulic jack as a stand alone device! **ALWAYS** transfer the lifted load **IMMEDIATELY** to a pair of appropriately rated jack stands. Use one pair of jack stands per vehicle. Rated capacity is per pair only! Do not exceed rated capacity.



Overloading may cause hydraulic system failure.

Lowering



*Be sure all tools and personnel are clear before lowering load. **Slowly open the release valve!** The more you turn the release valve knob counter-clockwise, the faster the load will come down. **Maintain control** of the rate of speed at which the load lowers at all times!*

1. Raise load high enough to clear the jack stands.
2. Remove jack stands, carefully. (**always** used in pairs).
3. **Slowly** turn the release valve knob counter-clockwise, but no more than 1/2 full turn. If the load fails to lower:
 - a. Use another jack to raise the vehicle high enough to reinstall jack stands.
 - b. Remove the malfunctioning jack and then the jack stands.
 - c. Using the functioning jack, lower the load by turning the release valve knob counter-clockwise, but no more than 1/2 full turn.
4. After removing jack from under the load, push saddle down to reduce ram exposure to rust and contamination.

MAINTENANCE

Important: Use only a good grade hydraulic jack oil. Avoid mixing different types of fluid and **Never** use brake fluid, turbine oil, transmission fluid, motor oil or glycerin. Improper fluid can cause failure of the jack and the potential for sudden and immediate loss of load. We recommend Hein-Werner hydraulic jack oil HW 93291 or equivalent.

Adding oil

1. Lower saddle fully.
2. Set jack in its upright, level position.
3. Locate and remove air vent screw.
4. Fill with oil until ~3/16" above the inner cylinder as seen from the air vent screw hole.
5. Reinstall the air vent screw.

Changing oil

For best performance and longest life, replace the complete hydraulic fluid at least once a year.

1. Lower saddle fully.
2. Remove the air vent screw.
3. Lay the jack on its side and drain the fluid into a suitable container.

Note: Dispose of hydraulic fluid in accordance with local regulations.

4. Fill with oil until ~3/16" above the inner cylinder as seen from the air vent screw hole.
5. Reinstall the air vent screw.

Lubrication

A periodic coating of light lubricating oil to pivot points, axles and hinges will help to prevent rust and assure that wheels, castors and pump assemblies move freely.

Cleaning

Periodically check the pump piston and ram for signs of rust or corrosion. Clean as needed and wipe with an oily cloth.

Note: Never use sandpaper or abrasive material on these surfaces!

Storage

Lower the saddle to its lowest position when not in use.

TROUBLESHOOTING

Symptom	Possible Causes	Corrective Action
Jack will not lift load	<ul style="list-style-type: none">• Release knob not tightly closed• Overload condition	<ul style="list-style-type: none">• Ensure release knob tightly closed• Remedy overload condition
Jack bleeds off after lift	<ul style="list-style-type: none">• Hydraulic unit malfunction	<ul style="list-style-type: none">• Discontinue use, contact Hein-Werner Technical Service
Jack will not lower after unloading	<ul style="list-style-type: none">• Reservoir overfilled• Linkages binding• Fluid level low	<ul style="list-style-type: none">• Drain fluid to proper level• Clean and lubricate moving parts• Ensure proper fluid level
Will not lift to full extension	<ul style="list-style-type: none">• Fluid level low	<ul style="list-style-type: none">• Ensure proper fluid level

REPLACEMENT PARTS (refer to page 6 thru 19)

Not all components of the jack are replacement items, but are illustrated as a convenient reference of location and position in the assembly sequence. When ordering parts, give model number, part number and parts description. Call or write for current pricing: Hein-Werner Customer Support, 10939 N. Pomona Ave. Kansas City, MO 64153. Phone: (816)891-6390; E-mail: customerservices@heinwerner-automotive.com

Model HW93657 Replacement Parts Illustration Part I (refer to parts list on page 8)

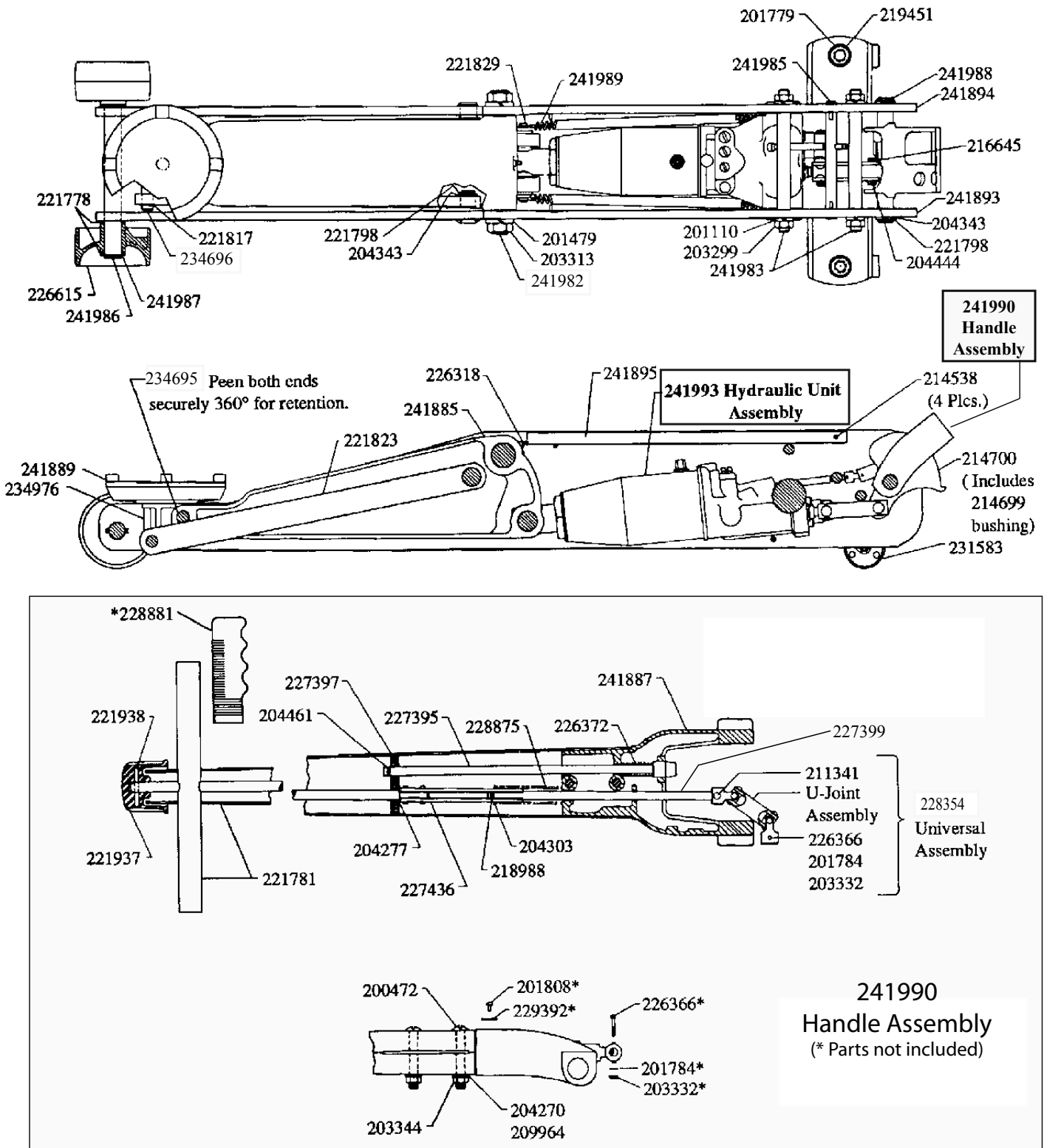

Figure 5 - Parts Illustration for Model HW93657

Model HW93657 Replacement Parts Illustration Part II - Hydraulic Unit (refer to parts list on page 8)

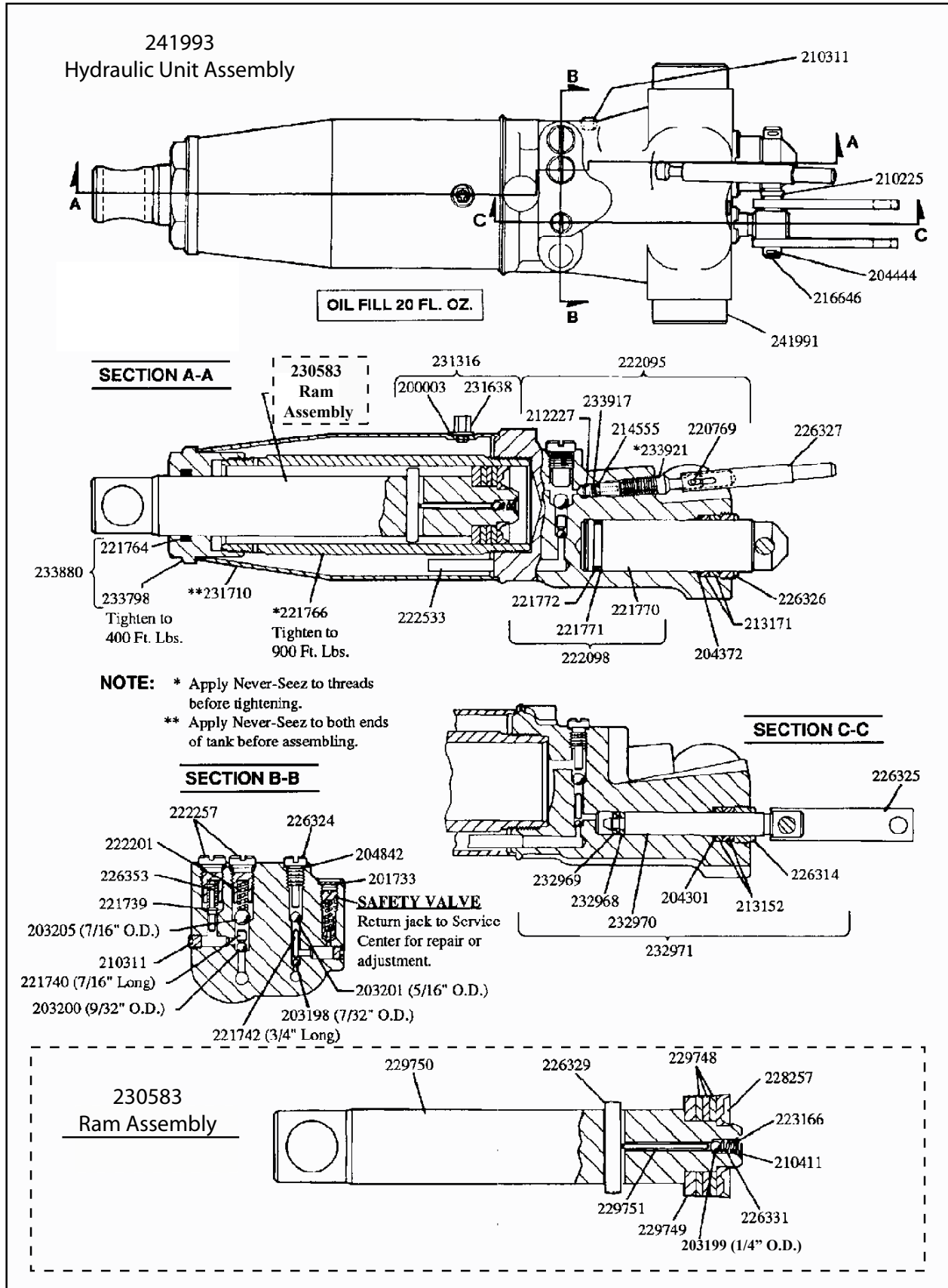

Figure 6 - Parts Illustration for Model HW93657 (Hydraulic Unit)

Model HW93657 Replacement Parts List (refer to figures on page 6 & 7)

<u>Part#</u>	<u>Description</u>	<u>Qty.</u>	<u>Part#</u>	<u>Description</u>	<u>Qty.</u>	<u>Part#</u>	<u>Description</u>	<u>Qty.</u>
200003*	Gasket	1	221742	Ball Stop Plug (3/4" L)	1	230583	Ram Assy.	1
200472	Screw	2	221764*	Ram Quad Ring	1	231316	Vent Valve Assy.	1
201110	Lockwasher	4	221766	Cylinder	1	231583	Rear Caster	2
201479	Lockwasher	2	221770	Low Pressure Pump	1	231638	Filler Screw	1
201733	Plug	1	221771*	Washer	1	231710	Oil Tank	1
201779	Lockwasher	2	221772*	Quad ring	1	232968*	Back-up Washer	1
201784	Lockwasher	1	221778	Washer	4	232969*	U-cup	1
201808	Rivet	2	221781	Handle and Cross Bar	1	232970	Pressure Pump	1
203198*	Ball (7/32" O.D.)	1	221798	Retainer Ring	4	232971	Pressure Pump Kit	1
203199*	Ball (1/4" O.D.)	1	221817	Retainer Ring	2	233798	Tank Nut	1
203200*	Ball (9/32" O.D.)	1	221823	Parallel Link	2	233880	Tank Nut and Quad Ring	1
203201*	Ball (5/16" O.D.)	1	221829	Pin	1	233917*	Plastic Spring	1
203205*	Ball (7/16" O.D.)	1	221937	Turning Knob	1	233921	Release Stem	1
203299	Jam Nut	4	221938	Roll Pin	1	234695	Bellcrank Pin 3/4x3.38	1
203313	Jam Nut	2	222095	Release Stem Kit	1	234696	Parallel Link Pin	1
203332	Nut	1	222098	Speed Pump Assy.	1	234976	Cap Housing	1
203344	Jam Nut	2	222201*	Spring	1	241885	Bellcrank	1
204270	Washer	2	222257	Plug Poppet Valve	2	241887	Handle Socket	1
204277	Washer	1	222533*	Screen	2	241889	Lift cap	1
204301	Washer	1	223166*	Ram Screen	1	241893	Sideplate Assy	1
204303	Washer	1	226314	Gland Nut	1	241894	Sideplate Assy	1
204343	Washer	4	226318	Grease Fitting	1	241895	Hydraulic Unit Cover	1
204372	Washer	1	226324	Pressure Plug	1	241907	Repair Kit (Hyd. Unit)	-
204444	Cotter Pin	3	226325	Pump Link	2	241982	Fulcrum Pin	1
204461	Cotter Pin	1	226326	Nut	1	241983	Sideplate Tie Rod	2
204842*	Copper Gasket	1	226327	Slotted Tube	1	241985	Support Rod	1
209964	Lockwasher	2	226329	Pin	1	241986	Front Axle	1
210225	Spacer	1	226331*	Spring	1	241987	Retainer Ring	2
210311	Pipe Plug	3	226353*	Spring	1	241988	Handle Pivot Pin	1
210411*	Washer	1	226366	Hex Head Bolt	1	241989	Extension Spring	2
211341	Rivet	1	226372	Spring	1	241990	Handle Assy.	1
212227	Release Valve	1	226615	Front Wheel	2	241991	Hydraulic Unit Casting	1
213152*	Packing Ring	2	227395	Plunger Assy.	1	241993	Hydraulic Unit Assy.	1
213171*	Packing Ring	2	227397	Release Link	1			
214538	Groove Pin	4	227399	Extension Rod	1			
214555*	O-ring	1	227436	Turning Rod Assy.	1	HW93657-K0	Label Kit (not shown)	
214699	Bushing	1	228257*	U-cup	1	HW93657-M0		
214700	Handle Segment Assy.	1	228354	Universal Assy.	1			
216645	Pin	1	228875	Spring	1			
216646	Pump Pin	1	228881	Grip	2			
218988	Roll Pin	1	229392	Serial Plate	1			
219451	Hex Nut	2	229748*	Heel Plate	3			
220769	Cross Pin	1	229749	Washer	1			
221739*	Poppet	1	229750	Ram	1			
221740	Ball Stop Plug(7/16" L)	1	229751	Pin	1			

(*) Items included in Repair Kit 241907

Model HW93660 Replacement Parts Illustration Part I (refer to parts list on page 11)

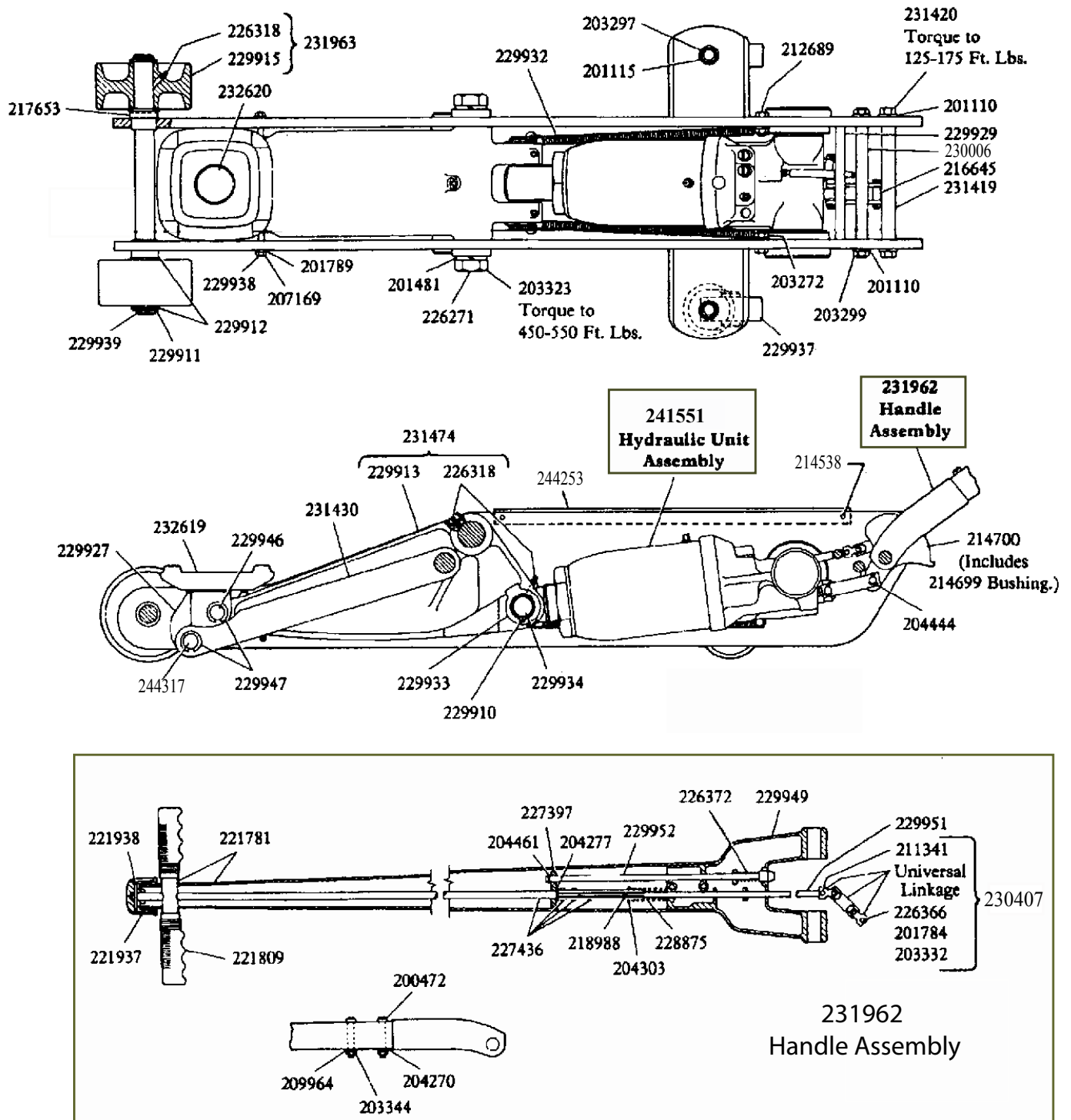

Figure 7 - Parts Illustration for Model HW93660

Model HW93660 Replacement Parts Illustration Part II - Hydraulic Unit (refer to parts list on page 11)

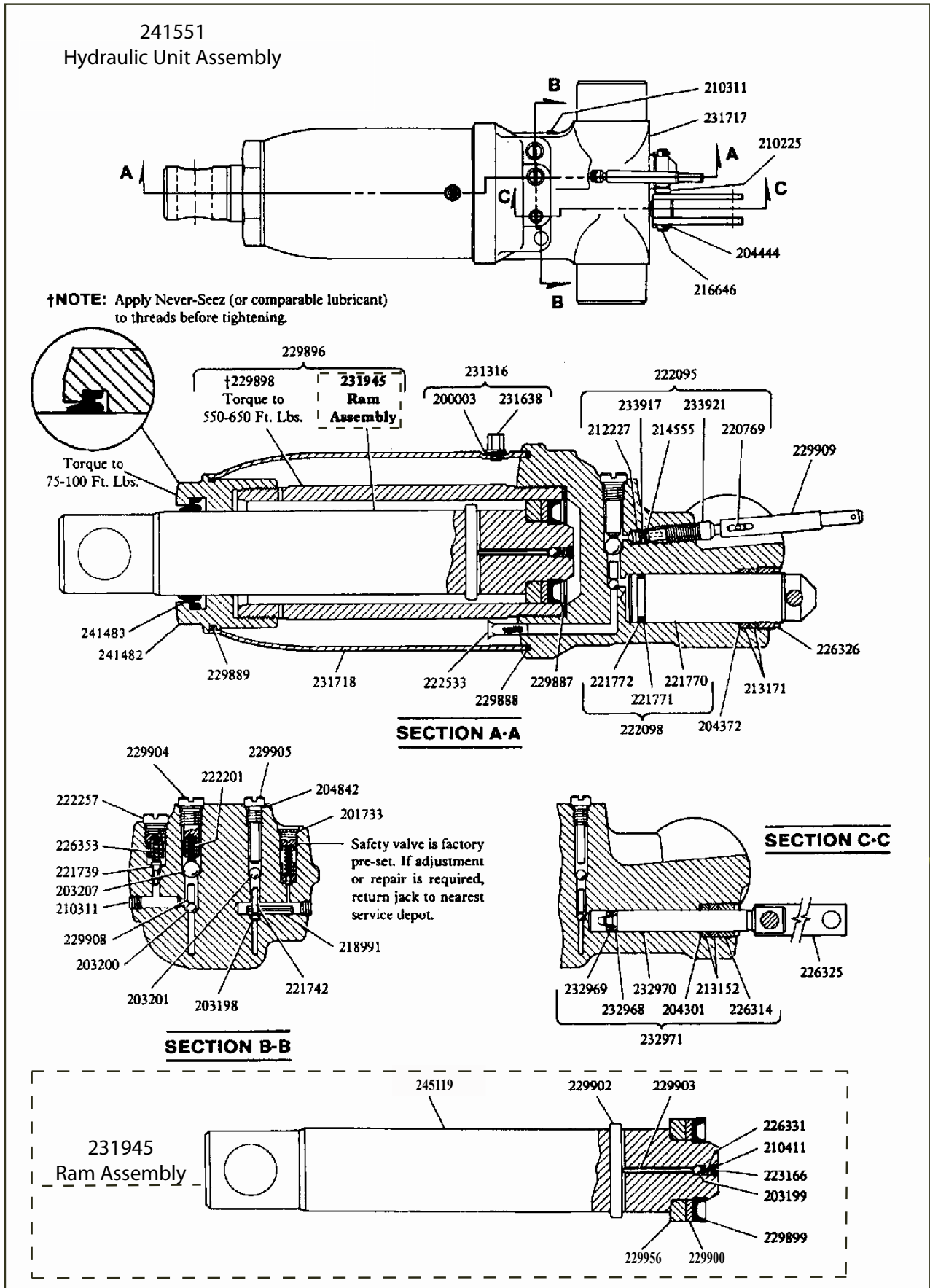

Figure 8 - Parts Illustration for Model HW93660 (Hydraulic Unit)

Model HW93660 Replacement Parts List (refer to figures on page 9 & 10)

<u>Part#</u>	<u>Description</u>	<u>Qty.</u>	<u>Part#</u>	<u>Description</u>	<u>Qty.</u>	<u>Part#</u>	<u>Description</u>	<u>Qty.</u>
200003	Gasket	1	220769	Cross Pin	1	229927	Cap Housing	1
200472	Bolt	2	221739	Poppet	1	229929	Bearing	1
201110	Lockwasher	4	221742	Ball Stop Plug	1	229932	Spring	2
201115	Lockwasher	2	221770	Speed Pump	1	229933	Plate	2
201481	Lockwasher	2	221771*	Back-up Washer	1	229934	Pin	1
201733	Expansion Plug	1	221772	Quad Ring	1	229937	Caster	2
201784	Lockwasher	1	221781	Handle & Cross Bar	1	229938	Pin	1
201789	Lockwasher	2	221809	Handle Grip	2	229939	Front Axle	1
203198*	Ball	1	221937	Release Knob	1	229946	Pin	1
203199*	Ball	1	221938	Roll Pin	1	229947	Retaining Ring	4
203200*	Ball	1	222095	Release Stem Assy.	1	229949	Handle Socket	1
203201*	Ball	1	222098	Speed Pump Assy.	1	229951	Extension Rod	1
203207*	Ball	1	222201*	Spring	1	229952	Plunger Assy.	1
203272	Nut	2	222257	Plug	1	229956	Heel Plate	1
203297	Nut	2	222533*	Screen	2	230006	Bumper Pin	1
203299	Nut	2	223166*	Screen	1	230407	Universal Assy.	1
203323	Nut	2	224253	Cover	1	231316	Filler Plug & Gasket Assy.	1
203332	Nut	1	226271	Fulcrum Pin	1	231419	Fulcrum Pin	1
203344	Nut	2	226314	Gland Nut	1	231420	Bolt	2
204270	Washer	2	226318	Grease Fitting	5	231430	Parallel Link	2
204277	Washer	1	226325	Pump Link	2	231474	Bell Crank & Fittings	1
204301	Washer	1	226326	Gland Nut	1	231638	Filler Plug & Vent Valve	1
204303	Washer	1	226331	Spring	1	231717	Base	1
204372	Washer	1	226353*	Spring	1	231718	Oil Tank	1
204444	Cotter Pin	4	226366	Bolt	1	231945	Ram Assy.	1
204461	Cotter Pin	1	226372	Plunger Spring	1	231962	Handle Assy.	1
204842*	Gasket	1	227397	Link	1	231963	Front Wheel Assy.	2
207169	Nut	2	227436	Turning Rod Assy.	1	232619	Lifting Cap	1
209964	Lockwasher	2	228875	Spring	1	232620	Swivel Pin	1
210225	Spacer	1	229887*	O-ring	1	232968*	Back-up Washer	1
210311	Pipe Plug	3	229888*	O-ring	1	232969*	U-cup Packing	1
210411*	Washer	1	229889*	O-ring	1	232970	Pressure Pump	1
211341	Rivet	1	229896	Ram & Cylinder Assy.	1	232971	Pressure Pump & Gland Packing Assy.	1
212227	Release Valve	1	229898	Cylinder	1	233917	Plastic Spring	1
212689	Bolt	2	229899*	U-cup Packing	1	233921	Release Stem	1
213152*	Packing Ring	2	229900*	Back-up Washer	1	240616	Repair Kit (Hyd. Unit)	-
213171*	Packing Ring	2	229902	Cross Pin	1	241482	Tank Nut	1
214538	Groove Pin	4	229903	Pin	1	241483*	Seal	1
214555*	O-ring	1	229904	Plug	1	241551	Hydraulic Unit Assy.	1
214699	Bushing	1	229905	Plug	1			
214700	Handle Segment & Bushing	1	229908	Spacer	1	244317	Pin	1
			229909	Slotted Tube	1	245119	Ram	1
216645	Pin	1	229910	Retaining Ring	2			
216646	Pin	1	229911	Retaining Ring	2			
217653	Roll Pin	2	229912	Washer	4			
218988	Roll Pin	1	229913	Bell Crank	1			
218991	Roll Pin	1	229915	Front Wheel	2			

(*) Items included in Repair Kit 240616

Model HW93662 Replacement Parts Illustration Part I (refer to parts list on page 14)

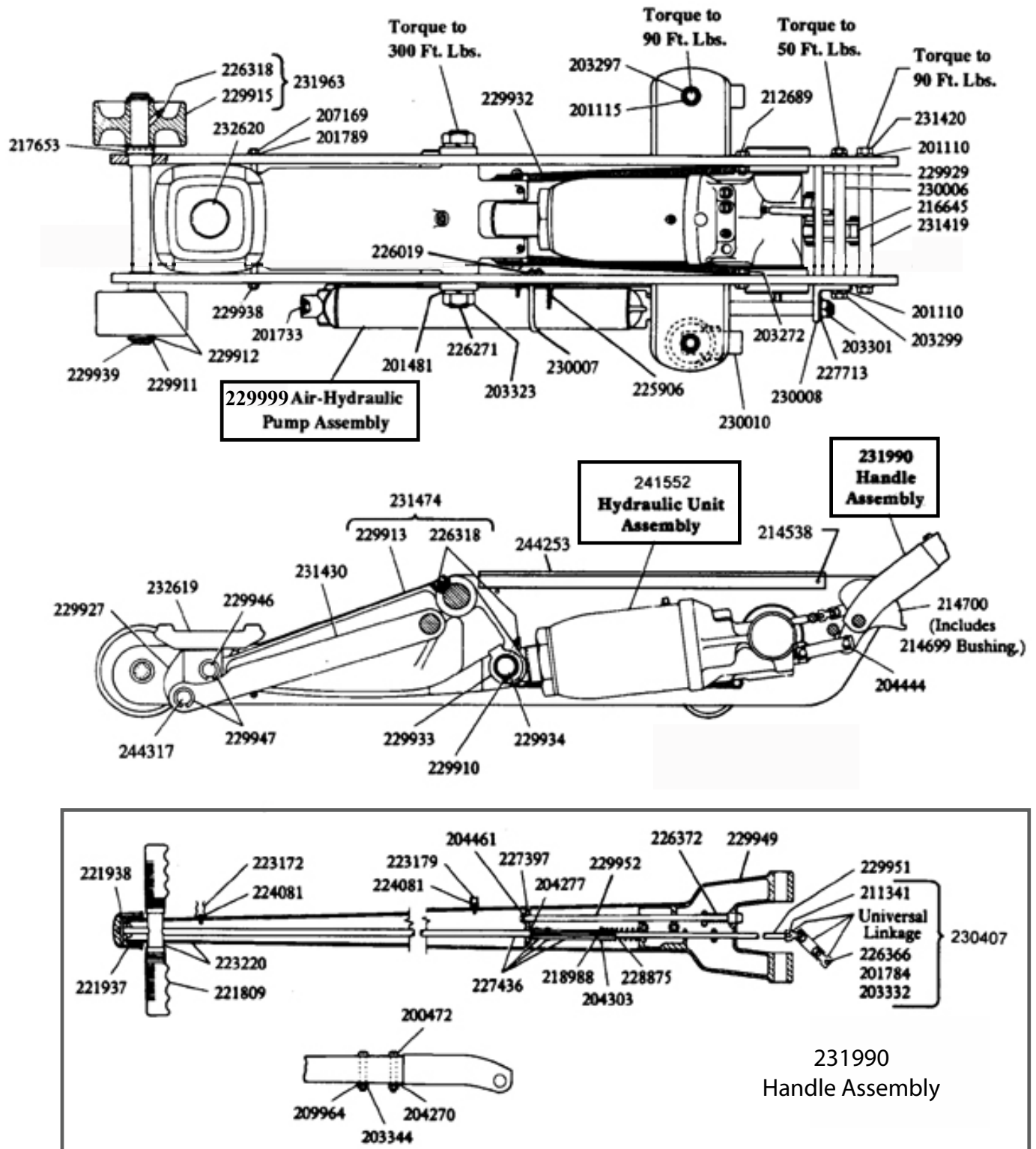

Figure 9 - Parts Illustration for Model HW93662

Model HW93662 Replacement Parts Illustration Part II - Hyd. Unit (refer to parts list on page 14)

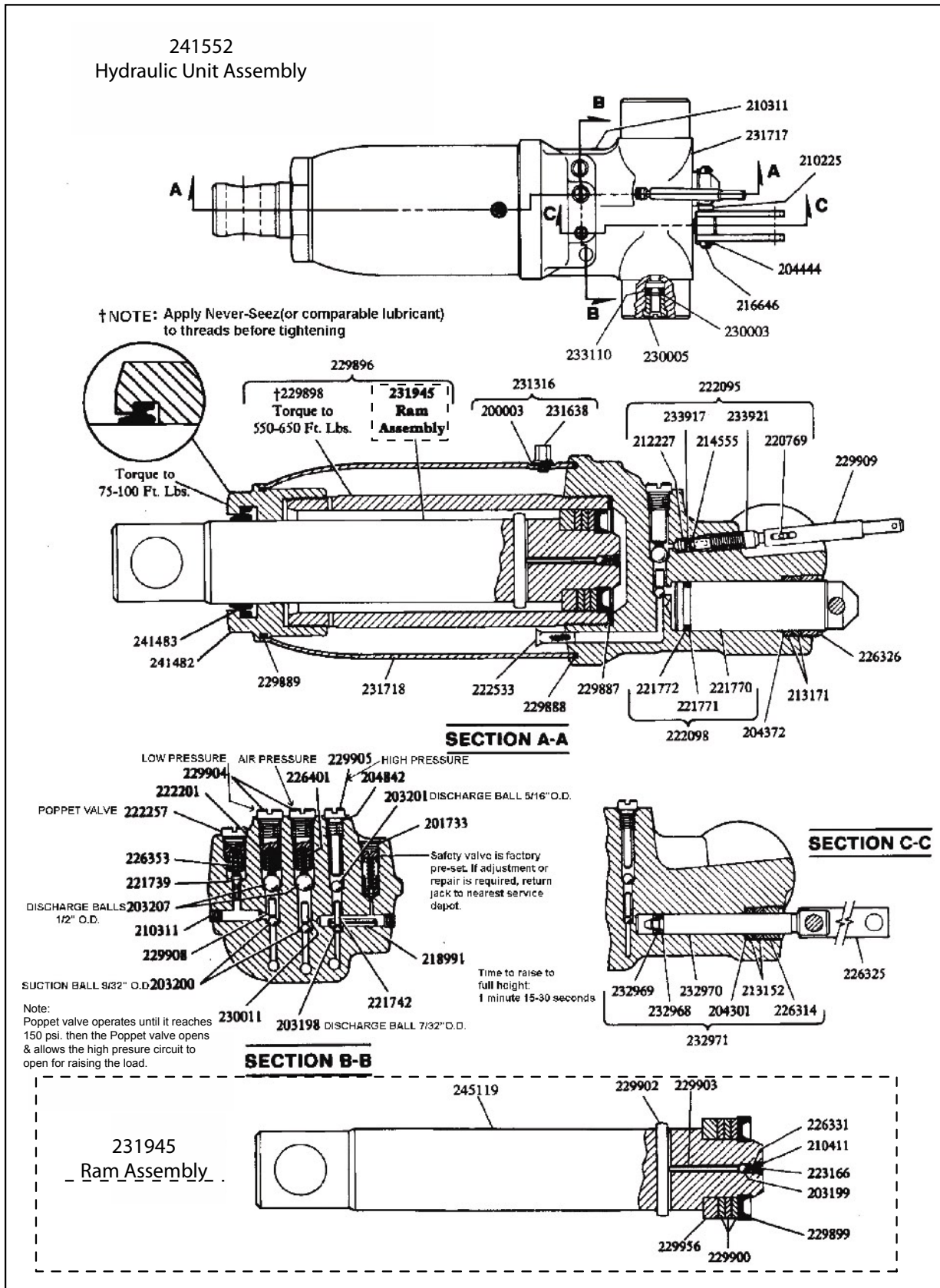
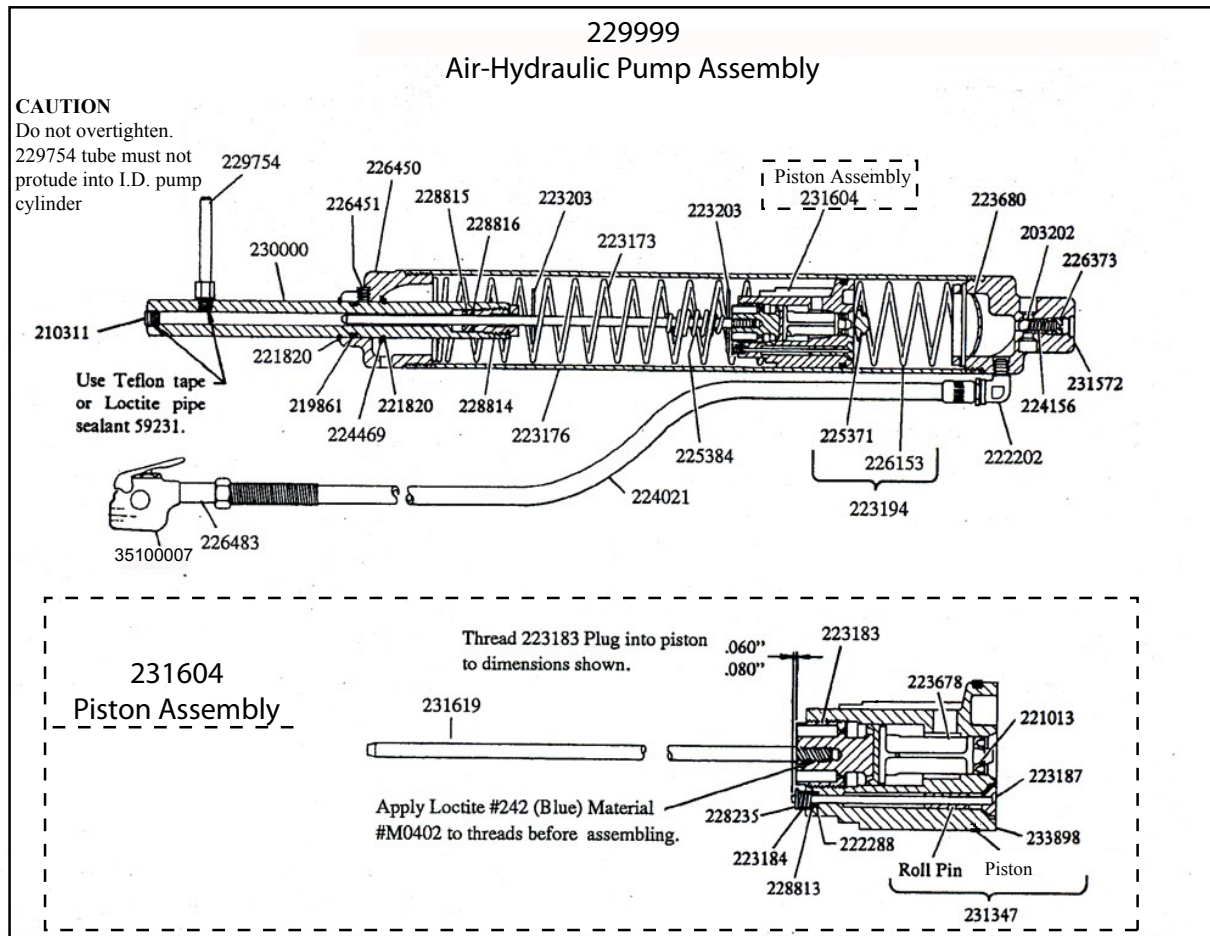

Figure 10 - Parts Illustration for Model HW93662 (Hydraulic Unit)

Model HW93662 Replacement Parts Illustration Part III - Air Hyd. Pump



Model HW93662 Replacement Parts List (refer to figures on page 12, 13 & 14)

Part#	Description	Qty	Part#	Description	Qty	Part#	Description	Qty
200003	Gasket	1	203344	Nut	2	214555*	O-ring	1
200472	Bolt	2	204270	Washer	2	214699	Bushing	1
201110	Lockwasher	4	204277	Washer	1	214700	Handle Segment & Bushing	1
201115	Lockwasher	2	204301	Washer	1	216645	Pin	1
201481	Lockwasher	2	204303	Washer	1	216646	Pin	1
201733	Expansion Plug	1	204372	Washer	1	217653	Roll Pin	2
201784	Lockwasher	1	204444	Cotter Pin	4	218988	Roll Pin	1
201789	Lockwasher	2	204461	Cotter Pin	1	218991	Roll Pin	1
203198*	Ball (7/32" O.D.)	1	204842*	Gasket	1	219861	O-ring	1
203199*	Ball (1/4" O.D.)	1	207169	Nut	2	220769	Cross Pin	1
203200*	Ball (9/32" O.D.)	1	209964	Lockwasher	2	221013#	U-cup Packing	1
203201*	Ball (5/16" O.D.)	1	210225	Spacer	1	221739	Poppet	1
203202	Ball (11/32" O.D.)	1	210311	Pipe Plug	3	221742	Ball Stop Plug	1
203207*	Ball	1	210411*	Washer	1	221770	Speed Pump	1
203272	Nut	2	211341	Rivet	1	221771*	Back-up Washer	1
203297	Nut	2	212227	Release Valve	1	221772	Quad Ring	1
203299	Nut	2	212689	Bolt	2	221809	Handle Grip	2
203301	Jam Nut	1	213152*	Packing Ring	2	221820	Retaining Ring	2
203323	Nut	2	213171*	Packing Ring	2	221937	Release Knob	1
203332	Nut	1	214538	Groove Pin	4			

...Continue on next page (page 15)

Model HW93662 Replacement Parts List (Cont.)

<u>Part#</u>	<u>Description</u>	<u>Qty</u>	<u>Part#</u>	<u>Description</u>	<u>Qty</u>	<u>Part#</u>	<u>Description</u>	<u>Qty</u>
221938	Roll Pin	1	227713	Lockwasher	1	230008	Bracket	1
222095	Release Stem Assy.	1	228235	Cotter Pin	1	230010	Caster	2
222098	Speed Pump Assy.	1	228813	Washer	1	230011	Spacer	1
222201*	Spring	1	228814#	Gland Nut	1	230407	Universal Assy.	1
222202	Elbow	1	228815#	U-cup Packing	1	231316	Filler Plug & Gasket Assy.	1
222257	Plug	1	228816#	Washer	1	231347	Piston & Roll Pin	1
222288#	O-ring	1	228875	Spring	1	231419	Fulcrum Pin	1
222533*	Screen	2	229754	Pin	1	231420	Bolt	2
223166*	Screen	1	229887*	O-ring	1	231430	Parallel Link	2
223172	Hose Clip	1	229888*	O-ring	1	231474	Bell Crank & Fittings	1
223173	Return Spring	1	229889*	O-ring	1	231572	Cylinder Cap	1
223176	Cylinder, Air	1	229896	Ram & Cylinder Assy.	1	231604	Piston Assy.	1
223179	Hose Clip	2	229898	Cylinder	1	231619	Rod, Pump	1
223183	Plug	1	229899*	U-cup Packing	1	231638	Filler plug & Vent Valve	1
223184	Spring	1	229900*	Back-up Washer	1	231717	Base	1
223187#	Valve & Plunger	1	229902	Cross Pin	1	231718	Oil Tank	1
223194	Spring & Cushion	1	229903	Pin	1	231945	Ram Assy.	1
223203	Trip Washer	2	229904	Plug	1	231963	Front Wheel Assy.	2
223220	Handle & Cross Bar	1	229905	Plug	1	231990	Handle Assy.	1
223678	Packing & Piston	1	229908	Spacer	1	232619	Lifting Cap	1
223680	Screen	1	229909	Slotted Tube	1	232620	Swivel Pin	1
224021	Hose, Air	1	229910	Retaining Ring	2	232968*	Back-up Washer	1
224081	Screw	2	229911	Retaining Ring	2	232969*	U-cup Packing	1
224156	Spring	1	229912	Washer	4	232970	Pressure Pump	1
224469	Washer	1	229913	Bell Crank	1	232971	Pressure Pump & Gland Packing Assy.	1
225371	Rubber Cushion	1	229915	Front Wheel	2	233110	Pump U-cup	1
225384	Trip Spring	1	229927	Cap Housing	1	233622	Screw	4
225906	Bracket, Speed pak	1	229929	Bearing	1	233897	Ring, Sealing	1
226153	Spring	1	229932	Spring	2	233917	Plastic Spring	1
226271	Fulcrum Pin	1	229933	Plate	2	233921	Release Stem	1
226314	Gland Nut	1	229934	Pin	1	240564	Repair Kit (Air Pump)-	
226318	Grease Fitting	5	229938	Pin	1	240616	Repair Kit (Hyd. Unit)-	
226325	Pump Link	2	229939	Front Axle	1	241482	Tank Nut	1
226326	Gland Nut	1	229946	Pin	1	241483*	Seal	1
226331	Spring	1	229947	Retaining Ring	4	241552	Hydraulic Unit Assy.	1
226353*	Spring	1	229949	Handle Socket	1	244253	Cover	1
226366	Bolt	1	229951	Extension Rod	1	244317	Pin	1
226372	Plunger Spring	1	229952	Plunger Assy.	1	245119	Ram	1
226373	Adjusting Screw	1	229956	Heel Plate	1	3510007	Air Valve	1
226401	Spring	1	229999	Air Hyd. Pump Assy.	1	HW93662-K0	Label Kit (not shown)	
226450	End Block	1	230000	Pump Cylinder	1	HW93657-M0	Manual	
226451	Set Screw	2	230003	Back-up Washer	1			
226483	Pipe Nipple	1	230005	Gland Nut	1			
227397	Link	1	230006	Bumper Pin	1			
227436	Turning Rod Assy.	1	230007	U-bolt	1			

(*) Items included in Repair Kit 240616
 (#) Items included in Repair Kit 240564

Model HW93667 Replacement Parts Illustration Part I (refer to parts list on page 18)

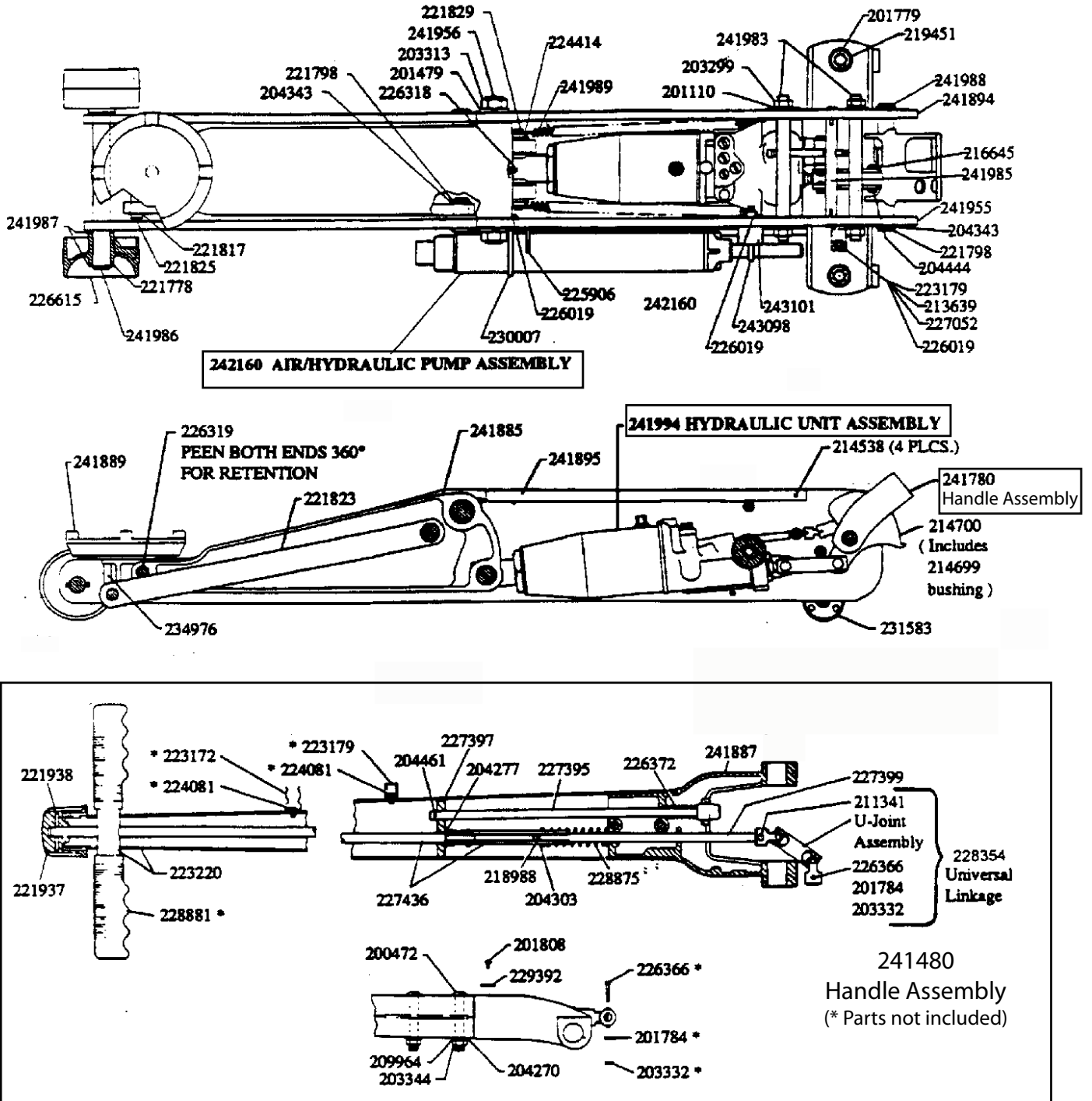

Figure 12 - Parts Illustration for Model HW93667

Model HW93667 Replacement Parts Illustration Part II - Hyd. Unit (refer to parts list on page 18)

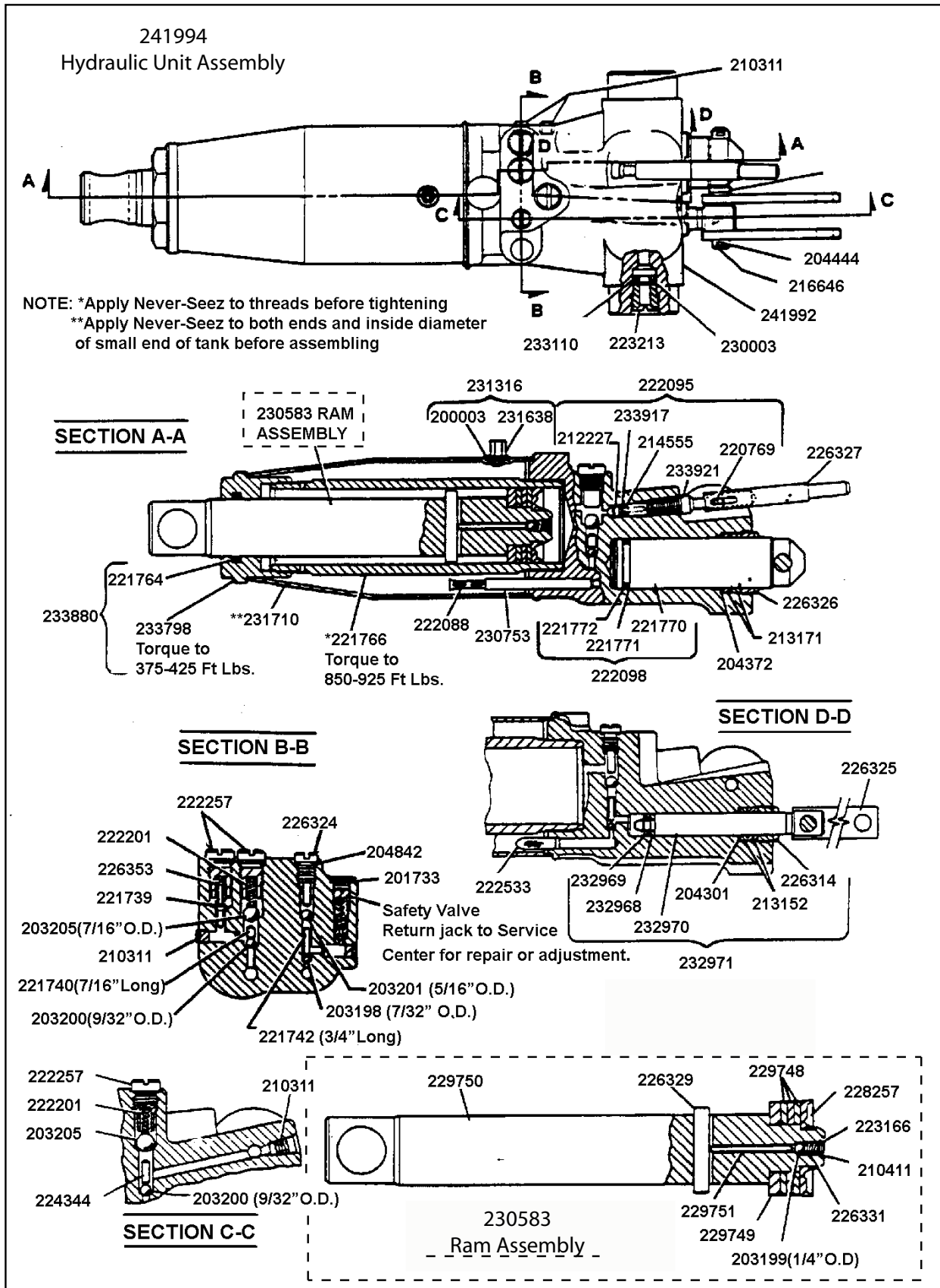

Figure 13 - Parts Illustration for Model HW93667 (Hyd. Unit)

Model HW93667 Replacement Parts Illustration Part III - Air Hyd. Pump

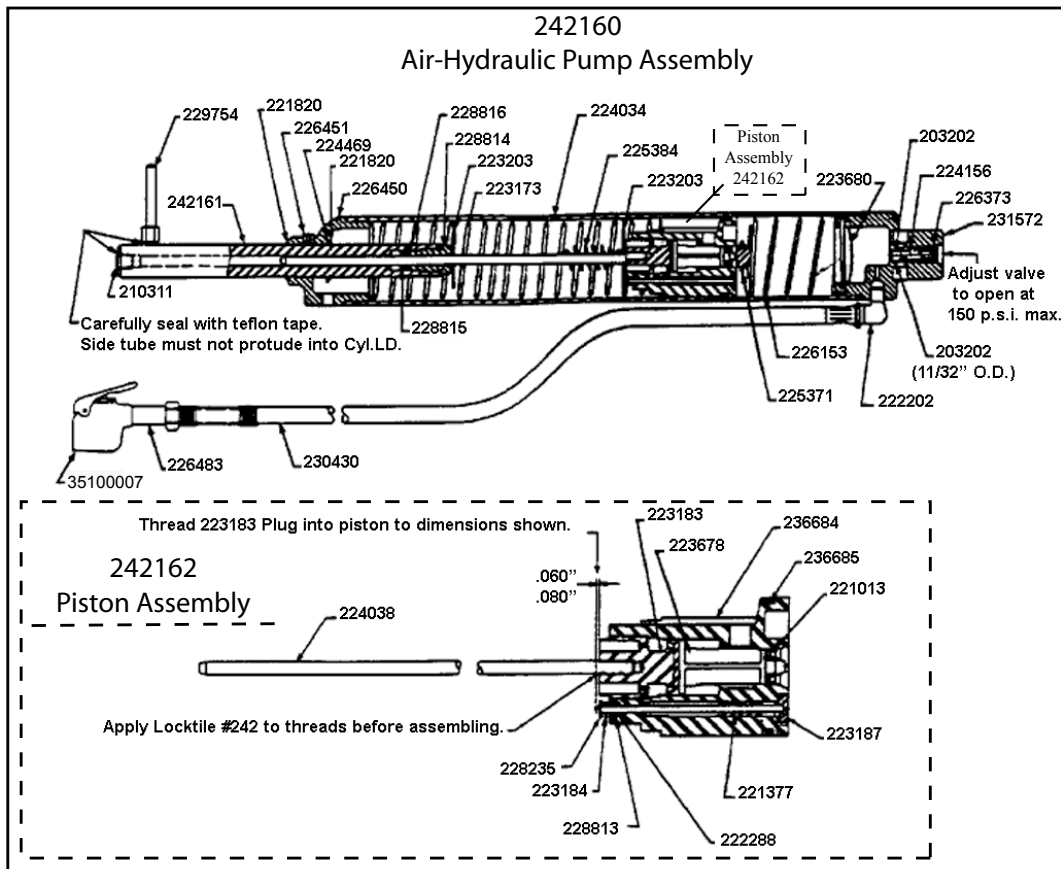

Figure 14 - Parts Illustration for Model HW93667 (Air Hyd. Pump)

Model HW93667 Replacement Parts List (refer to figures on page 16, 17 & 18)

Part#	Description	Qty	Part#	Description	Qty	Part#	Description	Qty
200003*	Gasket	1	204301	Washer	1	216645	Pin	1
200472	Screw	2	204303	Washer	1	216646	Pump Pin	1
201110	Lockwasher	4	204343	Washer	4	218988	Roll Pin	1
201479	Lockwasher	2	204372	Washer	1	219451	Hex Nut	2
201733	Plug	1	204444	Cotter Pin	3	220769	Cross Pin	1
201779	Lockwasher	2	204461	Cotter Pin	1	221013#	U-cup Packing	1
201784	Lockwasher	1	204842*	Copper Gasket	1	221377	Roll Pin	1
201808	Rivet	2	209964	Lockwasher	2	221739*	Poppet	1
203198*	Ball (7/32" O.D.)	1	210225	Spacer	1	221740	Ball Stop Plug (7/16" L)1	
203199*	Ball (1/4" O.D.)	1	210311	Pipe Plug	4	221742	Ball Stop Plug (3/4" L)1	
203200*	Ball (9/32" O.D.)	1	210411*	Washer	1	221764*	Ram Quad Ring	1
203201*	Ball (5/16" O.D.)	1	211341	Rivet	1	221766	Cylinder	1
203202	Ball (11/32" O.D.)	1	212227	Release Valve	1	221770	Low Pressure Pump	1
203205*	Ball (7/16" O.D.)	1	213152*	Packing Ring	2	221771*	Washer	1
203299	Jam Nut	4	213171*	Packing Ring	2	221772*	Quad ring	1
203313	Jam Nut	2	213639	Bolt	1	221778	Washer	2
203332	Nut	1	214538	Groove Pin	4	221798	Retainer Ring	4
203344	Jam Nut	2	214555*	O-ring	1	221817	Retainer Ring	2
204270	Washer	2	214699	Bushing	1	221820	Retaining Ring	1
204277	Washer	1	214700	Handle Segment Assy.	1	221823	Parallel Link	2

...Continue on next page (page 19)

Model HW93667 Replacement Parts List (cont.)

<u>Part#</u>	<u>Description</u>	<u>Qty</u>	<u>Part#</u>	<u>Description</u>	<u>Qty</u>	<u>Part#</u>	<u>Description</u>	<u>Qty</u>
221825	Parallel Link Pin	1	226353*	Spring	1	233917*	Plastic Spring	1
221829	Pin	1	226366	Hex Head Bolt	1	233921	Release Stem	1
221937	Turning Knob	1	226372	Spring	1	234976	Cap Housing	1
221938	Roll Pin	1	226373	Adjusting Screw	1	236684	Piston	1
222088	Screen Assembly	1	226450	End block	1			
						236685	Sealing Ring	1
222095	Release Stem Kit	1	226451	Set Screw	2	240564	Repair Kit (Hyd. Pump)	1
222098	Speed Pump Assy.	1	226483	Pipe Nipple	1	241780	Handle	1
222201*	Spring	1	226615	Front Wheel	2	241885	Bellcrank	1
222202	Elbow	1	227052	Washer	1	241887	Handle Socket	1
222257	Plug Poppet Valve	2	227395	Plunger Assy.	1	241889	Lift Cap	1
222288#	O-ring	1	227397	Release Link	1	241894	Sideplate Assy	1
222533*	Screen	2	227399	Extension Rod	1	241895	Hydraulic Unit Cover	1
223166*	Ram Screen	1	227436	Turning Rod Assy.	1	241907	Repair Kit (Hyd. Unit)-	
223172	Hose Clip	1	228235	Cotter Pin	1	241955	Sideplate Assy	1
223173	Return Spring	1	228257*	U-cup	1	241956	Fulcrum Pin	1
223179	Hose Clip	2	228354	Universal Linkage	1	241983	Sideplate Tie Rod	2
223183	Plug	1	228813	Washer	1	241985	Support Rod	1
223184	spring	1	228814#	Gland Nut	1	241986	Front Axle	1
223187#	Valve & Plunger	1	228815#	U-cup Packing	1	241987	Retainer Ring	4
223203	Trip Washer	2	228816#	Washer	1	241988	Handle Pivot Pin	1
223213	Gland Nut	1	228875	Spring	1	241989	Extension spring	2
223220	Handle & Cross Bar	1	228881	Grip	2	241992	Hydraulic Unit Casting	1
223678	Packing & Piston	1	229392	Serial plate	1	241994	Hydraulic Unit Assy.	1
223680	Screen	1	229748*	Heel Plate	3	242160	Air Hyd. Pump Assy.	1
224034	Air Cylinder	1	229749	Washer	1	242161	Pump Cylinder	1
224038	Pump Rod	1	229750	Ram	1	242162	Piston Assembly	1
224081	Screw	3	229751	Pin	1	243098	U-bolt	1
224156	Spring	1	229754	Extension Tube	1	243101	Sleeve	1
224344	Ball Stop Plug	1	230003*	Back-up Washer	1	35100007	Air Valve	1
224414	Retaining Ring	1	230007	U-bolt	1			
224469	Washer	1	230430	Air Hose Assy.	1	HW93667-K0	Label Kit (not shown)	
225371	Rubber Cushion	1	230583	Ram Assy.	1	HW93657-M0	Manual	
225384	Trip Spring	1	230753	Suction Tube	1			
225906	Bracket, Speed Pak	1	231316	Vent Valve Assy.	1			
226019	Lock Nut	4	231572	Cylinder Cap	1			
226153	Spring	1	231583	Rear Caster	2			
226314	Gland Nut	1	231638	Filler Screw	1			
226318	Grease fitting	1	231710	Oil Tank	1			
226319	Bellcrank Pin	1	232968*	Back-up Washer	1			
226324	Pressure Plug	1	232969*	U-cup	1			
226325	Pump Link	2	232970	Pressure Pump	1			
226326	Nut	1	232971	Pressure Pump Kit	1			
226327	Slotted Tube	1	233110	Pump U-cup	1			
226329	Pin	1	233798	Tank Nut	1			
226331*	Spring	1	233880	Tank Nut & Quad Ring	1			

(*) Items included in Repair Kit 241907
 # Items included in Repair Kit 240564



TWO YEARS LIMITED WARRANTY

For a period of two (2) years from date of purchase, SFA Companies will repair or replace, at its option, without charge, any of its products which fails due to a defect in material or workmanship under normal usage. This limited warranty is a consumer's exclusive remedy.

Performance of any obligation under this warranty may be obtained by returning the warranted product, freight prepaid, to SFA Companies Warranty Service Department, 10939 N. Pomona Ave., Kansas City, MO 64153. Except where such limitations and exclusions are specifically prohibited by applicable law:

- (1) THE CONSUMER'S SOLE AND EXCLUSIVE REMEDY SHALL BE THE REPAIR OR REPLACEMENT OF DEFECTIVE PRODUCTS AS DESCRIBED ABOVE
- (2) SFA COMPANIES SHALL NOT BE LIABLE FOR ANY CONSEQUENTIAL OR INCIDENTAL DAMAGE OR LOSS WHATSOEVER.
- (3) ANY IMPLIED WARRANTIES, INCLUDING WITHOUT LIMITATION THE IMPLIED WARRANTIES OF MERCHANTABILITY AND FITNESS FOR A PARTICULAR PURPOSE, SHALL BE LIMITED TO TWO YEARS, OTHERWISE THE REPAIR, REPLACEMENT OR REFUND AS PROVIDED UNDER THIS EXPRESS LIMITED WARRANTY IS THE EXCLUSIVE REMEDY OF THE CONSUMER, AND IS PROVIDED IN LIEU OF ALL OTHER WARRANTIES, EXPRESS OR IMPLIED.
- (4) ANY MODIFICATION, ALTERATION, ABUSE, UNAUTHORIZED SERVICE OR ORNAMENTAL DESIGN VOIDS THIS WARRANTY AND IS NOT COVERED BY THIS WARRANTY.

Some states do not allow limitations on how long an implied warranty lasts, so the above limitation may not apply to you. Some states do not allow the exclusion or limitation of incidental or consequential damages, so the above limitation or exclusion may not apply to you. This warranty gives you specific legal rights, and you may also have other rights which vary from state to state.