



## **500-LB. CARGO CARRIER**

### **OWNER'S MANUAL**



 **WARNING:** Read carefully and understand all **INSTRUCTIONS** before operating. Failure to follow the safety rules and other basic safety precautions may result in serious personal injury.

**Item # 148835**

Thank you very much for choosing a WEL-BILT™ Product. For future reference, please complete the owner's record below:

Model: \_\_\_\_\_ Purchase Date: \_\_\_\_\_

Save the receipt, warranty and these instructions. It is important that you read the entire manual to become familiar with this product before you begin using it.

This product is designed for certain applications only. The distributor cannot be responsible for issues arising from modification. We strongly recommend this product not be modified and/or used for any application other than that for which it was designed. If you have any questions relative to a particular application, DO NOT use the product until you have first contacted the distributor to determine if it can or should be performed on the product.

For technical questions please call **1-800-222-5381**.

## INTENDED USE

This easy-to-install Cargo Carrier fits any 2in. receiver hitch, providing extra storage to carry cargo that may not fit inside the vehicle.

## TECHNICAL SPECIFICATIONS & PACKING LIST

Item	Description
Product Size	19in. x 46in. (48.3 x 116.9cm)
Load Capacity	500 Lbs. (227kgs)
Hitch Size	2in. standard (Class III and Class IV)

## GENERAL SAFETY RULES



**WARNING:** Read and understand all instructions. Failure to follow all instructions listed below may result in serious injury.



**CAUTION:** Do not allow persons to use or assemble this cargo carrier until they have read this manual and have developed a thorough understanding of how the cargo carrier works.



**WARNING:** The warnings, cautions, and instructions discussed in this instruction manual cannot cover all possible conditions or situations that could occur. It must be understood by the operator that common sense and caution are factors which cannot be built into this product, but must be supplied by the operator.

# SAVE THESE INSTRUCTIONS

## WORK AREA

### When assembling, installing, or removing the cargo carrier

- **Keep work area clean**, free of clutter and well lit. Cluttered and dark work areas can cause accidents.
- **Keep children and bystanders** away while assembling, installing or removing the cargo carrier. Distractions can cause loss of control, so visitors should remain at a safe distance from the work area.
- **Be aware of all power lines, electrical circuits**, water pipes and other mechanical hazards near your work area, particularly those hazards below the work surface hidden from the operator's view that may be unintentionally contacted and may cause personal harm or property damage.

## PERSONAL SAFETY

- **Stay alert**, watch what you are doing and use common sense when using the cargo carrier. Secure all cargo with tie-down straps and/or bungee cords (not included).
- **Never exceed recommended load capacity of 500 lbs.**

## CARGO CARRIER USE AND CARE

- **Do not modify the cargo carrier in any way.** Unauthorized modification may impair the function and/or safety and could affect the life of the equipment. There are specific applications for which the cargo carrier was designed.
- **Always check for damaged or worn parts before using the cargo carrier.** Broken parts will affect the cargo carrier operation. Replace or repair damaged or worn parts immediately.
- **Distribute the load evenly.** Uneven loads may cause the cargo carrier to tip, resulting in damage to personal property or to the vehicle.
- **Use the cargo carrier only with 2in. Class III and Class IV hitches.** Always position loads evenly and secure with tie-down straps.
- **Never block or impede vehicle exhaust.** Loading items that block exhaust can cause fire or damage to personal property and vehicle.

## ASSEMBLY

### Recommended Tools:

**2 ea. – 6mm combination wrench**

**2 ea. – 8mm combination wrench**

**1 ea. – Medium size Phillips screw driver**

TIP: Refer to parts diagram during assembly to see fully assembled product.

## Step 1: Assemble Front and Back side rails

Hardware Needed:

Qty 4: Side Rail Tubes (part #8)

Qty 2: Square connector plates (part #7)

Qty 8: M6x40 Bolt (part #3)

Qty 8: M6 Nylock Nut (part #4)

See figure #1 below. Attach one square connector plate (part #7) onto two side railing tubes (part #8) using M6x 40 bolt and M6 nylock nut for each connection. **IMPORTANT! DO NOT FULLY TIGHTEN LOWER** connection, as it will be re-assembled in later step. Be sure holes in side rail tubes (part #8) are face out to same side as connector plate AND the holes match to the top/bottom of two side rail bars being attached to one square connector plate.

Note there will be 2 main side railing tubes.

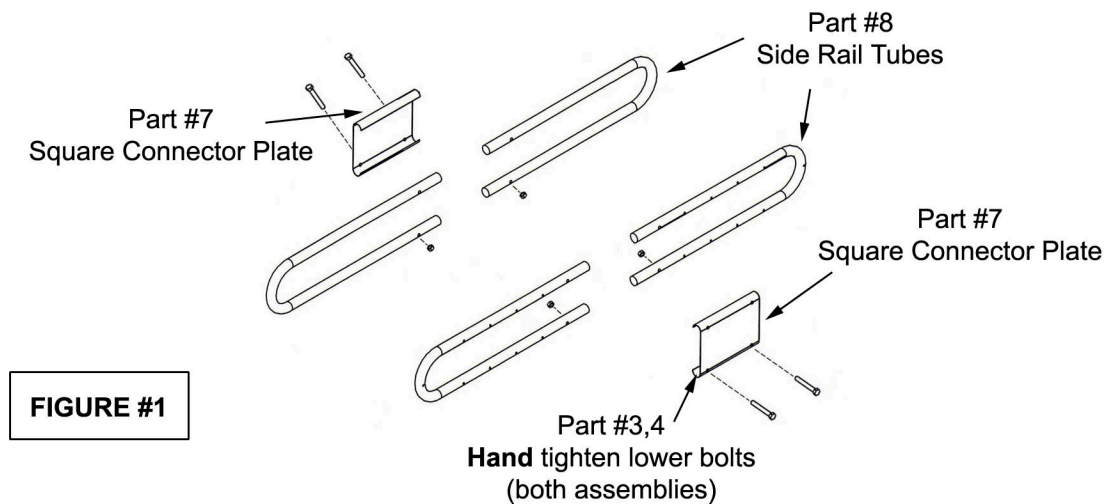

## Step 2: Attach Bottom and Side supports to rail tubes from step #1

Hardware Needed:

Qty 10: Support Tubes (part #4)

Qty 20: M5x10 Screws (part #5)

**IMPORTANT! DO NOT USE** drill for screws, as holes can be easily damaged. Using hand screw driver attach Support Bars (part #9) to Side Rail Tubes from step #1 using M5x10 screw. See figure #2 below.

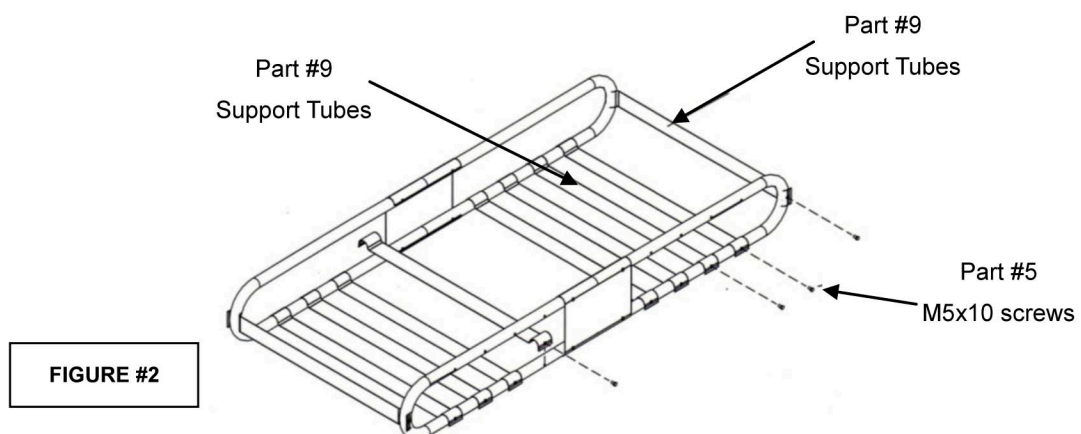

### Step 3: Attach Hitch Mounting Bar

Hardware Needed:

Qty 1: Rear mounting bar (part #6)

Qty 1: Front mounting bar (part #10)

Qty 1: M8x60 bolt (part #1)

Qty 1: M8 Nylock nut (part #2)

First, remove hand tighten connections from step #1 (lower 2 nuts and bolts or square connector plate). Next, inset Rear mounting bar (part #6) and Front mounting bar (part #10) below cargo carrier assembly and securing the two parts with M8x60 bolt (part#1) and M8 Nylock Nut (part#2). Then re-insert bolts in lower holes of square connector plate and fully tighten with nylock nut.

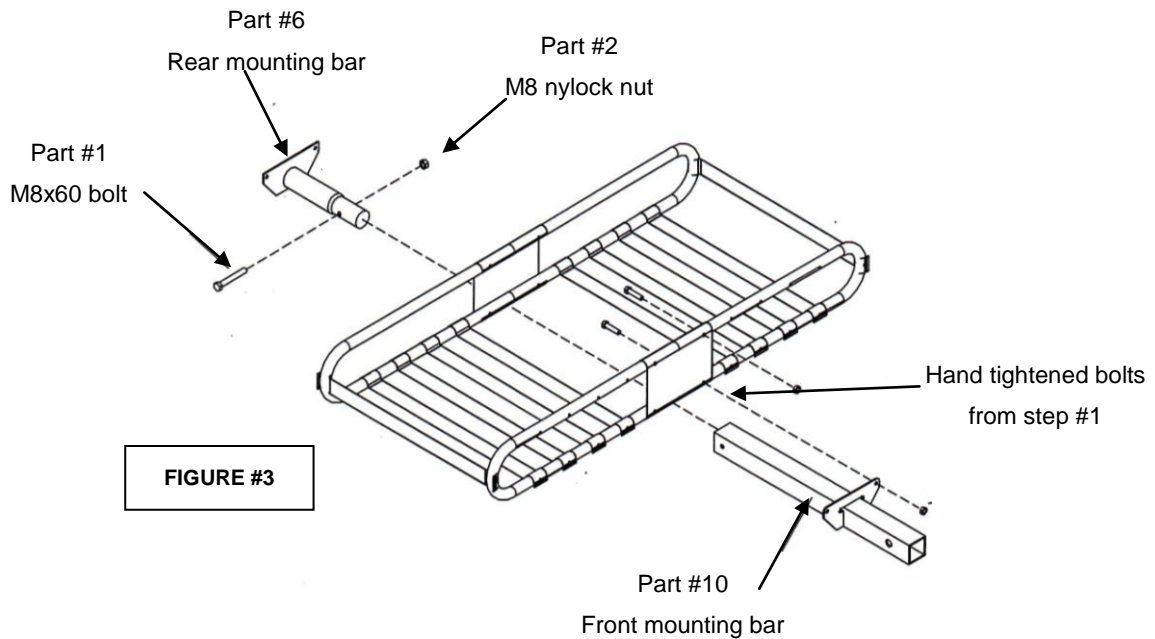

### Step 4. Assembly completed.

IMPORTANT! Check that all connections are tight.

Attach Cargo Carrier to vehicle receiver hitch, securing it with a hitch pin (not included).

See below.

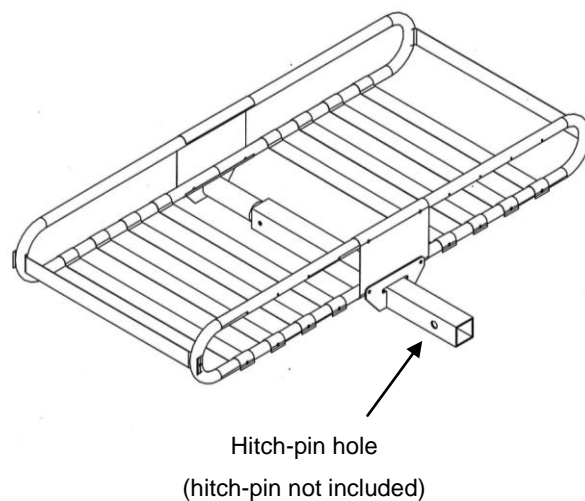

## OPERATION



### **WARNING: RISK OF FIRE / FIRE HAZARD**

- Never allow loads or items on the cargo carrier to block or impede exhaust from vehicle.
- This can cause a fire or damage to personal property or vehicle.

Step 1: 2-person installation is recommended to lift the cargo carrier into place.

Step 2: Lift the Cargo Carrier and insert receiver mounting bar into the hitch receiver on the vehicle.

Step 3: Line up the horizontal hole in the receiver mounting bar with the hole in your hitch. When the holes line up, insert a hitch-pin with clip through the holes to secure the cargo carrier.

## MAINTENANCE

- **Maintain your Cargo Carrier.** It is recommended that the general condition of the carrier be examined before each use. Keep the carrier in good condition by adopting a program of conscientious repair and maintenance in accordance with the recommended procedures found in this manual.
- **Keep the carrier clean.** A properly maintained cargo carrier will work more effectively. Keep all of the parts dry, clean, and free from oil and grease.
- **Cleaning.** Use only soap and a damp cloth to clean your Cargo Carrier.

# DIAGRAM & PARTS LIST

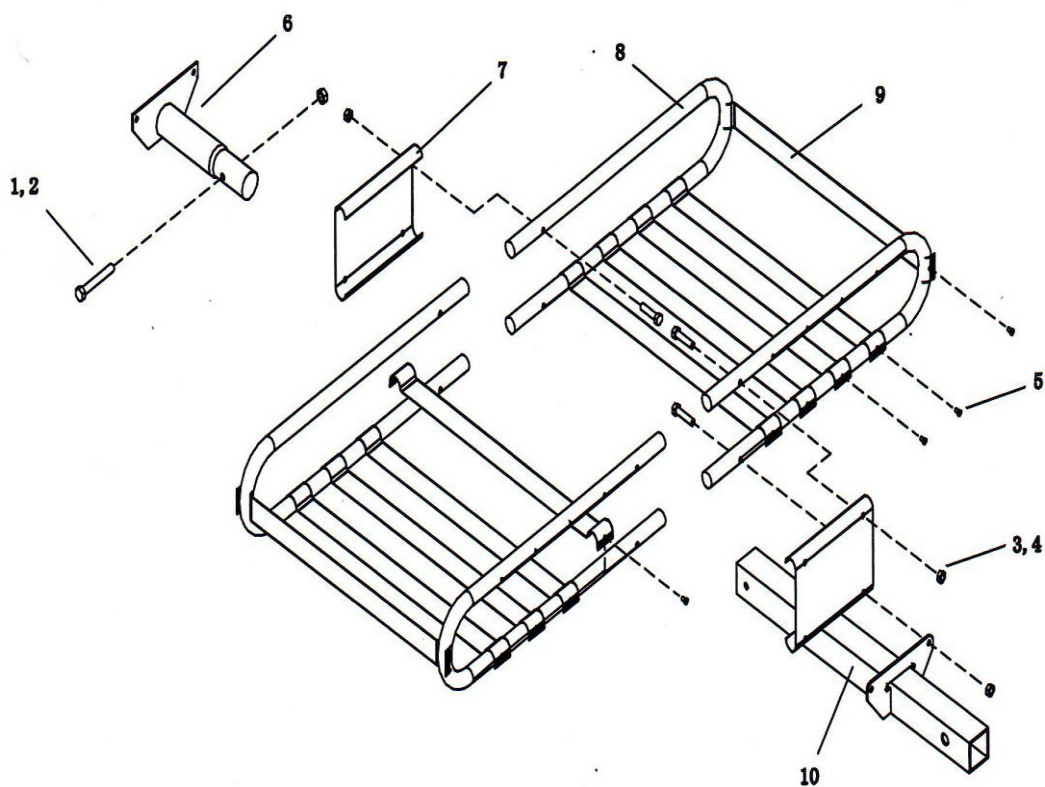

Part#	Description	Qty.
1	Bolt M8X60	1
2	M8 nylock nut	1
3	Bolt M6X40	8
4	M6 nylock nut	8
5	Bolt M5X10	20
6	Rear Mounting Bar	1
7	Square Connector Plate	2
8	Side Rail Tube	4
9	Support Tube	10
10	Front Mounting Bar	1

For replacement parts and technical questions, please call **1-800-222-5381**.

# WARRANTY

One-Year Limited Warranty



Distributed by  
Northern Tool + Equipment Co.,  
2800 Southcross Drive West  
P.O. Box 1499 Burnsville, MN 55337-0499  
Made in China