

ULTRA-TOW™

700-LB. Aluminum Motorcycle Trailer OWNER'S MANUAL



⚠ WARNING:

Read carefully and understand all INSTRUCTIONS before operating. Failure to follow the safety rules and other basic safety precautions may result in serious personal injury.

Item #14717

Thank you very much for choosing an Ultra-Tow™ Product! For future reference, please complete the owner's record below:

Model: _____ Purchase Date: _____

Save the receipt, warranty and these instructions. It is important that you read the entire manual to become familiar with this product before you begin using it.

This trailer is designed for certain applications only. The distributor cannot be responsible for issues arising from modification. We strongly recommend this trailer not be modified and/or used for any application other than that for which it was designed. If you have any questions relative to a particular application, DO NOT use the machine until you have first contacted the distributor to determine if it can or should be performed on the product.

For technical questions please call **1-800-222-5381**.

TECHNICAL SPECIFICATIONS

ITEM	DESCRIPTION
Tires	4.80-12 Tubeless
Wheel	4 Bolt Demountable
Overall Dimensions	153 1/2in.L x 58 3/16in.W x 36 7/16in.H
Ball/Coupler Size	1-7/8in.
Coupler Capacity	Class I; 2000 Lbs. Maximum Gross Load
GAWR	700 Lbs. with 4.80-12 Tires at 60 PSI Cold
GVWR	700 Lbs.

GENERAL SAFETY RULES



WARNING: Read and understand all instructions. Failure to follow all instructions listed below may result in electric shock, fire and/or serious injury.



WARNING: The warnings, cautions, and instructions discussed in this instruction manual cannot cover all possible conditions or situations that could occur. It must be understood by the operator that common sense and caution are factors that cannot be built into this product, but must be supplied by the operator.

- **Keep the work area clean and dry.** Damp or wet work areas can result in injury.
- **Keep children away from work area.** Do not allow children to handle this product.

- **Always wear ANSI-approved safety glasses and heavy-duty work gloves during assembly and use.** Do not wear loose clothing or jewelry which can get caught in moving parts.
- **Store idle equipment.** When not in use, tools and equipment should be stored in a dry location to inhibit rust. Always lock up tools and equipment, and keep out of reach of children.
- **Use the right tool for the job.** Do not attempt to force small equipment to do the work of larger industrial equipment. There are certain applications for which this equipment was designed. It will do the job better and more safely at the capacity for which it was intended. Do not modify this equipment, and do not use this equipment for a purpose for which it was not intended.
- **Check for damaged parts.** Before using this product, carefully check that it will operate properly and perform its intended function. Check for damaged parts and any other conditions that may affect the operation of this product. Replace damaged or worn parts immediately.
- **Do not overreach.** Keep proper footing and balance at all times to prevent tripping, falling, back injury, etc.
- **DO NOT use this trailer when tired or distracted.**
- **Industrial applications must follow OSHA requirements.**

SPECIFIC OPERATION WARNINGS

- Before each use, always examine the trailer for proper tire (Part# A15) condition and air pressure, loose bolts and nuts, structural cracks, bends and any other condition that may affect its safe operation. Do not use the Trailer even if minor damage appears.
- Before each use, always attach the Safety Chain (Part# A14) of the trailer to the towing vehicle. Make sure the Safety Chain is attached to the towing vehicle with the equal length at each side. Do not allow the Safety Chain to drag on the ground.
- Always check to make sure the payload being transported is properly and safely secured in the trailer.
- Make sure the towing vehicle is capable of towing this trailer and its payload. Make sure the hitch on the towing vehicle is capable of towing the Trailer and its payload. The towing capacity of the hitch is typically stamped on the hitch drawbar.
- Make sure the hitch coupler (Part# A13) and the vehicle's Ball Hitch (not included) are of equal mating size (1-7/8in.) and are rated equal to or greater than the weight of the trailer and its payload.
- **DO NOT** exceed 55 miles per hour when towing the trailer. Excess speed is a major cause of vehicle-trailer accidents.
- The Tail Light Bulbs supplied with this trailer are for a 12 VOLT DC electrical system only. Do not attempt to power the Light Bulbs with any other type or voltage electrical current.
- Whenever possible, park the trailers on a flat, level, paved surface and chock both tires to keep the trailer from accidentally moving.
- Before attempting to fold up the trailer, make sure it is on a flat, level, solid surface and chock both Tires (Part# A15).
- Never attempt to fold up the trailer without the help of one or two able assistants.
- **DO NOT** exceed the 700 pound weight capacity.
- **DO NOT** allow anyone to ride in the towed vehicle or on the trailer.
- **DO NOT** transport passengers or heavy cargo inside the vehicle that is being towed.
- **The coupler must be properly secured to the hitch ball.** After assembly and attachment, pull up and down on the hitch coupler to make sure the hitch ball is snug in the hitch coupler. If the coupler is not secured properly, it could come loose while the trailer is in motion, causing property damage, serious personal injury or even death.
- **Make wide turns when towing a loaded trailer, avoiding both sharp turns and U-turns. Turning too sharply can cause damage to the trailer and/or the tow vehicle.**

UNPACKING

When unpacking, check to make sure all the parts shown on the **Parts List** are included. If any parts are missing or broken, please call **1-800-222-5381**.

ASSEMBLY INSTRUCTIONS

Read following instructions step-by-step for easy assembly according to the complete parts and hardware list. Required Tools – Open-end wrench set, adjustable wrenches, rubber mallet, socket set.

STEP 1

Removed box from crate and separate hardware packs. Included will be lug nuts, nuts, bolts, washers and assembly instructions, and so on. See figure 1-1, 1-2 and 1-3.

NOTE: Some components have been pre-assembled for your convenience. Details are as below.

Light wire is partly through the trailer;

Hub has been assembled to the Axle;

The Front Channel (Part# A2) and Rear Channel (Part# A3) are connected to Front Frame (Part# A5) and Rear Frame (Part# A6) by M10*50 Bolts (Part# B4), M10*20 Bolts (Part# B9), 10 Washers (Part# B5) and M10 Lock Nuts (Part# B6);

The Tow Bar (Part# A1) is connected to Front Channel (Part# A2) by 14 Pin Roll (Part# A10), 14 Washer (Part# B7) and 4*35 Cotter Pin (Part# B8);

The Front Channel (Part# A2) is connected to Rear Channel (Part# A3) by M12*30 Hex-Head Bolts (Part# B1), 12 Washers (Part# B2) and M12 Lock Nuts (Part# B3);

The Rear Ramp (Part# A4) is connected to Rear Channel (Part# A3) by M10*25 Bolts (Part# B11), 10 Washers (Part# B5) and M10 Lock Nuts (Part# B6).



Figure 1-1



Figure 1-2

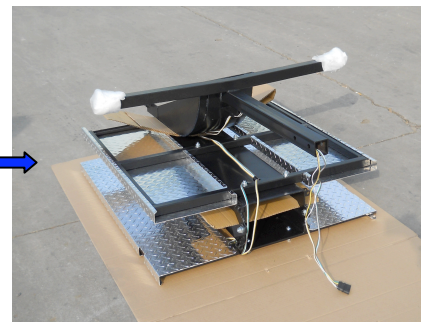

Figure 1-3

STEP 2

Open the whole trailer, then fold Rear Frame (Part# A6) onto Front Frame (Part# A5). See figure 2-1.

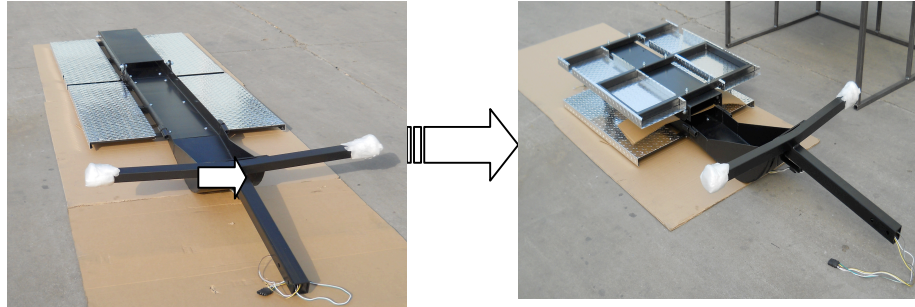

Figure 2-1

STEP 3

1. For ease of assembly process, move the folded trailer onto the crate. See figure 3-1.



Figure 3-1

2. Affix Axle Assembly (Part# A9) to the cutout slots on the Rear Frame (Part# A6), using M10*30 Bolts (Part# B10), 10 Washers (Part# B5) and M10 Lock Nuts (Part# B6). See figure 3-2.

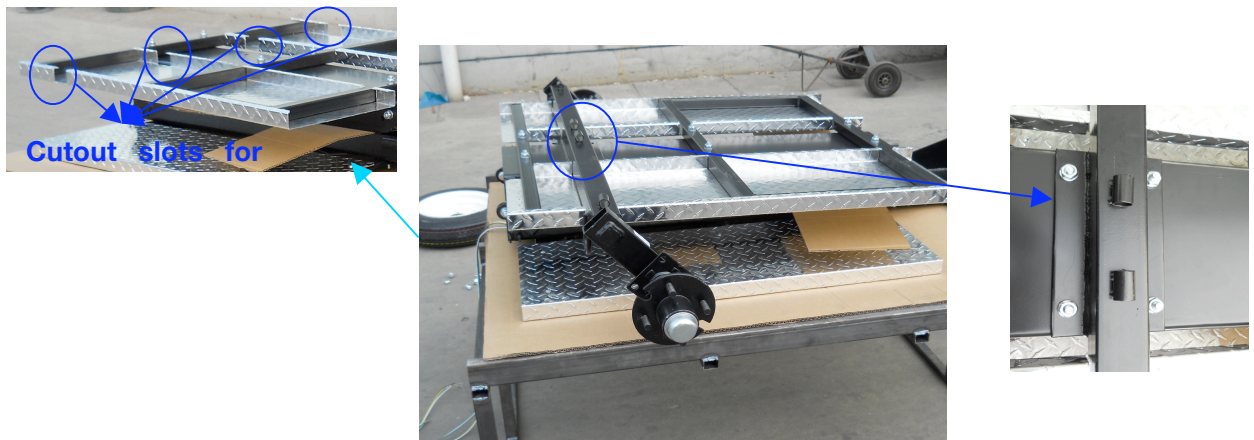

Figure 3-2

NOTE: When affixing the Axle Assembly, make sure that the degree of angle between Axle Assembly and Rear Frame is 45°. See figure 3-3.

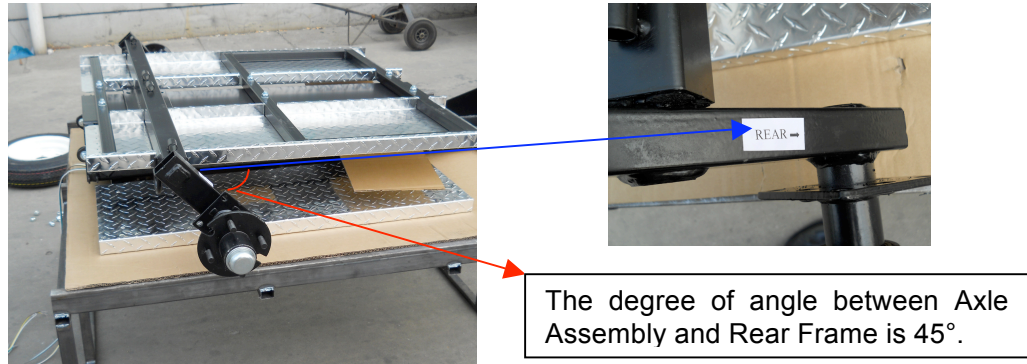

Figure 3-3

STEP 4

Connect the light wire to the Axle Assembly (Part# A9) as below. See figure 4-1.



Figure 4-1

NOTE: The colors of the light wire through the Axle Assembly should match with those through the Fenders. Light wires of Yellow-Brown-White are to Right Fender (Part# A7), while light wires of Green-Brown-White are to Left Fender (Part# A8).

STEP 5

Install the Tires (Part# A15) to the Axle Assembly (Part# A9). Slide the wheel over the Hub Studs, then use M12*1.25 Lug Nuts (Part# A17) to attach the tire/wheel assemblies. Tighten lug nuts to 85–90 ft.-lbs. of torque. See figure 5-1.

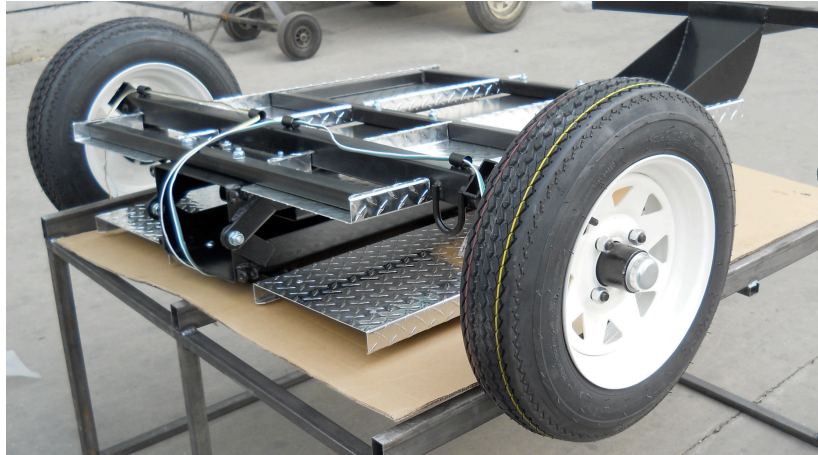

Figure 5-1

STEP 6

1. Take off the trailer from the crate, and then open the Rear Frame (Part# A6). See figure 6-1.

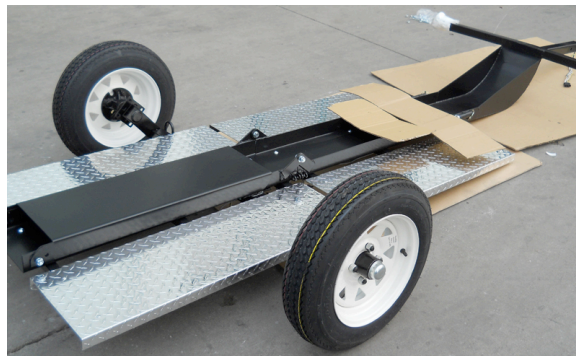

Figure 6-1

2. Attach the Fenders (Part# A7, A8) to bracket on Axle Assembly using M10*30 Bolts (Part# B12), 10 Washers (Part# B5) and M10 Lock Nuts (Part# B6). See figure 6-2.



Figure 6-2

STEP 7

Connect the wires from the Axle Assembly (Part# A9) to the wires on lights, making sure to route wires so they are free of moving parts. See Figure 7-1.

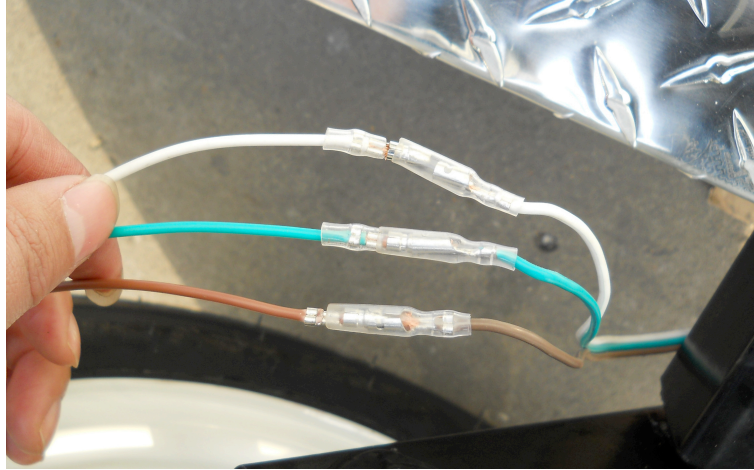

Figure 7-1

NOTE: The colors of the light wire through the Axle Assembly should match with those through the Fenders.

STEP 8

1. Use 16 Safety Pin (Part# A11) and Spring Pin (Part# A16) to connect the Front Channel (Part# A2) and Tow Bar (Part# A1). See Figure 8-1.

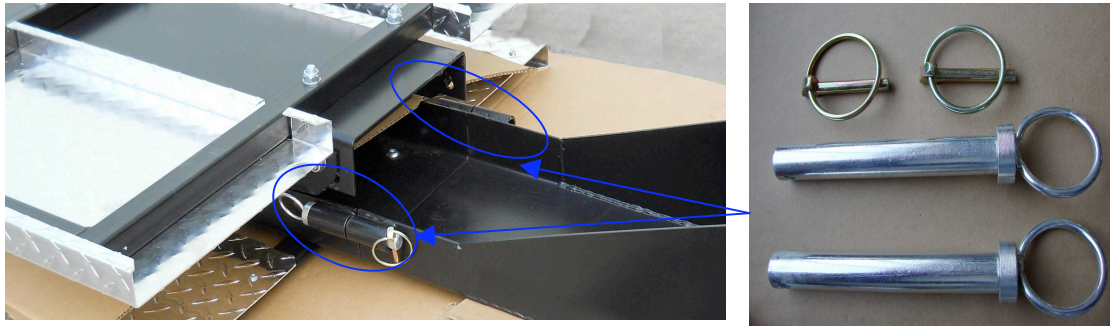

Figure 8-1

2. Use L-Pin (Part# A12) and R-Pin (Part# A18) to connect the Front Channel (Part# A2) and Rear Channel (Part# A3). See Figure 8-2.

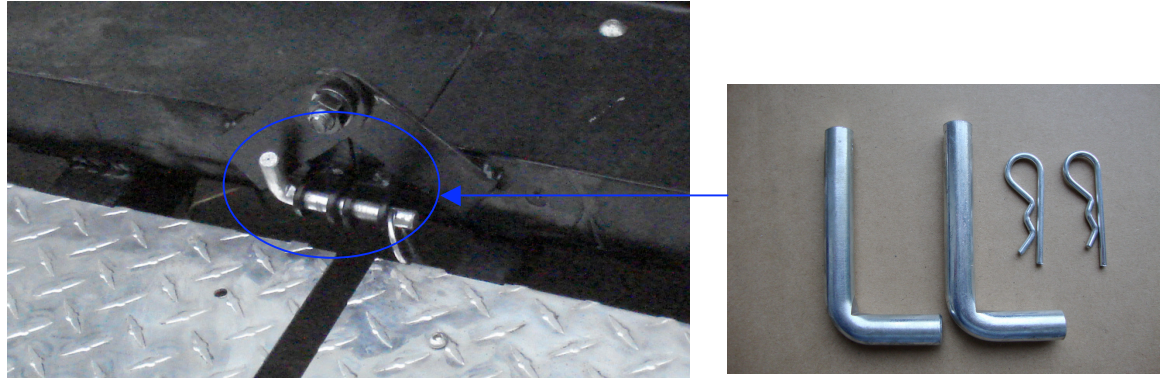

Figure 8-2

3. Once a motorcycle is loaded, lock the Rear Ramp (Part# A4) using 10 Pin Roll (Part# A19). See Figure 8-3.

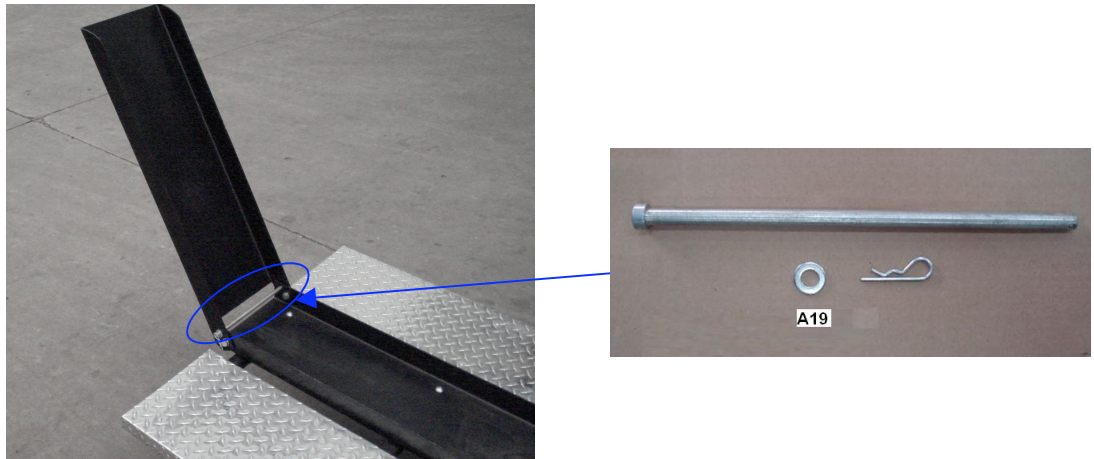

Figure 8-3

STEP 9

Install Hitch Coupler (Part# A13) to Tongue (Part# A1) with M10 x 75 bolts (Part# B13), M10 lock nuts (Part# B6) and M10 washers (Part# B5). The rear M10 x 75 bolt goes through center link of Safety Chain (Part# A14).

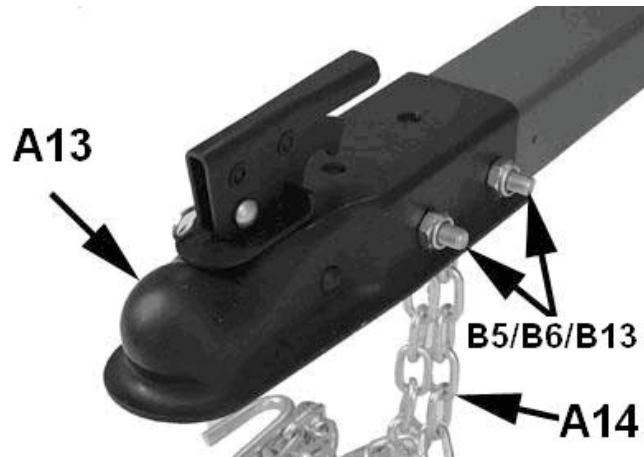

Figure 9-1

! WARNING:

Risk of trailer uncoupling.

The coupler provided with your trailer requires a 1-7/8 inch hitch ball.

Use only a 1-7/8 inch hitch ball on the tow vehicle towing this trailer.

NOTE: To reduce friction between the ball hitch and coupler, apply a layer of multipurpose lithium grease over ball hitch. Wipe off excess grease when not in use to avoid staining clothes.

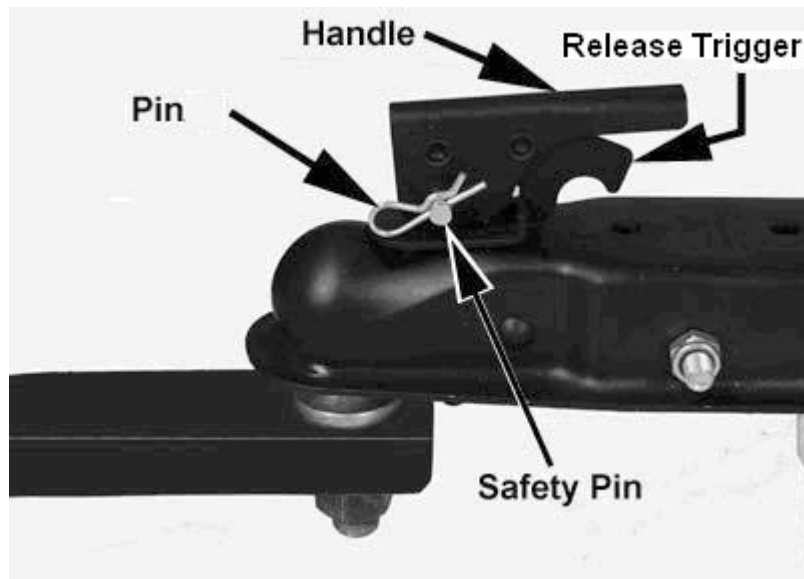

Figure 9-2

Pull up and down on the coupler to see if the coupler is fitting snug on the ball. There must not be play between the ball and coupler. If there is play, tighten the adjustment nut until no play is present. If the nut is too tight, the handle will not lock. See figure 9-3.

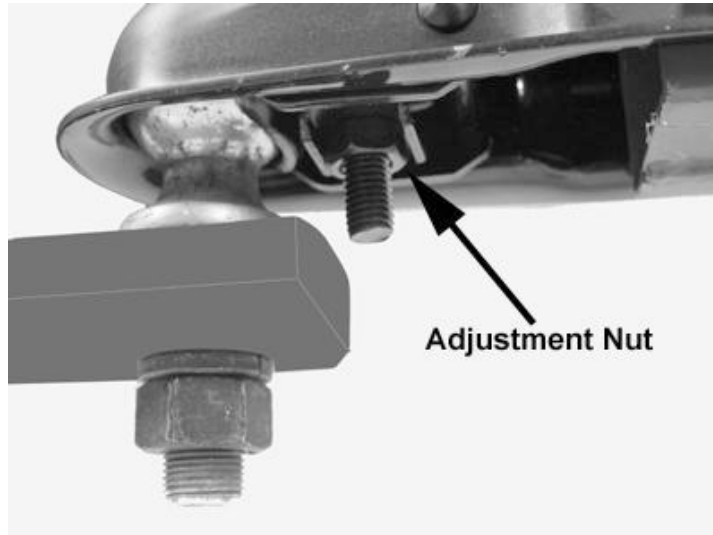

Figure 9-3

SAFE USE AND OPERATION RULES

1. TOWING VEHICLE

- Make sure vehicle is capable of towing the load.
- Recommended maximum speed for all passenger cars towing trailers is 55 MPH.

2. HITCH, BALL, COUPLER

- Check that the hitch on the towing vehicle is capable of towing the trailer. The capacity of the hitch is normally stamped on the hitch bar and the capacity of the ball is stamped on the ball.
- Make sure the coupler and the ball are the same size and are rated equal to or greater than the load.
- Never attach anything other than the proper size coupler to the ball for towing.

3. SAFETY CHAINS

- Always cross the chains under the coupler and connect the safety chains to the tow vehicle frame.
- Check that safety chains are attached to towing vehicle with the same length for each side.
- Do not allow chains to drag on ground.

4. LOADING

- Never overload trailer. **Maximum load is 700 lbs.**
- Secure motorcycle with tie-downs (not included) before being towed.

 **WARNING:** The tie-downs (not included) should be checked for security before you begin a trip and every 25 miles thereafter. Also check frequently for fraying or any other damage. If damaged, replace the tie-down(s). **DO NOT REPAIR, ALWAYS REPLACE.**

- It is unsafe and also against the law to carry passengers on or in any trailer.
- Always lock rear ramp in the travel position before towing trailer.

5. TIRES

- Check tires for wear, damage and proper inflation before each use and every 100 miles.
- Tire pressure should be 60 PSI.
- Check and tighten lug nuts. Tighten to 85-90 ft.-lbs. of torque.
- **RETIGHTEN AFTER FIRST 25, 50 AND 100 MILES AND BEFORE TOWING THEREAFTER.**

6. OPERATION

- Know how to properly control your towing vehicle-trailer combination on the highway under all conditions. It is important to remember that the loaded weight of the trailer will increase your braking and stopping distances appreciably.
- When towing a trailer over long distances, stop and check tightness of all connections, lights and running gear every 100 miles.
- Carry emergency flares, and fire extinguisher if required for operation in your state.
- It is desirable to carry extra bulbs and fuses if you are towing the trailer at night.

MAINTENANCE



WARNING: All maintenance, service or repairs listed in this manual are only to be attempted by a qualified service technician.

- Check and maintain the trailer, coupler, ball and hitch before each use and every 200 miles.
- Inspect coupler, hitch and ball for damage before each use.
- Ball or hitch can be damaged in parking, hitting curbs, dragging when crossing ditches or railroad tracks.
- Check safety chains and hooks for wear and do not allow safety chains to drag on ground.
- To prevent bearing damage, disassemble and repack wheel bearing with a good grade of wheel bearing grease every 2000-3000 miles or yearly.
- If you do not know how to repack wheel bearing, take your trailer to a qualified technician.

IMPORTANT:

The purpose of the following notices is to give you tips on safe use and operation of your motorcycle trailer.

1. Read the instructions carefully and follow them step-by-step for easy assembly. Keep this manual in a safe place.
2. Double check the Assembly instructions to be sure each is followed.
3. Before using, please inspect your trailer.
4. Do not remove the VIN sticker from the tow bar.

NOTE: Always comply with the following before using your trailer:

- 1) Tighten U-bolts
- 2) Tighten wheel lug nuts.
- 3) Make sure coupler is secured to the ball and is properly adjusted.
- 4) Cross and connect safety chains.
- 5) Trailer load must not exceed its 700-lb. capacity and must be properly secured.
- 6) Trailer load size must not exceed trailer's bed size.

TRAILER LICENSING NOTICE:

Some states may consider that this trailer kit is and specially constructed or a homemade vehicle for registration, licensing and/or titling purposes.

The M.C.O. (Manufacturer's Certificate of Origin) supplied with your trailer must be filled out and signed by the dealer transferring ownership to you.

When licensing your trailer, you will need the signed M.C.O., a purchase invoice, cash register receipt, or bill of sale showing the purchase and retail sales tax or use tax collection by the retailer. Take these to your local Department of Motor Vehicles and upon payment of the appropriate State fees, you will be issued a title, registration and license plate (if required). Some states will require inspection of the assembled and finished trailer kit before issuing a title registration/license.

If you require additional information or guidance on licensing or titling, please consult your State Department of Motor Vehicles.

DIAGRAM AND PARTS LIST

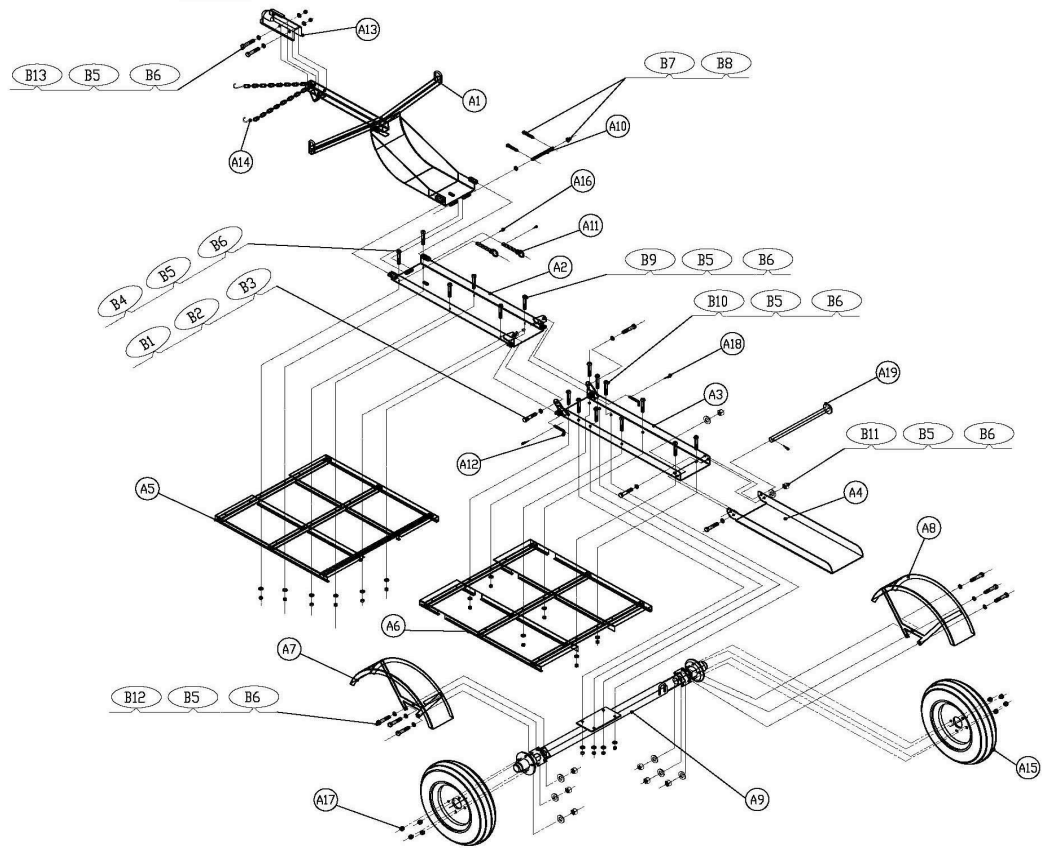

Part#	Description	Q'TY
A1	Tongue Assembly	1
A2	Front Channel	1
A3	Rear Channel	1
A4	Rear Ramp	1
A5	Front Frame	1
A6	Rear Frame	1
A7	Right Fender	1
A8	Left Fender	1
A9	Axle Assembly	1
A10	1/4 Pin Roll	1
A11	1/16 Safety Pin	2
A12	L-Pin	2
A13	Hitch Coupler	1
A14	Safety Chain	1
A15	Tire	2
A16	Spring Pin	2
A17	M12*1.25 Lug Nut	10
A18	R-Pin	3
A19	1/10 Pin Roll	1

Part#	Description	Q'T
B1	M12*30 Hex-Head Bolt	2
B2	1/12 Washer	4
B3	M12 Lock Nut	2
B4	M10*50 Bolt	10
B5	1/10 Washer	36
B6	M10 Lock Nut	26
B7	1/14 Washer	2
B8	1/4*35 Cotter Pin	2
B9	M10*20 Bolt	2
B10	M10*30 Bolt	4
B11	M10*25 Bolt	2
B12	M10*30 Bolt	6
B13	M10*75 Bolt	2

Note: Some parts and hardware are listed for illustration purposes only, and are not available individually as replacement parts.

WARRANTY

One-Year Limited Warranty

Reporting Safety Defects

If you believe that your vehicle has a defect which could cause a crash or could cause injury or death, you should immediately inform the National Highway Traffic Safety Administration (NHTSA) in addition to notifying Northern Tool & Equipment Company, Inc.

If NHTSA receives similar complaints, it may open an investigation, and if it finds that a safety defect exists in a group of vehicles, it may order a recall and remedy campaign. However, NHTSA cannot become involved in individual problems between you, your dealer, or Northern Tool & Equipment Company, Inc.

To contact NHTSA, you may call the Vehicle Safety Hotline toll-free at 1-888-327-4236 (TTY: 1-800-424-9153); go to <http://www.safercar.gov>; or write to:

Administrator, NHTSA
1200 New Jersey Avenue SE.
Washington, DC 20590.

You can also obtain other information about motor vehicle safety from <http://www.safercar.gov>.

The logo for ULTRA-TOW features the brand name in a bold, italicized, sans-serif font. A horizontal line is positioned above the letters 'A' and 'T', extending across the width of the text.

Distributed by
Northern Tool + Equipment Company, Inc.
Burnsville, Minnesota 55306-6936
Made in China