



# 30” Misting/Oscillating Fan

Model Number 01030

## READ AND SAVE THESE INSTRUCTIONS

### CAUTION:

Before using this product read this manual and follow all safety rules and operating instructions. Failure to comply with instructions could result in personal injury and/or property damage.

### IMPORTANT:

For replacement parts or assembly questions call 1-800-320-MIST or go to [www.auramist.net](http://www.auramist.net)

### TABLE OF CONTENTS

1. Safety Information
2. Hardware Package Contents
3. Carton Contents
4. Assembly
5. Operation
6. Maintenance
7. Storage
8. Troubleshooting
9. Warranty

### SAFETY INFORMATION

1. Read all instructions before using the misting fan. This product is designed to operate with DRINKING WATER ONLY. City water supply, bottled water, and other sources deemed suitable for human consumption will ensure optimal functionality of the system throughout maintenance intervals.  
In the event that another liquid other than DRINKING WATER is used to fill the water tank, immediately drain the contents of the tank and contact customer service regarding steps to take to help determine the usability of your system
2. Make sure that the power source complies with the electrical requirements of the Misting Fan.
3. Use this Misting Fan only as described in this manual. Any other use may cause electrical shock, fire, injury to persons or animals.
4. To reduce the risk, or personal injury, the misting fan should not be use as a toy or placed where small children can reach it.

**WARNING: DO NOT USE THE FAN MOTOR OR THE MISTING ON-OFF SWITCHES AS THE MEANS OF DISCONNECTING POWER WHEN INSTALLING OR SERVICING THIS PRODUCT. ALWAYS DISCONNECT THE POWER CORD.**

5. Disconnect the power cord before moving or performing any maintenance on the Misting Fan.
6. This misting fan shall not be used in potentially dangerous conditions, such as flammable, explosive or chemically loaded atmospheres.
7. The Misting Fan shall be completely assembled, according to these instructions before connecting to power source.

**WARNING: DO NOT USE A THREE PRONG TO TWO PRONG ADAPTER. IMPROPER CONNECTION MAY CREATE A RISK FOR ELECTRICAL SHOCK.**

8. The power cord of the Misting Fan is equipped with a three prong grounded plug, and it shall be connected into the corresponding power receptacle. Under no circumstance, shall the grounding leg be removed or bypassed from the power cord plug.
9. If the use of an extension cord is required, minimize the risk of overheating or fire by ensuring the extension is UL, ETL, CETL or CSA listed. Do not operate more than one Misting Fan per extension cord.
10. Do not operate the Misting Fan with a damage power cord, plug or after the Misting Fan is damage in any manner. Call an authorized service center for evaluation, adjustment or repair.
11. Do not insert or allow any foreign objects to enter the intake or exhaust air openings, as it may cause mechanical, electrical, or fire damage to the Misting Fan.
12. Do not block or tamper the Misting Fan nozzles, as it may reduce or impede the functionality or quality of the Misting Fan. Call an authorized service center for evaluation, adjustment or repair.
13. Always place the Misting Fan on a stable flat surface to avoid the chance of tipping over the Misting Fan.
14. Never placed the Misting Fan where it may fall into a water reservoir (example: bathtub, pool), or anything containing an electrical conductive substance.
15. When the product is used outdoors, use only on GFCI (Ground Fault Circuit Interrupter) protected receptacles.
16. All parts of the appliance are packed in one container.

**CAUTION: THIS MISTING FAN SHALL BE ASSEMBLED ACCORDING TO THESE INSTRUCTIONS, DUE TO ITS WEIGHT AND SIZE. FAILURE TO DO SO COULD RESULT IN THE PRODUCT COMING APART DURING OPERATION AND/OR PERSONAL INJURY.**

## HARDWARE PACKAGE CONTENTS

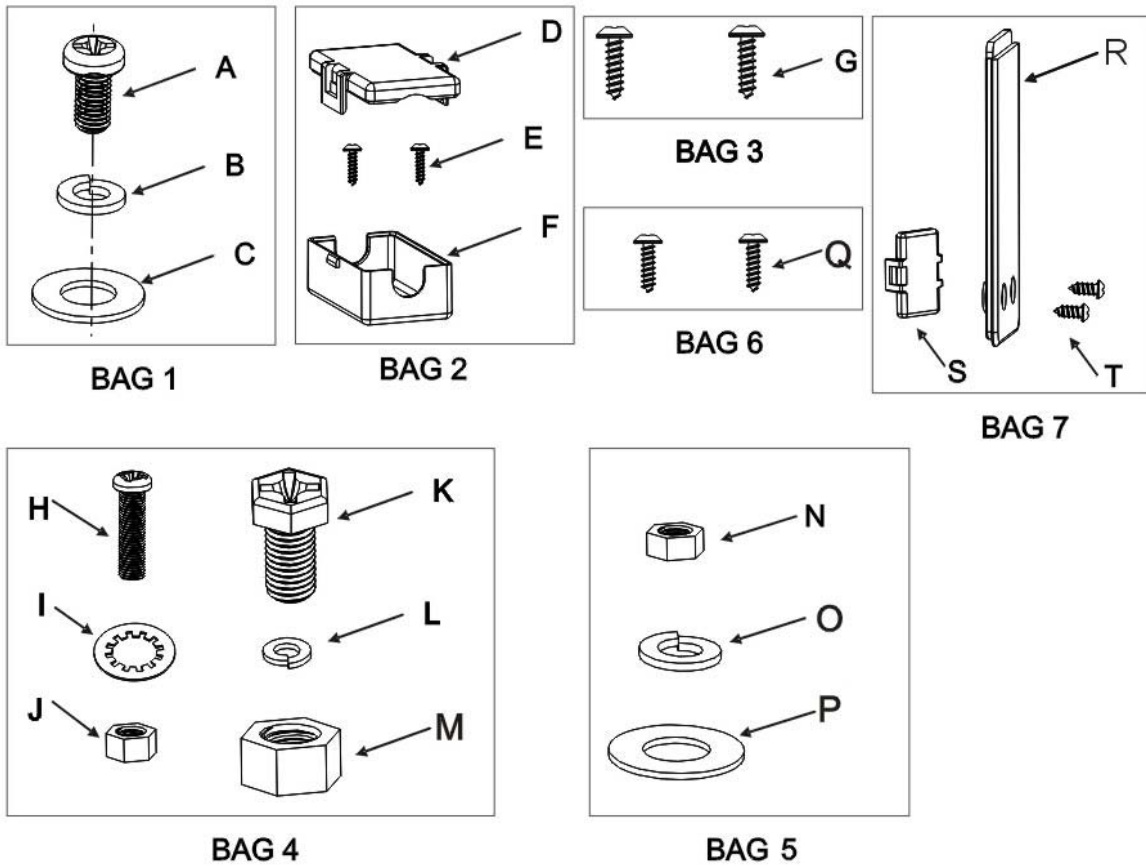

REFERENCE	HARDWARE BAG	QUANTITY	DESCRIPTION
A	1	4	M8 x 14 Screw
B	1	4	8 mm Pressure Washer
C	1	4	8 mm Flat Washer
D	2	1	Electrical Enclosure Top
E	2	2	ST 3.5 x 14 Screw
F	2	1	Electrical Enclosure Bottom
G	3	2	ST 4.0 x 12 Screw
H	4	1	M6 x 24 Screw
I	4	1	6 mm Lock Washer
J	4	1	M6 Nut
K	4	1	M13 X 24 Screw
L	4	1	φ 13 Pressure Washer
M	4	1	M13 Nut
N	5	4	M5 Nut
O	5	4	φ 5 Pressure Washer
P	5	4	φ 5 Flat Washer
Q	6	2	ST 3.0 X 14
R	7	1	Electrical Box Lid
S	7	1	Electrical Enclosure
T	7	2	ST 3.5 x 10 Screw

## CARTON CONTENTS

1. Front Fan Guard Assembly
2. Rear Fan Guard Assembly
3. Fan Blade
4. Power Base Assembly
5. Base Cover
6. 3 Speed Oscillating Motor Assembly
7. Mist Control Unit
8. Fan Pole Assembly

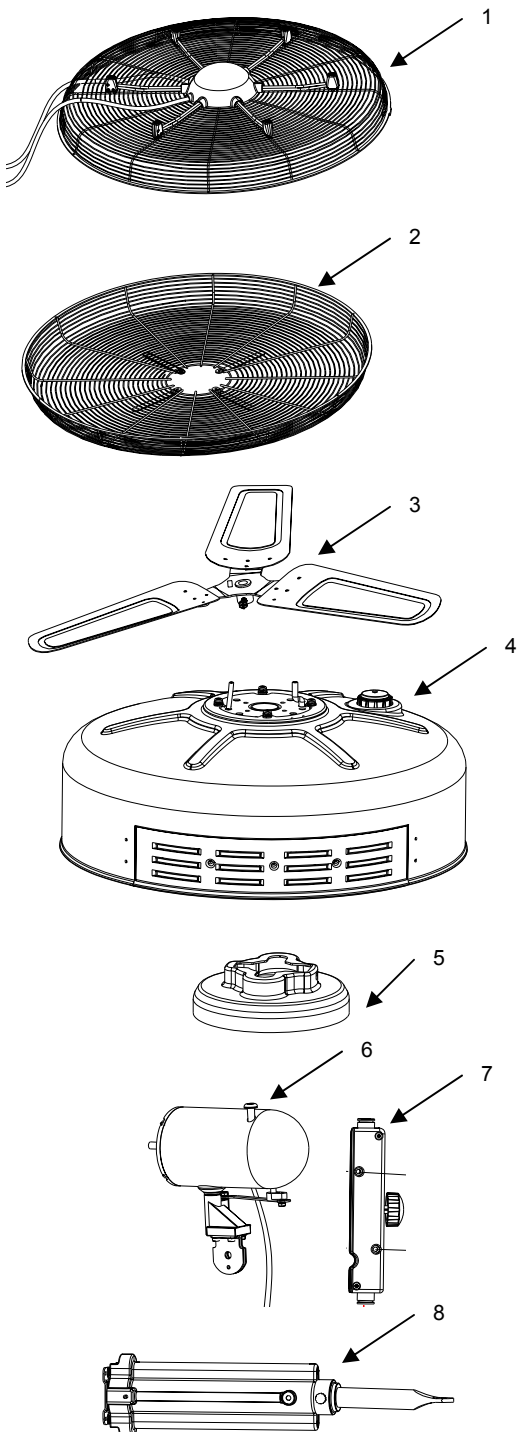

## FAN POLE ASSEMBLY TO POWER BASE ASSEMBLY

1. Align fan pole assembly "On-Off" switch to the Ventilation Grill. Gently pull hoses from power base assembly. (A-1)

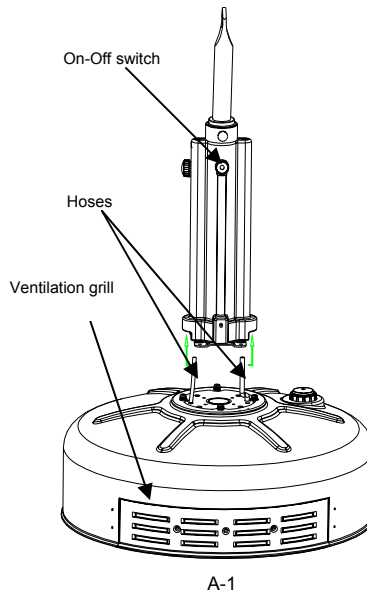

2. Fasten (four places) the fan pole assembly to the power base assembly by using fasteners from bag 1 (A-2).

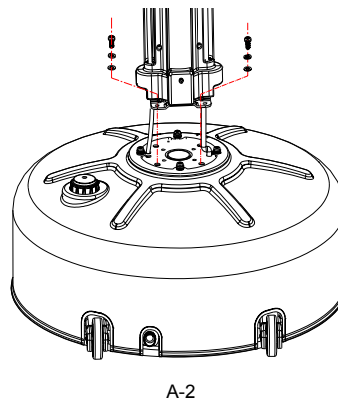

3. Fasten electrical housing with 2 screws from bag 2 (B-1).

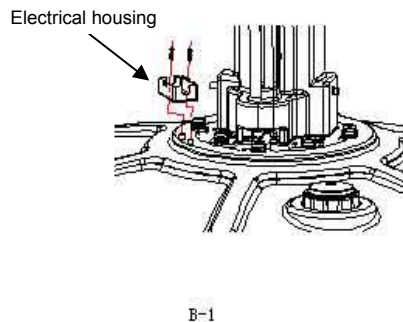

4. Connect the two wires, and close the electrical housing with housing lid in **bag 2** (B-2 and B3).

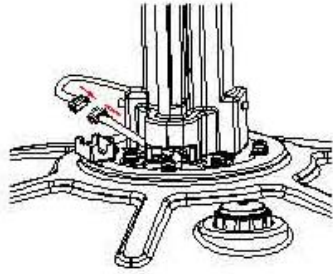

B-2

Electrical housing lid

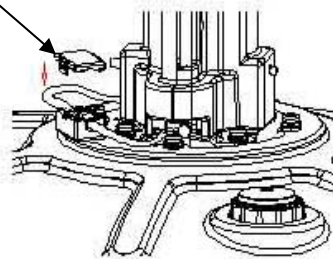

B-3

5. Align and slide base cover and fasten to back and front of mist control / fan pole assembly with two screws from **bag 3** (C-1).

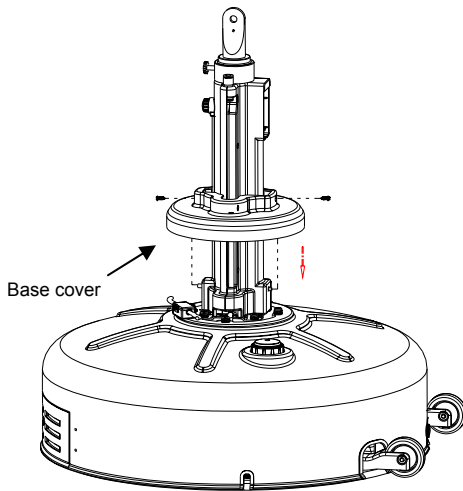

C-1

6. Install mist control unit by using fasteners from **bag 6**. Pull the water and air tube through the opening on the side of the fan pole assembly until they are inserted securely in the "Push-In" connector (C-2).

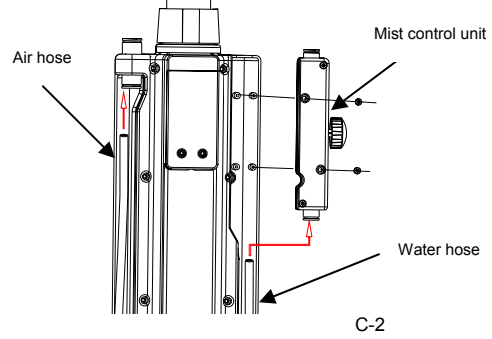

C-2

### FAN POLE ASSEMBLY TO MOTOR ASSEMBLY

1. Attach the motor to the Center Pole and fasten securely (D-1) with all fasteners from **bag 4**. Use an adjustable wrench to tighten the fasteners.

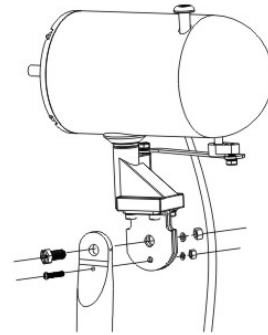

D-1

### FAN GUARD AND BLADE ASSEMBLY

1. Locate the small screw and nut at the bottom of the rear guard and position it so it is pointing to the ground. Mount the rear guard to the fan motor with screw from **bag 5** (E-1).

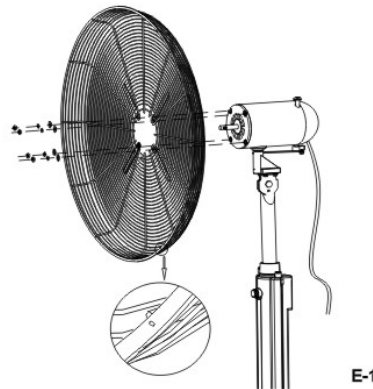

E-1

2. Mount the fan blade to the fan motor (E-2). Make sure the fan blade set screw is on the flat section of the fan motor shaft. Complete the fan assembly by removing the small screw and nut, and mounting the

front guard and tighten all the hinges around outer rims of the fan guard (E-3, E-4).

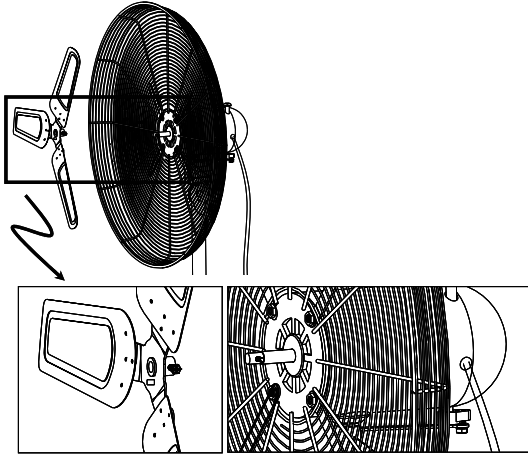

E-2

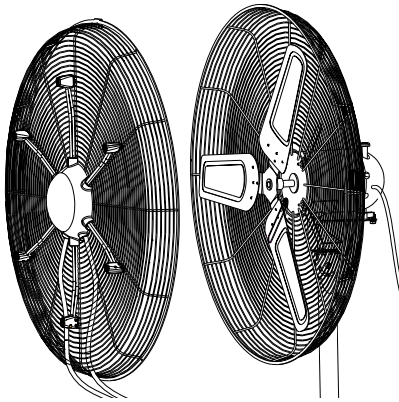

E-3

3. Place the small screw and nut at the bottom hole to secure the forward and rear guards (E-4).

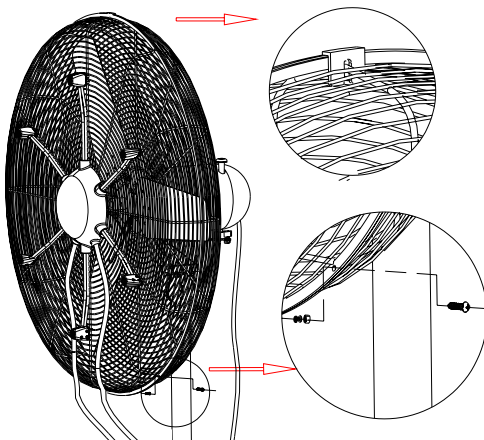

E-4

4. Connect nozzle housing by gently pushing the attachment legs on the front guard wire (E-5)

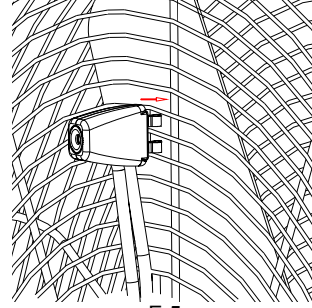

E-5

## AIR, WATER AND ELECTRICAL CONNECTIONS

1. Connect the air and water tubes to the connectors on the Mist Control / Fan Pole Assembly. The water is the smaller tube. Make sure the tube is pushed all the way into the connector, then make the electrical connection (F-1)

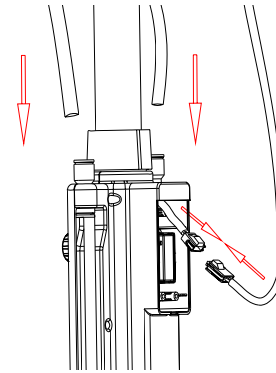

F-1

2. Place the connector inside the electrical housing, and then place the housing lid. Use screws and the lid from bag 7, to close the mist control / fan pole assembly (F-2, F-3). Do not over tighten the screws.

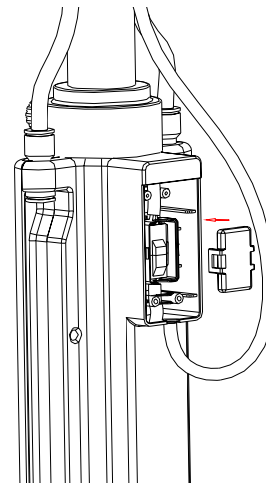

F-2

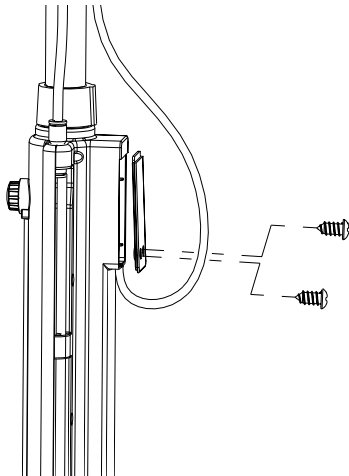

F-3

## OPERATING INSTRUCTIONS

### Read this owner's manual before operating this product

1. To operate the misting fan, plug the power cord into a 120 VAC, 60Hz outlet.

**CAUTION: FAN AND/OR MISTING SYSTEM MAY START UP WHEN THE UNIT IS INITIALLY PLUGGED TO THE POWER OUTLET.**

2. Fan Operation (ON-OFF, Speed control)

Pull Action	Speed
First	High
Second	Medium
Third	Low
Fourth	"OFF"

3. Fan Operation (Oscillation Control)

To turn on the oscillation function, press down the oscillation switch, to stop the function simply pull-up the oscillation switch. The oscillation angle is approximately 50° (G-1)

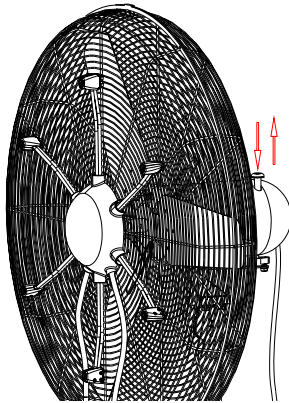

G-1

4. Misting Operation

**IMPORTANT:** This product is designed to operate with DRINKING WATER ONLY. Fan and/or misting system may start up when the unit is initially plugged to the power outlet.

### BEFORE STARTING

- Remove fill cap on power base assembly and fill with DRINKING WATER through the basket filter until tank is filled to approximately 1" below the bottom of the basket filter.
- Add ½ teaspoon of unscented chlorine bleach to the water tank (approximately 5 drops per gallon of drinking water).
- Replace cap and hand tighten.
- The misting function of this product is turned on by simply rotating the switch on the fan pole assembly, clockwise. It might take around 2-4 minutes for a new misting fan to start misting, and it is normal for air to come before water.

### ADJUSTING MIST DENSITY

To optimize the cooling effectiveness of the system, you can:

- Operate the unit with a DRY or WET mist, based on your needs.
- To increase the mist density, turn the mist control valve counterclockwise.
- To decrease the mist density, turn the mist control valve clockwise.

When the misting fan is turned "OFF", the air-pump continues to work for approximately 2 to 4 minutes. This allows the air-pump to clear the remaining water from the nozzle hoses to prevent accumulation of deposits and reduce the risk of clogging.

5. Operating Tips

Use DRINKING WATER only in the system. For dry climates, increasing the water flow will provide maximum cooling results. In humid climates, a reduced water flow is recommended.

## MAINTENANCE

**WARNING: ALWAYS UNPLUG THE POWER CORD BEFORE MOVING OR SERVICING**  
**WARNING: DO NOT IMMERSE THE MISTING FAN IN WATER!**

### CUSTOMER RESPONSIBILITIES

Read and follow the maintenance schedule and the maintenance procedures listed in this section.

### EMPTYING WATER TANK

- Place misting fan on surface where water can be drained to.
- Remove drain plug by turning counterclockwise.
- Allow tank to drain completely.
- Replace drain plug and hand tighten turning clockwise.

### CLEANING BASKET FILTER

- Remove fill cap and remove basket filter.
- Rinse debris from filter with running water.
- Replace basket filter and fill cap.

## CONDITIONING WATER TANK

Conditioning the water tank ensures that the cooling system will operate at optimal levels throughout the life of the system. It is suggested that the tank be conditioned at an interval of every 4th filling or once/month; whichever comes first.

- Completely drain water tank. (See Emptying Water Tank)
- Fill tank with DRINKING WATER. Be sure to always fill tank with basket filter in place.
- Add ½ teaspoon of unscented chlorine bleach to the water tank (approximately 5 drops per gallon of drinking water).
- Replace cap and hand tighten.
- Run system for 5 minutes with a WET mist.
- The system is conditioned and ready for operation.

## REPLACING FILTERS

The filters have been designed to provide optimal system performance by catching any debris that may enter the supply lines throughout use. Semi annual replacement of both the air and water filters ensures the life of your system.

- Remove the ventilation grill and locate the air and water filters (J-1, J-2).

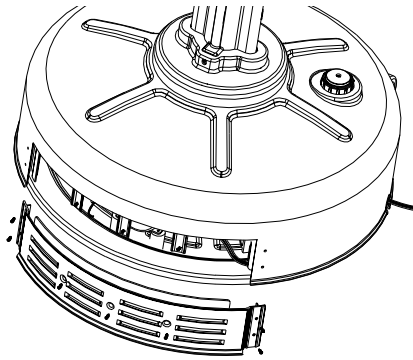

J-1

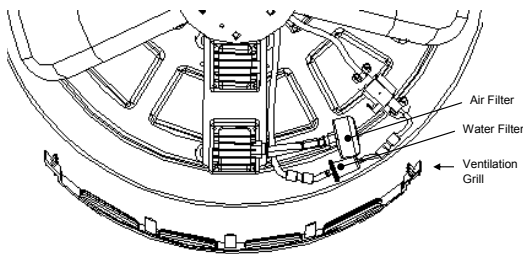

J-2

- The filters are connected to the system via “Push-In” connectors for ease of service. Push the connector and pull the hose (J-3).

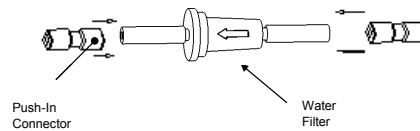
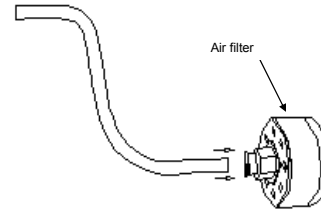

J-3

- Dispose of filter.

**CAUTION: IMPROPER PLACEMENT OF THE FILTER CAN DEGRADE SYSTEM PERFORMANCE.**

- Remove filter from package and orient the directional arrow so that the flow direction is towards the left J-4.

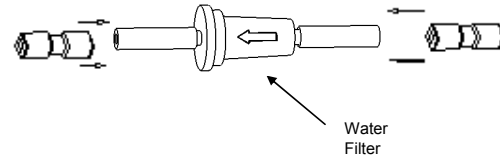

J-4

- Push the hose into the push-in connector to connect the filters
- Reinstall ventilation grill.
- Any other servicing of this unit, except for general maintenance described in this section, should be performed by an authorized service representative.

## STORAGE

1. Empty water tank completely, replace cap, and run system to evacuate all water in supply lines.
2. Clean debris from ventilation grill area on front of power unit.

**CAUTION: DO NOT USE GASOLINE, THINNER, ALCOHOL, SOLVENTS OR OTHER HARSH CLEANERS, SINCE THEY WILL DAMAGE THE MISTING FAN.**

3. Clean the unit with a soft cloth and mild soap solution. Dry all parts completely. Store the fan in a clean and dry place.

## TROUBLESHOOTING

PROBLEM	CAUSE	CORRECTION
Power base not running	1. Power cord in not connected 2. Switch in "OFF" position	1. Connect power cord 2. Rotate switch to "ON" position
Fan not running	1. Power cord in not connected 2. Switch in "OFF" position	1. Connect power cord 2. Pull fan switch
Unit not misting	1. Water tank is empty 2. Misting valve in "CLOSED" position 3. Water filter needs replaced	1. Fill tank with DRINKING WATER 2. Open valve (counterclockwise) 3. Replace water filter
Water streaming from nozzle	1. Air filter needs replaced 2. Air hose leaks  3. Foreign object in nozzle	1. Replace air filter 2. Turn off fan motor, and feel any air leaks on hoses 3. Order and replace nozzle holder
Water dripping from drain plug	1. Drain plug not seated 2. Drain plug seal is missing or damage	1. Properly seat drain plug 2. Replace drain plug seal

## WARRANTY

### ONE YEAR FULL WARRANTY

This product is warranted for one year from the date of purchase against defects in materials and workmanship. At our discretion, parts that prove to be defective will either be repaired or replaced, or the whole product will be replaced. In either case copy of your proof of purchase will be required.

In case that any mechanical or electrical repairs are required during the warranty period send your complete product, postage or freight prepaid to the auraMIST service center near you. Call the number below to get the nearest service center.

This warranty does not include the air or water filters, which are expendable parts that can wear out from normal use within the warranty period. This warranty applies for only 90 days if this product is ever used for commercial or rental purposes.

**AuraMIST, LLC**  
**5210 Village Parkway**  
**Rogers, AR 72758**

The model number and manufacturing date code can be found on the label attached to the back of the power unit. You should record both the model number and the date of purchase and keep in a safe place for future reference.

MODEL NUMBER:           XXXXX  
MFG DATE CODE:        XXXX  
SERIAL NUMBER:         XXXXXXX  
DATE OF PURCHASE:    XX-XX-XX

CUSTOMER SERVICE NUMBER:   1-800-320-MIST  
Website:                           www.auramist.net