



# M1144A

## Fender Installation Instructions

### Contents:

- 778846 - Fenders – 2
- 82017 - 5/16" x 1 1/2" Bolts – 4
- 82020 - 5/16" Lock Nuts – 4
- 82021 - 5/16" Flat Washers – 3

### Instructions:

Insert bolts through holes in fender and the tabs on the tank. To mount fender to motor mount, place 3 washers between fender and motor mount, then insert bolt and tighten. Tighten nuts on the bolts to 40 ft-lbs.

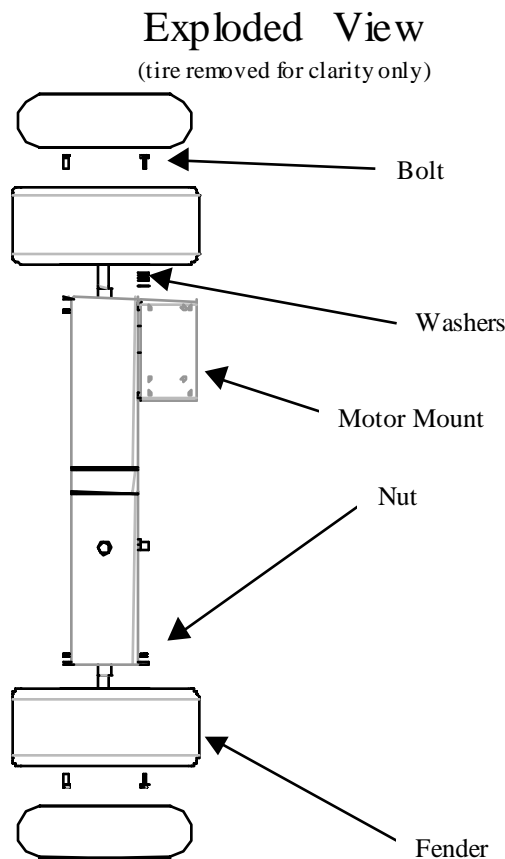

### **Assembled View**

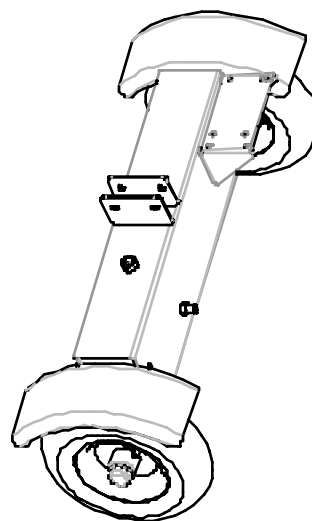

FIGURE 103