

Absorbant Glass Mat (AGM) technology for superior performance. Valve regulated, spill proof construction allows safe operation in any position. Approved for transport by air. D.O.T., I.A.T.A., F.A.A. and C.A.B. certified. U.L. recognized under file number MH 20567.

Maintenance-Free



Due to continuous improvements to our products, product may vary slightly from depiction.

Specification

Nominal Voltage	12 volts		
Nominal Capacity	77° F (25° C)		
20-hr. (1.10A)	22.0 Ah		
10-hr. (2.05A)	20.5 Ah		
5-hr. (3.74A)	18.7 Ah		
1-hr. (13.2A)	13.2 Ah		
Approximate Weight	13.01 lbs (5.9 kgs)		
Internal Resistance (approx.)	11mOHMS		
Shelf Life (% of normal capacity at 68° F (20° C)			
3 Months	6 Months	12 Months	
91%	83%	64%	
Temperature Dependency of Capacity	(20 hour rate)		
104° F (40°C)	77° F (25°C)	32° F (0°C)	5° F (-15°C)
102%	100%	85%	65%
AGM Operational Temperature			
Charge	32°F to 104°F (0°C to 40°C)		
Discharge	5°F to 113°F (-15°C to 45°C)		
AGM Storage Temperature	5°F to 104°F (-15°C to 40°C)		

universal battery®			
Non-Spillable Sealed Lead-Acid Battery			
AGM TYPE			
12220	12V	22Ah	
Constant Voltage Charge at 25°C	Voltage Regulation	Initial Current	
Standby Use	13.8 - 13.9V	No Limit	
Cyclic Use	14.4 - 14.6V	6.6A	
C/S Capacity @ 30°C: 18.7Ah			
UB12220			UPG STAY POWERED®

Charge Method (Constant Voltage)	
Cycle Use (Repeating Use)	
Initial Current	7.7 A or smaller
Control Voltage	14.6 - 14.8 V
Float Use	
Control Voltage	13.6 - 13.8 V

Physical Dimensions: in (mm)

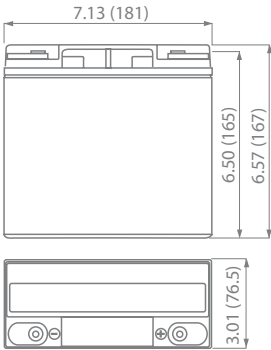

L: 7.13in (181 mm)
W: 3.01in (76.5 mm)
H: 6.50in (165 mm)
TH: 6.57in (167 mm)
 Tolerances are +/- 0.04 in. (+/- 1mm) and +/- 0.08 in. (+/- 2mm) for height dimensions. All data subject to change without notice.

Terminals

I Series (Internal Thread)

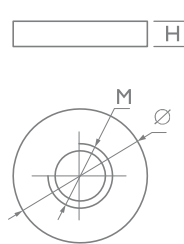

Type	Dimension	M	Ø	H
I10		5.00mm 0.19 in	12 mm 0.47 in	5.00mm 0.19 in

Discharge Time vs. Discharge Current

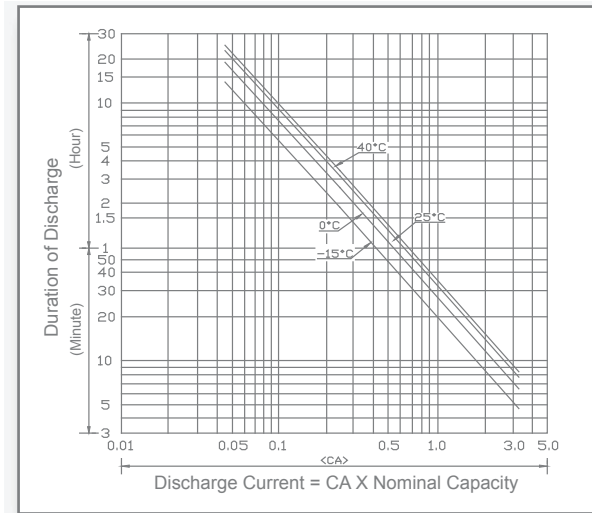

Discharge Characteristics

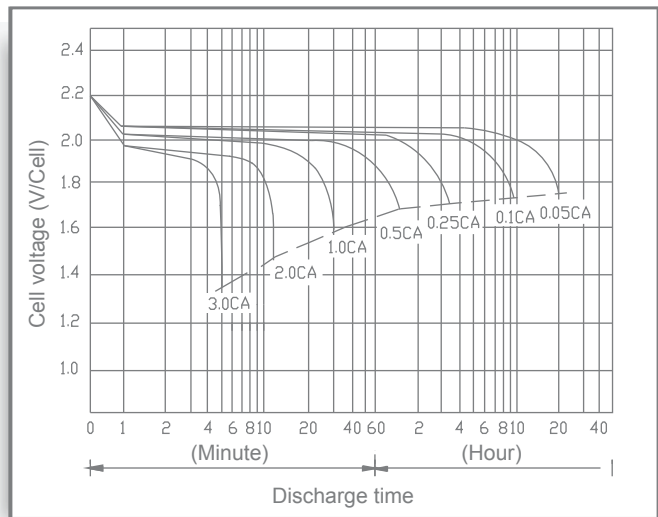

UB12220

Maintenance-Free

Shelf Life & Storage

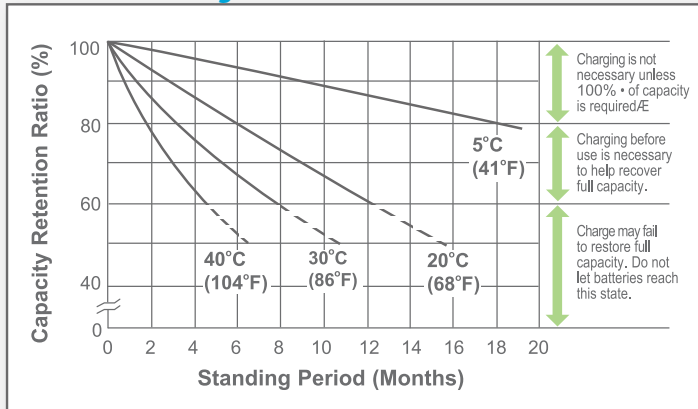

Cycle Life vs Depth of Discharge

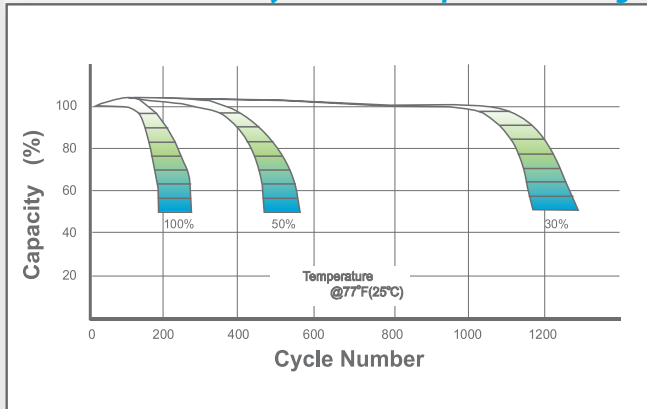

Open Circuit Voltage vs Residual Capacity

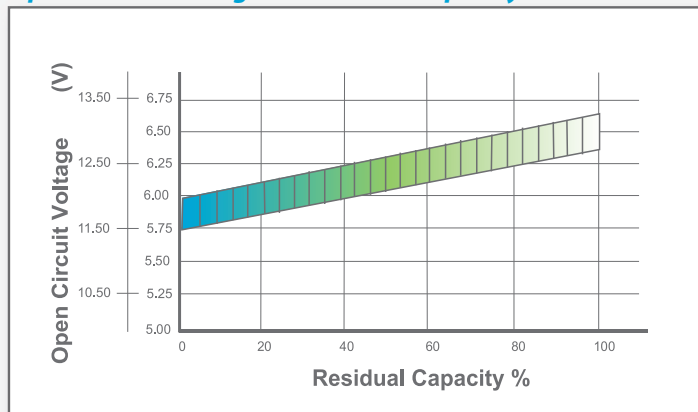

Effect of Temperature on Capacity

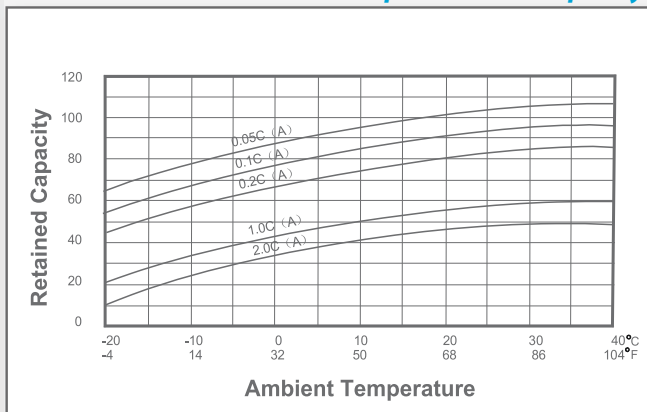

Charge Current & Final Discharge Voltage

Application	Charge Voltage(V/Cell)			Max. Charge Current	Final Discharge Voltage V/Cell	1.75	1.70	1.60	1.30
	Temperature	Set Point	Allowable Range						
Cycle Use	25°C(77°F)	2.30	2.40~2.47	0.3C	Discharge Current(A)	0.2C>(A)	0.2C<(A)<0.5C	0.5C<(A)<1.0C	(A)>1.0C
Standby	25°C(77°F)	2.28	2.26~2.30						