



SERVICE PARTS LIST

BULLETIN NO.
54-49-8410

SPECIFY CATALOG NO. AND SERIAL NO. WHEN ORDERING PARTS		REVISED BULLETIN	DATE
M18 FUEL™ PACKOUT™ 2.5 Gal Wet/Dry Vacuum			Apr. 2025
CATALOG NO.	0970-20	SERIAL NO.	L90A
WIRING INSTRUCTION			

EXAMPLE:

00	0
----	---

 Component Parts (Small #)
 Are Included When Ordering
 The Assembly (Large #).

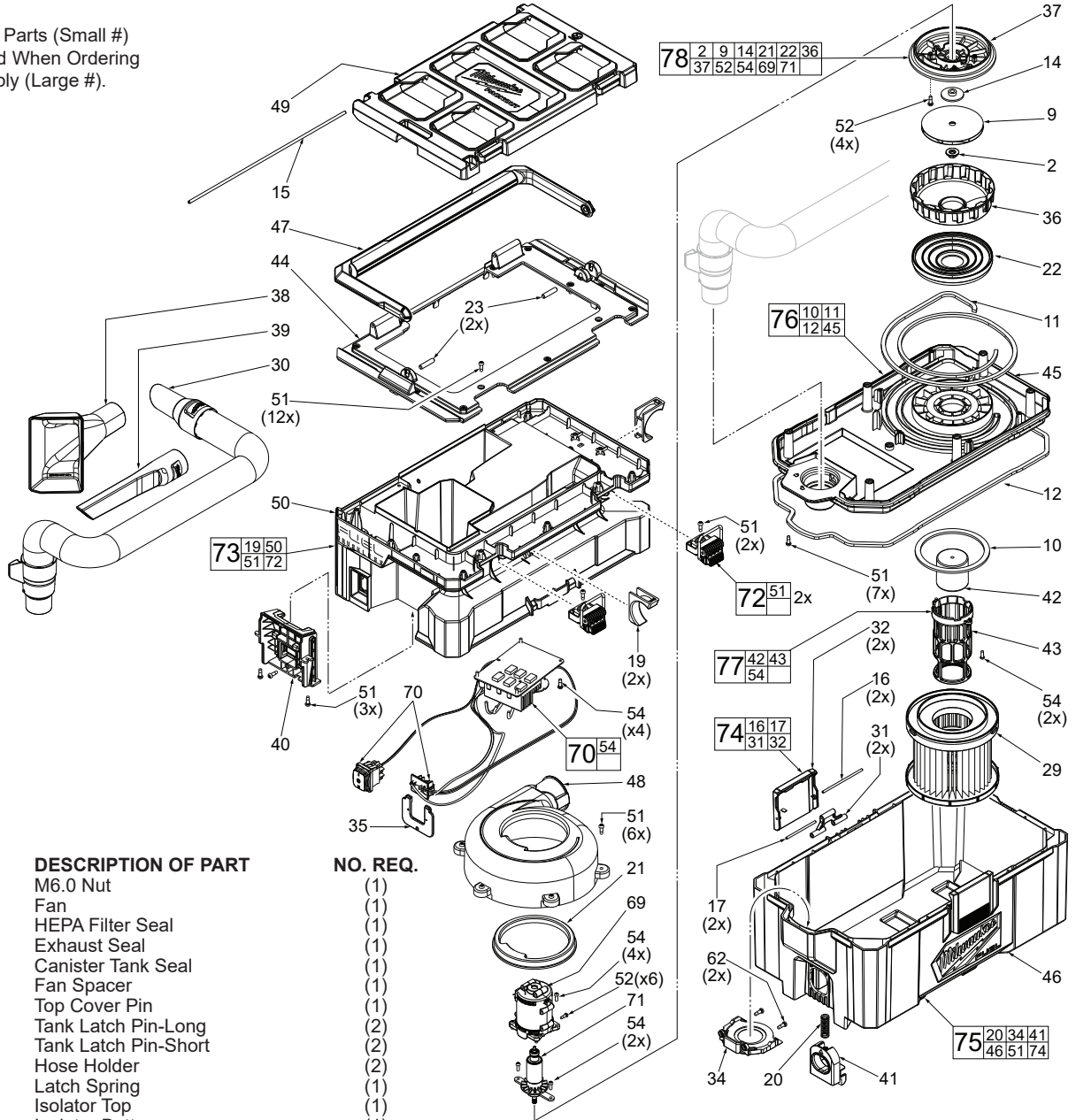

FIG.	PART NO.	DESCRIPTION OF PART	NO. REQ.
2	06-55-0021	M6.0 Nut	(1)
9	-----	Fan	(1)
10	43-44-0036	HEPA Filter Seal	(1)
11	43-44-0037	Exhaust Seal	(1)
12	43-44-0038	Canister Tank Seal	(1)
14	-----	Fan Spacer	(1)
15	44-60-0123	Top Cover Pin	(1)
16	-----	Tank Latch Pin-Long	(2)
17	-----	Tank Latch Pin-Short	(2)
19	43-72-0051	Hose Holder	(2)
20	40-50-0213	Latch Spring	(1)
21	43-87-0016	Isolator Top	(1)
22	-----	Isolator Bottom	(1)
23	44-60-0124	Handle Pin	(2)
29	49-90-1900	Hepa Filter	(1)
30	49-90-2014	Hose Assembly	(1)
31	-----	Tank Latch Pivot	(2)
32	-----	Tank Latch	(2)
34	42-16-0012	Dust Bag Holder	(1)
35	44-66-0218	Terminal Block Mounting Plate	(1)
36	-----	Fan Shroud	(1)
37	-----	Motor Mounting Base	(1)
38	31-01-0875	Utility Tool	(1)
39	31-01-0855	Crevice Tool	(1)
40	23-33-0018	Battery Receptacle	(1)
41	44-20-0085	PACKOUT™ Latch	(1)
42	-----	Ball Float	(1)
43	-----	Ball Float Cage	(1)
44	31-50-0101	Main Body Cover	(1)
45	-----	Connector Plate	(1)
46	-----	Tank	(1)
47	31-44-0236	Carrying Handle	(1)
48	31-15-0167	Exhaust Chute	(1)
49	31-50-0108	Top Cover	(1)

FIG.	PART NO.	DESCRIPTION OF PART	NO. REQ.
50	-----	Main Body	(1)
51	06-82-1081	M4 x 12mm Pan Hd. ST Screw	(30)
52	06-82-1082	M3 x 16mm Pan Hd. ST Screw	(6)
53	12-20-0267	Service Nameplate (Not Shown)	(1)
54	06-82-1083	M3.5 X 10mm Pan Hd. ST Screw	(12)
62	05-74-1011	8-18 x 12mm Hi-Lo T15 Screw	(2)
69	-----	Service Stator Assembly	(1)
70	14-20-1009	Service Electronics Assembly	(1)
71	-----	Service Rotor Assembly	(1)
72	14-46-0316	Service Latch Kit-Main Body	(2)
73	14-38-0116	Main Body Service Assembly	(1)
74	14-46-0422	Service Latch Assembly-Tank	(2)
75	31-01-0173	Tank Service Assembly	(1)
76	44-66-0277	Connector Plate Service Kit	(1)
77	42-46-0027	Float Ball/Cage Service Kit	(1)
78	16-01-0107	Motor/Stator Assembly	(1)